

# Attachment A

Attachment 'A' - ADL 104877  
DEVELOPMENT PLAN DIAGRAM

ADL 108347

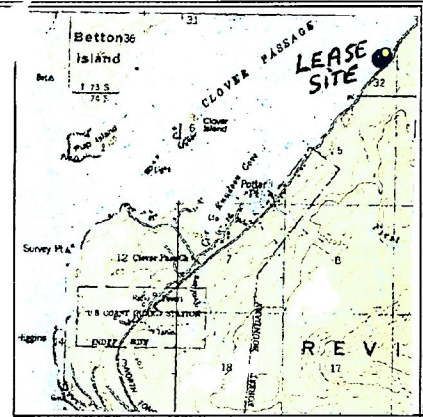

VICINITY MAP

Ketchikan B6

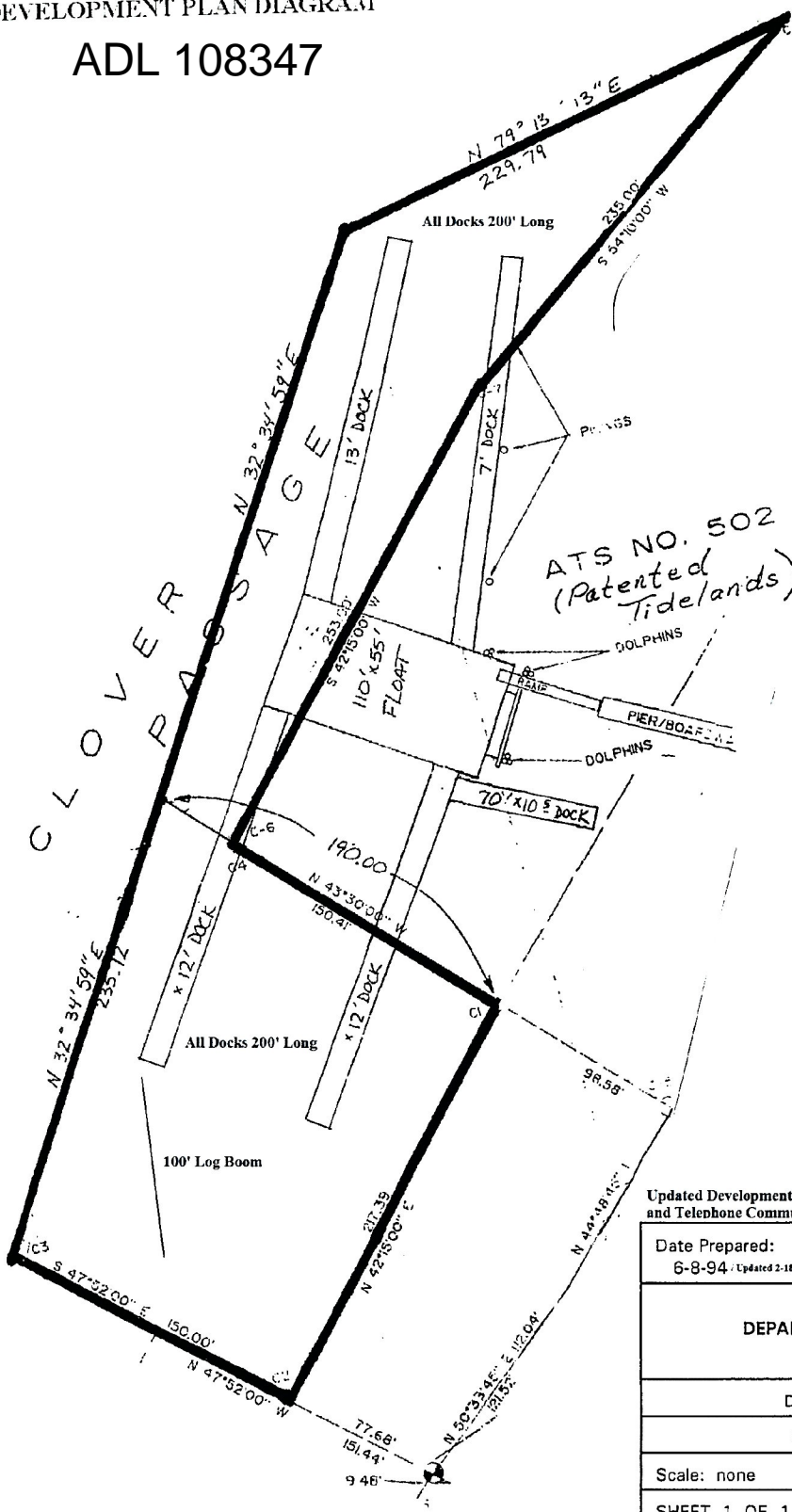

Updated Development Plan Based on 2-17-2015 Application, Aerial Photos, Email and Telephone Communication with Applicant

Date Prepared: 6-8-94 / Updated 2-18-2015	Applicant's Name: Salmon Falls Inc.
STATE OF ALASKA DEPARTMENT OF NATURAL RESOURCES DIVISION OF LAND	
DEVELOPMENT PLAN DIAGRAM	
Sec. 32, T.73S., R.90E., CRM	
Scale: none	Partial dock & finger floats
SHEET 1 OF 1	Tideland Lease - ADL 104877