

1 in equals 1,000 feet

Contour Interval 100 Feet

Background Data Source:
 USFS GIS Library May, 2010

Parcel Boundary Source:
 2014 Ketchikan Gateway Borough

NAD 1983

Proposed State Forest Road Existing Road Operable Timber Base KETCHIKAN GATEWAY BOROUGH UNIVERSITY OF ALASKA NATIONAL FOREST STATE FOREST	Cataloged Anadromous Uncataloged Anadromous Resident Fish Water Quality Eagle Trees
---	---

This map set depicts the proposed Vallenar Bay Project located on Gravina Island in Township 74 and 75 South, Range 89 and 90 East, Copper River Meridian.

Exhibit B
Vallenar Bay Timber Sale
Map
Page 1 of 5

Division of Forestry
 Date Saved: 1/14/2015 10:30:08 AM

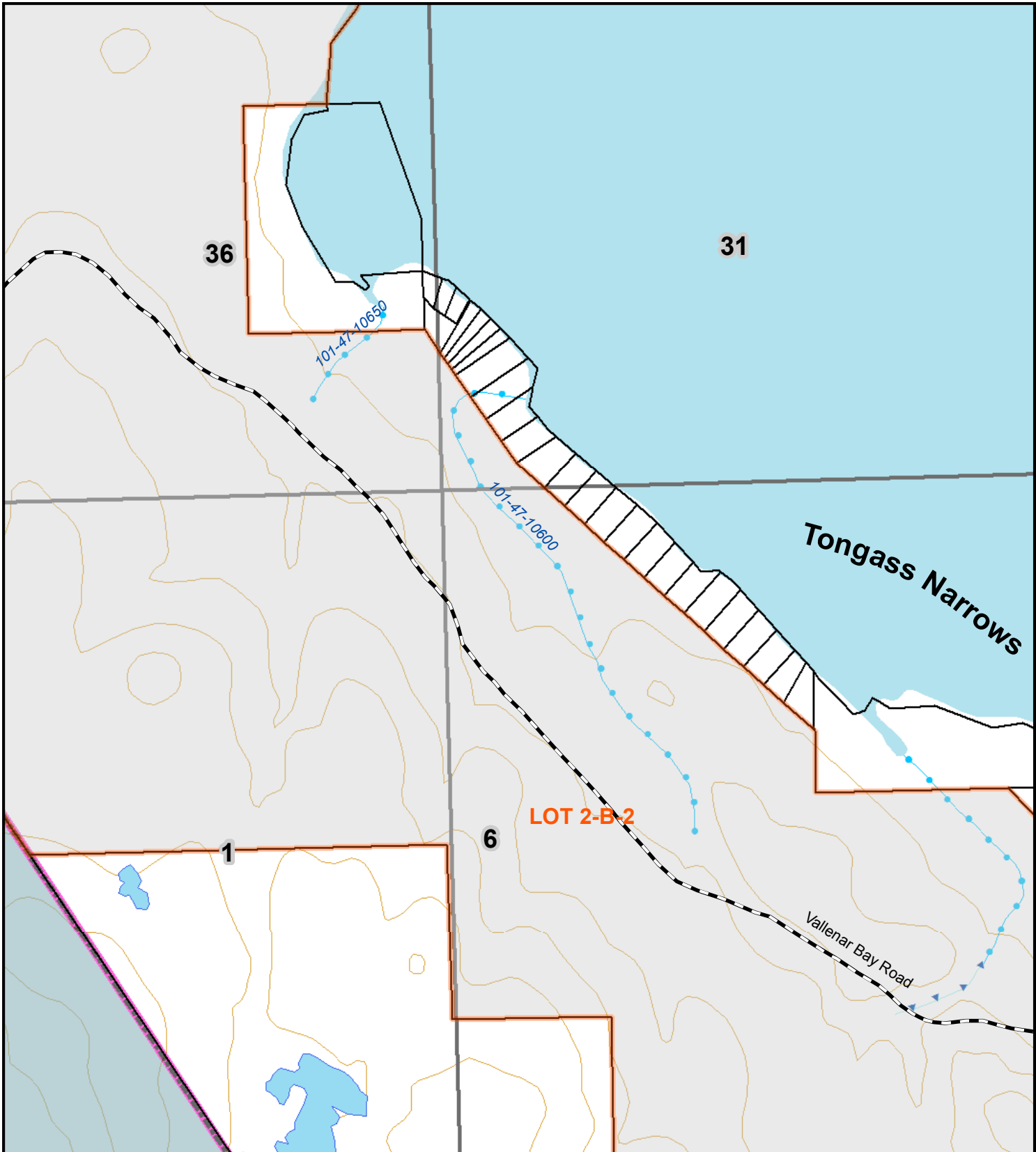

1,000 500 0 Feet

 1 in equals 1,000 feet

Contour Interval 100 Feet

Background Data Source:
USFS GIS Library May, 2010

Parcel Boundary Source:
2014 Ketchikan Gateway Borough

- | | |
|----------------------------|------------------------|
| Proposed State Forest Road | Cataloged Anadromous |
| Existing Road | Uncataloged Anadromous |
| Operable Timber Base | Resident Fish |
| KETCHIKAN GATEWAY BOROUGH | Water Quality |
| UNIVERSITY OF ALASKA | Eagle Trees |
| NATIONAL FOREST | |
| STATE FOREST | |

This map set depicts the proposed Vallenar Bay Project located on Gravina Island in Township 74 and 75 South, Range 89 and 90 East, Copper River Meridian.

Exhibit B
Vallenar Bay Timber Sale
Map
Page 2 of 5



Division of Forestry

Date Saved: 1/14/2015 10:30:08 AM

NAD 1983

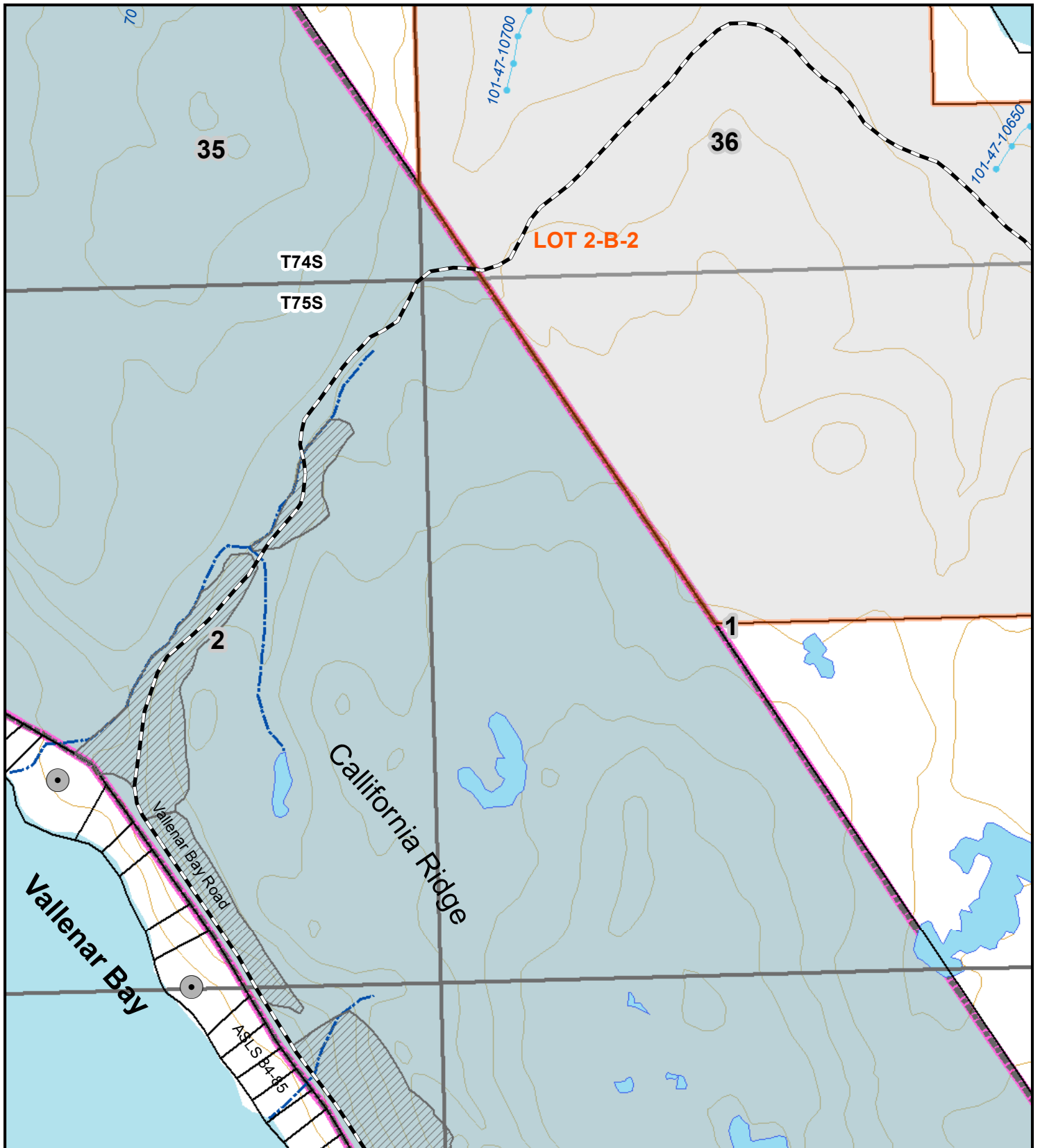

1,000 500 0 Feet

 1 in equals 1,000 feet

Contour Interval 100 Feet

Background Data Source:
USFS GIS Library May, 2010

Parcel Boundary Source:
2014 Ketchikan Gateway Borough

- | | |
|----------------------------|------------------------|
| Proposed State Forest Road | Cataloged Anadromous |
| Existing Road | Uncataloged Anadromous |
| Operable Timber Base | Resident Fish |
| KETCHIKAN GATEWAY BOROUGH | Water Quality |
| UNIVERSITY OF ALASKA | Eagle Trees |
| NATIONAL FOREST | |
| STATE FOREST | |

This map set depicts the proposed Vallenar Bay Project located on Gravina Island in Township 74 and 75 South, Range 89 and 90 East, Copper River Meridian.

Exhibit B
Vallenar Bay Timber Sale
Map
Page 3 of 5



Division of Forestry

Date Saved: 1/14/2015 10:30:08 AM

NAD 1983

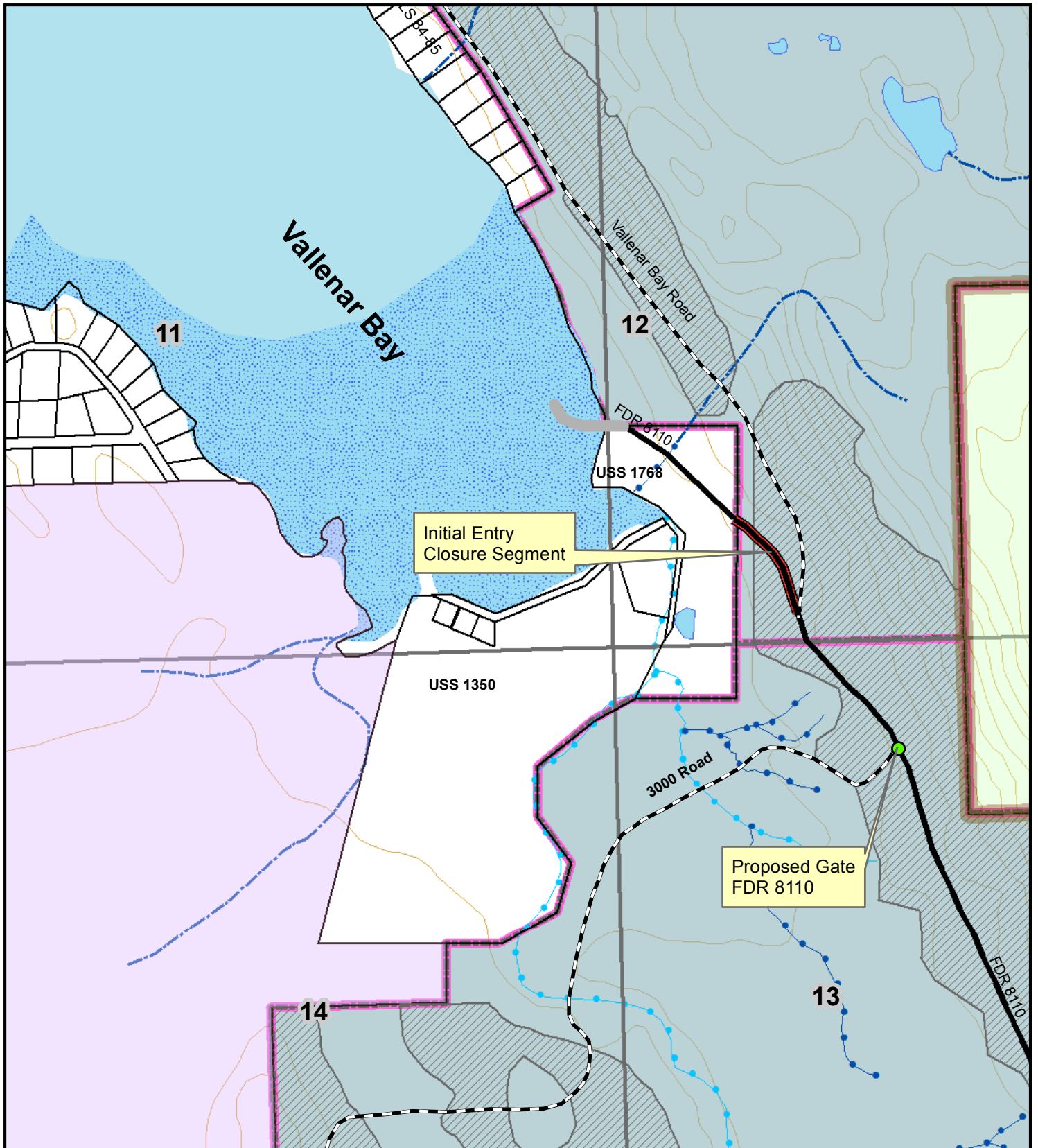

Scale: 1,000 500 0 Feet
1 in equals 1,000 feet

Contour Interval: 100 Feet

Background Data Source: USFS GIS Library May, 2010

Parcel Boundary Source: 2014 Ketchikan Gateway Borough

North Arrow: NAD 1983

<ul style="list-style-type: none"> Proposed State Forest Road Existing Road Operable Timber Base KETCHIKAN GATEWAY BOROUGH UNIVERSITY OF ALASKA NATIONAL FOREST STATE FOREST 	<ul style="list-style-type: none"> Cataloged Anadromous Uncataloged Anadromous Resident Fish Water Quality Eagle Trees
--	--

This map set depicts the proposed Vallenar Bay Project located on Gravina Island in Township 74 and 75 South, Range 89 and 90 East, Copper River Meridian.

Exhibit B
Vallenar Bay Timber Sale
Map
Page 4 of 5

Division of Forestry
Date Saved: 1/14/2015 10:30:08 AM

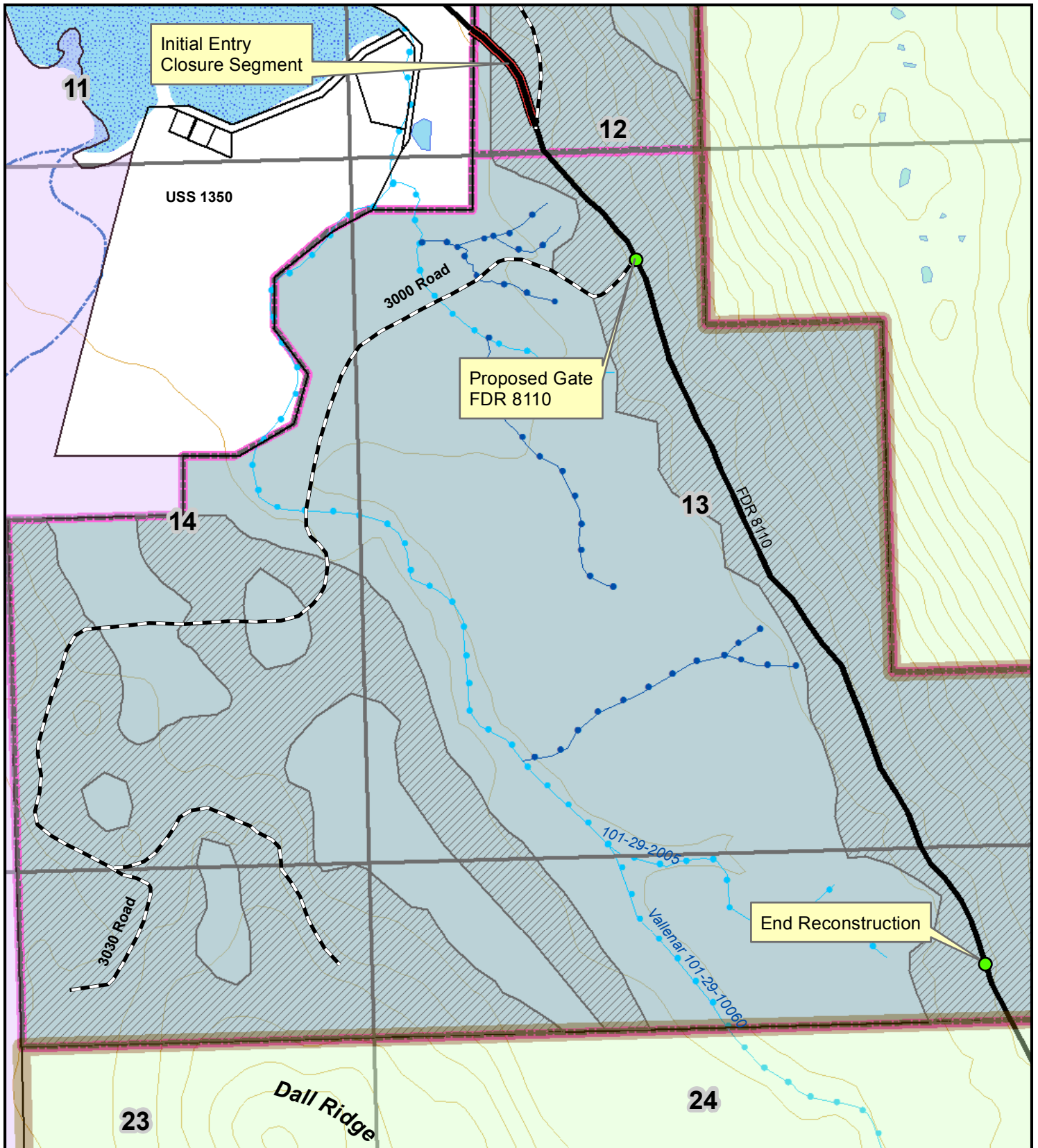

1,000 500 0 Feet

 1 in equals 1,000 feet

Contour Interval 100 Feet

Background Data Source:
USFS GIS Library May, 2010

Parcel Boundary Source:
2014 Ketchikan Gateway Borough

- Proposed State Forest Road
- Existing Road
- Operable Timber Base
- KETCHIKAN GATEWAY BOROUGH
- UNIVERSITY OF ALASKA
- NATIONAL FOREST
- STATE FOREST
- Cataloged Anadromous
- Uncataloged Anadromous
- Resident Fish
- Water Quality
- Eagle Trees

This map set depicts the proposed Vallenar Bay Project located on Gravina Island in Township 74 and 75 South, Range 89 and 90 East, Copper River Meridian.

Exhibit B
Vallenar Bay Timber Sale
Map
Page 5 of 5



Division of Forestry

Date Saved: 1/14/2015 10:30:08 AM

NAD 1983