

SITE DEVELOPMENT DIAGRAM

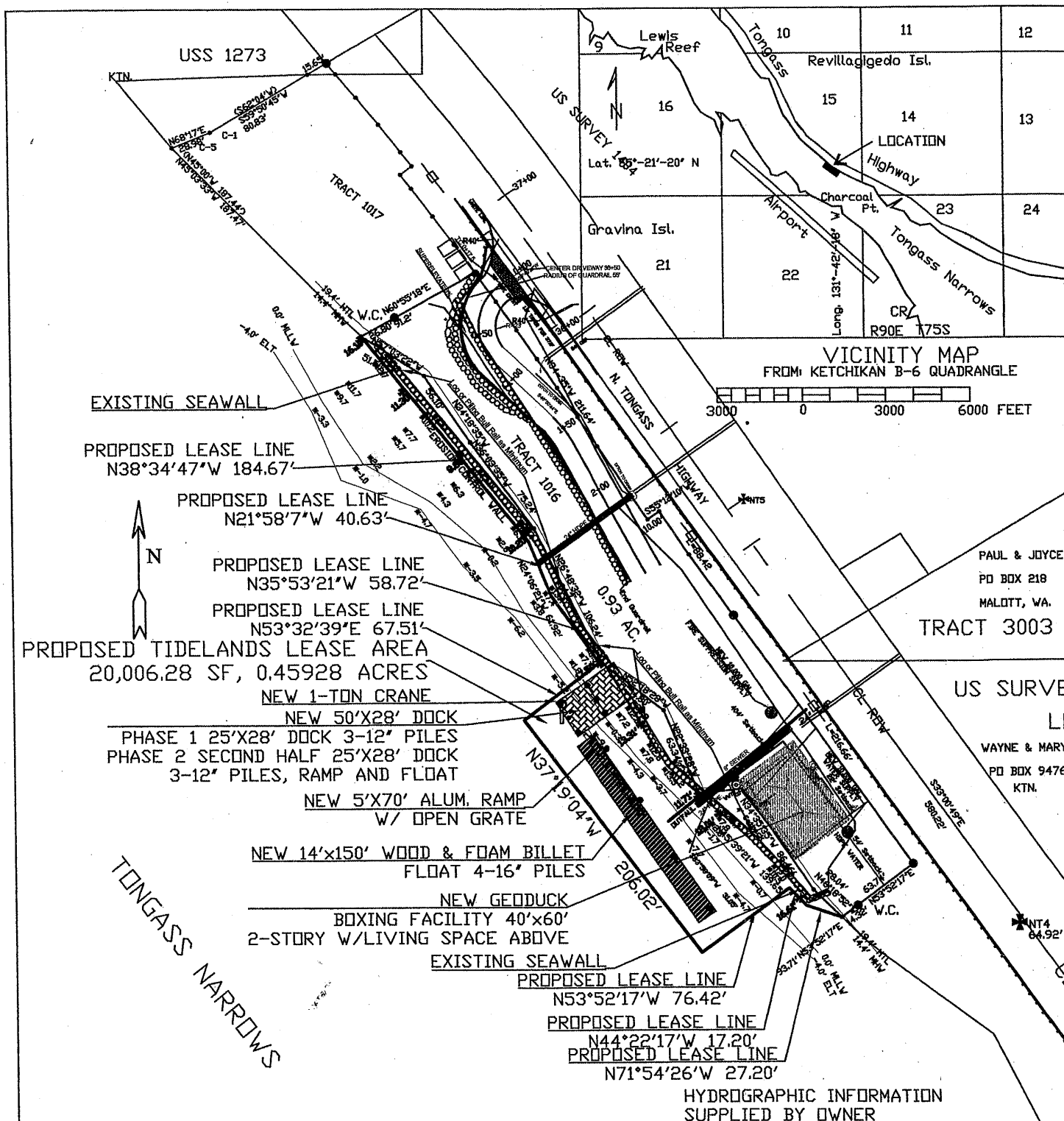

PLAN VIEW

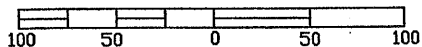

UPLANDS PROPERTY TRACT 1016
 PER. PLAT 2006-14 KR D

Date Prepared	Applicant's Name
DATE 6-27-11	LANCE PIHLMAN
ALASKA DEPARTMENT OF NATURAL RESOURCES DIV. OF MINING, LAND, WATER LAND USE PERMIT	
SITE DEVELOPMENT DIAGRAM	
Sec.(s) 15 T. 75S., R. 90E., CRM	
SHEET 1 of 1	LAS#

**STATE OF ALASKA DEPARTMENT OF NATURAL RESOURCES
DIVISION OF MINING, LAND AND WATER**

- | | | | |
|--|--|---|---|
| <input type="checkbox"/> Contract Administration
550 W 7th Ave., Suite 640
Anchorage, AK 99501-3576
(907) 269-8594 | <input type="checkbox"/> Northern Region
3700 Airport Way
Fairbanks, AK 99709
(907) 451-2740 | <input type="checkbox"/> Southcentral Region
550 W 7th Ave., Suite 900C
Anchorage, AK 99501-3577
(907) 269-8552 | <input checked="" type="checkbox"/> Southeast Region
400 Willoughby,
Suite #400
P.O. Box 111020
Juneau, AK 99801
(907) 465-3400 |
|--|--|---|---|

APPLICANT ENVIRONMENTAL RISK QUESTIONNAIRE

The purpose of this questionnaire is to help clarify the types of activities you propose to undertake. The questions are meant to help identify the level of environmental risk that may be associated with the proposed activity. The Division of Mining, Land and Water's evaluation of environmental risk for the proposed activity does not imply that the parcel or the proposed activity is an environmental risk from the presence or use of hazardous substances.

Through this analysis, you may become aware of environmental risks that you did not know about. If so, you may want to consult with an environmental engineer or an attorney.

<u>Lance Pihlman</u>		<u>Lance Pihlman Fisheries</u>	
Applicant's Name		Doing Business As	
<u>P.O. Box 5322</u>		<u>Ketchikan</u>	<u>AK 99901</u>
Address		City	State Zip
<u>(907) 723 7032</u>	<u>sweetlisa9990@yahoo.com</u>	<u>FRED, MONROE</u>	
Message Phone	Work Phone	E-Mail	Contact Person

Describe the proposed activity:

UNLOADING LIVE GEODUCK Clams from catcher boats
And grower transports, Boxing the LIVE GEODUCKS
Clams for shipment by air to market.

In the course of your proposed activity will you generate, use, store, transport, dispose of, or otherwise come in contact with toxic and/or hazardous materials, and/or hydrocarbons? Yes No

If yes, please list the substances and the associated quantities. Use a separate sheet of paper, if necessary.

Heating Fuel, Vessel & Equipment Fuel.

If the proposed activities involve any storage tanks, either above or below ground, address the following questions for each tank. Please use a separate sheet of paper, if necessary, and, where appropriate, include maps or plats:

a. Where will the tank be located? ON ADJACENT UPLANDS PROPERTY

b. What will be stored in the tank? #1 or #2 Heating Fuel

c. What will be the tank's size in gallons? 150 gal.

d. What will the tank be used for? (Commercial or residential purposes?) Heating for office
and quarters.

e. Will the tank be tested for leaks? YES

f. Will the tank be equipped with leak detection devices? Yes No . If yes, describe: _____

Do you know or have any reason to suspect that the site may have been previously contaminated? Yes No .

If yes, please explain: _____

I certify that due diligence has been exercised and proper inquiries made in completing this questionnaire, and that the foregoing is true and correct to the best of my knowledge.

Applicant

Date

AS 38.05.035(a) authorizes the director to decide what information is needed to process an application for the sale or use of state land and resources. This information is made a part of the state public land records and becomes public information under AS 40.25.110 and 40.25.120 (unless the information qualifies for confidentiality under AS 38.05.035(a)(9) and confidentiality is requested). Public information is open to inspection by you or any member of the public. A person who is the subject of the information may challenge its accuracy or completeness under AS 44.99.310, by giving a written description of the challenged information, the changes needed to correct it, and a name and address where the person can be reached. False statements made in an application for a benefit are punishable under AS 11.56.210.

**STATE OF ALASKA DEPARTMENT OF NATURAL RESOURCES
DIVISION OF MINING, LAND AND WATER**

- | | | | |
|--|---|--|--|
| <input type="checkbox"/> Resource Assessment and Development Section
550 W 7th Ave., Suite 1050
Anchorage, AK 99501-3579
(907) 269-8534 | <input type="checkbox"/> Northern Region
3700 Airport Way
Fairbanks, AK 99709
(907) 451-2740 | <input type="checkbox"/> Southcentral Region
550 W 7th Ave., Suite 900C
Anchorage, AK 99501-3577
(907) 269-8552 | <input checked="" type="checkbox"/> Southeast Region
400 Willoughby, #400
Juneau, AK 99801
(907) 465-3400 |
|--|---|--|--|

APPLICATION FOR PURCHASE OR LEASE OF STATE LAND

Date _____ ADL # (assigned by DNR) _____
 Applicant's Name Lance Pihlman Doing business as: Lance Pihlman Fisheries
 Mailing Address P.O. Box 5322
 City/State/Zip Ketchikan, Alaska 99901 E-Mail sweetlisa99901@yahoo.com
 Message Phone (907) 225 3868 Work Phone (907) 723-7032 Soc. Sec. # and/or Tax ID # 574-72-5444

Is applicant a corporation qualified to do business in Alaska? yes no. Is the corporation in good standing with the State of Alaska, Dept. of Commerce and Economic Development? yes no.

Is applicant 18 years or older? yes no. Are you applying for a lease or sale? What kind of lease or sale are you applying for? Tideland; Public/Charitable Use; Grazing; Millsite; Negotiated; Competitive.

If a lease, how many years are you applying for? 10 years. (55 years Max.)

Legal Description: Lot(s) _____ Block/Tract # 1016 Survey/Subdivision PLAT 2006-14
 Other: KRD

Meridian CR Township 75S, Range 90E, Section(s) 15 Acres _____

Municipality KETCHIKAN, LORAN Reading (optional)

Geographic Location: LAT 55°-21'-20"N LONG - 131°42'18"W

What is the proposed use of and activity on the state land? LIVE Geoduck CLAM BOXING Facility

Are there any improvements on the land now? yes no. If yes, who owns the improvements, and what is the estimated value? Lance Pihlman \$30,000

If yes, describe any existing improvements on the land. Rock retaining structure

Are there any improvements or construction planned? yes no. If yes, describe them and their estimated value.
STEEL & CONCRETE ROCK 1400 SF \$70,000; 5x70' RAMP \$15,000; 14x150' FLOAT \$89,000; CRANE \$15,000

State the proposed construction date: April 1, 2012; estimated completion date*: April, 2013

Name and address of adjacent land owners and, if you are applying for tidelands, the name and address of the adjacent upland owners: Russel Cockrum 5791 N. Tongass, APOT POB 8778 KTW, AK 99901

Are you currently in default on, or in violation of, any purchase contract, lease, permit or other authorization issued by the department under 11 AAC? yes no. Within the past three years, has the department foreclosed or terminated any purchase contract, lease, permit or other authorization issued to you? yes no.

Non-refundable filing fee: \$100
 (Fee may be waived under 11 AAC 05.010(c))

Date Stamp:

Is the land applied for subject to any existing leases or permits? yes no. If yes, lease or permit?

Name lease/permit is issued under: COE POA-2006-378-D

Do you think you qualify for a non-competitive lease or sale? yes no. If yes, under what provision of AS 38.05?

- AS 38.05.035(b)(2) (to correct an error or omission);
- AS 38.05.035(b)(3) (owner of bona fide improvements);
- AS 38.05.035(b)(5) (occupied, or are the heir of someone who occupied the land before statehood);
- AS 38.05.035(b)(7) (adjacent owner of remnant of state land, not adjoining other state land);
- AS 38.05.068 and .087 (U.S. Forest Service Permittee);
- AS 38.05.075(c) (upland owner or lessee);
- AS 38.05.035(f) (erected a building and used the land for business purposes);
- AS 38.05.102 (current long-term lessee or current shore fishery lessee);
- AS 38.05.255 (millsite lease for mine-related facilities);
- AS 38.05.810(a)* (government agency; tax-exempt, non-profit organization organized to operate a cemetery, solid waste facility, or other public facility; or a subdivision's nonprofit, tax-exempt homeowners' association);
- AS 38.05.810(b)-(d) (non-profit corporation, association, club, or society operated for charitable, religious, scientific, or educational purposes, or for the promotion of social welfare, or a youth encampment);
- AS 38.05.810(e) (licensed public utility or licensed common carrier);
- AS 38.05.810(f) (non-profit cooperative organized under AS 10.25, or licensed public utility);
- AS 38.05.810(h) (Alaska Aerospace Development Corporation);
- AS 38.05.810(i) (port authority);
- AS 38.05.825 (municipality applying for occupied or developable tidelands);
- other (please explain):

If you have checked one of the above statutes, attach a statement detailing your qualifications under each requirement of that statute.

Do you think you qualify to lease the land for less than fair market value? yes no. If yes, under what provision of AS 38.05?

- AS 38.05.097 (youth encampment or similar recreational purpose); other (please explain).
- AS 38.05.098 (senior citizen discount for a residential lease);

Signature

Date

If applying on behalf of an agency, municipality, or organization, state which one

Title

NOTICE TO APPLICANT:

- * For applications filed by a municipality under AS 38.05.810, if there is a remaining entitlement of the municipality under AS 29.65, land transferred under AS 38.05.810 shall be credited toward fulfillment of the entitlement.
- * Construction may not commence until approval is granted by lessor.
- * This application will not be considered unless it is accompanied by the appropriate filing fee and completed in full. THE FILING FEE WILL NOT BE REFUNDED NOR IS IT TRANSFERABLE. All checks are to be made payable to the Department of Natural Resources.
- * Include a 1:63,360 USGS map showing location of proposed activities in relation to survey monumentation or fixed geographical features which fully illustrates your intended use, including the location of buildings and improvements and access points, labeled with all dimensions, and a development plan providing a complete list of proposed activities.
- * The applicant may be required to deposit a sum of money sufficient to cover the estimated cost of survey, appraisal, and advertising. If the land is sold or leased to another party, the deposit will be returned to the applicant.
- * The filing of this application and payment of the filing fee vests the applicant with no right or priority in the lands applied for. It is merely an expression of the desire to purchase or lease a parcel of land when and if it becomes available. Filing an application serves the purpose of notifying the state that an individual is interested in purchasing or leasing land. It is not a claim, nor does it in any way obligate the state to sell or lease land.
- * If the application site is in the Coastal Zone, include a Coastal Project Questionnaire (www.gov.state.ak.us/dgc/Projects/projects.html).
- * If the application is for a commercial fish camp, include a copy of your limited entry permit or an interim-use salmon set net permit.
- * If applying for a senior citizen discount, include form 102-1042.
- * AS 38.05.035(a) authorizes the director to decide what information is needed to process an application for the sale or use of state land and resources. This information is made a part of the state public land records and becomes public information under AS 40.25.110 and 40.25.120 (unless the information qualifies for confidentiality under AS 38.05.035(a)(9) and confidentiality is requested). Public information is open to inspection by you or any member of the public. A person who is the subject of the information may challenge its accuracy or completeness under AS 44.99.310, by giving a written description of the challenged information, the changes needed to correct it, and a name and address where the person can be reached. False statements made in an application for a benefit are punishable under AS 11.56.210.

**Land Use Permit Application Supplemental Questionnaire for:
Use of Marine Waters (Tide & Submerged Lands)**

Tidelands are that portion of the intertidal zone below the elevation of mean high water. This elevation varies by location. Contact the nearest DNR regional office for assistance. **Submerged lands** are those below the lowest tidal elevation. The State of Alaska, with few exceptions, owns these lands out to 3 miles off shore. – If your activity includes the use of State tide and or submerged lands and the waters above them, answer the questions below and those applicable sections determined below. All site development details identified in this section must be represented graphically in the scaled drawings on Page 9 of the supplement.

Does the applicant own the directly adjacent, upland water front property? Yes No If no, give name(s) and current address / phone # of that property owner.

Give names and current addresses / phone #s for both upland property owners on either side of the above water front property. _____

RUSSEL COCKRAM 5791 N. Tongass Highway, Ketchikan, AK 99901
907-225-3419, STATE OF ALASKA DOT/PF P.O. Box 6778
Ketchikan, AK 99901 907-225-2513

Note: You must obtain the upland owner's written permission for any use of uplands you do not own including for waste disposal, access to roads, waterlines, power lines, or shore ties above MHW, and you must provide a copy to DNR before a permit is issued. If not the immediately adjacent upland property owner, does the applicant have legal access across the uplands? Yes No Please explain.

Will your tideland use also involve any use of adjacent State owned uplands? Yes No (If yes, indicate uses and show on your development plan diagram.) Shore tie Waterline Power line Access to roads Other Explain:

Type of Use, Activity, Development (Answer All)

Will you be developing / using a Mooring Buoy system or anchoring a commercial or industrial use vessel for more than 14 days? Yes No (If yes, please also answer all questions in Part 1 on pg. 2 and Part 6 on pg. 8.)

Will you be anchoring or mooring a commercial or industrial related floating facility that is or can be occupied, i.e. a float camp or floating lodge, a float house you rent, a seafood processor? Yes No (If yes, please answer all questions in Part 2, pgs. 2, 3 and Part 6 on pg. 8.)

Will you be anchoring or mooring your own personal use Float house? Yes No (If yes, please also answer all questions in Part 2, pgs. 2, 3 and Part 6 on pg. 8.)

Will you be placing non-occupied structures including but not limited to Piling, Dolphins, Fixed docks, Floating docks, or other floating structures? Yes No (If yes, please also answer all questions in Part 3, pg. 3 and Part 6 on pg. 8.)

Type of Use, Activity, Development (continued)

Are you seeking authorization to use or develop a Log Transfer Facility, a floating Log Storage area, or a Log Ship Loading site? **Yes** **No** (If yes, please also answer all questions in **Part 4, pgs. 4, 5, 6 and Part 6 on pg. 8.**)

Will you be placing fill or dredging material on a beach? **Yes** **No** (If yes, please also answer all questions in **Part 5, pgs. 6, 7 and Part 6 on pg. 8.**)

Part 1. Anchoring vessels and mooring buoy systems

Does the proposed use location include a known anchorage? **Yes** **No** If yes, have alternative locations been considered to reduce impact to the anchorage? **Yes** List below. **No** If no, explain why.

What type of vessel will use the site? Commercial Fish Tender/ Processor Log Ship General Cargo Ship Unoccupied Barge Fuel Barge Passenger Vessel Other: _____

Does the anchoring vessel require the ability to be able to occupy this site all year long? **Yes** **No** If No, what months will the site be needed? **From** _____ **to** _____

What is the maximum swing radius of vessel at anchor? Length _____ feet (distance from anchor to the aft of the vessel)

Will the vessel require the placement of a mooring buoy system? **Yes** **No** **Number of buoys:** _____
If placing buoys, fill out applicable parts of Part 3 to explain the anchoring system.

Part 2. Floathouses and Commercial, Industrial Floating Lodges, Float camps, Caretaker Residences (including seafood processors). An associated part of approving this type of use is The US Army Corps of Engineers (USACE) permit. Their general permit, GP 89-4N, for occupied floating facilities can be obtained if use and location is found consistent with the AK Coastal Management Program and you meet all conditions of GP 89-4N. Please obtain a copy of GP 89-4N from the Corps, review the conditions and indicate below if your facility will meet all of these conditions. This will help streamline the approval process.

Does your project meet all conditions for general permit GP 89-4N? **Yes** **No**

If no, you must Contact USACE at 1-800-478-2712 and apply for an individual Corps of Engineers permit.

Description of Facility Note: The structures and dimensions must be shown on the development plan diagram

Float Dimensions: float _____ x _____ float _____ x _____ float _____ x _____ Total float area _____ sq ft

Living quarters total area: _____ sq ft. Number of stories: _____ Maximum occupancy _____ persons

Describe other structures on floats, such as storage and generator sheds; give structure dimensions.

Describe anchoring system and address all that apply: No. of anchors _____ Type _____ Weight _____
No. of Rock bolts _____ No. of Shore ties _____

Other methods _____

Part 2. (continued)

Grounding is prohibited. What is the water depth beneath the facility at extreme low tide _____

How many feet of maximum draft does the floating facility have _____

Describe your potable Water Source: type, location, ownership of the source _____

Wastewater System. Describe how you will handle human waste, black water, grey water _____

Do you have an approved ADEC marine sanitation system Yes[] No[] Approval # _____

Describe how you will dispose of all solid waste including human waste and household garbage generated on facility _____

Part 3. Non occupied structures - Piling, Dolphins, fixed docks, floating docks, or other floating structures.

Select all boxes that apply for structures located below MHW and show all on the development plan diagram

- Fixed pile-supported dock, wharf or landing (non-floating) - dimensions 20 x 50 feet No. of pilings 6
- Ramp to floating dock - dimensions 5 x 70 feet
- Boat haulout or non-floating ramp - dimensions _____ x _____ feet
- Floating dock Dimensions 14 x 150 feet; _____ x _____ feet; _____ x _____ feet; _____ x _____ feet; _____ x _____ feet;
- Floating breakwater - materials _____ Dimensions _____ x _____ feet
- Other floating structures (e.g., net pens, gear storage float) - describe materials, structures, dimensions _____

- Storage sheds or similar structures on docks - description _____ Dimensions _____ x _____
- Bulkhead - type (log crib, sheet pile, etc) _____ Dimensions _____ x _____ Cubic Yards of Fill _____
- Individual pilings not counted under fixed dock above. Number 4
- Dolphins - Number _____ Number of piling per dolphin _____
- Anchors- Number _____ Type _____ Weight _____
- Rock bolts- Number 4
- Shore ties- Number _____ Note: You must obtain the upland owner's permission to place shore ties above MHW before a permit is issued.

Note: Grounding is prohibited.
What is the water depth beneath the floating structures at extreme low tide? 4 feet

Part 4. Temporary log transfer facility (LTF) including floating log storage area.

Siting of an LTF which discharges wood into the marine waters must meet the 1985 Alaska Timber Task Force siting criteria guidelines and the criteria established under the US EPA's - NPDES general permit and the AK Dept of Environmental Conservation 401 certification.

What is the maximum length of time that you will need to use the facility _____ years.

What will be your seasonal periods of operation? _____

What is the total timber volume you need to transfer across this LTF? _____ mmbf.

How many total acres do you need for this facility? _____ acres.

Note: This acreage must include all improvements including the anchors and lines. It must include the area required for such items as log raft construction, off shore storage, associated barge and vessel moorage, and shoreties.

Does the associated transfer site require a log raft building area? Yes [] No [] If yes then:

How many boom logs _____ and anchors _____ and what is the total length of boom logs _____ feet, that you need for the rafting area?

Will the log rafts ground or be moored in water at depths less than 40 feet as measured from MLLW? Yes [] No []

What is the near shore depth _____ feet, and the offshore depth _____ feet, of the log rafting area as measured from MLLW (0.0' elevation)?

What nautical chart did you use for reference _____, please include a copy of this area of the chart with the attachments.

Will you need an associated in-water log storage area? Yes [] No [] If yes, then answer the set of questions in the **Floating Log Storage Area section of Part 4.**

Will you need an associated log ship moorage and loading area? Yes [] No [] If yes then complete Part 1 on page 2.

What kind of transfer facility do you propose to operate? (i.e. A-Frame letdown, slide ramp, drive down ramp, barge ramp)

Will you be transferring logs into the marine waters?

[] **No, logs will never be discharged into the water, they will always be transported directly onto barges.**

[] **Yes - new facility.** The applicant must conduct a dive survey of the near shore area to document the pre-project underwater topography and habitat conditions that will be covered by the discharge of bark on to the likely one-acre zone of deposit. The initial dive survey must be done to guidelines established for bark monitoring by the USEPA and the Alaska Department of Environmental Conservation. A written report of findings including photographic documentation must be submitted prior to review and consideration of this application.

[] **Yes - existing facility.** Include a report of the last dive survey with attachments. The applicant / operator is responsible to conduct bark monitoring dive surveys, done to the guidelines established by the US EPA and the Alaska Department of Environmental Conservation to document the current extent of bark accumulation at the site. A written report of current monitoring findings must be submitted prior to review and consideration of this application.

Is this an existing LTF that has been fully approved and used to transport timber in the past? Yes [] No []

If Yes, then answer the following set of questions. If No, you are finished with **Part 4.**

Part 4. (continued)

Was the facility constructed before 1985? Yes [] No []

Is the facility currently authorized? Yes [] No [] If Yes, provide the Army Corp of Engineer's Permit Name and number (i.e. Mud bay 43) : _____ and attach a copy of it and all modifications.

What is the ACMP consistency determination number and date of approval? _____

What is the EPA - NPDES authorization number? _____ Date of approval _____ and who is the authorized operator: _____

When was the facility last actively used? _____ How long was it used for? _____
How much volume was transferred? _____ mmbf

What type of log entry system is currently authorized? (i.e. A-Frame letdown, slide ramp, drive down ramp, barge ramp)

Is there a tideland survey for the site? [] Yes [] No, ATS# _____

Does the existing facility require a physical modification? Yes [] No [] If yes, please submit your modification request to the USACE and include a copy with this application. Please briefly explain the modification.

Floating Log Storage Area

Will the storage area be inside the permit area at the log transfer facility? Yes [] No [] If no, Will there be a separate tract or tracts? Yes [] No [] If yes how many tracts do you need? _____ and list below the acreage of each tract.

How long do you need to use the storage area (s)? _____

How much volume will be moved thru this storage area? _____ mmbf.

How many log booms and anchors and what is the total length of the log boom perimeter that will be needed for storage?
of log booms _____, #of anchors _____ total length of all log booms _____ feet.

Will you be using shore ties? Yes [] No [] If yes how many? _____ and if you are not the upland owner have you received permission to place shore ties? Yes [] No [] If yes, provide a copy of this permission, if no, you need to obtain and provide this.

Will the log rafts ground or be moored in water at depths less than 40 feet as measured from MLLW? Yes [] No []

What is the near shore depth and the offshore depth of the log storage area as measured from MLLW?
Near shore depth _____ feet, Offshore depth _____ feet.

What nautical chart did you use for reference _____. If possible please include a copy with the attachments.

Part 4. (continued)

If the log storage area is one which has been fully approved and used to store log rafts in the past then answer the following:

When was the site last actively used? _____ and for how long? _____

If known, how much volume was stored here? _____ mmbf

Is the facility currently authorized? Yes[] No[] If yes, provide the Army Corp of Engineer's Permit Name and number (i.e. Mud bay 43) : _____ and attach a copy of the permit and all modifications

What is the DNR authorization number? _____

What is the ACMP consistency determination number and date of approval? _____

What is the EPA - NPDES authorization number? _____ Date of approval _____ and who is the authorized operator: _____

Has there been a recent dive survey completed? Yes[] No[] If yes, then include a copy of this report with the attachments.

Note: The applicant may have to conduct a dive survey of the log storage area to document the underwater topography and habitat that would be covered by the bark zone of deposit or to establish current bark accumulation levels. If required due to level of use, a bark monitoring dive survey must be done to guidelines established by the USEPA and the Alaska Department of Environmental Conservation to document the current conditions at the site

Part 5. Use that involves dredging, placing fill material or altering beaches.

NOTE: When altering the location of the line of mean high water on a beach by placing fill on or seaward of this line you need to be aware of the following. The line of mean high water (MHW) is the boundary where State (public) ownership of tide and submerged land begins. This boundary is an elevation contour on the beach and is determined by the tidal stage of MHW water elevation against the beach topography. This line is not fixed by a past survey of the upland property if that land survey shows a meandered boundary as is typically done. A meandered boundary is intended to be dynamic and move over time as natural forces affect the beach. Natural forces can either erode beach material or deposit material and as a result, the boundary can naturally move. Another natural way that boundaries can change is in tidal areas where glaciers have recently receded and the land is rebounding or uplifting over time. When any natural process is interrupted by the actions of man, such as placing material to stop erosion, the boundary line becomes fixed from that point on.

What is the elevation of the line of MHW at the proposed permit site? _____ feet

Are you proposing to alter the line of MHW in any manner? Yes[] No[] If yes, explain what you intend to do?

Placing fill material on a beach.

What is the purpose of the fill? _____

Is there an upland survey that has established a meandered boundary line? Yes[] No[] If yes, Survey # _____
(if a subdivision survey please provide a legible copy) (ATS, ASLS, US Survey#)

Part 5. (continued)

Will heavy equipment be used below the mean high water line to alter the beach? Yes[] No[] If yes, explain

How many cubic yards of fill are you proposing to place at and below the line of MHW? _____ cubic yards

What are the dimensions of fill area below MHW elevation? _____

How many linear feet along the (beach) line of MHW will be covered with fill? _____ feet.

Is there more than one area along the beach which will be filled? Yes[] No[] Identify the location of each area on the development plan diagram.

Will any of the fill material come from State owned uplands or tide and submerged lands? Yes[] No[] If yes, then what is the source? _____ and how many cubic yards? _____.

If you are intending to limit beach fill to the area above the current line of MHW will any of the fill or associated retaining wall material including the toe of the fill or retaining wall extend beyond the line of MHW? Yes[] No[]

Is the adjacent upland property encumbered with a public easement along the waterfront boundary? Yes[] No[]

How will the fill affect public access along the beach? _____

Excavation of materials from a beach.

What is the purpose of the excavation? _____

How many linear feet along the beach will be affected? _____ feet

To what depth will you be excavating? _____ feet

How many cubic yards will be excavated from the area seaward of the line of MHW? _____ cubic yards and what will this excavated material be used for or where will it be disposed of?

Part 6. Dismantle, Removal, Restoration Plan – The permit will require that upon expiration, completion, or termination the site shall be vacated and all improvements and personal property removed. The site shall be left in a clean, safe condition acceptable to the Regional Manager. Your answers to the following questions will establish your proposed restoration plan.

A. Explain how you plan to dismantle and remove the improvements and restore the site to a clean, safe condition acceptable to the Regional Manager. **Note:** One acceptable alternative is returning the permit site to the condition that existed before the site was developed or used.

Remove Pile, Ramp, Dock, Piles, etc.

B. If your project involves fill describe how it will be removed and where will it be removed to. How will you document that the original line of Mean High Water has been restored? (i.e. photo documentation, resurvey)

Existing Rockwall to be removed with backfill and sold
No fill once area is no longer used for commercial purposes.

C. If your project involves anchors and/or pilings how do you plan on removing them? Where is the nearest community that provides this type of removal equipment / service?

Piles & Rock bolts would have to be cut off and removed with a crane Ketchikan has many options for this

D. Describe the disposal method and identify the disposal site or sites for structural components, solid wastes, and hazardous wastes.

Concrete dock deck could be recycled, steel piles, beams etc have scrap value.

E. If components can be reused for other projects, such as anchors, identify where they would be stored?

Beams & Piles would be stored on adjacent up lands