

STATE OF ALASKA

2025

Application for Permits to Mine in Alaska (APMA)

Single Year 5 Multi-year Start: 2026 Finish: 2035 APMA Number (A/F/J, Year, ****) F 2026 6872 - 6219

What type activity are you planning to perform? *REQUIRED (1) <input type="checkbox"/> Suction Dredging/Reclamation <input type="checkbox"/> Reclamation Only <input checked="" type="checkbox"/> Placer Mining/ Reclamation <input type="checkbox"/> Access <input type="checkbox"/> Hardrock Exploration/ Reclamation	Surface estate of mineral properties: *REQUIRED (2) <input checked="" type="checkbox"/> State (General) <input type="checkbox"/> State (Mental Health) <input type="checkbox"/> Federal <input type="checkbox"/> Private <input type="checkbox"/> City or Borough
--	---

Check All That Apply: Mineral Property Owner Lessee Operator (s) *Required (3)

Name: Richard Swenson / Kelly Williams Primary Phone Number: (907) 488-0393

Address: P.O. Box 16205 Secondary Phone Number: _____
Two Rivers, AK 99716-0205 Email: lbelk@alaskasbest.net

Click here for the Department of Commerce Link

Alaska Business/Corporation Entity# _____ Registered Agent (Corp./LLC/LP) _____

Check All That Apply: Mineral Property Owner Lessee Operator *Required (4)

Name: _____ Primary Phone Number: _____

Address: _____ Secondary Phone Number: _____
 _____ Email: _____

Alaska Business/Corporation Entity# _____ Registered Agent (Corp./LLC/LP) _____

Check All That Apply: Mineral Property Owner Lessee Operator *Required (5)

Name: _____ Primary Phone Number: _____

Address: _____ Secondary Phone Number: _____
 _____ Email: _____

Alaska Business/Corporation Entity# _____ Registered Agent (Corp./LLC/LP) _____

Check All That Apply: Mineral Property Owner Lessee Operator *Required (6)

Name: _____ Primary Phone Number: _____

Address: _____ Secondary Phone Number: _____
 _____ Email: _____

Attach a separate sheet for additional contacts

Alaska Business/Corporation Entity# _____ Registered Agent (Corp./LLC/LP) _____

Project Name If Applicable: (7)	Average Number of Workers: *REQUIRED (8) <u>Two (selves)</u>	Start-Up/Shut Down: (Month/Day) (9) <u>Generally, Apr 1 to Sep 30</u>
---------------------------------	---	--

Mining District: *REQUIRED (10) <u>Manley Hot Springs</u>	Applicable USGS Map(s): *REQUIRED (11) <u>Tanana A1</u>	On What Stream Is This Activity? (12) <u>Doric Creek</u>
--	--	---

Legal Description of mineral properties to be worked (MTRS) *REQUIRED (13) Example: Fairbanks Meridian Township 001N Range 003E Sections 15, 16, and 21 or F 001N 003E Sec. 15, 16, and 21 <u>Fairbanks Meridian, T4N, R13W, Sec. 10</u>	Internal Use Only:
--	--------------------

Internal Use Only:

Date Application Received Complete: _____ Adjudicator: _____ LAS Entry: _____

Sec 3 CID: 150499 Sec 4 CID: _____ Sec 5 CID: _____ Sec 6 CID: _____

APMA 6872 Active Area



This map was created on 6/25/2026 by the Alaska Department of Natural Resources as a courtesy to supplement the application received. This map displays a graphical illustration only. Source documents remain the official record.

The State of Alaska makes no express or implied warranties (including warranties of merchantability and fitness) with respect to the character, function, or capabilities of electronic services or products or their appropriateness for any user's purposes. In no event will the State of Alaska be liable for any incidental, indirect, special, consequential or other damages suffered by the user or any other person or entity whether from the use of the electronic services or products, any failure thereof or otherwise, and in no event will the State of Alaska's liability to the requestor or anyone else exceed the fee paid for the electronic service or product.

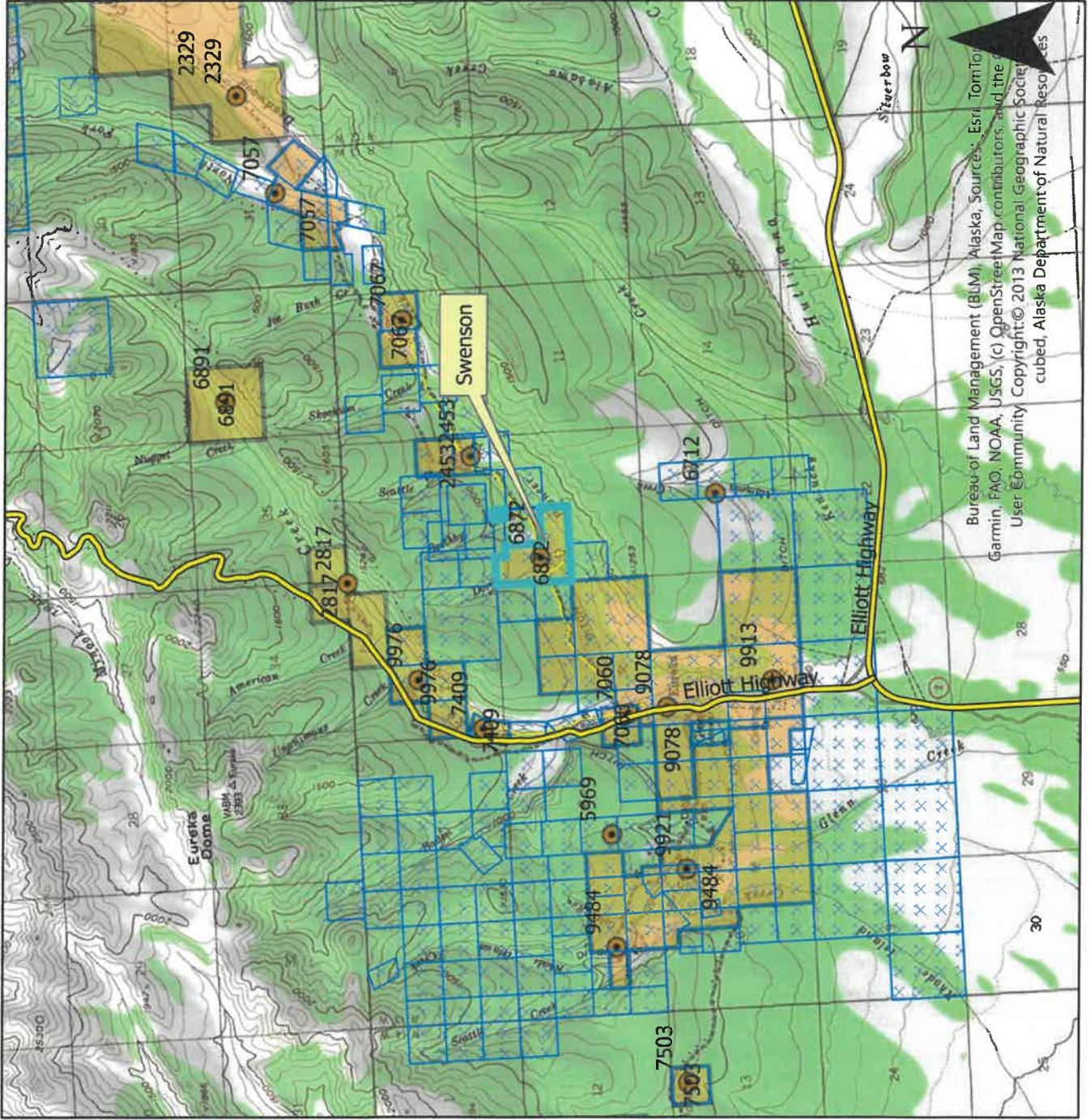

APMA 6872 Access Route



This map was created on 6/26/2026 by the Alaska Department of Natural Resources as a courtesy to supplement the application received. This map displays a graphical illustration only. Source documents remain the official record.

The State of Alaska makes no express or implied warranties (including warranties of merchantability and fitness) with respect to the character, function, or capabilities of electronic services or products or their appropriateness for any user's purposes. In no event will the State of Alaska be liable for any incidental, indirect, special, consequential or other damages suffered by the user or any other person or entity whether from the use of the electronic services or products, any failure thereof or otherwise, and in no event will the State of Alaska's liability to the requestor or anyone else exceed the fee paid for the electronic service or product.

Scale: 1:63,360

Legend

- APMA_Type
- BLM AK Federal Mining Claims (Active)
- APMA_Project
- Mechanical
- Placer Mining
- State Mining Claim Active
- Roads_AKDOT
- RS2477 Historic Transportation Routes
- Access Route

0 0.75 1.5 Miles
Center: 150°11'4"W 65°11'27"N

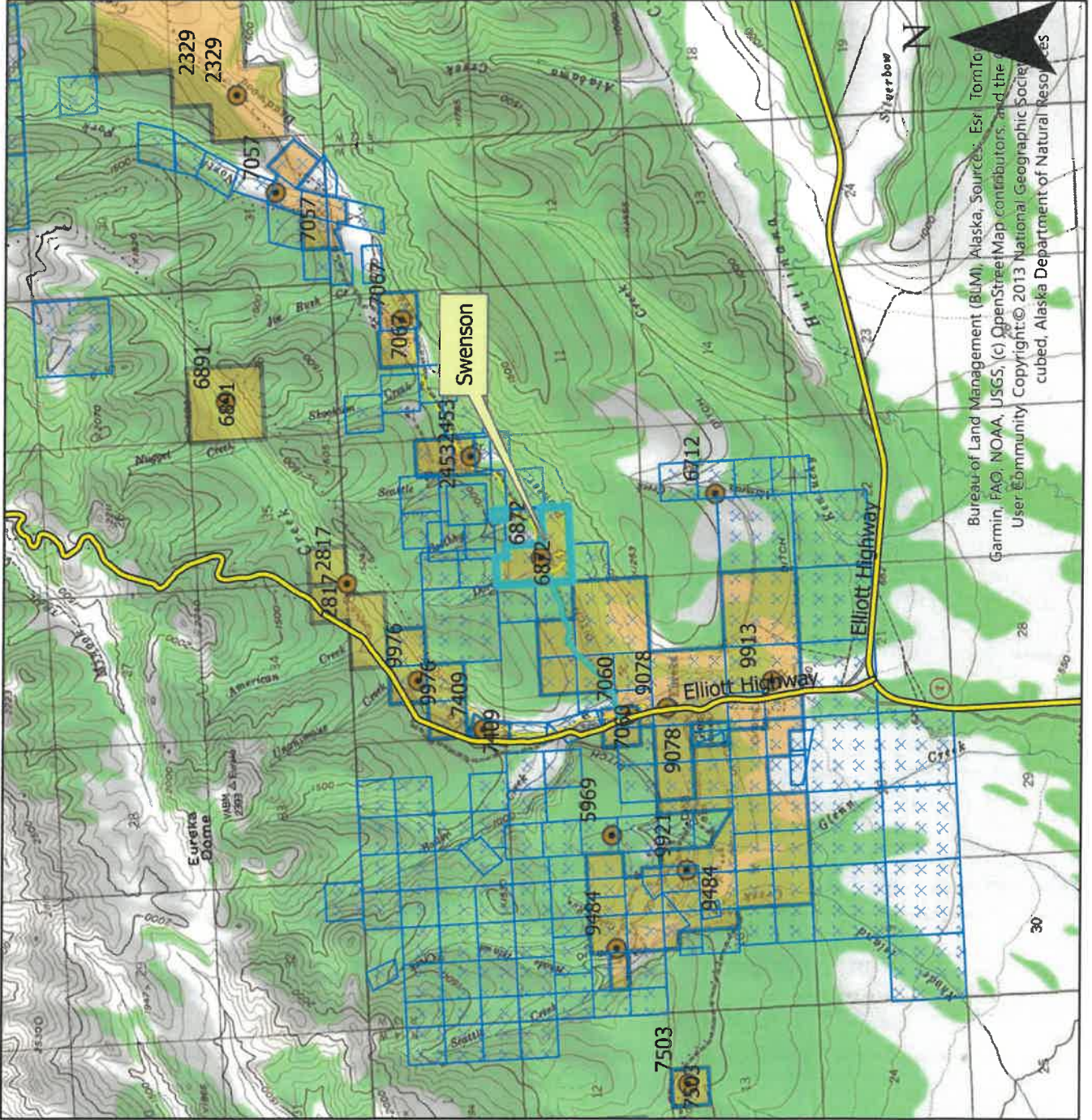

Bureau of Land Management (BLM), Alaska, Sources: Esri, TomTom, Garmin, FAG, NOAA, JGS, (c) OpenStreetMap contributors, and the User @bmmunity Copyright © 2013 National Geographic Society, Inc. Published, Alaska Department of Natural Resources

MV_ST_MINING

Source: Alaska Department of Natural Resources, Information Resource Management

Case ID	Case Status Description	Case Type Description	Claim Name	Customer Name	Notepost Date	Special Code Description	Total Acres
ADL 527420	Active (35)	Mining Claim (713)	BOOTHBY 1	Novak Ross	27-DEC-88	Mining Claim (MC)	40
ADL 527421	Active (35)	Mining Claim (713)	BOOTHBY 2	Novak Ross	27-DEC-88	Mining Claim (MC)	40
ADL 717986	Active (35)	Mining Claim (713)	DORIC DISCOVERY	Swenson Richard (Rick) A	14-JUL-13	Mining Claim (MC)	160

END OF REPORT

Report Information

Source ID	60
Source Name	MV_ST_MINING
Source Description	
Run Date and Time	06/25/2026 02:54:57 AKDT
Record Count	3

SQL Statement

CASE_ID,CASE_STATUS,CASE_STATUS_DESCRIPTI	

Ross Novak is senior (ADL 527420 and 527421)

MINERAL PROPERTIES LIST

(14)

Properties that have previous mining disturbance requiring reclamation, active mining/exploration activities, surface improvements, location of a camp, or provides access through the claim block for mining activities. **DO NOT LIST CLAIMS UNLESS LISTED ACTIVITIES ARE ASSOCIATED WITH THEM.**

If requesting more than 12 claims, are additional sheets with ADL/BLM/USMS and legal descriptions attached? Yes No

Are any of these mineral properties an Upland or Offshore Mining Lease? Yes No

	ADL/BLM/USMS #	PROPERTY NAME		ADL/BLM/USMS #	PROPERTY NAME
1.	717986	Doric Discovery	7.		
2.			8.		
3.			9.		
4.			10.		
5.			11.		
6.			12.		

INVENTORY OF EQUIPMENT

(15)

List all mechanized equipment to be used (make, model, type, size, purpose, and number of each, including pumps). Attach additional sheets as necessary. If you are transporting on a trailer to the claim block, include the trailer size.

Check One:

	Make, Model, Type, Size, Purpose of Equipment or Pump	Quantity of this type	Located on the claim block?	Transporting to claim block?
1.	CAT D8 Dozer for stripping and reclamation.	1	✓	
2.	CAT 931 Loader/Backhoe for stripping and feeding plant.	1	✓	
3.	CAT 257B MTL for all purpose use.	1		✓
4.	1963 International 5 Yd DumpTruck for moving material.	1	✓	
5.	Wash Plant (Hopper/trommel/conveyor)	1	✓	
6.	3" and 4" pumps for wash plant, as needed.	4	✓	
7.	Bucyrus Erie 22B Dragline for stripping and reclamation	1	✓	
8.				

ACCESS TO THE CLAIM BLOCK

(16)

Access across surface estates not owned by the State requires approval of the managing agency. It is the responsibility of the applicant to contact the owners of private property to obtain authorization for access.

When are you going to be transporting equipment and/or traveling to and from the claim block? Winter Summer

Access to the claim block crosses what type of land(s)?

State City/Borough Federal Private

Indicate type(s) Existing Access to the claim block:

All season Road (These are public easements maintained by municipal, borough, private, or state funds for year round use). List road(s) to claim block: Elliott Highway to Eureka-Rampart Road to existing RST 1845 and RST 1899

Existing Route or a RST/ RS 2477 Easement ~~with a mineral base surface.~~

If the RST/ RS 2477 Easement(s) has a State of Alaska number, please list: RST1845 Minook Cr/1899 Hutlinana H

Navigable Waterway

Aircraft Supported

Indicate type(s) of access to be constructed within the claim block for development of the mineral resource:

Road(s) Helicopter Pad Airstrip No Improvements or Construction Proposed

2

ACCESS TO THE CLAIM BLOCK, CONTINUED

(16)

Please describe your construction activities and include mitigation measures to protect water, fish and game resources. Include a time frame for final closure and a reclamation plan for access within the claim block. Attach additional pages if necessary:

A access map **MUST** be submitted with your application. Topographic maps at a scale of 1"=1 mile must clearly indicate the proposed access route from start to finish, location of proposed construction activities, and appropriate legal descriptions (township and range) on each map sheet. Paper size should be limited to 8 1/2" x 11". Do not tape maps together.

Name the individual(s) or business(es) who will be conducting the travel:

Richard Swenson / Kelly Williams

List all equipment and vehicles conducting travel to/from the claim block, including vehicle weights and season of travel:

2003 Dodge 2500 Pick-up Truck - 7500 lbs
1999 E 450 Cube Van - 10,000 lbs

State the average total miles traveled in one round trip: 2. State the number of trips proposed: 2.

State the start and end date(s) or period(s) of proposed travel: Apr. 1. - Sep. 30.

Select the following terrain type(s) that best describes your route of travel: Wetlands Tundra
 Uplands Rivers or Other Water Bodies Wooded Areas (6" Trees or larger at breast height)

Will water be needed to construct ramps/ ice bridges? Yes No

If Yes, estimated quantity of water will be used: _____ gallons/day Water Source: _____

Are you transporting fuel? Yes No

Maximum volume of fuel (in gallons) that is being transported by one vehicle and any trailers or sleds it is towing:

300g in 6 barrels

Are you transporting other hazardous substances? Yes No If "Yes" indicate type and amount (e.g. gallons, lbs, psi):

hydraulic oil in 5g buckets - usually 2

How are petroleum products contained? (i.e., drums, bladders, steel tanks, etc.) Indicate size of containers:

55g drums

How are petroleum products being transported? (i.e., skid-mounted tank, trailer, 55 gallon drums on skid, etc.)

tandem axle trailer

3



Date	Applicant
Prepared: 5/10/2026	Name: R. Swenson / K. Williams
STATE OF ALASKA	
DEPARTMENT OF NATURAL RESOURCES	
DIVISION OF MINING, LAND AND WATER	
Map: Tanana A1	
Sec(s) 10	Township 13W Range 4N Meridian Fairbanks
Scale: 1" = 80'	ADL(s): 717986
Sheet of	APMA # 26-6872 - 26-6219

1144
13

ACCESS TO CLAIM BLOCK CONTINUED

(16)

Does your travel include the staging or storage of equipment or structures off the claim block? Yes No
If Yes, describe the location and dimensions of the long term or short term parking and/or storage areas.

PETROLEUM PRODUCT STORAGE

(17)

Do you have an Oil Discharge Prevention and Contingency Plan approved by the Alaska Department of Environmental Conservation? Yes No

Do you have either a trained spill response team or a contract with a spill response company? Yes No

Describe any measures you plan to take to minimize drips or spills from leaking equipment or vehicles:

See narrative

Quantity Petroleum Products to be Stored on the Project Site?

- 0-1,320 gallons of total storage (Secondary Containment recommended, but not required)
- 1,321-10,000 gallons of total storage (count only containers with a capacity of 55 gallons or greater). A self-certified Spill Prevention, Control, and Countermeasure (SPCC) plan is required and applies to all products, such as diesel fuel, gasoline, lube oil, hydraulic oil and waste oil. The self certified SPCC form can be downloaded at: <https://www.epa.gov/oil-spills-prevention-and-preparedness-regulations/tier-i-qualified-facility-spcc-plan-template>.
- 10,000+ gallons of total storage (count only containers with 55 gallons or greater storage capacity). An SPCC certified by a professional engineer is required and applies to all oil products, such as diesel fuel, gasoline, lube oil, hydraulic oil and waste oil.

Indicate Distance Stored From Flowing Waters: 200 Feet. (Minimum distance from naturally occurring water bodies required by DNR is 100 feet).

Is waste oil stored on the project site? Yes No If Yes, describe quantity and storage modality: _____

Are fuel containment berms around storage containers? Yes No Is berm area lined? Yes No

BLM operators submitting a plan of operation must submit a spill contingency plan. Notice level operations are encouraged to submit a spill contingency plan. The optional BLM Spill Contingency Plan can downloaded from: https://www.blm.gov/sites/blm.gov/files/BLM-AK_spill-contingency-plan_APMA_worksheetSup.pdf

4

EXPLOSIVES

(21)

Will explosives be used? Yes No If "Yes", Indicate: Type: _____ Amount: _____

Explosive Handler's Certification/ATF Permit Numbers: _____

Describe your blast design, blast schedule, and explosives handling plan in the project narrative.

WATER ENTRAPMENT

(22)

Will you be capturing water for use in mining operations? Yes No The entrapment is: Existing To be constructed

Where does the water have a potential to being stored? Above ground Below ground level Both

If above ground, what is the Length _____ ft Height _____ ft Width at crest _____ ft Width at base _____ ft of the berm(s)

What is the purpose of the water use? Makeup water pond Settling/recycle pond Stream diversion Other _____

How long do you expect for the entrapment to be in place Permanent 1-3 years 3-5 years 5 or more

If above ground, how many acre-feet is the maximum capacity of water stored from ground level to crest of the berm? _____

Total volume in acre-feet = surface area (acres) x average depth (feet) (1 acre = 43,560 square feet)

Where is the topographic location of the water storage area? Valley bottom Hillside

If on a hillside, Approximately how many feet is the water storage above the valley floor _____ ft

IN-STREAM ACTIVITIES and STREAM CROSSINGS

(23)

List any equipment (refer to Box 15 if necessary) that will be crossing streams (including low-water crossings along established trails/roads) or used in any natural waterbody or used in-stream:

3" Pump

List all stream crossings, suction dredge or pump locations, including unnamed streams.

	Stream Name/ Water Source	NAD 83 Datum (approximate) Coordinates can be obtained using Alaska Mapper http://dnr.alaska.gov/mapper/controller		MTRSC ¼ ¼ Ex: F001S001N01 SWSW	Check boxes to indicate type(s) of activity		
		Latitude ddd.mmmm	Longitude -ddd.mmmm		Crossing	Dredging	Water Intake
1.	Doric Creek	65.1925N	150.1871W	<i>F4N13W10 S4NW</i>	<input type="checkbox"/>	<input type="checkbox"/>	<input checked="" type="checkbox"/>
2.					<input type="checkbox"/>	<input type="checkbox"/>	<input type="checkbox"/>
3.					<input type="checkbox"/>	<input type="checkbox"/>	<input type="checkbox"/>
4.					<input type="checkbox"/>	<input type="checkbox"/>	<input type="checkbox"/>
5.					<input type="checkbox"/>	<input type="checkbox"/>	<input type="checkbox"/>

If in-stream activities and/or stream crossings are requested at more than 5 locations, please provide tabular data format.

WATER USE AUTHORIZATIONS

If water is impounded, withdrawn, or diverted, the ADNR Water Resources Section needs to review the water sources and water uses to determine if a water use authorization is needed. Water usage (including from 100% recycle pond systems) may require approval by issuing a Temporary Water Use Authorization (TWUA) or a Water Right. Information provided below will be used to determine the quantity of water that you may be authorized to use for your mining operation. When estimating water quantities, please estimate withdrawal amounts typical of a dry summer and provide the maximum quantity that you may withdraw from a particular source (e.g., stream, pond, groundwater, etc.) in a season. A TWUA application may be initiated from this APMA, unless a Water Right is requested. Please contact the ADNR, Water Resources Section at telephone number (907) 451-2790 for more information.

- Is there a current Water Right within the proposed mineral property boundary? Yes No
- If yes, provide the LAS or ADL Water Right Case File number: Doric Creek - LAS 11956
- What are the months of water use needed (for example May 1st through October 31st)? Apr 1 - Sep 30

Name & Location of Water Source(s):

- If water is required **to fill** or **to maintain** water in the recycle/settling pond system check the applicable box (table below in part A) for each water source used. Please note that a recycle/settling pond system is a water source (5 sources per TWUA). Stormwater from rainfall or snowmelt do not require water use authorizations.
- Identify each water source and its geographic location using MTRS. Include Lat/Long coordinates if available.

Example: Finger Lake: Fairbanks Meridian, Township 3 North, Range 3 West, Section 20.
 MTRS: F3N3W 20
 Lat/Long: 65° 4' 15" N; 148° 12' 43" W

A. Name & Location of Water Source(s). No more than 5 water sources per TWUA. Attach list of additional sources if needed. A \$450 fee is associated with each TWUA. The APMA paperwork is all that is needed to apply for TWUAs. For example, if there are 20 sources listed in the APMA, 4 TWUA case files will be generated. **When submitting an APMA, a separate Application for Temporary use of Water form is not needed.**

Provide the geographic name or locally know name of water Source. (Recycle/settling ponds, creek, stream, well, etc.) If requesting a stream reach, clearly identify the entire stream reach on a legible map.	Meridian	Township	Range	Section(s)	Start-Up Water and/or Make-Up Water? Check each applicable box.		
					Start-Up	Make-Up	
<u>Example:</u> Unnamed Creek	F	3N	3W	20	<input checked="" type="checkbox"/>	<input checked="" type="checkbox"/>	<input checked="" type="checkbox"/>
1. Doric Creek	F	4N	13W	10	Start-Up <input checked="" type="checkbox"/>	Make-Up <input checked="" type="checkbox"/>	
	Latitude: 65-1925N			Longitude: 150.1871W			
2.					Start-Up <input type="checkbox"/>	Make-Up <input type="checkbox"/>	
	Latitude:			Longitude:			
3.					Start-Up <input type="checkbox"/>	Make-Up <input type="checkbox"/>	
	Latitude:			Longitude:			
4.					Start-Up <input type="checkbox"/>	Make-Up <input type="checkbox"/>	
	Latitude:			Longitude:			
5.					Start-Up <input type="checkbox"/>	Make-Up <input type="checkbox"/>	
	Latitude:			Longitude:			

8

WATER USE AUTHORIZATIONS CONT.

(24)

B. Water Use Activities. Complete applicable information for each source. For recycle/settling pond system complete part **C. Recycle/Settling Pond System**. For stream diversions also complete Section 29.

Geographic Name of Water Source <i>(Same as sources Above).</i> Describe the water use information for each source. For recycle/settling pond system complete Section C.	Diversion (gpm/cfs)	Withdrawal Rate (gpm/pump)	Number of Pumps	Hours per Day	Days per Month
1. Doric Creek		320 gpm	1	24	30
2.					
3.					
4.					
5.					

C. Recycle/Settling Pond System	Withdrawal Rate (gpm/pump)	Number of Pumps	Hours per Day	Days per Month	Additional Notes:
This system will also need to be listed as a water source in Section A. This entire pond system counts towards the 5 sources allowed per TWUA. Provide Length (L), Width (W), and Depth (D), of each pond. Beaver ponds or similar nature made impoundments will not be permitted for use as settling ponds.	555	1	6		45 days per season
	Pond # 1: L: ___ ft W: ___ ft D: ___ ft 100 X 30 X 10			Pond # 2: L: ___ ft W: ___ ft D: ___ ft 160 X 15 X 6	
	Pond # 3: L: ___ ft W: ___ ft D: ___ ft			Pond # 4: L: ___ ft W: ___ ft D: ___ ft	

D. Camp Water Uses	Maximum # of People in Camp	Withdrawal Rate (gpm/pump)	Number of Pumps	Hours per Day	Days per Month	Source(s) of Water Well, Haul, Stream, Spring, Lake Source(s) will count towards the 5 sources identified in Section A.
Provide information on camp water uses. If an ADEC public drinking water system is used, please attach certificate to operate and/or associated documents.	2	320	1			6 hours per month
Additional Notes:						

WATER USE AUTHORIZATIONS CONTINUED

(24)

E. Exploration Activities A map of your requested drilling water sources is required with the following information: -MTRS sections, -stream reaches or other water sources (please label, including take points if known) -and drill hole locations.	Is Water Needed for Exploration Trenching or Drilling?	Withdrawal Rate (gpm/pump)	Number of Pumps	Hours per Day	Days per Month	Source(s) of Water Well, Haul, Stream, Spring Lake, etc. Source(s) will count towards the 5 sources identified in Section A.

D. SUCTION DREDGING.

If suction dredging activity is occurring, please ensure that you have completed the dredge table in Section (19) MINING METHOD.

TIMBER CLEARING AND USE
(Operations on State Lands Only)

(25)

Pursuant to AS 38.05.255, timber from land open to mining without lease, except "timberland", may be used by a mining claimant or prospecting site locator for the mining or development of the location or adjacent claims under common ownership. Timber not used for the mining or development of the location or adjacent locations, that is removed from the operation must be acquired via timber sale or written letter of non-objection from the Alaska Division of Forestry.

For questions on the appropriate use of timber on federal mining claims, contact your local BLM field office.

On other lands ("timberlands" and in areas that are closed to mining without lease), timber cleared, used and/or removed must be acquired via a timber sale or a written letter of non-objection from the Alaska Division of Forestry.

Will timber be used for the mining or development of the location or lease? Yes No

Describe the timbered area or areas to be cleared; include a map or drawing of the areas of timber to be cleared.

Describe the amount of timber to be used for the mining or development of the location or lease and the clearing methods you will use.

Are more than 40 acres of timbered area(s) to be cleared? Yes No

11 AAC 86.145. "A classification or designation indicating that timber and other forest products of significant value are included within a mining property is prima facie evidence that the land on which the property is located is considered to be "timberlands" for purposes of AS 38.05.255"

WASTEWATER DISCHARGE PERMIT APPLICATION

(26)

All mechanical placer mine, suction dredge, and mechanical dredge operations that discharge to a water of the U.S. require an Alaska Pollutant Discharge Elimination System (APDES) permit from DEC. See Cover Pages for a list of APDES permit fees.

Operations wishing to discharge under the APDES Small Suction Dredge General Permit (dredges with intake diameters of 6" or less, or highbankers) may skip this section but must complete annual online registrations, including \$25 fee payments, at <https://dec.alaska.gov/water/edms>.

Previously issued DEC-APDES Wastewater discharge permit #: AKG 370000 Swenson/Williams Doric AKG 3700122

Do you want this APMA to act as an application or renewal for any of the following APDES general permits (GPs)*:

- Mechanical Placer Miners GP (open-cut terrestrial operations): Yes No
- Medium-Size Suction Dredge GP (nozzle diameter greater than 6" to 10"): Yes No
- Norton Sound Large Dredge GP (nozzle diameter greater than 10" or mechanical dredge): Yes No

Waterbody the discharge flows directly into, or would potentially flow: Doric Creek - NO DISCHARGE

Approximate coordinates of mine site:

Latitude: 65.1925N Longitude: 150.1871W

Source (e.g., DNR - Alaska Mapper): DNR Alaska Mapper

*Mechanical placer operations that do not elect coverage under the Mechanical Placer Miners GP may be required to obtain coverage under the Multi-Sector General Permit for Storm Water. Contact DEC to terminate a permit.

Optional* - Mixing Zone Request or Termination for Mechanical Placer Mine Operations

Do you wish to apply for a mixing zone and modified turbidity limit from DEC? Yes No

If a mixing zone is requested, provide the following:

Coordinates of discharge location: Latitude: _____ Longitude: _____

Maximum Effluent Flow anticipated from your operation _____ (GPM) [must be greater than zero (0)].

Distance to nearest downstream drinking water source _____ and downstream placer mine _____.

Do you wish to terminate an active authorized mixing zone? Yes (APDES# _____) No

*A mixing zone authorizes an increase in the permit's turbidity limit based on available dilution from the surface water. Permittees without mixing zones must meet the water quality standard for turbidity at the point of discharge into the surface water.

Certification Statement – applicable only to information required for DEC authorizations (required for all DEC permit or mixing zone applicants)

I certify under penalty of law that this document and all attachments were prepared under my direction or supervision in accordance with a system designed to assure that qualified personnel properly gather and evaluate the information submitted. Based on my inquiry of the person or persons who manage the system, or those persons directly responsible for gathering the information, the information submitted is, to the best of my knowledge and belief, true, accurate, and complete. I am aware that there are significant penalties for submitting false information, including the possibility of fine and imprisonment for knowing violations.

Signature of Responsible Party: 

Responsible Party Name (First Last, Position) - Printed: Richard Swenson/Kelly Williams

Business Name (if applicable) - Printed: _____

11

SECTION 404 WETLANDS PERMIT

JURISDICTIONAL DETERMINATION (CORPS JD) and MITIGATION STATEMENT

All Placer Mining applicants are required to contact the Corps of Engineers for submittal requirements.

A complete application for a Department of the Army (DA), U.S. Army Corps of Engineers (Corps) Section 404 permit includes a description of project impacts (contained in the APMA), a Jurisdictional Determination (JD) and a Mitigation Statement. The applications for the JD and the Mitigation Statement are contained in two Corps Supplements, which may be attached to this APMA. The Supplements may be downloaded from the Corps and DNR websites, or obtained directly from a Corps office in paper copy, by email, or mail. Please contact the Corps to determine what supplements are required.

The Supplements are available at: <https://www.poa.usace.army.mil/Missions/Regulatory/Placer-Mining/>

Corps Supplement, Attachment 1, Jurisdictional Determination: Attachment 1 must be filled in and submitted to the Corps for **all new placer applications (New and Existing Operations)**. Photos of your mine site are required. Your JD will be valid for five years. Your photos will be used only for the purpose of conducting an offsite JD.

Corps Supplement, Attachment 2, Mitigation Statement: Alaska District regional mitigation policy for placer mining operations under this General Permit (GP) emphasizes avoidance and minimization of impacts; **compensatory mitigation is not required**. However, by regulation, a Mitigation Statement covering measures for avoidance, minimization, and compensatory mitigation, or, a reason why compensatory mitigation is not proposed, must be submitted to the Corps with each new APMA for projects that impact waters of the U.S.

Provide the Latitude and Longitude of the operation location (DD, NAD83):

Latitude: 65.1901N Longitude: - 150.1871W
Source (e.g., DNR - Alaska Mapper): DNR Mapper

Please list Corps permits previously issued for this site: POA- 1994 - 574 , POA- 1997 - 0403

Certification Statement

The Alaska District will accept the APMA as a pre-construction notification, pursuant to 33 CFR 320.1 (c). Application is hereby made for a permit to authorize the work described in this APMA. I certify the information in the APMA, and any required Supplements, is complete and accurate. I further certify that I possess the authority to undertake the work described herein or am acting as the duly authorized agent of the operator/ applicant.

Operator or Agent:

Richard Swenson/Kelly Williams
Print Name

Kelly Williams
Signature

5.12.26
Date

A MAP OF COMPLETE STREAM DIVERSION IS REQUIRED: The map MUST show the entire length of the diversion (i.e., where the water is diverted from the natural stream channel to where it returns to the natural stream channel) with start and end locations clearly marked. Pending on the scale of the proposed diversion, additional maps, construction details, and a stream reclamation plan may be requested in addition to this section after initial review. Operations on BLM lands that are proposing a stream diversion are encouraged to contact their local field office as early as possible in the permitting process due to additional requirements. **Contact ADF&G, Habitat Section for Fish Habitat Permitting information regarding diversion requirements.**

Please note: A stream diversion structure may also qualify as a dam and be subject to the Alaska Department of Natural Resources Dam Safety Program per definitions provided in AS 46.17.900(3). If you require further regulatory guidance regarding dams, please contact our Dam Safety and Construction Unit, Dam Safety Engineer at (907) 269-8636, or for more information go to the Alaska Dam Safety Program website at: <http://dnr.alaska.gov/mlw/water/dams/>

Is Stream Diversion Required? Yes (if Yes, complete information below). No

Stream Name: _____

Existing (Date Constructed _____) To Be Constructed (Date _____)

Diversion Start/upstream Location (Lat/Long) _____

Diversion End/Downstream Location (Lat/Long) _____

Is Stream Diversion? Permanent Temporary _____ year(s) _____ months

Will diversion be reclaimed annually prior to freeze-up or be retained throughout the mine life?

Annually reclaimed/returned to natural stream Maintained throughout mine life

Dimensions of existing stream in diversion area:

Length _____(ft) Top Width _____(ft) Bottom Width _____(ft) Depth _____(ft) Floodplain Width _____(ft)

Dominant substrate type (Choose Two): Bedrock Boulder Cobble Gravel Sand Silt/Clay

Dimensions of proposed diversion:

Length _____(ft) Top Width _____(ft) Bottom Width _____(ft) Depth _____(ft) Floodplain Width _____(ft)

Note: The general geomorphology (e.g., meander, width/depth, pools/runs, etc.) and instream components (e.g., large woody debris, boulder/cobble, etc.) of the natural stream should be mimicked to the extent practicable.

***Required: A written stream diversion narrative in addition to this form. The narrative should describe the following:**

- 1.) Step by Step Procedures
- 2.) Construction Techniques
- 3.) Reclamation Techniques
- 4.) Timelines

Are culverts being installed in any natural water-body or diversion structures? Yes/No _____

If yes include culvert locations, sizes and length on a map or table.

13

Date	Applicant
Prepared: 5/10/2026	Name: R. Swenson / K. Williams
STATE OF ALASKA DEPARTMENT OF NATURAL RESOURCES DIVISION OF MINING, LAND AND WATER	
Map: Tanana A1	
Sec.(s) 10 Township 13W Range 4N Meridian Fairbanks	
Scale: 1" = 80'	ADL(s): 717986
Sheet of	APMA # 26-6872 - 26-6219

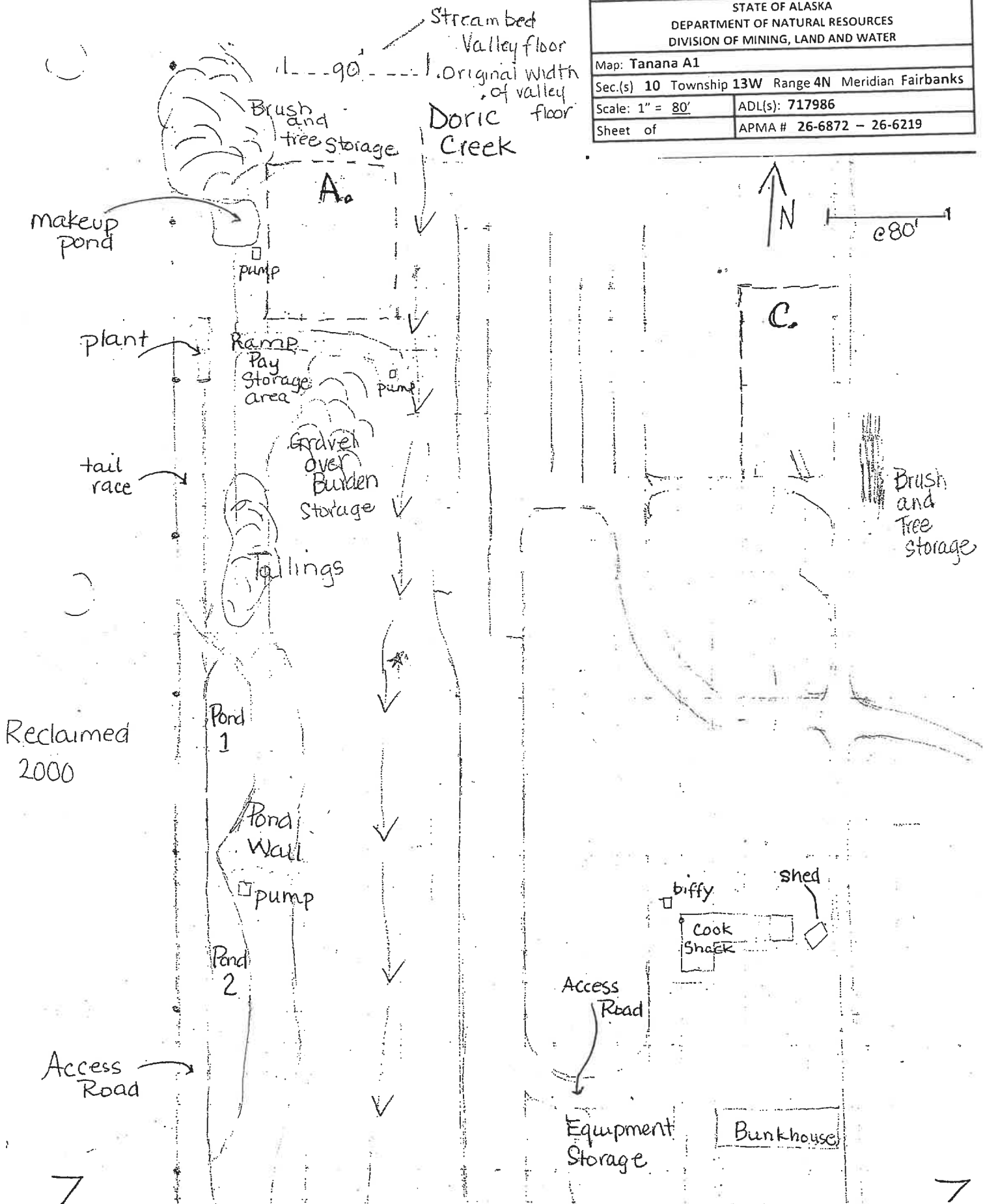

7

7
was 1/10

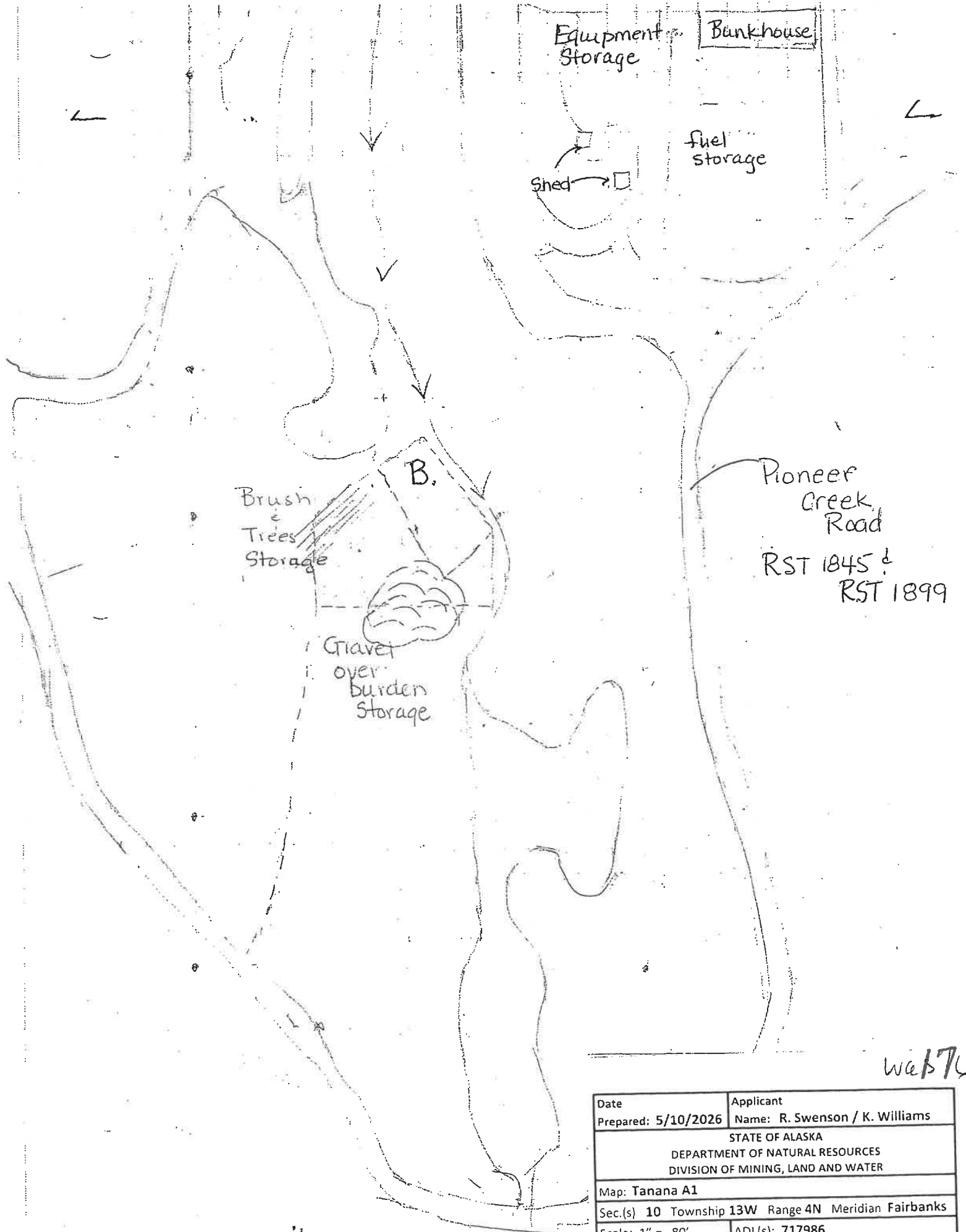

web76

Date	Applicant
Prepared: 5/10/2026	Name: R. Swenson / K. Williams
STATE OF ALASKA DEPARTMENT OF NATURAL RESOURCES DIVISION OF MINING, LAND AND WATER	
Map: Tanana A1	
Sec.(s) 10 Township 13W Range 4N Meridian Fairbanks	
Scale: 1" = 80'	ADL(s): 717986
Sheet of	APMA # 26-6872 - 26-6219

Before Mining



During Mining

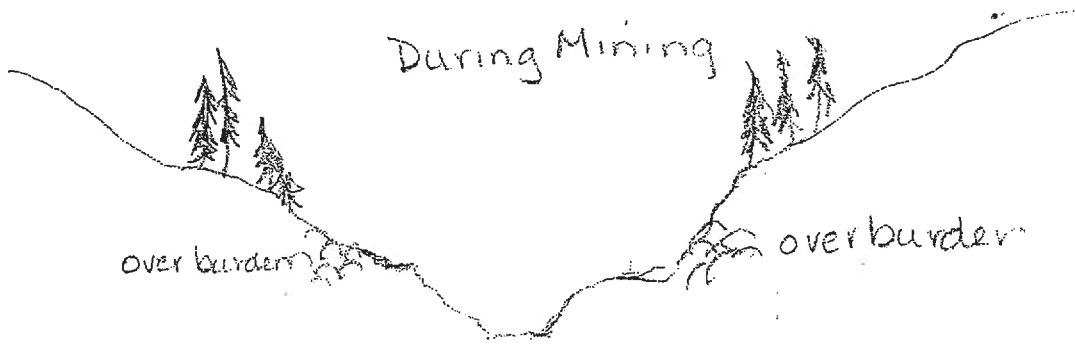

Reclamations

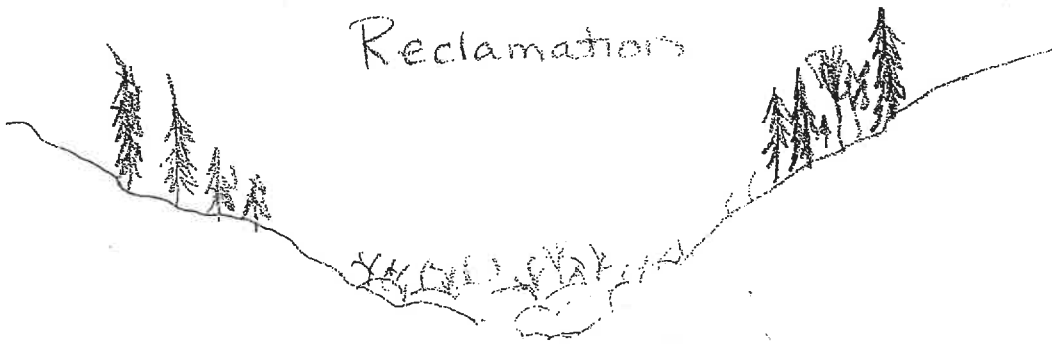

Date	Applicant
Prepared: 5/10/2026	Name: R. Swenson / K. Williams
STATE OF ALASKA DEPARTMENT OF NATURAL RESOURCES DIVISION OF MINING, LAND AND WATER	
Map: Tanana A1	
Sec.(s) 10 Township 13W Range 4N Meridian Fairbanks	
Scale: 1" = 80'	ADL(s): 717986
Sheet of	APMA # 26-6872 - 26-6219

was 18

PLACER/SUCTION DREDGE NARRATIVE *REQUIRED

(31)

A narrative of the operation is required. Please use this space to describe the access, mining process, environmental protection measures and reclamation measures to be used for the duration of this permit. Use multiple sheets if necessary.

DESCRIBE ACCESS, PERSONNEL HOUSING AND CAMP LAYOUT:

This is a continuation of APMA 6872, 2021-2025 for Doric Creek Discovery (ADL 717986). Her camp and mining operation are accessed directly from RST 1845/1899. Both her camp and mining operation camp sit on previously mined ground. The labeled "Plan Map of Operation" shows the access, camp layout, etc.

DESCRIBE PROGRESSIVE STEPS OF MINING METHOD:

Please see attached narrative.

DESCRIBE PLANNED RECLAMATION MEASURES INCLUDING TIMELINE FOR RECLAMATION TO TAKE PLACE:

Please see attached narrative.

DISCUSS WATER MANAGEMENT PLANS, INCLUDING USE, SOURCE, QUANTITY AND SURFACE WATER/ EROSION MANAGMENT PLAN:

Surface waters will be directed away from the work area with berms and ditches. Water from the cut and surface water will be directed into settling ponds. Process water will be recycled in settling ponds.

DISCUSS FUEL STORAGE, HANDLING, AND SPILL PREVENTION AND RESPONSE PLANS:

Fuel is transported in 55g drums to storage area as shown on APMA Plan map. Total fuel on site less than 1,000g. Spill prevention and response supplies at storage site and with equipment, as necessary.

DISCUSS HOW THE OPERATION WILL AVOID/MITIGATE POTENTIAL IMPACTS TO FISH, WILDLIFE AND CULTURAL RESOURCES:

We will have no impact on fish, wildlife and cultural resources.

19

Five Year Mining Plan

Richard Swenson/Kelly Williams

Three components make up the work planned. Each component's ground disturbance is independent of the other two. As much reclamation will be concurrent with the work on each; the open ground will remain less than five acres.

For the sake of brevity, it is understood that all work will be done using best mining practices and will include but not be limited to:

- Stream will be protected from fines and sediments.
- Separate removal, storage and reclamation usage of trees, vegetation, top soils, and gravel overburden. Later to be used in reclamation.
- The current stockpile area will be used to stack pay for processing.
- Existing plant (hopper/trommel/conveyor) will be used for processing pay material.
- Oversize stacks at the end of conveyer. As oversize exceeds storage area directly south of conveyor, it will be removed and stacked east of tail race. Later to be used in reclamation.
- Tailings and sluice water will move down tail race towards settling ponds. Tailings will drop out while travelling down tail race, be allowed to drain, then removed and stacked east of tail race to dry. Later to be used in reclamation.
- Current recycle ponds will be used.
- Reclamation to be accomplished in basically the reverse order of mining steps.
- Prior to permanently leaving the site; final reclamation will include the removal of camp skid-mounted structures and any equipment. Camp area and any area not already reclaimed will be reclaimed with stored materials following above listed protocols.

A. Move North on Right limit: Renewed request.

Move up right limit of creek 100' to the North - 80' east/west. Gravel overburden will be piled in previously mined area just south of this cut. Pay will be stored in current stock pile area for washing.

B. Pick up small Magic Trapezoid, south of old claim line: Renewed request.

Following an old road bed; brush out and cut trees 30' wide for about 200'. Continue to clear brush and trees to create a work pad. The scant vegetative matter in the road bed and work pad to be left in place to take advantage of root mass (or removed and stacked for later use). The Magic Trapezoid, measuring approximately 100' X 75', will be cleared of trees, brush and other organic overburden, to be stacked on west edge of work pad. The gravel overburden will be moved to south onto previously mined ground. Pay will be transported to existing storage site for processing.

C. Small cut in Old Timers' Workings on bench:

Clear trees, brush and organic matter from area of approximately of 120' X 60' and stack on east edge of clearing. Haul pay to existing storage area for sluicing.

While Doric Creek runs a relatively straight line, it does not run directly north and south. In this mining plan; north, south, east and west (from the line of the creek) will be utilized for narrative purposes.

2025 ANNUAL RECLAMATION STATEMENT

(33)

- Placer Mining
- Suction Dredging
- Hardrock Exploration

APMA # F-25-6872

Complete and return this statement by December 31, 2025. If you did not operate, fill in your name, check bottom box, sign, and return form.

In accordance with AS 27.19 (Reclamation Act):

I, Richard Swenson/Kelly Williams hereby file an annual reclamation statement for the 2025 mining operation described in subject Application for Permits to Mine in Alaska. (Submission of this statement does not constitute reclamation approval.)

Volume of material disturbed in 2025: 0 cubic yards (Includes stripping and processed material.)

Sluice days last season: 0 Cubic yards of material processed daily: 0 Annually: 0

Total acreage disturbed in 2025 State 4.5, Federal _____, Private _____. (Includes stripped areas, mining cuts, overburden and tailing stockpiles and disposal areas, temporary stream diversions, stream bypasses, and settling ponds.) Federal operators should include area of camp and access roads.

Length _____ feet and Width _____ feet of stream diversion.

Stream diversion: Temporary Permanent No Diversion (check one).

Total Area reclaimed in 2025: 0 acres.

Total un-reclaimed acres: 4.5 (This should match "total acreage currently disturbed" on the 2026 Reclamation Plan Form.)

For areas reclaimed, the following reclamation measures were used (check only measures that were used).

You must include photographs or videotapes of the completed reclamation work:

- Spread and contoured tailings
- Spread topsoil, vegetation, overburden muck or fines on the surface of contoured tailings
- Reestablished flood plain with stream channel in stable position
- Ponds are reclaimed
- Backfilled and reclaimed temporary stream diversions
- Camp removed, cleaned up and left free of debris
- Hardrock Exploration: Complete and submit an electronic Annual Reclamation Report

State of Alaska
Natural Resources
NOV 25 2025
Mining Section
RECEIVED

Other Reclamation Measures Taken:

Did not operate in 2025 and therefore did not conduct reclamation.

Relationship to Claim(s)

- Owner Lessee Operator
- Agent For: _____

Signed Kelly Williams Date 11/24/25

21

2026 RECLAMATION PLAN FORM (PLACER EXPLORATION OR MINING)

<input type="checkbox"/> A. RECLAMATION PLAN (REQUIRED if the operation will disturb five or more acres this year, OR 50,000 cubic yards, OR if the operation has a cumulative disturbed area of five or more acres).	<input type="checkbox"/> B. RECLAMATION PLAN VOLUNTARY (for an operation below limits shown in Box A but wanting to qualify for the statewide bonding pool. (Operations on BLM Lands and others not filing Letter of Intent).	<input checked="" type="checkbox"/> C. LETTER OF INTENT (34) (less than five acres to be disturbed AND less than 50,000 cubic yards AND less than five acres unreclaimed area).
---	---	--

In accordance with Alaska Statute 27.19, reclamation is required of all mining operations. Reclamation bonding is required of operations with disturbance of 5 acres or greater. Completion of this application will meet the requirements for a "Reclamation Plan" for operations 5 acres and larger in size and for a "Letter of Intent To Do Reclamation" for operations under 5 acres. If you do not intend to use the reclamation methods presented below, you must provide additional information concerning your plans for reclamation under separate attachments.

Total acreage currently disturbed: 4.5 acres. This should match: "Total Unreclaimed Acres" on your 2025 Annual Reclamation Statement for Small Mines, or line #7 on your 2026 Bond Pool Renewal Form. Disturbed ground includes all unreclaimed mining and exploration activity (excluding camps and roads) since October 1991. Federal operators must include areas of camps and roads.

New acres to be disturbed in 2026 0 acres. Total acreage (currently disturbed plus new acres): 4.5 acres.

Acreage disturbed by land status: 4.5 State (general) _____ State (Mental Health) _____ Private _____ Federal _____

Total acreage to be reclaimed in 2026: 0.5 acres; Total volume of material to be disturbed in 2026: 1000 cubic yards.

Include strippings and overburden to be removed. Cubic yards = Length (yards) x Width (yards) x Depth (yards).

Reclamation will be conducted concurrently with activity. Reclamation will be conducted at the end of the season.

THE FOLLOWING RECLAMATION MEASURES SHALL BE USED:

(These measures are required by law. Those that do not apply may be crossed out; but, an explanation must be given as to why these measures are not necessary at your site.)

- Topsoil, vegetation, and overburden muck, not promptly redistributed to an area being reclaimed, will be individually separated and stockpiled for future use. This material will be protected from erosion and from contamination by acidic or toxic materials and will not be buried by tailings.
- The area reclaimed will be reshaped to blend with the surrounding area using tailings, strippings, and overburden and be stabilized.
- Stockpiled topsoil, overburden muck, will be spread over the contoured exploration sites to promote natural plant growth such that the area can reasonably be expected to revegetate within five years. Stockpiled vegetation will be spread over topsoils.
- Settling ponds located within the active flood plain and necessary for continued use during the next mining season will be protected from erosion or the fines removed.
- If the mining operation diverts a stream channel or modifies a flood plain to the extent that the stream channel is no longer stable, the stream channel will be reestablished in a stable location in the valley flood plain.
- The flood plain will be established as appropriate to accommodate seasonal high-water flood events and prevent undue erosional degradation.
- Exploration trenches will be backfilled. Brush piles, stumps, topsoil, and other organics will be spread on the backfilled surface to inhibit erosion and promote natural revegetation.
- Shallow auger holes (limited to depth of overburden) will be backfilled with drill cuttings or other locally available material in such a manner that closes the hole to minimize the risk to humans, livestock and wildlife.
- At placer drift mine closure, all mine shafts, adits, tunnels, and air vents to underground workings will be stabilized and properly sealed to ensure protection of the public, wildlife, and the environment.
- On state lands; all buildings and structures constructed, used or improved will be removed, dismantled, or otherwise properly disposed of unless the surface owner or manager authorizes that the buildings and structures may stay.
- On state lands; all scrap iron, equipment, tools, piping, hardware, chemicals, fuels, waste, and general construction debris will be removed or properly disposed of.
- Reclamation measures taken will be consistent with any alternate post mining land use approved by the Commissioner, subject to the provisions of 11 AAC 97.300(h) and the conditions (if any) of an approved reclamation plan.

IMPORTANT: 1. Alternative reclamation measures may be approved if the reclamation measures presented above are not applicable to your site. Please explain in separate correspondence. Submit a sketch and describe additional reclamation measures you propose to conduct at your operation. Reclamation measures must comply with AS 27.19.

BONDING: In accordance with AS 27.19, bonding is required for all operations having a mined area of greater than or equal to five acres on State Land. This area must be bonded for \$750.00 per acre, unless the miner can demonstrate that a third party contractor can do the needed reclamation for less. The Statewide Bonding Pool may be joined by completing a bond pool application form and meeting certain requirements. No reclamation plan approval goes into effect until the bonding pool deposit and annual nonrefundable fees are paid. Use bond form to calculate area of disturbance for bonding.

BLM requires that a reclamation plan be consistent with §43 CFR 3809.420, Performance Standards for the Surface Management regulations for Federal Operations. Refer to 43 CFR 3809 or the BLM minerals website available at <https://www.blm.gov/programs/energy-and-minerals/mining-and-minerals> for more information on what is needed for a reclamation plan on Federal lands, as they may be different than those identified above.

<p><u>Kelly Williams</u> Printed name (Applicant)</p> <p><u>Kelly Williams</u> Signature (Applicant)</p>	Relationship to Mineral Property: <input checked="" type="checkbox"/> Owner <input type="checkbox"/> Lessee <input checked="" type="checkbox"/> Operator <input type="checkbox"/> Agent For: _____	Date: <u>5.13.26</u> APMA #: <u>6872-</u> <u>6219</u>
--	--	---