



Jeanie Shifflett
Staff Environmental Advisor
ConocoPhillips Alaska, Inc.
Health, Safety, & Environmental
P.O. Box 100360
Anchorage, AK 99510-0360
(907) 265-6488
Jeanie.M.Shifflett@conocophillips.com

May 8, 2026

DOG Permitting
State of Alaska
Department of Natural Resources
550 West 7th Avenue, Suite 1100
Anchorage, AK 99501-3563

Submitted electronically to:
dog.permitting@alaska.gov

**RE: Request to Amend Unit Plan of Operations LONS 83-109
Oliktok Staging Pad (12 Acre Pad) Expansion
Kuparuk River Unit**

Dear Regulators,

ConocoPhillips Alaska, Inc. (CPAI) requests authorization for placement of approximately 11,490 cubic yards of clean gravel fill onto 1.1 acres of land to expand the existing Oliktok Staging Pad (formerly "12 Acre Pad") gravel pad at the southwest corner area. The proposed pad expansion is necessary for the purpose of providing additional lay-down space for the staging and storage of drilling rigs, equipment, piping, modules, and other materials associated with North Slope oil and gas development projects. All work will take place from existing gravel in the Kuparuk River Unit.

The proposed work is scheduled to begin August 1, 2026.

Additional details are provided in the attached ADNRR DOG Unit Plan of Operations Amendment Application form, project description, and figures.

If you have any questions or need additional information, please contact me at (907) 265-6488 or Jeanie.M.Shifflett@conocophillips.com.

Sincerely,

A handwritten signature in blue ink, appearing to read "Jeanie Shifflett".

Jeanie Shifflett
Staff Environmental Advisor

Enclosures



UNIT PLAN OF OPERATIONS AMENDMENT APPLICATION

State of Alaska
 Department of Natural Resources, Division of Oil & Gas
 550 W. 7th Ave, Suite 1100, Anchorage, AK 99501-3563
 Phone: 907-269-8800 Fax: 907-269-8943
 Permitting Email: dog.permitting@alaska.gov



SECTION I: APPLICANT INFORMATION	
1. Applicant: Name: ConocoPhillips Alaska, Inc. (CPAI) Mailing Address: P.O. Box 100360 City: Anchorage State: AK Zip Code: 99510-0360 Phone: N/A Fax: N/A Email: N/A	2. Applicant Contact: First Name: Jeanie Last Name: Shifflett Title: Staff Environmental Advisor Mailing Address: P.O. Box 100360 City: Anchorage State: AK Zip Code: 99510-0360 Phone: 907-265-6488 Fax: N/A Email: jeanie.m.shifflett@conocophillips.com
3. Unit Name Kuparuk River Unit	
4. Unit Operator Contact: First Name: Wendy Last Name: Mahan Title: Field Environmental Coordinator Mailing Address: P.O. Box 100360 City: Anchorage State: AK Zip Code: 99510-0360 Phone: 907-659-7212 Fax: 907-659-7254 Email: N1438@conocophillips.com Describe the relationship between the Unit Operator and the Applicant: CPAI is the unit operator and the applicant is an employee of CPAI.	
SECTION II: 3RD PARTY INFORMATION (Fill out this section only if you are applying for the Applicant)	SECTION III: APPLICATION DATE AND NUMBER
3rd Party Company Name: N/A First Name: N/A Last Name: N/A Title: N/A Mailing Address: N/A City: N/A State: N/A Zip Code: N/A Phone: N/A Fax: N/A Email: N/A Describe the affiliation to the Applicant: N/A	Application Date (Office Use Only): Application Number: LONS 83-109
SECTION IV: PROJECT INFORMATION	
1. Project Name:	Oliktok Staging Pad (12 Acre Pad) Expansion
2. Proposed Start Date:	8/1/2026
3. Project Description:	

Is activity discussed in the approved Plan of Development on file with the Division's Units Section? Yes No

Describe what and where:

ConocoPhillips Alaska, Inc. (CPAI) requests authorization for placement of approximately 11,490 cubic yards (cy) of clean gravel fill onto 1.1 acres of land to expand the existing Oliktok Staging Pad (formerly "12 Acre Pad") gravel pad at the southwest corner area. The proposed pad expansion is necessary for the purpose of providing additional lay-down space for the staging and storage of drilling rigs, equipment, piping, modules, and other materials associated with North Slope oil and gas development projects. All work will take place from existing gravel in the Kuparuk River Unit. See attached project description and figures for additional details.

SECTION V: LAND STATUS

1. State Mineral Estate:

Are supplemental pages for land status included in Appendix C? Yes No

Affected ADL: 025513 Date Effective: 7/1/2018 Date Assigned: 11/13/2018

Oil And Gas Lessee(s): CPAI

Surface Ownership: State of Alaska

Do you have, or anticipate having an Access Agreement: Yes No

Special Use Lands: None identified

Jointly Managed Lands: None identified

Other Considerations: None

Project Components	Meridian, Township, Range, And Section(s)	GPS Coordinates
Gravel	Umiat, T13N, R9E, Section 16	Latitude: 70.4864769, Longitude -149.8397951
Click here to enter text.	Click here to enter text.	Click here to enter text.
Click here to enter text.	Click here to enter text.	Click here to enter text.

2. State of Alaska Surface Lands:

Are supplemental pages for land status included in Appendix C? Yes No

Oil And Gas Mineral Estate Owner: N/A

Access Authorization(s): N/A

Special Use Lands: N/A

Jointly Managed Lands: N/A

Other Considerations: N/A

Project Components	Meridian, Township, Range, And Section(s)	GPS Coordinates
N/A	N/A	N/A
N/A	N/A	N/A
N/A	N/A	N/A

3. Private Lands:

Are supplemental pages for land status included in Appendix C? Yes No

Oil And Gas Mineral Estate Owner: N/A

Surface Ownership And Access Agreement(s): N/A

Special Use Lands: N/A

Jointly Managed Lands: N/A

Other Considerations: N/A

Project Components	Meridian, Township, Range, And Section(s)	GPS Coordinates
--------------------	---	-----------------

N/A	N/A	N/A
N/A	N/A	N/A
N/A	N/A	N/A

SECTION VI: SEQUENCE AND SCHEDULE OF OPERATIONS

Project Milestone #	Project Milestone	Proposed Start Date	Proposed End Date
1.	Gravel	8/1/2026	10/31/2026
2.	N/A	N/A	N/A
3.	N/A	N/A	N/A
4.	N/A	N/A	N/A
5.	N/A	N/A	N/A
6.	N/A	N/A	N/A
7.	N/A	N/A	N/A
8.	N/A	N/A	N/A
9.	N/A	N/A	N/A
10.	N/A	N/A	N/A

SECTION VII: PROJECTED USE REQUIREMENTS

1. Describe the proposed operations, including the location and design, of **Well Sites**:

N/A
 Click here to enter text.

2. Describe the proposed operations, including the location and design, of **Buildings**:

Click here to enter text.
 N/A

3. Describe the proposed operations, including the location and design, of **Fuel and Hazardous Substances**:

N/A

4. Describe the proposed operations, including the location and design, of **Solid Waste Sites**:

N/A

5. Describe the proposed operations, including the location and design, of **Water Supplies**:

N/A

6. Describe the proposed operations, including the location and design, of **Utilities**:

N/A

7. Describe the proposed operations, including the location and design, of **Material Sites**:

The project will include the placement of approximately 11,490 cubic yards of clean gravel onto 1.1 acre of land. The gravel will be sourced from existing permitted sources (Mine Site C and/or E) within the KRU and will be hauled to the project area on the existing Kugaruk field road system.

8. Describe the proposed operations, including the location and design, of Roads :				
N/A				
9. Describe the proposed operations, including the location and design, of Airstrips :				
N/A				
10. Describe the proposed operations, including the location and design, of All Other Facilities and Equipment :				
CPAI proposes to place approximately 11,490 cubic yards of gravel fill onto 1.1 acre of land.				
11. If another permit(s) is required for the above described Projected Use Requirements, provide the following information:				
Agency	Permit Type	Permit Number	Application Status	Projected Use Requirement(s)
North Slope Borough	Land Management Regulations (LMR) Development Permit	NSB-431	Applied	7, 10
SECTION VIII: REHABILITATION PLAN				
1. Proposed Level of Infrastructure, Facilities and Equipment Removal:				
N/A				
2. Description of Restoration and Rehabilitation Activities for Vegetation, Habitat, Impacted Wildlife, and Other Applicable Resources:				
The amended application does not change the plans for rehabilitation upon abandonment outlined in the original authorization.				
SECTION IX: OPERATING PROCEDURES DESIGNED TO MINIMIZE ADVERSE EFFECTS				
Describe operating procedures designed to prevent or minimize adverse effects on other natural resources and other uses of the Unit area and adjacent areas including:				
Fish and Wildlife Habitats: CPAI has a Wildlife Avoidance Interaction Plan designed to prevent or minimize adverse effects on other natural resources.				
Historic and Archeological Sites: CPAI does not believe this would have any impacts to cultural resources since the area has been previously cleared from archeological and cultural clearance. No impacts are expected.				
Public Use Areas: This area is not open to the public.				
Other Uses: N/A				
SECTION X: GLOSSARY OF TERMS				
Term #	Term	Term Definition		
1.	CPAI	ConocoPhillips Alaska, Inc.		
2.	N/A	Not Applicable		
3.	TBD	To be determined		
4.	cy	Cubic Yards		
5.	OSP	Oliktok Staging Pad (formerly 12 Acre Pad)		
SECTION XI: CONFIDENTIALITY				
The undersigned hereby requests that each page/section of this application <u>marked</u> confidential be held confidential under AS 38.05.035(a)(8).				
APPLICANT CONTACT:				
Sign here.	Enter Name.	Enter Title.	Enter Date.	
Signature	Name	Title	Date	

See the attached maps and figures.

No new exceptions are expected

APPENDIX C: OTHER

See Project Description

Additional permits required for the above Project Use Requirements:

Agency	Permit Type	Permit Number	Application Status	Projected Use Requirement(s)
North Slope Borough	Certificate of Traditional Land Use Inventory Clearance	NSB TLUI-50	Approved	10
US Army Corp of Engineers	Regional General Permit 05 North Slope	POA-2022-00543	Applied	10



Department of Natural Resources
Division of Oil and Gas
Permitting Receipt

Receipt Number: 5393006

Identifier: LONS 83-109

Amount: \$250.00

Date: 05/08/2026

Description: Oliktok Staging Pad (12 Acre Pad) Expansion

Bankcard Number: 7116

Bankcard Type: VI

Remitter Name: SHIFFLETT, JEANNETTE

Address: [REDACTED]
[REDACTED]



Oliktok Staging Pad (12 Acre Pad) Expansion

Kuparuk River Unit

Amend LONS 83-109

Project Description

ConocoPhillips Alaska, Inc. (CPAI) requests authorization for placement of approximately 11,490 cubic yards (cy) of clean gravel fill onto 1.1 acres of land to expand the existing Oliktok Staging Pad (formerly "12 Acre Pad") gravel pad at the southwest corner area. The proposed pad expansion is necessary for the purpose of providing additional lay-down space for the staging and storage of drilling rigs, equipment, piping, modules, and other materials associated with North Slope oil and gas development projects. All work will take place from existing gravel in the Kuparuk River Unit.

All activities will be conducted in accordance with federal, state, and local regulations, permit stipulations and general concurrence stipulations as appropriate. The proposed project maps and figures represent the project plan and will be adjusted if needed for varying field conditions.

The proposed work is scheduled to begin August 1, 2025. CPAI will utilize typical construction equipment including gravel-hauling trucks, road graders, and compactors.

All activities will be conducted in accordance with federal, state, and local regulations, permit stipulations and general concurrence stipulations as appropriate. Please see the attachments for additional details. The figures represent the project plan and will be adjusted if needed for varying field conditions.

REV	DATE	BY	CK	APP	DESCRIPTION	REV	DATE	BY	CK	APP	DESCRIPTION
0	4/25/26	JFC	JHV		Create Drawing						

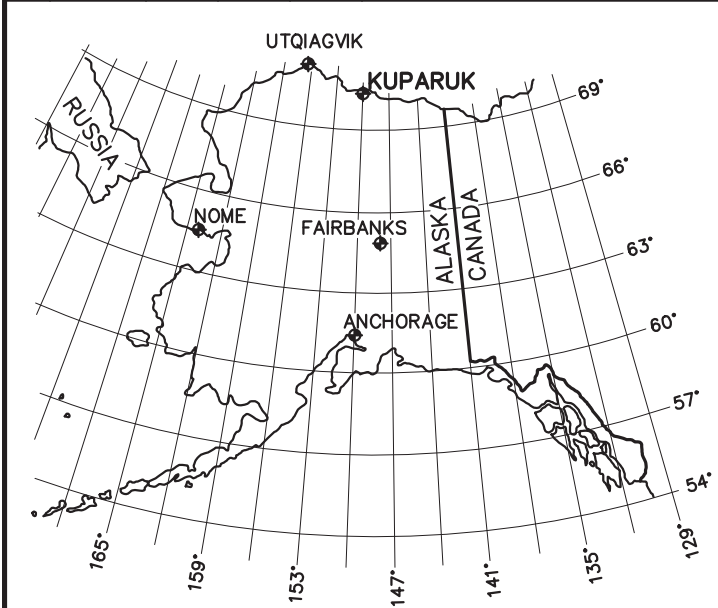

ALASKA VICINITY MAP N.T.S.

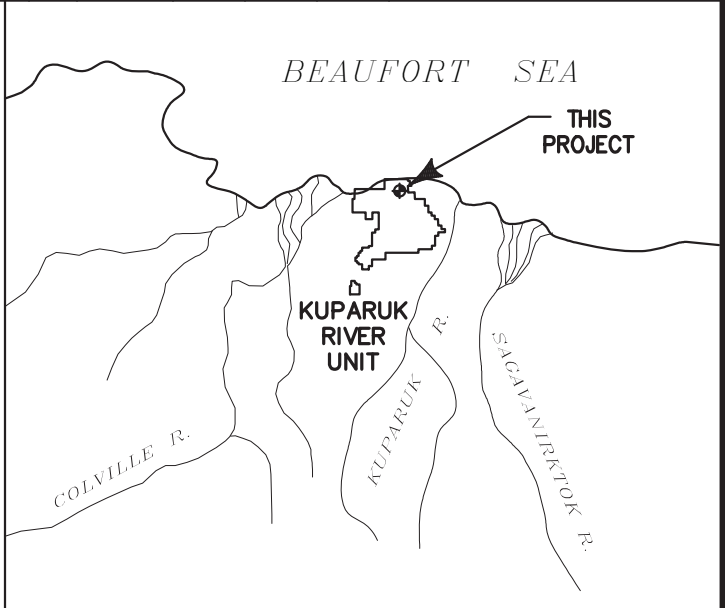

KUPARUK VICINITY MAP N.T.S.

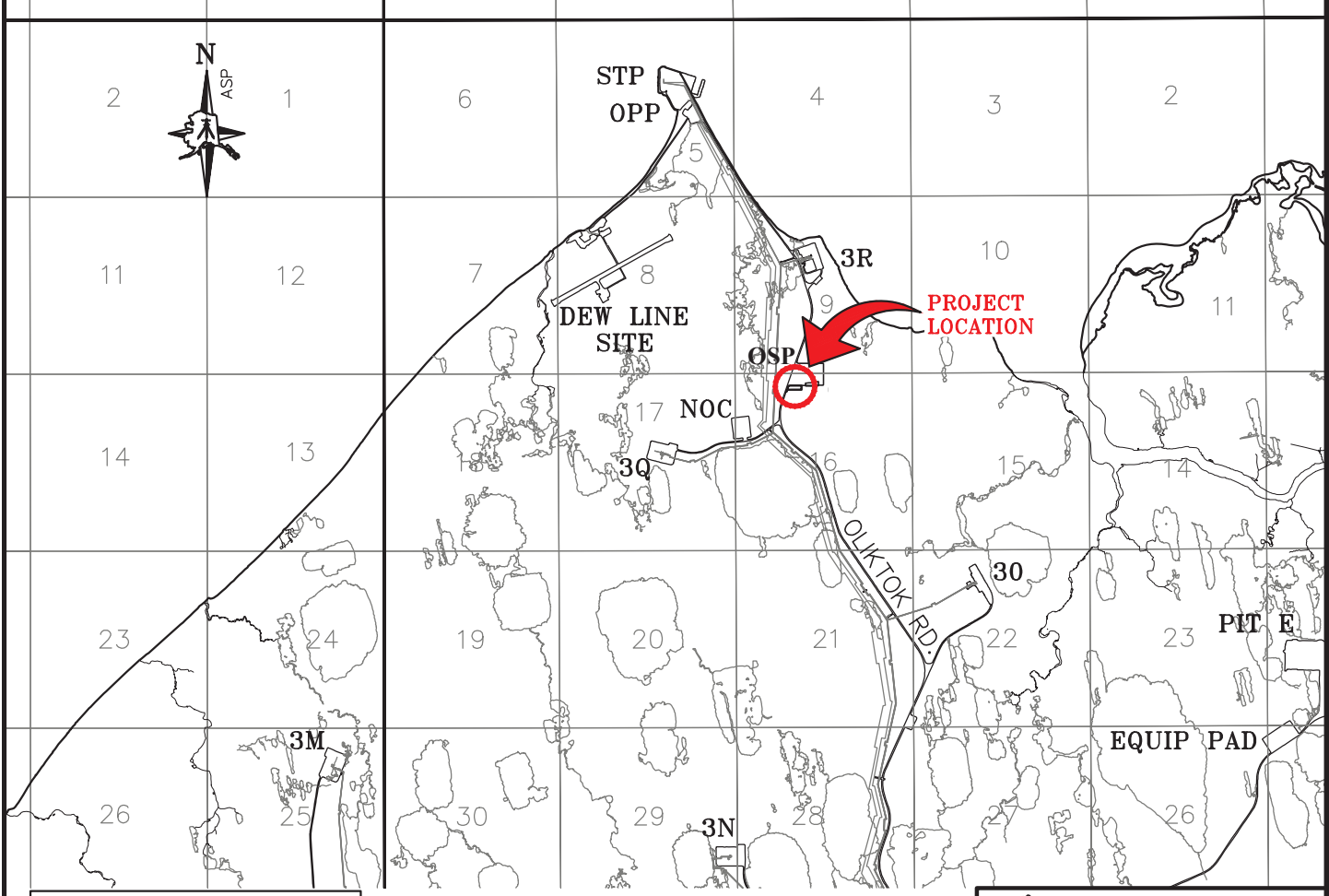

This Project is Located in BEECHEY POINT B-5 Quadrangle.

SCALE: 1"=1 MILE

LOUNSBURY & ASSOCIATES, INC.
SURVEYORS ENGINEERS PLANNERS

ConocoPhillips Alaska, Inc.	AREA:	MODULE: XXXX	UNIT:
		OCC GRAVEL EXPANSION PERMIT EXHIBIT	

CADD FILE NO. LK610D111	4/25/26	DRAWING NO. NSK 6.10 - d111	PART: 1 OF 3	REV: 0
----------------------------	---------	--------------------------------	-----------------	-----------

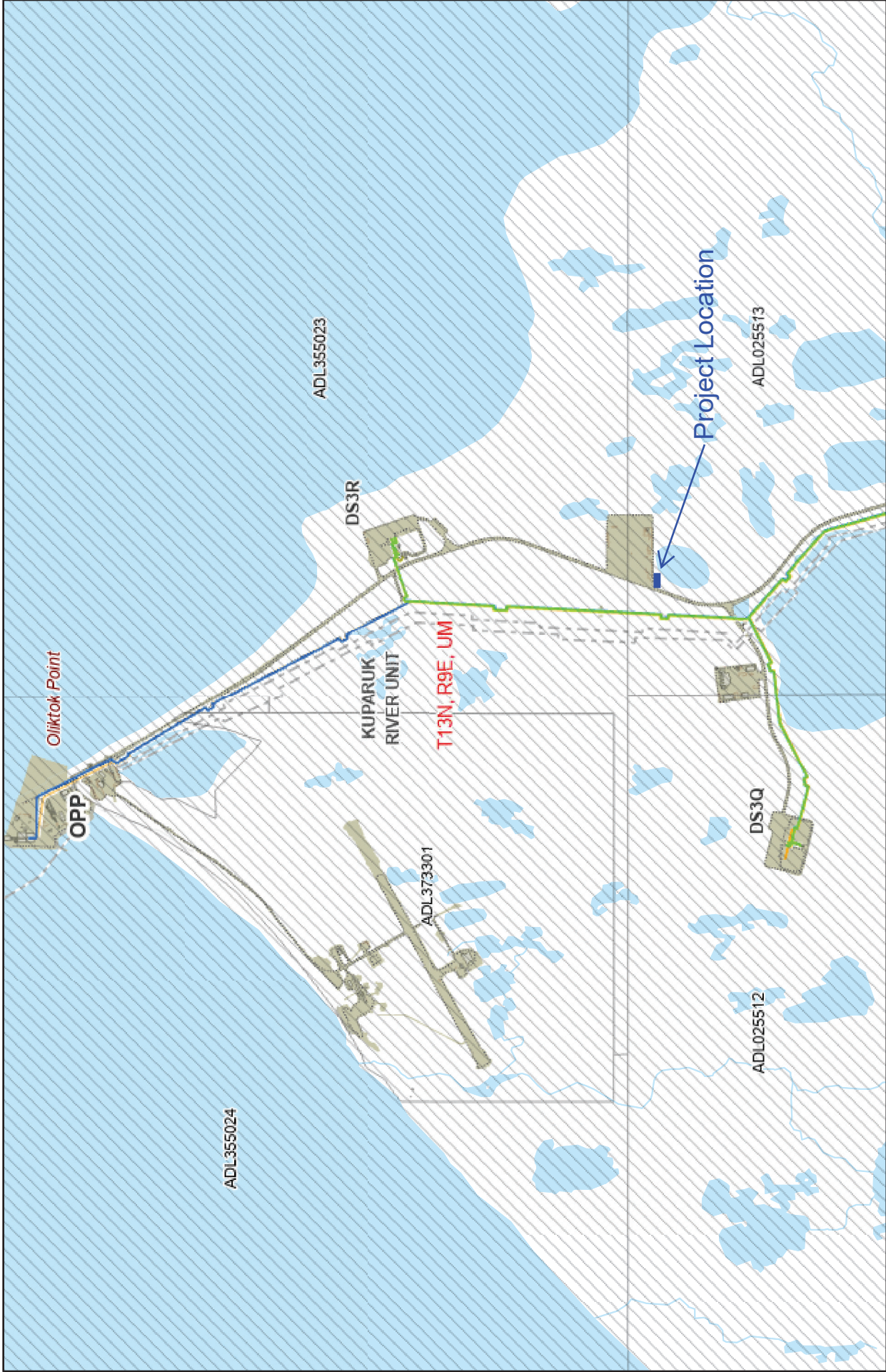

OSP Expansion Project - Location Map

5/8/2026

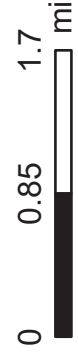

The source website and all maps are the property of ConocoPhillips and may not be used without authorization by ConocoPhillips. This map is a graphical representation and is not guaranteed for completeness, accuracy, scale, or suitability for any purpose.

Map Datum: WGS84

REV	DATE	BY	CK	APP	DESCRIPTION	REV	DATE	BY	CK	APP	DESCRIPTION
0	4/25/26	JFC	JHV		Create Drawing						

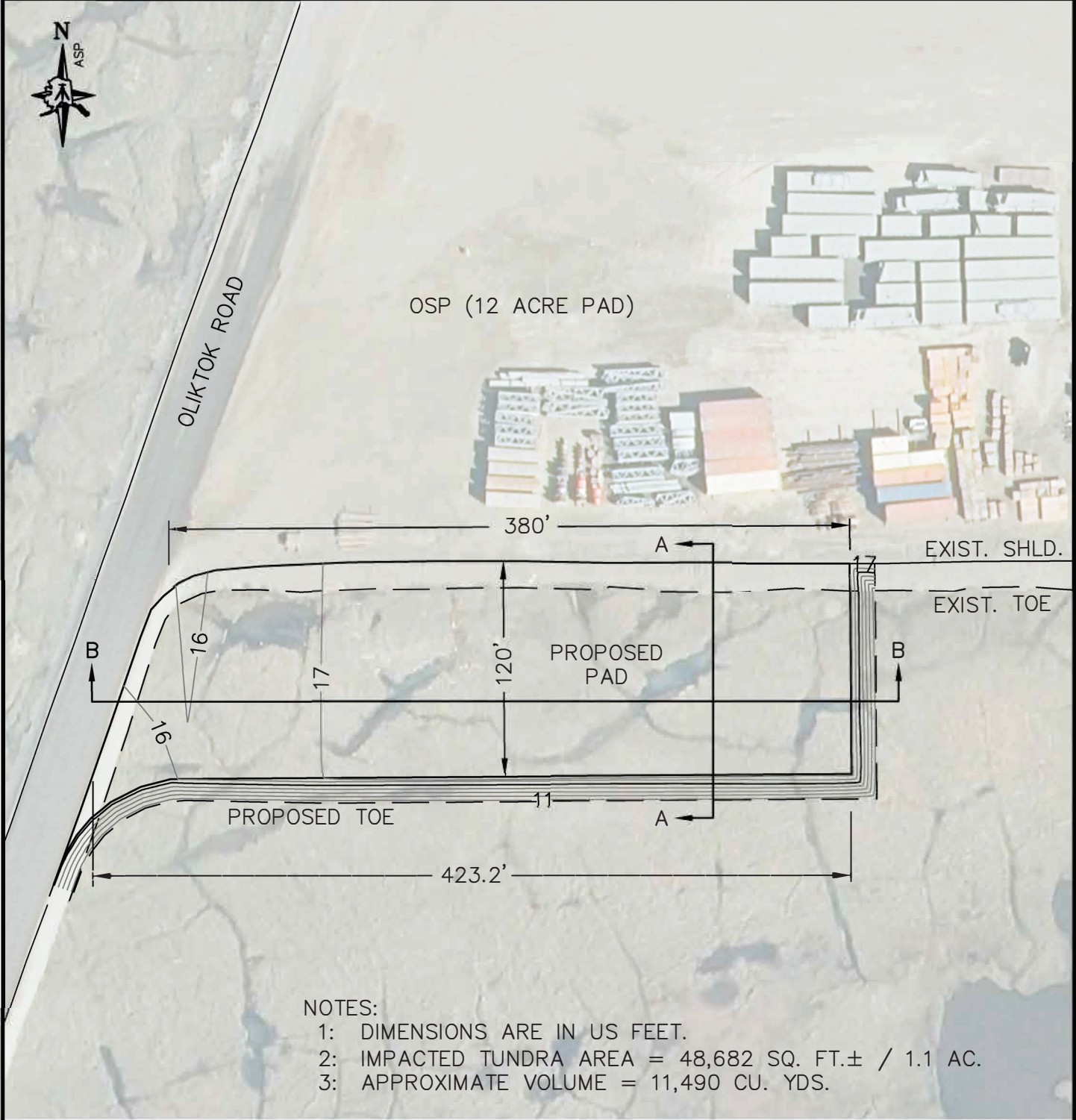

- NOTES:
- 1: DIMENSIONS ARE IN US FEET.
 - 2: IMPACTED TUNDRA AREA = 48,682 SQ. FT.± / 1.1 AC.
 - 3: APPROXIMATE VOLUME = 11,490 CU. YDS.

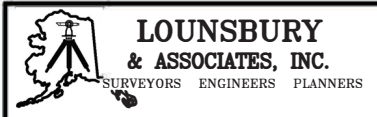
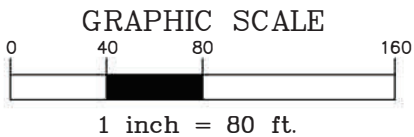

		AREA:	MODULE: XXXX	UNIT:
		OSP GRAVEL EXPANSION PERMIT EXHIBIT		
CADD FILE NO. LK610D111	4/25/26	DRAWING NO. NSK 6.10 - d111	PART: 2 OF 3	REV: 0

