

CERTIFICATE OF OWNERSHIP AND DEDICATION

I, the undersigned, hereby certify that I am the Director, Division of Geological & Geophysical Surveys, and that the State of Alaska is owner of ASLS 84-157 as shown hereon. I hereby approve this survey and plat for the State of Alaska, and dedicate for public or private use as noted, all easements, public utility areas, and rights of way as shown and described hereon.

DATE April 16, 1986
 DIRECTOR
 DIVISION OF GEOLOGICAL & GEOPHYSICAL SURVEYS

NOTARY'S ACKNOWLEDGEMENT

Subscribed and sworn to before me this 15th day of April, 1986.
 For State of Alaska
 NOTARY FOR THE STATE OF ALASKA
 My commission expires 7-18-86

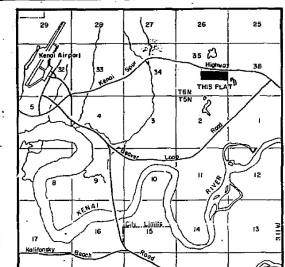

VICINITY MAP

CERTIFICATE OF LESSEE

I, hereby certify that the City of Kenai is the lessee for Tract A shown hereon and that I hereby approve this plat for the City of Kenai.

DATE April 16, 1986
 AUTHORIZED OFFICIAL
 DATE 4-14-86

NOTARY'S ACKNOWLEDGEMENT

Subscribed and sworn to before me this 15th day of April, 1986.
 For City of Kenai
 NOTARY FOR THE STATE OF ALASKA
 My commission expires 8-2-87

NOTES

- This survey was accomplished in accordance with Special Survey Instructions No. 84-157.
- All bearings shown are true bearings as oriented to the Basis of Bearing. Distances shown are reduced to horizontal field distances.
- The accuracy of this survey is greater than 1:5000.
- All parcels of land owned by the State of Alaska, located within fifty (5000) feet of, or abutted by surveyed section line, are subject to a fifty (5000) foot easement, each side of the section line, which is reserved to the State of Alaska for public highways under AS 19.10.010.
- A setback of 20' is required from all street right-of-ways unless a lesser standard is approved by resolution of the appropriate planning commission.
- Primary monuments consist of a 2" X 30" Alum. pins with a 3/16" Alum. cap.
- No structures permitted within posthole portion of tract A.

SURVEYOR'S CERTIFICATE

I, hereby certify that I am a properly registered and licensed to practice land surveying in the State of Alaska, and that this plat represents a survey made by me or under my direct supervision, and the measurements shown hereon actually taken as described, and that all dimensions and other details are correct.

DATE Feb 11, 1986 REGISTRATION NUMBER LS-6101



PLAT APPROVAL

This plat was approved by the Kenai Peninsula Borough Planning Commission at the meeting of Nov. 18, 1985

BY Richard P. Topp
 AUTHORIZED OFFICIAL

SELECTION INFORMATION

Mental Health 25
 Tentative Approval dated 7-2-83



LEGEND

- S.L.O.-B.L.M. MONUMENT RECOVERED
- PRIMARY ALUMINUM CAP MONUMENT SET
- ⊙ PRIMARY BRASS CAP MONUMENT RECOVERED
- UNRECOVERED
- SURVEYED
- () RECORDED

36-72
 FILED
 DATE 12/11/85
 BY AS/ALC

MONUMENT										ACCESSORIES									
NO.	DESC.	TYPE	BEARING	DIST.	NO.	DESC.	TYPE	BEARING	DIST.	NO.	DESC.	TYPE	BEARING	DIST.	NO.	DESC.	TYPE	BEARING	DIST.
1/4	15"	PP	N39°32'E	115.42	1	US500	1/4	S35°53'W	536.1	1	US500	1/4	S35°53'W	536.1	1	US500	1/4	S35°53'W	536.1
1/4	10"	PP	N25°19'E	58.25	2	US500	1/4	S35°53'W	536.1	2	US500	1/4	S35°53'W	536.1	2	US500	1/4	S35°53'W	536.1
1/4	5"	PP	S60°02'W	51.85	3	US500	1/4	S35°53'W	536.1	3	US500	1/4	S35°53'W	536.1	3	US500	1/4	S35°53'W	536.1
1/4	5"	PP	S60°02'W	51.85	4	US500	1/4	S35°53'W	536.1	4	US500	1/4	S35°53'W	536.1	4	US500	1/4	S35°53'W	536.1
1/4	5"	PP	S60°02'W	51.85	5	US500	1/4	S35°53'W	536.1	5	US500	1/4	S35°53'W	536.1	5	US500	1/4	S35°53'W	536.1
1/4	5"	PP	S60°02'W	51.85	6	US500	1/4	S35°53'W	536.1	6	US500	1/4	S35°53'W	536.1	6	US500	1/4	S35°53'W	536.1
1/4	5"	PP	S60°02'W	51.85	7	US500	1/4	S35°53'W	536.1	7	US500	1/4	S35°53'W	536.1	7	US500	1/4	S35°53'W	536.1
1/4	5"	PP	S60°02'W	51.85	8	US500	1/4	S35°53'W	536.1	8	US500	1/4	S35°53'W	536.1	8	US500	1/4	S35°53'W	536.1
1/4	5"	PP	S60°02'W	51.85	9	US500	1/4	S35°53'W	536.1	9	US500	1/4	S35°53'W	536.1	9	US500	1/4	S35°53'W	536.1
1/4	5"	PP	S60°02'W	51.85	10	US500	1/4	S35°53'W	536.1	10	US500	1/4	S35°53'W	536.1	10	US500	1/4	S35°53'W	536.1
1/4	5"	PP	S60°02'W	51.85	11	US500	1/4	S35°53'W	536.1	11	US500	1/4	S35°53'W	536.1	11	US500	1/4	S35°53'W	536.1
1/4	5"	PP	S60°02'W	51.85	12	US500	1/4	S35°53'W	536.1	12	US500	1/4	S35°53'W	536.1	12	US500	1/4	S35°53'W	536.1
1/4	5"	PP	S60°02'W	51.85	13	US500	1/4	S35°53'W	536.1	13	US500	1/4	S35°53'W	536.1	13	US500	1/4	S35°53'W	536.1
1/4	5"	PP	S60°02'W	51.85	14	US500	1/4	S35°53'W	536.1	14	US500	1/4	S35°53'W	536.1	14	US500	1/4	S35°53'W	536.1
1/4	5"	PP	S60°02'W	51.85	15	US500	1/4	S35°53'W	536.1	15	US500	1/4	S35°53'W	536.1	15	US500	1/4	S35°53'W	536.1
1/4	5"	PP	S60°02'W	51.85	16	US500	1/4	S35°53'W	536.1	16	US500	1/4	S35°53'W	536.1	16	US500	1/4	S35°53'W	536.1
1/4	5"	PP	S60°02'W	51.85	17	US500	1/4	S35°53'W	536.1	17	US500	1/4	S35°53'W	536.1	17	US500	1/4	S35°53'W	536.1
1/4	5"	PP	S60°02'W	51.85	18	US500	1/4	S35°53'W	536.1	18	US500	1/4	S35°53'W	536.1	18	US500	1/4	S35°53'W	536.1
1/4	5"	PP	S60°02'W	51.85	19	US500	1/4	S35°53'W	536.1	19	US500	1/4	S35°53'W	536.1	19	US500	1/4	S35°53'W	536.1
1/4	5"	PP	S60°02'W	51.85	20	US500	1/4	S35°53'W	536.1	20	US500	1/4	S35°53'W	536.1	20	US500	1/4	S35°53'W	536.1
1/4	5"	PP	S60°02'W	51.85	21	US500	1/4	S35°53'W	536.1	21	US500	1/4	S35°53'W	536.1	21	US500	1/4	S35°53'W	536.1
1/4	5"	PP	S60°02'W	51.85	22	US500	1/4	S35°53'W	536.1	22	US500	1/4	S35°53'W	536.1	22	US500	1/4	S35°53'W	536.1
1/4	5"	PP	S60°02'W	51.85	23	US500	1/4	S35°53'W	536.1	23	US500	1/4	S35°53'W	536.1	23	US500	1/4	S35°53'W	536.1
1/4	5"	PP	S60°02'W	51.85	24	US500	1/4	S35°53'W	536.1	24	US500	1/4	S35°53'W	536.1	24	US500	1/4	S35°53'W	536.1
1/4	5"	PP	S60°02'W	51.85	25	US500	1/4	S35°53'W	536.1	25	US500	1/4	S35°53'W	536.1	25	US500	1/4	S35°53'W	536.1
1/4	5"	PP	S60°02'W	51.85	26	US500	1/4	S35°53'W	536.1	26	US500	1/4	S35°53'W	536.1	26	US500	1/4	S35°53'W	536.1
1/4	5"	PP	S60°02'W	51.85	27	US500	1/4	S35°53'W	536.1	27	US500	1/4	S35°53'W	536.1	27	US500	1/4	S35°53'W	536.1
1/4	5"	PP	S60°02'W	51.85	28	US500	1/4	S35°53'W	536.1	28	US500	1/4	S35°53'W	536.1	28	US500	1/4	S35°53'W	536.1
1/4	5"	PP	S60°02'W	51.85	29	US500	1/4	S35°53'W	536.1	29	US500	1/4	S35°53'W	536.1	29	US500	1/4	S35°53'W	536.1
1/4	5"	PP	S60°02'W	51.85	30	US500	1/4	S35°53'W	536.1	30	US500	1/4	S35°53'W	536.1	30	US500	1/4	S35°53'W	536.1

() - ORIG. B.T.
 S - SPRUCE
 B - BIRCH
 A - ASPEN
 BB - STUMP
 PP - POWER POLE

DATE OF SURVEY February 1986 NAME OF SURVEYOR DOWNRICK & ASSOC.
 ENGINEER NUMBER 155 STATE OF ALASKA
 ADDRESS 155 South Way ANCHORAGE, ALASKA 99569

STATE OF ALASKA
 DEPARTMENT OF NATURAL RESOURCES
 DIVISION OF GEOLOGICAL & GEOPHYSICAL SURVEYS
 ANCHORAGE, ALASKA

ALASKA STATE LAND SURVEY NO. 84-157

LOCATED WITHIN
 S E 1/4 SECTION 35, TOWNSHIP 6 NORTH, RANGE 1 WEST
 SEWARD MERIDIAN, ALASKA
 CITY OF KENAI

DRAWN BY AS/ALC APPROVAL 4/16/86
 DATE 12/11/85 FILE NO. 84-157
 SCALE 1" = 200' CHECKED AS/ALC