



**Miranda Buckmaster**  
Environmental Advisor

ConocoPhillips Alaska, Inc.  
Environmental Sustainability & Permitting  
P.O. Box 100360  
Anchorage, AK 99510-0360  
Phone: (907) 263-4868  
Email: [miranda.buckmaster@conocophillips.com](mailto:miranda.buckmaster@conocophillips.com)

3/20/2026

Department of Natural Resources  
Division of Oil and Gas  
DOG Permitting  
550 West 7th Avenue, Suite 1100  
Anchorage, AK 99501-3563

*Submitted Electronically to:*  
[DOG.Permitting@alaska.gov](mailto:DOG.Permitting@alaska.gov)

**RE: 2026 Willow KRU Roads Upgrades  
Request to Amend Unit Plan of Operations LONS 79-016  
Kuparuk River Unit**

Dear Regulators:

ConocoPhillips, Alaska, Inc. (CPAI) requests authorization to upgrade sections of Kuparuk River Unit (KRU) roads between Station 49 (just south of the Oliktok causeway) and Drill Site 2P (DS-2P) by placing up to 94,900 cubic yards of clean gravel fill on top of and along the toe of existing KRU gravel roads. The new project footprint within the KRU is 5.4 acres. The purpose of this work is to widen select curves and narrow spots in the road system to allow for the safe transportation of the Willow Central Facility (WCF) modules for the Willow development project. These upgrades also include the extension or replacement of 15 culverts within the KRU.

Please see the attached project description figures, and maps for additional information.

The proposed work is scheduled to begin May 15, 2026, or as soon as the required permits are received.

If you have any questions or need additional information, please contact me at (907) 263-4868 or [miranda.buckmaster@conocophillips.com](mailto:miranda.buckmaster@conocophillips.com).

Sincerely,

A handwritten signature in blue ink, appearing to read "MBuckmaster", written over a light blue horizontal line.

Miranda Buckmaster

Enclosures



# UNIT PLAN OF OPERATIONS AMENDMENT APPLICATION

State of Alaska  
 Department of Natural Resources, Division of Oil & Gas  
 550 W. 7th Ave, Suite 1100, Anchorage, AK 99501-3563  
 Phone: 907-269-8800 Fax: 907-269-8943  
 Permitting Email: [dog.permitting@alaska.gov](mailto:dog.permitting@alaska.gov)



SECTION I: APPLICANT INFORMATION	
<b>1. Applicant:</b>  Name: ConocoPhillips Alaska, Inc. (CPAI)  Mailing Address: P.O. Box 100360 City: Anchorage State: AK                                      Zip Code: 99510-0360 Phone: N/A                                      Fax: N/A Email: N/A	<b>2. Applicant Contact:</b>  First Name: Mirnada                                      Last Name: Buckmaster Title: Senior Environmental Coordinator Mailing Address: P.O. Box 100360 City: Anchorage State: AK    Zip Code: 99510-0360 Phone: 907-263-4868    Fax: N/A Email: <a href="mailto:Miranda.buckmaster@conocophillips.com">Miranda.buckmaster@conocophillips.com</a>
<b>3. Unit Name</b> Kuparuk River Unit	
<b>4. Unit Operator Contact:</b>  First Name: Wendy                                      Last Name: Mahan                                      Title: Field Environmental Coordinator Mailing Address: P.O. Box 100360 City: Anchorage    State: AK    Zip Code: 99510-0360 Phone: 907-659-7212                                      Fax: 907-659-7254                                      Email: <a href="mailto:N1438@conocophillips.com">N1438@conocophillips.com</a> Describe the relationship between the Unit Operator and the Applicant: CPAI is the unit operator.	
SECTION II: 3RD PARTY INFORMATION (Fill out this section only if you are applying for the Applicant)	SECTION III: APPLICATION DATE AND NUMBER
3rd Party Company Name: N/A  First Name: N/A                                      Last Name: N/A Title: N/A Mailing Address: N/A City: N/A State: N/A    Zip Code: N/A Phone: N/A    Fax: N/A Email: N/A  Describe the affiliation to the Applicant: N/A	Application Date (Office Use Only):          Application Number: LONS 79-016
SECTION IV: PROJECT INFORMATION	
<b>1. Project Name:</b>	Willow KRU Road Upgrades - 2026
<b>2. Proposed Start Date:</b>	5/15/2026
<b>3. Project Description:</b>	

Is activity discussed in the approved Plan of Development on file with the Division's Units Section?  Yes  No

Describe what and where:

ConocoPhillips, Alaska, Inc. (CPAI) requests authorization to upgrade sections of Kuparuk River Unit (KRU) roads between Station 49 (just south of the Oliktok causeway) and Drill Site 2P (DS-2P) by placing up to 94,900 cubic yards of clean gravel fill on top of and along the toe of existing KRU gravel roads. The new project footprint within the KRU is 8.2 acres. The purpose of this work is to widen select curves and narrow spots in the road system to allow for the safe transportation of the Willow Central Facility (WCF) modules for the Willow development project. These upgrades also include the extension or replacement of fifteen culverts within the KRU. Please see the attached project description, figures, and land ownership map for additional information.

**SECTION V: LAND STATUS**

**1. State Mineral Estate:**

Are supplemental pages for land status included in Appendix C?  Yes  No

Affected ADL: 025646 Date Effective: 7/1/2018 Date Assigned: 11/13/2018

Oil And Gas Lessee(s): CPAI

Surface Ownership: State of Alaska

Do you have, or anticipate having an Access Agreement:  Yes  No

Special Use Lands: None identified

Jointly Managed Lands: None identified

Other Considerations: None

Project Components	Meridian, Township, Range, And Section(s)	GPS Coordinates
Gravel	See lands location table in Project Description	See lands location table in Project Description
Replacement Culverts	See culvert location table in Project Description	See culvert location table in Project Description
N/A	N/A	N/A

**2. State of Alaska Surface Lands:**

Are supplemental pages for land status included in Appendix C?  Yes  No

Oil And Gas Mineral Estate Owner: N/A

Access Authorization(s): N/A

Special Use Lands: ADL 50666

Jointly Managed Lands: N/A

Other Considerations: N/A

Project Components	Meridian, Township, Range, And Section(s)	GPS Coordinates
N/A	N/A	N/A
N/A	N/A	N/A
N/A	N/A	N/A

**3. Private Lands:**

Are supplemental pages for land status included in Appendix C?  Yes  No

Oil And Gas Mineral Estate Owner: N/A

Surface Ownership And Access Agreement(s): N/A

Special Use Lands: N/A

Jointly Managed Lands: N/A

Other Considerations: N/A

Project Components	Meridian, Township, Range, And Section(s)	GPS Coordinates
N/A	N/A	N/A
N/A	N/A	N/A
N/A	N/A	N/A

**SECTION VI: SEQUENCE AND SCHEDULE OF OPERATIONS**

Project Milestone #	Project Milestone	Proposed Start Date	Proposed End Date
1.	Gravel Placement	5/15/2026	5/15/2027
2.	Culvert Replacement	5/15/2026	5/15/2027
3.	N/A	N/A	N/A
4.	N/A	N/A	N/A
5.	N/A	N/A	N/A
6.	N/A	N/A	N/A
7.	N/A	N/A	N/A
8.	N/A	N/A	N/A
9.	N/A	N/A	N/A
10.	N/A	N/A	N/A

**SECTION VII: PROJECTED USE REQUIREMENTS**

1. Describe the proposed operations, including the location and design, of **Well Sites**:

Click here to enter text.  
N/A

2. Describe the proposed operations, including the location and design, of **Buildings**:

N/A

3. Describe the proposed operations, including the location and design, of **Fuel and Hazardous Substances**:

N/A

4. Describe the proposed operations, including the location and design, of **Solid Waste Sites**:

N/A

5. Describe the proposed operations, including the location and design, of **Water Supplies**:

N/A

6. Describe the proposed operations, including the location and design, of **Utilities**:

N/A

7. Describe the proposed operations, including the location and design, of **Material Sites**:

N/A				
<b>8. Describe the proposed operations, including the location and design, of Roads:</b>				
CPAI proposes to place 94,900 cy of clean gravel fill into 8.2 acres of tundra wetlands to widen and thicken road segments from Station 49 to DS-2P to allow the safe transport of the Willow Central Facility modules for the Willow Development Project.				
<b>9. Describe the proposed operations, including the location and design, of Airstrips:</b>				
N/A				
<b>10. Describe the proposed operations, including the location and design, of All Other Facilities and Equipment:</b>				
15 culverts will be replaced or extended as part of the road upgrades. Final determination about extending four specific culverts, instead of replacing them, will be made in the field.				
<b>11. If another permit(s) is required for the above described Projected Use Requirements, provide the following information:</b>				
<b>Agency</b>	<b>Permit Type</b>	<b>Permit Number</b>	<b>Application Status</b>	<b>Projected Use Requirement(s)</b>
USACE	404 individual Permit Modification	POA-2018-00190-M6	Application Submitted	10
<b>SECTION VIII: REHABILITATION PLAN</b>				
<b>1. Proposed Level of Infrastructure, Facilities and Equipment Removal:</b>				
N/A				
<b>2. Description of Restoration and Rehabilitation Activities for Vegetation, Habitat, Impacted Wildlife, and Other Applicable Resources:</b>				
The amended application does not change the plans for rehabilitation upon abandonment outlined in the original authorization.				
<b>SECTION IX: OPERATING PROCEDURES DESIGNED TO MINIMIZE ADVERSE EFFECTS</b>				
Describe operating procedures designed to prevent or minimize adverse effects on other natural resources and other uses of the Unit area and adjacent areas including:				
Fish and Wildlife Habitats: CPAI has a Wildlife Avoidance Interaction Plan designed to prevent or minimize adverse effects on other natural resources.				
Historic and Archeological Sites: CPAI does not believe this would have any impacts to cultural resources since the area has been previously cleared from archeological and cultural clearance. No impacts are expected.				
Public Use Areas: This area is not open to the public.				
Other Uses: N/A				
<b>SECTION X: GLOSSARY OF TERMS</b>				
<b>Term #</b>	<b>Term</b>	<b>Term Definition</b>		
1.	CPAI	ConocoPhillips Alaska, Inc.		
2.	N/A	Not Applicable		
3.	TBD	To be determined		
4.	cy	Cubic Yards		
5.	Drillsite 2P	DS-2P		
<b>SECTION XI: CONFIDENTIALITY</b>				
The undersigned hereby requests that each page/section of this application <u>marked</u> confidential be held confidential under AS 38.05.035(a)(8).				
APPLICANT CONTACT:				
Sign here.	Enter Name.	Enter Title.	Enter Date.	

Signature	Name	Title	Date
-----------	------	-------	------

See the attached maps and figures.

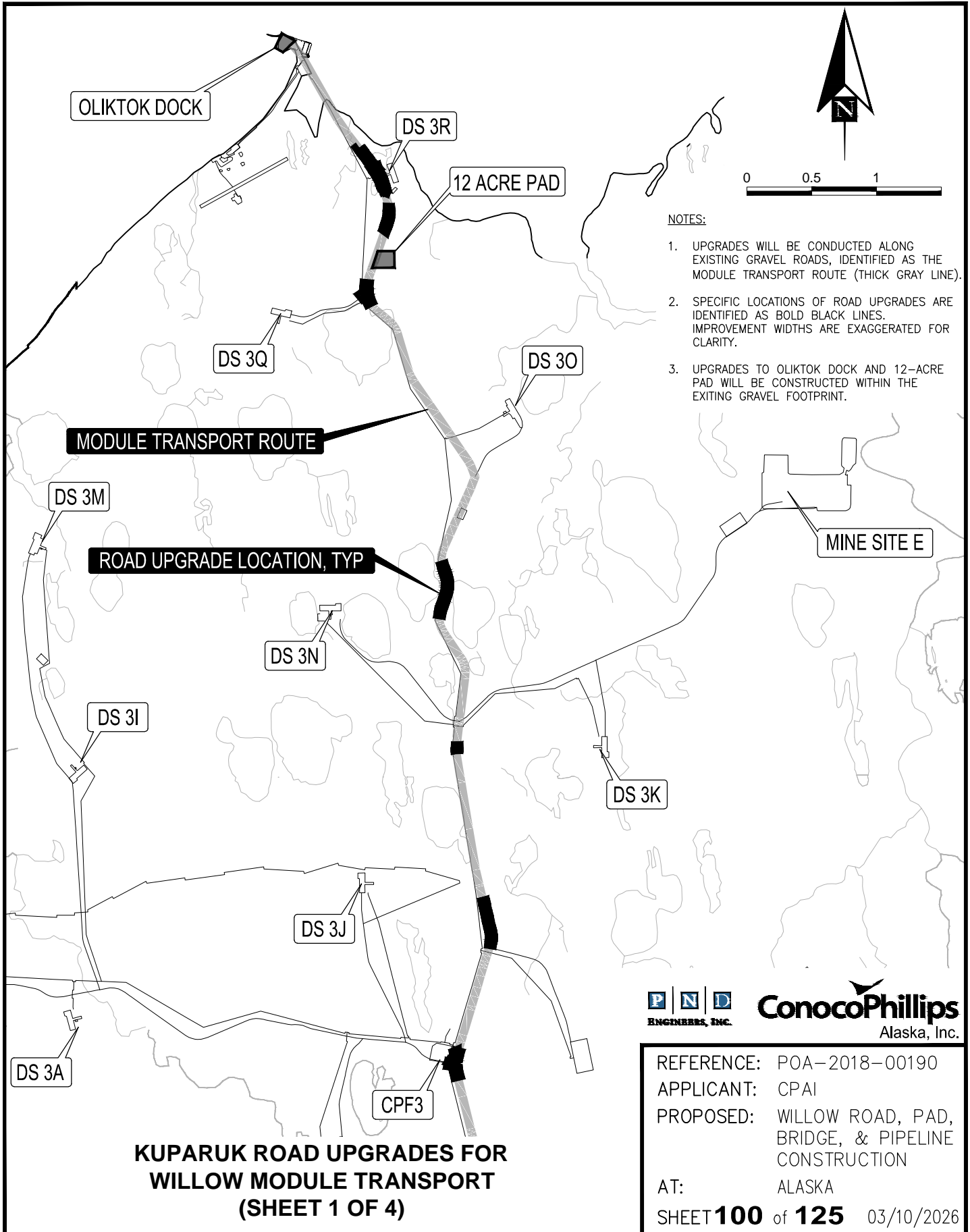

OLIKOTOK DOCK

DS 3R

12 ACRE PAD

DS 3Q

DS 30

**MODULE TRANSPORT ROUTE**

DS 3M

**ROAD UPGRADE LOCATION, TYP**

DS 3N

MINE SITE E

DS 3I

DS 3K

DS 3J

DS 3A

CPF3

**KUPARUK ROAD UPGRADES FOR  
WILLOW MODULE TRANSPORT  
(SHEET 1 OF 4)**



**NOTES:**

1. UPGRADES WILL BE CONDUCTED ALONG EXISTING GRAVEL ROADS, IDENTIFIED AS THE MODULE TRANSPORT ROUTE (THICK GRAY LINE).
2. SPECIFIC LOCATIONS OF ROAD UPGRADES ARE IDENTIFIED AS BOLD BLACK LINES. IMPROVEMENT WIDTHS ARE EXAGGERATED FOR CLARITY.
3. UPGRADES TO OLIKOTOK DOCK AND 12-ACRE PAD WILL BE CONSTRUCTED WITHIN THE EXISTING GRAVEL FOOTPRINT.



REFERENCE: POA-2018-00190  
 APPLICANT: CPAI  
 PROPOSED: WILLOW ROAD, PAD, BRIDGE, & PIPELINE CONSTRUCTION  
 AT: ALASKA  
 SHEET **100** of **125** 03/10/2026



**NOTES:**

- 1. UPGRADES WILL BE CONDUCTED ALONG EXISTING GRAVEL ROADS, IDENTIFIED AS THE MODULE TRANSPORT ROUTE (THICK GRAY LINE).
- 2. SPECIFIC LOCATIONS OF ROAD UPGRADES ARE IDENTIFIED AS BOLD BLACK LINES. IMPROVEMENT WIDTHS ARE EXAGGERATED FOR CLARITY.
- 3. UPGRADES TO OLIKTOK DOCK AND 12-ACRE PAD WILL BE CONSTRUCTED WITHIN THE EXISTING GRAVEL FOOTPRINT.

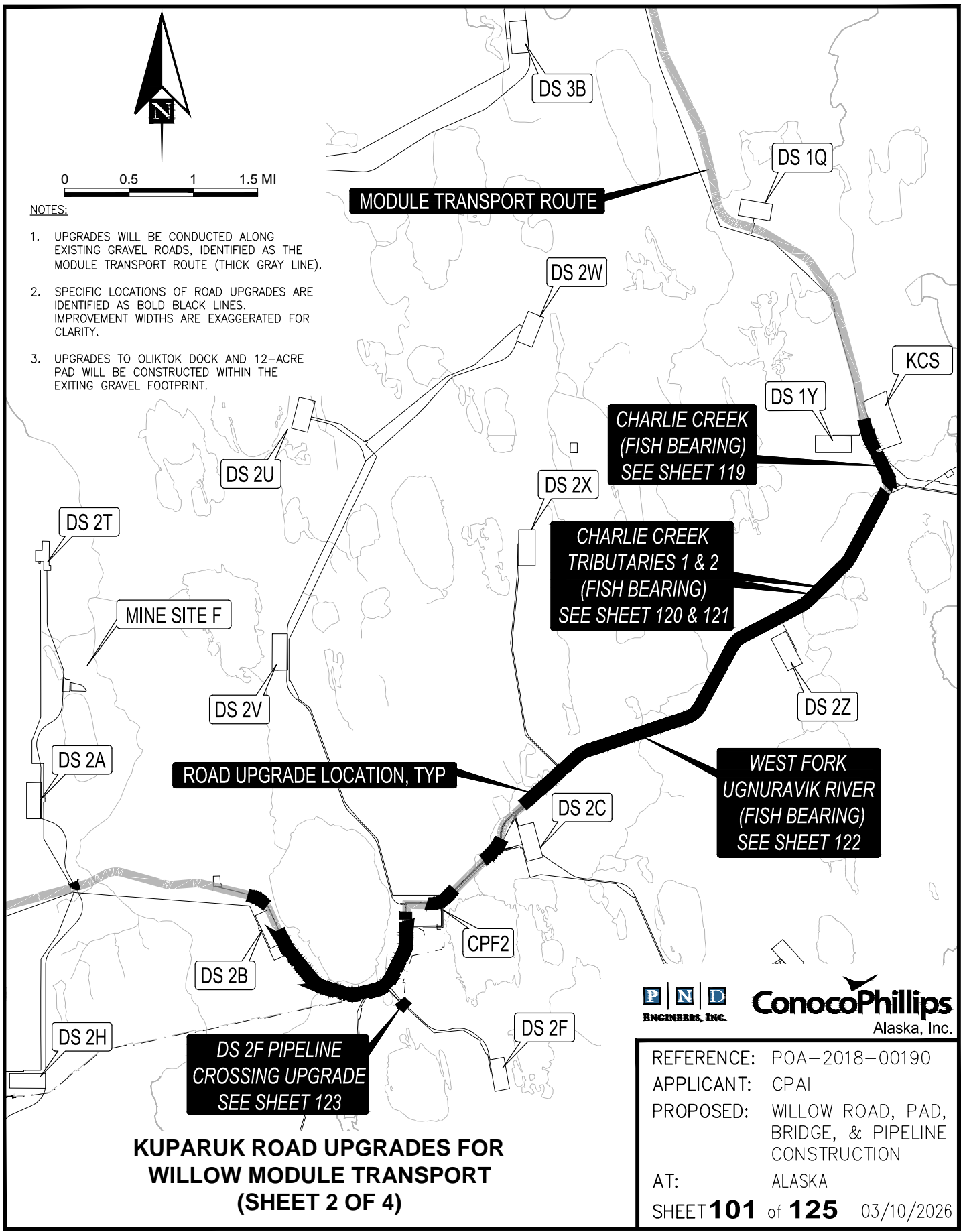

**ROAD UPGRADE LOCATION, TYP**

**DS 2F PIPELINE CROSSING UPGRADE  
SEE SHEET 123**

**KUPARUK ROAD UPGRADES FOR  
WILLOW MODULE TRANSPORT  
(SHEET 2 OF 4)**



REFERENCE: POA-2018-00190  
 APPLICANT: CPAI  
 PROPOSED: WILLOW ROAD, PAD, BRIDGE, & PIPELINE CONSTRUCTION  
 AT: ALASKA  
 SHEET **101** of **125** 03/10/2026



**NOTES:**

1. UPGRADES WILL BE CONDUCTED ALONG EXISTING GRAVEL ROADS, IDENTIFIED AS THE MODULE TRANSPORT ROUTE (THICK GRAY LINE).
2. SPECIFIC LOCATIONS OF ROAD UPGRADES ARE IDENTIFIED AS BOLD BLACK LINES. IMPROVEMENT WIDTHS ARE EXAGGERATED FOR CLARITY.
3. UPGRADES TO OLIKTOK DOCK AND 12-ACRE PAD WILL BE CONSTRUCTED WITHIN THE EXISTING GRAVEL FOOTPRINT.

**ROAD UPGRADE LOCATION, TYP**

DS 2M

**MODULE TRANSPORT ROUTE**

DS 2L

DS 2S



**KUPARUK ROAD UPGRADES FOR  
WILLOW MODULE TRANSPORT  
(SHEET 3 OF 4)**

REFERENCE: POA-2018-00190  
 APPLICANT: CPAI  
 PROPOSED: WILLOW ROAD, PAD,  
 BRIDGE, & PIPELINE  
 CONSTRUCTION  
 AT: ALASKA  
 SHEET **102** of **125** 03/10/2026



**NOTES:**

1. UPGRADES WILL BE CONDUCTED ALONG EXISTING GRAVEL ROADS, IDENTIFIED AS THE MODULE TRANSPORT ROUTE (THICK GRAY LINE).
2. SPECIFIC LOCATIONS OF ROAD UPGRADES ARE IDENTIFIED AS BOLD BLACK LINES. IMPROVEMENT WIDTHS ARE EXAGGERATED FOR CLARITY.
3. UPGRADES TO OLIKTOK DOCK AND 12-ACRE PAD WILL BE CONSTRUCTED WITHIN THE EXISTING GRAVEL FOOTPRINT.

**ROAD UPGRADE LOCATION, TYP**

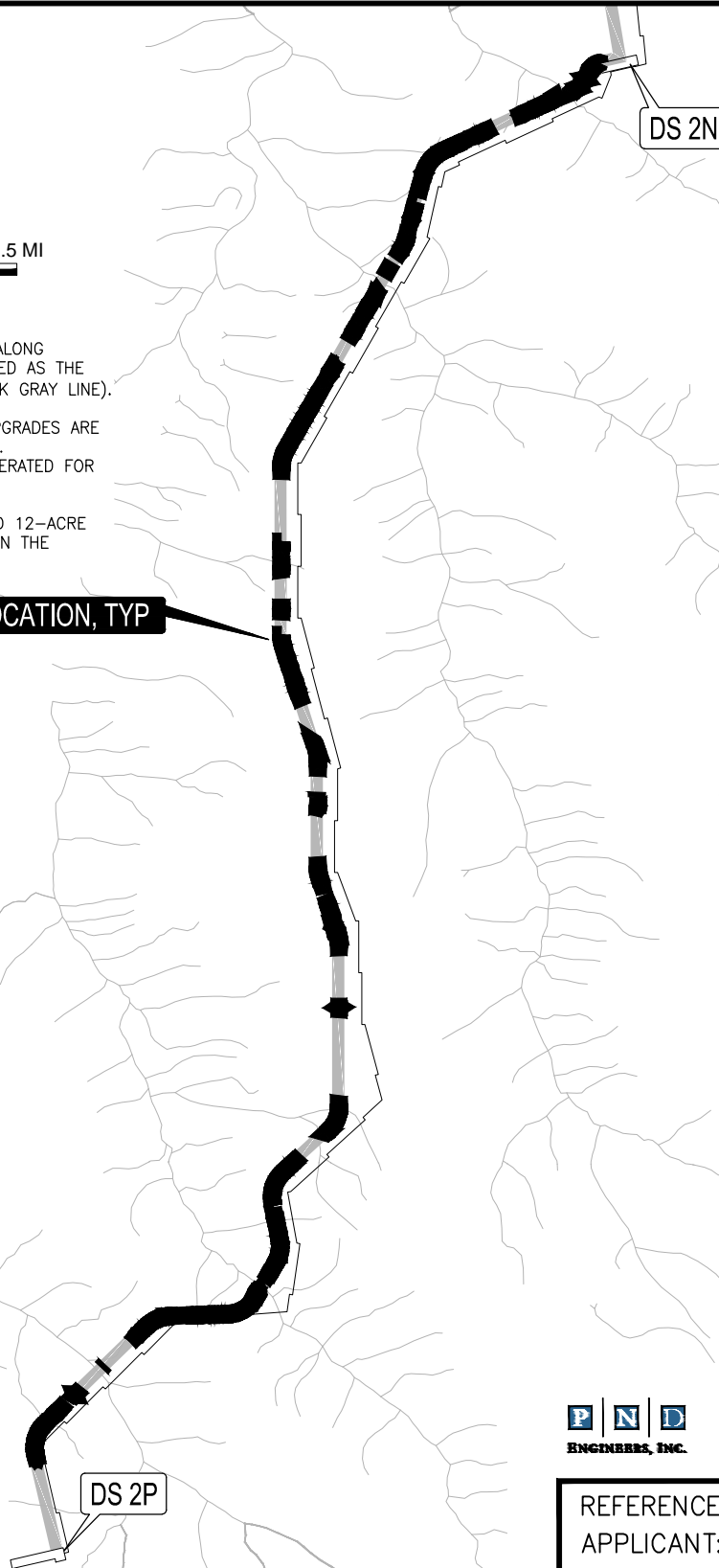

**KUPARUK ROAD UPGRADES FOR  
WILLOW MODULE TRANSPORT  
(SHEET 4 OF 4)**



REFERENCE: POA-2018-00190  
APPLICANT: CPAI  
PROPOSED: WILLOW ROAD, PAD,  
BRIDGE, & PIPELINE  
CONSTRUCTION  
AT: ALASKA  
SHEET **103** of **125** 03/10/2026

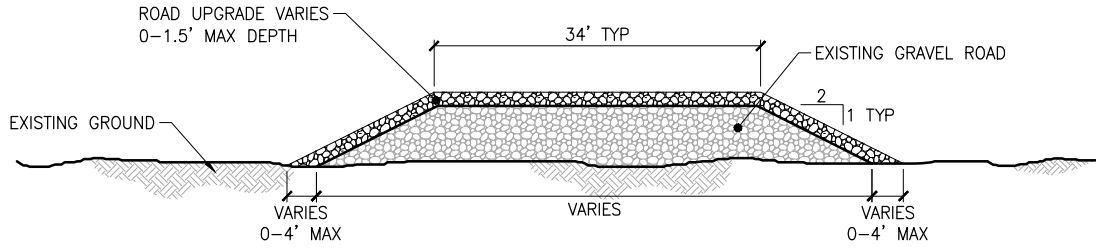

**VERTICAL CURVE ROAD UPGRADES - TYPICAL SECTION**

NOT TO SCALE

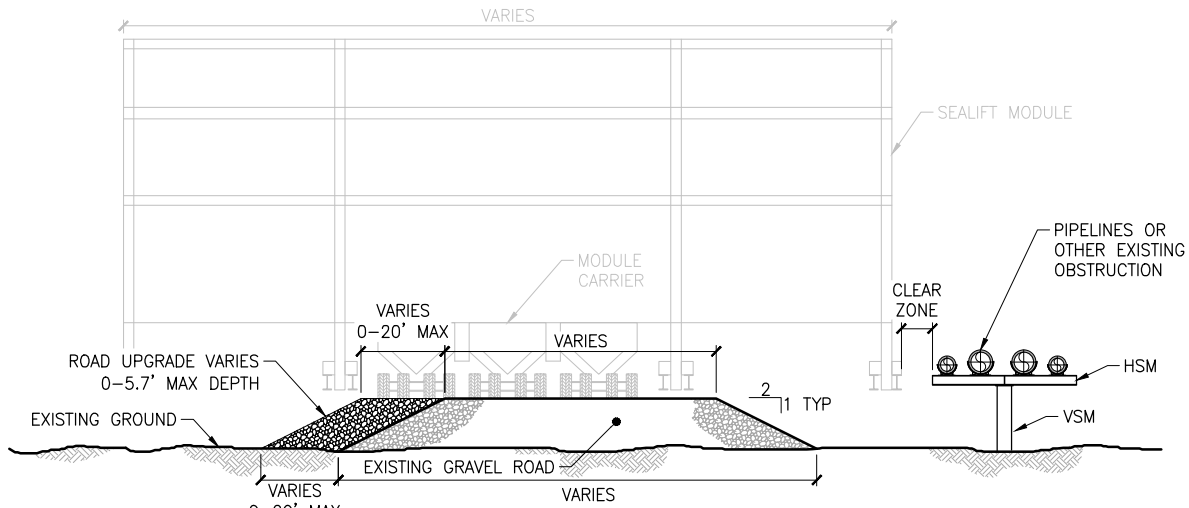

**ROAD UPGRADE TYPICAL SECTION**

NOT TO SCALE

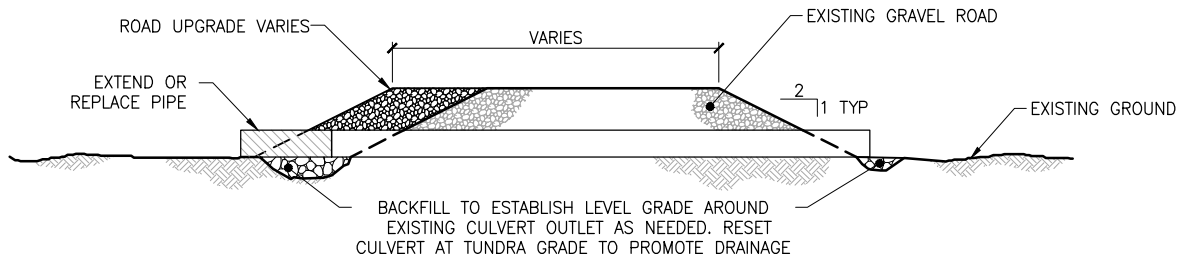

**CROSS DRAINAGE CULVERT EXTENSION TYPICAL SECTION**

NOT TO SCALE



**KUPARUK ROAD UPGRADES  
TYPICAL ROAD AND CROSS  
DRAINAGE CULVERT SECTIONS**

REFERENCE: POA-2018-00190  
 APPLICANT: CPAI  
 PROPOSED: WILLOW ROAD, PAD,  
 BRIDGE, & PIPELINE  
 CONSTRUCTION  
 AT: ALASKA  
 SHEET **118** of **125** 03/10/2026

CHARLIE CREEK QUANTITIES	
GRAVEL FOOTPRINT	415 SF, 0.010 AC
GRAVEL FILL	9 CY



**NOTES:**

1. STREAM EXTENTS ARE APPROXIMATE AND HAVE BEEN DEVELOPED FROM AERIAL IMAGERY. WATER SURFACE EXTENTS AND ELEVATIONS VARY SEASONALLY.
2. FISH BEARING STREAMS WERE IDENTIFIED PER, 'TECHNICAL REPORT NO. 80-01, "A SURVEY OF STREAM CROSSING STRUCTURES IN THE NORTH SLOPE OILFIELDS," BY WILLIAM A. MORRIS AND JACK F. WINTERS. DATED FEBRUARY 2008. ALASKA DEPARTMENT OF NATURAL RESOURCES OFFICE OF HABITAT MANAGEMENT AND PERMITTING.'

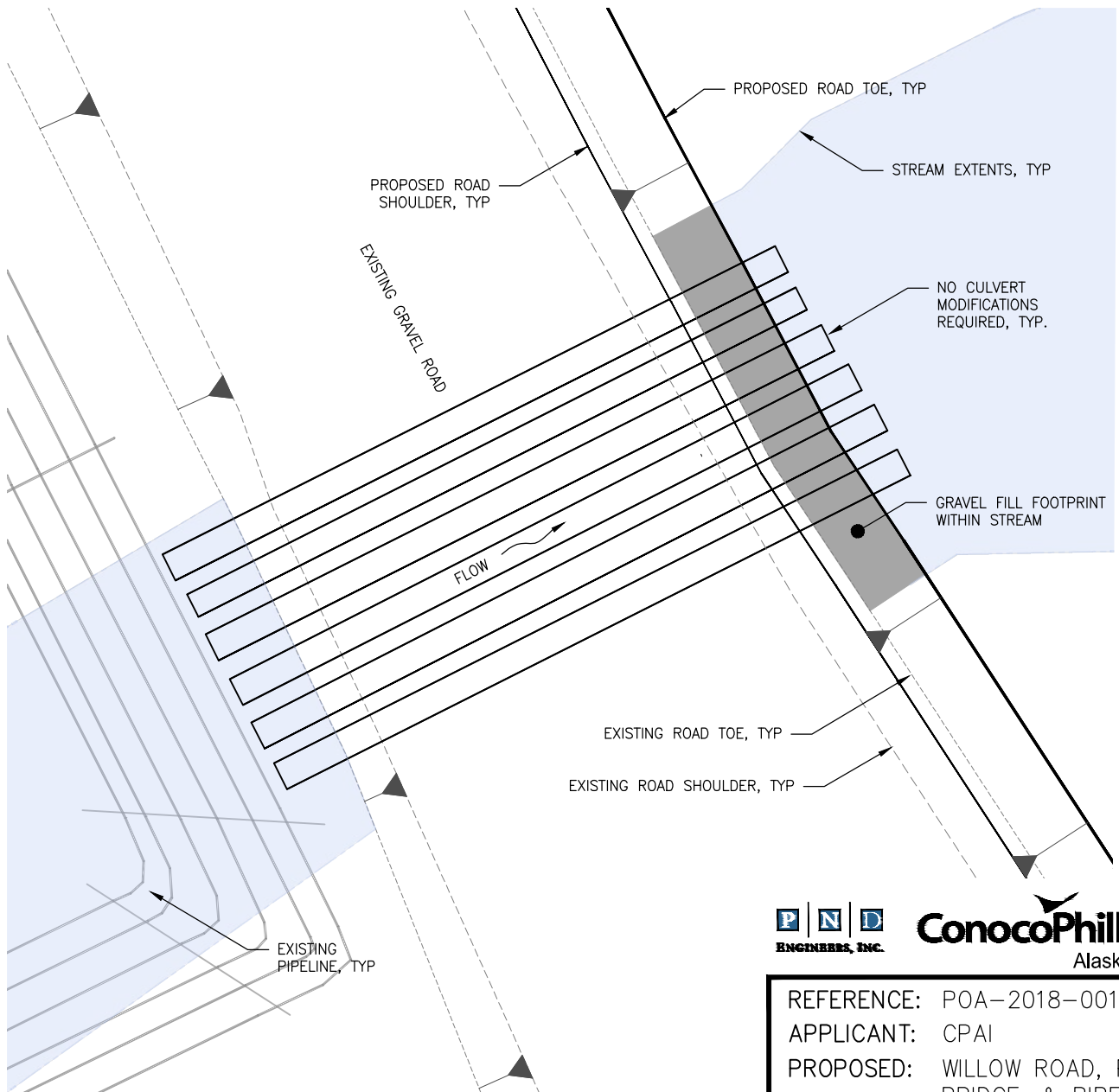

**KUPARUK ROAD UPGRADES  
CHARLIE CREEK CULVERT CROSSING  
PLAN VIEW**



REFERENCE: POA-2018-00190  
 APPLICANT: CPAI  
 PROPOSED: WILLOW ROAD, PAD, BRIDGE, & PIPELINE CONSTRUCTION  
 AT: ALASKA  
 SHEET **119** of **125** 03/10/2026

CHARLIE CREEK TRIBUTARY 1 QUANTITIES	
GRAVEL FOOTPRINT	147 SF, 0.003 AC
GRAVEL FILL	5 CY



**NOTES:**

1. STREAM EXTENTS ARE APPROXIMATE AND HAVE BEEN DEVELOPED FROM AERIAL IMAGERY. WATER SURFACE EXTENTS AND ELEVATIONS VARY SEASONALLY.
2. FISH BEARING STREAMS WERE IDENTIFIED PER, 'TECHNICAL REPORT NO. 80-01, "A SURVEY OF STREAM CROSSING STRUCTURES IN THE NORTH SLOPE OILFIELDS," BY WILLIAM A. MORRIS AND JACK F. WINTERS, DATED FEBRUARY 2008. ALASKA DEPARTMENT OF NATURAL RESOURCES OFFICE OF HABITAT MANAGEMENT AND PERMITTING.'

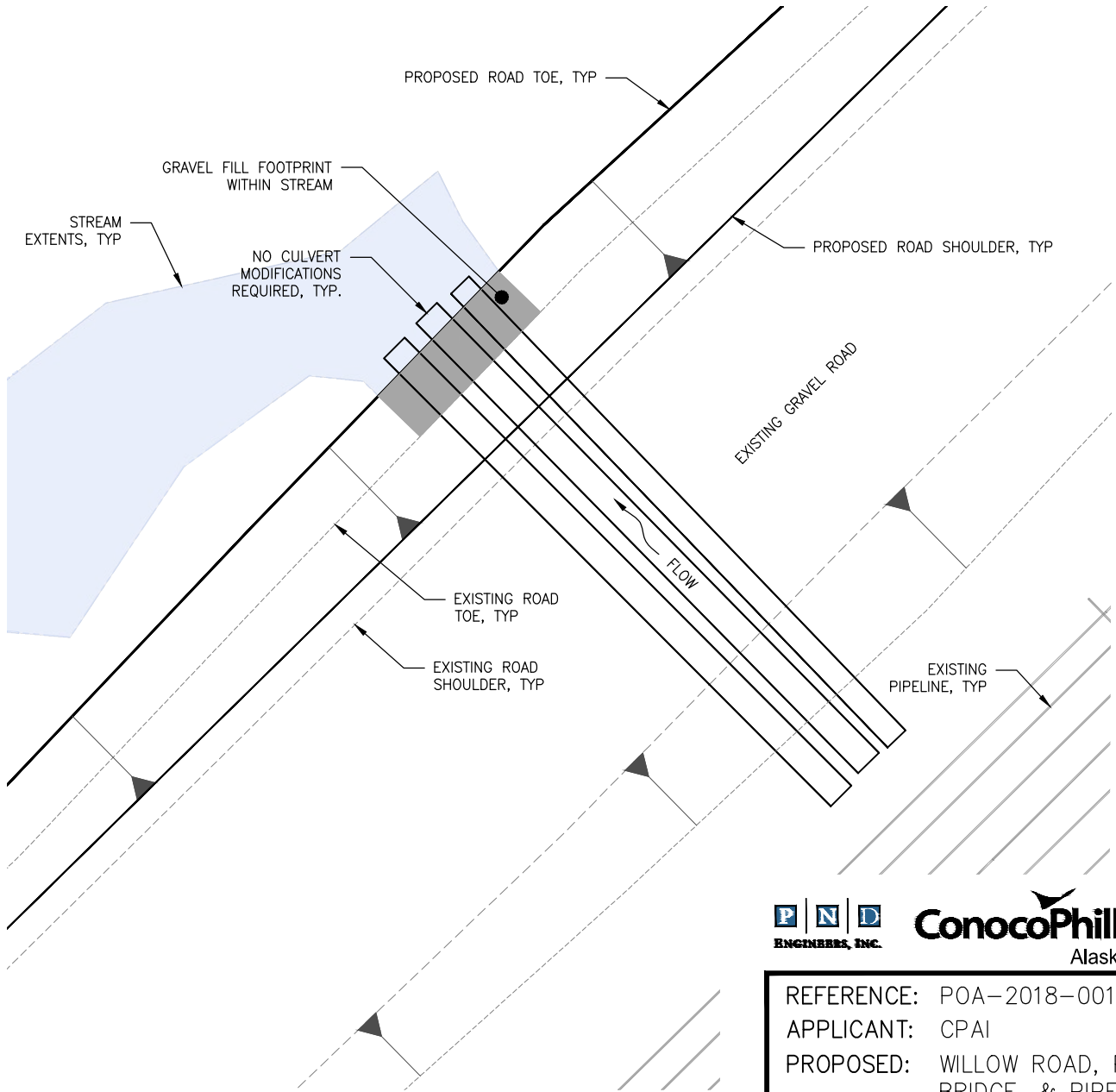

**KUPARUK ROAD UPGRADES  
CHARLIE CREEK TRIBUTARY 1 CULVERT CROSSING  
PLAN VIEW**

REFERENCE: POA-2018-00190  
 APPLICANT: CPAI  
 PROPOSED: WILLOW ROAD, PAD,  
 BRIDGE, & PIPELINE  
 CONSTRUCTION  
 AT: ALASKA  
 SHEET **120** of **125** 03/10/2026

CHARLIE CREEK TRIBUTARY 2 QUANTITIES	
GRAVEL FOOTPRINT	162 SF, 0.004 AC
GRAVEL FILL	3 CY



**NOTES:**

1. STREAM EXTENTS ARE APPROXIMATE AND HAVE BEEN DEVELOPED FROM AERIAL IMAGERY. WATER SURFACE EXTENTS AND ELEVATIONS VARY SEASONALLY.
2. FISH BEARING STREAMS WERE IDENTIFIED PER, 'TECHNICAL REPORT NO. 80-01, "A SURVEY OF STREAM CROSSING STRUCTURES IN THE NORTH SLOPE OILFIELDS," BY WILLIAM A. MORRIS AND JACK F. WINTERS, DATED FEBRUARY 2008, ALASKA DEPARTMENT OF NATURAL RESOURCES OFFICE OF HABITAT MANAGEMENT AND PERMITTING.'

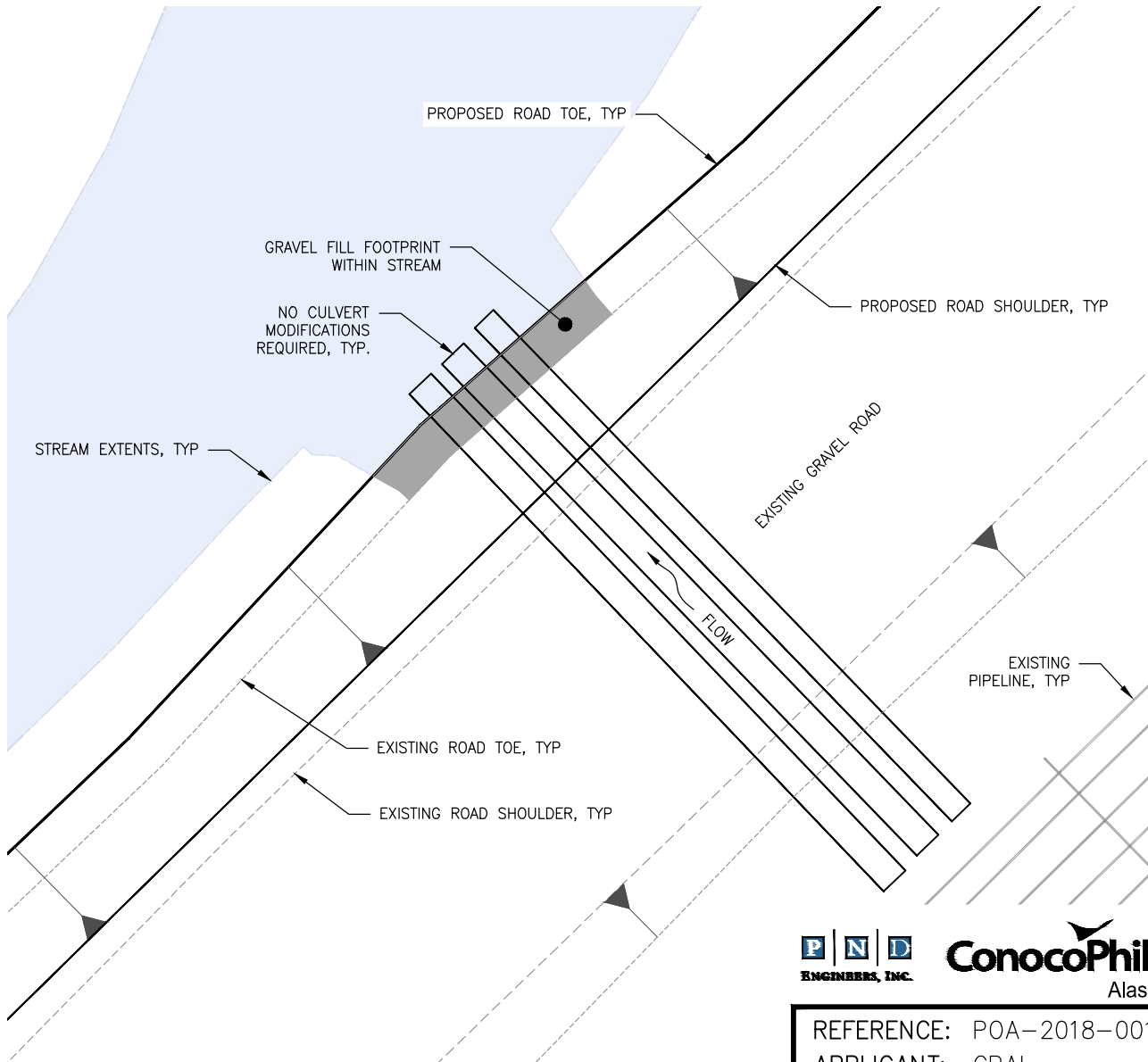

**KUPARUK ROAD UPGRADES  
CHARLIE CREEK TRIBUTARY 2 CULVERT CROSSING  
PLAN VIEW**



REFERENCE: POA-2018-00190  
 APPLICANT: CPAI  
 PROPOSED: WILLOW ROAD, PAD, BRIDGE, & PIPELINE CONSTRUCTION  
 AT: ALASKA  
 SHEET **121** of **125** 03/10/2026

WEST FORK UGNURAVIK RIVER QUANTITIES	
GRAVEL FOOTPRINT	326 SF, 0.008 AC
GRAVEL FILL	16 CY

**NOTES:**

1. STREAM EXTENTS ARE APPROXIMATE AND HAVE BEEN DEVELOPED FROM AERIAL IMAGERY. WATER SURFACE EXTENTS AND ELEVATIONS VARY SEASONALLY.
2. FISH BEARING STREAMS WERE IDENTIFIED PER, 'TECHNICAL REPORT NO. 80-01, "A SURVEY OF STREAM CROSSING STRUCTURES IN THE NORTH SLOPE OILFIELDS," BY WILLIAM A. MORRIS AND JACK F. WINTERS, DATED FEBRUARY 2008. ALASKA DEPARTMENT OF NATURAL RESOURCES OFFICE OF HABITAT MANAGEMENT AND PERMITTING.'

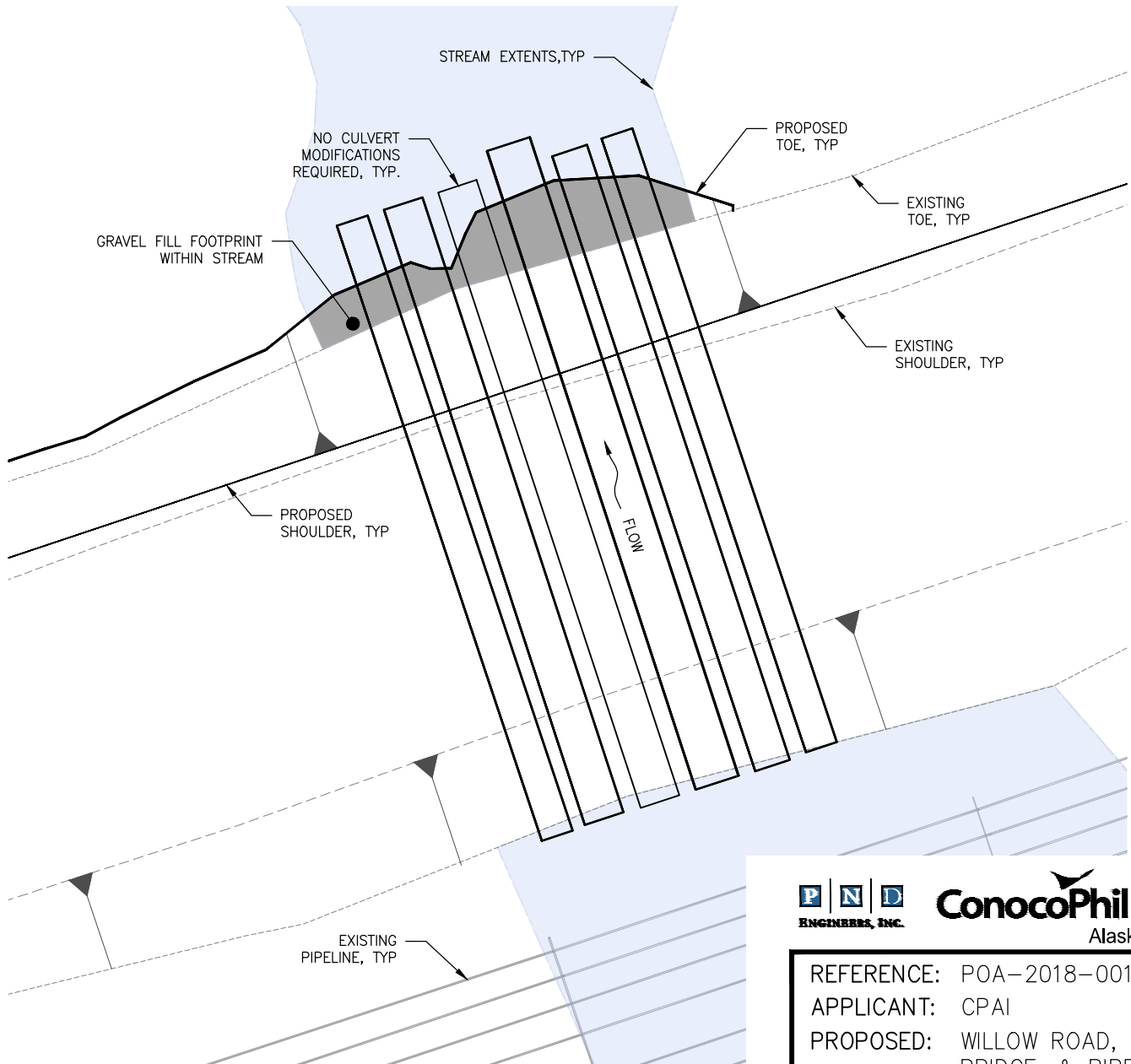
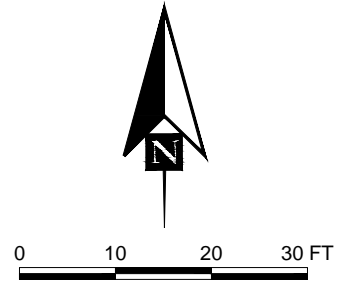

**KUPARUK ROAD UPGRADES  
WEST FORK UGNURAVIK RIVER CULVERT CROSSING  
PLAN VIEW**



REFERENCE: POA-2018-00190  
 APPLICANT: CPAI  
 PROPOSED: WILLOW ROAD, PAD,  
 BRIDGE, & PIPELINE  
 CONSTRUCTION  
 AT: ALASKA  
 SHEET **122** of **125** 03/10/2026

# LONS 79-016 Amendment Request

## Land Ownership

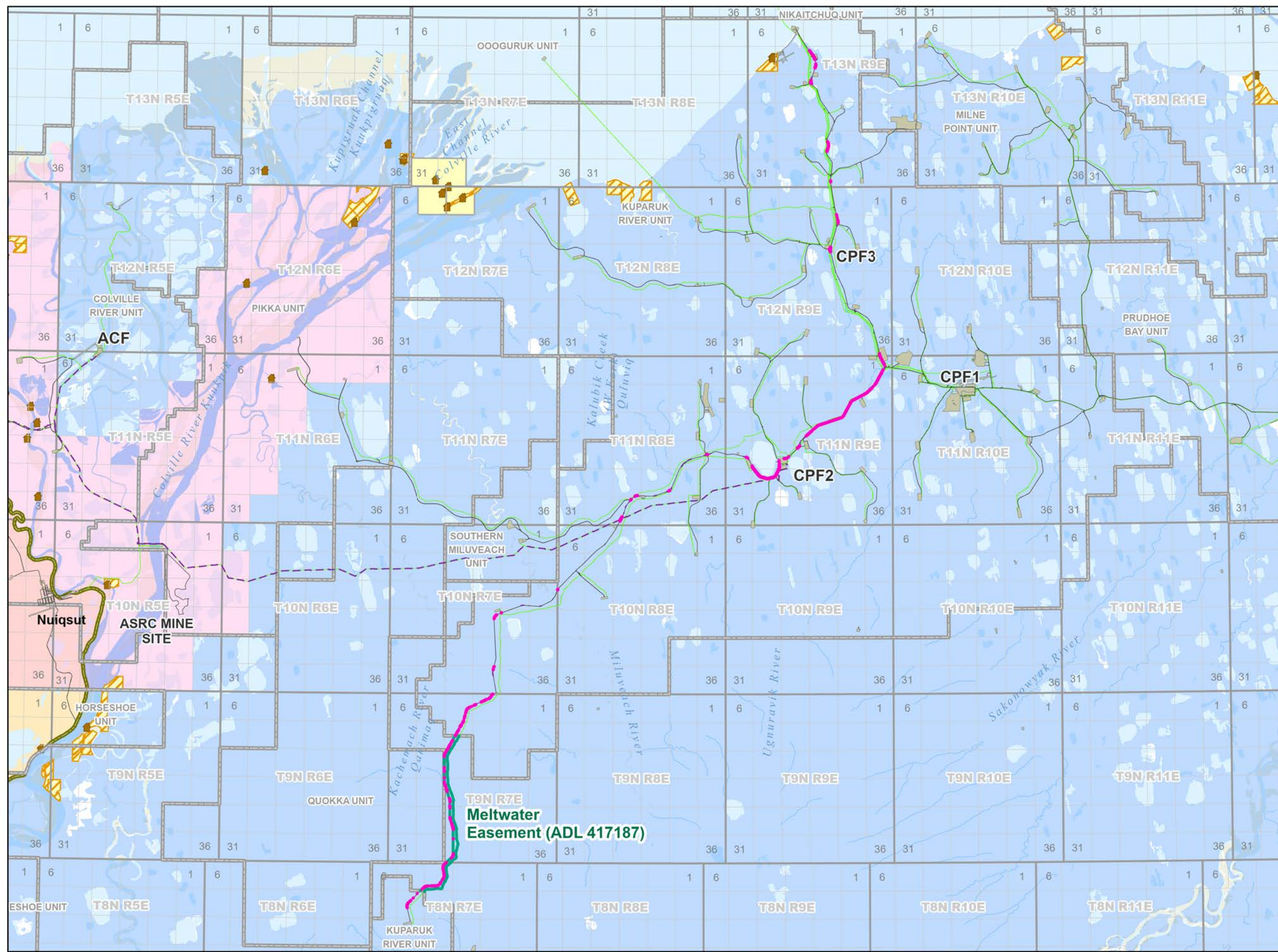

- Kuparuk Road Upgrades**
- Proposed Gravel Footprint
- Easement**
- Meltwater Easement (ADL 417187)
- Land Status**
- Cabin or Platform
  - State of Alaska Land - ADNR
  - Native Patented or IC
  - Native Allotment
  - Private Property
  - BLM (NPR-A)
- Willow Development**
- Pipeline
- Infrastructure**
- Pipeline
  - Road
  - Pad
- Boundaries**
- Oil and Gas Unit



N

0 2 4 Miles

**ConocoPhillips**  
Alaska

February 24, 2026

Layout: KRU\_Road\_Improvements\_12Ac\_2P\_LONS  
Project: KRU\_Road\_improvements\_12Ac\_2P\_LONS.aprx

**APPENDIX B: MITIGATION MEASURES**

No new exceptions are requested.

**APPENDIX B: MITIGATION MEASURES**

No new exceptions are requested.

**APPENDIX C: OTHER**

See Project Description

Additional permits required for the above Project Use Requirements:

Agency	Permit Type	Permit Number	Application Status	Projected Use Requirement(s)
North Slope Borough	Certificate of Traditional Land Use Inventory Clearance	Pending	Preparing	10
North Slope Borough	Land Management Regulations (LMR) Permit	Pending	Preparing	10
ADFG	Fish Habitat Permit Amendment	FH17-III-0167-A1	Preparing	10

DOG	Easement Renewal and Amendment	ADL 417187	Application Submitted	10



## **2026 Willow KRU Road Upgrades Willow Module Transport**

### **KRU Project Description**

ConocoPhillips Alaska, Inc. (CPAI) requests authorization to upgrade sections of Kuparuk River Unit (KRU) roads under LONS 79-016 and Meltwater Easement (ADL 417187) between Station 49 (just south of the Oliktok causeway) and Drill Site 2P (DS2P). Separate requests for authorization will be submitted for the portion of work that is proposed to occur under a LONS Amendment and the Meltwater Easement, however the entirety of the project information is included here for clarity. The proposed work is scheduled to begin May 15, 2026, or as soon as the required permits are received.

On May 3, 2023, the Division of Oil and Gas (DOG) approved an amendment to LONS 79-016 for KRU Road Upgrades between 12-Acre Pad and Drill Site 2L (DS-2L) to place approximately 47,000 cubic yards (cy) of clean gravel on top of and along the toe of existing KRU roads, with a project footprint of approximately 5.0 acres and to replace or extend several existing culverts.

A portion of the approved road upgrades were completed in support of the Willow Operation Center (WOC) module transport, and the remaining permitted upgrades are anticipated to be completed in Summer 2026. However, additional road upgrades are required for the safe transportation of the larger and heavier Willow Central Facility (WCF) modules, which are scheduled for delivery Summer 2027.

Upcoming construction activities, permitted and proposed, include:

- Continued installation of up to 108,400 cy of clean gravel fill to widen road curves and other narrow road areas (94,900 within KRU and 13,500 within the Meltwater Easement), with a project footprint of approximately 9.8 acres (8.2 within the KRU and 1.6 within the Meltwater Easement)
- Replacement or extension of 26 culverts, and installation of associated shoulder/culvert markers and barrier rails (15 in the KRU, 11 in the Meltwater Easement)
- Placement of gravel below the Ordinary High Water mark at four waterbodies
  - Charlie Creek
  - Charlie Creek Tributary 1
  - Charlie Creek Tributary 2,
  - West Fork of the Ugnuravik River

CPAI holds Alaska Department of Fish and Game (ADF&G) Fish Habitat Permits for construction activities at Charlie Creek, Charlie Creek Tributary 1, Charlie Creek Tributary 2 (also approved by May 3, 2023, LONS 79-016 Unit Plan of Operations Amendment Decision) and is requesting DOG, ADF&G, and US Army Corps of Engineers approval for the West Fork of the Ugnuravik River. See

the attached figures and Tables 1 and 2 below for additional details and location information. Tables 3 and 4 below contain information about the project's footprint and gravel fill volume and the changes from the previous authorization.

All work will be completed from existing gravel pads or roads. Gravel will be sourced from Mine Sites C and E, or other permitted sources if required, and no mine site expansions are needed for this work. The project will utilize the nearest available gravel source to reduce driving distances and vehicle traffic. Most of the gravel used for road upgrades has been or will be added on top of the existing gravel road. CPAI will utilize typical road construction equipment including gravel-hauling trucks, road graders, excavators, dozers, and compactors.

**Table 1. Location Information for KRU Road Upgrades**

<b>MTR</b>	<b>Sections</b>	<b>Unit/Easement</b>	<b>Latitude &amp; Longitude</b>
U008N007E	4-5,8	Kuparuk River Unit and ADL 417187	70.071558381073757, -150.4212618576892
U009N007E	3-4,9,16,21,28,33	Kuparuk River Unit and ADL 417187	70.106251278629315, -150.3873995458077 & 70.141063753288876, -150.393157003867
U010N007E	22-23,34	Kuparuk River Unit	70.2098388177228, -150.32161328799157
U010N008E	18	Kuparuk River Unit	70.2237252379061, -150.227018385652
U011N008E	24,26-28,33	Kuparuk River Unit	70.2718247712954, -150.1094231523741
U011N009E	1,11-12,14-16, 19-21,29	Kuparuk River Unit	70.28090294765195, -149.907113916369 & 70.31933672696826, -149.7835855789913
U012N009E	2,11,15,36	Kuparuk River Unit	70.398159364234488, -149.81431165185475 & 70.412780770106238, -149.8018487766853
U013N009E	9,16,28,33	Kuparuk River Unit	70.4506187411713, -149.815923509677 & 70.492837228940047, -149.83479720707

**Table 2. Culvert Location Information for KRU Road Upgrades**

<b>CP Culvert Number</b>	<b>Latitude</b>	<b>Longitude</b>	<b>MTRS</b>	<b>KRU or Easement</b>	<b>Potential Extension</b>
CU-157	70° 26' 58.72"N	149° 49' 01.63"W	U013N009E28	Kuparuk River Unit	yes
CU-151	70° 25' 12.45"N	149° 48' 25.25"W	U012N009E03	Kuparuk River Unit	
CU-150	70° 24' 58.14"N	149° 48' 15.72"W	U012N009E02	Kuparuk River Unit	
CU-95	70° 19' 13.63"N	149° 46' 50.00"W	U011N009E11	Kuparuk River Unit	
CU-93	70° 18' 40.00"N	149° 48' 10.43"W	U011N009E15	Kuparuk River Unit	yes
CU-86	70° 18' 26.85"N	149° 50' 02.67"W	U011N009E15	Kuparuk River Unit	
CU-255	70° 10' 07.73"N	150° 19' 37.76"W	U009N007E03	Kuparuk River Unit	yes
CU-254	70° 10' 00.99"N	150° 20' 10.23"W	U009N007E03	Kuparuk River Unit	
CU-253	70° 09' 52.87"N	150° 21' 01.17"W	U009N007E03	Kuparuk River Unit	
CU-250	70° 09' 46.41"N	150° 21' 40.54"W	U009N007E04	Kuparuk River Unit	
CU-249	70° 09' 43.92"N	150° 21' 47.66"W	U009N007E04	Kuparuk River Unit	
CU-248	70° 09' 41.00"N	150° 21' 51.46"W	U009N007E04	Kuparuk River Unit	yes
CU-245	70° 09' 22.41"N	150° 22' 06.10"W	U009N007E04	Kuparuk River Unit	
CU-241	70° 08' 39.27"N	150° 23' 17.12"W	U009N007E09	Meltwater Easement	
CU-238	70° 08' 32.14"N	150° 23' 28.97"W	U009N007E09	Meltwater Easement	
CU-233	70° 07' 16.61"N	150° 23' 36.07"W	U009N007E21	Meltwater Easement	
CU-225	70° 05' 45.11"N	150° 22' 57.83"W	U009N007E33	Meltwater Easement	
CU-221	70° 05' 14.63"N	150° 22' 58.35"W	U009N007E33	Meltwater Easement	
CU-218	70° 04' 53.52"N	150° 23' 51.80"W	U008N007E04	Meltwater Easement	
CU-216	70° 04' 38.42"N	150° 23' 45.47"W	U008N007E04	Meltwater Easement	

CP Culvert Number	Latitude	Longitude	MTRS	KRU or Easement	Potential Extension
CU-215	70° 04' 34.08"N	150° 23' 47.42"W	U008N007E04	Meltwater Easement	yes
CU-214	70° 04' 18.74"N	150° 24' 24.19"W	U008N007E04	Meltwater Easement	
CU-213	70° 04' 17.69"N	150° 25' 20.69"W	U008N007E04	Meltwater Easement	
CU-212	70° 04' 14.75"N	150° 25' 35.85"W	U008N007E05	Meltwater Easement	
CU-209	70° 03' 49.96"N	150° 26' 50.58"W	U008N007E08	Kuparuk River Unit	
CU-207	70° 03' 42.48"N	150° 27' 06.76"W	U008N007E08	Kuparuk River Unit	

Table 3. Project Footprint and Gravel Fill Volumes

KRU or Easement	Gravel Volume (cy)	Project Footprint (acres)	Impact to Tundra (acres)
KRU	94,900	8.2	5.4
Meltwater Easement	13,500	1.6	1.0

Table 4. Project Footprints and Gravel Fill Volumes by Authorization

KRU or Easement	2023 Approval	2026 Request	Project Scope Increase
KRU	5.0 acres	8.2 acres	3.2 acres
KRU	47,000 cy	94,900 cy	47,900
Meltwater Easement	n/a	1.6 acres	1.6 acres
Meltwater Easement	n/a	13,500 cy	13,500 cy

All activities will be conducted in accordance with federal, state, and local regulations, permit stipulations and general concurrence stipulations as appropriate. Minor site-specific variations are likely to occur due to field conditions

