

EV 3-369  
S012N003W Sections 29 and 32  
13940 Jarvi Drive and 14000 Jarvi Drive  
Anchorage, AK

Page 1 of 2

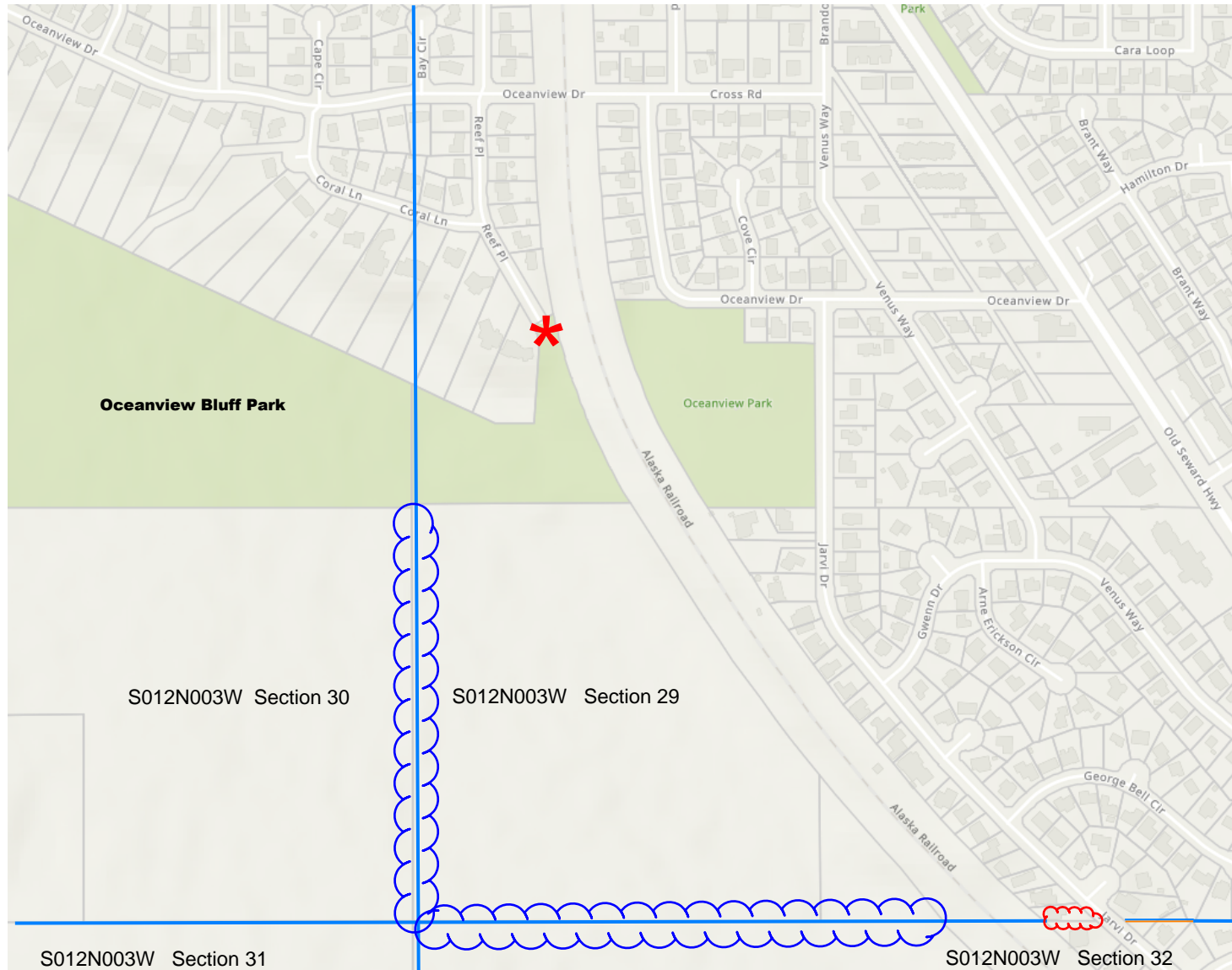

33' SLE proposed  
for vacation (66'  
total)



Section Line  
Easements



33' SLE  
previously  
vacated  
EV 2-629



Alternate Access  
Entry Point. Thru  
Oceanview Bluff  
Park to Section  
Line Easements  
specified in  
blue bubbles



EV 3-369  
S012N003W Sections 29 and 32  
13940 Jarvi Drive and 14000 Jarvi Drive  
Anchorage, AK

Page 2 of 2

 33' SLE Proposed for vacation (66' total)

 Alaska Railroad Easement

 Section Line Easement

 Previously Vacated SLE EV 2-629

