

ADDENDUM #3

Utqiagvik Courthouse Upgrades Bid Package PROJECT #UTQ-C-25-0015

Date: **September 11, 2025**

To All Plan Holders:

The following changes, additions, clarifications, and/or deletions are hereby made a part of the Contract Documents for the above noted project, fully and completely as if the same were fully contained therein. All other terms, conditions, and specifications of the original Invitation to Bid remain unchanged.

This amendment must be acknowledged in the space provided on the Bid Schedule.

The required date and time for Bid Submittal has not changed and remains Tuesday, September 23, 2025 at 12:00 PM.

The changes/clarifications directed by this Addendum #3 are described on this 1 (one) page.

Questions/Answers:

1. At the walk through there was a mock-up of the clerk's counter, on it a paint sample was present that is different than the current walls. What is the desired paint color? **Answer: paint color is Fuller O'Brien "It's A Cream" OW 134.**
2. The wall we are extending in the clerk's office is 5" thick overall. The drawings reference 5-1/2" metal studs plus sheetrock. (B4A-104) This is too thick and 5-1/2" metal studs are unusual. **Answer: To match existing wall thickness, use a 3 5/8" metal studs and (1) layer of 5/8" gypsum board on each side to achieve the 5" thick wall.**
3. Is there a room or space on the 2nd floor to store materials and work from? On the 1st floor would even work. **Answer: ACS does not currently have any extra storage space in the facility.**
4. A3/A-104 references 3/4" solid surface material. This item comes in 1/2" thicknesses, can we use additional plywood to make up the difference? **Answer: Yes, this is approved.**
5. Per onsite discussion, Putting the ballistic shielding on the front of the benches and overlay with matching wood panels? **Answer: Please bid per the drawings attached to the ITB.**
6. C1/A105 shows a dashed line. A1/A105 does not show a dashed line. The legend does not indicate what the dashed line is for. Please advise what the dashed line is for and if it should also be applied to A1/A105. **Answer: The dashed line indicates the location of the ballistic shielding installation. The drawing has been revised to show it applying to A1/A-105 (attached).**
7. There is only one wall type shown W01 pointing to a 1'7 1/2" extension at the COC waiting. B4/A-104 defines W01 as 5 1/2" metal stud. The wall that we need to connect to is 5". Can we use wood studs on this project so the walls plane out smooth? **Answer: The wall extensions should use 3 5/8" metal studs with 5/8" gypsum board on both sides to achieve the 5" thickness.**
8. Will the elevator be in-service and available for our use? **Answer: yes.**
9. 1/M501 Requesting welding details. **Answer: 3/16 Fillet weld 1" long on each angle leg.**

END OF ADDENDUM #3

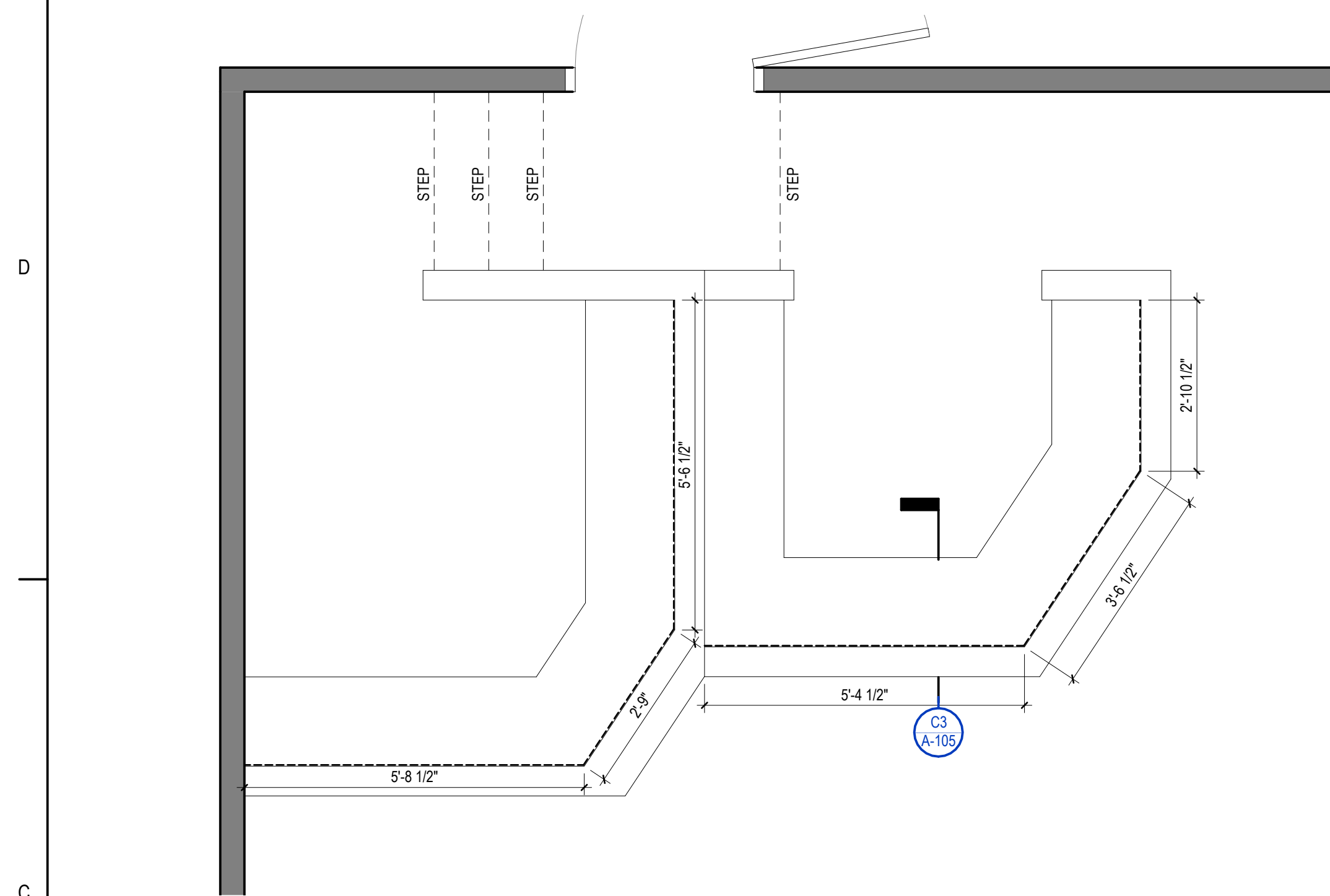

C1 ENLARGED PLAN - SUPERIOR COURT 201 JUDGE/CLERK BENCH

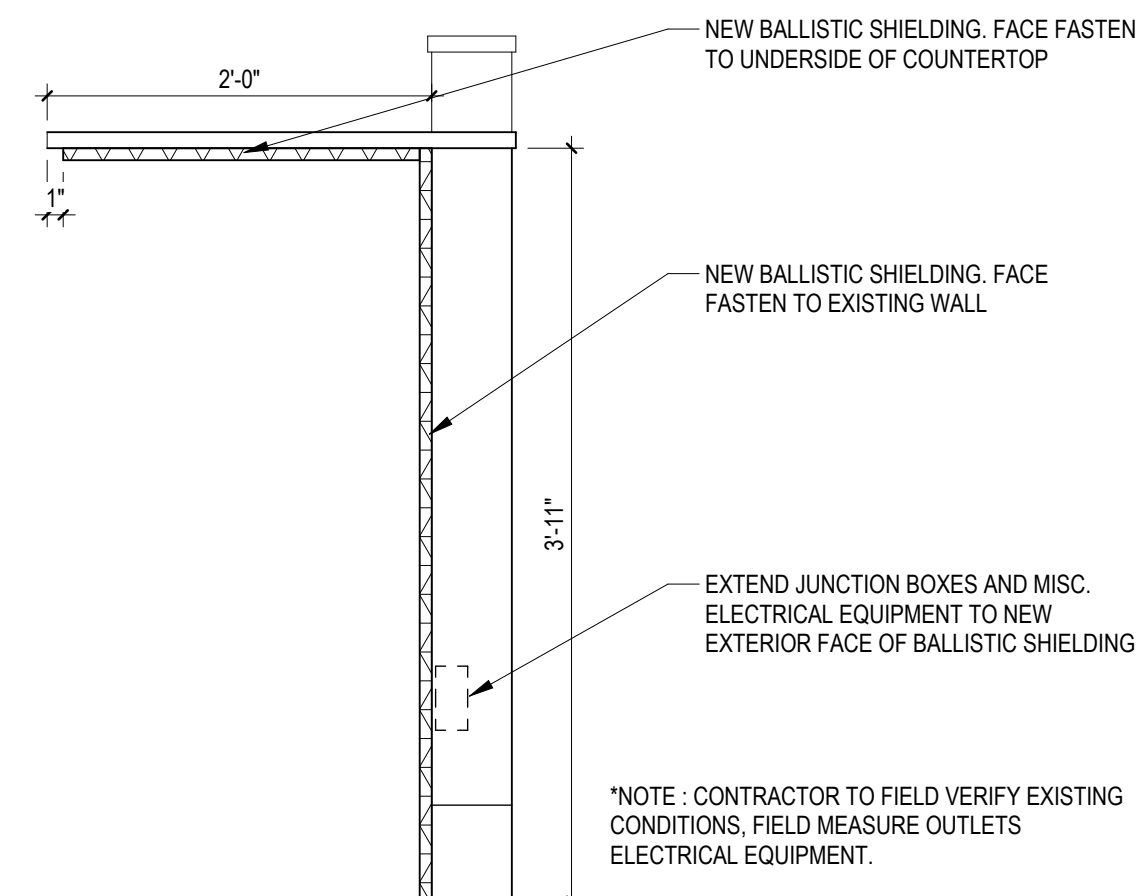

JUDGE BENCH SECTION

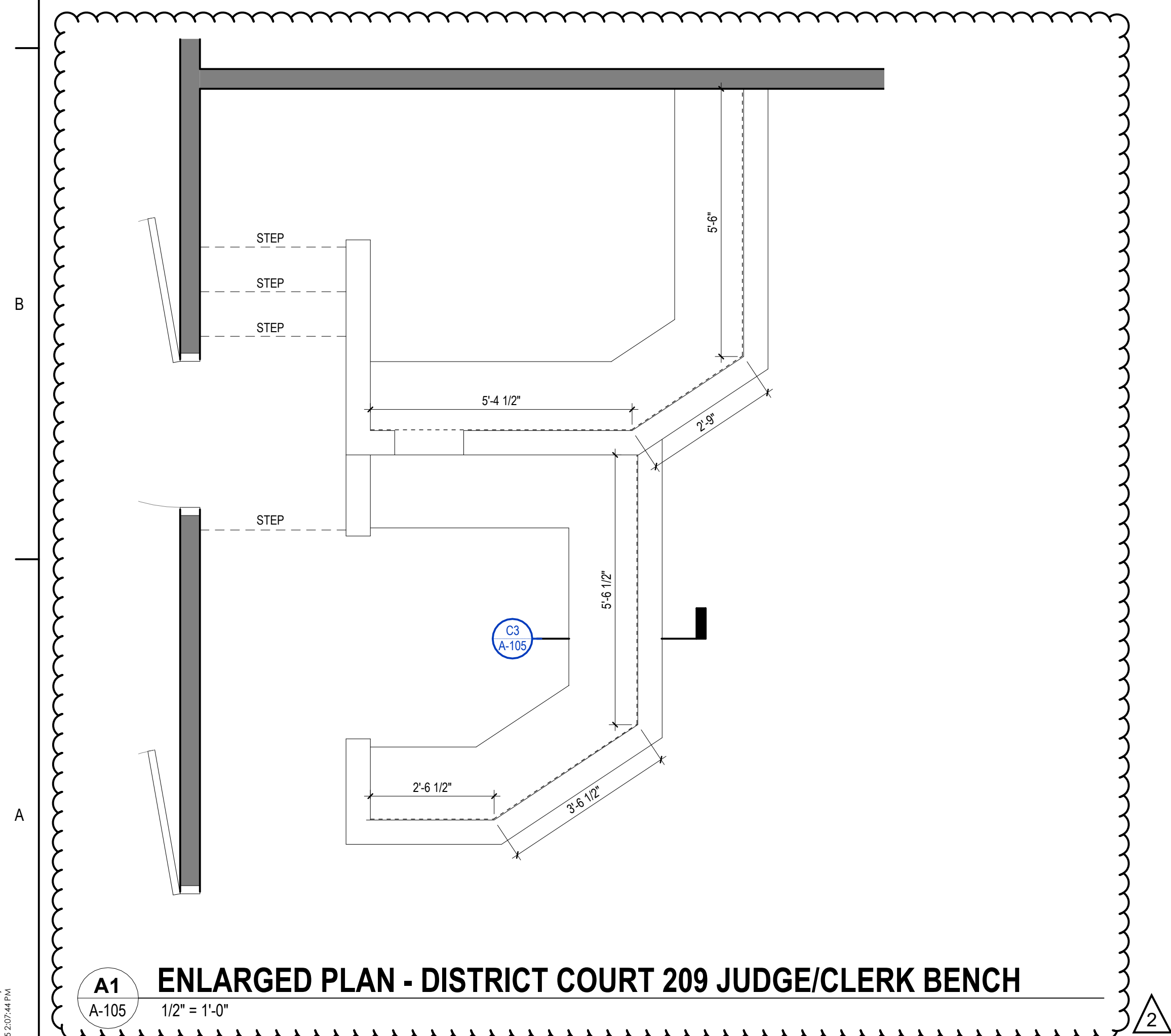
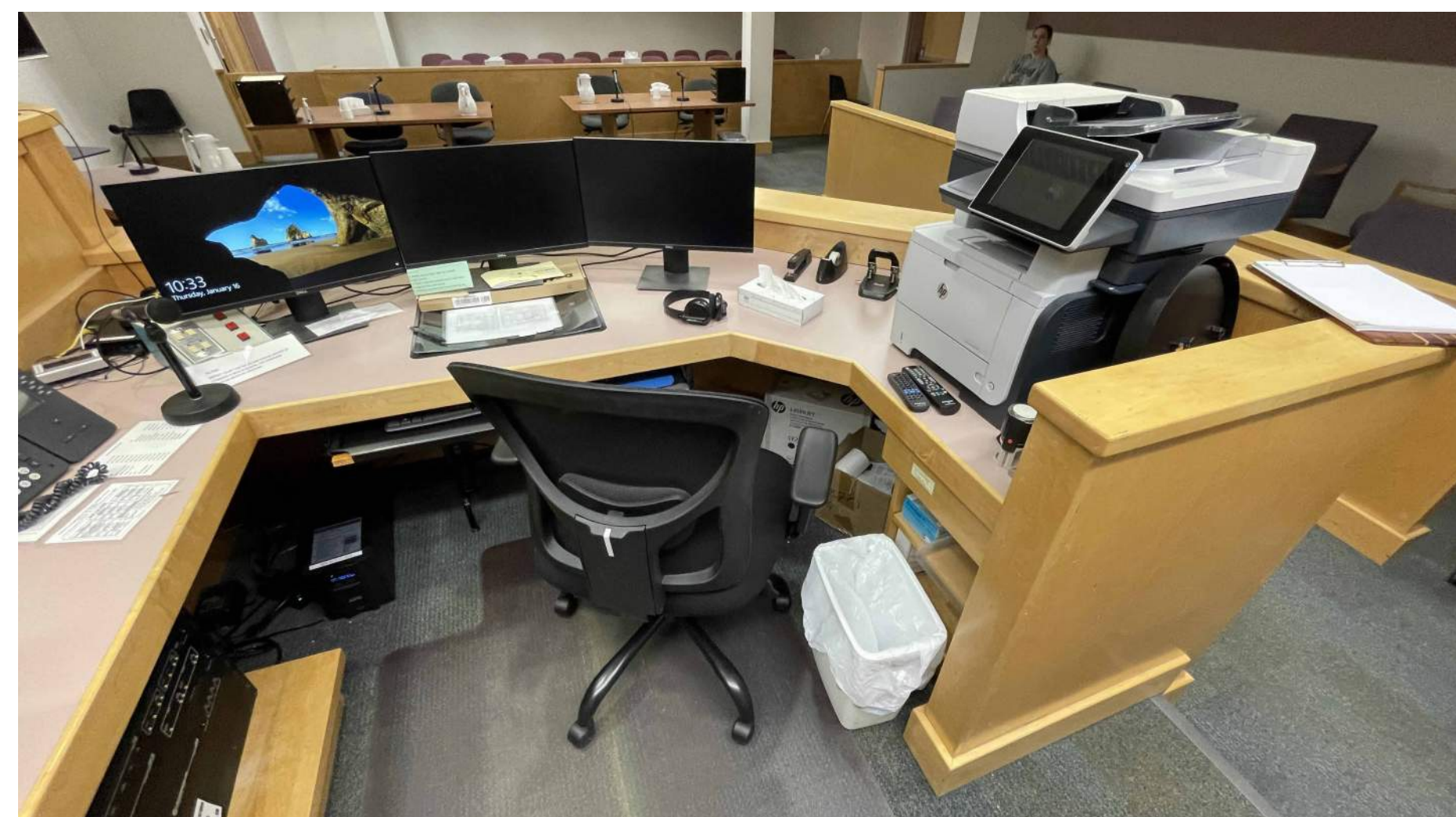

A1 **ENLARGED PLAN - DISTRICT COURT 209 JUDGE/CLERK BENCH**
A-105 1/2" = 1'-0"



GENERAL NOTES

THE PROVIDED IMAGES ILLUSTRATE THE EXISTING JUDGES' BENCHES AND THE EQUIPMENT STORED THERE. NO BALLISTIC SHIELDING IS CURRENTLY INSTALLED. BALLISTIC PROTECTION PANELS ARE TO BE ADDED BEHIND THE JUDGES' BENCHES IN BOTH COURTROOMS. PANELS SHALL BE DESIGNED AND FABRICATED TO MEET [XXX] AND INSTALLED WITH SECURE ANCHORAGE TO THE EXISTING BENCH STRUCTURE AND SUPPORTING FRAMEWORK. ENLARGED PLANS ARE FOR REFERENCE. CONTRACTOR MUST VERIFY IN FIELD DIMENSIONS AND COORDINATE WITH BENCH MANUFACTURERS WHAT IS REQUIRED TO ENSURE SEAMLESS INTEGRATION, PROPER ALIGNMENT, AND COMPLIANCE WITH LOCAL CODES.



Stantec Architecture Inc.

Anchorage, AK 99503-5938

Copyright Reserved

Consultant

[illegible]

Permit/Seal



ALASKA COURT SYSTEM

BARROW COURTHOUSE
CLERK COUNTER
REMODEL PERMIT
DOCUMENTS
1250 AGVIK STREET
UTQIAGVIK AK 99723

Project No.:2014341790

Title

COURT BENCHES ENLARGED PLANS AND DETAILS

Scale: As indicated

Revision: 1

Drawing No. _____

A-105