



LEASE PLAN OF OPERATIONS APPLICATION

State of Alaska

Department of Natural Resources, Division of Oil & Gas

550 W. 7th Ave, Suite 1100, Anchorage, AK 99501-3563

Phone: 907-269-8800 Fax: 907-269-8943

Permitting Email: dog.permitting@alaska.gov



SECTION I: APPLICANT INFORMATION

1. Applicant:

Name: Hilcorp Alaska, LLC

Mailing Address: 3800 Centerpoint Drive, Suite 1400

City: Anchorage

State: AK Zip Code: 99503

Phone: 907-777-8300 Fax: 907-777-8560

Email: Enter Email.

2. Applicant Contact:

First Name: Stetson Last Name: Sannes

Title: Environmental Specialist, Permitting

Is the Mailing Address the same as Applicant's Mailing Address? If ☐ Yes
"No", please provide information below:

Mailing Address: Enter Mailing Address.

City: Enter City. State: Enter State. Zip Code: Enter Zip Code.

Phone: 907-564-4665 Fax: Enter Fax.

Email: Stetson.sannes@hilcorp.com

SECTION II: THIRD PARTY INFORMATION

(Fill out this section only if you are applying for the Applicant)

Third Party Company Name: Enter 3rd Party Company Name.

First Name: Enter First Name. Last Name: Enter Last Name.

Title: Enter Title.

Mailing Address: Enter Mailing Address.

City: Enter City.

State: Enter State. Zip Code: Enter Zip Code.

Phone: Enter Phone. Fax: Enter Fax.

Email: Enter Email.

Describe the affiliation to the Applicant:

Describe your affiliation to the Applicant.

SECTION III: APPLICATION DATE AND NUMBER

(FOR OFFICE USE ONLY)

Application Date:

Application Number:

SECTION IV: PROJECT INFORMATION

1. Project Name: 2025 Happy Valley Middle Road and Pad Natural Gas Exploration

2. Proposed Start Date: 10/20/2025

3. Project Description:

Describe what and where:

Hilcorp Alaska, LLC (Hilcorp) requests authorization to construct a new gravel pad and road, drill two grassroots wells, and install associated infrastructure including gas flowlines, electrical instrumentation, line heaters, separators, compressors, communication tower, well cellars, and conductors as necessary. Wells

will be drilled from the new Happy Valley Middle Pad located on state land. Well installation will include installation of well cellar and conductor. Additionally, one water well will be drilled to support drilling operations.

SECTION V: LAND STATUS

1. State Mineral Estate:

Are supplemental pages for land status included in Appendix C?

☐ Yes

☐ No

Affected ADL: 394277

Date Effective: 7/9/2024

Date Assigned: 7/9/2024

Oil And Gas Lessee(s): State of Alaska

Surface Ownership: State of Alaska

Do you have, or anticipate having an Access Agreement: ☒ Yes

☐ No

Special Use Lands: N/A

Jointly Managed Lands: N/A

Other Considerations: N/A

Project Components	Meridian, Township, Range, And Section(s)	GPS Coordinates
Vegetation Clearing and Grubbing	03N 13W 7, Seward Meridian	59.931083, -151.569317
Gravel and Facilities Install	03N 13W 7, Seward Meridian	59.931083, -151.569317
Drilling Activities	03N 13W 7, Seward Meridian	59.931083, -151.569317

Affected ADL: 394278

Date Effective: 8/1/2024

Date Assigned: 8/1/2024

Oil And Gas Lessee(s): State of Alaska

Surface Ownership: State of Alaska

Do you have, or anticipate having an Access Agreement: ☐ Yes

☐ No

Special Use Lands: N/A

Jointly Managed Lands: N/A

Other Considerations: N/A

Project Components	Meridian, Township, Range, And Section(s)	GPS Coordinates
Vegetation Clearing and Grubbing	03N 13W 7, Seward Meridian	59.931083, -151.569317
Gravel and Facilities Install	03N 13W 7, Seward Meridian	59.931083, -151.569317
Drilling Activities	03N 13W 7, Seward Meridian	59.931083, -151.569317

Affected ADL: Enter ADL.

Date Effective: Enter Date.

Date Assigned: Enter Date.

Oil And Gas Lessee(s): Click here to enter text.

Surface Ownership: Click here to enter text.

Do you have, or anticipate having an Access Agreement: ☐ Yes

☐ No

Special Use Lands: Click here to enter text.

Jointly Managed Lands: Click here to enter text.

Other Considerations: Click here to enter text.

Project Components	Meridian, Township, Range, And Section(s)	GPS Coordinates
Click here to enter text.	Click here to enter text.	Click here to enter text.
Click here to enter text.	Click here to enter text.	Click here to enter text.
Click here to enter text.	Click here to enter text.	Click here to enter text.

Affected ADL: Enter ADL.

Date
Effective: Enter Date.

Date Assigned: Enter Date.

Oil And Gas Lessee(s): Click here to enter text.

Surface Ownership: Click here to enter text.

Do you have, or anticipate having an Access Agreement: ☐ Yes

☐ No

Special Use Lands: Click here to enter text.

Jointly Managed Lands: Click here to enter text.		
Other Considerations: Click here to enter text.		
Project Components	Meridian, Township, Range, And Section(s)	GPS Coordinates
Click here to enter text.	Click here to enter text.	Click here to enter text.
Click here to enter text.	Click here to enter text.	Click here to enter text.
Click here to enter text.	Click here to enter text.	Click here to enter text.
Affected ADL: Enter ADL. Date Effective: Enter Date. Date Assigned: Enter Date. Oil And Gas Lessee(s): Click here to enter text. Surface Ownership: Click here to enter text. Do you have, or anticipate having an Access Agreement: <input type="checkbox"/> Yes <input type="checkbox"/> No Special Use Lands: Click here to enter text. Jointly Managed Lands: Click here to enter text. Other Considerations: Click here to enter text.		
Project Components	Meridian, Township, Range, And Section(s)	GPS Coordinates
Click here to enter text.	Click here to enter text.	Click here to enter text.
Click here to enter text.	Click here to enter text.	Click here to enter text.
Click here to enter text.	Click here to enter text.	Click here to enter text.
2. State of Alaska Surface Lands:		
Are supplemental pages for land status included in Appendix C? <input type="checkbox"/> Yes <input type="checkbox"/> No		
Oil And Gas Mineral Estate Owner: Click here to enter text. Access Authorization(s): Click here to enter text. Special Use Lands: Click here to enter text. Jointly Managed Lands: Click here to enter text. Other Considerations: Click here to enter text.		
Project Components	Meridian, Township, Range, And Section(s)	GPS Coordinates
Click here to enter text.	Click here to enter text.	Click here to enter text.
Click here to enter text.	Click here to enter text.	Click here to enter text.
Click here to enter text.	Click here to enter text.	Click here to enter text.
Oil And Gas Mineral Estate Owner: Click here to enter text. Access Authorization(s): Click here to enter text. Special Use Lands: Click here to enter text. Jointly Managed Lands: Click here to enter text. Other Considerations: Click here to enter text.		
Project Components	Meridian, Township, Range, And Section(s)	GPS Coordinates
Click here to enter text.	Click here to enter text.	Click here to enter text.
Click here to enter text.	Click here to enter text.	Click here to enter text.
Click here to enter text.	Click here to enter text.	Click here to enter text.
Oil And Gas Mineral Estate Owner: Click here to enter text. Access Authorization(s): Click here to enter text. Special Use Lands: Click here to enter text. Jointly Managed Lands: Click here to enter text. Other Considerations: Click here to enter text.		
Project Components	Meridian, Township, Range, And Section(s)	GPS Coordinates

Click here to enter text.	Click here to enter text.	Click here to enter text.
Click here to enter text.	Click here to enter text.	Click here to enter text.
Click here to enter text.	Click here to enter text.	Click here to enter text.

3. Private Lands:

Are supplemental pages for land status included in Appendix C? ☐ Yes ☒ No

Oil And Gas Mineral Estate Owner: N/A
 Surface Ownership And Access Agreement(s): Cook Inlet Region, Inc. (CIRI)
 Special Use Lands: N/A
 Jointly Managed Lands: N/A
 Other Considerations: Surface Use Agreement

Project Components	Meridian, Township, Range, And Section(s)	GPS Coordinates
Vegetation Clearing and Grubbing	03N 13W 7, Seward Meridia	59.931083, -151.569317
Gravel and Facilities Install	03N 13W 7, Seward Meridia	59.931083, -151.569317
Drilling Activities	03N 13W 7, Seward Meridia	59.931083, -151.569317

Oil And Gas Mineral Estate Owner: Click here to enter text.
 Surface Ownership And Access Agreement(s): Click here to enter text.
 Special Use Lands: Click here to enter text.
 Jointly Managed Lands: Click here to enter text.
 Other Considerations: Click here to enter text.

Project Components	Meridian, Township, Range, And Section(s)	GPS Coordinates
Click here to enter text.	Click here to enter text.	Click here to enter text.
Click here to enter text.	Click here to enter text.	Click here to enter text.
Click here to enter text.	Click here to enter text.	Click here to enter text.

Oil And Gas Mineral Estate Owner: Click here to enter text.
 Surface Ownership And Access Agreement(s): Click here to enter text.
 Special Use Lands: Click here to enter text.
 Jointly Managed Lands: Click here to enter text.
 Other Considerations: Click here to enter text.

Project Components	Meridian, Township, Range, And Section(s)	GPS Coordinates
Click here to enter text.	Click here to enter text.	Click here to enter text.
Click here to enter text.	Click here to enter text.	Click here to enter text.
Click here to enter text.	Click here to enter text.	Click here to enter text.

SECTION VI: BOND INFORMATION

Bonded Company: Enter Bonded Company.
 Type: Enter Bond Type. Number: Enter Bond Number. Amount: Enter Bond Amount.

Bonding Company: The bonding requirement is satisfied through Hilcorp's Financial Assurance Agreement with DNR.
 Mailing Address: Enter Mailing Address.
 City: Enter City. State: Enter State. Zip Code: Enter Zip Code.
 Phone: Enter Phone. Fax: Enter Fax. Email: Enter Email.

SECTION VII: SEQUENCE AND SCHEDULE OF OPERATIONS

Project Milestone #	Project Milestone	Proposed Start Date	Proposed End Date
1.	Vegetation clearing and grubbing of Project Area	10/20/2025	11/24/2025

2.	Install pad and road	11/24/2025	1/1/2026
3.	Install cellars and conductors, water well, mobilize drilling equipment, begin drilling, well testing	1/1/2026	2/1/2025
4.	Install facility piping, electrical and instrumentation, other infrastructure as needed.	2/1/2026	4/1/2025
5.	Enter Milestone.	Enter Date.	Enter Date.
6.	Enter Milestone.	Enter Date.	Enter Date.
7.	Enter Milestone.	Enter Date.	Enter Date.
8.	Enter Milestone.	Enter Date.	Enter Date.
9.	Enter Milestone.	Enter Date.	Enter Date.
10.	*** Note that all proposed project milestone dates are subject to change based on permit authorizations, project constraints, scheduling, weather, and other factors.***	Enter Date.	Enter Date.

SECTION VIII: PROJECTED USE REQUIREMENTS

1. Describe the proposed operations, including the location and design, of **Well Sites**:

A 300 x 400- foot wide gravel pad will be constructed at the end of the gravel access road discussed above to support the drilling of up to two (2) natural gas wells. Additionally, Hilcorp would like to drill and install one (1) freshwater well. The purpose of this pad is to support the ongoing development of natural gas resources in the area. See attached figures for more information.

2. Describe the proposed operations, including the location and design, of **Buildings**:

Hilcorp may install wellhouses to facilitate production facilities on the pad.

3. Describe the proposed operations, including the location and design, of **Fuel and Hazardous Substances**:

Approximately 500 barrels of ultra-low sulfur diesel (ULSD) may be stored onsite temporarily to support drilling activities. Additional hazardous substances that may be onsite include ethylene glycol and/or methanol. All fuel and hazardous substances will be stored and handled in accordance with standard operating procedures.

4. Describe the proposed operations, including the location and design, of **Solid Waste Sites**:

The project does not include installing a solid waste facility. The project is not expected to generate significant quantities of waste materials. Any waste material generated will be disposed of in an approved manner at existing facilities. Solid wastes and combustibles will be hauled off-site to the Kenai Peninsula Borough Landfill.

5. Describe the proposed operations, including the location and design, of **Water Supplies**:

Approximately 100 barrels (bbls) of freshwater are anticipated to be required per day for each well during drilling activities. Existing permitted water sources will be used and tracked in compliance with applicable water source permits.

6. Describe the proposed operations, including the location and design, of **Utilities**:

The flowlines and instrumentation/electrical cables will be installed below grade.

7. Describe the proposed operations, including the location and design, of **Material Sites**:

No material sites are proposed as part of this project application. Any gravel fill needed for pad/road leveling will be obtained from a local permitted gravel source.

8. Describe the proposed operations, including the location and design, of **Roads**:

A 26-foot wide x 3 mile long gravel access road will be constructed as a part of this project to connect the gravel pad to the existing gravel road infrastructure of the area.

9. Describe the proposed operations, including the location and design, of Airstrips:

N/A

10. Describe the proposed operations, including the location and design, of All Other Facilities and Equipment:

Hilcorp Rig 169 or Rig 147 will be used for drilling and well completion activities. Major equipment components include the following: Drill rig and pipe, boilers, mud tanks/ mudpumps, rig generator, work trailers for supervisory staff and support staff, and light plants. Hilcorp may use additional support equipment for infrastructure installation, which may include, but is not limited to, an excavator, mini excavator, super sucker, zoom boom, and weld truck. Drilling will be a 24-hour operation, with a trailer staged on the pad to house various supervisory personnel and a minimum number of support personnel.

11. If another permit(s) is required for the above described Projected Use Requirements, provide the following information:

Agency	Permit Type	Permit Number	Application Status	Projected Use Requirement(s)
U.S. Army Corps of Engineers (USACE)	Nationwide Permit #14 – Linear Transportation for Access Road	TBD	Submitted	Wetlands
Alaska Department of Natural Environmental Conservation (ADEC), Division of Air	Minor General 1 (MG1)	TBD	To be submitted	Air quality, Drilling rig
Alaska Department of Natural Resources (ADNR), Division of Mining, Land and Water (DMLW)	Temporary Water Use Authorization (TWUA)	TBD	To be submitted	Fresh water for drilling and production activities.
Alaska Department of Fish & Game (ADF&G)	Fish Habitat Permit	TBD	To be submitted	Stariski Creek Bridge
Alaska Oil and Gas Conservation Commission (AOGCC)	Permit to Drill	TBD	To be submitted	Drill wells
Kenai Peninsula Borough (KPB), Kenai River Center (KRC)	Multi-Agency Permit	TBD	To be submitted	Project impacts
Enter Agency.	Enter Permit Type.	Enter Permit Number.	Enter Application Status.	Enter Projected Use Requirement(s).
Enter Agency.	Enter Permit Type.	Enter Permit Number.	Enter Application Status.	Enter Projected Use Requirement(s).
Enter Agency.	Enter Permit Type.	Enter Permit Number.	Enter Application Status.	Enter Projected Use Requirement(s).
Enter Agency.	Enter Permit Type.	Enter Permit Number.	Enter Application Status.	Enter Projected Use Requirement(s).
Enter Agency.	Enter Permit Type.	Enter Permit Number.	Enter Application Status.	Enter Projected Use Requirement(s).
Enter Agency.	Enter Permit Type.	Enter Permit Number.	Enter Application Status.	Enter Projected Use Requirement(s).
Enter Agency.	Enter Permit Type.	Enter Permit Number.	Enter Application Status.	Enter Projected Use Requirement(s).
Enter Agency.	Enter Permit Type.	Enter Permit Number.	Enter Application Status.	Enter Projected Use Requirement(s).
Enter Agency.	Enter Permit Type.	Enter Permit Number.	Enter Application Status.	Enter Projected Use Requirement(s).

Enter Agency.	Enter Permit Type.	Enter Permit Number.	Enter Application Status.	Enter Projected Use Requirement(s).
Enter Agency.	Enter Permit Type.	Enter Permit Number.	Enter Application Status.	Enter Projected Use Requirement(s).
Enter Agency.	Enter Permit Type.	Enter Permit Number.	Enter Application Status.	Enter Projected Use Requirement(s).
Enter Agency.	Enter Permit Type.	Enter Permit Number.	Enter Application Status.	Enter Projected Use Requirement(s).
Enter Agency.	Enter Permit Type.	Enter Permit Number.	Enter Application Status.	Enter Projected Use Requirement(s).
SECTION IX: REHABILITATION PLAN				
1. Proposed Level of Infrastructure, Facilities and Equipment Removal:				
Facility infrastructure will be removed from the site at the time of facility decommissioning.				
2. Description of Restoration and Rehabilitation Activities for Vegetation, Habitat, Impacted Wildlife, and Other Applicable Resources:				
No restoration or rehabilitation activities are planned at this time. No impact to vegetation, habitat, wildlife, or resources is anticipated. Restoration and rehabilitation will be addressed at the time of facility decommissioning.				
SECTION X: OPERATING PROCEDURES DESIGNED TO MINIMIZE ADVERSE EFFECTS				
Describe operating procedures designed to prevent or minimize adverse effects on other natural resources and other uses of the Lease area and adjacent areas including:				
Fish and Wildlife Habitats: It is not anticipated that this project will result in any barriers to wildlife access or movement other than the physical presence of project infrastructure. There are no known fish bearing waters in the project area. A desktop analysis for endangered species was performed; no species are believed to be present in the project area.				
Historic and Archeological Sites: There are no known historical sites or properties that fall within the proposed project area; after a full pedestrian survey of the area, an outcome of No Historic Properties Affected is recommended.				
Public Use Areas: Public use areas will not be impacted by the proposed project. While public access to Happy Valley Middle Pad will be restricted, the access road and other areas around the pad will not be restricted.				
Other Uses: N/A				
SECTION XI: GLOSSARY OF TERMS				
Term #	Term	Term Definition		
1.	ADEC	Alaska Department of Environmental Conservation		
2.	ADF&G	Alaska Department of Fish and Game		
3.	ADNR-OHA	Alaska Department of Natural Resources – Office of History and Archaeology		
4.	TBD	To Be Determined		
5.	USACE	United States Army Corps of Engineers		
6.	KRC	Kenai River Center		
7.	N/A	Not Applicable		
8.	Enter Term.	Enter Term Definition.		
9.	Enter Term.	Enter Term Definition.		
10.	Enter Term.	Enter Term Definition.		
SECTION XII: CONFIDENTIALITY				
The undersigned hereby requests that each page/section of this application <u>marked</u> confidential be held confidential under AS 38.05.035(a)(8).				
APPLICANT CONTACT:				
Sign here.	Stetson Sannes	Environmental Specialist	9/3/2025	
Signature	Name	Title	Date	

APPENDIX A: MAPS

Include maps here.

HILCORP ALASKA, LLC

HAPPY VALLEY MIDDLE

NATURAL GAS EXPLORATION PROJECT

INDEX OF SHEETS

SHEET #	DESCRIPTION
1	COVER & VICINITY MAP
2	PROJECT LOCATION MAP
3 - 6	DETAILS & TYPICAL SECTIONS
7	STARISKI CREEK BRIDGE CROSSING PLAN VIEW
8	ACCESS ROAD WETLAND CROSSING 90+10 - 95+76 PLAN VIEW
9	EXPLORATION PAD WETLAND
10	BRIDGE DETAIL PLAN VIEW
11	FILL AREA & VOLUME SUMMARY

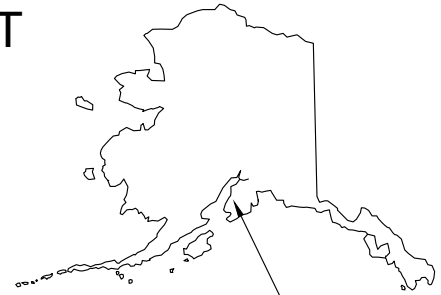

PROJECT LOCATION
NINILCHIK, ALASKA



SCALE
0 6000 12000
FEET

VICINITY MAP

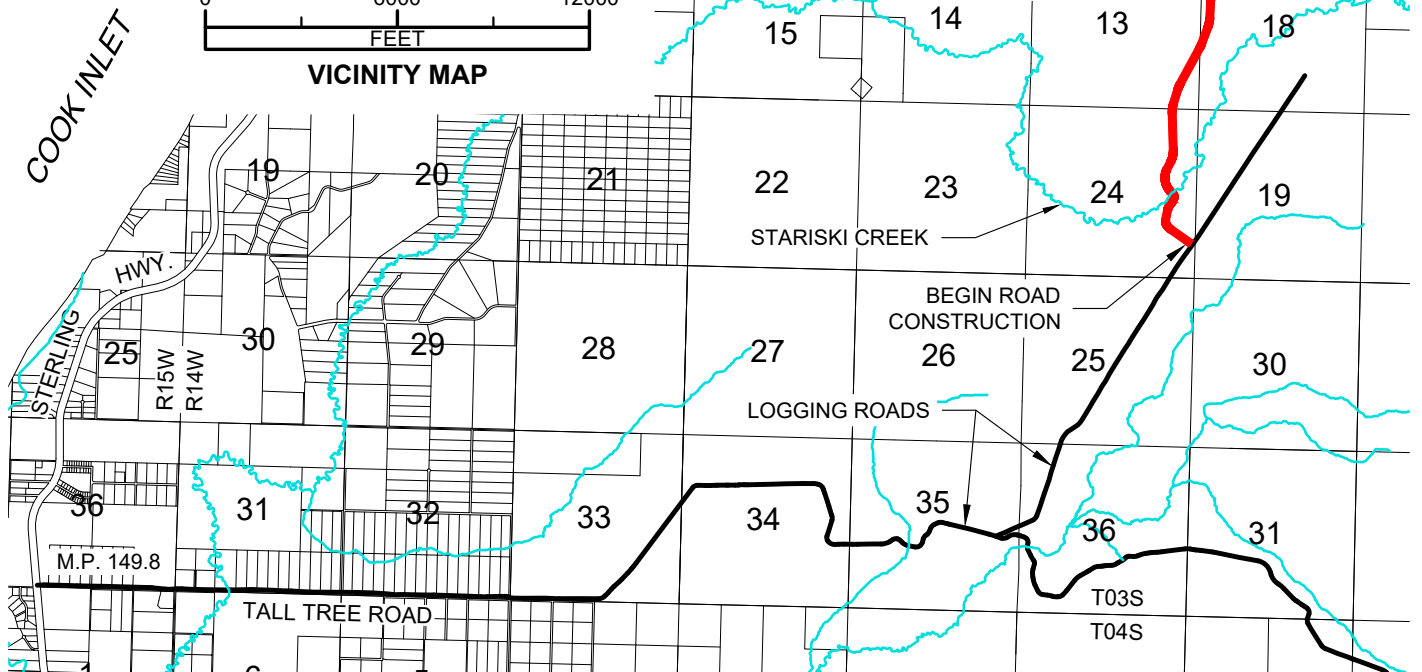

Consulting Inc

ENGINEERING - TESTING
SURVEYING - MAPPING
P.O. BOX 468
SOLDOTNA, AK. 99669
VOICE: (907) 283-4218
FAX: (907) 283-3265
WWW.MCLANECG.COM

LOCATION

SEC 24 T3S R14W, SEC 13 T3S R14W,
SEC 18 T3S R13W, SEC 7 T3S R13W

PROJECT

HAPPY VALLEY MIDDLE
NATURAL GAS EXPLORATION PROJECT

APPLICANTS

HILCORP ALASKA

3800 CENTERPOINT DRIVE, STE. 100, ANCHORAGE, AK 99503



Hilcorp Alaska, LLC

REVISION: -

DATE: 8/8/2025

DRAWN BY: BGB/CRM

SCALE: 1" = 6000'

PROJECT NO. 257005

SHEET

1 OF 11



SCALE

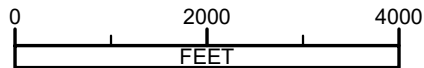

SECTION 12
T 3 S, R 14 W
ALASKA DNR

WETLAND CROSSING
STA 90+10 TO 95+76
SHEET 8

SECTION 13
T 3 S, R 14 W
ALASKA DNR

PROPOSED
ACCESS ROAD

LAT: 59° 54' 09.05" N
LONG: -151° 35' 56.49" W

PROPOSED STARISKI
CREEK BRIDGE
SHEET 7

PROPOSED PAD
WETLAND IMPACT
SHEET 11

SECTION 7
T 3 S, R 13 W
ALASKA DNR

WETLAND

LAT: 59° 55' 51.90" N
LONG: -151° 34' 09.54" W

WETLAND
(PSS4/1B)

SECTION 8
T 3 S, R 13 W
C.I.R.I.

PAD WETLAND
PEN1F

C.I.R.I.

SECTION 17
T 3 S, R 13 W

LAT: 59° 55' 14.23" N
LONG: -151° 35' 25.54" W

WETLAND
(PSS1/FO4E)

CREEK

SECTION 18
T 3 S, R 13 W
C.I.R.I.

C.I.R.I.

SECTION 19
T 3 S, R 13 W
C.I.R.I.

SECTION 20
T 3 S, R 13 W
C.I.R.I.

BEGIN ACCESS ROAD



Consulting Inc

ENGINEERING - TESTING
SURVEYING - MAPPING
P.O. BOX 468
SOLDOTNA, AK. 99669
VOICE: (907) 283-4218
FAX: (907) 283-3265
WWW.MCLANECG.COM

LOCATION

SEC 24 T3S R14W, SEC 13 T3S R14W,
SEC 18 T3S R13W, SEC 7 T3S R13W

PROJECT

HAPPY VALLEY MIDDLE
NATURAL GAS EXPLORATION PROJECT

APPLICANTS

HILCORP ALASKA

3800 CENTERPOINT DRIVE, STE. 100, ANCHORAGE, AK 99503



Hilcorp Alaska, LLC

REVISION: -

DATE: 8/8/2025

DRAWN BY: BGB/CRM

SCALE: 1" = 6000'

PROJECT NO. 257005

SHEET

2 OF 11

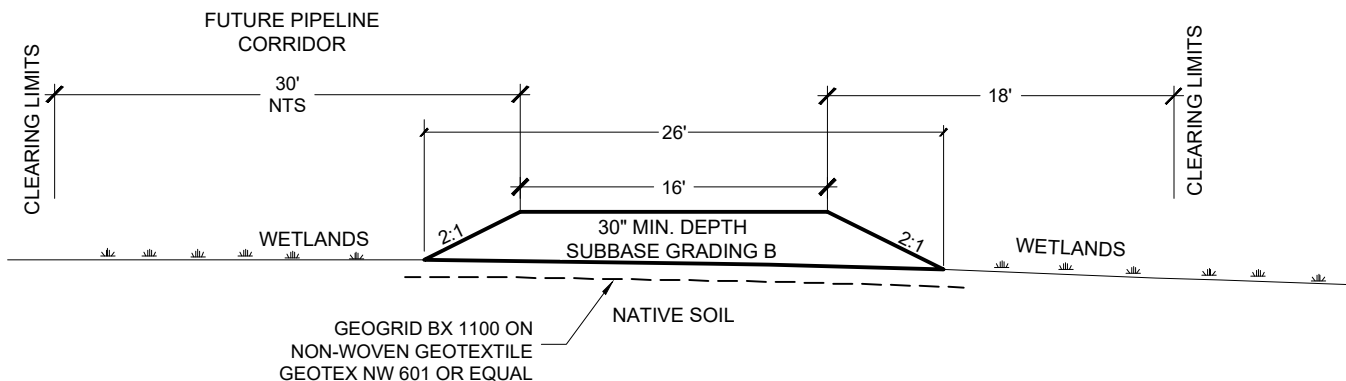

NOTES:

1. GRAVEL FILL SHALL BE PLACED IN NO GREATER THAN 12" LIFTS AND COMPACTED TO 95% OF MAXIMUM DENSITY, AS DETERMINED BY AASHTO T 180, METHOD D.
2. GRAVEL FILL SHALL BE UNDERLAIN WITH NON-WOVEN GEOTEXTILE, GEOTEX NW 601 OR EQUAL OVER BX 1100 OR EQUAL.
3. IN WETLAND AREAS CONTRACTOR MAY NOT PLACE FILL, REMOVE NATIVE MATERIAL, OR RUN EQUIPMENT OUTSIDE DESIGNATED CONSTRUCTION ZONE AS MARKED IN FIELD BY THE ENGINEER.

A 16' WIDE ROAD SECTION - WETLANDS - FILL SECTION

SCALE: 1" = 10'

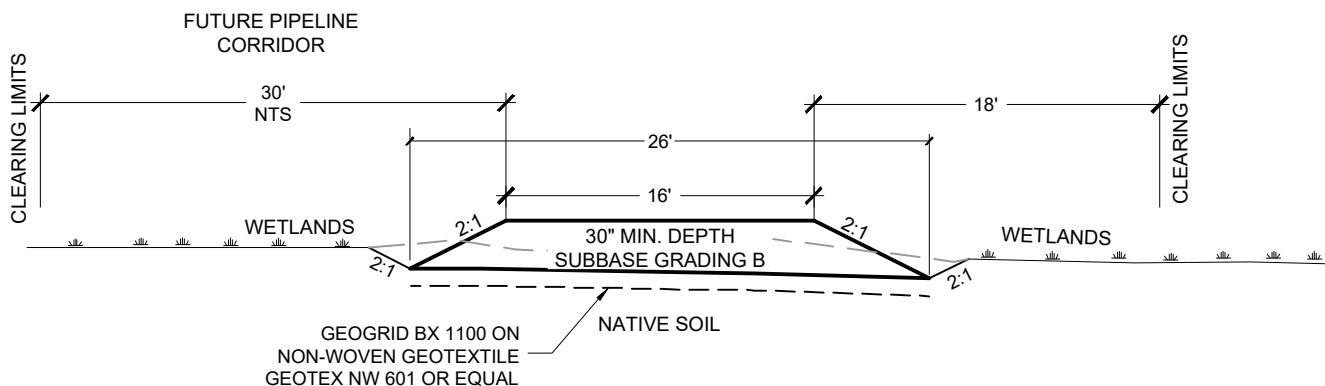

NOTES:

1. GRAVEL FILL SHALL BE PLACED IN NO GREATER THAN 12" LIFTS AND COMPACTED TO 95% OF MAXIMUM DENSITY, AS DETERMINED BY AASHTO T 180, METHOD D.
2. GRAVEL FILL SHALL BE UNDERLAIN WITH NON-WOVEN GEOTEXTILE, GEOTEX NW 601 OR EQUAL OVER BX 1100 OR EQUAL.
3. IN WETLAND AREAS CONTRACTOR MAY NOT PLACE FILL, REMOVE NATIVE MATERIAL, OR RUN EQUIPMENT OUTSIDE DESIGNATED CONSTRUCTION ZONE AS MARKED IN FIELD BY THE ENGINEER.

B 16' WIDE ROAD SECTION - WETLANDS - CUT SECTION

SCALE: 1" = 10'



Consulting Inc

ENGINEERING - TESTING
SURVEYING - MAPPING
P.O. BOX 468
SOLDOTNA, AK. 99669
VOICE: (907) 283-4218
FAX: (907) 283-3265
WWW.MCLANECG.COM

LOCATION

SEC 24 T3S R14W, SEC 13 T3S R14W,
SEC 18 T3S R13W, SEC 7 T3S R13W

PROJECT

HAPPY VALLEY MIDDLE
NATURAL GAS EXPLORATION PROJECT

APPLICANTS

HILCORP ALASKA

3800 CENTERPOINT DRIVE, STE. 100, ANCHORAGE, AK 99503



REVISION: -

DATE: 8/8/2025

DRAWN BY: BGB/CRM

SCALE: 1" = 10'

PROJECT NO. 257005

SHEET

3 OF 11

PROFILE VIEW
1" = 10'

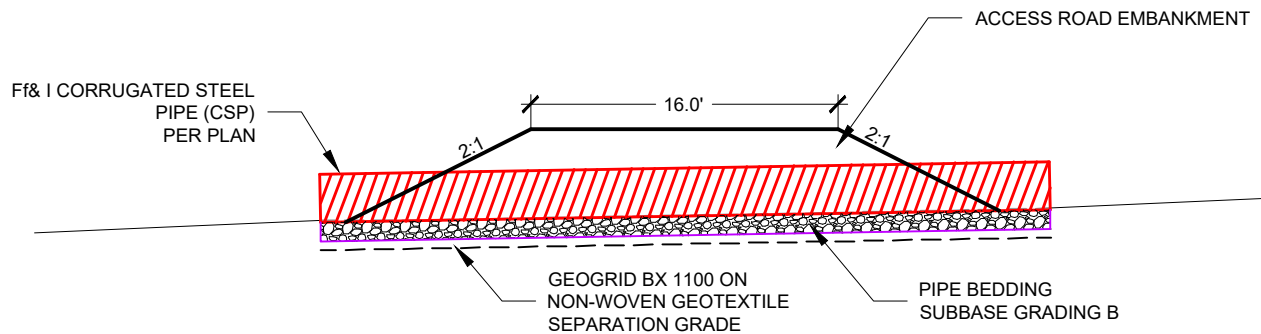

SECTION VIEW
1" = 2'

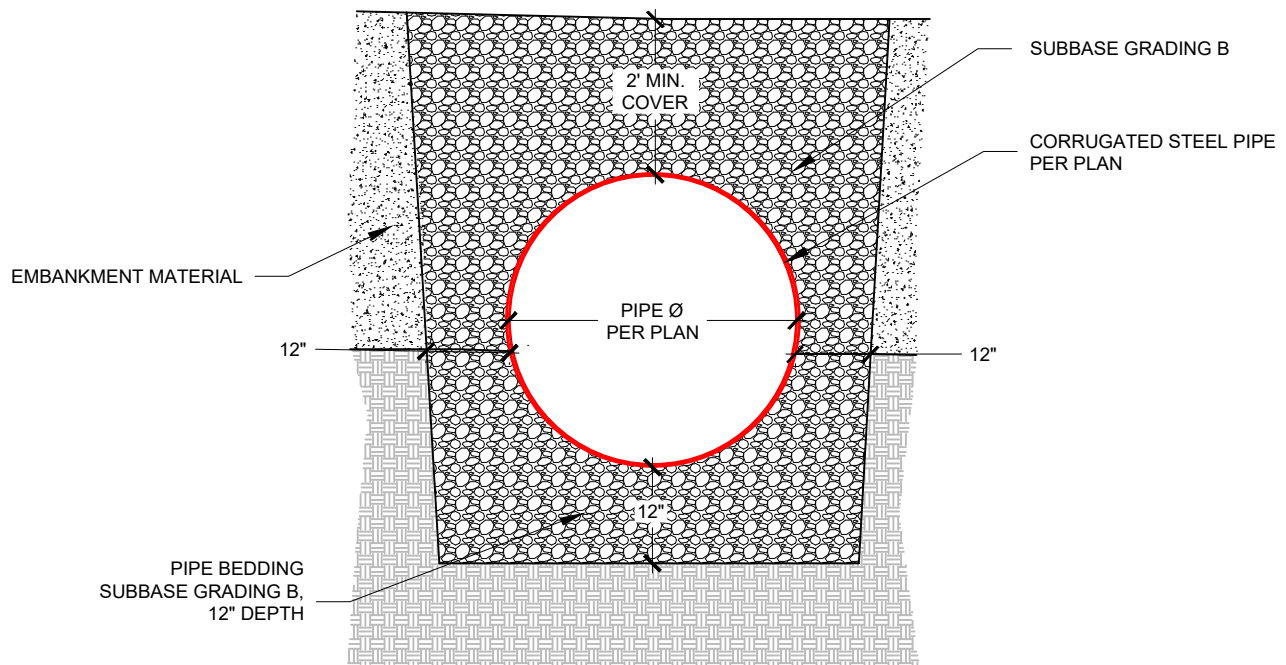

NOTE:
1. INSTALL PIPE AT SPECIFIED GRADE AND LOCATION.

A CORRUGATED PIPE TYPICAL SECTION
4



Consulting Inc

ENGINEERING - TESTING
SURVEYING - MAPPING
P.O. BOX 468
SOLDOTNA, AK. 99669
VOICE: (907) 283-4218
FAX: (907) 283-3265
WWW.MCLANECG.COM

LOCATION

SEC 24 T3S R14W, SEC 13 T3S R14W,
SEC 18 T3S R13W, SEC 7 T3S R13W

PROJECT

HAPPY VALLEY MIDDLE
NATURAL GAS EXPLORATION PROJECT

APPLICANTS

HILCORP ALASKA

3800 CENTERPOINT DRIVE, STE. 100, ANCHORAGE, AK 99503



REVISION: -

DATE: 8/8/2025

DRAWN BY: BGB/CRM

SCALE: AS SHOWN

PROJECT NO. 257005

SHEET

4 OF 11

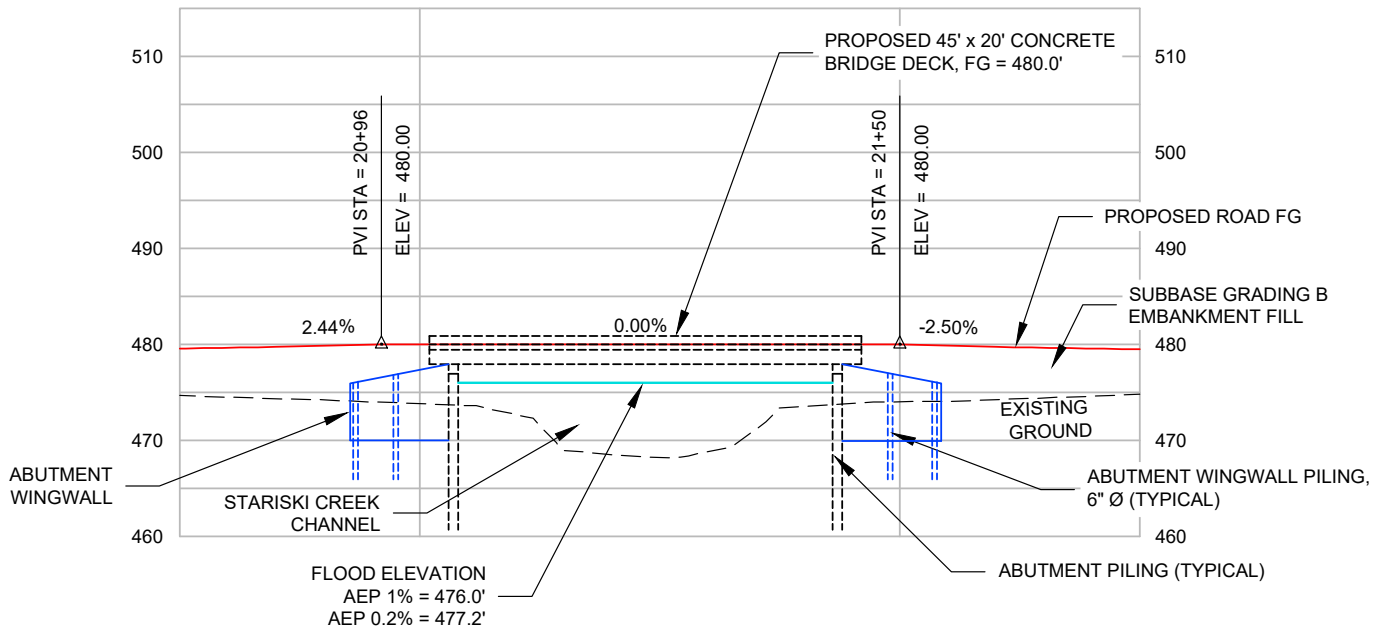

A **BRIDGE PROFILE VIEW**
5 SCALE: 1" = 20'

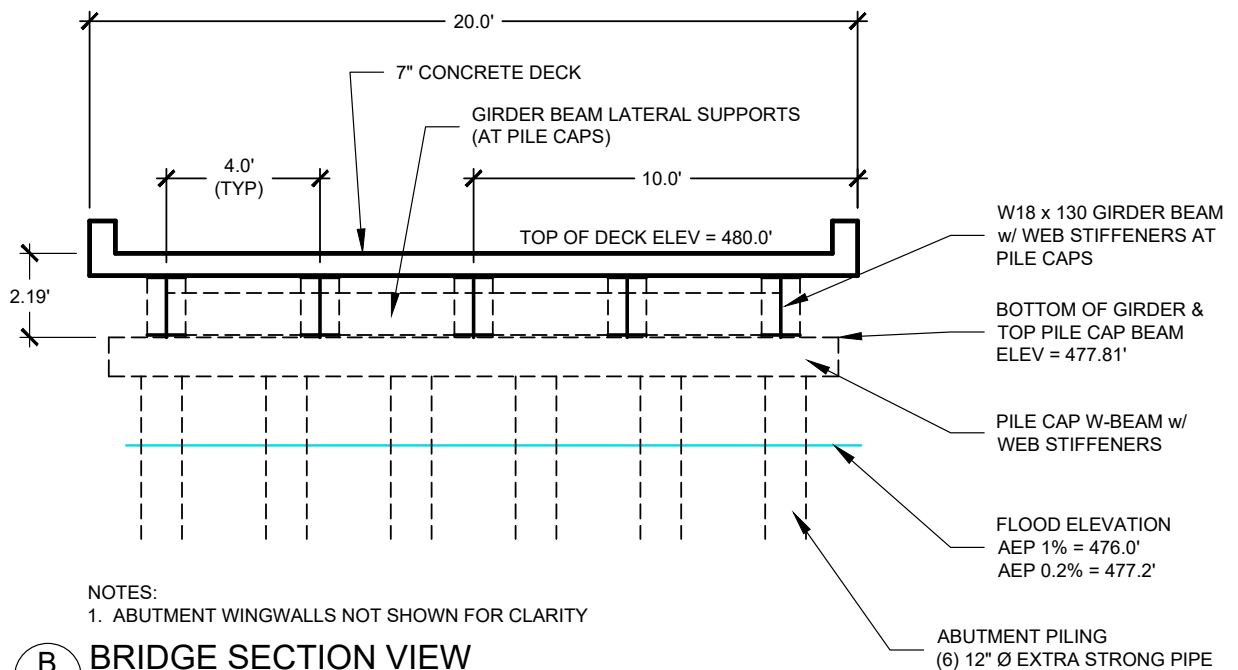

NOTES:
1. ABUTMENT WINGWALLS NOT SHOWN FOR CLARITY

B **BRIDGE SECTION VIEW**
5 SCALE: 1" = 5'



ENGINEERING - TESTING
SURVEYING - MAPPING
P.O. BOX 468
SOLDOTNA, AK. 99669
VOICE: (907) 283-4218
FAX: (907) 283-3265
WWW.MCLANECG.COM

LOCATION

SEC 24 T3S R14W, SEC 13 T3S R14W,
SEC 18 T3S R13W, SEC 7 T3S R13W

PROJECT

HAPPY VALLEY MIDDLE
NATURAL GAS EXPLORATION PROJECT

APPLICANTS

HILCORP ALASKA

3800 CENTERPOINT DRIVE, STE. 100, ANCHORAGE, AK 99503



REVISION: -

DATE: 8/8/2025

DRAWN BY: BGB/CRM

SCALE: N/A

PROJECT NO. 257005

SHEET

5 OF 11

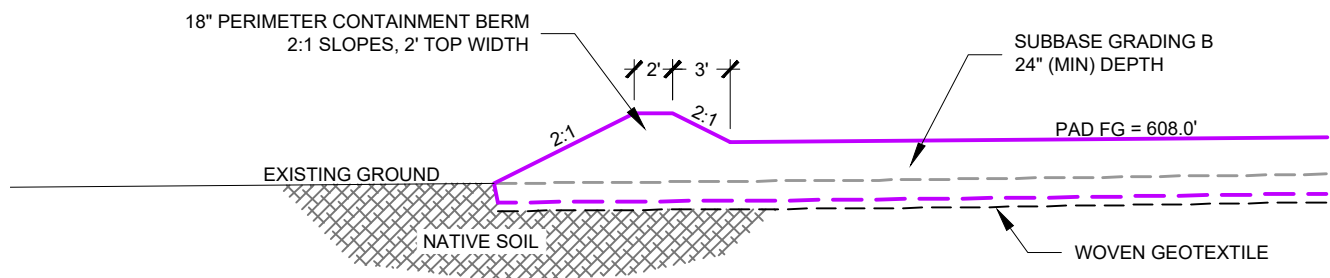

B
3

PAD FILL SECTION

SCALE: 1" = 10'



Consulting Inc

ENGINEERING - TESTING
SURVEYING - MAPPING
P.O. BOX 468
SOLDOTNA, AK. 99669
VOICE: (907) 283-4218
FAX: (907) 283-3265
WWW.MCLANECG.COM

LOCATION

SEC 24 T3S R14W, SEC 13 T3S R14W,
SEC 18 T3S R13W, SEC 7 T3S R13W

PROJECT

HAPPY VALLEY MIDDLE
NATURAL GAS EXPLORATION PROJECT

APPLICANTS

HILCORP ALASKA

3800 CENTERPOINT DRIVE, STE. 100, ANCHORAGE, AK 99503



REVISION: -

DATE: 8/8/2025

DRAWN BY: BGB/CRM

SCALE: 1" = 10'

PROJECT NO. 257005

SHEET

6 OF 11

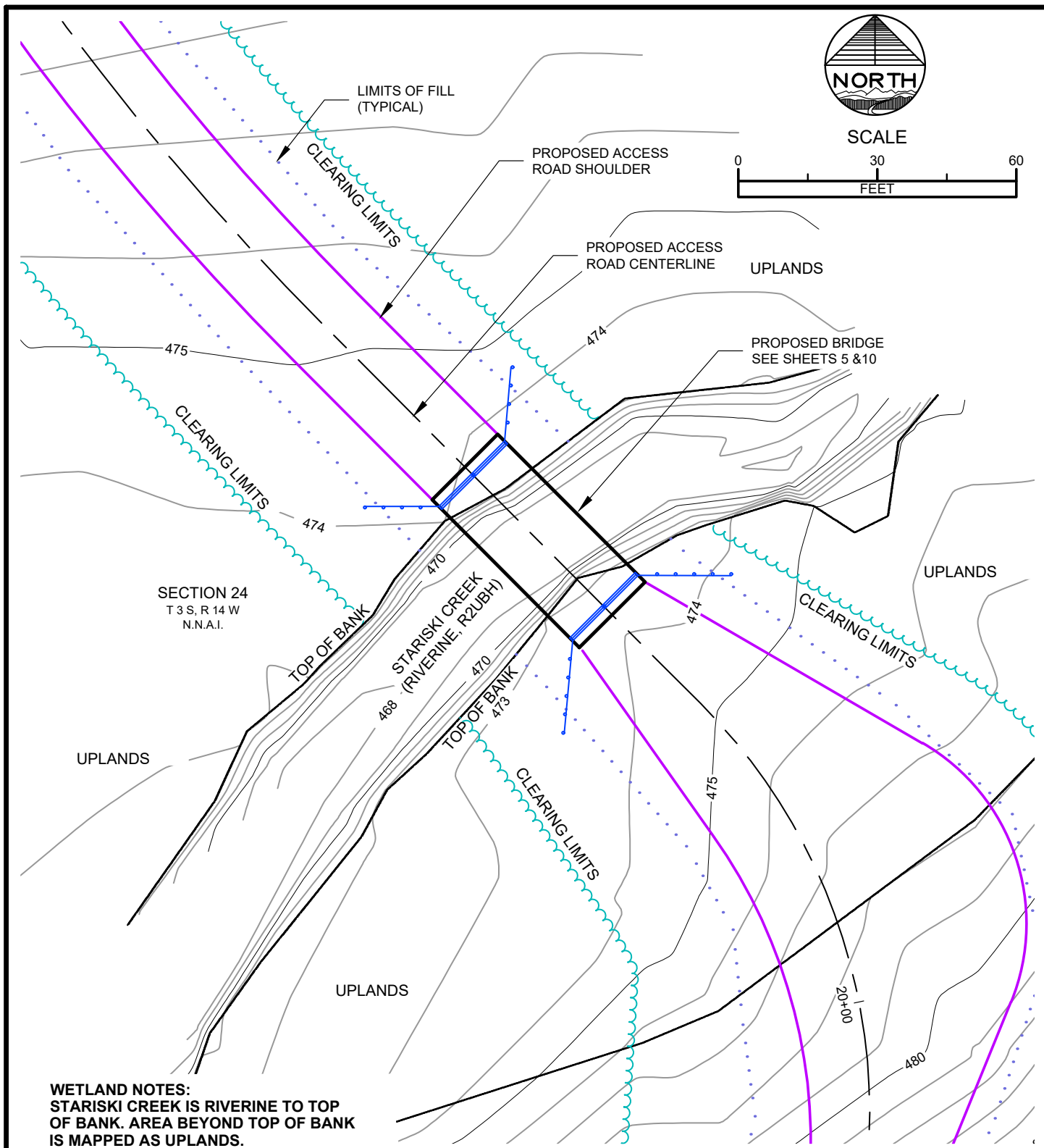

Consulting Inc

ENGINEERING - TESTING
 SURVEYING - MAPPING
 P.O. BOX 468
 SOLDOTNA, AK. 99669
 VOICE: (907) 283-4218
 FAX: (907) 283-3265
 WWW.MCLANECG.COM

LOCATION

SEC 24 T3S R14W, SEC 13 T3S R14W,
 SEC 18 T3S R13W, SEC 7 T3S R13W

PROJECT

HAPPY VALLEY MIDDLE
 NATURAL GAS EXPLORATION PROJECT

APPLICANTS

HILCORP ALASKA

3800 CENTERPOINT DRIVE, STE. 100, ANCHORAGE, AK 99503



REVISION: -

DATE: 8/8/2025

DRAWN BY: BGB/CRM

SCALE: 1" = 30'

PROJECT NO. 257005

SHEET

7 OF 11

WETLAND NOTE:
MAPPED WETLANDS FRESHWATER
FORESTED / SHRUB



SCALE

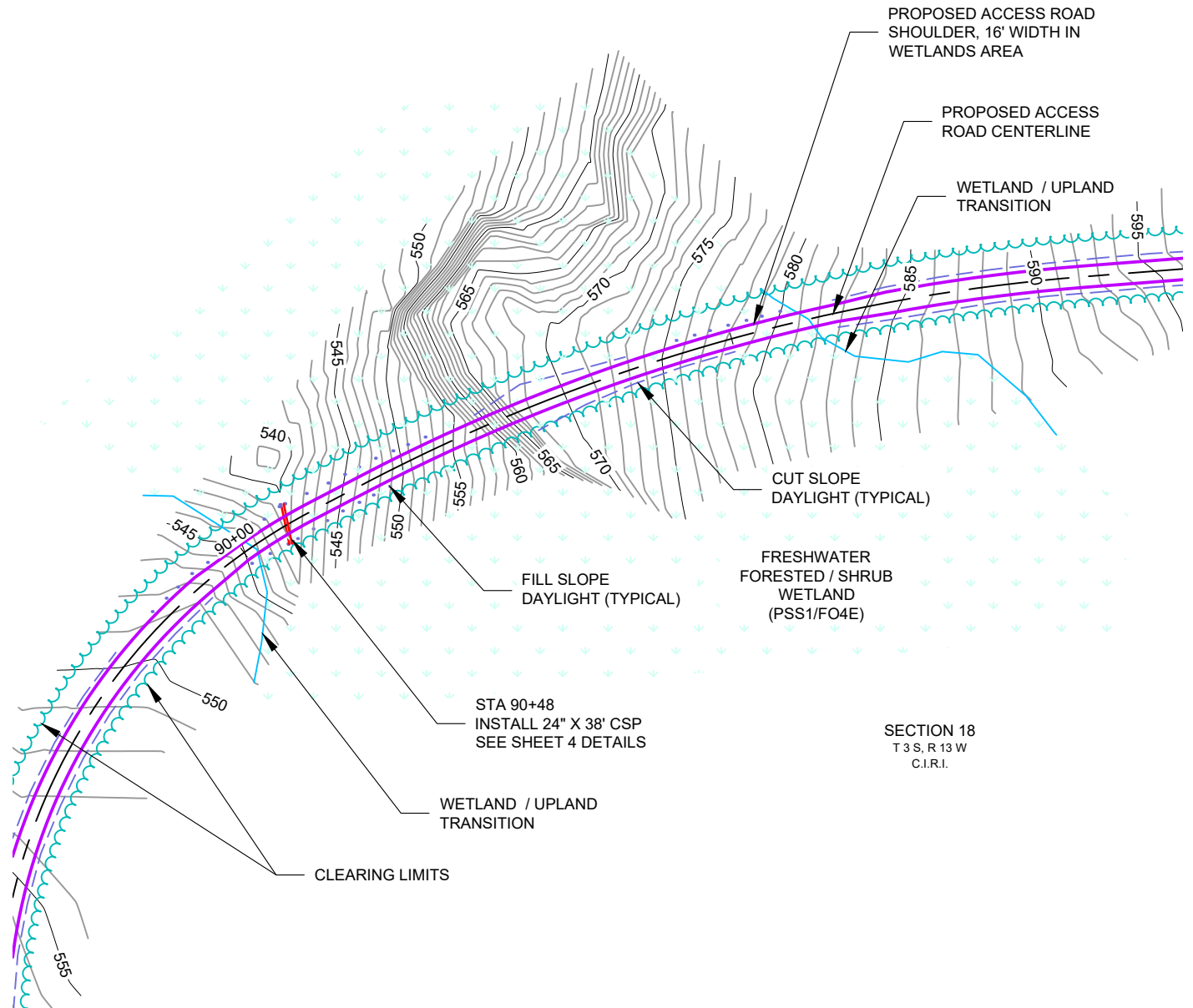
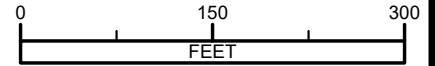

Consulting Inc

ENGINEERING - TESTING
 SURVEYING - MAPPING
 P.O. BOX 468
 SOLDOTNA, AK. 99669
 VOICE: (907) 283-4218
 FAX: (907) 283-3265
 WWW.MCLANECG.COM

LOCATION

SEC 24 T3S R14W, SEC 13 T3S R14W,
 SEC 18 T3S R13W, SEC 7 T3S R13W

PROJECT

HAPPY VALLEY MIDDLE
 NATURAL GAS EXPLORATION PROJECT

APPLICANTS

HILCORP ALASKA

3800 CENTERPOINT DRIVE, STE. 100, ANCHORAGE, AK 99503



Hilcorp Alaska, LLC

REVISION: -

DATE: 8/8/2025

DRAWN BY: BGB/CRM

SCALE: N/A

PROJECT NO. 257005

SHEET

8 OF 11

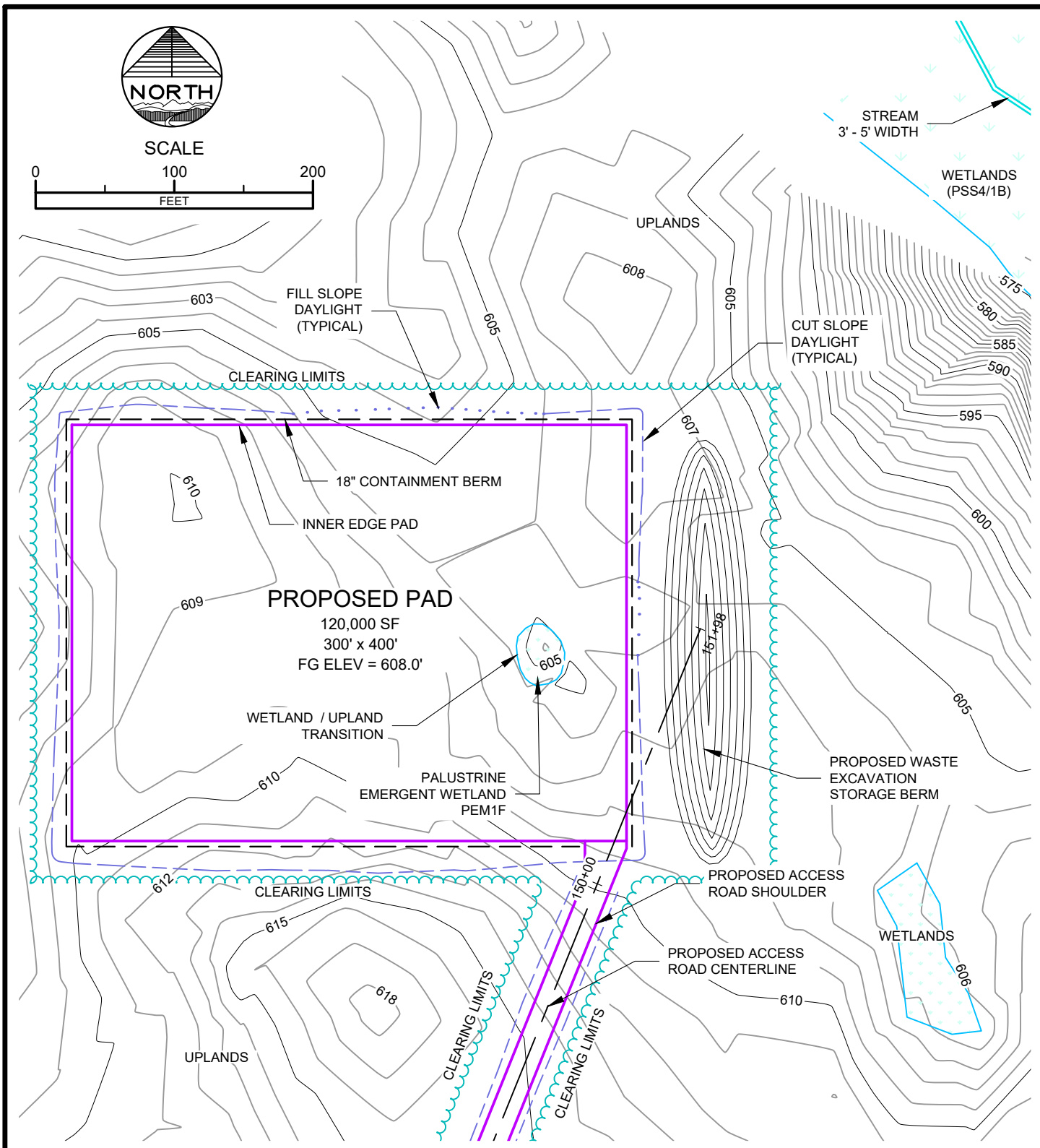

Consulting Inc

ENGINEERING - TESTING
SURVEYING - MAPPING
P.O. BOX 468
SOLDOTNA, AK. 99669
VOICE: (907) 283-4218
FAX: (907) 283-3265
WWW.MCLANECG.COM

LOCATION

SEC 24 T3S R14W, SEC 13 T3S R14W,
SEC 18 T3S R13W, SEC 7 T3S R13W

PROJECT

HAPPY VALLEY MIDDLE
NATURAL GAS EXPLORATION PROJECT

APPLICANTS

HILCORP ALASKA

3800 CENTERPOINT DRIVE, STE. 100, ANCHORAGE, AK 99503



Hilcorp Alaska, LLC

REVISION: -

DATE: 8/8/2025

DRAWN BY: BGB/CRM

SCALE: N/A

PROJECT NO. 257005

SHEET

9 OF 11



SCALE

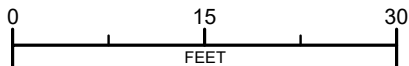

ABUTMENT WINGWALL STEEL "Z"
PILE OR APPROVED PILING & STEEL
PLATE EQUIVALENT

ABUTMENT WINGWALL PILING,
6" Ø (TYPICAL)

BRIDGE STRUCTURE
SEE SHEET 5 FOR DETAIL

LIMITS OF FILL
(TYPICAL)

STARISKI CREEK
(RIVERINE, R2UBH)

ACCESS ROAD
DESIGN CENTERLINE
ACCESS ROAD
DESIGN SHOULDER



Consulting Inc

ENGINEERING - TESTING
SURVEYING - MAPPING
P.O. BOX 468
SOLDOTNA, AK. 99669
VOICE: (907) 283-4218
FAX: (907) 283-3265
WWW.MCLANECG.COM

LOCATION

SEC 24 T3S R14W, SEC 13 T3S R14W,
SEC 18 T3S R13W, SEC 7 T3S R13W

PROJECT

HAPPY VALLEY MIDDLE
NATURAL GAS EXPLORATION PROJECT

APPLICANTS

HILCORP ALASKA

3800 CENTERPOINT DRIVE, STE. 100, ANCHORAGE, AK 99503



REVISION: -

DATE: 8/8/2025

DRAWN BY: BGB/CRM

SCALE: 1" = 15'

PROJECT NO. 257005

SHEET

10 OF 11

STARISKI CREEK CROSSING - STATION 21+23 BRIDGE			
IMPACTED WETLAND AREA	WETLAND EXCAVATION	TOTAL FILL	WETLAND FILL
0.0 SF	0.0 CF	0.0 CF	0.0 CF
0.0 AC	0.0 CY	0.0 CY	0.0 CY

ACCESS ROAD WETLAND CROSSING STATION 90+10 TO 95+76		
IMPACTED WETLAND AREA	WETLAND EXCAVATION	WETLAND FILL
16754 SF	17847 CF	35802 CF
0.38 AC	661 CY	1326 CY

24" X 38" CULVERT STATION 90+48			
CULVERT DIAMETER	CULVERT LENGTH	PIPE BEDDING FILL IN CHANNEL	EXCAVATION
24 IN	38 FT	189 CF	189 CF
		7 CY	7 CY

PAD WETLAND IMPACT		
IMPACTED WETLAND AREA	WETLAND EXCAVATION	WETLAND FILL
1199 SF	11985 CF	4793 CF
0.03 AC	45 CY	178 CY



Consulting Inc

ENGINEERING - TESTING
SURVEYING - MAPPING
P.O. BOX 468
SOLDOTNA, AK. 99669
VOICE: (907) 283-4218
FAX: (907) 283-3265
WWW.MCLANECG.COM

LOCATION

SEC 24 T3S R14W, SEC 13 T3S R14W,
SEC 18 T3S R13W, SEC 7 T3S R13W

PROJECT

HAPPY VALLEY MIDDLE
NATURAL GAS EXPLORATION PROJECT

APPLICANTS

HILCORP ALASKA

3800 CENTERPOINT DRIVE, STE. 100, ANCHORAGE, AK 99503



REVISION: -

DATE: 8/8/2025

DRAWN BY: BGB/CRM

SCALE: N/A

PROJECT NO. 257005

SHEET

11 OF 11

APPENDIX B: MITIGATION MEASURES

Include mitigation measures here.

MITIGATION MEASURE ANALYSIS: COOK INLET

The following instructions are provided for guidance to adequately complete the Mitigation Measure Analysis form.

1. The applicant shall respond to each Mitigation Measure, and all subsets of mitigation measures; i.e. A.2.d.i should be addressed and A.2.d.ii, and so forth.
2. The applicant's response shall begin by clearly indicating if the **mitigation measure is satisfied**, an **exception is requested**, or if the mitigation measure is **not applicable**.
3. The applicants' response shall then address how the proposed project clearly satisfies the mitigation measure, meets the intent of the mitigation measure, is not practicable, or is not applicable.
4. The applicant shall verify working 'in consultation with' parties other than Department of Natural Resources (DNR), Division of Oil and Gas (DO&G) by reporting meeting dates and parties present for Mitigation Measures which require consultation with parties other than DNR, DO&G; i.e. Mitigation Measure 1.b.

Please note that this form, along with the Plan of Operations Application form and the Plan of Operations, must be adequately completed before DNR DO&G will review an application for potential approval.

Cook Inlet	Company Response
A. Mitigation Measures	
1. Facilities and Operations	
a. Oil and gas facilities, including pipelines, will be designed using industry-accepted engineering codes and standards. Technical submittals to the Division of Oil and Gas (DOG) that reflect the "practice of engineering," as defined by AS 08.48.341, must be sealed by a professional engineer registered in the State of Alaska.	A.1.a. Mitigation measure satisfied: All infrastructure are designed using industry-accepted engineering codes and standards.
b. A plan of operations will be submitted and approved before conducting exploration, development, or production activities in accordance with 11 AAC 83.	A.1.b. Mitigation measure satisfied: A Lease Plan of Operations approval will be obtained prior to construction.
c. Facilities will be designed and operated to minimize sight and sound impacts in areas of high residential, recreational, and subsistence use and important wildlife habitat.	A.1.c. Mitigation measure satisfied: Drilling and well testing are anticipated to take approximately 8 weeks per well. It is not practicable to operate the drilling rig on a schedule other than around the clock; however, steps will be taken to minimize visual and sound impacts during operation. Except where safety concerns dictate otherwise, lights on the drill rig and mobile light plants will be pointed down toward activities occurring on the pad. The typical use of loudspeakers to communicate during drilling will be replaced by the use of handheld radios. Additionally, drilling vehicles and heavy equipment will use broadband "white noise" backup alarms, instead of the typical louder and more annoying single-tone backup alarms.
d. The siting of facilities, including roads, airstrips, and pipelines, is prohibited within one-half mile of the coast as measured from the mean high water mark and 500 feet of all fish bearing water bodies.	A.1.d. Mitigation measure satisfied: The proposed project is not located within any of the buffer areas specified in this mitigation measure.

Revised: November 2018

<p>e. Notwithstanding (d) above, the siting of facilities is prohibited within one-half mile of the banks of the Harriet, Alexander, Lake, Deep, and Stariski creeks, and the Drift, Big, Kustatan, McArthur, Chuitna, Lewis, Theodore, Beluga, Susitna, Little Susitna, Kenai, Kasilof, Ninilchik, and Anchor rivers as measured from the ordinary high water mark. Facilities may be sited, on a case-by-case basis, within the one-half mile buffer for the creeks and rivers identified here in if the lessee demonstrates that siting of such facilities outside this buffer zone is not feasible or prudent, or that a location within the buffer is environmentally preferable.</p>	<p>A.1.e. Mitigation measure satisfied: The proposed project is not located within any of the buffer areas specified in this mitigation measure.</p>
<p>f. Impacts to important wetlands will be minimized to the satisfaction of the director, in consultation with Alaska Department of Fish and Game (ADF&G) and Alaska Department of Environmental Conservation (ADEC). The director will consider whether facilities are sited in the least sensitive areas.</p>	<p>A.1.f. Mitigation measure satisfied: Hilcorp conducted a wetlands field survey in the project area in August 2025. A Nationwide Permit from the Army Corps of Engineers will be submitted and approved before the project begins.</p>
<p>g. Exploration roads, pads, and airstrips will be temporary. Use of gravel roads, pads, and airstrips may be permitted on a case-by-case basis by the director, in consultation with Division of Mining, Land, and Water (DMLW) and ADF&G.</p>	<p>A.1.g. Mitigation measure satisfied: Hilcorp proposes constructing a gravel pad and access road to accomplish drilling. The access road will tie into existing roads.</p>
<p>h. Road and pipeline crossings will be aligned perpendicular or near perpendicular to watercourses.</p>	<p>A.1.h. Mitigation measure not applicable: No road or pipeline crossings of watercourses are planned as part of this project.</p>

Revised: November 2018

<p>i. Pipelines</p> <ul style="list-style-type: none"> i. Will use existing transportation corridors and be buried where soil and geophysical conditions permit. ii. In areas with above ground placement, pipelines must be designed, sited, and constructed to allow for the free movement of wildlife and to avoid significant alteration of large ungulate movement and migration patterns. iii. Where practicable, pipelines must be located on the upslope side of roadways and construction pads, unless it is determined that an alternative site is environmentally acceptable. iv. Pipelines and gravel pads will facilitate the containment and cleanup of spilled fluids. v. Pipelines that must cross marine waters will be constructed beneath the marine waters using directional drilling techniques, unless the director, in consultation with ADF&G and the local borough, approves an alternative method based on technical, environmental, and economic justification. Offshore pipelines must be located and constructed to prevent obstruction to marine navigation and fishing operations. 	<p>A.1.i. Mitigation measure not applicable: No pipelines are planned as part of this project.</p> <p>A.1.i.i. Mitigation measure not applicable: No pipelines are planned as part of this project.</p> <p>A.1.i.ii. Mitigation measure not applicable: No pipelines are planned as part of this project.</p> <p>A.1.i.iii. Mitigation measure not applicable: No pipelines are planned as part of this project.</p> <p>A.1.i.iv. Mitigation measure not applicable: No pipelines are planned as part of this project.</p> <p>A.1.i.v. Mitigation measure not applicable: No pipelines are planned as part of this project.</p>
<p>j. Causeways, docks, artificial gravel islands, and bottom founded structures will not be located in river mouths, estuaries, or active river deltas, except as provided for in (k) below.</p>	<p>A.1.j. Mitigation measure not applicable: No causeways, docks, artificial gravel islands, and bottom founded structures are planned as part of this project.</p>

Revised: November 2018

<p>k. Each proposed structure will be reviewed on a case-by-case basis. Causeways, docks, artificial gravel islands and bottom founded structures may be permitted if the director, in consultation with ADF&G and ADEC, determines that a causeway or other structures are necessary for field development and that no practicable alternatives exist. Approved causeways will be designed, sited, and constructed to minimize significant changes to nearshore oceanographic circulation patterns and water quality characteristics (e.g., salinity, temperature, suspended sediments) that result in exceedances of water quality criteria, and must maintain free passage of marine and anadromous fish and marine mammals. A monitoring program may be required to address the objectives of water quality and free passage of fish and marine mammals, and mitigation will be required where significant deviation from objectives occurs.</p>	<p>A.1.k. Mitigation measure not applicable: No causeways, docks, artificial gravel islands, and bottom founded structures are planned as part of this project.</p>
<p>l. Upon abandonment of material sites, drilling sites, roads, pipelines, buildings or other facilities, such facilities must be removed, and the site rehabilitated to the satisfaction of the director, unless the director, in consultation with any non-state surface owner, as applicable, determines that such removal and rehabilitation is not in the state's interest.</p>	<p>A.1.l. Mitigation measure satisfied: Upon abandonment all surface infrastructure will be removed and remediated to the satisfaction of the State Director.</p>
<p>m. Material sites required for exploration and development activities will be:</p> <ul style="list-style-type: none"> i. restricted to the minimum necessary to develop the field efficiently and with minimal environmental damage, ii. where practicable, designed and constructed to function as water reservoirs for future use, and iii. located outside active floodplains of a watercourse unless the director of DMLW, after consultation with ADF&G, determines that there is no practicable alternative, or that a floodplain site would enhance fish and wildlife habitat after mining operations are completed and the site is closed. 	<p>A.1.m. Mitigation measure not applicable. No material sites are planned as part of this project.</p> <p>A.1.m.i. Mitigation measure not applicable: No material sites are planned as part of this project.</p> <p>A.1.m.ii. Mitigation measure not applicable: No material sites are planned as part of this project.</p> <p>A.1.m.iii. Mitigation measure not applicable: No material sites are planned as part of this project.</p>
<p>n. The director may include plan stipulations if necessary to reduce or eliminate adverse impacts to fish and wildlife or to protect the environment.</p>	<p>A.1.n. Mitigation measure satisfied: Opportunity for inclusion of potential plan stipulations is noted.</p>
<p>2. Habitat, Fish, and Wildlife</p>	

Revised: November 2018

<p>a. Detonation of explosives is prohibited in open water areas of fish bearing water bodies and in fish bearing water bodies that are not solidly frozen, including the substrate unless otherwise approved. Blasting criteria have been established by ADF&G and are available from ADF&G upon request. The location of known fish-bearing waters within the project area can be obtained from ADF&G.</p>	<p>A.2.a. Mitigation measure not applicable: Explosives will not be detonated for this project.</p>
<p>b. Any water intake structures in fish bearing water bodies will be designed, operated, and maintained to minimize fish entrapment, entrainment, or injury. All water withdrawal equipment must use fish screening devices approved by ADF&G.</p>	<p>A.2.b. Mitigation measure not applicable: No water will be extracted from fish bearing streams.</p>
<p>c. Removal of snow from fish-bearing rivers, streams, and natural lakes is subject to prior written approval by ADF&G. Compaction of snow cover overlying fish-bearing water bodies is prohibited except for approved crossings. If ice thickness is not sufficient to facilitate a crossing, then ice or snow bridges may be required</p>	<p>A.2.c. Mitigation measure not applicable: No snow is planned to be removed from or compacted over fish bearing water bodies.</p>
<p>d. Surface entry is prohibited in parcels that are within the Kenai River Special Management Area.</p>	<p>A.2.d. Mitigation measure not applicable: The project area is not within the Kenai River Special Management Area.</p>
<p>e. Surface entry, other than access, is prohibited on state lands within the Kenai National Wildlife refuge.</p>	<p>A.2.e. Mitigation measure not applicable: The project area is not within the Kenai National Wildlife Refuge.</p>
<p>f. The lessee is prohibited from placing drilling rigs and lease-related facilities and structures within an area near the Kenai River composed of: all land within Section 36 in T6N, R11W that is located south of a line drawn from the protracted NE corner to the protracted SW corner of the section; all land within the western half of Section 31 in T6N, R10W and Section 6 in T5N, R10W; and all land within Section 1 in T5N, R11W.</p>	<p>A.2.f. Mitigation measure not applicable: The project area is not near the Kenai River.</p>
<p>g. Surface entry into the critical waterfowl habitat along the Kasilof River is prohibited. Directional drilling from adjacent sites may be allowed.</p>	<p>A.2.g. Mitigation measure not applicable: The project area is not near the Kasilof River.</p>

Revised: November 2018

h. Surface entry is prohibited within one-quarter mile of trumpeter swan nesting sites between April 1 and August 31. The siting of permanent facilities, including roads, material sites, storage areas, powerlines, and above ground pipelines is prohibited within one-quarter mile of known nesting sites. Trumpeter swan nesting sites will be identified by ADF&G at the request of the lessee.	A.2.h. Mitigation measure not applicable: There are no known trumpeter swan nesting sites in the area.
i. The director, in consultation with ADF&G, will restrict or modify lease related activities if scientific evidence documents the presence of Steller's eiders from the Alaska breeding population in the lease area and it is determined that oil and gas exploration and development will impact them or their over-wintering habitat in the near-shore waters of Cook Inlet.	A.2.i. Mitigation measure satisfied: Steller's eiders are known to overwinter offshore from the pad location on Cook Inlet waters. Proposed activities are onshore and do not have high risk of hydrocarbon releases to the inlet. Impacts to Steller's eider or other waterfowl species or their nearshore overwintering habitats are not anticipated.
j. The director, in consultation with ADF&G, may impose seasonal restrictions on activities located in and adjacent to important waterfowl and shorebird habitat during the plan of operations approval stage.	A.2.j. Mitigation measure satisfied: Opportunity for inclusion of potential seasonal restrictions is noted.
k. A lessee must consult with ADF&G before commencing any activities to identify the locations of known brown bear den sites that are occupied in the season of proposed activities.	A.2.k. Mitigation measure satisfied: Prior to commencing any activities, Hilcorp will consult with ADF&G to identify the locations of known brown bear den sites that are occupied in the season of proposed activities
l. Exploration and production activities will not be conducted within one-half mile of occupied brown bear dens unless alternative mitigation measures are approved by ADF&G.	A.2.l. Mitigation measure satisfied: Activities will not be conducted within one-half mile of dens identified in consultation with ADF&G as per Mitigation measure A.2.k unless alternative mitigation measures are approved by ADF&G.
m. A lessee who encounters an occupied brown bear den not previously identified by ADF&G shall report it to the Division of Wildlife Conservation, ADF&G, within 24 hours. The lessee will avoid conducting mobile activities one-half mile from discovered occupied dens unless alternative mitigation measures are approved by the director, with concurrence from ADF&G. Non- mobile facilities will not be required to relocate.	A.2.m. Mitigation measure satisfied: Mitigation measure noted.

Revised: November 2018

<p>n. For projects in proximity to areas frequented by bears, the lessee is required to prepare and implement a human-bear interaction plan designed to minimize conflicts between bears and humans. The plan will include measures to:</p> <ul style="list-style-type: none"> i. minimize attraction of bears to facility sites; ii. organize layout of buildings and work areas to minimize interactions between humans and bears; iii. warn personnel of bears near or on facilities and the proper actions to take; iv. if authorized, deter bears from the drill site; v. provide contingencies in the event bears do not leave the site; vi. discuss proper storage and disposal of materials that may be toxic to bears; and vii. provide a systematic record of bears on the site and in the immediate area. 	<p>A.2.n. Mitigation measure satisfied: Hilcorp has a Wildlife Interaction and Avoidance Plan in place. Hilcorp policy is to require best management practices that minimize attractants to bears and other wildlife. EH&S training conducted for site workers will include training for wildlife interactions.</p> <p>A.2.n.i. Mitigation measure satisfied: Hilcorp's Wildlife Interaction and Avoidance Plan describe food and waste management procedures that help eliminate the potential for bears to associate humans and facilities with food.</p> <p>A.2.n.ii. Mitigation measure satisfied: Facility operators will visually scan the pad for the presence of bears before getting out of their vehicle or exiting a structure</p> <p>A.2.n.iii. Mitigation measure satisfied: Hilcorp's Wildlife Interaction and Avoidance Plan describes notification procedures for bear sighting at or near a facility.</p> <p>A.2.n.iv. Mitigation measure satisfied: Hilcorp's Wildlife Interaction and Avoidance Plan describes bear deterrence activities for Hilcorp.</p> <p>A.2.n.v. Mitigation measure satisfied: Hilcorp's Wildlife Interaction and Avoidance Plan describes procedures for sighting communication and bear deterrence; if a bear is encountered at the site and the bear will not leave the site, work will cease until measures are taken for work to continue safely.</p> <p>A.2.n.vi. Mitigation measure satisfied: Storage and handling of materials will be such that materials are not left exposed to bears.</p> <p>A.2.n.vii. Mitigation measure satisfied: Hilcorp's Wildlife Interaction and Avoidance Plan describes notification and documentation procedures for bear sightings at or near a facility.</p>
<p>o. Surface entry within the core calving area of the Kenai Lowlands Caribou Herd is prohibited, except that surface entry for seismic exploration may be allowed from October 16 to March 31.</p>	<p>Mitigation measure satisfied: Project area is not located within the Kenai Lowlands Caribou Herd core calving area.</p>

Revised: November 2018

<p>p. Exploration and development activities may be restricted or prohibited between April 1 and October 15 within the core summer habitat of the Kenai Lowlands Caribou Herd, except that maintenance and operation of production wells may be allowed year-round. Permanent roads, or facilities other than production wells, may also be restricted or prohibited within this area. Facilities within the core summer habitat of the Kenai Lowlands Caribou Herd that require year-round access must be located in forested areas, where practical.</p>	<p>A.2.p. Mitigation measure not applicable: Project area is not located within the Kenai Lowlands Caribou Herd core summer habitat.</p>
<p>q. Pipelines must be buried within the core summer habitat of the Kenai Lowlands Caribou Herd.</p>	<p>A.2.q. Mitigation measure not applicable: Project area is not located within the Kenai Lowlands Caribou Herd core summer habitat.</p>
<p>r. The director, in consultation with ADF&G, may impose additional and seasonal restrictions on activities located in, or requiring travel through or overflight of, important caribou or other large ungulate calving and wintering areas during the plan of operations approval stage.</p>	<p>A.2.r. Mitigation measure not applicable: Project area is not located within important caribou or other large ungulate calving and wintering areas.</p>
<p>s. No permanent or temporary oil and gas exploration or development may occur within High Value/High Sensitivity (Type 1) beluga whale habitat areas, unless it occurs on upland areas (above Mean Higher Water datum). Type 1 habitat areas include the following tracts: 320-334, 391-409, 410, 462, 464-475, 476-481, 483, 484, 485, 486, 493, 494, 497, 498, 522, 524-537, 538, 539, 540, 541, 542, 543, 544, 547-552, 559, 575-577, 579, 581, 582, 585, 586, 590, 593, 594, 598, 616-618, 620-623, 627, 655-658, and 662.</p>	<p>A.2.s. Mitigation measure not applicable: Project is not located within and has no impact on Cook Inlet beluga whale habitat, including type 1, 2 and 3 critical habitat areas.</p>
<p>t. The director will assess oil and gas-related activities within all High Value (Type 2) beluga whale habitat areas on a case-by-case basis. No permanent surface entry or structures are allowed, and temporary activities and structures, for example exploration drilling, will only be allowed between November 1 and April 1 of each year, unless it occurs on upland areas, within the following tracts: 021, 022, 126, 127, 129-132, 161, 162, 175, 177, 211, 218, 257, 301, 302, 373, 376, 377, and 384.</p>	<p>A.2.t. Mitigation measure not applicable: Project is not located within and has no impact on Cook Inlet beluga whale habitat, including type 1, 2 and 3 critical habitat areas.</p>
<p>u. The director will assess oil and gas-related activities within the remaining tracts (Type 3 habitat areas) on a case-by-case basis.</p>	<p>A.2.u. Mitigation measure not applicable: Project is not located within and has no impact on Cook Inlet beluga whale habitat, including type 1, 2 and 3 critical habitat areas.</p>

Revised: November 2018

3. Subsistence, and Other Fish and Wildlife Uses	
<p>a. Lease-related use may be restricted, if necessary, to prevent unreasonable conflicts between lease-related activities and subsistence, commercial, sport, personal use, and educational fish and wildlife harvest activities. Traditional and customary access to subsistence areas will be maintained unless reasonable alternative access is provided to subsistence users. "Reasonable access" is access using means generally available to subsistence users. The lessee will consult with nearby communities, and native organizations for assistance in identifying and contacting local subsistence users.</p>	<p>A.3.a. Mitigation measure satisfied: Project is located on state and private land and will have no impact to subsistence and other fish and wildlife uses.</p>
<p>b. Before submitting a plan of operations that has the potential to disrupt subsistence activities, the lessee will consult with the potentially affected subsistence communities to discuss the siting, timing, and methods of proposed operations and safeguards or mitigating measures that could be implemented by the operator to prevent unreasonable conflicts. The parties will also discuss the reasonably foreseeable effect on subsistence activities of any other operations in the area that they know will occur during the lessee's proposed operations. Through this consultation, the lessee will make reasonable efforts to ensure that exploration, development, and production activities are compatible with subsistence hunting and fishing activities and will not result in unreasonable interference with subsistence harvests.</p>	<p>A.3.b. Mitigation measure satisfied: Project is located on state and private land and will have no impact to subsistence and other fish and wildlife uses.</p>
4. Fuel, Hazardous Substances, and Waste	
<p>a. The lessee will ensure that secondary containment is provided for the storage of fuel or hazardous substances and sized as appropriate to container type and according to governing regulatory requirements in 18 AAC 75 and 40 CFR 112. Containers with an aggregate storage capacity of greater than 55 gallons that contain fuel or hazardous substances will not be stored within 100 feet of a water body or within 1,500 feet of a current surface drinking water source.</p>	<p>A.4.a. Mitigation measure satisfied: All fuel and other hazardous substances will have appropriately sized impermeable secondary containment. No fuel, hazardous substances or waste will be stored within 100 feet of a water body or 1,500 feet of a current surface drinking water source.</p>

Revised: November 2018

<p>b. During equipment storage or maintenance, the lessee will ensure that the site is protected from leaking or dripping fuel and hazardous substances by the placement of drip pans or other surface liners designed to catch and hold fluids under the equipment, or by creating an area for storage or maintenance using an impermeable liner or other suitable containment mechanism.</p>	<p>A.4.b. Mitigation measure satisfied: Limited equipment storage and maintenance may occur on pad and will be conducted above impermeable secondary containment.</p>
<p>c. During fuel or hazardous substance transfer, the lessee will ensure that a secondary containment or a surface liner is placed under all container or vehicle fuel tank inlet and outlet points, hose connections, and hose ends. Appropriate spill response equipment, sufficient to respond to a spill of up to five gallons, must be on hand during any transfer or handling of fuel or hazardous substances.</p>	<p>A.4.c. Mitigation measure satisfied: Duck ponds or bermed liners will be placed beneath connections during fuel and other fluid transfers, and fluid transfer operations will be continuously monitored. During drilling operations, spill response equipment will be staged at the pad. During any fuel or other hazardous fluid transfers, spill response equipment to clean up a minimum of a 5-gallon spill will be kept with the vehicle used for the substance transfer.</p>
<p>d. The lessee will ensure that vehicle refueling will not occur within the annual floodplain, except as addressed and approved in the plan of operations. This measure does not apply to water-borne vessels.</p>	<p>A.4.d. Mitigation measure satisfied: No vehicle fueling will be conducted within an annual floodplain.</p>
<p>e. The lessee will ensure that all independent fuel and hazardous substance containers are permanently marked with the contents and the lessee's or contractor's name.</p>	<p>A.4.e. Mitigation measure satisfied: Fuel and hazardous substance containers will be marked as required.</p>
<p>f. The lessee will ensure that a fresh water aquifer monitoring well and quarterly water quality monitoring, is in place down gradient of a permanent storage facility, unless alternative acceptable technology is approved by ADEC.</p>	<p>A.4.f. Mitigation measure not applicable: Facility is not an above-ground liquid hydrocarbon storage facility.</p>
<p>g. The lessee will ensure that waste from operations is reduced, reused, or recycled to the maximum extent practicable. Garbage and domestic combustibles must be incinerated whenever possible or disposed of at an approved site in accordance with 18 AAC 60.</p>	<p>A.4.g. Mitigation measure satisfied: Waste will be reduced, reused, or recycled whenever practicable. During drilling activities, closed top dumpsters will be on site for food trash and household waste and will be hauled away from the site regularly to prevent overfilling. Garbage will be disposed of at the Kenai Peninsula Borough landfill. Oily waste will be segregated and sent to an offsite contractor for disposal.</p>

Revised: November 2018

<p>h. Proper disposal of garbage and putrescible waste is essential to minimize attraction of wildlife. The lessee must use the most appropriate and efficient method to achieve this goal. The primary method of garbage and putrescible waste is prompt, on-site incineration in compliance with State of Alaska air quality regulations. The secondary method of disposal is on-site frozen storage in animal-proof containers with backhaul to an approved waste disposal facility. The tertiary method of disposal is on-site non-frozen storage in animal proof containers with backhaul to an approved waste disposal facility. Daily backhauling of non-frozen waste is required unless safety considerations prevent it.</p>	<p>A.4.h. Mitigation measure satisfied: Garbage and putrescible waste will be handled, stored, and disposed of per Hilcorp's existing Wildlife Interaction and Avoidance Plan, Waste management plans, and best practices. All garbage and putrescible waste will be sealed inside of office trailers or within bear-proof containers, and removed from site on and as-needed basis.</p>
<p>i. New solid waste disposal sites, other than for drilling waste, will not be approved or located on state property for exploration.</p>	<p>A.4.i. Mitigation measure not applicable: A solid waste disposal site will not be constructed for this project.</p>
<p>j. The preferred method for disposal of muds and cuttings from oil and gas activities is by underground injection. The lessee will ensure that drilling mud and cuttings will not be discharged into lakes, streams, rivers, or wetlands. On-pad temporary cuttings storage may be allowed as necessary to facilitate annular injection and backhaul operations.</p>	<p>A.4.j. Mitigation measure satisfied: Mud and cuttings generated by activities will be hauled via vacuum truck or supersucker directly from the rig process tank to an offsite, permitted underground injection disposal facility. Hilcorp will request an ADEC Temporary Drilling Waste Storage plan authorization in the unlikely event drilling waste cannot be delivered directly for disposal.</p>
<p>5. Access</p>	
<p>a. Public access to, or use of, the lease area may not be restricted except within the immediate vicinity of drill sites, buildings, and other related structures. Areas of restricted access must be identified in the plan of operations. Lease facilities and operations will not block access to or along navigable or public waters as defined in AS 38.05.965.</p>	<p>A.5.a. Mitigation measure satisfied: Pad access will be restricted. No access to public waters is blocked.</p>
<p>6. Prehistoric, Historic, and Archaeological Sites</p>	

Revised: November 2018

<p>a. Before the construction or placement of any structure, road, or facility supporting exploration, development, or production activities, the lessee must conduct an inventory of prehistoric, historic, and archeological sites within the area, including a detailed analysis of the effects that might result from that construction or placement.</p>	<p>A.6.a. Mitigation measure not applicable: Hilcorp contracted ASRC Energy Services to identify potential historic and cultural resources in the project area. The proposed pad and road will have no impact to archaeological/cultural resources. No cultural resources were located within the project area, therefore ASRC recommends a finding of “no historic properties affected.”</p>
<p>b. The inventory of prehistoric, historic, and archeological sites must be submitted to the director and the Office of History and Archeology (OHA). If a prehistoric, historic, or archeological site or area could be adversely affected by a lease activity, the director, after consultation with OHA, will direct the lessee as to the course of action to take to avoid or minimize adverse effects.</p>	<p>A.6.b. Mitigation measure not applicable: If the proposed construction site reveals any site, structure, or object of prehistoric, historic, or archaeological significance, Hilcorp will make reasonable efforts to preserve and protect the discovered site or object and consult with the Office of History and Archaeology to determine the course of action for preservation efforts.</p>
<p>c. If a site, structure, or object of prehistoric, historic, or archaeological significance is discovered during lease operations, the lessee shall report the discovery to the director as soon as possible. The lessee will make all reasonable efforts to preserve and protect the discovered site, structure, or object from damage until the director, after consultation with the State Historic Preservation Office, has directed the lessee on the course of action to take for its preservation.</p>	<p>A.6.c. Mitigation measure satisfied: EH&S training includes instruction to site workers to stop work if any archaeological/historic sites or artifacts are discovered. Discovery of archeological/historic sites or artifacts will be reported as soon as possible, as required, to the appropriate agencies.</p>
<p>7. Local Hire, Communication, and Training</p>	
<p>a. The lessee is encouraged to employ local and Alaska residents and contractors, to the extent they are available and qualified, for work performed in the lease area. The lessee will submit, as part of the plan of operations, a hiring plan that will include a description of the operator's plans for partnering with local communities to recruit, hire, and train local and Alaska residents and contractors. As a part of this plan, the lessee is encouraged to coordinate with employment and training services offered by the State of Alaska and local communities to train and recruit employees from local communities.</p>	<p>A.7.a. Mitigation measure satisfied: Hilcorp works with local organizations, such as the Alaska Support Industry Alliance and the Kenai Peninsula Economic Development District, and local Chambers of Commerce to encourage growth in the local service sector. While not all contracted services are awarded to local/in-state providers, Hilcorp strives to do business locally whenever possible. To the extent they are available and qualified, locally based contractors will provide construction support for this and other projects.</p>
<p>b. In accordance with Administrative Order 278, the lessee is encouraged to employ apprentice labor to perform at least 15 percent of total work hours, to the extent they are available and qualified, for work performed in the lease area. The lessee will submit, as part of the plan of operations, a hiring plan detailing the means by which the lessee might incorporate apprentice labor.</p>	<p>A.7.b. Mitigation measure satisfied: Hilcorp Alaska prioritizes local hire and actively supports workforce development efforts in Alaska. We work with entities such as the Pipeline Training Center, University of Alaska, Kenai Peninsula College Process Technology Program and various workers unions to offer internships and on the job training opportunities both in the field and technical support positions</p>

Revised: November 2018

<p>c. A plan of operations application must describe the lessee's past and prospective efforts to communicate with local communities and interested local community groups.</p>	<p>A.7.c. Mitigation measure satisfied: Hilcorp employees are actively engaged with regulators and stakeholders on all activities within the state. Hilcorp community outreach to date has included correspondence and/or presentations to Anchor Point Chamber of Commerce, the Alaska Support Industry Alliance, Cook Inlet Regional Citizens Advisory Council, and the Kenai Peninsula Economic Development District. Hilcorp personnel have been in contact with local land owners and area</p> <p>Hilcorp's Alaska-based External Affairs Manager ensures that Hilcorp remains in open communication with stakeholders, regulators and the general public in Alaska. Hilcorp will continue to keep community members informed of planned activities by bulk mailings, posting targeted informational flyers in local information repositories (e.g., post offices), and evaluating projects on a case-by-case basis to hold public meetings.</p>
<p>d. A plan of operations application must include a training program</p> <ul style="list-style-type: none"> i. for all personnel including contractors and subcontractors; ii. designed to inform each person working on the project of environmental, social, and cultural concerns that relate to that person's job; iii. using methods to ensure personnel understand and use techniques necessary to preserve geological, archeological, and biological resources; and iv. designed to help personnel increase their sensitivity and understanding of community values, customs, and lifestyles in areas where they will be operating. 	<p>A.7.d. Mitigation measure satisfied:</p> <p>A.7.d.i. Mitigation measure satisfied: Company and contract personnel will participate in project kickoff meetings that will include information specific to the impacts to resources related to the project and local project area.</p> <p>A.7.d.ii. Mitigation measure satisfied: The project kickoff training will include the following: A discussion regarding environmental, social, and cultural concerns as they relate to the project. Ensuring personnel understand and use techniques necessary to preserve geological, archeological, and biological resources. Increasing sensitivity and understanding of community values, customs, and lifestyles in areas where they will be operating.</p> <p>A.7.d.iii. Mitigation measure satisfied: The project kickoff training will include the following: A discussion regarding environmental, social, and cultural concerns as they relate to the project. Ensuring personnel understand and use techniques necessary to preserve geological, archeological, and biological resources. Increasing sensitivity and understanding of community values, customs, and lifestyles in areas where they will be operating.</p> <p>A.7.d.iv. Mitigation measure satisfied: The project kickoff training will include the following: A discussion regarding environmental, social, and cultural concerns as they relate to the project. Ensuring personnel understand and use techniques necessary to preserve geological, archeological, and biological resources. Increasing sensitivity and understanding of community values, customs, and lifestyles in areas where they will be operating.</p>
<p>8. Definitions</p>	

Revised: November 2018

Facilities - Any structure, equipment, or improvement to the surface, whether temporary or permanent, including, but not limited to, roads, pads, pits, pipelines, power lines, generators, utilities, airstrips, wells, compressors, drill rigs, camps, and buildings.

Hazardous substance - As defined under 42 USC 9601 - 9675 (Comprehensive Environmental Response, Compensation, and Liability Act of 1980).

Important wetlands - Those wetlands that are of high value to fish, waterfowl, and shorebirds because of their unique characteristics or scarcity in the region or that have been determined to function at a high level using the hydrogeomorphic approach.

Minimize - To reduce adverse impacts to the smallest amount, extent, duration, size, or degree reasonable in light of the environmental, social, or economic costs of further reduction.

Plan of operation - A lease plan of operations under 11 AAC 83.158 and a unit plan of operations under 11 AAC 83.346.

Practicable - Feasible in light of overall project purposes after considering cost, existing technology, and logistics of compliance with the mitigation measure.

Secondary containment - An impermeable diked area, portable impermeable containment structure, or integral containment space capable of containing the volume of the largest independent container. The containment will, in the case of external containment, have enough additional capacity to allow for local precipitation.

Temporary - No more than 12 months.

APPENDIX C: OTHER

Insert other information here.