

PURPOSE:
DOUGLAS ISLAND
CRUISE SHIP TERMINAL

SCALE: 1" = N/A

DATUM: 0.0' HAT = +24.0'
 HTL = +20.6'
 MHW = +15.3'
 MLLW = +3.4'

COVER SHEET

JOB NO. 25-002

PROPOSED: TURNAGAIN MARINE
AT: JUNEAU, ALASKA
WATERWAY: STEPHENS PASSAGE
APPLICATION BY: TURNAGAIN MARINE
DATE: 29 APRIL 2025 SHEET: 1 OF 22

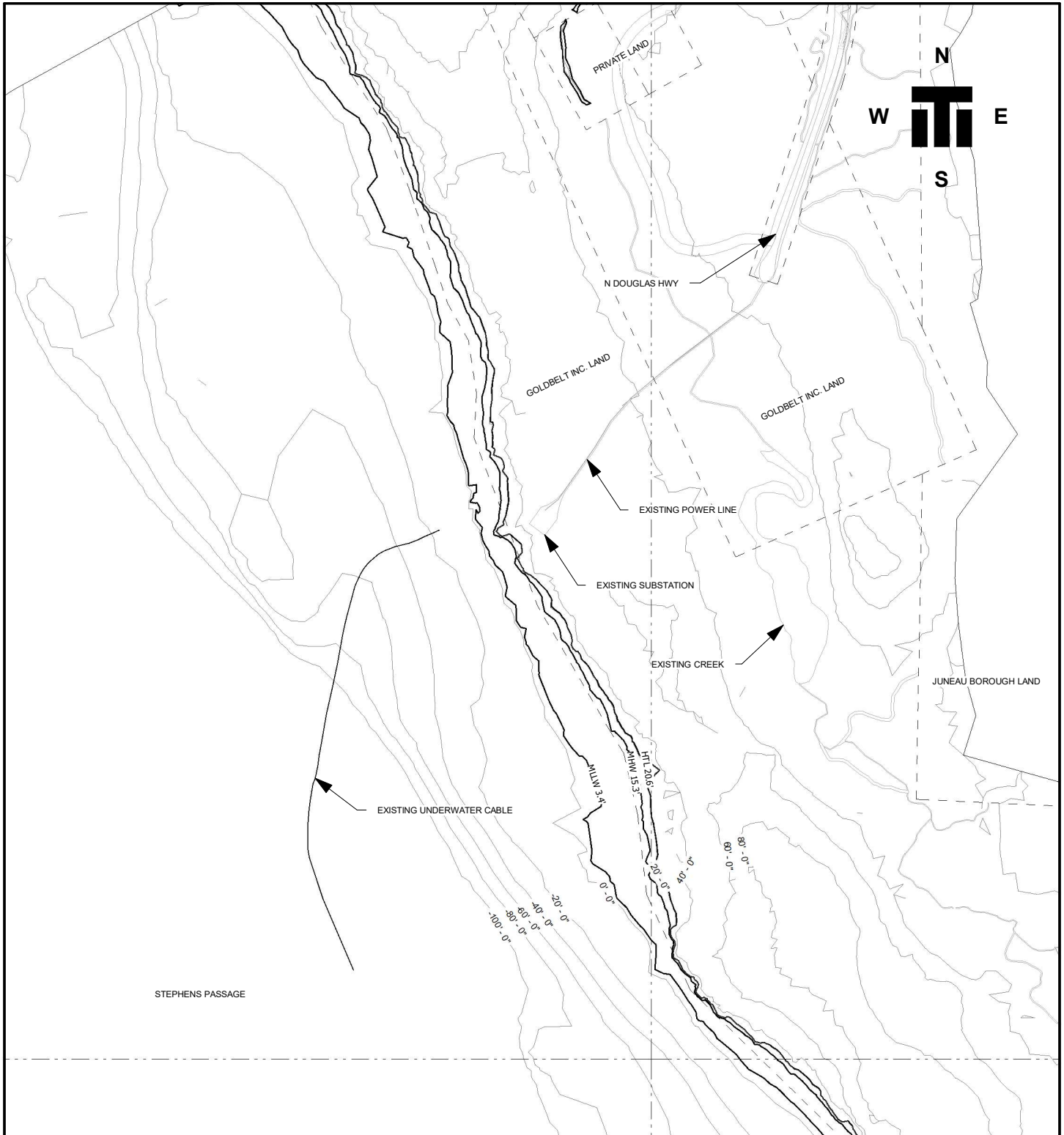

PURPOSE:
**DOUGLAS ISLAND
CRUISE SHIP TERMINAL**

SCALE: 1" = 700'

DATUM: 0.0' HAT = +24.0'
 HTL = +20.6'
 MHW = +15.3'
 MLLW = +3.4'

**EXISTING
CONDITION
OFFSHORE SITE
PLAN**

JOB NO. 25-002

PROPOSED: **TURNAGAIN MARINE**
AT: **JUNEAU, ALASKA**
WATERWAY: **STEPHENS PASSAGE**
APPLICATION BY: **TURNAGAIN MARINE**
DATE: 29 APRIL 2025 SHEET: 2 OF 22

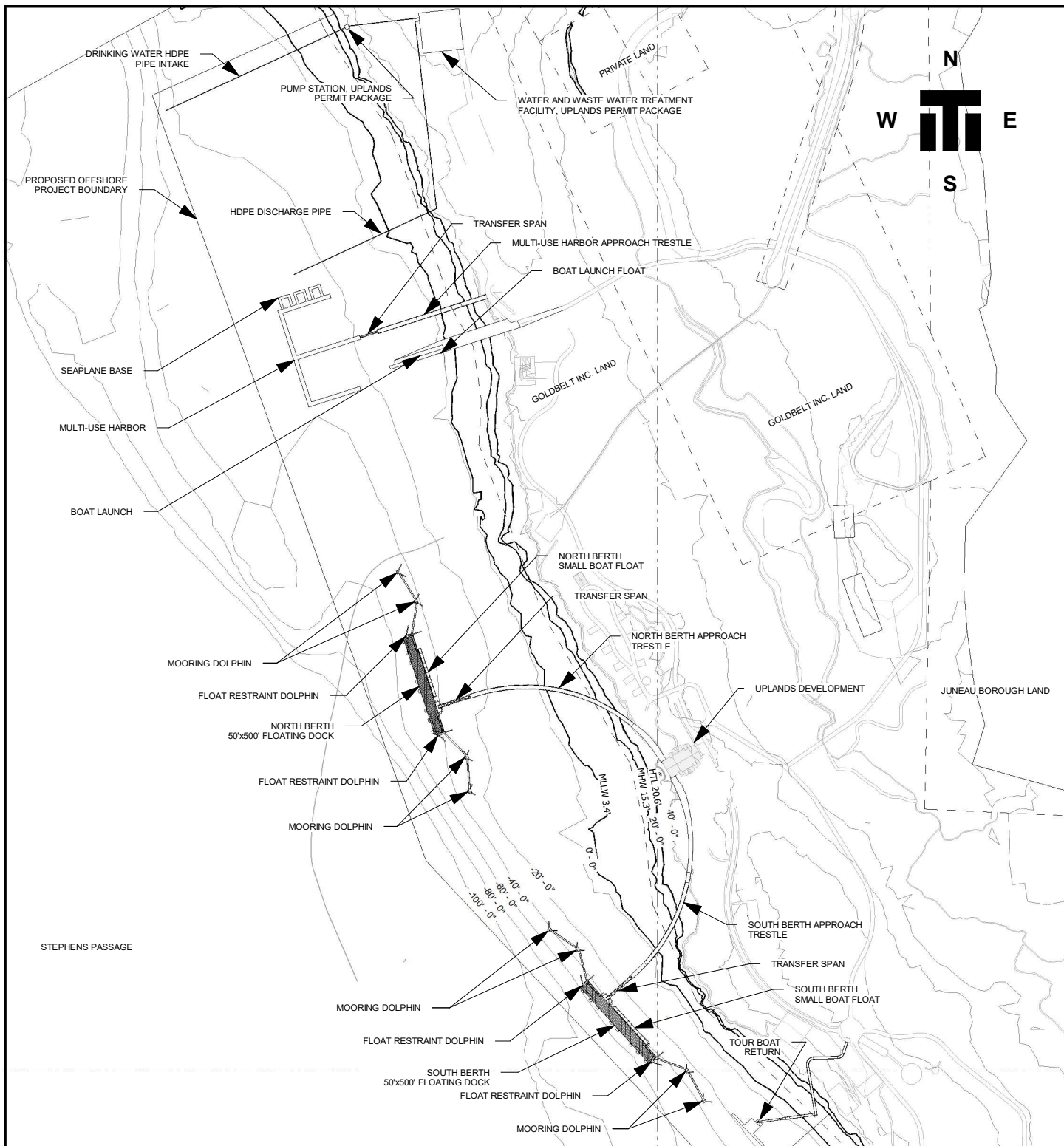

PURPOSE:
**DOUGLAS ISLAND
CRUISE SHIP TERMINAL**

SCALE: 1" = 700'

DATUM: 0.0'

HAT	= +24.0'
HTL	= +20.6'
MHW	= +15.3'
MLLW	= +3.4'

**PROPOSED
OFFSHORE SITE
PLAN**

JOB NO. 25-002

PROPOSED: **TURNAGAIN MARINE**
AT: **JUNEAU, ALASKA**
WATERWAY: **STEPHENS PASSAGE**
APPLICATION BY: **TURNAGAIN MARINE**
DATE: 29 APRIL 2025 SHEET: 3 OF 22

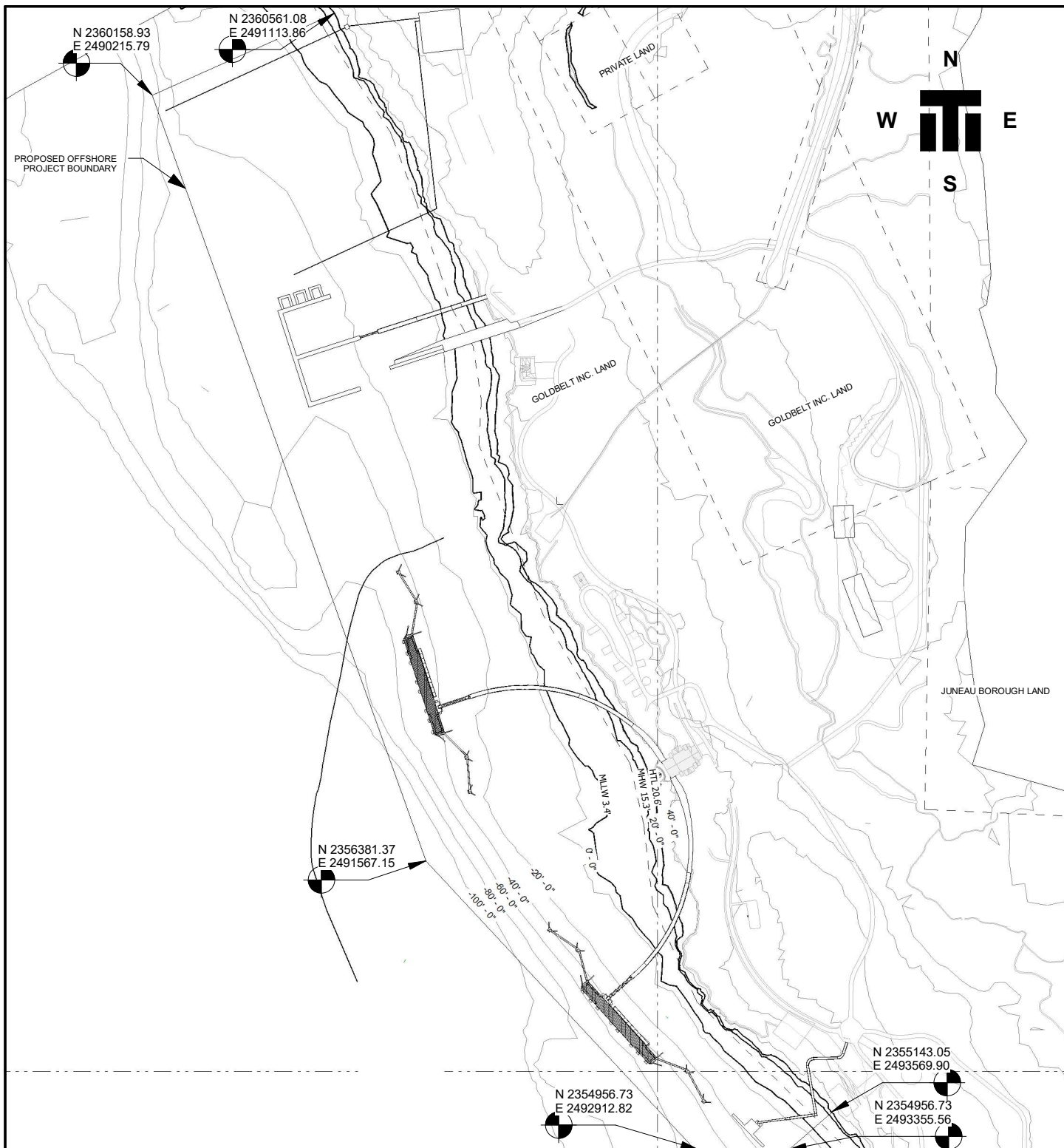

PURPOSE:
DOUGLAS ISLAND
CRUISE SHIP TERMINAL

SCALE: 1" = 700'

DATUM:	0.0'	HAT	= +24.0'
		HTL	= +20.6'
		MHW	= +15.3'
		MLLW	= +3.4'

PROPOSED
OFFSHORE
PROJECT
BOUNDARY

JOB NO. 25-002

PROPOSED: TURNAGAIN MARINE
AT: JUNEAU, ALASKA
WATERWAY: STEPHENS PASSAGE
APPLICATION BY: TURNAGAIN MARINE
DATE: 29 APRIL 2025

SHEET: 4 OF 22

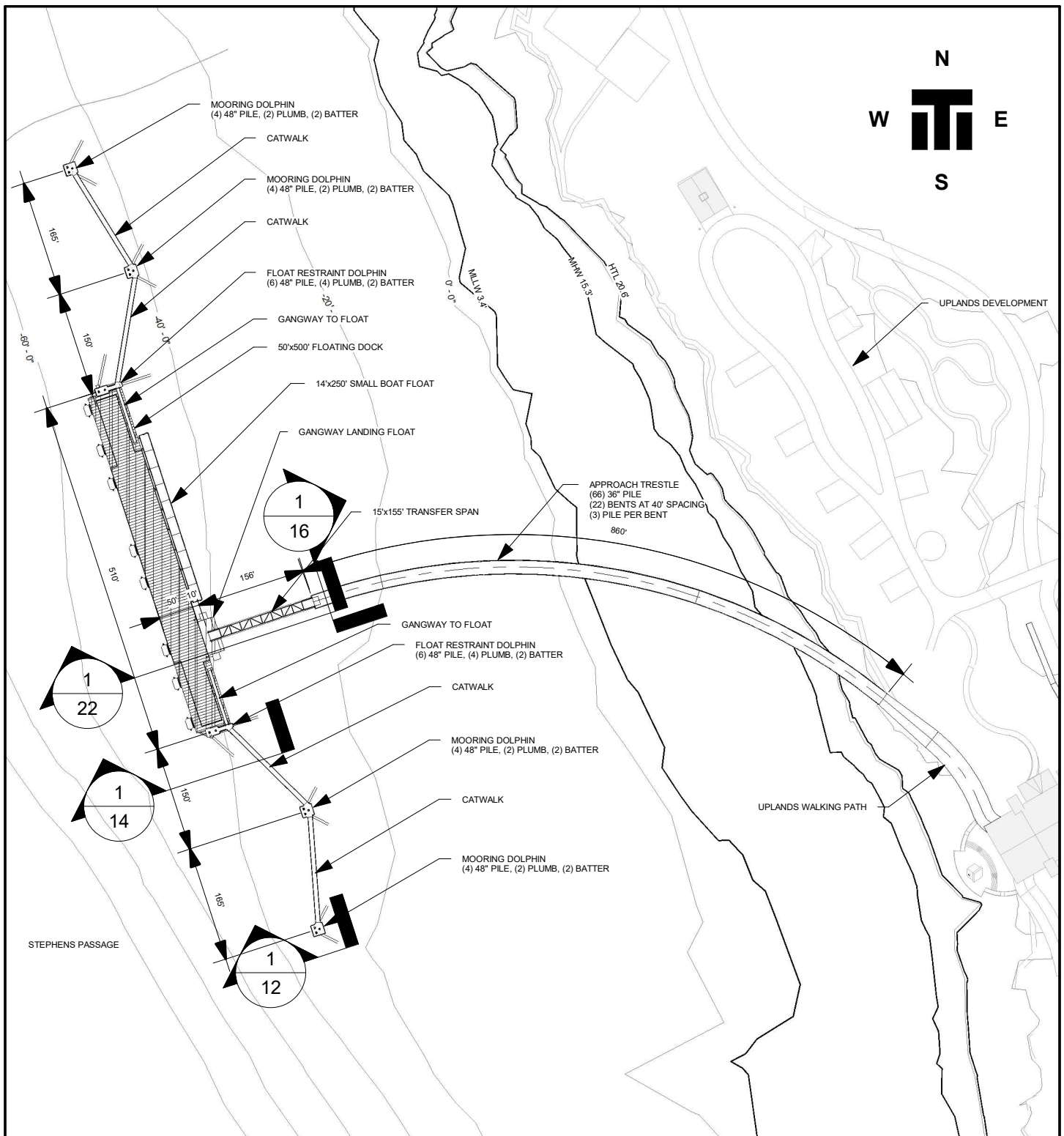

PURPOSE:
DOUGLAS ISLAND
CRUISE SHIP TERMINAL

SCALE: 1" = 200'

DATUM: 0.0' HAT = +24.0'
HTL = +20.6'
MHW = +15.3'
MLLW = +3.4'

NORTH BERTH SITE PLAN

JOB NO. 25-002

PROPOSED: TURNAGAIN MARINE
AT: JUNEAU, ALASKA
WATERWAY: STEPHENS PASSAGE
APPLICATION BY: TURNAGAIN MARINE
DATE: 29 APRIL 2025 SHEET: 5 OF 22

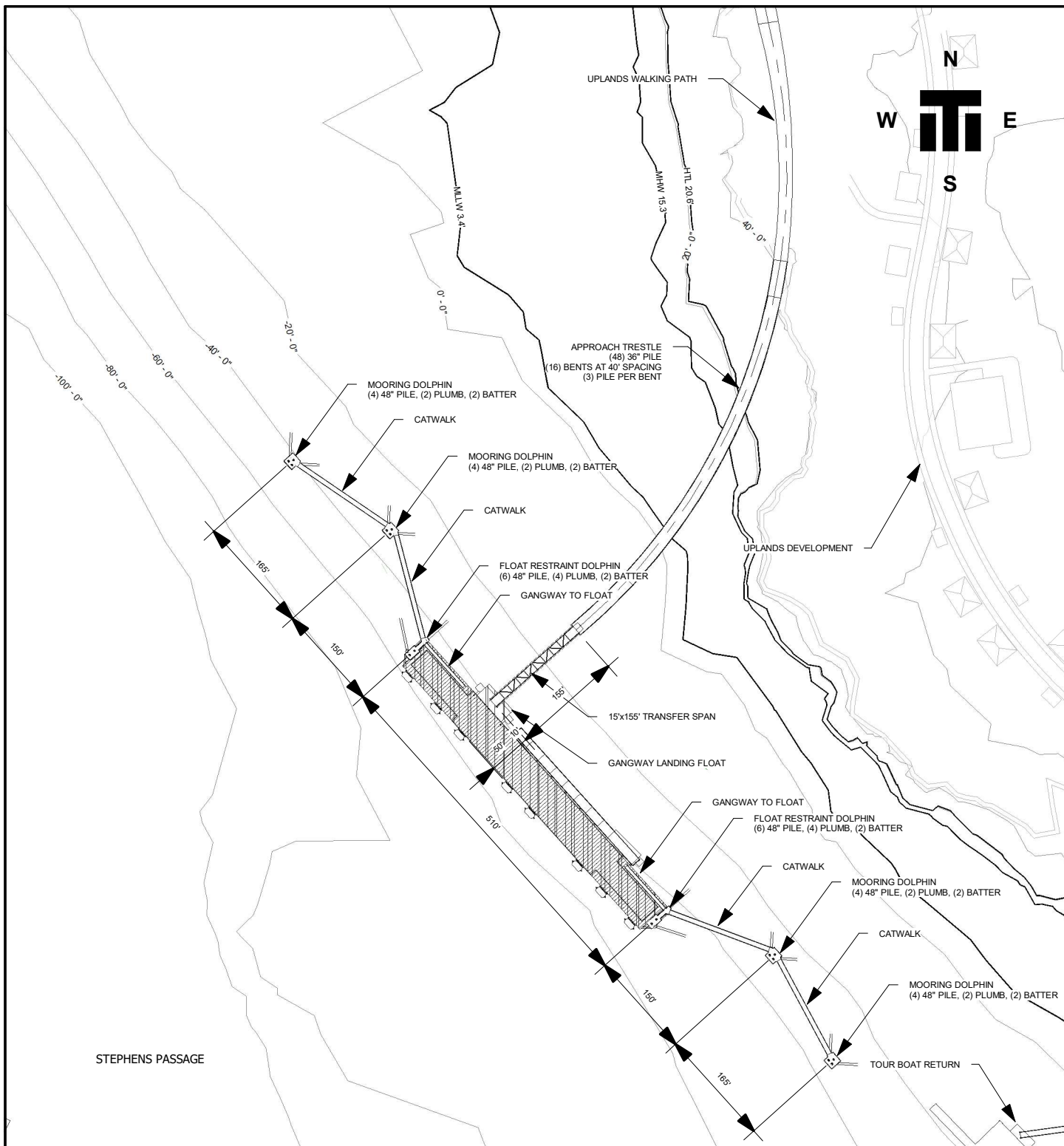

PURPOSE:

DOUGLAS ISLAND CRUISE SHIP TERMINAL

SCALE: 1" = 200'

DATUM: 0.0'

HAT = +24.0'
HTL = +20.6'
MHW = +15.3'
MLLW = +3.4'

SOUTH BERTH SITE PLAN

JOB NO. 25-002

PROPOSED:

TURNAGAIN MARINE

AT:

JUNEAU, ALASKA

WATERWAY:

STEPHENS PASSAGE

APPLICATION BY:

TURNAGAIN MARINE

DATE: 29 APRIL 2025

SHEET: 6 OF 22

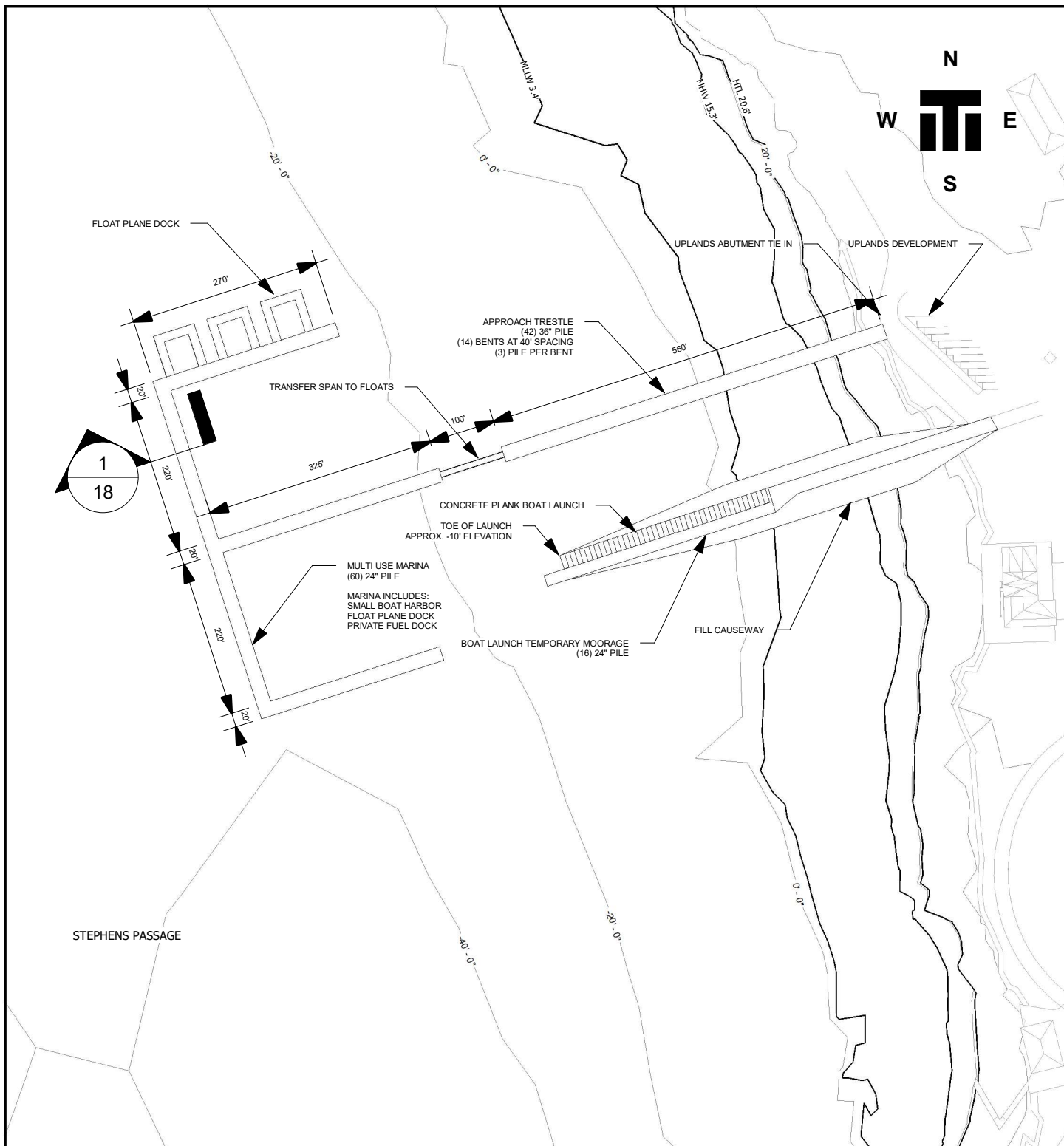

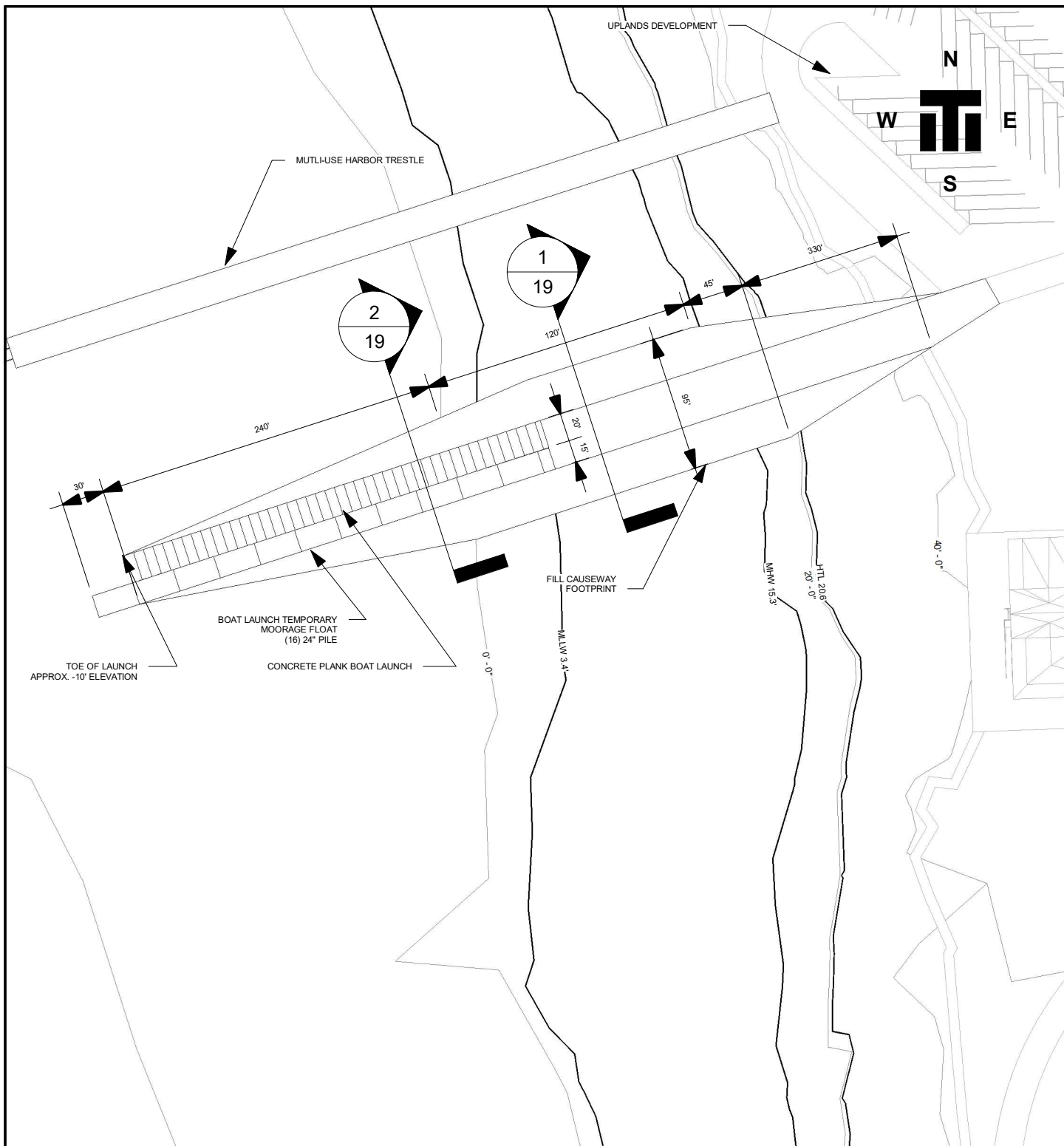

PURPOSE:
DOUGLAS ISLAND
CRUISE SHIP TERMINAL

SCALE: 1" = 100'



DATUM:	0.0'	HAT	= +24.0'
		HTL	= +20.6'
		MHW	= +15.3'
		MLLW	= +3.4'

BOAT LAUNCH SITE DETAIL

JOB NO. 25-002

PROPOSED: TURNAGAIN MARINE
AT: JUNEAU, ALASKA
WATERWAY: STEPHENS PASSAGE
APPLICATION BY: TURNAGAIN MARINE
DATE: 29 APRIL 2025

SHEET: 8 OF 22

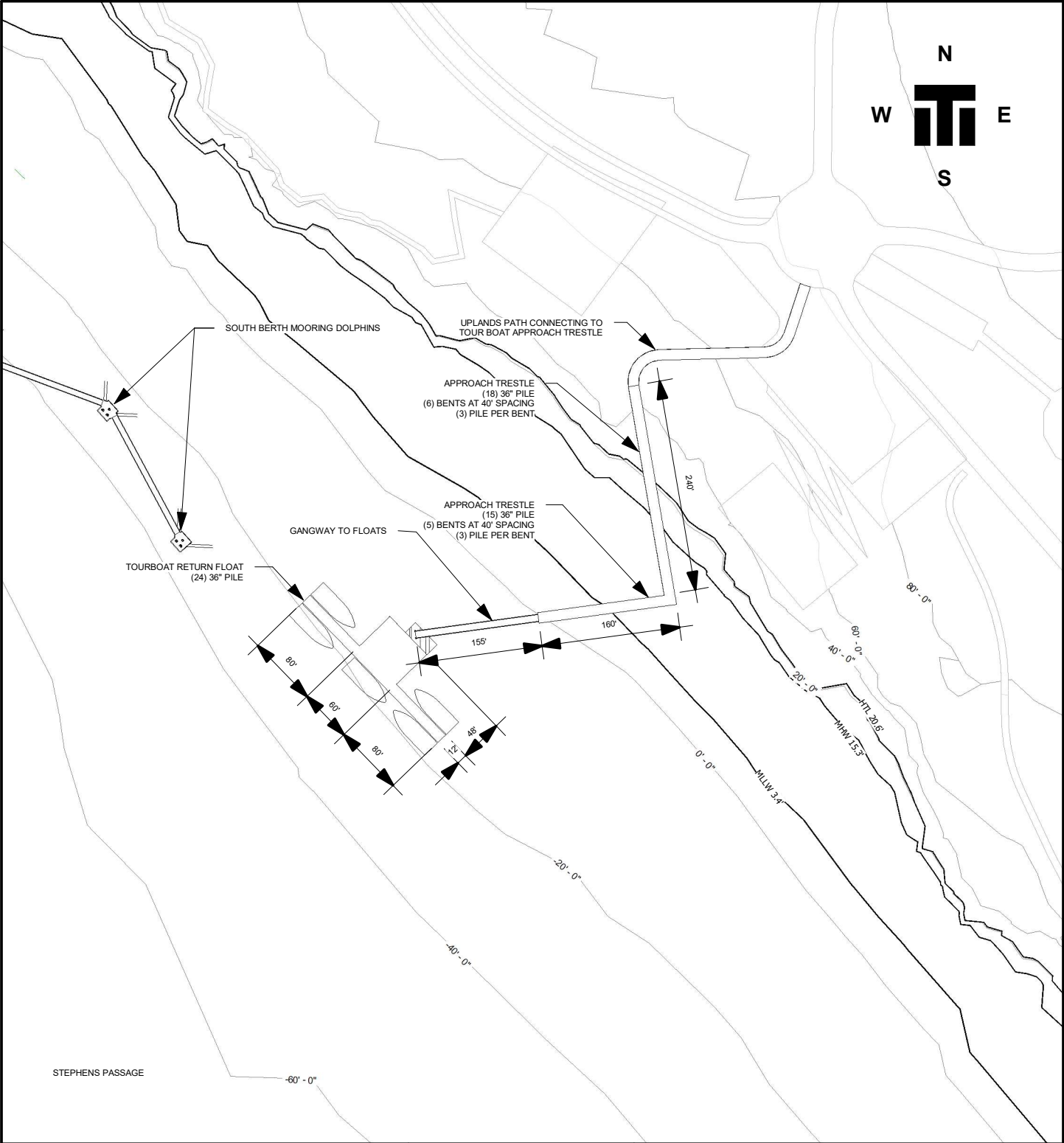

PURPOSE:
**DOUGLAS ISLAND
CRUISE SHIP TERMINAL**

SCALE: 1" = 160'

DATUM: 0.0' HAT = +24.0'
 HTL = +20.6'
 MHW = +15.3'
 MLLW = +3.4'

**TOUR BOAT
RETURN SITE
PLAN**

JOB NO. 25-002

PROPOSED: **TURNAGAIN MARINE**
AT: **JUNEAU, ALASKA**
WATERWAY: **STEPHENS PASSAGE**
APPLICATION BY: **TURNAGAIN MARINE**
DATE: 29 APRIL 2025 SHEET: 9 OF 22

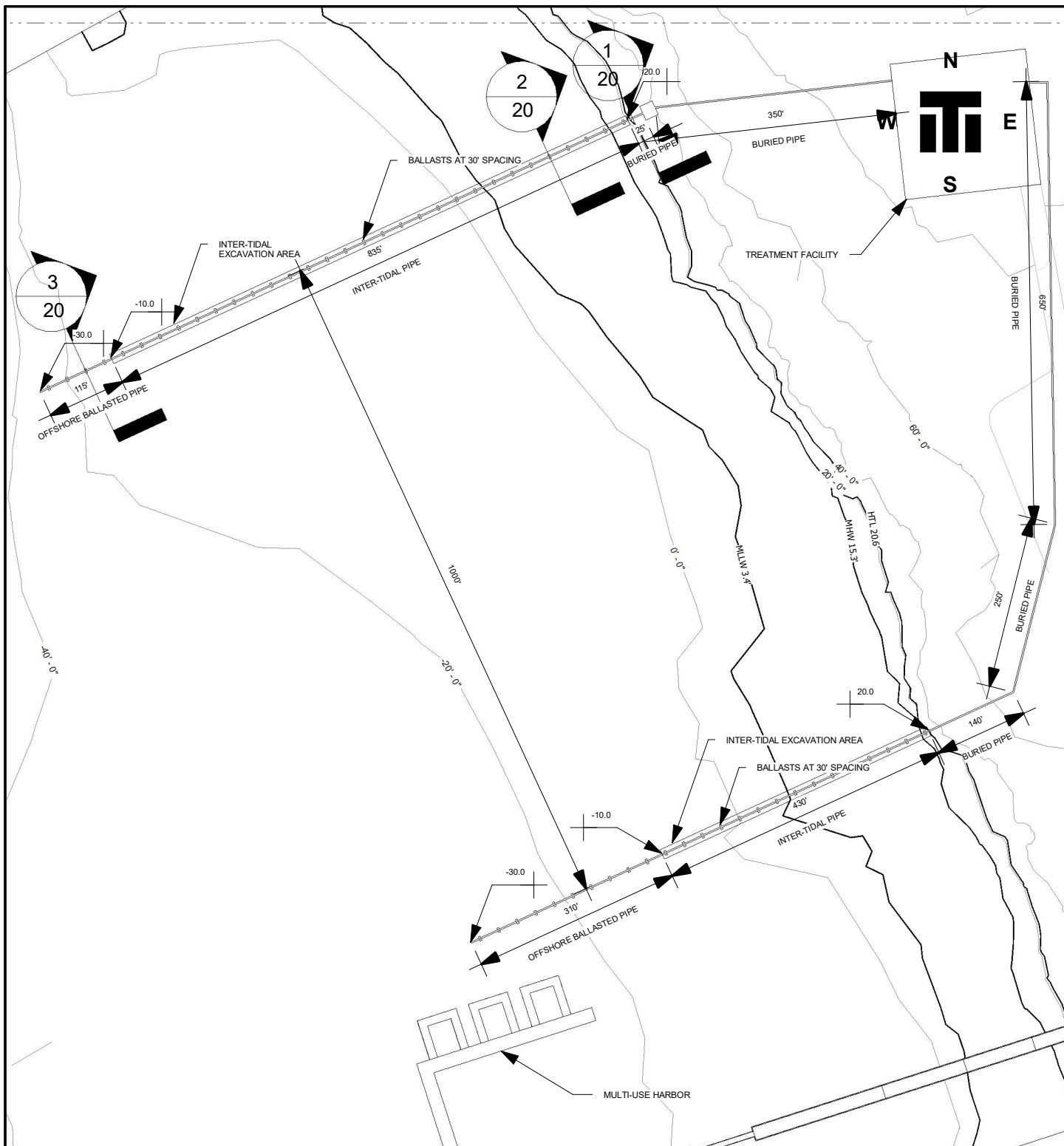

PURPOSE:
**DOUGLAS ISLAND
CRUISE SHIP TERMINAL**

SCALE: 1" = 208' - 4"

DATUM:	0.0'	HAT	= +24.0'
		HTL	= +20.6'
		MHW	= +15.3'
		MLLW	= +3.4'

**INTAKE AND
DISCHARGE
SITE PLAN**

JOB NO. 25-002

PROPOSED: **TURNAGAIN MARINE**
AT: **JUNEAU, ALASKA**
WATERWAY: **STEPHENS PASSAGE**
APPLICATION BY: **TURNAGAIN MARINE**
DATE: 29 APRIL 2025 SHEET: 10 OF 22

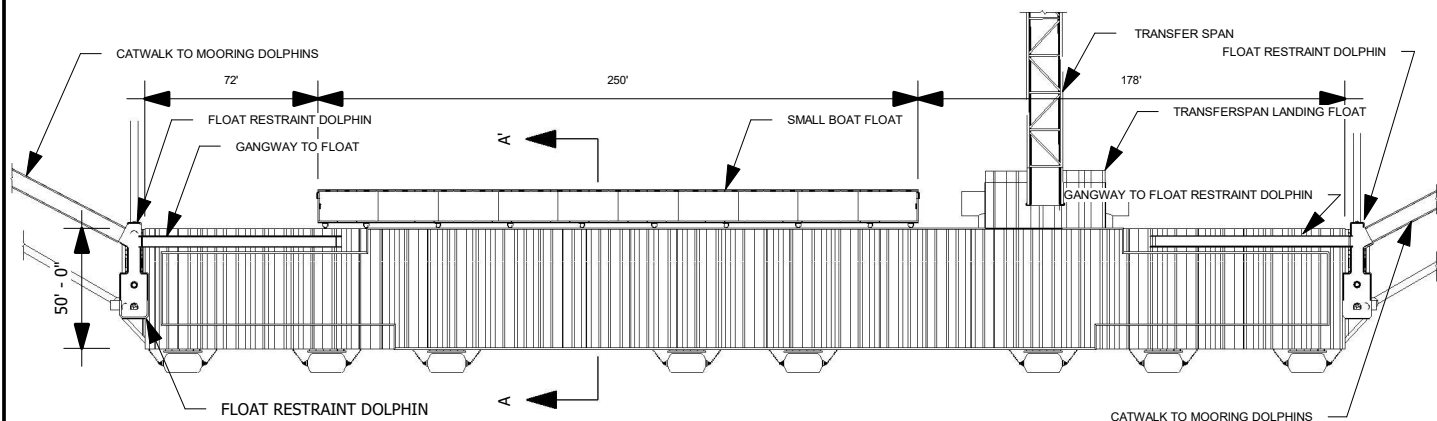

1 500' X 50' FLOATING DOCK PLAN
1" = 80'-0"

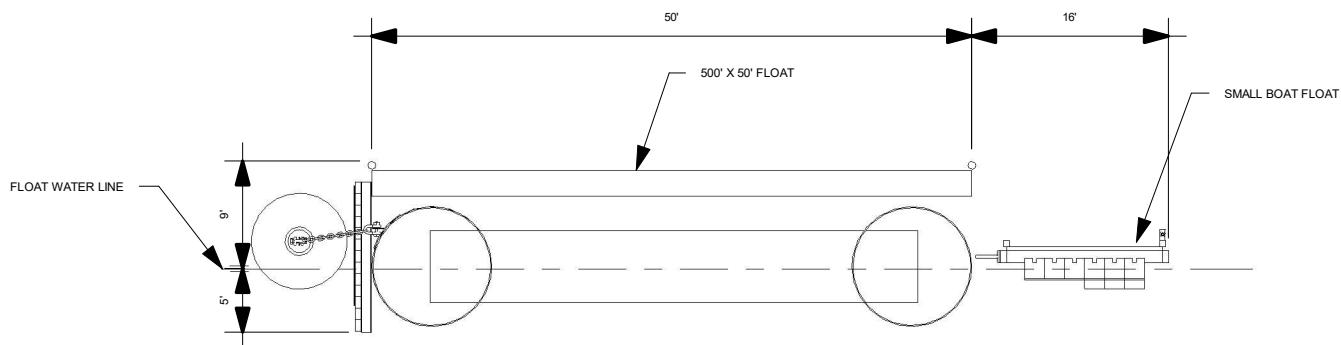

2 TYPICAL FLOATING DOCK SECTION A-A'
1/16" = 1'-0"

PURPOSE:
**DOUGLAS ISLAND
CRUISE SHIP TERMINAL**

SCALE: 1" = VARIES

DATUM:	0.0'	HAT	= +24.0'
		HTL	= +20.6'
		MHW	= +15.3'
		MLLW	= +3.4'

**LARGE
FLOATING
DOCK DETAIL**

JOB NO. 25-002

PROPOSED: **TURNAGAIN MARINE**
AT: **JUNEAU, ALASKA**
WATERWAY: **STEPHENS PASSAGE**
APPLICATION BY: **TURNAGAIN MARINE**
DATE: 29 APRIL 2025 SHEET: 11 OF 22

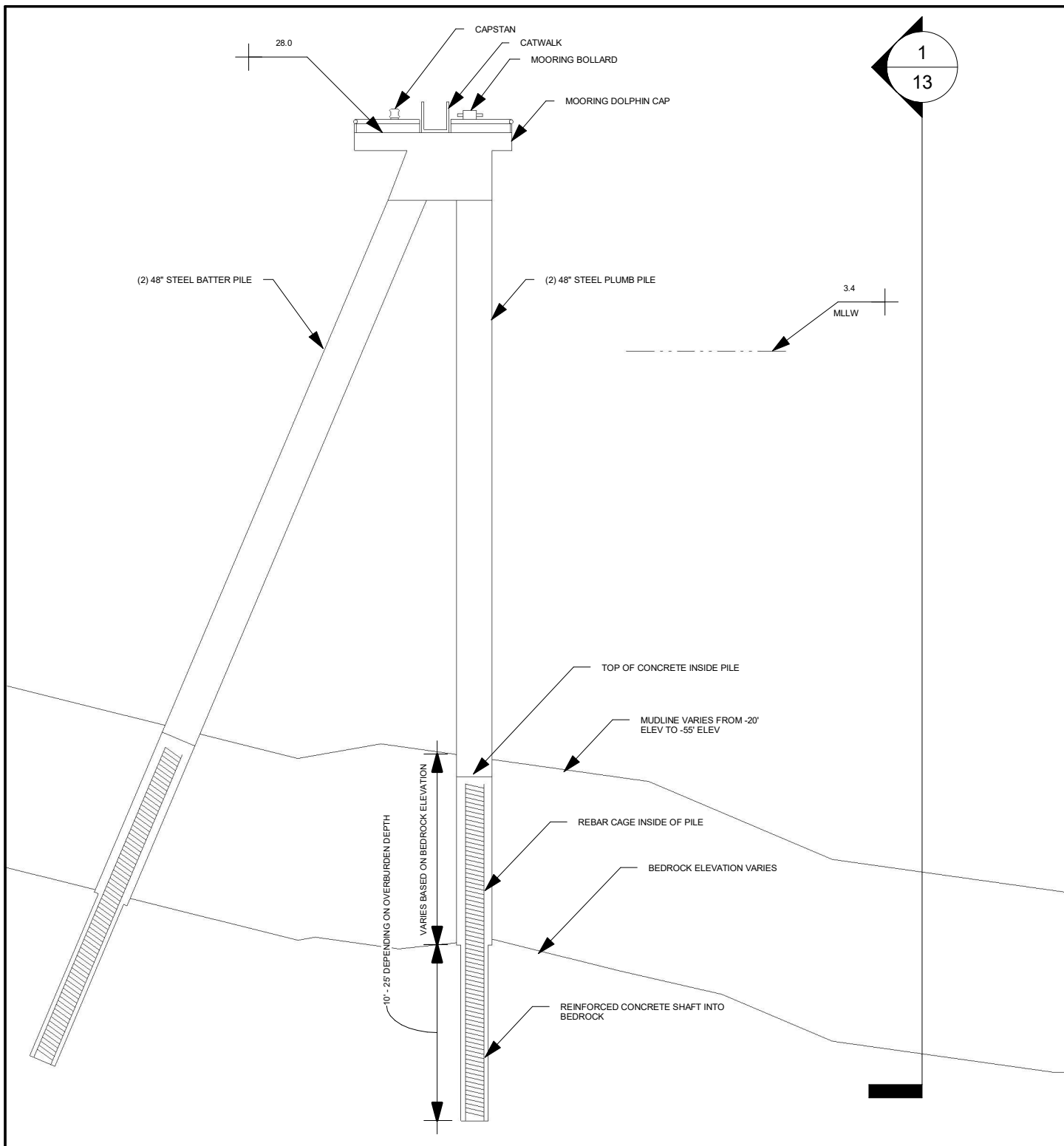

PURPOSE:
DOUGLAS ISLAND
CRUISE SHIP TERMINAL

SCALE: 1" = 16'

DATUM: 0.0' HAT = +24.0'
 HTL = +20.6'
 MHW = +15.3'
 MLLW = +3.4'

TYPICAL MOORING DOLPHIN SECTION

JOB NO. 25-002

PROPOSED: TURNAGAIN MARINE
AT: JUNEAU, ALASKA
WATERWAY: STEPHENS PASSAGE
APPLICATION BY: TURNAGAIN MARINE
DATE: 29 APRIL 2025 SHEET: 12 OF 22

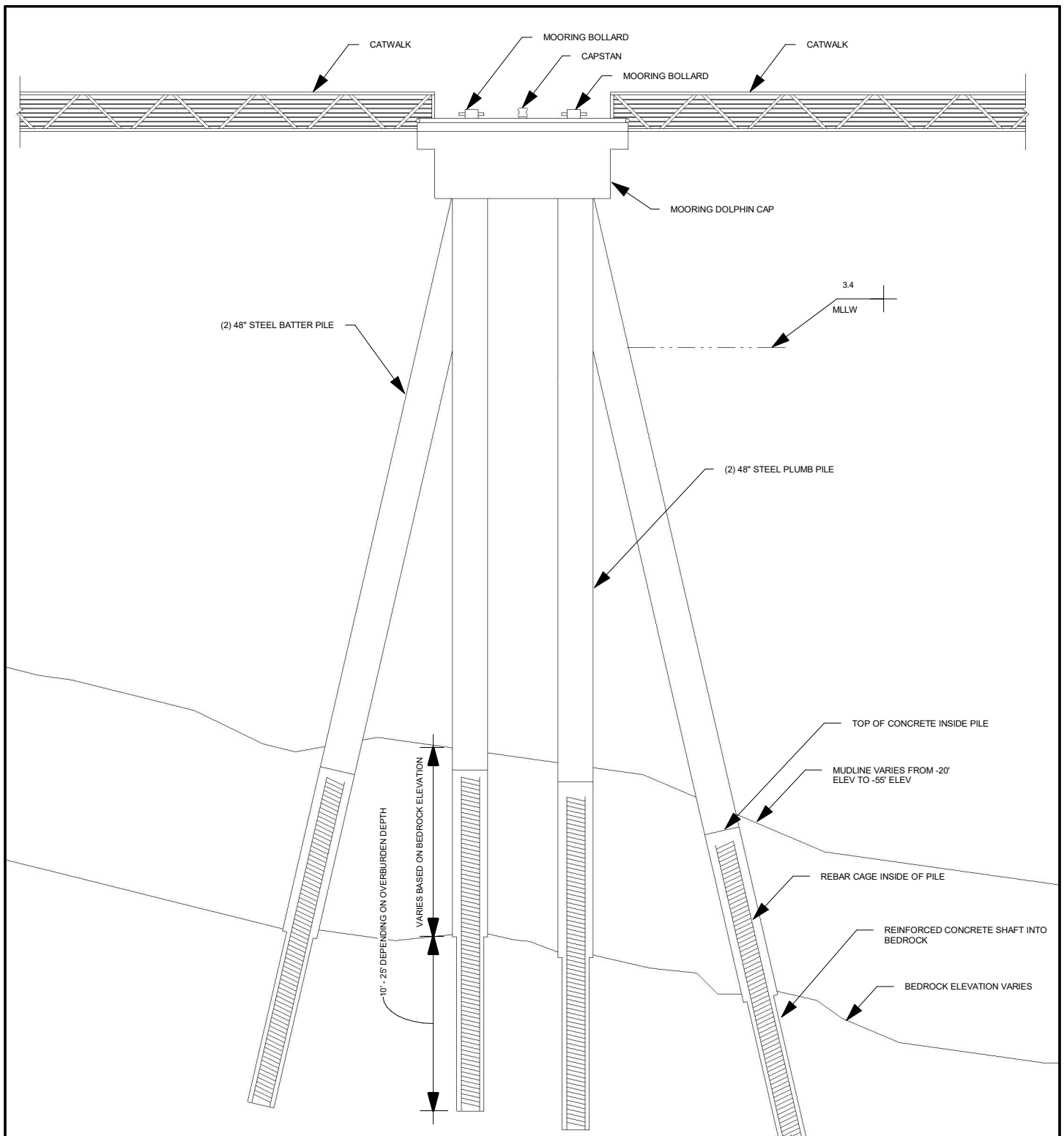

PURPOSE:
DOUGLAS ISLAND
CRUISE SHIP TERMINAL

SCALE: 1" = 16'

DATUM: 0.0' HAT = +24.0'
 HTL = +20.6'
 MHW = +15.3'
 MLLW = +3.4'

TYPICAL
MOORING
DOLPHIN
ELEVATION

JOB NO. 25-002

PROPOSED: TURNAGAIN MARINE
AT: JUNEAU, ALASKA
WATERWAY: STEPHENS PASSAGE
APPLICATION BY: TURNAGAIN MARINE
DATE: 29 APRIL 2025 SHEET: 13 OF 22

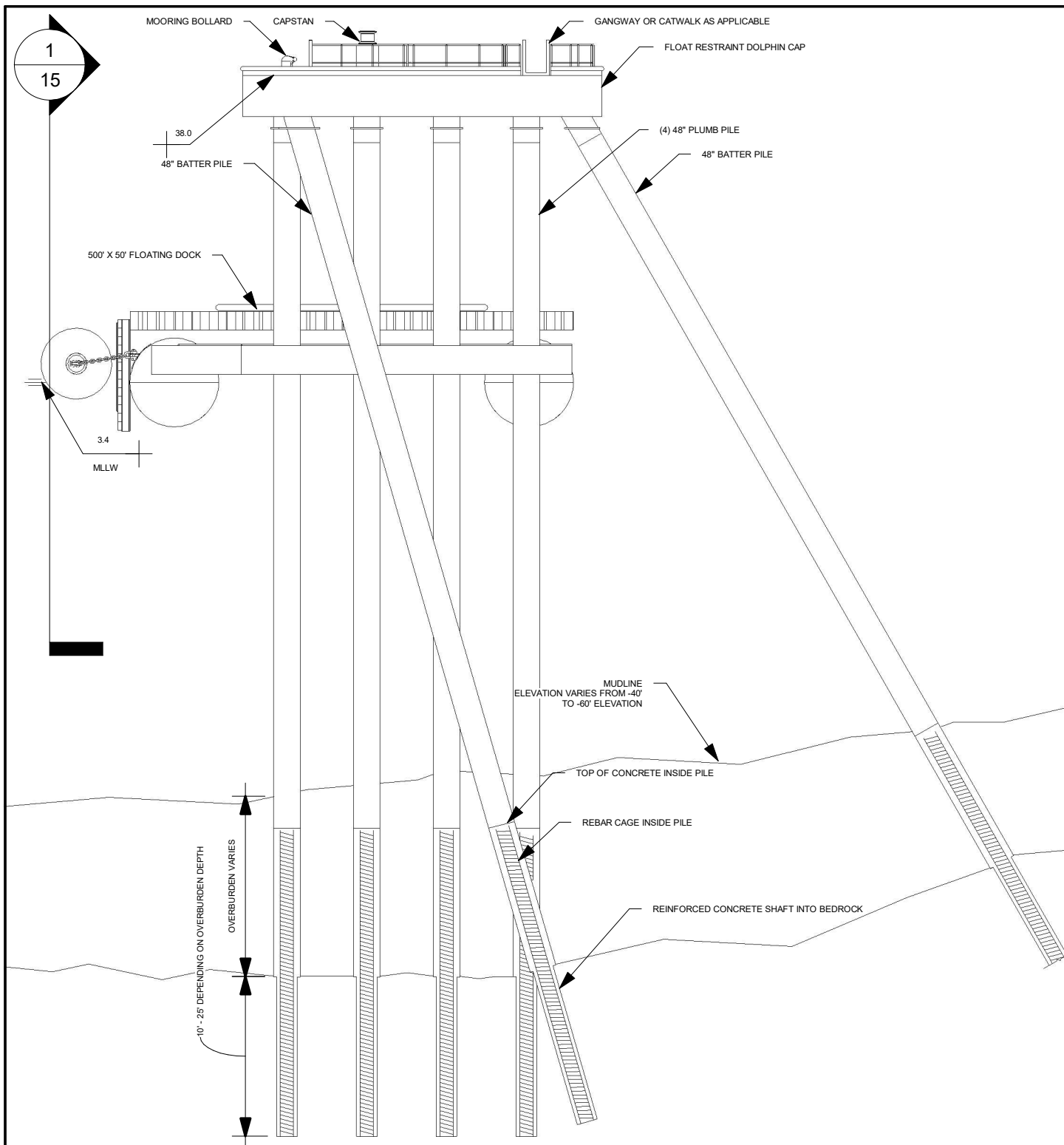

PURPOSE:

**DOUGLAS ISLAND
CRUISE SHIP TERMINAL**

SCALE: 1" = 16'

DATUM:	0.0'	HAT	= +24.0'
		HTL	= +20.6'
		MHW	= +15.3'
		MLLW	= +3.4'

**TYPICAL FLOAT
RESTRAINT
DOLPHIN
SECTION**

JOB NO. 25-002

PROPOSED:

TURNAGAIN MARINE

AT:

JUNEAU, ALASKA

WATERWAY:

STEPHENS PASSAGE

APPLICATION BY:

TURNAGAIN MARINE

DATE: 29 APRIL 2025

SHEET: 14 OF 22

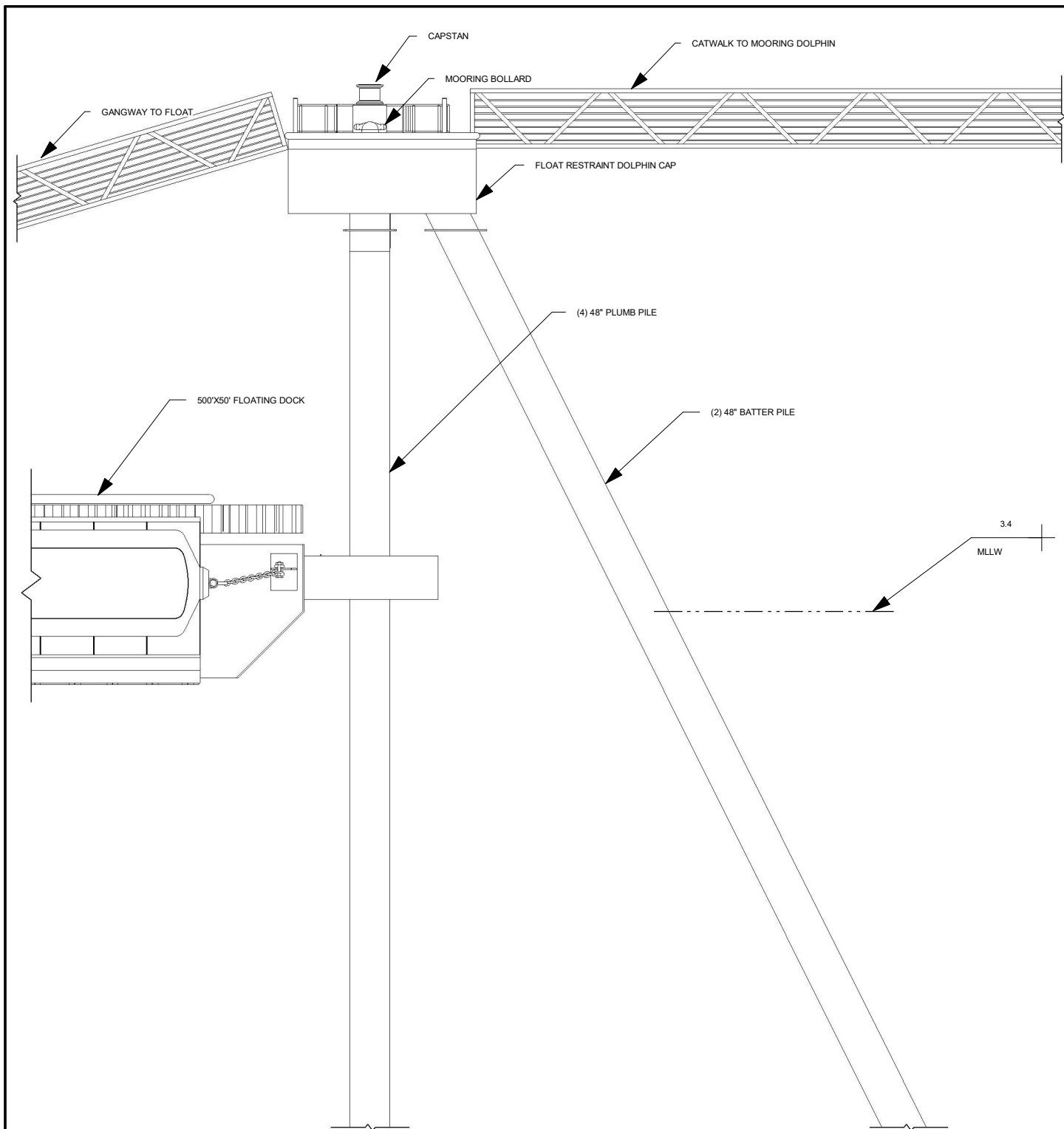

PURPOSE:
DOUGLAS ISLAND
CRUISE SHIP TERMINAL

SCALE: 1" = 10' - 8"

DATUM:	0.0'	HAT	= +24.0'
		HTL	= +20.6'
		MHW	= +15.3'
		MLLW	= +3.4'

TYPICAL FLOAT
RESTRAINT
DOLPHIN
ELEVATION

JOB NO. 25-002

PROPOSED:	TURNAGAIN MARINE
AT:	JUNEAU, ALASKA
WATERWAY:	STEPHENS PASSAGE
APPLICATION BY:	TURNAGAIN MARINE
DATE:	29 APRIL 2025
SHEET:	15 OF 22

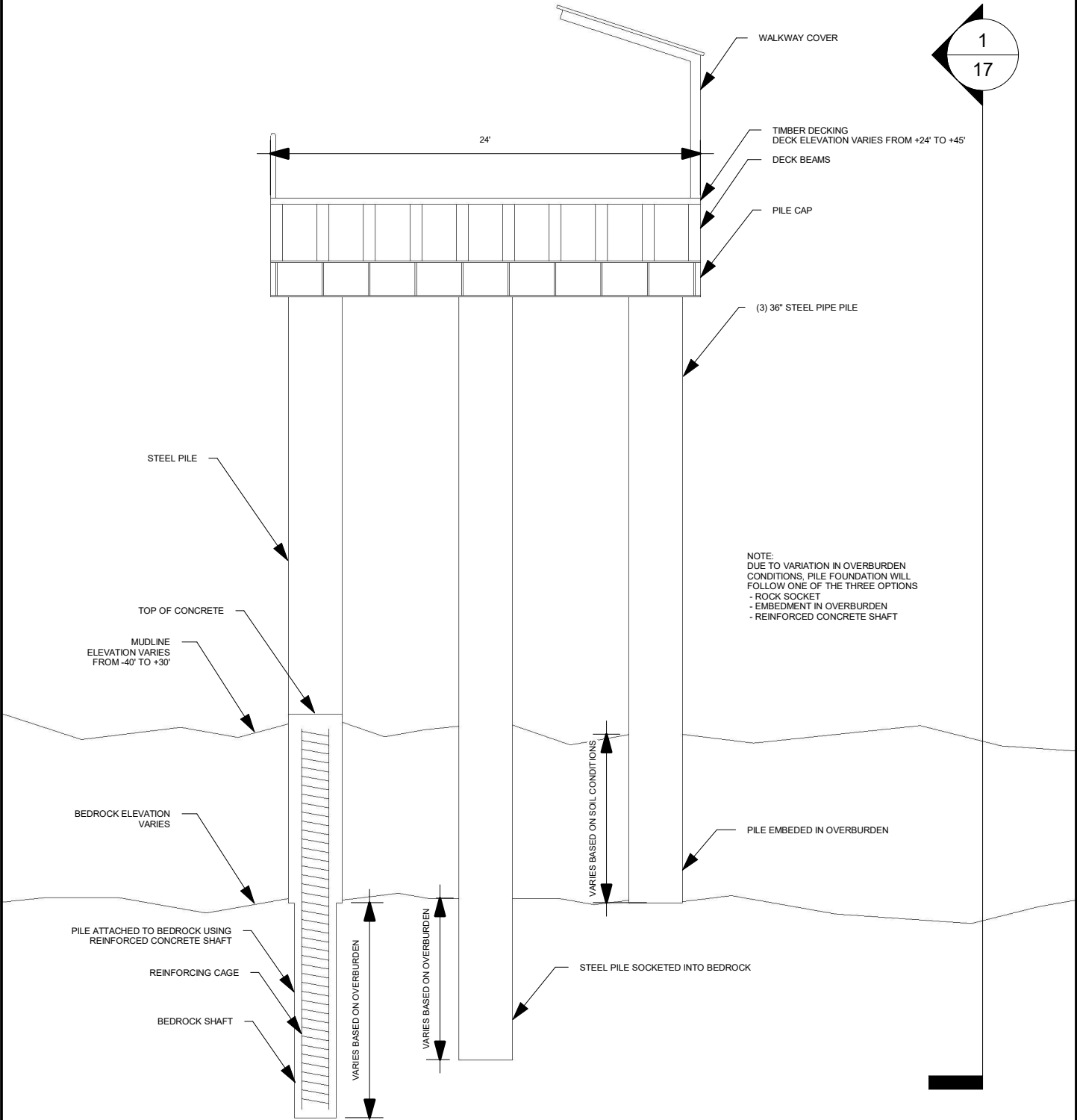

PURPOSE:

DOUGLAS ISLAND
CRUISE SHIP TERMINAL

SCALE: 1" = 8'

DATUM: 0.0'

HAT = +24.0'

HTL = +20.6'

MHW = +15.3'

MLLW = +3.4'

3 PILE TYPICAL
TRESTLE
SECTION

JOB NO. 25-002

PROPOSED:

TURNAGAIN MARINE

AT:

JUNEAU, ALASKA

WATERWAY:

STEPHENS PASSAGE

APPLICATION BY:

TURNAGAIN MARINE

DATE: 29 APRIL 2025

SHEET: 16 OF 22

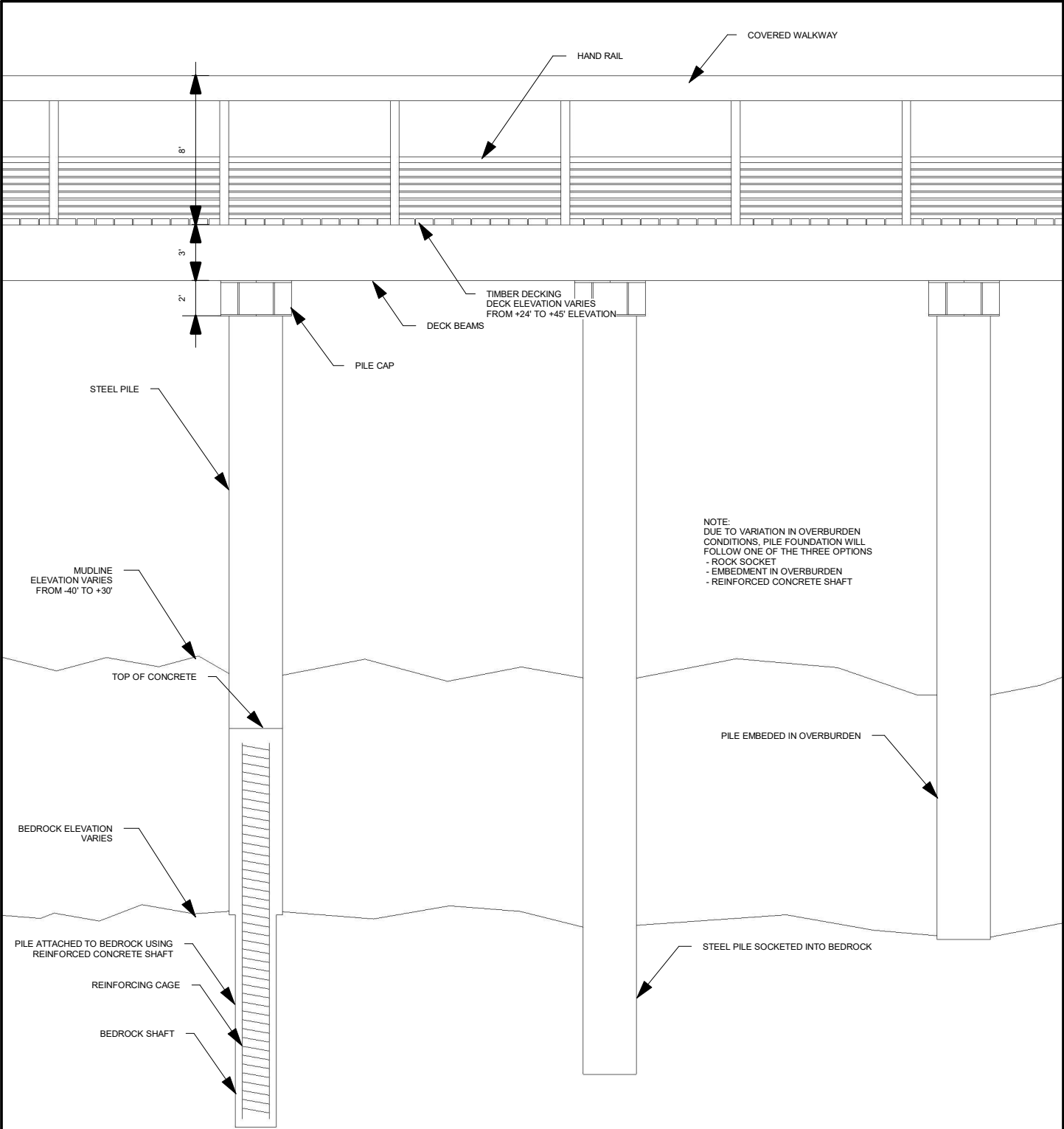

PURPOSE:
**DOUGLAS ISLAND
CRUISE SHIP TERMINAL**

SCALE: 1" = 8'

DATUM: 0.0' HAT = +24.0'
 HTL = +20.6'
 MHW = +15.3'
 MLLW = +3.4'

**TYPICAL
TRESTLE
ELEVATION**

JOB NO. 25-002

PROPOSED: **TURNAGAIN MARINE**
AT: **JUNEAU, ALASKA**
WATERWAY: **STEPHENS PASSAGE**
APPLICATION BY: **TURNAGAIN MARINE**
DATE: 29 APRIL 2025 SHEET: 17 OF 22

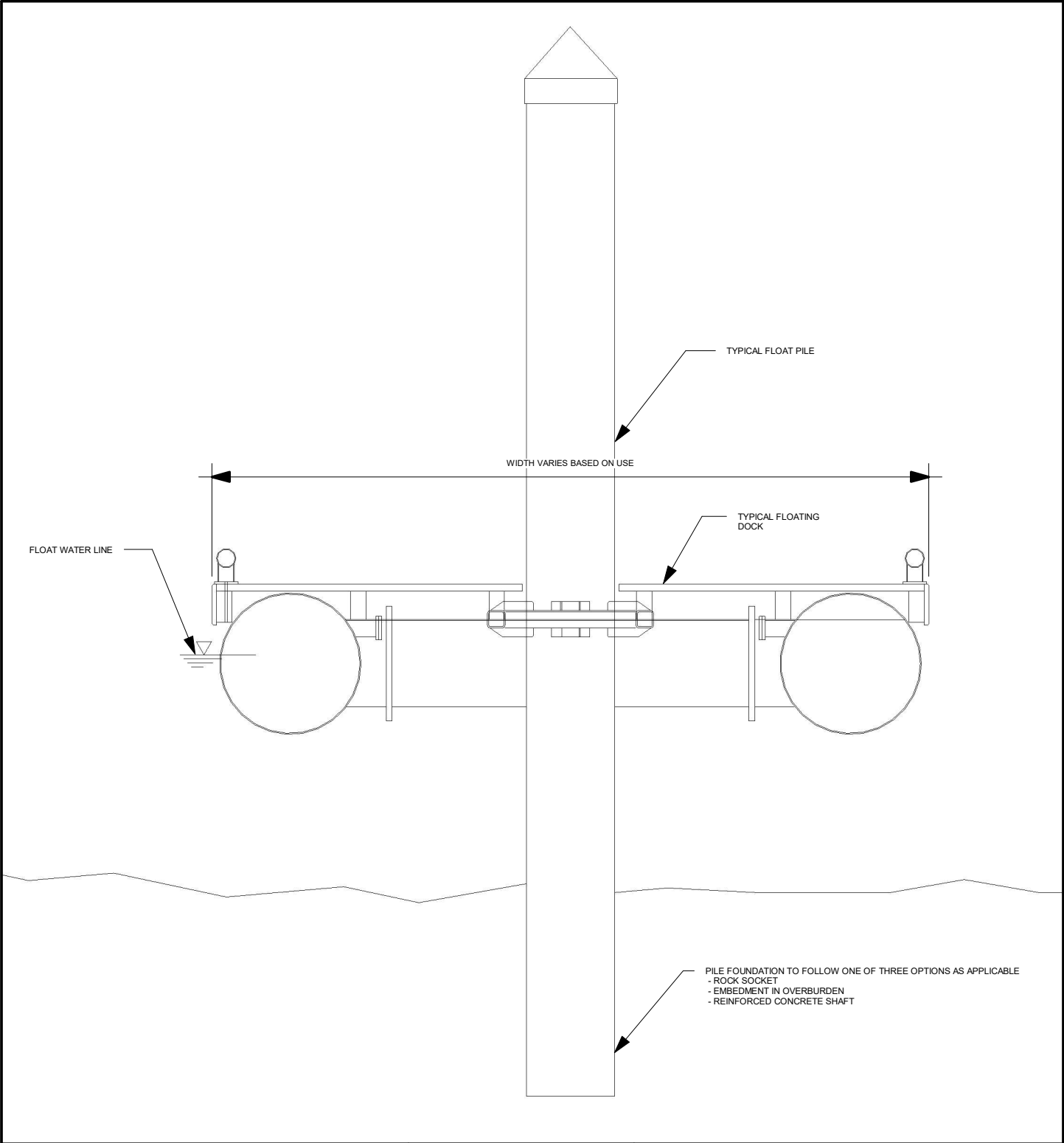

PURPOSE:
**DOUGLAS ISLAND
CRUISE SHIP TERMINAL**

SCALE: 1" = 4'

DATUM:	0.0'	HAT	= +24.0'
		HTL	= +20.6'
		MHW	= +15.3'
		MLLW	= +3.4'

**TYPICAL SMALL
FLOAT SECTION**

JOB NO. 25-002

PROPOSED: **TURNAGAIN MARINE**
AT: **JUNEAU, ALASKA**
WATERWAY: **STEPHENS PASSAGE**
APPLICATION BY: **TURNAGAIN MARINE**
DATE: 29 APRIL 2025

SHEET: 18 OF 22

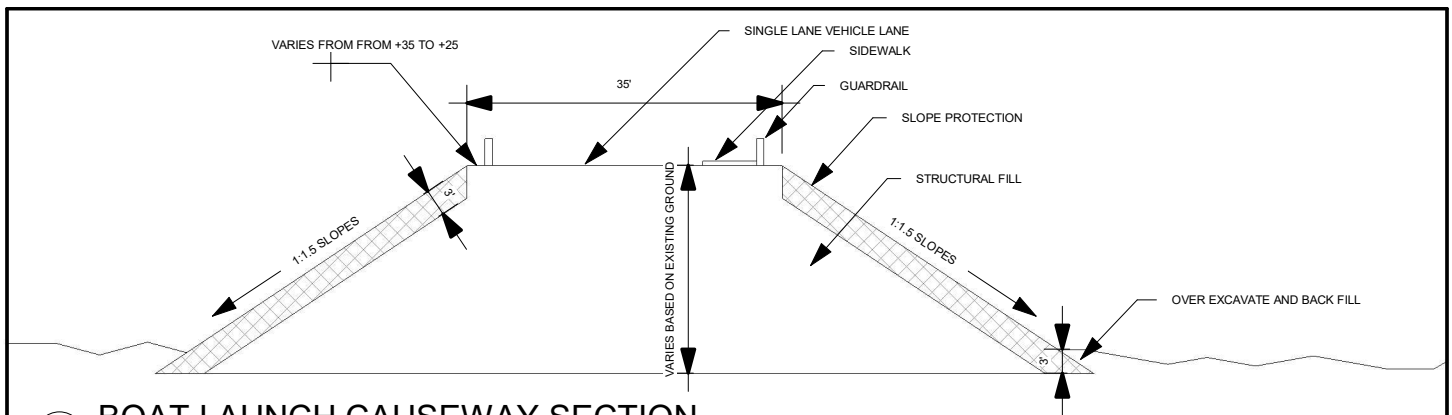

① BOAT LAUNCH CAUSEWAY SECTION
3/64" = 1'-0"

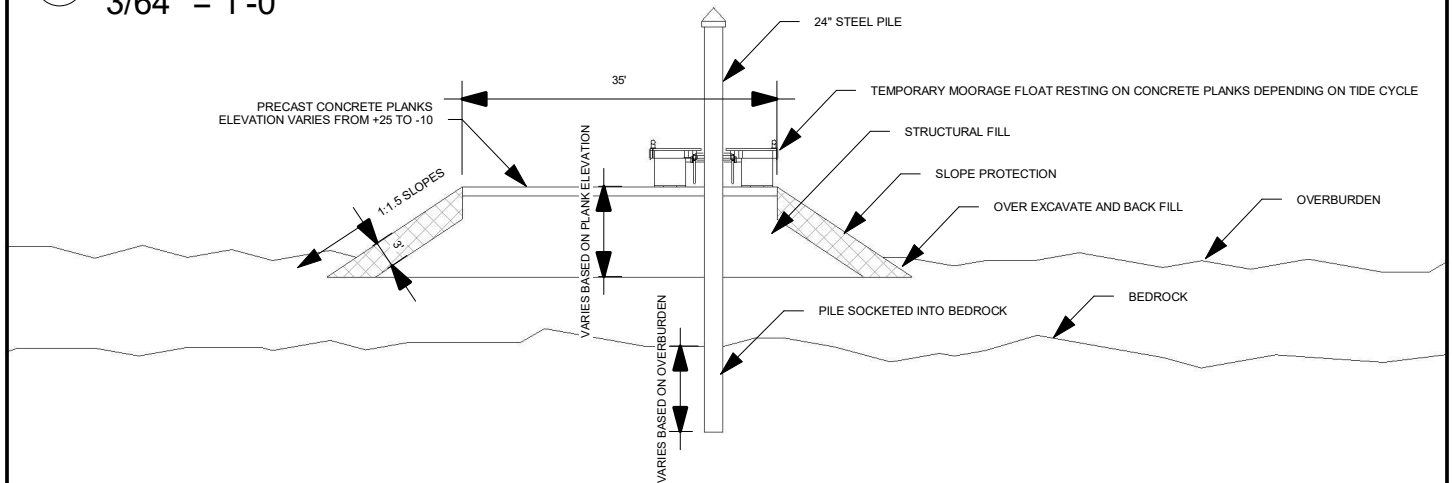

② BOAT LAUNCH SECTION - WITH FLOAT RESTING ON PLANKS
3/64" = 1'-0"

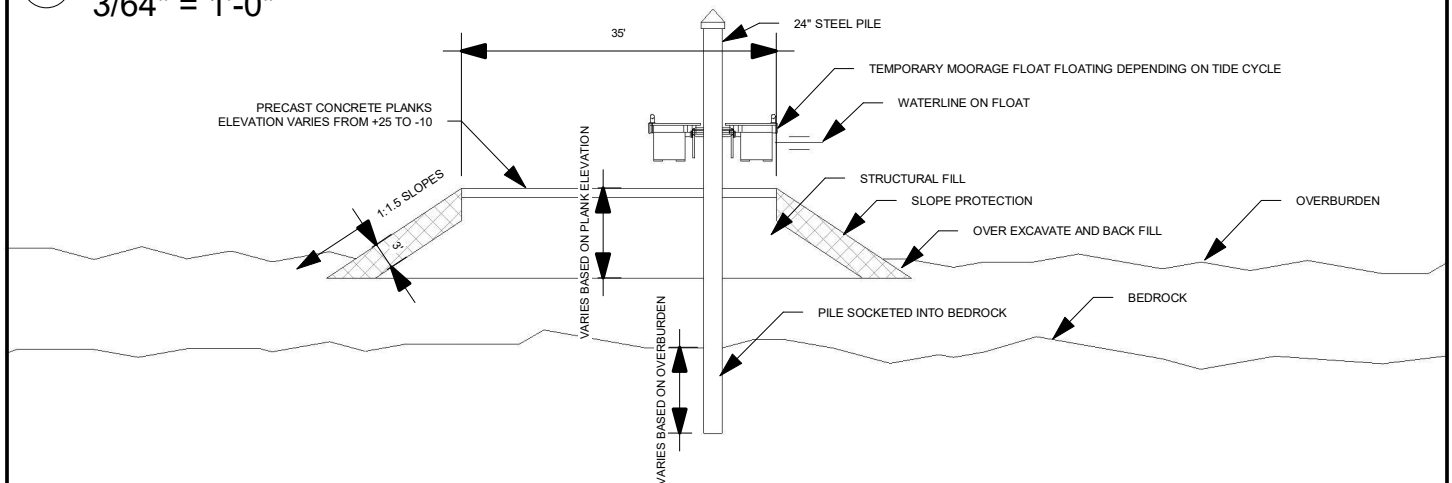

③ BOAT LAUNCH SECTION - WITH FLOAT FLOATING ABOVE PLANKS
3/64" = 1'-0"

PURPOSE:
DOUGLAS ISLAND
CRUISE SHIP TERMINAL

SCALE: 1" = 21' - 4"

DATUM: 0.0' HAT = +24.0'
 HTL = +20.6'
 MHW = +15.3'
 MLLW = +3.4'

BOAT LAUNCH
SECTIONS

JOB NO. 25-002

PROPOSED: TURNAGAIN MARINE
AT: JUNEAU, ALASKA
WATERWAY: STEPHENS PASSAGE
APPLICATION BY: TURNAGAIN MARINE
DATE: 29 APRIL 2025 SHEET: 19 OF 22

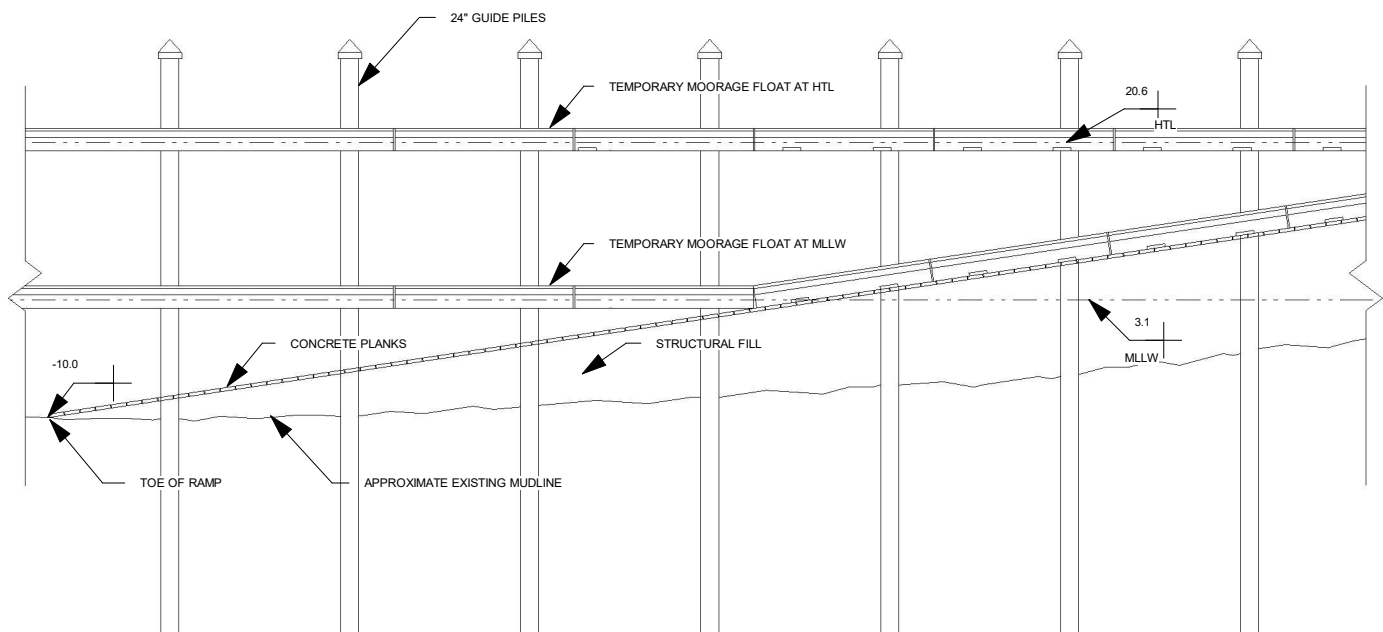

PURPOSE:
DOUGLAS ISLAND
CRUISE SHIP TERMINAL

SCALE: 1" = 21' - 4"

DATUM:	0.0'	HAT	= +24.0'
		HTL	= +20.6'
		MHW	= +15.3'
		MLLW	= +3.4'

BOAT LAUNCH
ELEVATION

JOB NO. 25-002

PROPOSED: TURNAGAIN MARINE
AT: JUNEAU, ALASKA
WATERWAY: STEPHENS PASSAGE
APPLICATION BY: TURNAGAIN MARINE
DATE: 29 APRIL 2025 SHEET: 20 OF 22

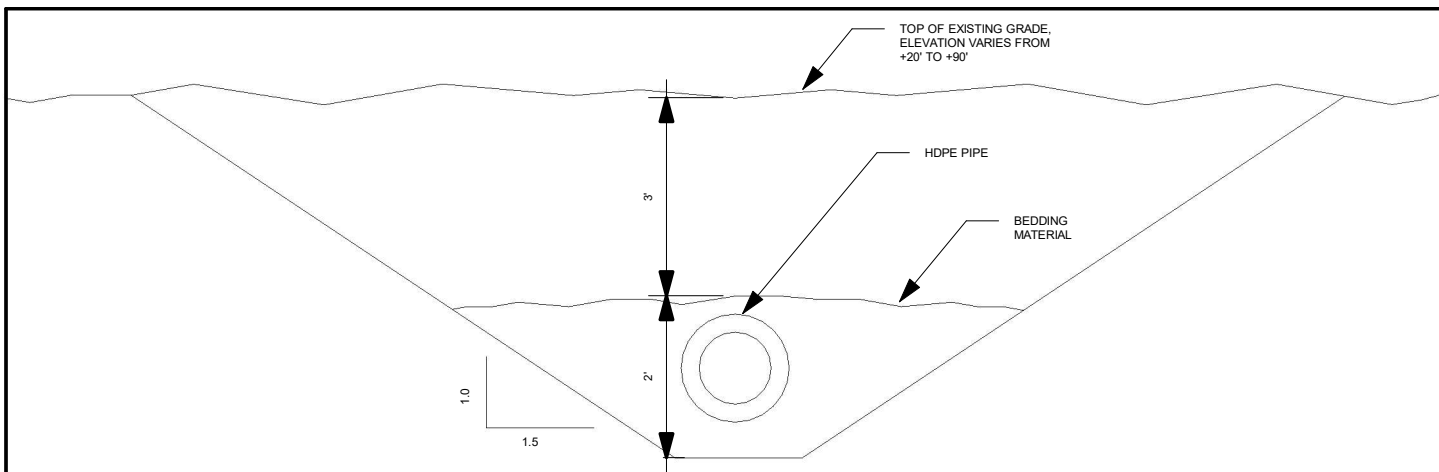

① **BURIED PIPE SECTION**
3/8" = 1'-0"

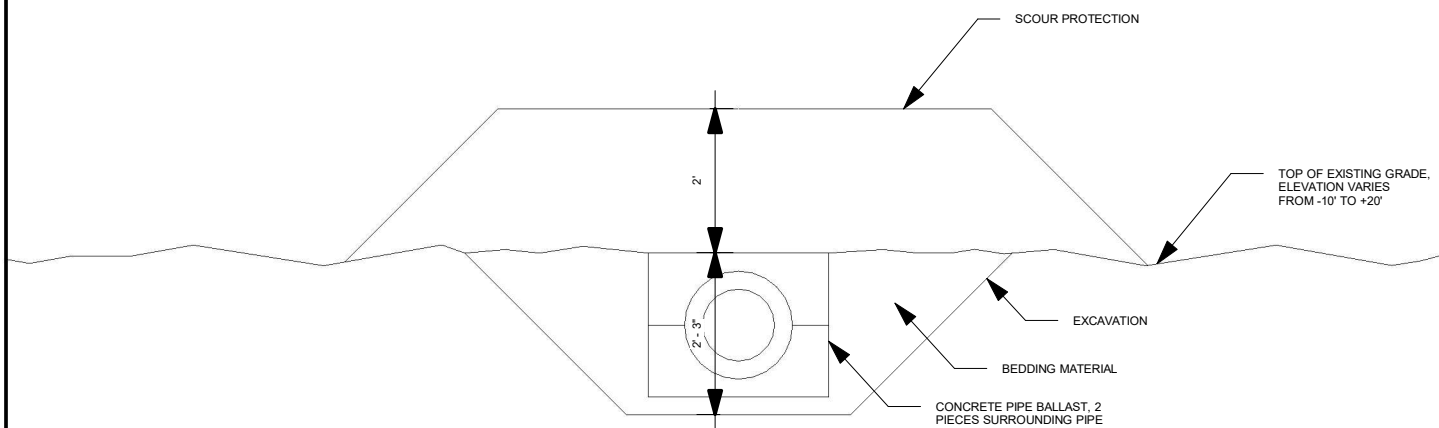

② **INTER-TIDAL PIPE SECTION**
3/8" = 1'-0"

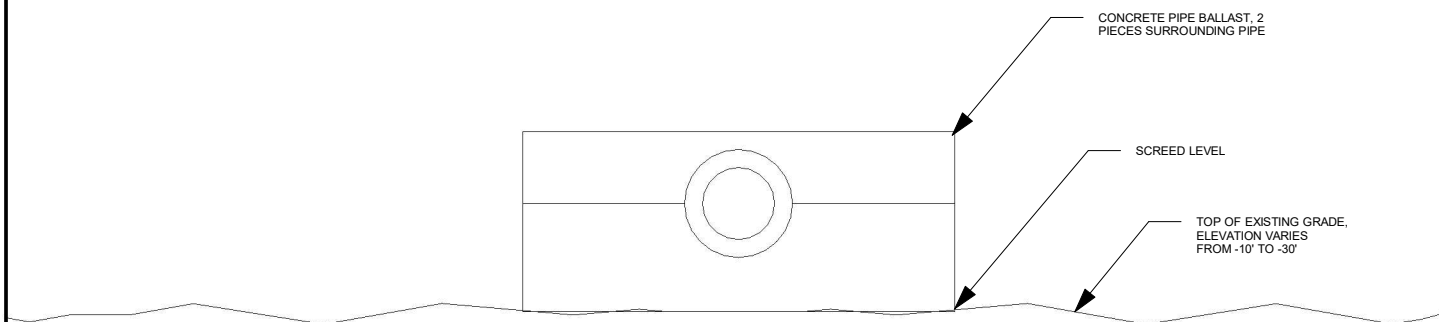

③ **OFFSHORE BALLASTED PIPE SECTION**
3/8" = 1'-0"

PURPOSE:
**DOUGLAS ISLAND
CRUISE SHIP TERMINAL**

SCALE: 1" = 2' - 8"

DATUM: 0.0' HAT = +24.0'
 HTL = +20.6'
 MHW = +15.3'
 MLLW = +3.4'

**INLET OUTFALL
PIPE SECTIONS**

JOB NO. 25-002

PROPOSED: **TURNAGAIN MARINE**
AT: **JUNEAU, ALASKA**
WATERWAY: **STEPHENS PASSAGE**
APPLICATION BY: **TURNAGAIN MARINE**
DATE: 29 APRIL 2025 SHEET: 21 OF 22

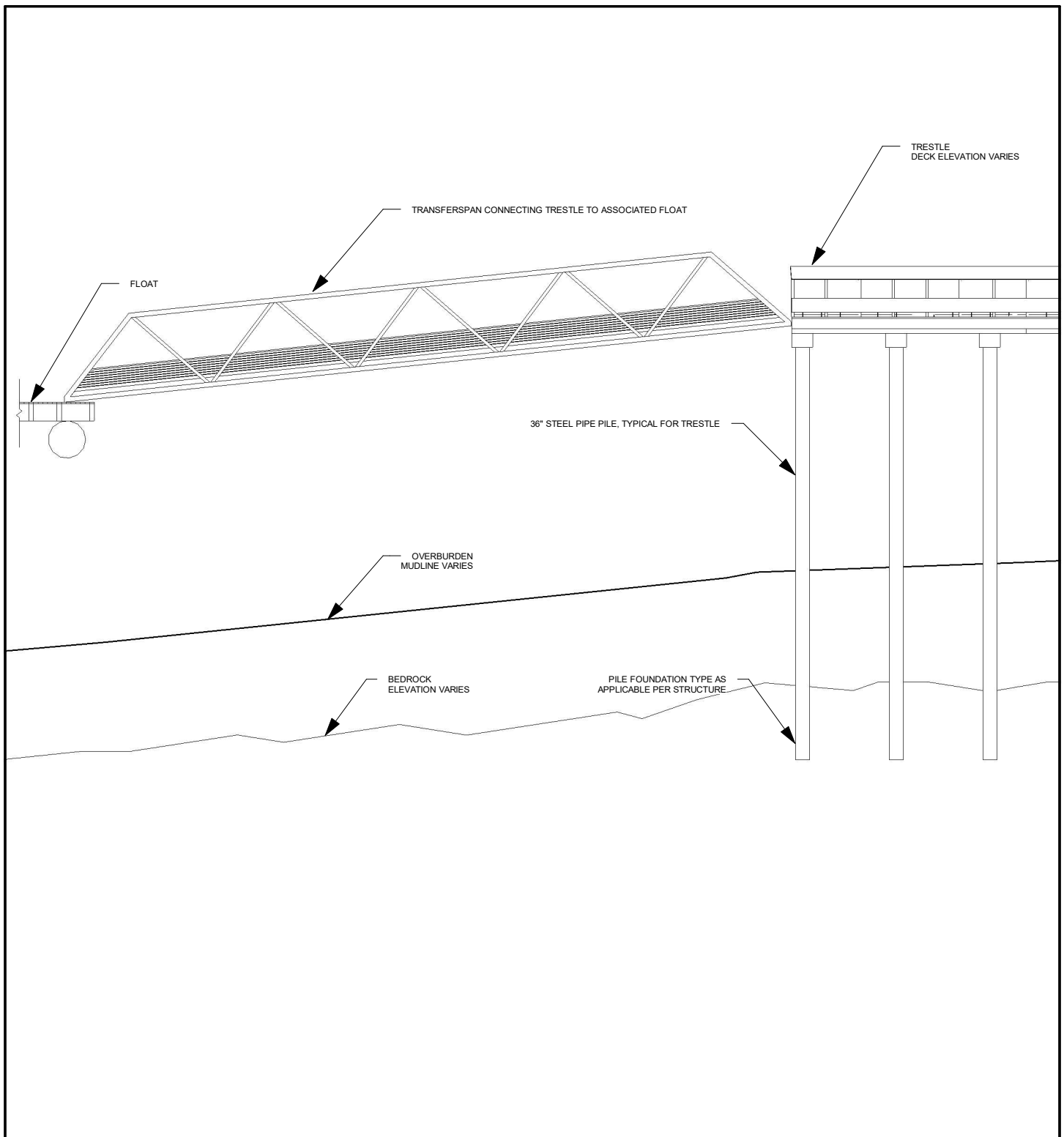

PURPOSE:
DOUGLAS ISLAND
CRUISE SHIP TERMINAL

SCALE: 1" = 30'

DATUM: 0.0' HAT = +24.0'
HTL = +20.6'
MHW = +15.3'
MLLW = +3.4'

TYPICAL
TRANSFERSPAN
OR GANGWAY
ELEVATION

JOB NO. 25-002

PROPOSED: TURNAGAIN MARINE
AT: JUNEAU, ALASKA
WATERWAY: STEPHENS PASSAGE
APPLICATION BY: TURNAGAIN MARINE
DATE: 29 APRIL 2025 SHEET: 22 OF 22