



**PRICE AND METHOD OF PAYMENT**

**A Price Estimate is NOT required with your proposal.** The selected Offeror shall submit a Price Estimate within **one** business day following a request from the Contracting Agency.

**A Price Estimate is required with your proposal.**

A Price Estimate shall include all tasks to perform the contract and be prepared in the format shown below. Note that a Price Estimate is not a bid. It is a negotiable offer. A Fixed Price contract is desirable; however, a Cost Reimbursement contract may result if a Fixed Price cannot be negotiated.

PRICE ESTIMATE FORMAT (if required per above)						
1. *	<u>Direct Costs of Direct Labor</u> (DCDL). Provide a table with the following columns (Names required only for key staff and persons "in-responsible-charge"):					
	<u>Job Classification</u>	<u>Name</u>	<u>Total Hours</u>	<u>Rate (\$/hr) *</u>	<u>Estimated Cost (\$)</u>	<u>Total DCDL \$ _____</u>
2. *	<u>Indirect Costs</u> (IDC).				<b>IDC Rate: _____%</b>	<b>Total IDC \$ _____</b>
3.	<u>Subcontracts</u> . List each, the amount for each and <b>attach an estimate in this format for each.</b>					<b>Total Subcontracts \$ _____</b>
4.	<u>Expenses</u> . (Equipment, transportation, food and lodging, reproduction, etc. - if not included in Indirect Costs.) Amounts shall be based on actual cost to the Offeror, without any profit or other markup. Provide a table with the following columns:					
	<u>Item</u>	<u>Quantity</u>	<u>Cost (\$/Unit)</u>	<u>Estimated Cost (\$)</u>	<b>Total Expenses \$ _____</b>	
5. *	<u>Total Estimated Cost</u> . Sum of DCDL + IDC + Subcontracts + Expenses.					<b>Total Cost \$ _____</b>
6. *	<u>Proposed Fee</u> . List a proposed <b>amount</b> (not a percentage) for profit.					<b>Fee \$ _____</b>
7.	<u>Total Estimated Price</u> . Sum of Total Estimated Cost plus Proposed Fee.					<b>Total Price \$ _____</b>
* Sole proprietorships and small firms that do not maintain an accounting system that separately identifies costs for "payroll" benefits and overhead, for routine allocation of such costs to jobs, may omit items 2, 5, & 6 if the Rates (\$/hr) in Item 1 are proposed as Billing Rates (DCDL + IDC + FEE). <b>Firms that routinely allocate Indirect Costs to projects may not use Billing Rates for this estimate.</b>						

SUBMITTAL DEADLINE AND LOCATION	
DATE: <b>June 24, 2025</b>	PREVAILING TIME: <b>2:00 PM</b> FAX OR EMAIL: <b>(907) 269-8917</b> <b>rangell.soriano@alaska.gov</b>
Hand deliver proposal directly to following location, and person, if named; or email to address above:  Rangell Soriano, P.E. at 550 W. 7 <sup>th</sup> Avenue, Suite 1340; Anchorage, AK 99501	
Late proposals will not be considered. <b>Offerors</b> are responsible to assure timely delivery and receipt and <b>are encouraged to respond at least four business hours prior to the above deadline.</b> Any addendum issued less than 24 hours prior to a Deadline will extend that Deadline by a minimum of an additional 24 hours. The Contracting Agency shall not be responsible for any communication equipment failures or congestion and will not extend the deadline for any proposals not received in their entirety prior to the deadline. Except for hand delivered proposals, confirmation of receipt by telephone or other means four hours or less prior to deadline will <b>not</b> be provided. (An out-of-town/state Offeror may also electronically transmit their proposal to a local personal representative who may reproduce a copy of it and deliver it "in person" to the submittal location prior to the deadline.)	

**BASIS OF SELECTION**

This solicitation does not guarantee that a contract will be awarded. All proposals may be summarily rejected. Our intent, however, is to select a Contractor based on the following criteria:

- 1) Demonstrated comprehension of required services and proposed strategy for performance.
- 2) Relevant experience and credentials of proposed personnel including any subcontractors.
- 3) Reasonableness of proposed schedule for performance.
- 4) Price Estimate (**if** required with proposal).
- 5) Other (specify): **N/A**

Proposals will be evaluated per Chapter 2 of the DOT&PF PSA Manual.

END OF PART A

# PROPOSED STATEMENT OF SERVICES APPENDIX B

<b>PSA No:</b>	<b>71043-4</b>
<b>IRIS Program No:</b>	N/A
<b>Federal Project No:</b>	N/A
<b>Date Prepared:</b>	6/3/25

## Byers Lake Campground and Outlet Bridge Geotechnical Investigation

### ARTICLE B1 INDEX

<u>Article</u>	<u>Subject</u>
B2	Exhibits
B3	Codes, Regulations, Standards, and Procedures
B4	Administrative Requirements
B5	Project Description and Location
B6	Summary of Contract Services
B7	Management
B8	Geotechnical Investigation

### ARTICLE B2 EXHIBITS

<u>Exhibits</u>	<u>Subject</u>
B-1	Exhibit 1: Vicinity Map
B-2	Exhibit 2: Campground Site Map
B-3	Exhibit 3: Outlet Bridge Existing Conditions
B-4	Exhibit 4: Outlet Bridge Photos
B-5	Exhibit 5: Excerpt from Byers Lake Geotech Report (2016)
B-6	Exhibit 6: Excerpt From Mat-Su Soil Report (1994)

### ARTICLE B3 CODES, REGULATIONS, STANDARDS, AND PROCEDURES

**B3.1 General.** All studies, reports, and design services shall be performed in accordance with applicable codes, regulations, standards, professional practice procedures, and commonly recognized construction methods. The Contractor shall consider the geographical location of the project as well as other environmental and site-specific constraints when performing services for this project.

**B3.2 Units of Measurement.** Standard U.S. units of measurements shall be used throughout development of the project.

### ARTICLE B4 ADMINISTRATIVE REQUIREMENTS

**B4.1 General.** The Contractor shall provide services as identified and authorized by sequentially numbered

Notices-to-Proceed. The Contractor shall not perform services or incur billable expense except as authorized by an NTP.

**B4.2 Project Staff.** All services must be performed by or under the direct supervision of the following individuals:

<u>Name</u>	<u>Project Responsibilities</u>
	[TBD]

Replacement of, or addition to, the Project Staff named above shall be accomplished only by prior written approval from the Contracting Agency.

**B4.3 Professional Registration.** All reports, plans, specification, estimates and similar work products provided by the Contractor shall be prepared by or under the supervision of the Registered Alaskan Engineer or Land Surveyor in responsible charge for the services. These Engineers or Land Surveyors shall be currently registered in the State of Alaska and they shall sign, seal and certify as to the accuracy of each final work product for which they are responsible.

**B4.4 Billing Reports.** The Contractor shall provide a two-page (typical) report with each monthly billing for months in which services are performed. The report shall specifically describe the services and other items **for which the billing is submitted** and shall estimate the percentage the services are complete. Any delayed costs from previous billing periods that are included in the current billing must be clearly explained in the report.

**B4.5 Correspondence.** All correspondence prepared by the Contractor shall bear the Contracting Agency's assigned Project name and number.

**B4.6 Documents and Reports** shall be printed with solid black letters that are double spaced on white, 8.5-inch x 11-inch bond or "Xerox Copy" paper. Other size paper may be used for illustrations if they are folded to 8.5-inch x 11-inch size. Original documents and reports shall be printed on one side of the paper only and shall be ready for copying. Documents and reports shall have no black and white photographs, color photographs, or multicolored graphics except as specifically approved by the Contracting Agency. Original, camera ready, copies of final documents and reports shall be submitted to the Contracting Agency for a check before printing.

**B.4.6.1 Copies.** When the Contract calls for multiple copies of documents or reports, the copies shall be printed on both sides of the paper. However, the cover and pages with approved illustrations, multicolored graphics, or photographs shall be printed on one side of the page only. All copies - except for originals - shall be bound.

**B4.6.2 Page Numbers.** All documents shall be page numbered to allow every major Section, Chapter, Appendix, etc., to begin on a "right hand," odd numbered page.

**B4.6.3 Covers.** The cover of all documents and reports shall include the following information:

- a. Name of document or report.
- b. Date.
- c. Indicate whether draft or final.
- d. Project Name.
- e. State Project Number.
- f. Prepared for: Alaska Department of Natural Resources, Division of Parks and Outdoor Recreation.
- g. Prepared by: [COMPANY NAME AND ADDRESS]
- h. Map and/or picture of project area.

**B4.7 Contractor Name on Plan Sheets and Documents.** No Contractor logos shall be allowed on any electronic or hard copy document produced for the Contracting Agency. The Contractor company name shall be included in the box above or below the engineer's seal on each plan sheet. Documents produced for the Contracting Agency shall include the Contractor's company name at the bottom right of the first page, cover sheet or title sheet only. Contractor letterhead shall be allowed only as exhibits in document appendices. The Contractor name shall be in the same font as other lettering on the plan sheet or document, shall be 1/16" or less in height on 11"x17" plan sheets, and shall be in the following format:

PLANS DEVELOPED BY:  
[COMPANY NAME AND ADDRESS]

**B4.8 Plans.** Plans shall be submitted on title block provided by the Department. All submittals shall be half size, on 11"x17" plan sheets.

**B4.8.1 Drafting.** All drawings shall be submitted in Autocad, format using the e-transmit feature to capture all peripheral files into one zip file. AutoCAD version shall be the current release or as designated by the Contract Manager. All submissions shall include the Autocad drawing files on thumb drives or external hard drive. An industry standard layering scheme shall be used.

**B4.9 Borehole Logs.** Final logs from the subsurface investigation shall be 8.5" x 11", prepared using software capable of producing logs that are professional looking, consistent in scale, and graphically depict the different soil

types encountered. The software shall be compatible with Autocad for exporting scaled graphic soil profiles. Final log format and appearance shall be approved by the Contract Manager.

**B4.9.1** Copies of the Specifications shall be printed on both sides of the paper and shall be bound with a comb binder. Copies of the estimates shall be single sided. For Reviews, copies of estimates shall be included as the first item behind the cover of the Specifications.

**B4.9.2** All Specifications shall also be submitted on thumb drives as document files for Microsoft Word.

**B4.10 Revisions.** The Contractor shall modify work products in response to direction from the Contracting Agency. Corrections, adjustments, or modifications necessitated by the review/approval process, but which do not substantially affect the scope, complexity, or character of the services, shall be considered a normal part of the Contractor's services.

**B4.10.1 Errors and Omissions.** Except as described in this Statement of Services, work products shall be essentially complete when submitted to the Contracting Agency. Work products having significant errors or omissions will not be accepted until such problems are corrected.

**B4.10.2 Review Meetings.** Following each review, the Contracting Agency will provide written comments and may hold a meeting to discuss the issues. The Contractor's personnel who are in-responsible-charge for the work products under review shall attend the meeting and may be asked to interpret and provide explanations of the content.

**B4.10.3 Comment Resolution.** The Contractor shall provide a written response with subsequent submittals that address all written and oral comments from the Contracting Agency. All changes from previous submittals shall be clearly explained.

**B4.11 Reproduction and Distribution.** When the contract requires only the original or only one copy of a work product to be delivered, the Contracting Agency will reproduce and distribute any other copies required. Items delivered for reproduction shall be organized and camera-ready for copying and not stapled or otherwise bound.

## **ARTICLE B5** **PROJECT DESCRIPTION AND LOCATION**

**B5.1** The Department of Natural Resources, Division of Parks and Outdoor Recreation (DPOR) is planning improvements to its Byers Lake facility to include replacing a collapsed bridge crossing across Byers Creek at the outlet end of Byers Lake and paving the campground and boat launch areas.

The existing outlet bridge has fallen into a state of disrepair to the point that repair efforts are impractical and

a new bridge is more desirable. The existing bridge consists of nine 20-foot +/- spans founded on seven cylindrical, rock-filled gabion piers. In one location the bridge is situated on a large boulder. Exhibits B-3 and B-4 illustrate site conditions.

The campground and boat launch areas will be paved. Exhibit B-2 depicts the proposed work at the campground.

The Byers Lake facility is located off Parks Highway MP 146 adjacent to the Alaska Veterans Memorial Wayside (SM, T31N, R04W, Sec 30). The campground can be accessed by standard drilling equipment. The outlet bridge (coordinates 62°44'54"N, 150°05'28"W) is accessible by a 2-foot wide, non-motorized trail; via watercraft on Byers Lake; or by air with a helicopter.

### **ARTICLE B6** **SUMMARY OF CONTRACT SERVICES**

**B6.1 General.** The Contractor shall provide professional services to include mobilization and demobilization, onsite subsurface investigation, soil sampling and testing, analysis, reporting, and geotechnical engineering recommendations.

### **ARTICLE B7** **MANAGEMENT**

**B7.1 Performance Schedule.** The Contractor shall abide by the schedule submitted, adjusted for the actual Notice to Proceed (NTP) date.

**B7.1.1 Schedule Changes.** Adherence to the Project Schedule is necessary to meet the Contracting Agency's long-term goals and commitments. The Contractor agrees to expend all effort necessary to stay on schedule and meet the contract delivery dates.

**B7.2 Project Coordination.** All coordination and correspondence for the project shall be handled through or with the concurrence of the Contract Manager.

**B7.2.1 Correspondence.** The Contractor shall submit all written material, letters, survey forms, etc., used to communicate information regarding the project to the Contract Manager for review and acceptance prior to its distribution. Copies of all outgoing and incoming correspondence shall be provided to the Contract manager. All outgoing correspondence shall include the project title and state project numbers.

**B7.2.2 Release of Information.** The release of any project-related information must be approved by the Contract Manager.

### **ARTICLE B8** **GEOTECHNICAL INVESTIGATION**

**B8.1 General.** The Contractor shall conform to the latest edition of the Alaska Geotechnical Procedures Manual as published by the Department of Transportation and Public Facilities (DOT&PF).

The Contractor is responsible for due diligence work to evaluate the project site for equipment access.

**B8.2 Subsurface Investigation.** Submit for approval a project specific exploration plan. The plan shall describe the equipment to be used, the number of investigation holes, their locations in relation to the proposed development, and their depth. The plan shall outline all necessary permits, which the Contractor will secure.

Determine the bearing capacity of the soils at bridge location to facilitate decision-making as whether the existing piers can continue to be used for a new bridge (potentially wider suitable for ATV use) or if new abutments are necessary.

Investigate subsurface conditions at the campground and boat launch areas in support of pavement design.

**B8.3 Lab Testing.** At a minimum, determine the gradation, soil classification, and moisture content of all collected samples. Test for organic content of organic soils. Determine the frost-susceptibility of all soil samples collected within 15 feet below ground surface.

**B8.4 Deliverable Items.**

<b><u>Deliverable Item</u></b>	<b><u>Originals</u></b>	<b><u>Copies</u></b>
Draft Report	1 & PDF	0
Final Report	1 & PDF	2



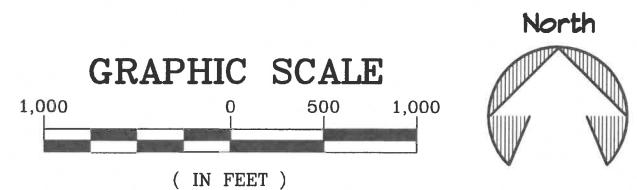
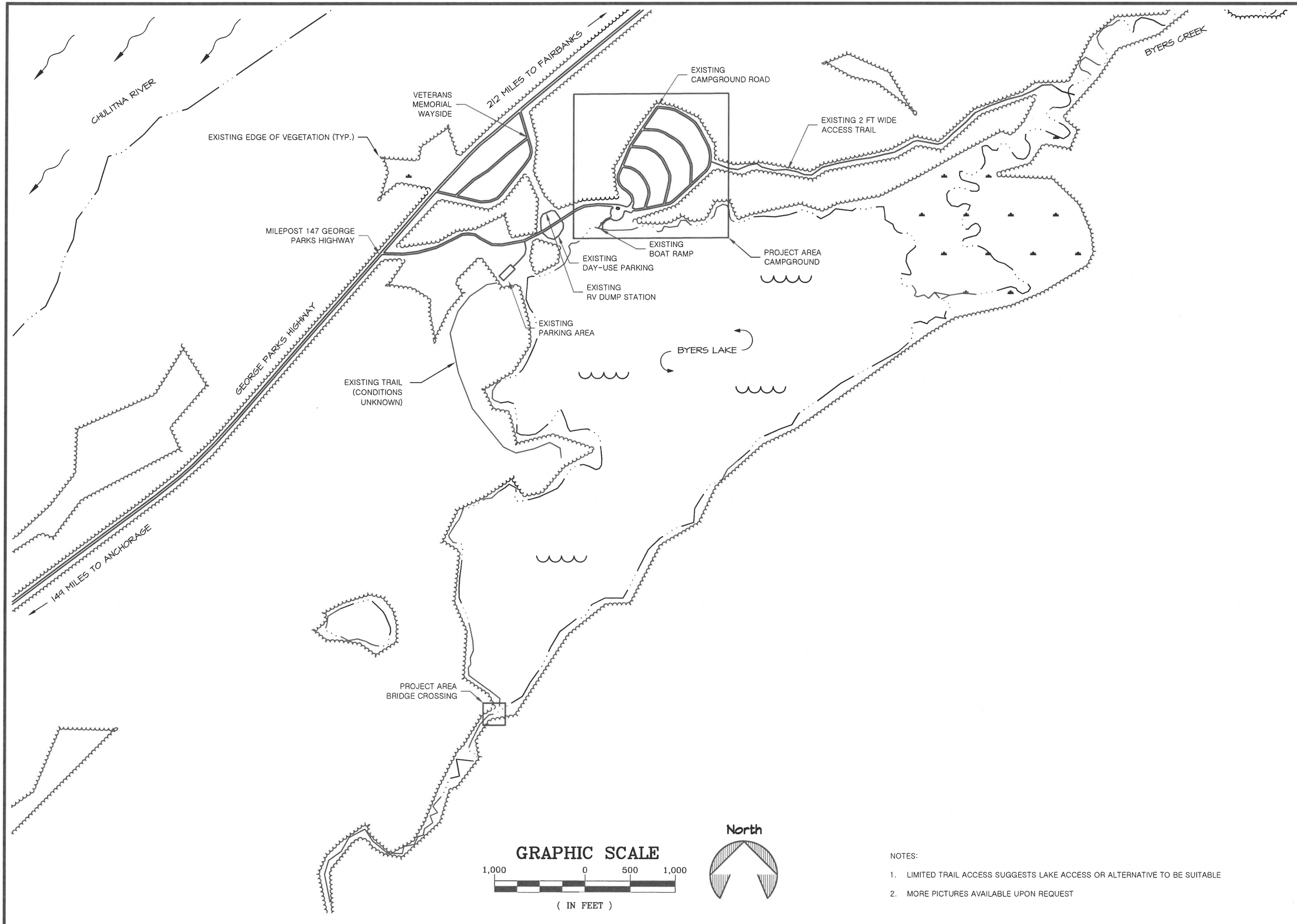

- NOTES:
1. LIMITED TRAIL ACCESS SUGGESTS LAKE ACCESS OR ALTERNATIVE TO BE SUITABLE
  2. MORE PICTURES AVAILABLE UPON REQUEST

**STATE OF ALASKA, DEPARTMENT OF NATURAL RESOURCES**  
**PLANS DEVELOPED BY: DIVISION OF PARKS AND OUTDOOR RECREATION**  
 550 W 7TH AVE. SUITE 1340, ANCHORAGE, AK 99501 - 907.269.8731

BYERS LAKE CAMPGROUND  
 GEOTECHNICAL INVESTIGATION  
 PROJECT No. 71043-4

VICINITY MAP



PREPARED: RCS  
 DRAWN: D&C  
 REVIEWED: D&C  
 DATE: 05/12/2025

SHEET  
**1**  
 OF 1 SHEETS



- NOTES:
1. AERIAL IMAGERY AND TOPOGRAPHIC DATA WERE OBTAINED BY DRONE METHODS ON JUNE 9, 2023 AND ARE INTENDED FOR INFORMATIONAL PURPOSES ONLY.
  2. SCOPE OF WORK NOT SHOWN INCLUDES REPLACING FACILITY-WIDE SIGNS, STRIPING, BULLETIN BOARDS, AND CAMPSITE FURNISHINGS (PICNIC TABLE, FIRE RING, AND CAMPSITE MARKER POST).

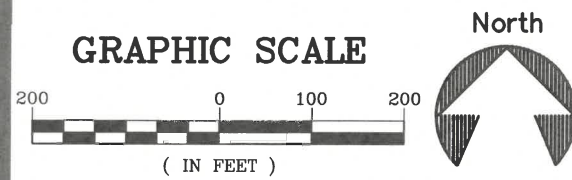
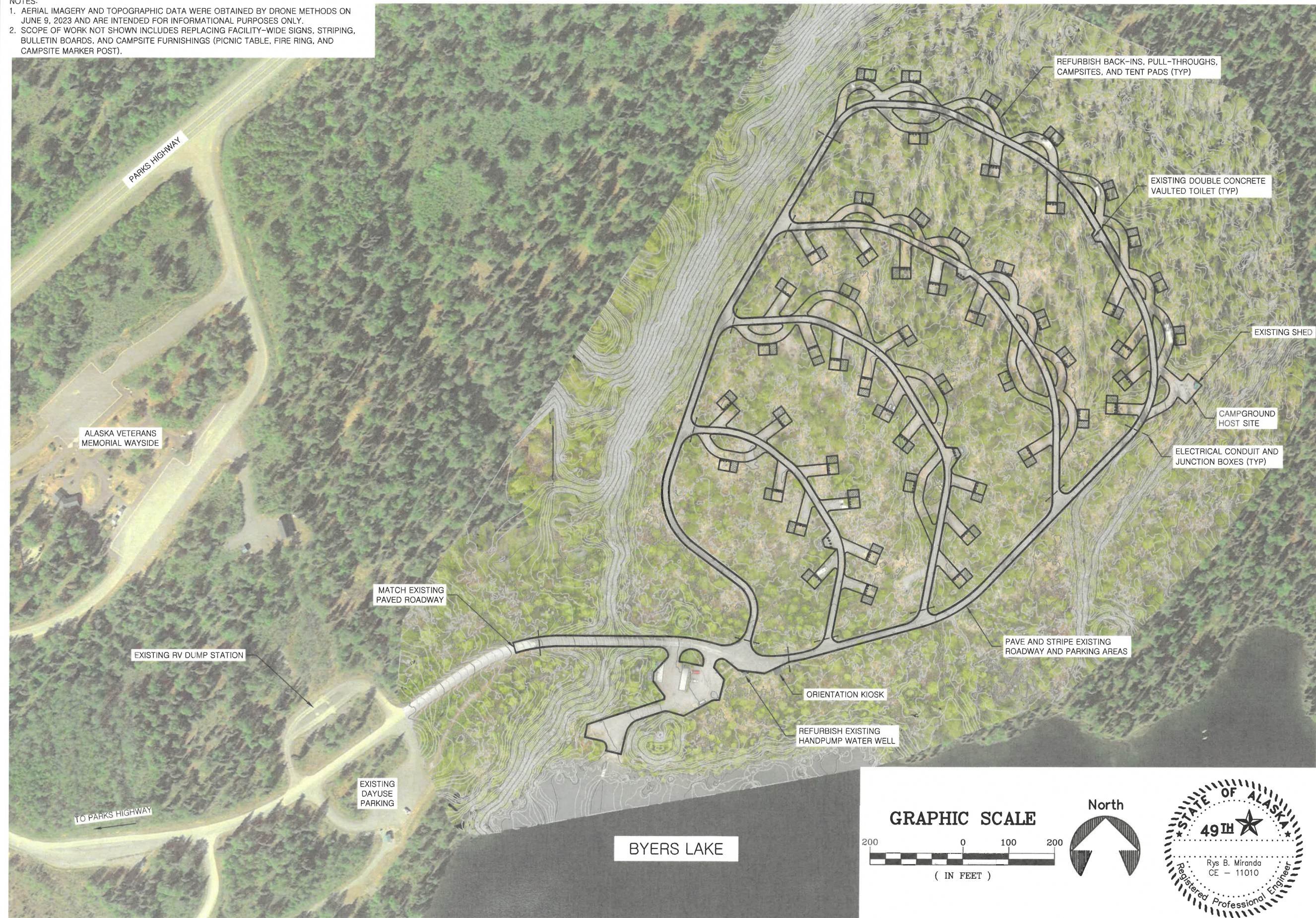

STATE OF ALASKA, DEPARTMENT OF NATURAL RESOURCES  
 PLANS DEVELOPED BY: DIVISION OF PARKS AND OUTDOOR RECREATION  
 550 W 7TH AVE. SUITE 1340, ANCHORAGE, AK 99501 - 907.269.8731

DSP: BYERS LAKE  
 CAMPGROUND IMPROVEMENTS  
 PROJECT NO. 7XXXX-X

CONCEPT SITE PLAN



PREPARED: RBM  
 DRAWN: RBM  
 REVIEWED: D&C  
 DATE: AUGUST 23, 2023

SHEET  
 1  
 OF 1 SHEETS



NOTES:  
 1. AERIAL IMAGERY WAS OBTAINED FROM GOOGLE EARTH AND IS INTENDED FOR INFORMATIONAL PURPOSES ONLY.  
 2. TOPOGRAPHIC AND EXISTING CONDITIONS SURVEY ARE BASED ON LOCAL COORDINATES AND ASSUMED ELEVATION AS CONDUCTED BY ALASKA STATE PARKS ON SEPTEMBER 7, 2017.



EXISTING PIER-DECK CONNECTION



EXISTING BOULDER PIER

BYERS LAKE

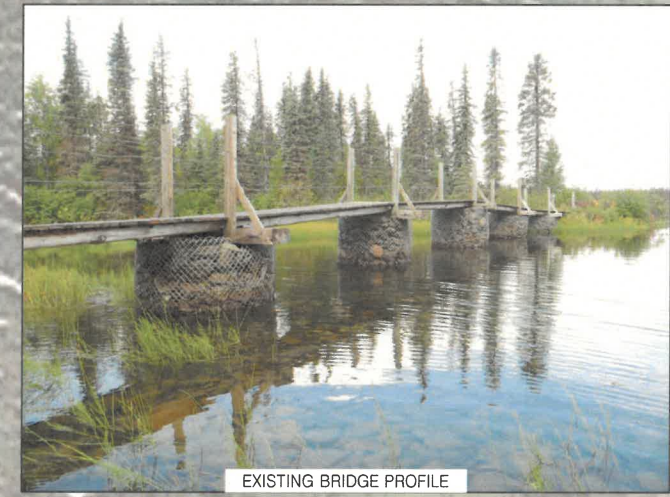

EXISTING BRIDGE PROFILE

5' Ø CHAIN-LINK ENCASED STONE PIER (TYP)

EDGE OF TIMBER DECK

BOULDER PIER

ON-GRADE TIMBER PIER

EDGE OF WATER AS SURVEYED ON 09/07/2017

BYERS CREEK

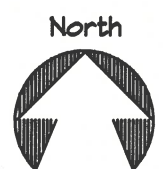
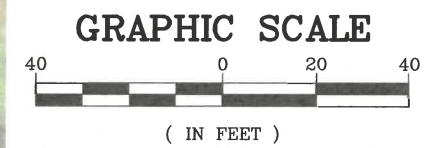

STATE OF ALASKA, DEPARTMENT OF NATURAL RESOURCES  
 PLANS DEVELOPED BY: DIVISION OF PARKS AND OUTDOOR RECREATION  
 550 W 7TH AVE. SUITE 1340, ANCHORAGE, AK 99501 - 907.269.8731

DSP: BYERS LAKE  
 OUTLET BRIDGE REPLACEMENT  
 PROJECT NO. 7XXXX-1

EXISTING CONDITIONS



PREPARED: RBM  
 DRAWN: RBM  
 REVIEWED: D&C  
 DATE: NOVEMBER 2021

SHEET  
 1  
 OF 1 SHEETS



## Byers Lake Outlet Bridge Pictures



Figure 1. Bridge Conditions Facing South (September 7, 2017)



Figure 2. Bridge Conditions Facing North (September 7, 2017)

EXHIBIT B-4 – OUTLET BRIDGE PHOTOS  
Page 2 of 6



Figure 3. Rock Foundation (September 7, 2017)



Figure 4. Side View (September 7, 2017)

EXHIBIT B-4 – OUTLET BRIDGE PHOTOS  
Page 3 of 6



Figure 5. Boulder Foundation (September 7, 2017)



Figure 6. Bridge Underside (September 7, 2017)

EXHIBIT B-4 – OUTLET BRIDGE PHOTOS  
Page 4 of 6



Figure 7. Bridge Ramp Underside (September 7, 2017)



Figure 8. Bridge Closure (June 20, 2020)



Figure 9. Bridge Current Conditions (June 11, 2023)

EXHIBIT B-4 – OUTLET BRIDGE PHOTOS  
Page 6 of 6



Figure 10. Aerial Overview (June 11, 2023)



**REVISED GEOTECHNICAL REPORT**

**For**

**Byers Lake Bridge Design  
Mile 147 Parks Highway, Alaska**

**Prepared By:  
Doug P. Simon, P.E.  
Geotechnical Services Manager**

**HDL ENGINEERING  
Consultants**

3335 Arctic Blvd., Ste. 100  
Anchorage, AK 99503  
Phone: 907.564.2120  
Fax: 907.564.2122

**August 3, 2016**

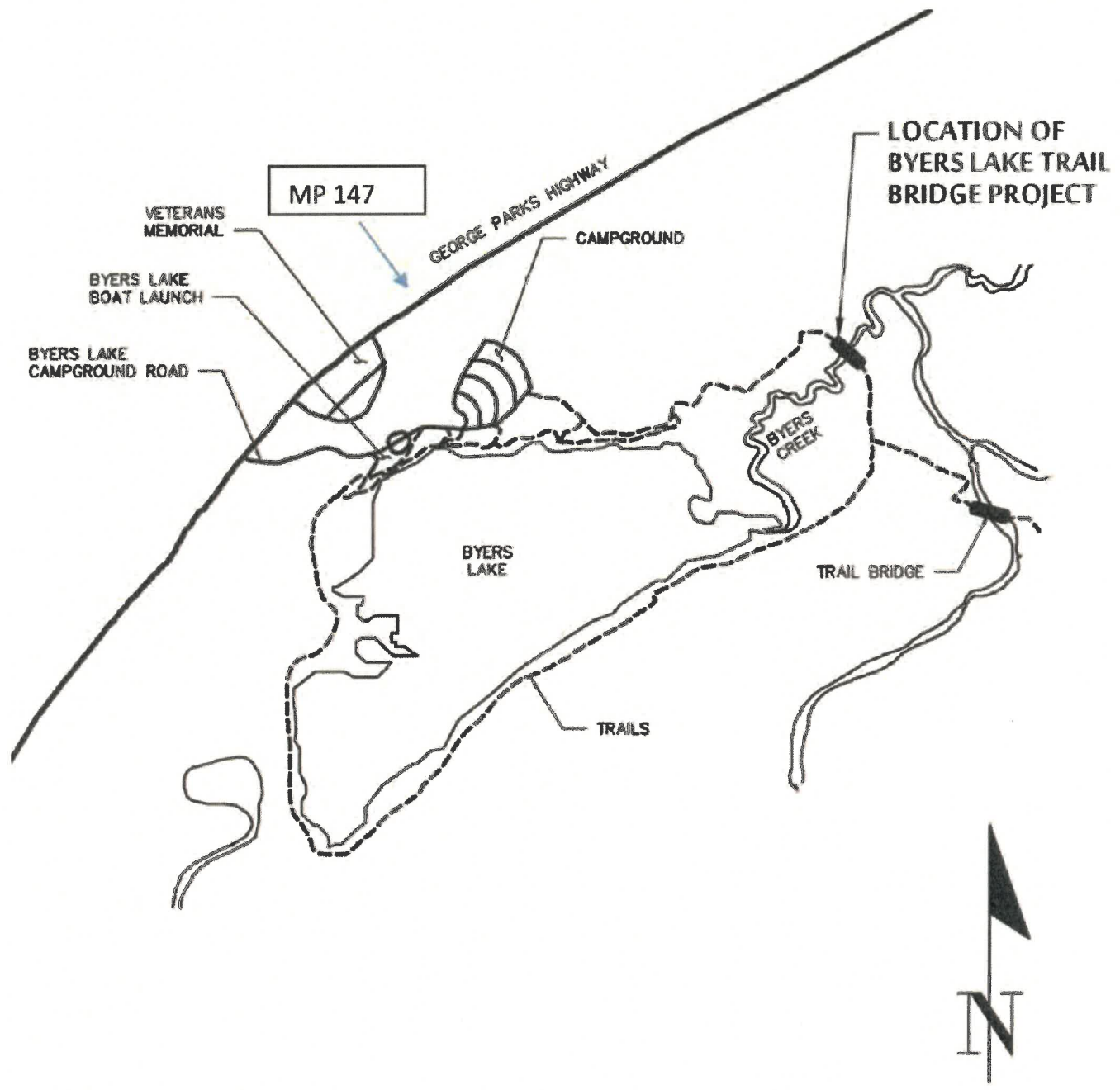

**NOTE:**

TAKEN FROM UNIVERSITY OF ALASKA, ANCHORAGE "FINAL REPORT BYERS LAKE TRAIL BRIDGE" REPORT FROM SPRING 2014.

H:\jobs\14-118 Byers Lake Bridge (GTS)\CAD\Drawings\14-118\_00\_FIG-1, 1=1, 12/10/14 at 11:03 by jkk  
LAYOUT: Layout1

H:\jobs\14-118 Byers Lake Bridge (GTS)\CAD\Drawings\14-118\_00\_FIG-2, 1=1, 12/10/14 at 11:05 by jkk  
LAYOUT: Figure-2

XREF: BASE MAP, BUYER\_LAKE\_CONTOUR, TITLE\_BLOCK

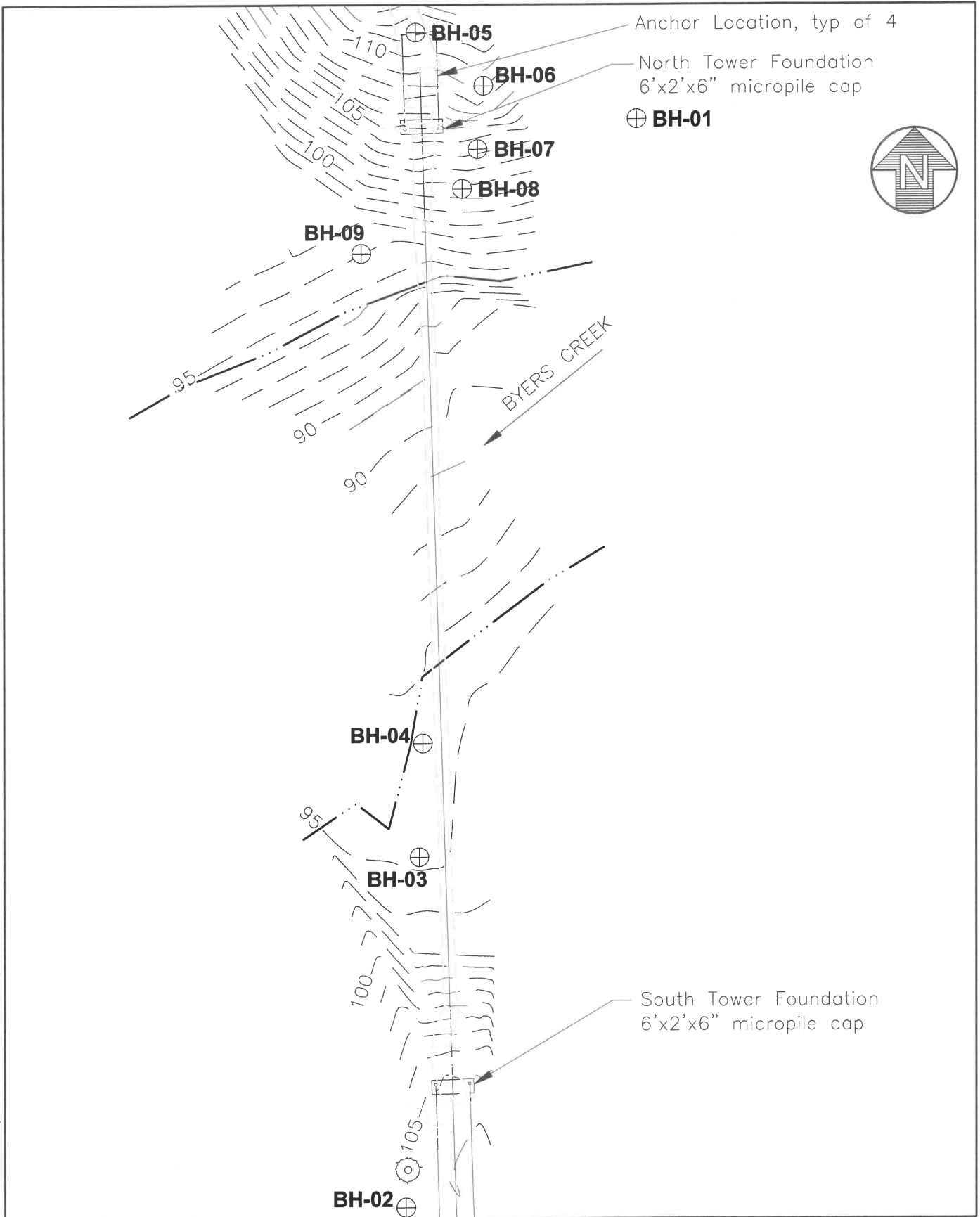

GIESSEL TECHNICAL SERVICES, INC.  
EAGLE RIVER, ALASKA

Figure 2  
**BYERS LAKE BRIDGE DESIGN  
BOREHOLE LOCATION MAP**

UNIFIED SOIL CLASSIFICATION SYSTEM

Criteria for Assigning Group Symbols and Names			Soil Classification	
			Generalized Group Descriptions	
<b>COARSE-GRAINED SOILS</b> More than 50% retained on No. 200 sieve	<b>GRAVELS</b> 50% or more of coarse fraction retained on No. 4 sieve	<b>CLEAN GRAVELS</b> Less than 5% fines	<b>GW</b>	Well-graded Gravels
			<b>GP</b>	Poorly-graded Gravels
		<b>GRAVELS with fines</b> More than 12% fines	<b>GM</b>	Gravel & Silt Mixtures
			<b>GC</b>	Gravel & Clay Mixtures
	<b>SANDS</b> More than 50% of coarse fraction passes No. 4 sieve	<b>CLEAN SANDS</b> Less than 5% fines	<b>SW</b>	Well-graded Sands
			<b>SP</b>	Poorly Graded Sands
		<b>SANDS with FINES</b> More than 12% fines	<b>SM</b>	Sand & Silt Mixtures
			<b>SC</b>	Sand & Clay Mixtures
<b>FINE-GRAINED SOILS</b> 50% or more passes the No. 200 sieve	<b>SILTS AND CLAYS</b> Liquid limit 50% or less	<b>INORGANIC</b>	<b>ML</b>	Non-plastic & Low Plasticity Silts
			<b>CL</b>	Low-plasticity Clays
		<b>ORGANIC</b>	<b>OL</b>	Non-plastic and Low Plasticity Organic Clays Non-plastic and Low Plasticity Organic Silts
	<b>SILTS AND CLAYS</b> Liquid limit greater than 50%	<b>INORGANIC</b>	<b>CH</b>	High-plasticity Clays
			<b>MH</b>	High-plasticity Silts
		<b>ORGANIC</b>	<b>OH</b>	High plasticity Organic Clays High Plasticity Organic Silts
<b>HIGHLY ORGANIC SOILS</b>	Primarily organic matter, dark in color, and organic odor	<b>PT</b>	Peat	

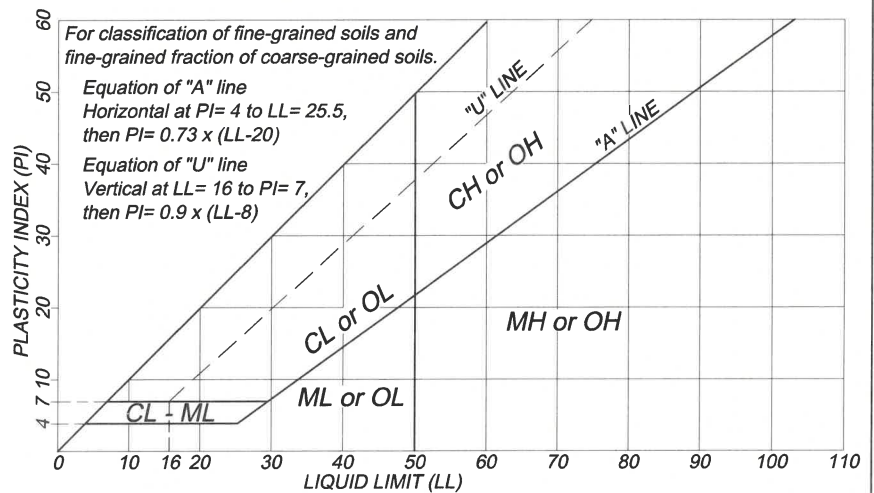

H:\jobs\14-118 Byers Lake Bridge (GTS)\CAD\Drawings\14-118\_00\_FIGA1, 1=1, 12/11/14 at 08:49 by jkk LAYOUT: Layout1

**FROST DESIGN SOIL CLASSIFICATION**  
 (Modeled after U.S. Army Corps of Engineers Standards)

<b>GROUP</b>	<b>KIND OF SOIL</b>	<b>P200</b>	<b>TYPICAL SOILS</b>
<i>NFS</i>	<i>Sand or Gravel</i>	<i>0 to 6</i>	<i>SW, SP GW, GP</i>
<i>F1</i>	<i>Gravelly Soils</i>	<i>6 to 10</i>	<i>GM, GW-GM, GP-GM</i>
<i>F2</i>	<i>Gravelly Soils Sands</i>	<i>10-20 6-15</i>	<i>GM, GW-GM, GP-GM SW, SP, SM, SW-SM, SP-SM</i>
<i>F3</i>	<i>Gravelly Soils  Sands, except very fine silty sands  Clays PI &gt; 12</i>	<i>Over 20  Over 15</i>	<i>GM, GC  SM, SC CL, CH  CL, CH</i>
<i>F4</i>	<i>All Silts  Very fine silty sands  Clays, PI &lt; 12  Varved clays and other fine-grained, banded sediments</i>	<i>Over 15</i>	<i>ML, MH  SM  CL, CL-ML  CL and ML CL, ML, and SM; CL, CH, and ML; CL, CH, ML, and SM</i>

*P200 = percent passing the number 200 sieve*

H:\jobs\14-118 Byers Lake Bridge (GTS)\CAD\Drawings\14-118\_00\_FIGA2, 1=1, 12/09/14 at 10:02 by jkk LAYOUT: Layout1



**LOG OF BORING**

**HOLE # BH-01**

**PROJECT NUMBER :** 14-118  
**PROJECT :** Byers Lake Bridge Replacement  
**CLIENT :** Giessel Technical Services, Inc.

**Station / Location:** N. Side Byers Creek  
**Lat/Long:**  
**Elevation:**

**Equipment Type:** 6620 DT  
**Drilling Method:** Hollow-Stem Auger  
**Field Crew:** GeoTek Alaska

**Total Depth:** 10.5 feet  
**Date:** 11/17/2014  
**Geologist:** V. Pate

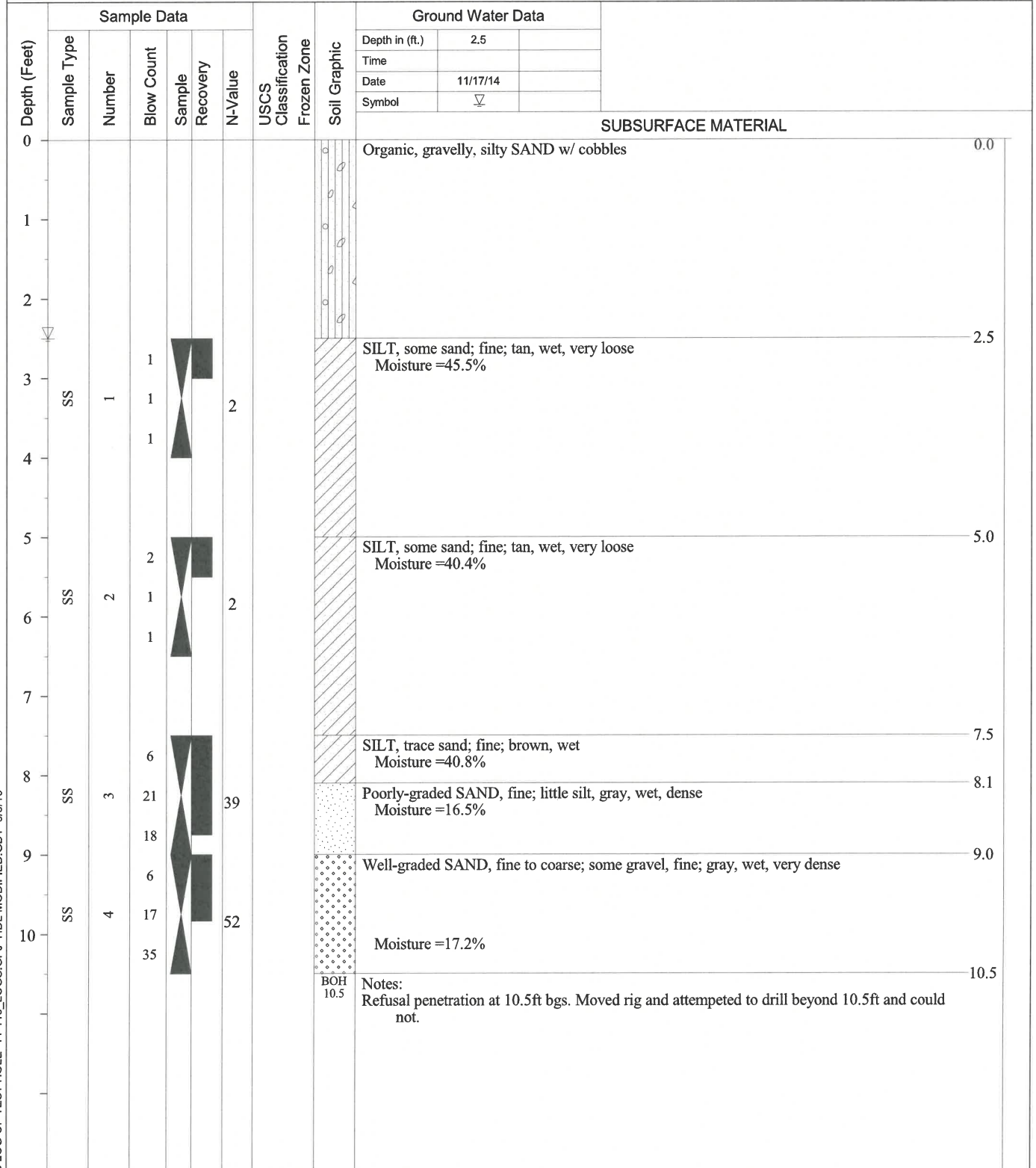

A USCS LOG OF TEST HOLE 14-118\_LOGS.GPJ HDL MODIFIED.GDT 8/3/16

Auto Hammer     Cathead Rope Method     140 lb. hammer with 30 in. drop     340 lb. hammer with 30 in. drop

Sheet Number 1 of 1

Figure A3



**LOG OF BORING**

**HOLE # BH-02**

**PROJECT NUMBER :** 14-118  
**PROJECT :** Byers Lake Bridge Replacement  
**CLIENT :** Giessel Technical Services, Inc.

**Station / Location:** S. Side Byers Creek  
**Lat/Long:**  
**Elevation:**

**Equipment Type:** Hand Tools  
**Drilling Method:** Hand Auger  
**Field Crew:** HDL

**Total Depth:** 6.5 feet  
**Date:** 6/2/2016  
**Geologist:** D. Simon

Depth (Feet)	Sample Data						USCS Classification	Frozen Zone	Soil Graphic	Ground Water Data		
	Sample Type	Number	Blow Count	Sample Recovery	N-Value	Depth in (ft.)				Time	Date	Symbol
0									SUBSURFACE MATERIAL			
0									Well-graded SAND, fine to coarse; with gravel, fine to coarse; trace to little silt, brown, moist 0.0			
1												
2												
3												
3									1 PR = 7, Moisture =26.1% P200 =13.8%, Sa =47.2%, Gr =29.0%			
4	GRAB	1										
5												
6												
6.5									Notes: End of boring at 6.5 feet. 6.5			

A USCS LOG OF TEST HOLE 14-118\_LOGS.GPJ HDL MODIFIED.GDT 8/3/16

- Auto Hammer
- Cathead Rope Method
- 140 lb. hammer with 30 in. drop
- 340 lb. hammer with 30 in. drop

Figure A4



**LOG OF BORING**

**HOLE # BH-03**

**PROJECT NUMBER :** 14-118  
**PROJECT :** Byers Lake Bridge Replacement  
**CLIENT :** Giessel Technical Services, Inc.

Station / Location: S. Side Byers Creek  
 Lat/Long:  
 Elevation:

Equipment Type: Hand Tools  
 Drilling Method: Hand Auger  
 Field Crew: HDL

Total Depth: 4.5 feet  
 Date: 6/2/2016  
 Geologist: D. Simon

Depth (Feet)	Sample Data						USCS Classification	Frozen Zone	Soil Graphic	Ground Water Data	
	Sample Type	Number	Blow Count	Sample Recovery	N-Value	Depth in (ft.)				Time	
0									1	1.0	
1									6/2/16	6/2/16	
2									▽	▼	
3											
4											
4.5											

SUBSURFACE MATERIAL	
0.0	Poorly-graded SAND, fine to medium; some silt, brown, wet
4.5	Notes: Auger refusal at 4.5 feet.

A USCS LOG OF TEST HOLE 14-118\_LOGS.GPJ HDL MODIFIED.GDT 8/3/16

- Auto Hammer
- Cathead Rope Method
- 140 lb. hammer with 30 in. drop
- 340 lb. hammer with 30 in. drop

Figure A5



**LOG OF BORING**

**HOLE # BH-04**

**PROJECT NUMBER :** 14-118  
**PROJECT :** Byers Lake Bridge Replacement  
**CLIENT :** Giessel Technical Services, Inc.

**Station / Location:** S. Side Byers Creek  
**Lat/Long:**  
**Elevation:**

**Equipment Type:** Hand Tools  
**Drilling Method:** Hand Auger  
**Field Crew:** HDL

**Total Depth:** 6.0 feet  
**Date:** 6/2/2016  
**Geologist:** D. Simon

Depth (Feet)	Sample Data						USCS Classification	Frozen Zone	Soil Graphic	Ground Water Data	
	Sample Type	Number	Blow Count	Sample Recovery	N-Value	Depth in (ft.)				Time	
0									1	1.0	
1									6/2/16	6/2/16	
2									▽	▼	
3											
4											
5											
6											

SUBSURFACE MATERIAL	
0	Poorly-graded SAND, fine to medium; some silt, brown, wet
6.0	Notes: Auger refusal at 6.0 feet.

A USCS LOG OF TEST HOLE 14-118\_LOGS.GPJ HDL MODIFIED.GDT 8/3/16

- Auto Hammer
- Cathead Rope Method
- 140 lb. hammer with 30 in. drop
- 340 lb. hammer with 30 in. drop

Figure A6



**LOG OF BORING**

**HOLE # BH-05**

**PROJECT NUMBER :** 14-118  
**PROJECT :** Byers Lake Bridge Replacement  
**CLIENT :** Giessel Technical Services, Inc.

Station / Location: *N. Side Byers Creek*  
 Lat/Long:  
 Elevation:

Equipment Type: *Hand Tools*  
 Drilling Method: *Hand Auger*  
 Field Crew: *HDL*

Total Depth: *2.0 feet*  
 Date: *6/2/2016*  
 Geologist: *D. Simon*

Depth (Feet)	Sample Data						USCS Classification	Frozen Zone	Soil Graphic	Ground Water Data			SUBSURFACE MATERIAL
	Sample Type	Number	Blow Count	Sample Recovery	N-Value	Depth in (ft.)				Time	Date	Symbol	
0												Well-graded SAND, fine to coarse; with gravel, fine to coarse; trace to little silt, brown, moist 0.0	
1													
2								BOH 2				Notes: Auger Refusal at 2.0 feet. 2.0	

A USCS LOG OF TEST HOLE 14-118\_LOGS.GPJ HDL MODIFIED.GDT 8/3/16

- Auto Hammer
- Cathead Rope Method
- 140 lb. hammer with 30 in. drop
- 340 lb. hammer with 30 in. drop

**Figure A7**



**LOG OF BORING**

**HOLE # BH-06**

**PROJECT NUMBER :** 14-118  
**PROJECT :** Byers Lake Bridge Replacement  
**CLIENT :** Giessel Technical Services, Inc.

Station / Location: *N. Side Byers Creek*  
 Lat/Long:  
 Elevation:

Equipment Type: *Hand Tools*  
 Drilling Method: *Hand Auger*  
 Field Crew: *HDL*

Total Depth: *3.5 feet*  
 Date: *6/2/2016*  
 Geologist: *D. Simon*

Depth (Feet)	Sample Data						USCS Classification Frozen Zone	Soil Graphic	Ground Water Data			
	Sample Type	Number	Blow Count	Sample Recovery	N-Value	Depth in (ft.)			Time	Date	Symbol	
0								SUBSURFACE MATERIAL				
0							[Soil Graphic: Well-graded SAND]	Well-graded SAND, fine to coarse; with gravel, fine to coarse; trace to little silt, brown, moist 0.0				
1												
2												
3												
3.5							BOH 3.5	Notes: Auger Refusal at 3.5 feet. 3.5				

A USCS LOG OF TEST HOLE 14-118 LOGS.GPJ HDL.MODIFIED.GDT 8/3/16

- Auto Hammer
- Cathead Rope Method
- 140 lb. hammer with 30 in. drop
- 340 lb. hammer with 30 in. drop

Figure A8



**LOG OF BORING**

**HOLE # BH-07**

PROJECT NUMBER : 14-118  
 PROJECT : Byers Lake Bridge Replacement  
 CLIENT : Giessel Technical Services, Inc.

Station / Location: N. Side Byers Creek  
 Lat/Long:  
 Elevation:

Equipment Type: Hand Tools  
 Drilling Method: Hand Auger  
 Field Crew: HDL

Total Depth: 2.0 feet  
 Date: 6/2/2016  
 Geologist: D. Simon

Depth (Feet)	Sample Data						USCS Classification	Frozen Zone	Soil Graphic	Ground Water Data		
	Sample Type	Number	Blow Count	Sample Recovery	N-Value	Depth in (ft.)				Time	Date	Symbol
0									SUBSURFACE MATERIAL			
0.0								Organic Topsoil				0.0
0.5									Well-graded SAND, fine to coarse; with gravel, fine to coarse; trace to little silt, brown, moist			0.5
1												
2									Notes: Auger Refusal at 2.0 feet			2.0

A USCS LOG OF TEST HOLE 14-118\_LOGS.GPJ HDL\_MODIFIED.GDT 8/3/16

- Auto Hammer
- Cathead Rope Method
- 140 lb. hammer with 30 in. drop
- 340 lb. hammer with 30 in. drop

Figure A9



**LOG OF BORING**

**HOLE # BH-08**

**PROJECT NUMBER :** 14-118  
**PROJECT :** Byers Lake Bridge Replacement  
**CLIENT :** Giessel Technical Services, Inc.

Station / Location: *N. Side Byers Creek*  
 Lat/Long:  
 Elevation:

Equipment Type: *Hand Tools*  
 Drilling Method: *Hand Auger*  
 Field Crew: *HDL*

Total Depth: *3.0 feet*  
 Date: *6/2/2016*  
 Geologist: *D. Simon*

Depth (Feet)	Sample Data						USCS Classification Frozen Zone	Soil Graphic	Ground Water Data		
	Sample Type	Number	Blow Count	Sample Recovery	N-Value	Depth in (ft.)			Time	Date	Symbol
0								SUBSURFACE MATERIAL			
0.0								Organic Topsoil		0.0	
0.5								Well-graded SAND, fine to coarse; with gravel, fine to coarse; trace to little silt, brown, moist		0.5	
1											
2											
3								Notes: Auger Refusal at 3.0 feet		3.0	

A USCS LOG OF TEST HOLE 14-118\_LOGS.GPJ HDL MODIFIED.GDT 8/3/16

- Auto Hammer
- Cathead Rope Method
- 140 lb. hammer with 30 in. drop
- 340 lb. hammer with 30 in. drop

Figure A10



**LOG OF BORING**

**HOLE # BH-09**

**PROJECT NUMBER :** 14-118  
**PROJECT :** Byers Lake Bridge Replacement  
**CLIENT :** Giessel Technical Services, Inc.

Station / Location: *N. Side Byers Creek*  
 Lat/Long:  
 Elevation:

Equipment Type: *Hand Tools*  
 Drilling Method: *Hand Auger*  
 Field Crew: *HDL*

Total Depth: *6.5 feet*  
 Date: *6/2/2016*  
 Geologist: *D. Simon*

Depth (Feet)	Sample Data						USCS Classification	Frozen Zone	Soil Graphic	Ground Water Data	
	Sample Type	Number	Blow Count	Sample Recovery	N-Value	Depth in (ft.)					
0									1	1.0	
1									6/2/16	6/2/16	
									▽	▼	
<b>SUBSURFACE MATERIAL</b>											
0.0								Organic Topsoil			0.0
1.0								Poorly-graded SAND, fine to medium; some silt, trace gravel, brown, wet			1.0
6.5								Notes: End of boring at 6.5 feet.			6.5

A USCS LOG OF TEST HOLE 14-118\_LOGS.GPJ HDL MODIFIED.GDT 8/3/16

- Auto Hammer
- Cathead Rope Method
- 140 lb. hammer with 30 in. drop
- 340 lb. hammer with 30 in. drop

Figure A11

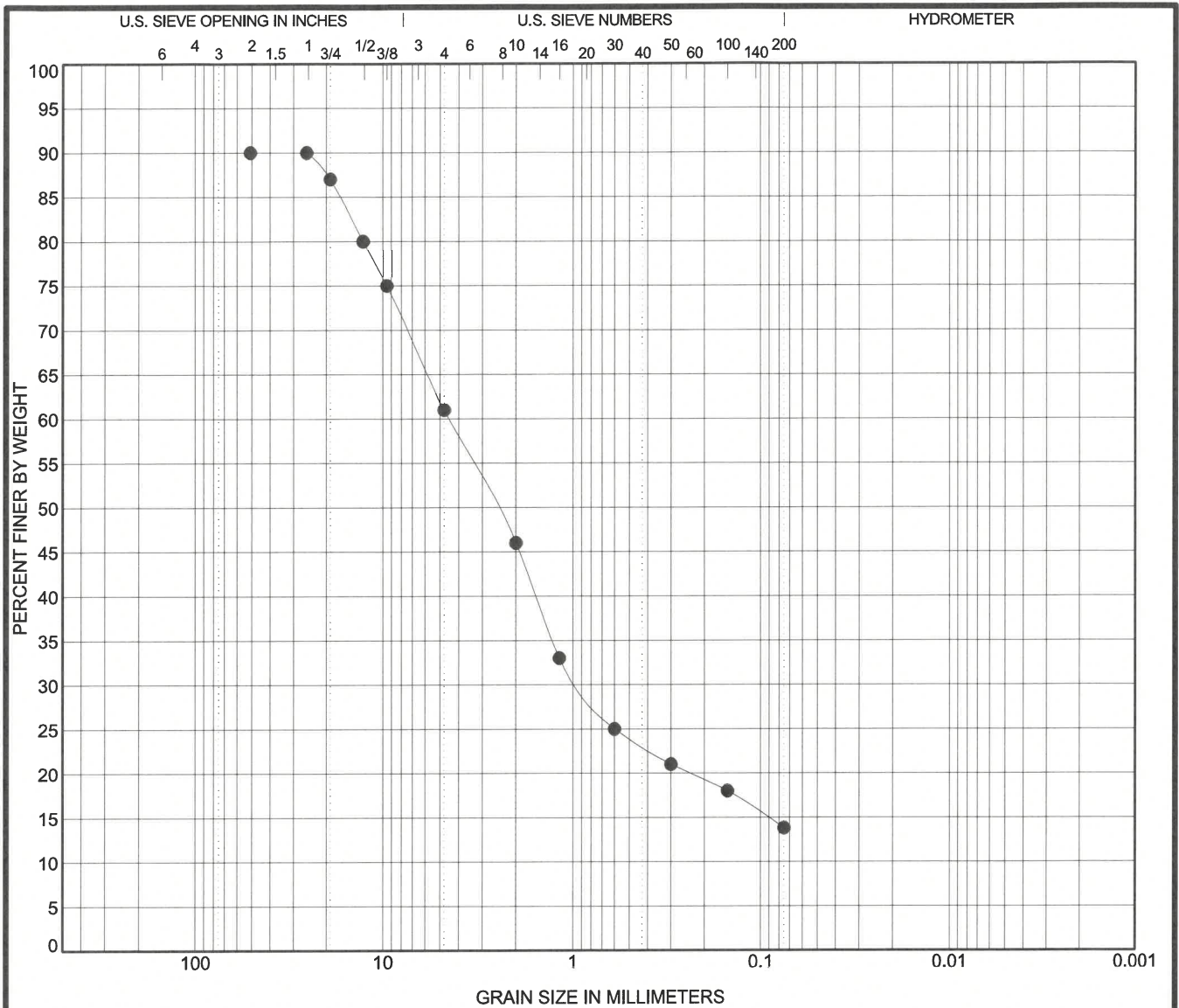

COBBLES	GRAVEL		SAND			SILT OR CLAY
	coarse	fine	coarse	medium	fine	

Specimen Identification	Classification					LL	PL	PI	Cc	Cu
● BH-02 DEPTH 3.0										

Specimen Identification	D100	D60	D30	D10	%Gravel	%Sand	%Silt	%Clay
● BH-02 DEPTH 3.0	50.8	4.484	0.916		29.0	47.2	13.8	

US GRAIN SIZE 14-118 LOGS.GPJ HDL MODIFIED.GDT 8/2/16

**HDL ENGINEERING**  
**Consultants**  
 3335 Arctic Blvd Ste 100  
 Anchorage, AK 99503  
 Telephone: 907-564-2120  
 Fax: 907-564-2122

**GRAIN SIZE DISTRIBUTION**

Project: Byers Lake Bridge Replacement  
 Client: Giessel Technical Services, Inc.  
 Project Number: 14-118



**STATE OF ALASKA  
DEPARTMENT OF NATURAL RESOURCES**

**DIVISION OF PARKS  
AND  
OUTDOOR RECREATION**

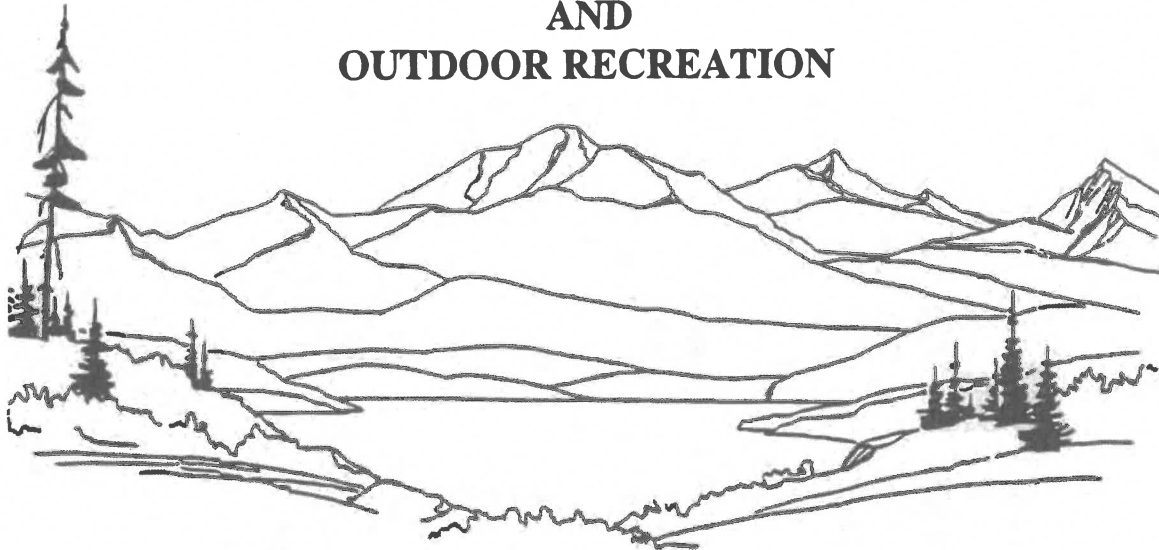

**MAT-SU AREA PROJECTS  
SOIL INVESTIGATION  
PROJECT NO: 75457-1**

**PREPARED BY:**

**ALASKA RIM ENGINEERING**  
*Engineers·Planners·Surveyors*  
P.O. BOX 2749 PALMER, AK. 99645

The logo for Alaska Rim Engineering features a stylized outline of the state of Alaska. The text "ALASKA RIM ENGINEERING" is positioned above the map, and "Engineers·Planners·Surveyors" is written in a smaller, italicized font below it. At the bottom, the address "P.O. BOX 2749 PALMER, AK. 99645" is provided.

# VETERAN'S MEMORIAL

*A ska Rim Engineerin*  
*Engineers .. Planners .. Surveyors*

P.O. Box 2749  
Palmer, Alaska 99645

Phone (907) 745-0222  
Fax (907) 746-0222

# SOILS LOG

PROJECT TNIR / MAT-SU SOILS / VETERAN'S MEMORIAL  
 WORK ORDER No. 94-00413 DATE: 24 OCTOBER 94  
 BY: DICK LOWMAN EQUIPMENT: CASE 850  
 SAMPLE TYPE: VISUAL / GRAB

TEST HOLE No. PERK 2

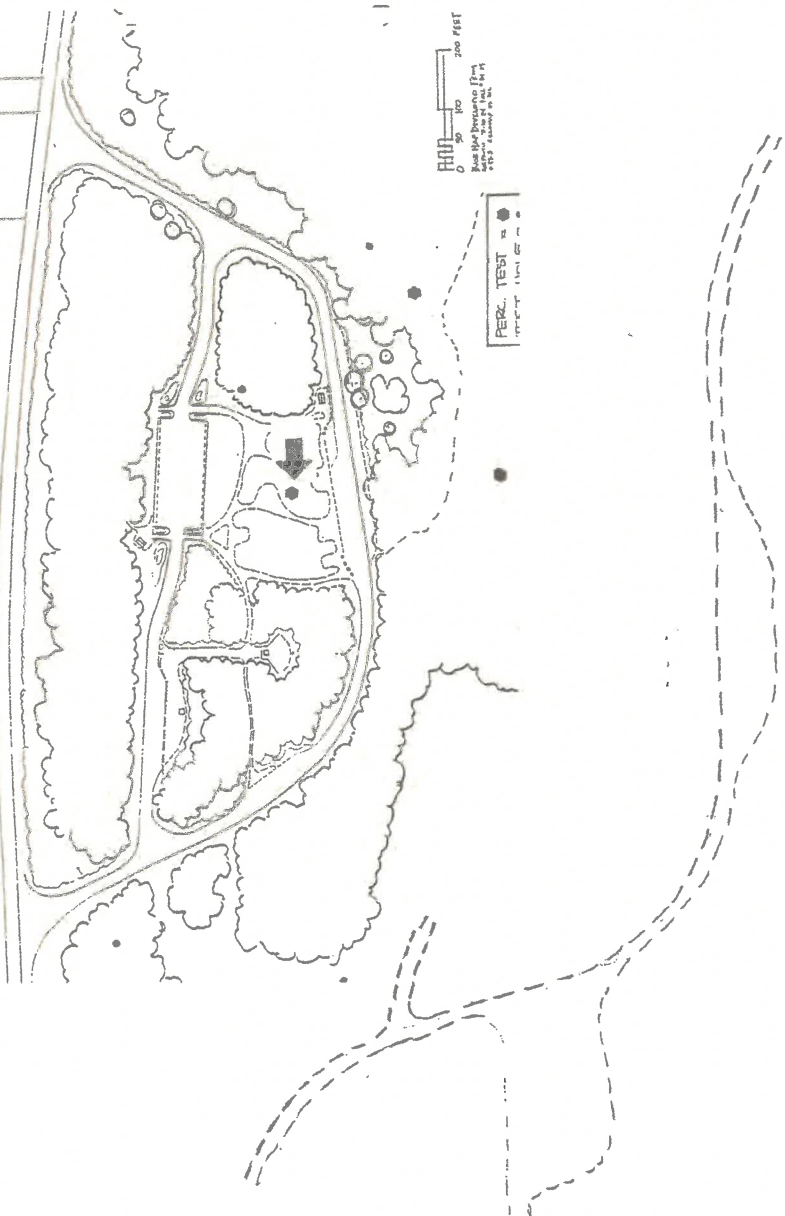
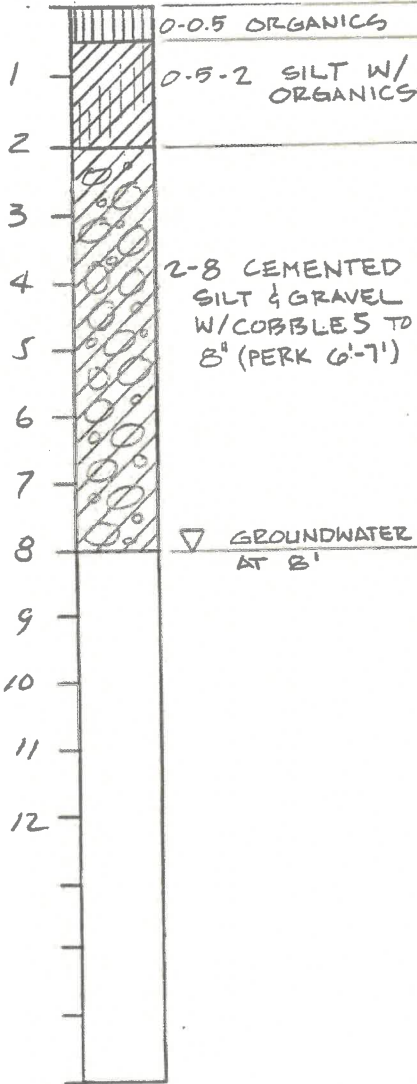

Engineers • Planners • Surveyors

*Alaska Rim Engineers*  
*Engineers .. Planners .. Surveyors*

P.O. Box 2749  
Palmer, Alaska 99645

Phone (907) 745-0222  
Fax (907) 746-0222

# SOILS LOG

PROJECT TDNR / MAT-SU SOILS / VETERAN'S MEMORIAL

WORK ORDER No. 94-00413 DATE: 24 OCTOBER 94

BY: DICK LOWMAN EQUIPMENT: CASE 850

SAMPLE TYPE: VISUAL / GRAB

TEST HOLE No. PERK 1

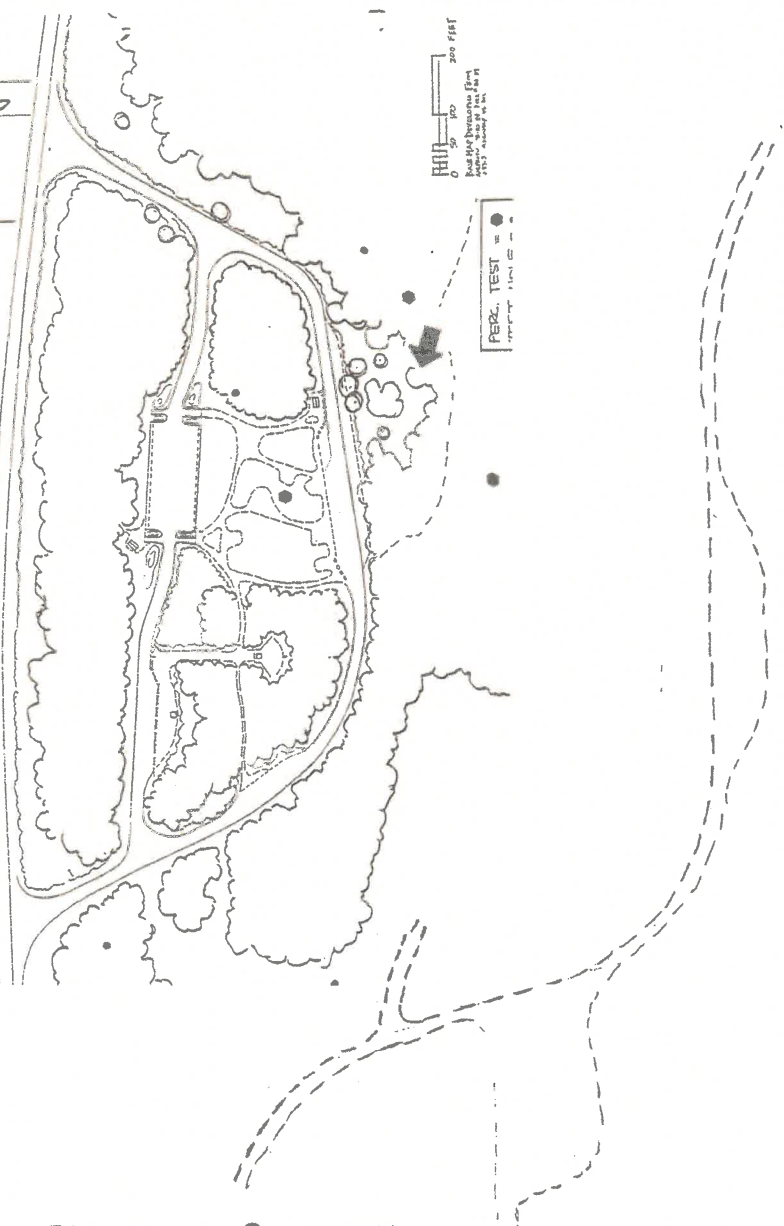
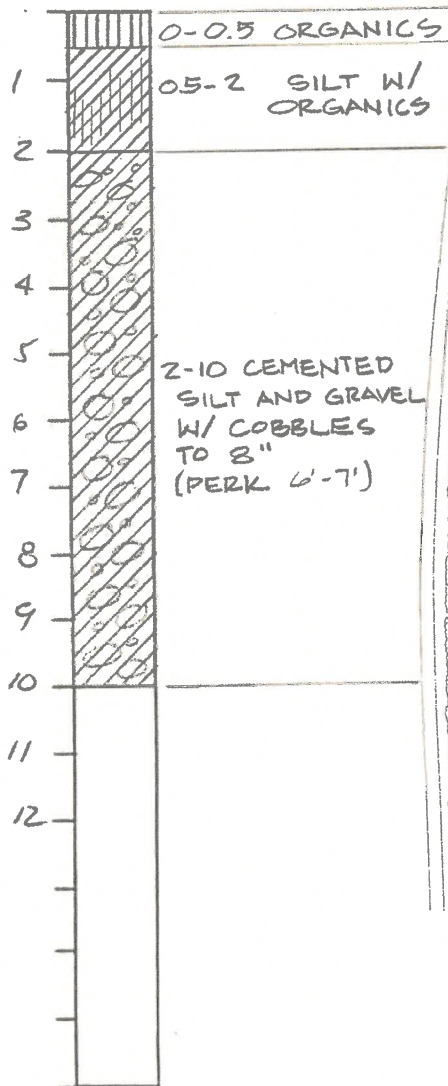

Engineers • Planners • Surveyors

P.O. Box 2749  
Palmer, Alaska 99645

*At Sea Rim Engineering*  
*Engineers • Planners • Surveyors*

Phone (907) 745-0222  
Fax (907) 746-0222

# SOILS LOG

PROJECT T DNR / MAT-SU SOILS / VETERAN'S MEMORIAL  
 WORK ORDER No. 94-00413 DATE: 24 OCTOBER 94  
 BY: DICK LOWMAN EQUIPMENT: CASE 850  
 SAMPLE TYPE: VISUAL / GRAB

TEST HOLE No. PERK 3

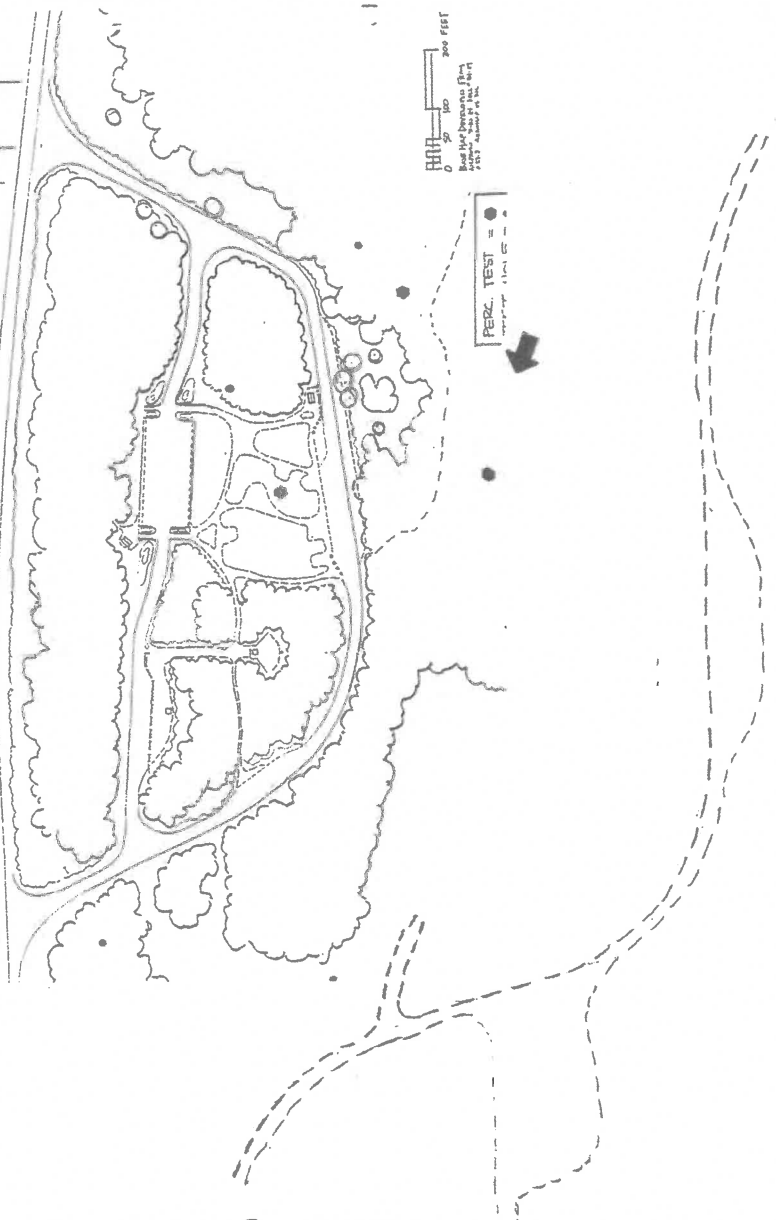
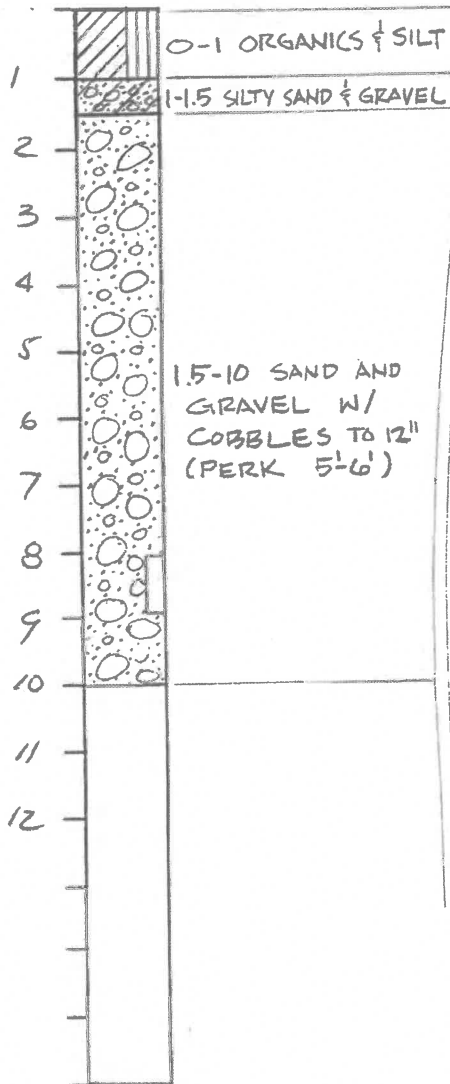

Engineers • Planners • Surveyors

P.O. Box 2749  
Palmer, Alaska 99645

*Alaska Rim Engineering*  
*Engineers .. Planners .. Surveyors*

Phone (907) 745-0222  
Fax (907) 746-0222

# SOILS LOG

PROJECT DNR / MAT-SU SOILS / VETERAN'S MEMORIAL

WORK ORDER No. 94-00413 DATE: 24 OCTOBER 94

BY: DICK LOWMAN EQUIPMENT: CASE 850

SAMPLE TYPE: VISUAL / GRAB

TEST HOLE No. A

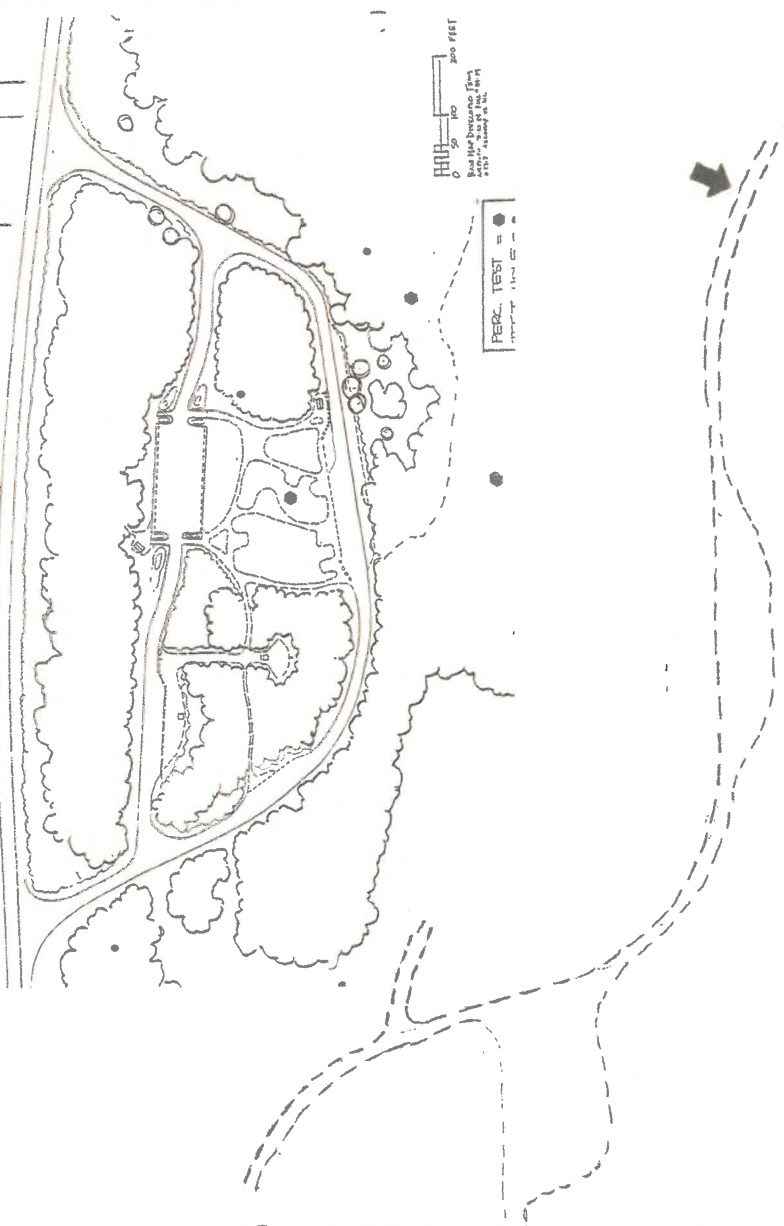
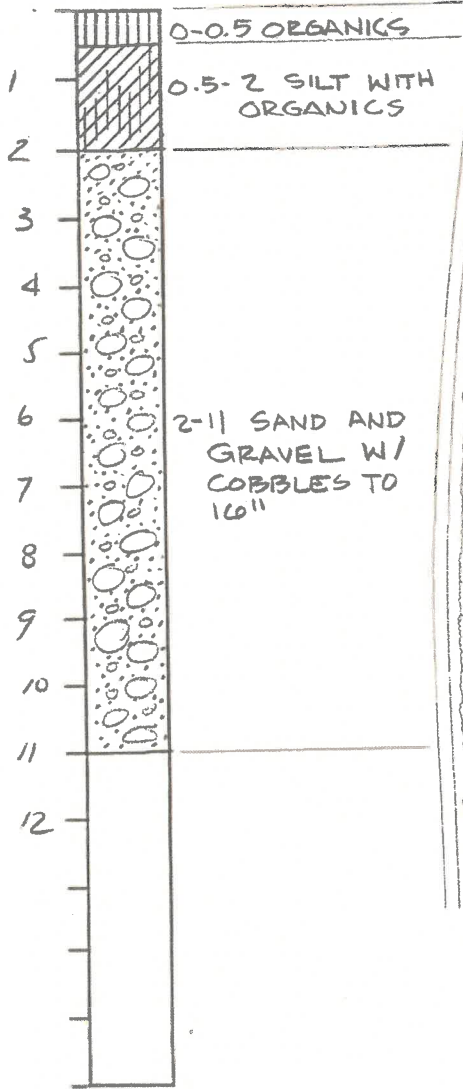

Engineers • Planners • Surveyors

# Alka Rim Engineering Engineers - Planners - Surveyors

P.O. Box 2749  
Palmer, Alaska 99645

Phone (907) 745-0222  
Fax (907) 746-0222

## SOILS LOG

PROJECT TDNR / MAT-SU SOILS / VETERAN'S MEMORIAL  
 WORK ORDER No. 94-00413 DATE: 24 OCTOBER 94  
 BY: DICK LOWMAN EQUIPMENT: CASE 850  
 SAMPLE TYPE: VISUAL / GRAB

TEST HOLE No. B

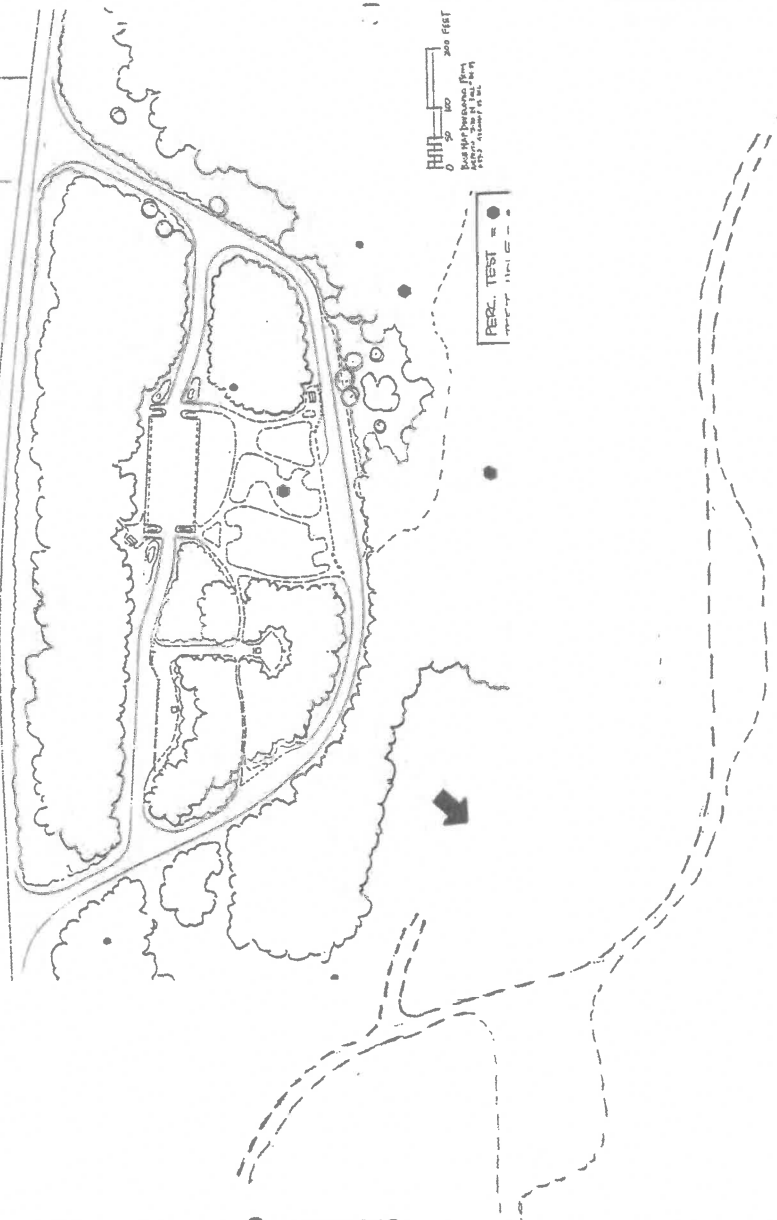
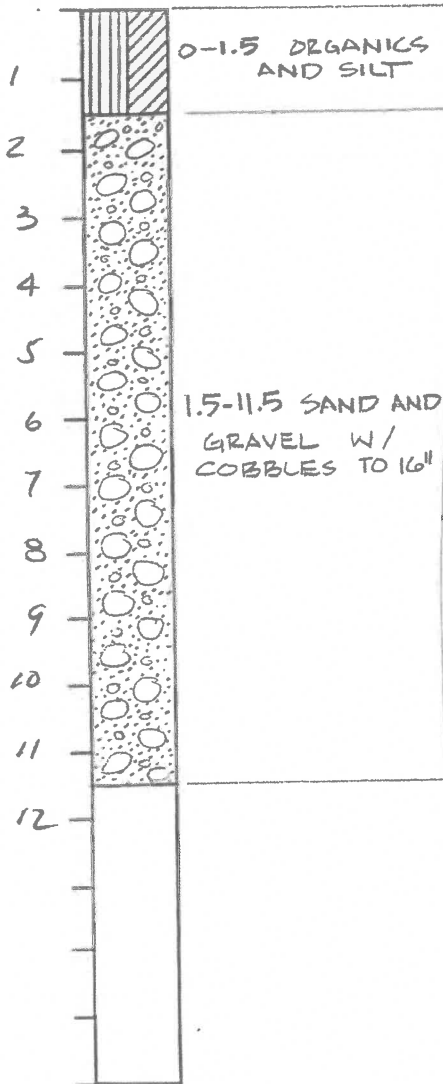

Engineers • Planners • Surveyors

P.O. Box 2749  
Palmer, Alaska 99645

*Alaska Rim Engineers*  
*Engineers • Planners • Surveyors*

Phone (907) 745-0222  
Fax (907) 746-0222

# SOILS LOG

PROJECT TNR / MAT-SU SOILS / VETERAN'S MEMORIAL  
 WORK ORDER No. 94-00413 DATE: 24 OCTOBER 94  
 BY: DICK LOWMAN EQUIPMENT: CASE 850  
 SAMPLE TYPE: VISUAL / GRAB

TEST HOLE No. C

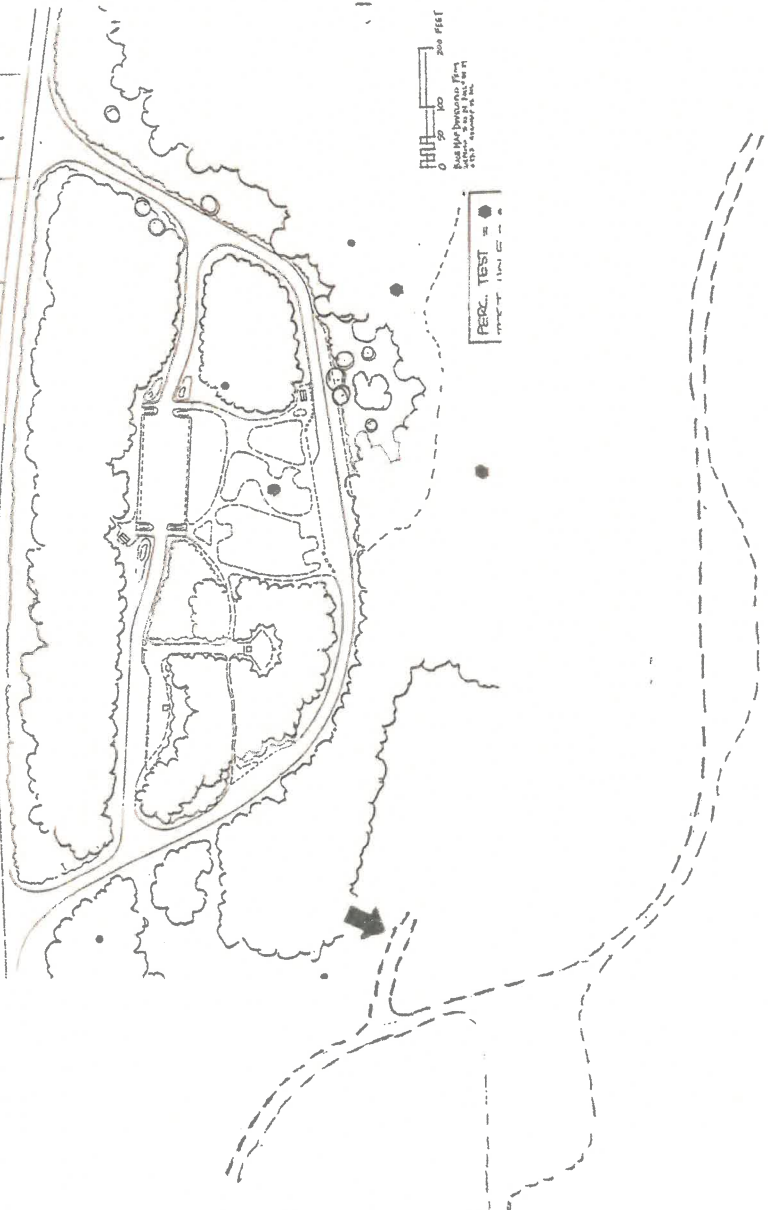
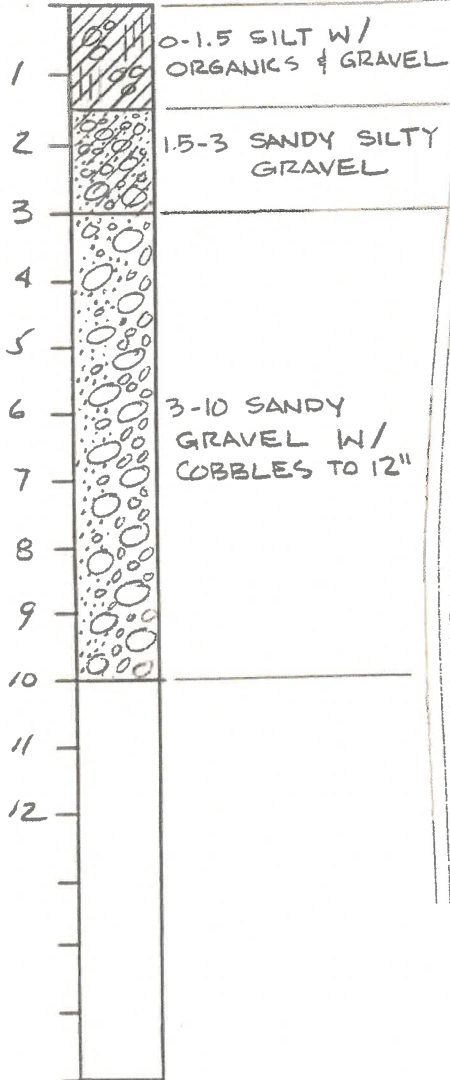

Engineers • Planners • Surveyors

P.O. Box 2749  
Palmer, Alaska 99645

*Alaska Rim Engineering*  
*Engineers .. Planners .. Surveyors*

Phone (907) 745-0222  
Fax (907) 746-0222

# SOILS LOG

PROJECT DNR / MAT-SU SOILS / VETERAN'S MEMORIAL

WORK ORDER No. 94-00413 DATE: 24 OCTOBER 94

BY: DICK LOWMAN EQUIPMENT: CASE 850

SAMPLE TYPE: VISUAL / GRAB

TEST HOLE No. D

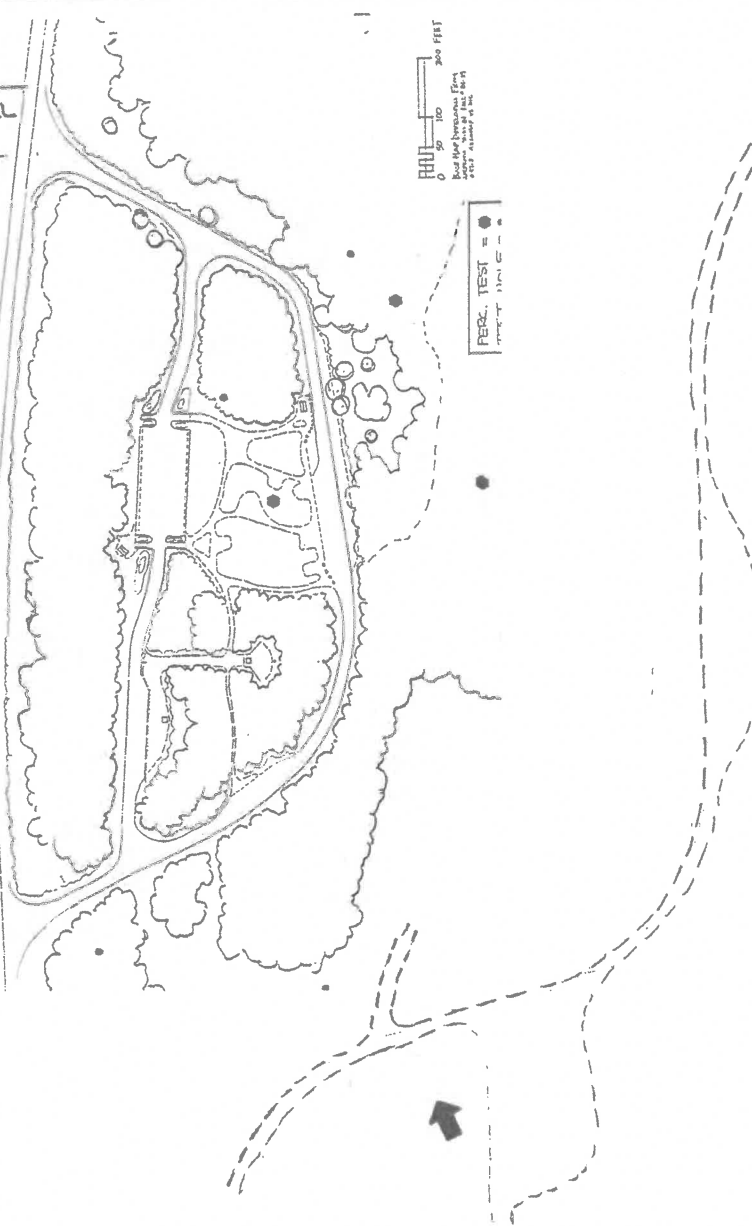
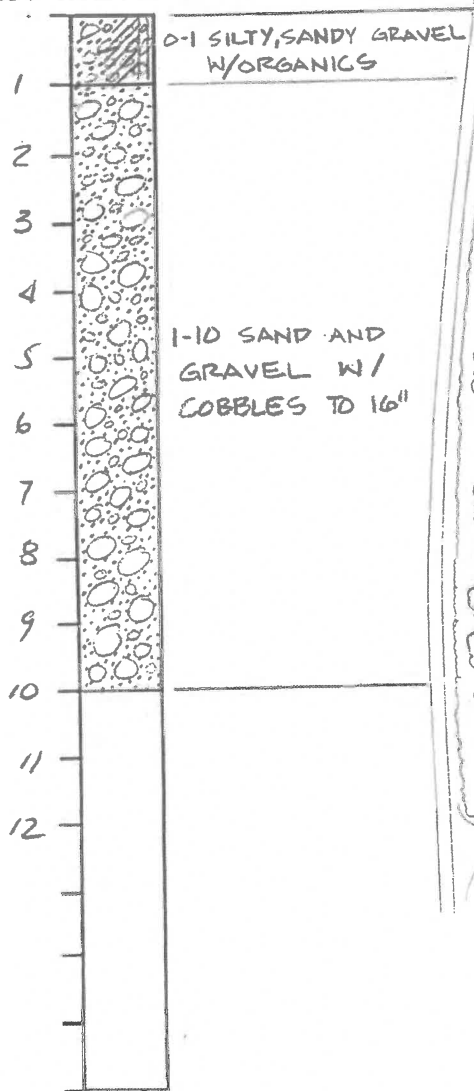

Engineers • Planners • Surveyors

P.O. Box 2749  
Palmer, Alaska 99645

*Alaska* **Alaska Rim Engineering**  
*Engineers .. Planners .. Surveyors*

Phone (907) 745-0222  
Fax (907) 746-0222

# SOILS LOG

PROJECT TNR / MAT-SU SOILS / VETERAN'S MEMORIAL

WORK ORDER No. 94-00413 DATE: 24 OCTOBER 94

BY: DICK LOWMAN EQUIPMENT: CASE 850

SAMPLE TYPE: VISUAL / GRAB

TEST HOLE No. E

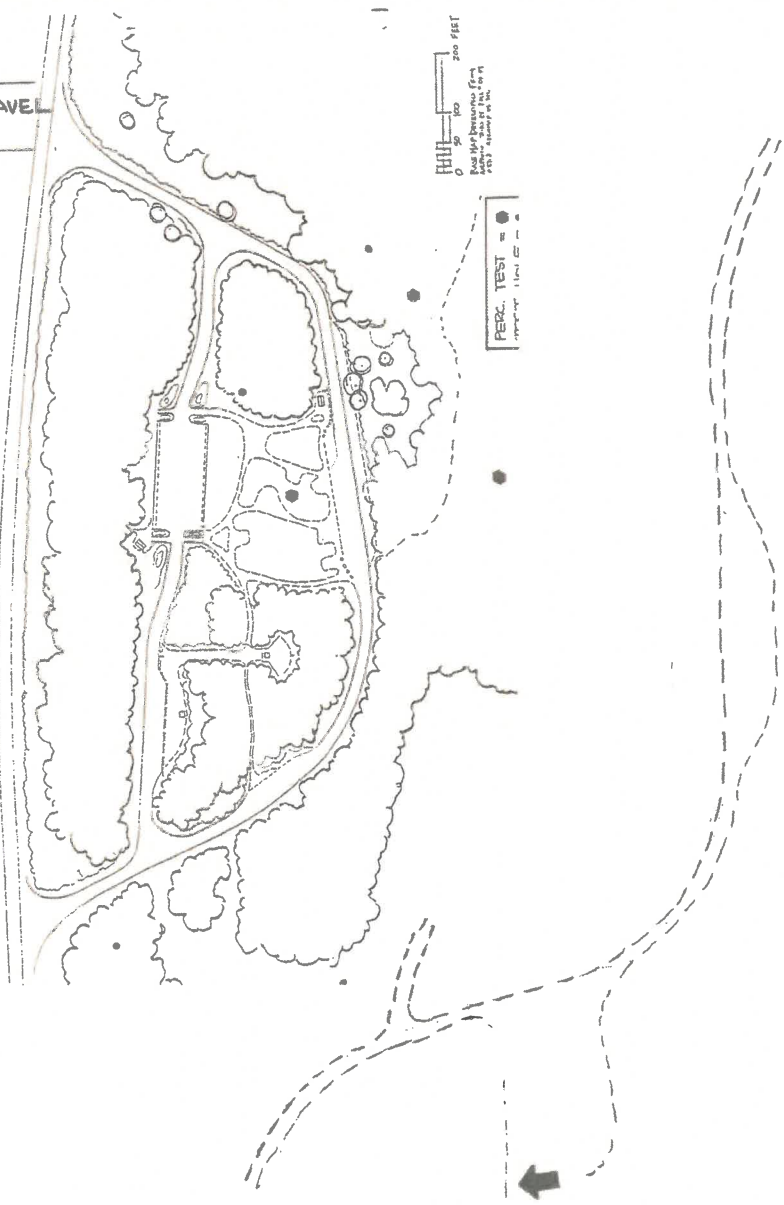
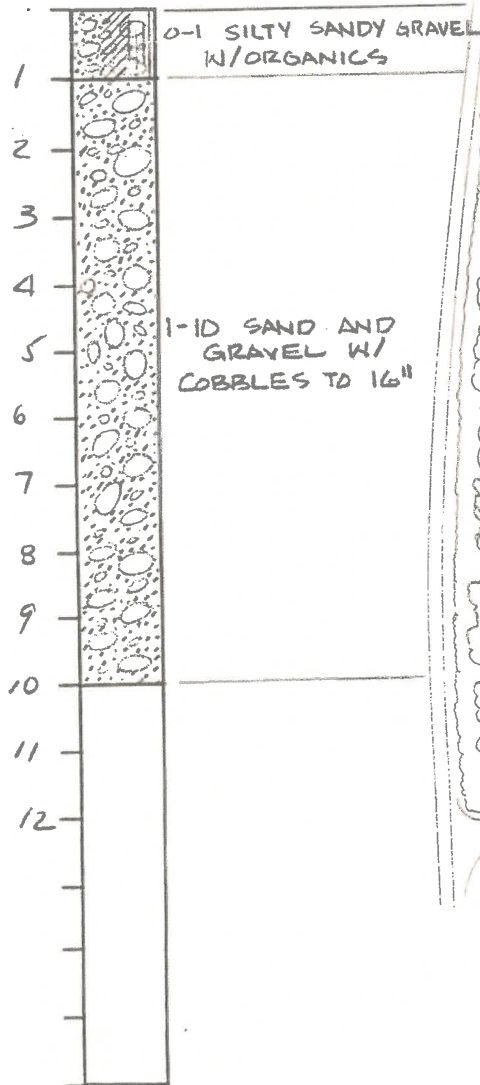

PERC. TEST = ●

P.O. Box 2749  
Palmer, Alaska 99645

*Alaska Rim Engineering*  
*Engineers .. Planners .. Surveyors*

Phone (907) 745-0222  
Fax (907) 746-0222

# SOILS LOG

PROJECT DNR / MAT-SU SOILS / VETERAN'S MEMORIAL  
WORK ORDER No. 94-00413 DATE: 24 OCTOBER 94  
BY: DICK LOWMAN EQUIPMENT: CASE 850

TEST HOLE #1



TEST HOLE #2



P.O. Box 2749  
Palmer, Alaska 99645

*Alaska Rim Engineering*  
*Engineers .. Planners .. Surveyors*

Phone (907) 745-0222  
Fax (907) 746-0222

# SOILS LOG

PROJECT DNR / MAT-SU SOILS / VETERAN'S MEMORIAL  
WORK ORDER No. 94-00413 DATE: 24 OCTOBER 94  
BY: DICK LOWMAN EQUIPMENT: CASE 850

TEST HOLE #3



TEST HOLE A



P.O. Box 2749  
Palmer, Alaska 99645

*Alaska Rim Engineering*  
*Engineers .. Planners .. Surveyors*

Phone (907) 745-0222  
Fax (907) 746-0222

# SOILS LOG

PROJECT DNR / MAT-SU SOILS / VETERAN'S MEMORIAL  
WORK ORDER No. 94-00413 DATE: 24 OCTOBER 94  
BY: DICK LOWMAN EQUIPMENT: CASE 850

TEST HOLE B



TEST HOLE C



P.O. Box 2749  
Palmer, Alaska 99645

*Alaska Rim Engineering*  
*Engineers .. Planners .. Surveyors*

Phone (907) 745-0222  
Fax (907) 746-0222

# SOILS LOG

PROJECT DNR / MAT-SU SOILS / VETERAN'S MEMORIAL  
WORK ORDER No. 94-00413 DATE: 24 OCTOBER 94  
BY: DICK LOWMAN EQUIPMENT: CASE 850

TEST HOLE D



TEST HOLE E





SMALL PROCUREMENT DOCUMENTS

THIS COMPLETED FORM MUST BE THE FIRST PAGE. NO OTHER COVER SHALL BE USED.

Project Title: Byers Lake Campground and Outlet Bridge Geotechnical Investigation
RFP No.: 71043-4

PROPOSAL REQUIREMENTS

Proposals shall demonstrate comprehension of the objectives and services for the proposed contract; include a brief overview of what will be done; and show a sequence and schedule for each important task.

registration number). Include a brief – about one paragraph – statement for each person named that describes experience directly related to the service(s) they will perform.

ALASKA STATUTORY PREFERENCES

are are not applicable to this contract.

If applicable, check those preferences that you (Offeror) claim.

Alaska Bidder (Offeror) AND Veterans AND Employment Program OR Disabled Persons

2 AAC 12.260(d) AS 36.30.175 if applicable AS 36.30.170(c) AS 36.30.170 (e & f)

Invalid claim(s) will result in the Offeror's disqualification for contract award.

PROPOSAL

The undersigned has reviewed Part A – RFP of these documents, understands the instructions, terms, conditions, and requirements contained therein and in the Standard Provisions Booklet, and proposes to provide the required services described in Part A in accordance with the attached letter which constitutes our proposal to complete the project.

this requirement may cause the state to reject the proposal as non-responsive, or cancel the contract.

I further certify that I am a duly authorized representative of the Offeror; that this Proposal accurately represents capabilities of the Offeror and Subcontractors identified for providing the services indicated. I understand that these Certifications are material representations of fact upon which reliance will be placed if this contract is awarded and that failure to comply with these Certifications is a fraudulent act.

By my initials below, I certify that the Offeror and all Subcontractors identified in the Proposal shall comply with all requirements for the following items as explained in the Standard Provisions Booklet:

- Certification of Compliance (Alaska Licenses and Registrations, and Certifications).
Insurance, including Workers' Compensation, Comprehensive or Commercial General Liability, and Comprehensive Automobile Liability.
Professional Liability Insurance as follows:
As available.
Minimum of \$300,000.
Minimum of \$500,000.
Certification for Federal-Aid Contracts Exceeding \$100,000 (DOT&PF Form 25A262 Appendix A, General Conditions)

Signature and Date

Name.....:
Title .....:
Offeror (Firm) .....:
Street or PO Box .....:
City, State, Zip.....:
Telephone - Voice .....:
Telephone - Fax.....:
Email .....:

Federal Tax Identification No. .... :

Type of Firm (Check one of the following):

- Individual Partnership
Corporation in state of.....:
Other (specify) .....

For Small Procurements over \$50,000, by signature on this form, the Offeror certifies that all services provided under this contract by the Contractor and all Subcontractors shall be performed in the United States. If the offeror cannot certify that all work is being performed in the United States, the Offeror must contact the Contracts Officer to request a waiver at least 24 hours prior to proposal deadline.

END OF PART B



**Alaska Department of Natural Resources**



**SMALL PROCUREMENT  
DOCUMENTS PART C -  
CONTRACT AWARD, NTP &  
INVOICE SUMMARY**

Agreement No ..... : 71043-4  
IRIS Program No ..... : N/A  
Federal Project No ..... : N/A

Contractor:  
Project Title: Byers Lake Campground and Outlet Bridge Geotechnical Investigation

**CONTRACT AWARD & NOTICE TO PROCEED**

You have been awarded this Agreement in accordance with Parts A, B & C of these documents and the following correspondence:

From ..... : Date :  
To ..... : Number of Pages :  
Subject..... :

This Agreement incorporates by reference the Small Procurement Standard Provisions Booklet dated . If you do not have a copy of the Standard Provisions Booklet, obtain one from the Contracting Agency. You are authorized to proceed with performance of this contract immediately and are required to complete it not later than:

The Agency Manager for this Contract is: Telephone: Email:  
Compensation for this Contract shall be by the method(s) and not exceed the authorized amount(s) shown in the Invoice Summary (below):.

Issued for the Contracting Agency per ADOT&PF Policy #01.01.050 by:	Accepted for the Contractor by:
Signature _____ Date _____	Signature _____ Date _____
Name: _____	Name: _____

**INVOICE SUMMARY**

This Invoice is for [ ] Progress OR [ ] Final Payment. **Sequential Invoice Number for this Contract is: [ ]**.

\* Each firm may be compensated for this Contract by only one of the following Methods of Payment (as explained in the Standard Provisions Booklet):  
Fixed Price (FP) .....Amounts entered in Columns "c" and "g" only Cost Plus Fixed Fee (CPFF) ..... Columns "c", "d", "e", "f" and "g"  
FP + Expenses (FPPE) .... Columns "c", "e" and "g" only Time and Expenses (T&E) ..... Columns "c", "e" and "g" only  
a b c d e f g

Firms (Prime & Subcontractors)*	Meth of Pay	Labor (or FP)	Indirect Cost	Expenses	Fixed Fee	Total Price
Total Contract Amounts Authorized for All Firms						
Sum of Prior APPROVED Payments						
Sum for THIS INVOICE						
Sum of Prior Payments plus this Invoice						
Balance of Authorized Amounts						

**PAYMENT**

<u>Phase Code</u> <u>Activity Code</u>  <u>Template Code</u> <u>Object Code</u>	<b>CONTRACTOR'S PAYMENT REQUEST:</b>  Signature _____ Date _____ Name: _____ (Contractor's Project Manager)
<b>PAYMENT RECOMMENDED:</b> I certify this Invoice to be valid and accurate and that services were performed substantially in conformance with the contract requirements and schedule.  Signature _____ Date _____ Name: _____	<b>PAYMENT APPROVED:</b> Based upon the payment recommendation and certification, I hereby approve payment.  Signature _____ Date _____ Name: _____

SEE INSTRUCTIONS ON NEXT PAGE

Alaska Department of Natural Resources

INSTRUCTIONS FOR AGENCY ISSUE AND CONTRACTOR BILLING

1. Agency Contract Manager – The Small Procurement Documents are organized for **only one Notice-to-Proceed (NTP) to be issued with the Contract Award for all services to be provided so that accounting procedures do not become unnecessarily burdensome and costly** (i.e., the Contractor is required to establish only one cost account for this contract). Also, this document (Part C – Contract Award, Notice to Proceed & Invoice Summary) must be issued and signed by the Contracting Officer (or a written designee per DOT&PF Policy #01.01.050). All items with a text form field must be complete at the time this document is issued. Other items are completed by the Contractor with each billing. *Note: If a revised NTP is required, do not reissue this document; use the "c-2 ntp" or "c-3-cr.ntp" form.*
  2. Contractor – If this Contract Award & NTP is unacceptable, notify the Contracting Agency immediately. If acceptable, acknowledge by signature where indicated on page 1 **on a copy** of this document and return the signed copy within ten days after your receipt. **Retain the unmarked, as issued, document to be used for reproduction and billing.**
  3. Contractor – Submit Invoices to the Agency Contract Manager named on page one of this document. Contractor may use the firm's invoice forms; however the Contractor must also **provide a copy of page one of this form as the FACE PAGE of each invoice submitted and with the following entries under "Invoice Summary" and "Contractor's Payment Request" accurately completed:**
    - a) Indicate if the Invoice is for Progress or Final Payment and enter the Sequential Invoice Number for this Contract.
    - b) In each column (c, d, e, f & g) where there is an Authorized Amount, show amounts for: Prior APPROVED Payments; THIS INVOICE; Prior Payments plus this Invoice; and Balance of Authorized Amounts.
- Note* **"Prior APPROVED Payments" amounts might not equal the total of all prior invoices if some items were disallowed or adjustments were made. If a prior billing has not been acknowledged with any payment, or a different amount from the billing was paid without any notification of the reason(s), Contractor may attach a request for an explanation and remedial action.**
4. Contractor – Sign and date under "CONTRACTOR'S PAYMENT REQUEST" thereby attesting to the following:

"By signature hereunder, the Contractor certifies entries to be true and correct for the services performed to date under or by virtue of said Contract and in accordance with AS 36.30.400. The Contractor further certifies that all applicable Federal, State and Local taxes incurred by the Contractor in the performance of the services have been paid and that all Subcontractors engaged by the Contractor for the services included in any invoice shall be fully compensated by the Contractor for such services."
  5. Contractor – Substantiate all charges on each invoice, other than for Fixed Prices or Fixed Fees, by attaching a summary of hours expended and hourly labor rate per employee; summary of units completed; subcontractor invoices; expense receipts, etc., or other proof of expenditures.
  6. Contractor - **Prime Contractor's Labor and Indirect Cost shall be billed to the Contracting Agency within 45 days of performance. Subcontractors' Labor and Indirect Cost shall be billed to the Contracting Agency within 60 days of performance. All of the Contractor's and Subcontractors' Other Direct Costs (Expenses) shall be billed to the Contracting Agency within 90 days of being incurred. Charges submitted after the above stated times will, at the Contracting Agency's discretion, not be paid.**
  7. Contractor – When this Contract is approximately 75% complete, the Contractor shall determine if the Authorized Amount(s) might be exceeded; and, if so, shall provide an estimate of cost to complete. The Contracting Agency will determine after discussion with the Contractor if additional cost is reasonable and does not include costs that should be absorbed by the Contractor. If additional cost is validated, a negotiated Amendment will be executed which either (1) reduces the scope of services/work products required commensurate with the Authorized Amount(s), or (2) increases the Authorized Amount(s) to that required for completion of the original contract.
  8. Amendments – if required – will be issued per Article A8 of Appendix A, General Conditions, as contained in the Standard Provisions Booklet.

END OF PART C