



Maximum Performance



**MAXIMUM BALANCE OF RESOURCES.
SERIOUS RESULTS.**

UNIMAC.COM

UC SERIES HARDMOUNT WASHER-EXTRACTORS 20-80 LB

UC SERIES HARDMOUNT 20-80 LB WASHER-EXTRACTORS

As the leading manufacturer of on-premises laundry equipment, UniMac® offers more than 7 decades of incomparable quality and long-lasting performance. Our UC series is built with unyielding construction to ensure industrial strength. Our cutting-edge innovations and technologies reduce costs and maximize throughput. And we're constantly improving. It's all part of our commitment to providing the lowest cost of ownership in the industry.



LOWER YOUR COSTS WITH UNIMAC

- Faster extraction technology spins up to 200 G-Force to remove more water during each load, resulting in shorter drying times and lower energy bills.
- The proven technology and proprietary design of our advanced inverter drive provides smooth, reliable power for optimal wash and extract performance.
- Uses 7% less water, while maintaining optimal cleaning.
- Water Guardian leak detection leak detection reduces water consumption by detecting leaking fill or drain valves, identifying leaks before they cost your operation hundreds of dollars in wasted resources.



OUR COMMITMENT TO ON-PREMISES LAUNDRY

Our customers are the direct focus of every product we manufacture and every decision we make. We make sure every piece of UniMac equipment comes with peace of mind and the support you need to help your business succeed. We are with you every step of the way with:

- Support from a worldwide network of distributors and a team of trained technicians.
- Service-parts availability.
- Service-training certification for distributors through Alliance Laundry Systems University.

INDUSTRY-LEADING DURABILITY

The washer-extractor's heavy-duty, robotically welded frame is designed to stand up to the toughest laundry conditions. It's stronger than ever before, has a quieter operation and balances loads more efficiently.

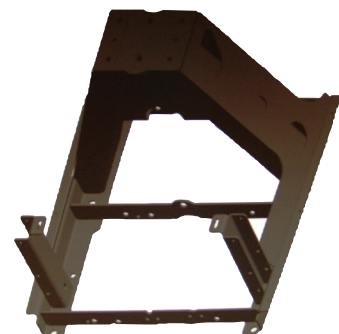

BEST-IN-CLASS BEARING PROTECTION

UniMac washer-extractors feature two close-tolerance ball bearings, permanently lubricated for trouble-free operation. Excluder seal and two triple-lip seals provide seven times the sealing power to isolate the bearings from water and chemicals.



M9 CONTROL

Offers nine cycles that can be modified to meet your laundry's unique demands. Three water levels and up to five supply signals for automated dispensing of laundry chemicals. Cycle counter and test cycle for self-diagnostics.



Proudly based in Ripon, Wisconsin, USA, UniMac is dedicated to research, development and testing to provide equipment that delivers industrial strength and long-lasting quality. Our products undergo a 5-stage product-development process and are pushed beyond their limits in our state-of-the-art test lab to ensure they exceed the toughest demands of the commercial environment and meet our customers' highest standards.



UC SERIES AT A GLANCE

- Improved cycle times
- Reduced drying time and increased throughput with up to 200 G-Force extraction speed
- Computer-optimized frame design stronger than ever before, with quieter operation
- Stainless-steel top and front panels
- Offered in five capacity options (20, 30, 40, 60 and 80 lb)
- Heavy-duty bearings and seals
- Engineered for quick troubleshooting and ease of service
- Self-cleaning, four-compartment dispenser
- Large, heavy-duty loading door
- Faster fill times – UC60 43%, UC80 20%



UC SERIES HARDMOUNT WASHER-EXTRACTORS 20-80 LB

SPECIFICATIONS			UCT20	UCT30	UCT40	UCT60	UCT80	
Control Option			M9	M9	M9	M9	M9	
Capacity - lb (kg)			20 (9)	30 (13.6)	40 (18)	60 (27)	80 (36)	
Overall Width - in (mm)			26 (660)	29 (737)	30.6 (777)	34.1 (866)	41.5 (1054)	
Overall Depth - in (mm)			30.9 (785)	35.3 (897)	42.3 (1074)	44.7 (1135)	47.1 (1196)	
Overall Height - in (mm)			43 (1092)	45 (1143)	47.2 (1199)	49.9 (1267)	57.2 (1453)	
Cylinder Diameter - in (mm)			21 (533)	24 (610)	26.3 (668)	30 (762)	36 (916)	
Cylinder Depth - in (mm)			13.8 (351)	16 (406)	20.3 (516)	22 (559)	21.9 (556)	
Cylinder Volume - cu ft (liters)			2.8 (79)	4.2 (119)	6.3 (178)	9.0 (255)	12.9 (365)	
Door Opening Size - in (mm)			11.6 (295)	14.3 (363)	16.3 (414)	16.3 (414)	18.5 (470)	
Door Bottom to Floor - in (mm)			14.4 (366)	14 (356)	14.6 (371)	14.9 (378)	17.9 (455)	
Water Inlet Connection - in (mm)			2 x 0.75 (19)	2 x 0.75 (19)	2 x 0.75 (19)	4 x .75 (19)	4 x .75 (19)	
Drain Diameter - in (mm)			1 x 3 (76)	1 x 3 (76)	1 x 3 (76)	1 x 3 (76)	1 x 3 (76)	
Drain Center Height to Floor - in (mm)			3.9 (99)	4.3 (109)	4.5 (114)	4.9 (124)	5.1 (130)	
Motor Power - HP (kW)			1 (0.75)	1 (0.75)	2 (1.5)	3 (2.25)	5 (3.75)	
Total # of Speeds			6, 9	6, 9	6, 9	6, 9	6, 9	
Cylinder Speed RPM (G-Force)	Gentle Wash Distribution		37 (0.4)	34 (0.4)	33 (0.4)	31 (0.4)	28 (0.4)	
			51 (0.8)	48 (0.8)	46 (0.8)	43 (0.8)	39 (0.8)	
			92 (2.5)	86 (2.5)	82 (2.5)	77 (2.5)	70 (2.5)	
	Very Low Extract		301 (27)	282 (27)	269 (27)	252 (27)	230 (27)	
		Low Extract		518 (80)	485 (80)	464 (80)	434 (80)	396 (80)
			Medium Extract		579 (100)	542 (100)	518 (100)	485 (100)
	High Extract		648 (125)	606 (125)	579 (125)	542 (125)	495 (125)	
		Very High Extract		710 (150)	664 (150)	635 (150)	594 (150)	542 (150)
	Ultra High Extract		819 (200)	766 (200)	733 (200)	686 (200)	626 (200)	
Voltage/Circuit Breaker FLA	B	120/60/1	15-9	15-12	20-15	N/A	N/A	
	X	200-240/50-60/1-3	15-4 (1 Ph)	15-7 (1 Ph)	15-7 (1 Ph)	15-11 (1 Ph)	20-15 (1 Ph)	
			15-3 (3 Ph)	15-4 (3 Ph)	15-4 (3 Ph)	15-7 (3 Ph)	15-9 (3 Ph)	
N	440-480/50/60/3	15-2	15-3	15-3	15-4	15-6		
Shipping Dimensions - in (mm)	Width		28 (711)	31.5 (800)	32.5 (826)	37.5 (953)	44 (1118)	
	Depth		33.8 (859)	38.3 (973)	43.5 (1105)	46.9 (1191)	54.5 (1384)	
	Height		49.4 (1255)	51.3 (1303)	53.6 (1361)	56.3 (1430)	59.6 (1514)	
Net Weight - lb (kg)			340 (154)	440 (200)	540 (245)	680 (308)	1250 (567)	
Standard Shipping Weight - lb (kg)			380 (172)	480 (218)	580 (263)	720 (327)	1300 (590)	
Slat Crate Shipping Weight - lb (kg)			460 (209)	580 (263)	680 (308)	840 (381)	1430 (649)	
Agency Approvals			cULus	cULus	cULus	cULus	cULus	

TO LEARN MORE OR TO FIND A DISTRIBUTOR IN YOUR AREA, VISIT UNIMAC.COM
ALLIANCE LAUNDRY SYSTEMS - SHEPARD ST, RIPON, WI 54971 - 1.800.587.5458

Consult your UniMac distributor for details. For the most accurate information, the installation guide should be used for all design and construction purposes. Due to continuous product improvements, design and specifications subject to change without notice. The quality management systems at Alliance Laundry Systems are registered to ISO 9001.



Maximum Performance



**MAXIMUM ENERGY EFFICIENCY.
SERIOUS RESULTS.**

UNIMAC.COM

UT SERIES 75 LB TUMBLE DRYERS

MAXIMUM PERFORMANCE WITH MORE CONTROL

Quality results are the goal of your on-premises laundry. However, you also want advanced functionality and access to the data that enables you to better manage your resources. UniMac® Premium tumble dryers deliver exceptional performance along with our legendary durability, while offering complete control of the operation.

LOWER YOUR COSTS WITH UNIMAC

Drying cycles are usually 30 percent longer than wash cycles. Reducing dry times to match wash times enables you to run your laundry at maximum efficiency. Our dryers are designed for fast drying, while balancing energy costs. With more than 70 years of dryer engineering experience, we have found the perfect balance between drying time and actual Btu usage to conserve energy, maximize throughput and lower labor costs.

OPTidry™

OVER-DRY PREVENTION TECHNOLOGY*

UniMac's optional OPTidry system takes efficiency further by eliminating costly over-drying. Removing over-drying from your laundry not only reduces utility expenses, but also curbs labor costs and extends linen life, saving up to thousands of dollars annually.



OPTIDRY SAVES AN AVERAGE OF 8 MINUTES PER LOAD. WHAT WOULD 8 MINUTES PER LOAD SAVE YOU?

THE COST OF OVER-DRYING: UTILITIES**

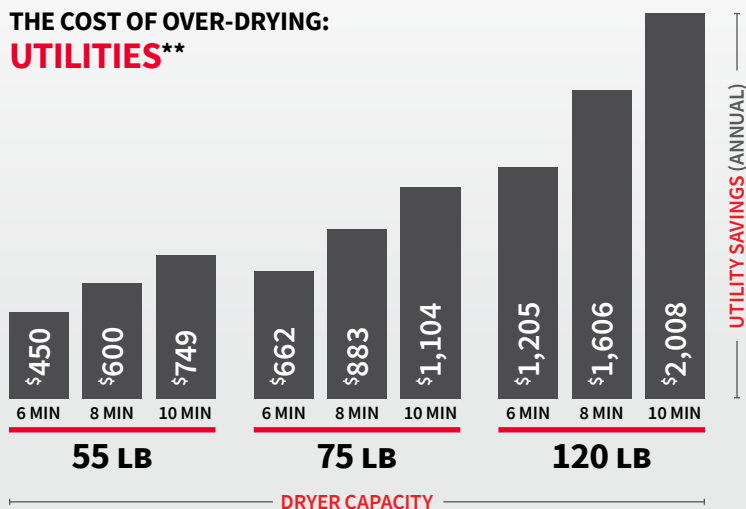

THE COST OF OVER-DRYING: LABOR***

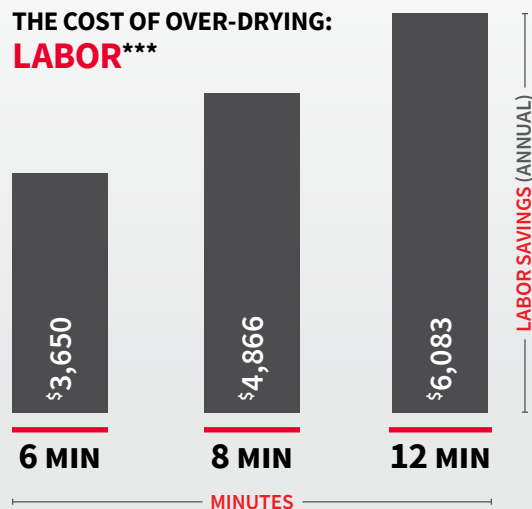

* OPTidry™ is available for tumble dryers with UniLinc Touch and select M Series control packages.

** Based on 10 loads/day, seven days/week and \$1.10/therm

*** Based on seven days/week and \$10/employee hour

UniLinc™ Touch

EASE OF USE drives the ultimate user experience in on-premises laundry with the UniLinc™ Touch control. UniMac's premium control brings simplicity, flexibility and intelligence to every laundry room.

Perfectly matched to UniMac's industrial performance and longevity, the UniLinc Touch control takes industry leading value and lowest total cost of ownership to the next level.

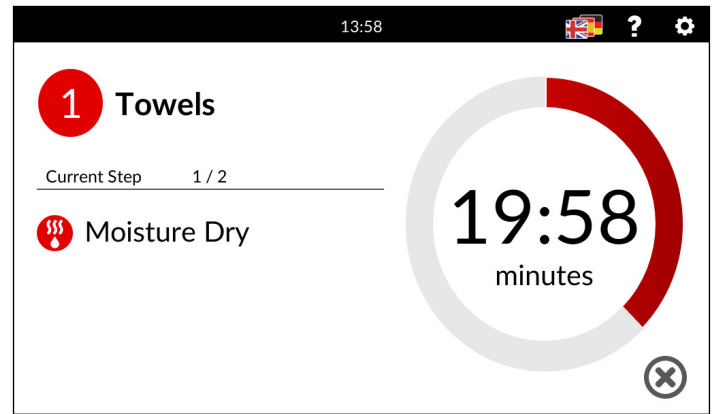

BRIGHT, CAPACITIVE TOUCH SCREEN
with clear cycle navigation



34 LANGUAGE OPTIONS
enabling staff members to operate the machine in their first language

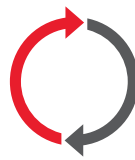

STREAMLINE THROUGHPUT
with an easy-to-read main screen cycle countdown timer, complimented by a count-up timer upon completion of the cycle



SEAMLESS USER EXPERIENCE
with control continuity from the washer-extractor to the tumble dryer



STAFF TRAINING
is quick and simple with this intuitive control



SET-UP, PROGRAMMING, AND TROUBLESHOOTING
simplified with easy-to-understand notifications



DIAGNOSTICS AND MACHINE AUDIT DATA
identify and resolve errors faster, reducing downtime and service costs



M SERIES CONTROL

This customizable control allows any combination up to 30 auto-dry and time-dry cycles to be saved, providing easy user interface.



DUAL DIGITAL TIMER (DDT) CONTROL

This economy control allows for the operator to select the ideal temperature, heating time and cooling time for each use.

C.A.R.E.™

In the unlikely event of a linen fire within the cylinder, our optional Combustion Automated Response Equipped (C.A.R.E.) system, a multiport water manifold system, will saturate the linens in the cylinder. It can also activate an alarm at a remote location.

C.A.R.E.™ is available for tumble dryers with UniLinc Touch and select M Series control packages.



Proudly based in Ripon, Wisconsin, USA, UniMac is dedicated to research, development and testing to provide equipment that delivers industrial strength and long-lasting quality. Our products undergo a 5-stage product-development process and are pushed beyond their limits in our state-of-the-art test lab to ensure they exceed the toughest demands of the commercial environment and meet our customers' highest standards.

SINGLE TUMBLE DRYERS

SPECIFICATIONS	UT075	UTF75 FAST DRY
Control Options	UniLinc Touch, M Series, Dual Digital	UniLinc Touch
Capacity - lb (kg)	75 (34)	75 (34)
Overall Width - in (mm)	38.5 (980)	38.5 (980)
Overall Depth - in (mm)	53.0 (1350)	53.0 (1350)
Overall Height - in (mm)	77.3 (1960)	77.3 (1960)
Cylinder Diameter - in (mm)	37.0 (940)	37.0 (940)
Cylinder Depth - in (mm)	36.0 (914)	36.0 (914)
Cylinder Volume - cu ft (liters)	22.4 (634)	22.4 (634)
Door Opening Size - in (mm)	26.9 (683)	26.9 (683)
Reversing Cylinder	Option	Standard
Water Inlet Size (C.A.R.E.™ System)	(1) 3/4"-11 1/2" NH Hose Connection	(1) 3/4"-11 1/2" NH Hose Connection
Heat Input Power	Gas 165,000 Btu/hr Steam 153,985 Btu/hr Electric 36 kW	225,000 Btu/hr – –
Gas Connections - in (npt)	0.5	0.75
Plumbing Connections - Steam - in (npt)	0.75	–
Air Outlet - in (mm)	8 (200)	10 (254)
Motor - HP	Fan 0.5 Cylinder 0.5	1.5 0.5
Airflow - cfm (liters/sec)	800 (380)	1100 (520)
Electrical Specs - amps	Gas & Steam B 100-120V/50-60/1 12 X* 200-240V/50-60/1-3 7 N 440-480V/50-60/3 3 Q 200-240/50-60/3 – Electric G 230-240V/50-60/3 90 L 460-480V/50-60/3 45	– – 3 3 90 45
Shipping Dimensions Approx - in (mm)	Width 41.5 (1054) Depth 56.0 (1420) Height Gas & Electric - 81.0 (2060) Steam - 83.5 (2120)	41.5 (1050) 56.0 (1420) Gas & Electric - 81.0 (2060) –
Net Weight - lb (kg)	Gas & Steam 715 (324), 740 (336) Electric 730 (331)	735 (334) –
Shipping Weight - lb (kg)	Gas & Steam 760 (345), 800 (363) Electric 780 (354)	780 (354) –
Agency Approvals	CSA	CSA

*X voltage can be connected to 1 or 3 phase power and operates on 1 phase only.

**TO LEARN MORE OR TO FIND A DISTRIBUTOR IN YOUR AREA,
VISIT UNIMAC.COM ALLIANCE LAUNDRY SYSTEMS - SHEPARD ST, RIPON, WI 54971 - 1.800.587.5458**

For the most accurate information, the installation guide should be used for all design and construction purposes. Due to continuous product improvements, design and specifications subject to change without notice. The quality management systems at Alliance Laundry Systems is registered to ISO 9001.