

# TRANSMITTAL FORM

<b>ADDENDUM TO THE CONTRACT DOCUMENTS</b>	<b>Page Number</b> 1	<b>No. of Pages</b> 12
<b>Addendum No. One (1)</b>	<b>Date Addendum Issued:</b> March 24, 2025	
<b>Issuing Office</b> Alaska State Parks, Design & Construction Section 550 West 7 <sup>th</sup> Avenue, Suite 1340 Anchorage, Alaska 99501 Phone: (907) 269-8736 Fax: (907) 269-8901	<b>Previous Addenda Issued</b> None	
<b>Project:</b> KRSMA: Kenai River Flats Facility Improvements <b>Project No.:</b> TA-21002/CFHWY00688	<b>Date &amp; Hour of Quotes Due:</b> April 2, 2025 2:00 PM prevailing time	

## NOTICE TO BIDDERS

**Bidder must acknowledge receipt of this addendum prior to the hour and date set for the quotes being due by one of the following methods:**

- (a) By acknowledging receipt of this addendum on the quote submitted.
- (b) By telegram or telefacsimile which includes a reference to the project and addendum number.

The bid documents require acknowledgment individually of all addenda to the drawings and/or specifications. This is a mandatory requirement and any quote received without acknowledgment of receipt of addenda may be classified as not being a responsive bid. If, by virtue of this addendum it is desired to modify a quote already submitted, such modification may be made by telegram or telefacsimile provided such a telegram or telefacsimile makes reference to this addendum and is received prior to the opening hour and date specified above.

\*\*\*\*\*

### THE CONTRACT IS MODIFIED AS FOLLOWS:

- Replace Bid Schedule of the Contract Documents with the modified Bid Schedule (Attachment A)

### THE PLANS ARE MODIFIED AS FOLLOWS:

- Replace sheet 2 with modified sheet 2 (Attachment B)
- Replace sheet 9 with modified sheet 9 (Attachment C)
- Replace sheet 10 with modified sheet 10 (Attachment D)
- Replace sheet 13 with modified sheet 13 (Attachment E)
- Replace sheet 22 with modified sheet 22 (Attachment F)
- Add the following DOT&PF standard drawing to the Plans:
  - I-30.10 (Attachment G)

### THE SPECIAL PROVISIONS ARE MODIFIED AS FOLLOWS:

- Replace page 15 with modified sheet 15 (Attachment H)
- Replace page 87 with modified sheet 87 (Attachment I)

Bidders are required to acknowledge this addendum on the proposal form or by FAX prior to the quotes being due.

\*\*\*\*\*  
\*\*\*\*\*

Addendum Number One (1) received.

\_\_\_\_\_  
Name/Title

\_\_\_\_\_  
Date

\_\_\_\_\_  
Firm

**END OF ADDENDUM**



STATE OF ALASKA  
DEPARTMENT OF NATURAL RESOURCES

**BID SCHEDULE**

Project Name: KRSMA: Kenai River Flats Facility Improvements

Project Number: TA-21002/CFHWY00688

Before preparing this bid schedule, read carefully, Section 102 of the 2020 edition of the Standard Specifications for Highway Construction, and the following:

The Bidder shall insert, as called for, a unit price or lump sum price in figures opposite each pay item for which an estimated quantity appears in the bid schedule. A unit price or lump sum price is not to be entered or tendered for any pay item not appearing in the bid schedule. The estimated quantity of work for payment on a lump sum basis will be "All Required" (All Req'd) and as further specified in the contract.

Whenever a Contingent Sum is shown for any item in this schedule, such amount shall govern and be included in the bid total.

Conditioned or qualified bids will be considered non-responsive.

Notice: Contract award will be made on the basis of the total adjusted basic bid.

The bidder shall insert a unit bid price for each pay item listed below. Type or print legibly.

Pay Item Number	Pay Item Description	Pay Unit	Quantity	Unit Bid Price	Amount Bid
***** BASIC BID *****					
202.0001.0000	Removal of Structures and Obstructions	L.S.	All Req'd	\$(LUMP SUM)	\$
203.0003.0000	Unclassified Excavation	C.Y.	250	\$	\$
203.005.0000A	Borrow, Type A	Ton	70	\$	\$
301.0001.00D1	Aggregate Base Course, Grading D-1	Ton	1000	\$	\$
401.0001.002B	HMA, Type II; Class B	Ton	500	\$	\$
505.0005.0000	Furnish Structural Steel Helical Pile	L.F.	4400	\$	\$
505.0006.0000	Drive Structural Steel Helical Pile	Each	176	\$	\$
<b>615.0001.0000</b>	<b>Standard Sign</b>	<b>S.F.</b>	<b>46</b>	<b>\$</b>	<b>\$</b>
618.0002.0000	Seeding	Pound	4	\$	\$

Pay Item Number	Pay Item Description	Pay Unit	Quantity	Unit Bid Price	Amount Bid
***** CONTINUE BASIC BID *****					
620.0001.0000	Topsoil	S.Y.	350	\$	\$
622.2012.0000	ELP Walkway	S.F.	3410	\$	\$
622.2012.0001	River Access Stair Tread	Each	32	\$	\$
622.2014.0000	Spotting Scope	Each	2	\$	\$
622.2014.0001	Barrier Rail	L.F.	114	\$	\$
622.2028.0000	Orientation Kiosk	Each	1	\$	\$
622.2028.0001	Interpretive Bracket	Each	8	\$	\$
640.0001.0000	Mobilization and Demobilization	L.S.	All Req'd	\$(LUMP SUM)	\$
640.0004.0000	Worker Meals and Lodging, or Per Diem	L.S.	All Req'd	\$(LUMP SUM)	\$
641.0001.0000	Erosion, Sediment and Pollution Control Administration	L.S.	All Req'd	\$(LUMP SUM)	\$
641.0002.0000	Temporary Erosion, Sediment and Pollution Control	C.S.	All Req'd	\$20,000.00	\$20,000.00
641.0006.0000	Withholding	C.S.	All Req'd	\$0.00	\$0.00
641.0007.0000	SWPPP Manager	L.S.	All Req'd	\$(LUMP SUM)	\$
642.0001.0000	Construction Surveying	L.S.	All Req'd	\$(LUMP SUM)	\$
642.0003.0000	Three Person Survey Party	Hour	10	\$	\$
643.0002.0000	Traffic Maintenance	L.S.	All Req'd	\$(LUMP SUM)	\$
643.0003.0000	Permanent Construction Signs	L.S.	All Req'd	\$(LUMP SUM)	\$
643.0023.0000	Traffic Price Adjustment	C.S.	All Req'd	\$0.00	\$0.00
643.0025.0000	Traffic Control	C.S.	All Req'd	\$2,500.00	\$2,500.00
643.0032.0000	Flagging	C.S.	All Req'd	\$1,000.00	\$1,000.00

BID SCHEDULE  
 KRSMA: Kenai River Flats  
 Facility Improvements  
 Project No. TA-21002/CFHWY00688

Name of Bidding Firm \_\_\_\_\_

Pay Item Number	Pay Item Description	Pay Unit	Quantity	Unit Bid Price	Amount Bid
-----------------	----------------------	----------	----------	----------------	------------

\*\*\*\*\* CONTINUE BASIC BID \*\*\*\*\*

646.0001.0000	CPM Scheduling	L.S.	All Req'd	\$(LUMP SUM)	\$
647.2002.0000	Backhoe, 4WD, 1 CY Bucket, 75-HP Minimum, 15 Ft	C.S.	All Req'd	\$5,000.00	\$5,000.00
670.0001.0000	Painted Traffic Markings	L.S.	All Req'd	\$(LUMP SUM)	\$
TOTAL BASIC BID					\$

No: \_\_\_\_\_ Expires \_\_\_\_\_  
Alaska Business License

No: \_\_\_\_\_ Expires \_\_\_\_\_  
Alaska Contractor's License

ESTIMATE OF QUANTITIES			
ITEM NO.	ITEM DESCRIPTION	UNIT	QUANTITY
202.0001.0000	REMOVAL OF STRUCTURES AND OBSTRUCTIONS	L.S.	ALL REQ'D
203.0003.0000	UNCLASSIFIED EXCAVATION	C.Y.	250
203.0006.000A	BORROW, TYPE A	TON	70
301.0001.00D1	AGGREGATE BASE COURSE, GRADING D-1	TON	1000
401.0001.002B	HMA, TYPE II; CLASS B	TON	500
505.0005.0000	FURNISH STRUCTURAL STEEL HELICAL PILE	L.F.	4400
505.0006.0000	DRIVE STRUCTURAL STEEL HELICAL PILE	EACH	176
615.0001.0000	STANDARD SIGN	S.F.	46
618.0002.0000	SEEDING	POUND	4
620.0001.0000	TOPSOIL	S.Y.	350
622.2012.0000	ELP WALKWAY	S.F.	3410
622.2012.0001	RIVER ACCESS STAIR TREAD	EACH	32
622.2014.0000	SPOTTING SCOPE	EACH	2
622.2014.0001	BARRIER RAIL	L.F.	114
622.2028.0000	ORIENTATION KIOSK	EACH	1
622.2028.0001	INTERPRETIVE BRACKET	EACH	8
640.0001.0000	MOBILIZATION AND DEMOBILIZATION	L.S.	ALL REQ'D
640.0004.0000	WORKER MEALS AND LODGING, OR PER DIEM	L.S.	ALL REQ'D
641.0001.0000	EROSION, SEDIMENT AND POLLUTION CONTROL ADMINISTRATION	L.S.	ALL REQ'D
641.0002.0000	TEMPORARY EROSION, SEDIMENT AND POLLUTION CONTROL	C.S.	ALL REQ'D
641.0006.0000	WITHOLDING	C.S.	ALL REQ'D
641.0007.0000	SWPPP MANAGER	C.S.	ALL REQ'D
642.0001.0000	CONSTRUCTION SURVEYING	L.S.	ALL REQ'D
642.0003.0000	THREE PERSON SURVEY PARTY	HOUR	10
643.0002.0000	TRAFFIC MAINTENANCE	L.S.	ALL REQ'D
643.0003.0000	PERMANENT CONSTRUCTION SIGNS	L.S.	ALL REQ'D
643.0023.0000	TRAFFIC PRICE ADJUSTMENT	C.S.	ALL REQ'D
643.0025.0000	TRAFFIC CONTROL	C.S.	ALL REQ'D
643.0032.0000	FLAGGING	C.S.	ALL REQ'D
646.0001.0000	CPM SCHEDULING	L.S.	ALL REQ'D
647.2002.0000	BACKHOE, 4WD, 1 CY BUCKET, 75HP MINIMUM, 15 FT.	C.S.	ALL REQ'D
670.0001.0000	PAINTED TRAFFIC MARKINGS	L.S.	ALL REQ'D



**LEGEND**

EXISTING	PROPOSED	
		EDGE OF AC PAVEMENT
		EDGE OF VEGETATION
		MAJOR CONTOUR LINE
		MINOR CONTOUR LINE
		EDGE OF GRAVEL ROAD/PARKING
		CULVERT
		WATERLINE
		BARRIER RAIL
		SURVEY CONTROL POINT
		LIMITS OF CUT SLOPE
		LIMITS OF FILL SLOPE
		BARRIER ROCK
		SPOTTING SCOPE/ ADA SPOTTING SCOPE
		SIGN
		PICNIC TABLE
		ORIENTATION KIOSK

**ABBREVIATIONS**

φ	DIAMETER
CL	CENTERLINE
AC	ASPHALT CONCRETE
APPRX.	APPROXIMATE
BLDG	BUILDING
BVCE	BEGIN VERTICAL CURVE ELEVATION
BVCS	BEGIN VERTICAL CURVE STATION
C.F.	CUBIC FOOT
CP	CONTROL POINT
CPP	CORRUGATED POLYETHYLENE PIPE
C.S.	CONTINGENT SUM
C.Y.	CUBIC YARD
ELEV	ELEVATION
ELP	ELEVATED LIGHT PENETRATING
EST	ESTIMATE
EVCE	END VERTICAL CURVE ELEVATION
EVCS	END VERTICAL CURVE STATION
HSS	HOLLOW STRUCTURAL SECTION
INV.	INVERT
LB	POUND
LB/LBS	POUND/POUNDS
L.F.	LINEAR FEET
L.S.	LUMP SUM
M.E.	MATCH EXISTING
MAX.	MAXIMUM
MIN.	MINIMUM
MP	MILEPOST
NO.	NUMBER
OC	ON CENTER
OHW	ORDINARY HIGH WATER
PCC	PORTLAND CEMENT CONCRETE
PL	PLATE
PIP	PROTECT IN PLACE
PST	PERFORATED SQUARE TUBE
QTY.	QUANTITY
RAS	RIVER ACCESS STAIRS
REQ'D	REQUIRED
S.F.	SQUARE FEET
SRS	STATE RECREATION SITE
STA	STATION
STD.	STANDARD
S.Y.	SQUARE YARD
TYP.	TYPICAL

**TABLE OF ESTIMATING FACTORS**

ITEM NO.	ITEM DESCRIPTION	ESTIMATING FACTOR
203.0006.000A	BORROW, TYPE A	144 LB/C.F.
301.0001.00D1	AGGREGATE BASE COURSE, GRADING D-1	144 LB/C.F.
401.0001.002B	HOT MIX ASPHALT, TYPE II, CLASS B	151 LB/S.Y.



NO.	REVISION	DATE	NOTES
1	ADDENDUM 1	3/21/25	QUANTITY CHANGE

**STATE OF ALASKA, DEPARTMENT OF NATURAL RESOURCES**  
**PLANS DEVELOPED BY: DIVISION OF PARKS AND OUTDOOR RECREATION**  
 550 W 7TH AVE. SUITE 1340, ANCHORAGE, AK 99501 - 907.269.8731

KRSMA: KENAI RIVER FLATS  
 FACILITY IMPROVEMENTS

ESTIMATE OF QUANTITIES,  
 ABBREVIATIONS & TABLE OF ESTIMATING FACTORS

PROJECT NO. TA-21002/CFHWY00688



PREPARED: CDC  
 DRAWN: CDC  
 REVIEWED: RCS  
 DATE: FEB 2025

SHEET  
 2  
 OF 28 SHEETS

NO.	REVISION	DATE	NOTES
1	ADDENDUM 1	3/21/25	ADA PARKING STALL AND SIGNAGE

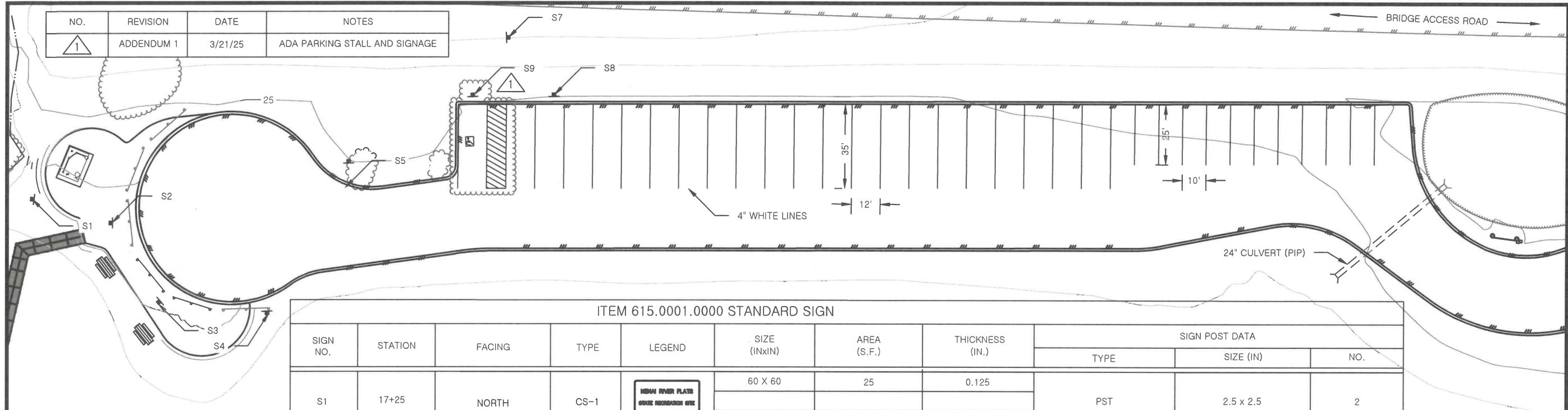

ITEM 615.0001.0000 STANDARD SIGN

SIGN NO.	STATION	FACING	TYPE	LEGEND	SIZE (INxIN)	AREA (S.F.)	THICKNESS (IN.)	SIGN POST DATA		
								TYPE	SIZE (IN)	NO.
S1	17+25	NORTH	CS-1	NO PARKING OFF ROAD VEHICLE USE PROHIBITED	60 X 60	25	0.125	PST	2.5 x 2.5	2
S2	17+00	SOUTH	R7P-101	NO PARKING ANY TIME	12 X 18	1.50	0.125	PST	2.5 x 2.5	1
S3	16+95	SOUTHEAST	R7P-101	NO PARKING ANY TIME	12 X 18	1.50	0.125	PST	2.5 x 2.5	1
S4	16+50	SOUTHEAST	R7P-101	NO PARKING ANY TIME	12 X 18	1.50	0.125	PST	2.5 x 2.5	1
S5	17+00	EAST	R7-1	NO PARKING ANY TIME	18 X 9	1.13	0.125	PST	2.5 x 2.5	1
S6	16+00	WEST	CS-2	OFF ROAD VEHICLE USE PROHIBITED	12 X 18	1.50	0.125	PST	2.5 x 2.5	1
				NO GROUND FIRES	12 X 18	1.50	0.125			
S7	15+45	NORTH	D9-14	P	30 X 30	6.25	0.125	PST	2.5 x 2.5	1
		NORTH	W1-6R	→	6 X 30	1.25	0.125			
S8	15+25	WEST	CS-3	CUSTOM SIGN	12 X 18	1.50	0.125	PST	2.5 x 2.5	1
S9	15+52	WEST	R7-8	RESERVED PARKING	12 X 18	1.50	0.125	PST	2.5 x 2.5	1
		WEST	R7-8A	VAN ACCESSIBLE	18 X 9	1.13	0.125			
TOTALS						46				10

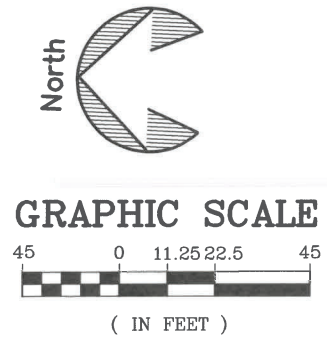

STATE OF ALASKA, DEPARTMENT OF NATURAL RESOURCES  
 PLANS DEVELOPED BY: DIVISION OF PARKS AND OUTDOOR RECREATION  
 550 W 7TH AVE. SUITE 1340, ANCHORAGE, AK 99501 - 907.269.8731  
 KRMA: KENAI RIVER FLATS  
 FACILITY IMPROVEMENTS  
 PROJECT NO. TA-21002/CFHWY00688  
 STRIPING PLAN & SIGN SUMMARY TABLE



PREPARED: CDC  
 DRAWN: CDC  
 REVIEWED: RCS  
 DATE: FEB 2025  
 SHEET  
**9**  
 OF 28 SHEETS

NOTES:  
1. TOPSOIL AND SEE EDGES OF D1

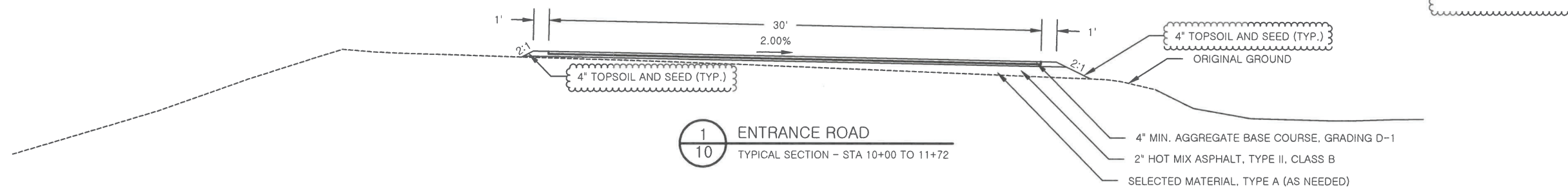

1  
10 ENTRANCE ROAD  
TYPICAL SECTION - STA 10+00 TO 11+72

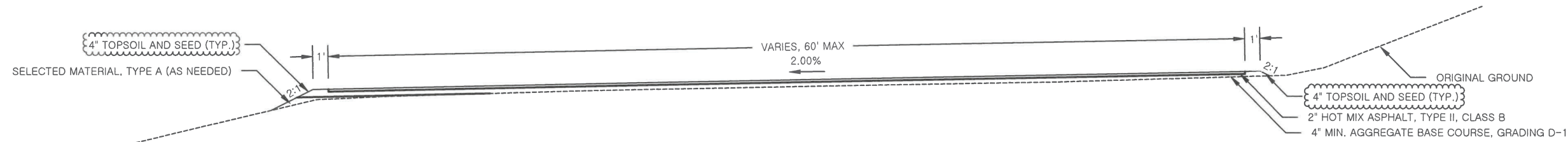

2  
10 PARKING AREA  
TYPICAL SECTION - STA 11+72 TO 15+61

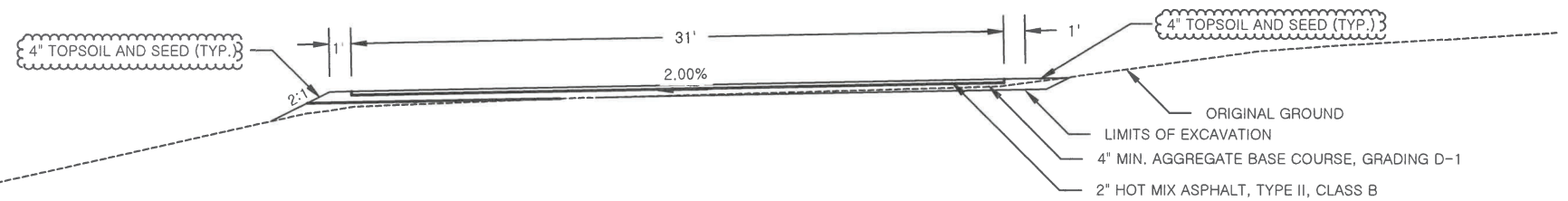

3  
10 ROAD TO TURNAROUND AREA  
TYPICAL SECTION - STA 15+61 TO 16+24

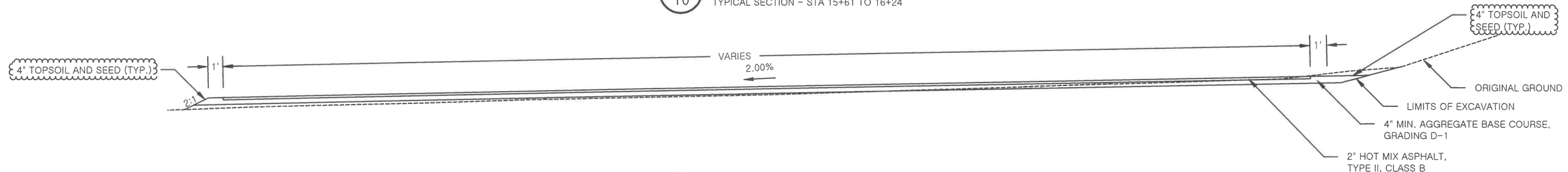

4  
10 TURNAROUND AREA  
TYPICAL SECTION - STA 16+24 TO 23+50

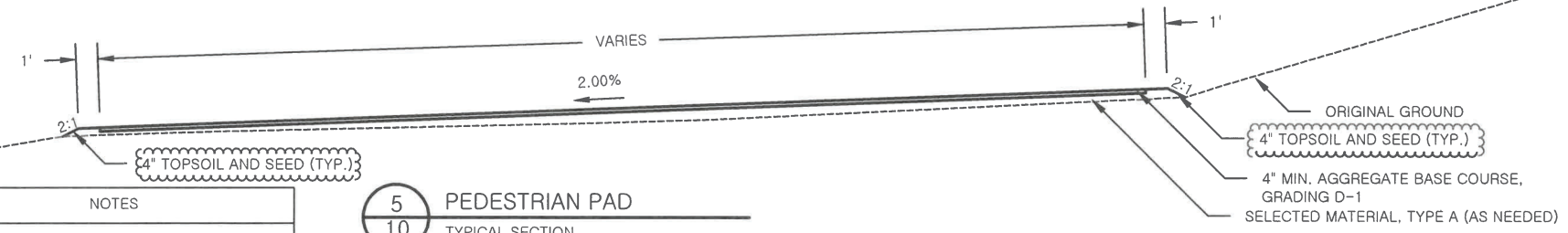

5  
10 PEDESTRIAN PAD  
TYPICAL SECTION



NO.	REVISION	DATE	NOTES
1	ADDENDUM 1	3/21/25	CLARIFY TOPSOIL AND SEED AREA

**STATE OF ALASKA, DEPARTMENT OF NATURAL RESOURCES**  
**PLANS DEVELOPED BY: DIVISION OF PARKS AND OUTDOOR RECREATION**  
 550 W 7TH AVE. SUITE 1340, ANCHORAGE, AK 99501 - 907.269.8731

KRSMA: KENAI RIVER FLATS  
 FACILITY IMPROVEMENTS  
 PROJECT NO. TA-21002/CFHWY00688

PARKING LOT TYPICAL SECTIONS



PREPARED: CDC  
 DRAWN: CDC  
 REVIEWED: RCS  
 DATE: FEB 2025

SHEET  
**10**  
 OF 28 SHEETS

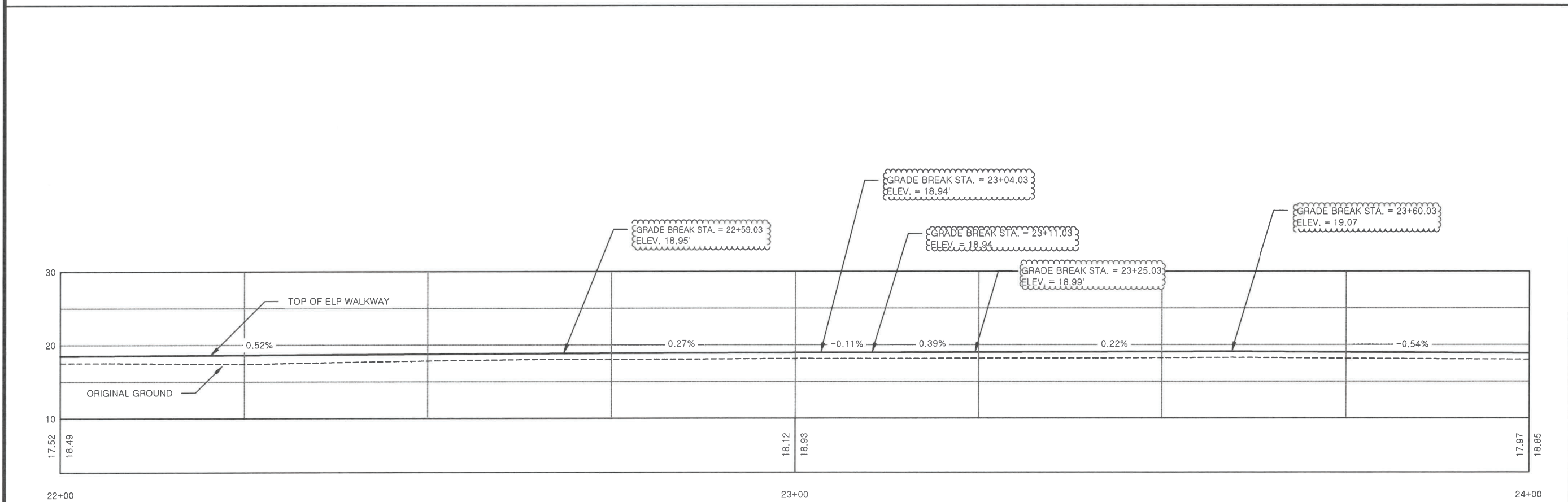
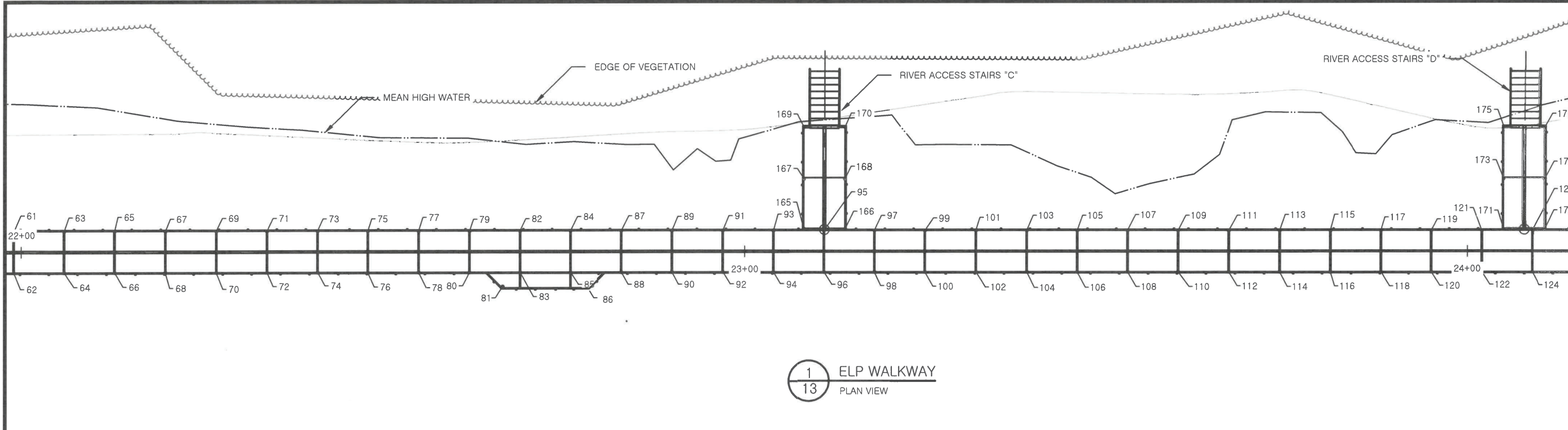

2 ELP WALKWAY  
13 PROFILE VIEW

NOTES:  
1. PROFILE ELEVATIONS ARE IN REFERENCE TO TOP OF FINISHED WALKWAY

NO.	REVISION	DATE	NOTES
1	ADDENDUM 1	3/21/25	MODIFY TOP OF WALKWAY ELEVATION

**STATE OF ALASKA, DEPARTMENT OF NATURAL RESOURCES**  
**PLANS DEVELOPED BY: DIVISION OF PARKS AND OUTDOOR RECREATION**  
 550 W 7TH AVE. SUITE 1340, ANCHORAGE, AK 99501 - 907.269.8731

KRSMA: KENAI RIVER FLATS  
 FACILITY IMPROVEMENTS  
 PROJECT NO. TA-21002/CFHWY00688

ELP WALKWAY PLAN AND PROFILE  
 STA. 22+00 TO 24+00



PREPARED: CDC  
 DRAWN: CDC  
 REVIEWED: RCS  
 DATE: FEB 2025

SHEET

13

OF 28 SHEETS

NOTES:

1. FRAME CORNERS SHALL BE JOINED USING MITERED CORNERS.

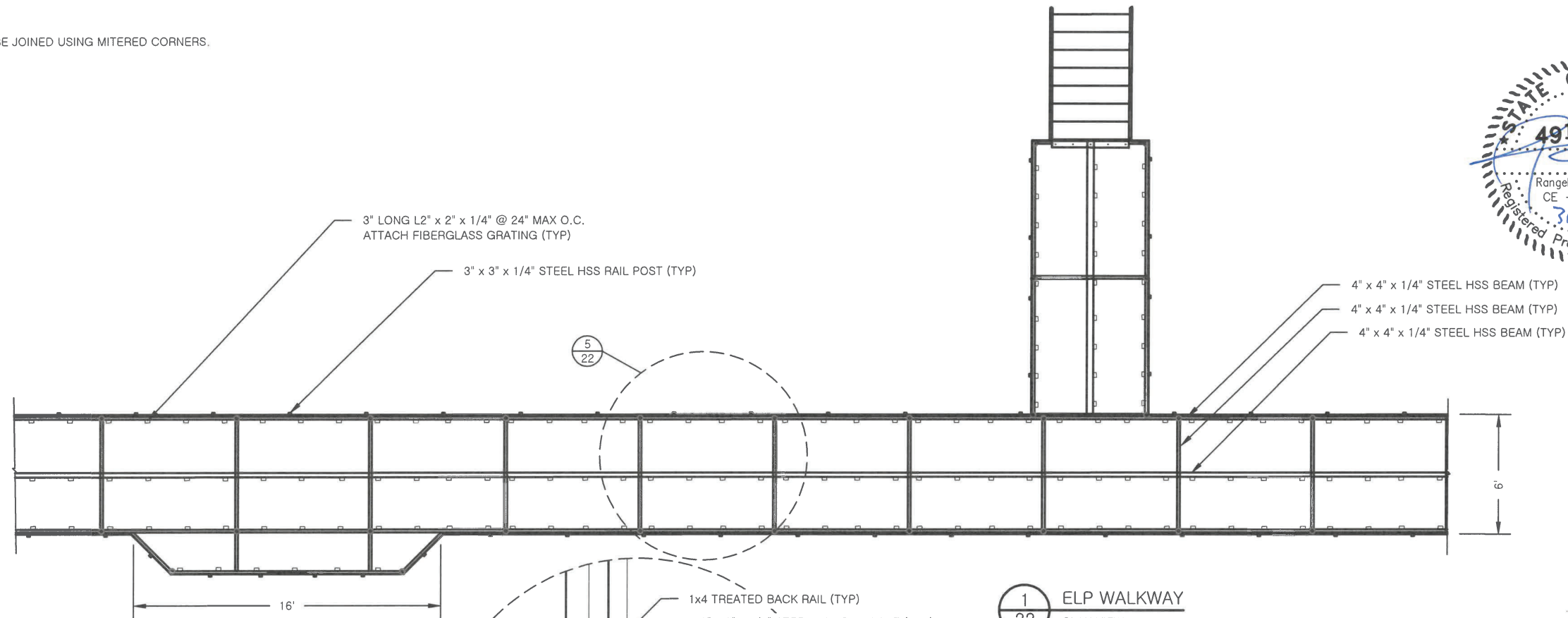

1  
22  
ELP WALKWAY  
PLAN VIEW

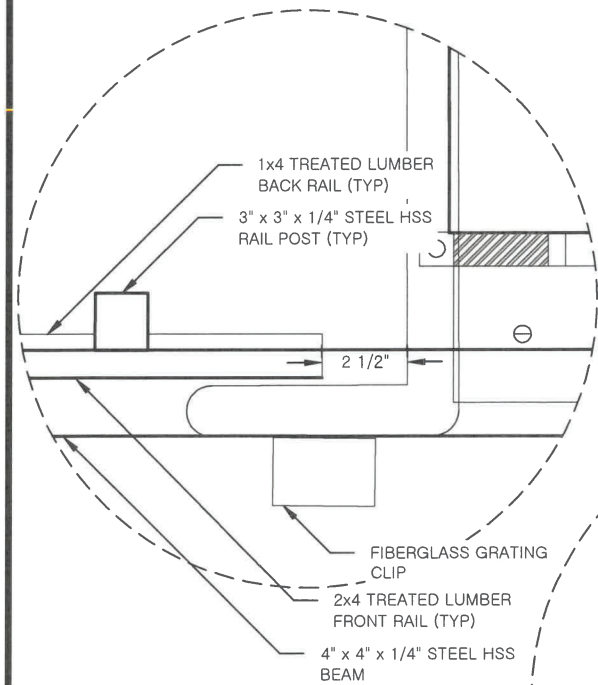

2  
22  
RAIL POST SPACING  
DETAIL

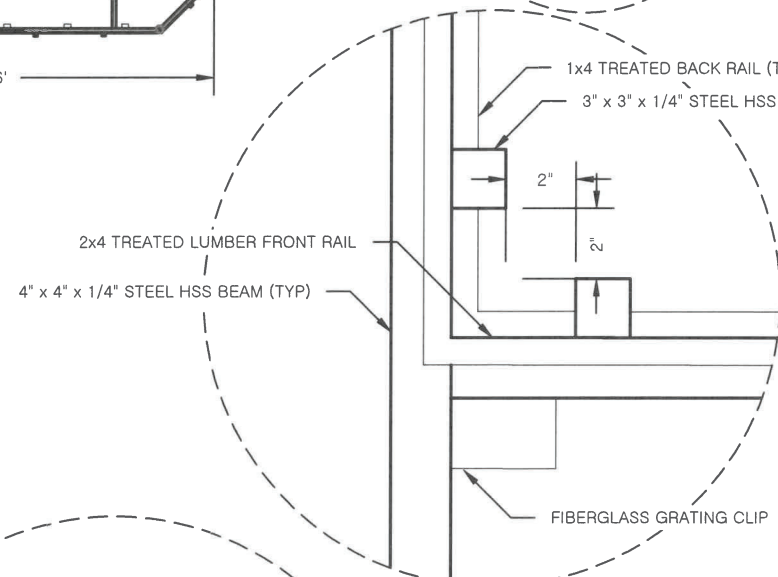

4  
22  
RAIL POST SPACING  
INSIDE CORNER

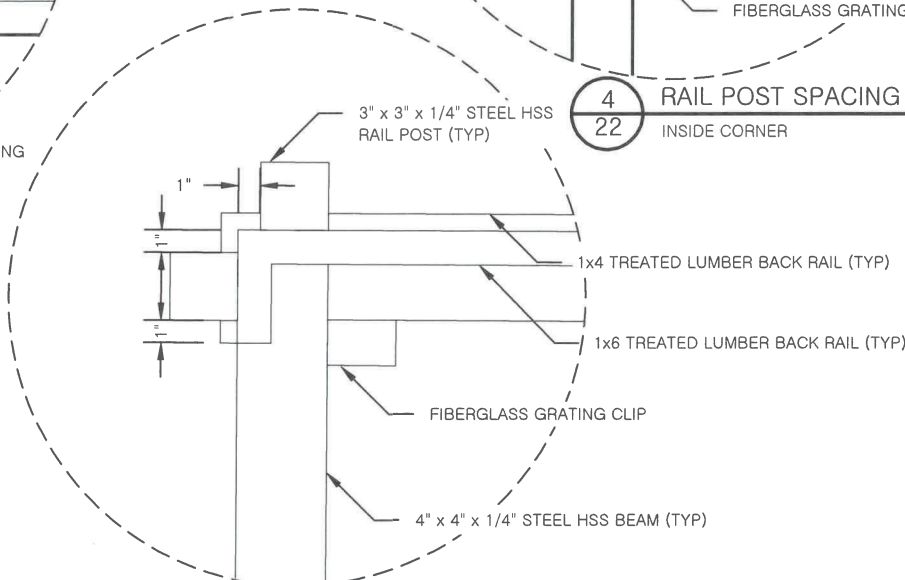

3  
22  
RAIL POST SPACING  
END CORNER

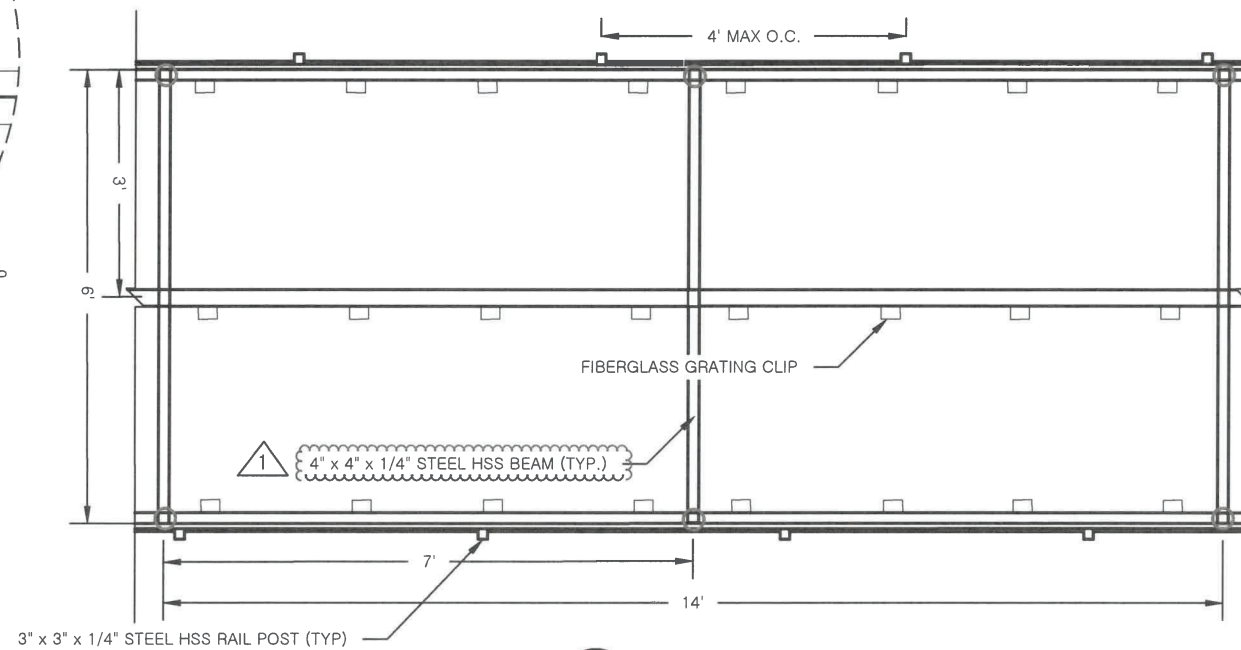

5  
22  
ELP DECK  
PLAN VIEW

NO.	REVISION	DATE	NOTES
1	ADDENDUM 1	3/21/25	CLARIFY LOCATION OF 4" x 4" x 1/4" STEEL HSS BEAM ON ELP

STATE OF ALASKA, DEPARTMENT OF NATURAL RESOURCES  
 PLANS DEVELOPED BY: DIVISION OF PARKS AND OUTDOOR RECREATION  
 550 W 7TH AVE. SUITE 1340, ANCHORAGE, AK 99501 - 907.269.8731

KRSMA: KENAI RIVER FLATS  
 FACILITY IMPROVEMENTS  
 PROJECT NO. TA-21002/CFHWY00688

ELP WALKWAY FRAMING DETAILS II



PREPARED: CDC  
 DRAWN: CDC  
 REVIEWED: RCS  
 DATE: FEB 2025

SHEET

22

OF 28 SHEETS

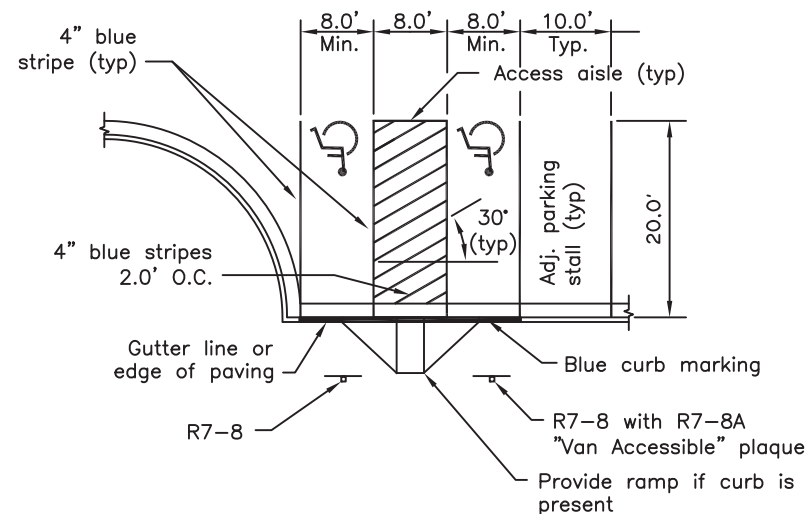

PARKING LOT ACCESSIBLE PERPENDICULAR PARKING

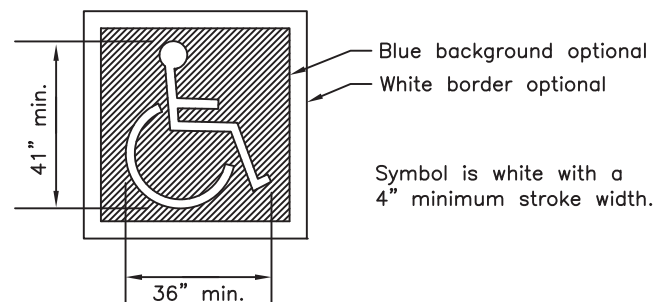

PAVEMENT MARKING SYMBOL DETAIL

GENERAL NOTES:

1. Accessible aisles and accessible routes and those pathways leading from the accessible parking space to the sidewalk shall be free of any obstructions, fixtures or loose surfaces.
2. See standard drawing I-20, I-21, I-22 for curb and curb ramp details.
3. All curb ramps shall be constructed of concrete.
4. The slope for all accessible parking spaces, van accessible parking spaces and access aisles shall not exceed 50:1 in any direction.
5. Although only perpendicular ramps are shown, either parallel or perpendicular ramps are allowable, space permitting.

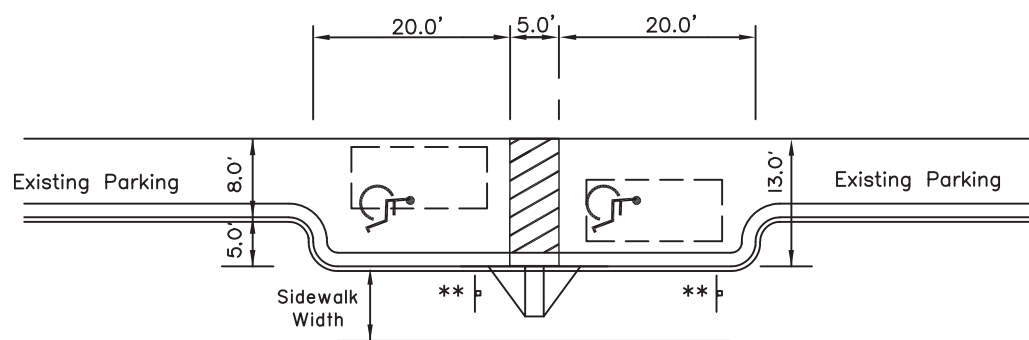

ACCESSIBLE ON-STREET PARALLEL PARKING PARTIAL INSET

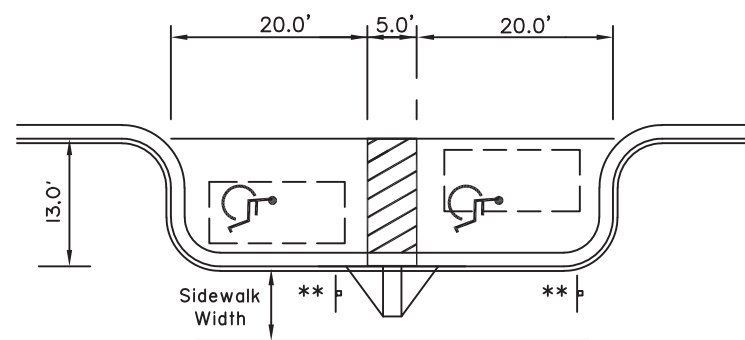

ACCESSIBLE ON-STREET PARALLEL PARKING FULL INSET

ON-STREET PARALLEL PARKING NOTES

1. The 13' width provides for 8' wide parking with a 5' wide access aisle on either side of a car.
2. Add a new curb ramp and 5' aisle between parking places for each additional two accessible parking spaces.
3. Parking spaces may be made van accessible by providing an unobstructed 8' sidewalk width next to each parking space. Ensure curb ramps, parking meters, sign posts, etc. do not encroach on the area where a van's lift would operate.
4. In some cases, ADAAG may allow normal-width parking spaces at the beginning and end of blocks to be designated as accessible. See the latest ADAAG.

\*\* R7-8 "Reserved Parking" and, where appropriate (see note 3), R7-8A, "Van Accessible".

State of Alaska DOT&PF  
ALASKA STANDARD PLAN

ACCESSIBLE PARKING

Adopted as an Alaska Standard Plan by: *Kenneth J. Fisher*  
Kenneth J. Fisher, P.E.  
Chief Engineer

Adoption Date: 02/08/2019

Last Code and Stds. Review By: Date:

Next Code and Standards Review date: 02/08/2029

## SECTION 203

### EXCAVATION AND EMBANKMENT

**203-3.03 EMBANKMENT CONSTRUCTION.** Add the following:

Cut and fill slopes shall be constructed to template. At the direction of the Engineer, the Contractor may be required to finish all slopes by a method of hand raking. This work shall be at no additional cost to the State. The finished slope surface parallel to the shoulder line shall not vary more than 0.10 foot when tested using a 10-foot straightedge. The finished slope surface perpendicular to the shoulder line shall not vary more than 0.10 foot for the following slope ratios and corresponding straightedge lengths: 2:1 slope and two-foot length; 3:1 slope and three-foot length; 4:1 slope and four-foot length; 5:1 slope and five-foot length; and 6:1 slope and six-foot length.

(01/01/01)PARKS-Special Provision

**203-3.04 COMPACTION WITH MOISTURE AND DENSITY CONTROL.** In the second paragraph of this subsection, delete the words: “and ATM 214.”

(11/30/20)HSM20-5-Standard Modification

**203-4.01 METHOD OF MEASUREMENT.**

**Add the following: Clearing and grubbing will not be measured directly for payment but will be considered subsidiary to other Section 203 items.**

**203-5.01 BASIS OF PAYMENT.** Add the following: The contract unit price for borrow is for furnishing the material if suitable selected material is not available in the unclassified excavation. The cost for placing and compacting the imported material is included in the contract unit price. The cost for placing and compacting selected material acquired from unclassified excavation shall be included in the contract unit price for the excavation items. Material paid for as excavation will not be paid for again as selected material.

(01/01/01)PARKS-Special Provision

SPECIAL PROVISIONS  
KRSMA: KENAI RIVER FLATS  
FACILITY IMPROVEMENTS  
PROJECT NO. TA-21002/CFHWY0068

Replace Section 643 with the following:

## SECTION 643

### TRAFFIC MAINTENANCE

**643-1.01 DESCRIPTION.** Protect and control traffic during the contract. Furnish, erect, maintain, replace, clean, move, and remove the traffic control devices required to ensure the traveling public's safety. Perform all administrative responsibilities necessary to implement this work.

Maintain all roadways and pedestrian and bicycle facilities affected by the work in a smooth and traversable condition to maintain access to private businesses in the project boundaries. Construct and maintain approaches, crossings, intersections, and other necessary features throughout the project for the life of the contract.

Illuminate construction activities listed in Table 643-4 during hours of night work on roads open to the public within project limits.

**[Deleted Text]**

**No Construction activity will be allowed from July 1 to August 18, 2025. Full closure prior to July 1, 2025 and after August 18, 2025 is allowable.**

**643-1.02 DEFINITIONS.** These definitions apply only to Section 643.

**ATM.** When used in this Section, ATM stands for the Alaska Traffic Manual, which is comprised of the Manual on Uniform Traffic Control Devices (MUTCD), the Alaska Traffic Manual Supplement, any adopted revisions or interim addenda to either document issued subsequently, and corrections to known errors to either document.

**Balloon Light.** Light surrounding by a balloon-like enclosure kept inflated by pressurized air or helium, and producing uniform light through 360 horizontal degrees.

**Construction Phasing Plan.** A plan for each phase of the project showing how to accommodate traffic. Show the sequence of work by segment or phase, if required.

**Fixed Objects.** Private vehicles, parked flagger vehicles, idle construction equipment,