

STATE OF ALASKA
DEPARTMENT OF NATURAL RESOURCES
DIVISION OF PARKS
AND
OUTDOOR RECREATION

OLIVER INLET SMP
TRAM IMPROVEMENTS

PROJECT NO.
79199-2

In Cooperation with the Department of Fish and Game,
Division of Wildlife Management
Funding: 75% Federal Aid / 25% State Funded

Vicinity Map

SM, T43, R68, S28

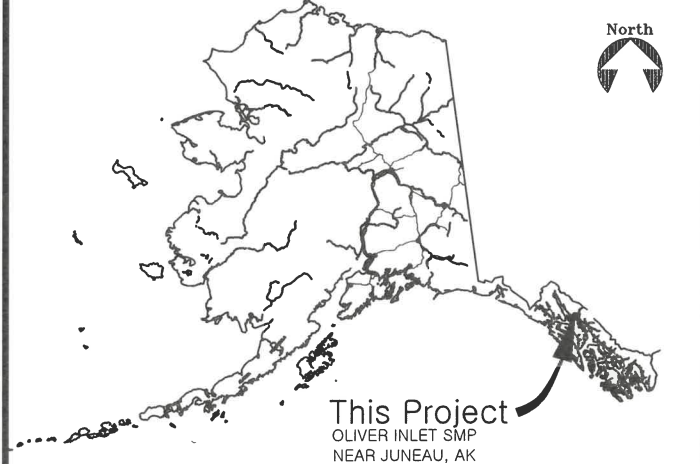

INDEX

1. TITLE SHEET
2. ESTIMATE OF QUANTITIES, LEGEND AND ABBREVIATIONS
3. VICINITY MAP AND EXISTING CONDITIONS
4. PLAN AND PROFILE
5. TRAM TERMINAL DETAILS
6. TRAM REPAIR PLAN
7. INTERPRETIVE SIGN, TYPE E DETAILS
8. ADDITIVE ALTERNATIVE {NO.1} WATER ACCESS PATHWAY
9. ADDITIVE ALTERNATIVE {NO.2} REMOVAL OF DEBRIS PILES

Plans developed by:
STATE OF ALASKA
Department of Natural Resources
Division of Parks & Outdoor Recreation
550 W 7th Ave. Suite 1340, Anchorage, AK 99501

Recommended:

Ros Miranda
Ros Miranda, P.E.
Chief, Design and Construction

5/22/24
Date

Approved: *for*

M. WEDEKIND
Ricky Geese
Director, Alaska State Parks

5/24/24
Date

EXISTING

LEGEND

PROPOSED

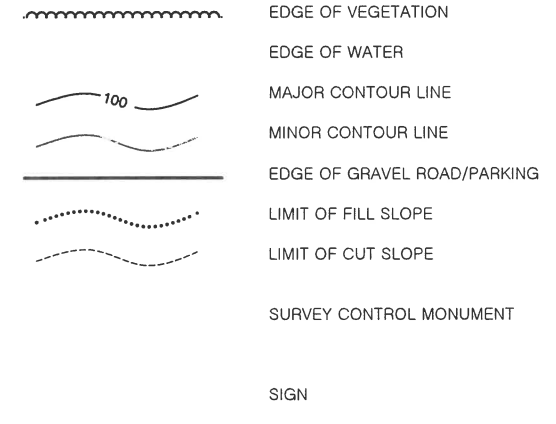
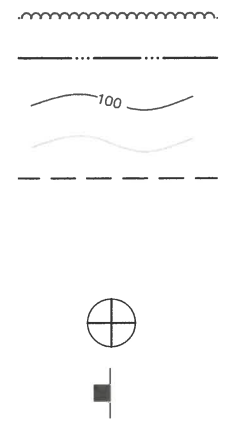

EDGE OF VEGETATION
 EDGE OF WATER
 MAJOR CONTOUR LINE
 MINOR CONTOUR LINE
 EDGE OF GRAVEL ROAD/PARKING
 LIMIT OF FILL SLOPE
 LIMIT OF CUT SLOPE
 SURVEY CONTROL MONUMENT
 SIGN

ABBREVIATIONS AND SYMBOLS

∅ DIAMETER
 CL CENTERLINE
 C.S. CONTINGENT SUM
 DNR DEPARTMENT OF NATURAL RESOURCES
 E EAST
 ELEV. ELEVATION
 F.G. FINISH GRADE
 HWY HIGHWAY
 INV INVERT
 L.S. LUMP SUM
 LB/LBS POUND/POUNDS
 M.E. MATCH EXISTING
 MP MILEPOST
 N NORTH
 NE NORTHEAST
 NO. NUMBER
 NW NORTHWEST
 PIP PROTECT IN PLACE
 REQ'D REQUIRED
 SE SOUTHEAST
 S.F. SQUARE FOOT
 SW SOUTHWEST
 S.Y. SQUARE YARD
 TYP TYPICAL
 W WEST
 PUC PUBLIC USE CABIN

100(1) REMOVAL OF STRUCTURES AND OBSTRUCTIONS		
ITEM DESCRIPTION	QUANTITY	COMMENT
TRAM WALKWAY BOARDS	500 L.F.	REMOVE AND DISPOSE
RAIL GAUGE RODS	ALL REQ'D	REMOVE AND SALVAGE

ESTIMATE OF QUANTITIES - BASIC BID			
ITEM NO.	ITEM DESCRIPTION	UNIT	QUANTITY
100(1)	REMOVAL OF STRUCTURES AND OBSTRUCTIONS	L.S.	ALL REQ'D
103(1)	MOBILIZATION AND DEMOBILIZATION	L.S.	ALL REQ'D
104(1)	EROSION, SEDIMENT AND POLLUTION CONTROL ADMINISTRATION	L.S.	ALL REQ'D
104(2)	TEMPORARY EROSION, SEDIMENT AND POLLUTION CONTROL	C.S.	ALL REQ'D
104(3)	ESCP PRICE ADJUSTMENT	C.S.	ALL REQ'D
105(1)	TRAM REPAIR	STA.	5
106(1)	TRAM TERMINAL	EACH	1
107(1)	INTERPRETIVE SIGN, TYPE E	EACH	1

ESTIMATE OF QUANTITIES - ADDITIVE ALTERNATIVE No. 1			
ITEM NO.	ITEM DESCRIPTION	UNIT	QUANTITY
102(1A)	AGGREGATE BASE COURSE, GRADING C-1 - AA1	C.Y.	2

ESTIMATE OF QUANTITIES - ADDITIVE ALTERNATIVE No. 2			
ITEM NO.	ITEM DESCRIPTION	UNIT	QUANTITY
100(1A)	DEBRIS REMOVAL - AA2	L.S.	ALL REQ'D



STATE OF ALASKA, DEPARTMENT OF NATURAL RESOURCES
 PLANS DEVELOPED BY: DIVISION OF PARKS AND OUTDOOR RECREATION
 550 W 7TH AVE. SUITE 1340, ANCHORAGE, AK 99501 - 907.269.8731

ESTIMATE OF QUANTITIES, LEGEND AND ABBREVIATIONS

OLIVER INLET SMP
 TRAM IMPROVEMENTS
 PROJECT No. 79199-2



PREPARED: CDC
 DRAWN: CNS
 REVIEWED: RCS
 DATE: APRIL 2024

SHEET
2
 OF 9 SHEETS

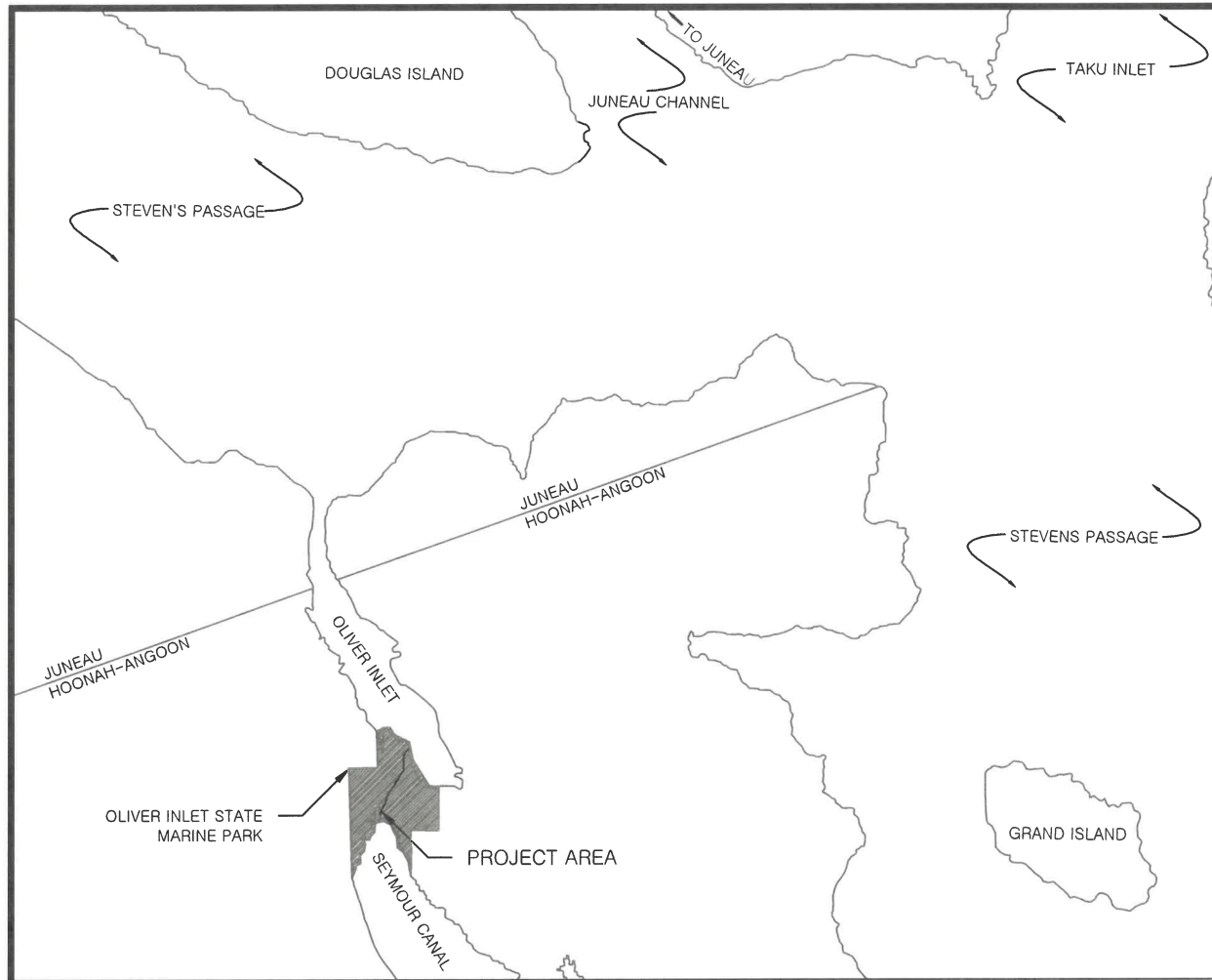

VICINITY MAP

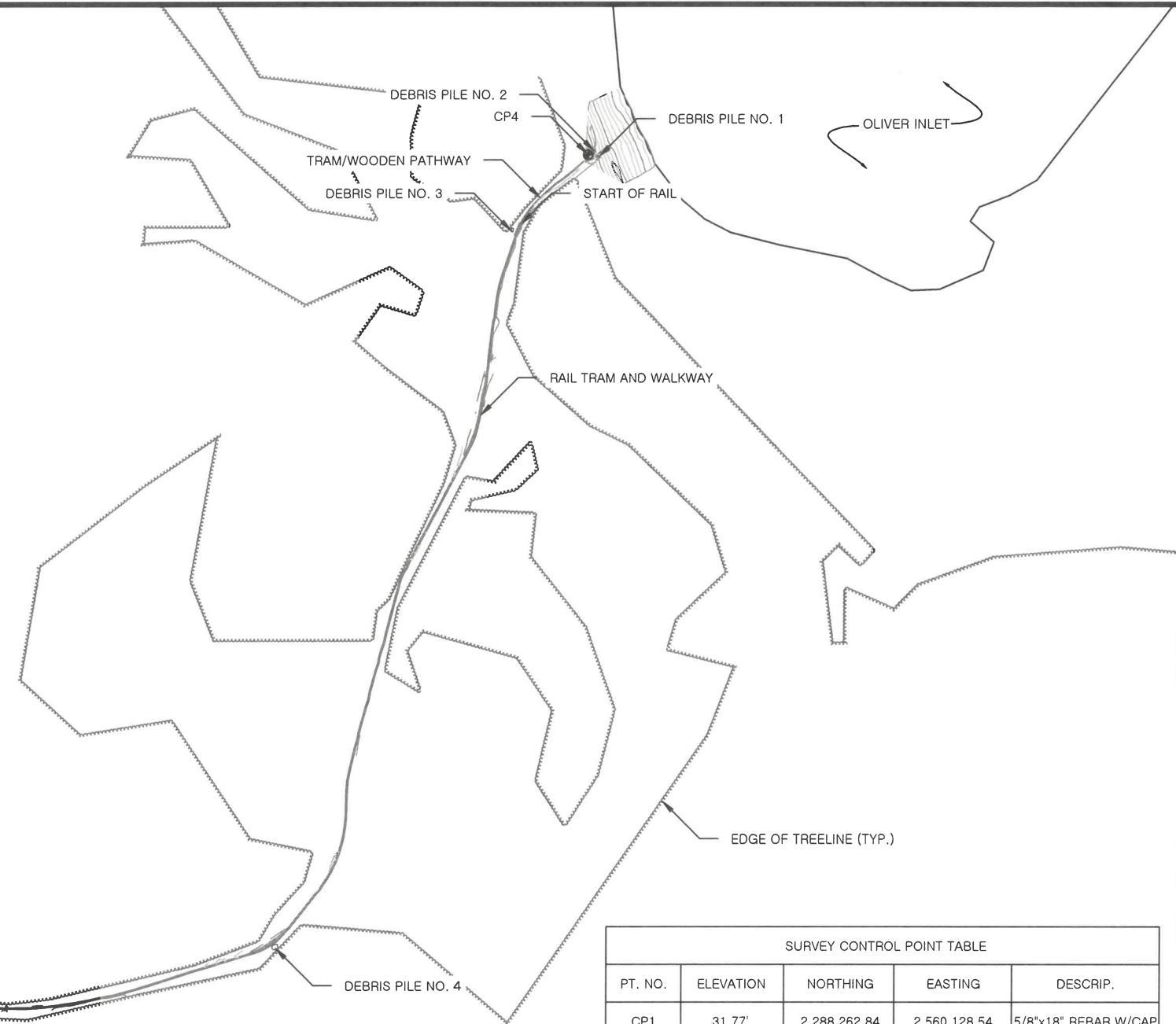

SURVEY CONTROL POINT TABLE				
PT. NO.	ELEVATION	NORTHING	EASTING	DESCRIP.
CP1	31.77'	2,288,262.84	2,560,128.54	5/8"x18" REBAR W/CAP
CP2	32.07'	2,288,320.01	2,560,121.60	MAG NAIL
CP3	32.06'	2,288,309.94	2,560,088.54	5/8"x18" REBAR W/CAP
CP4	37.50'	2,291,177.85	2,562,009.25	5/8"x18" REBAR W/CAP

NOTE:
1. SURVEY PERFORMED BY ALASKA STATE PARKS ON SEPTEMBER 2021.

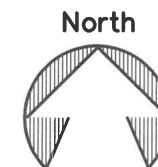
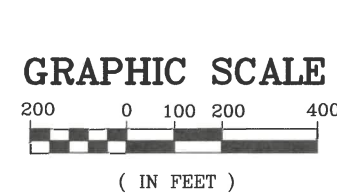
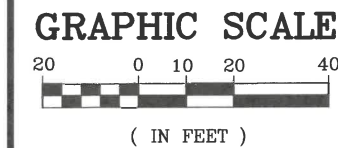
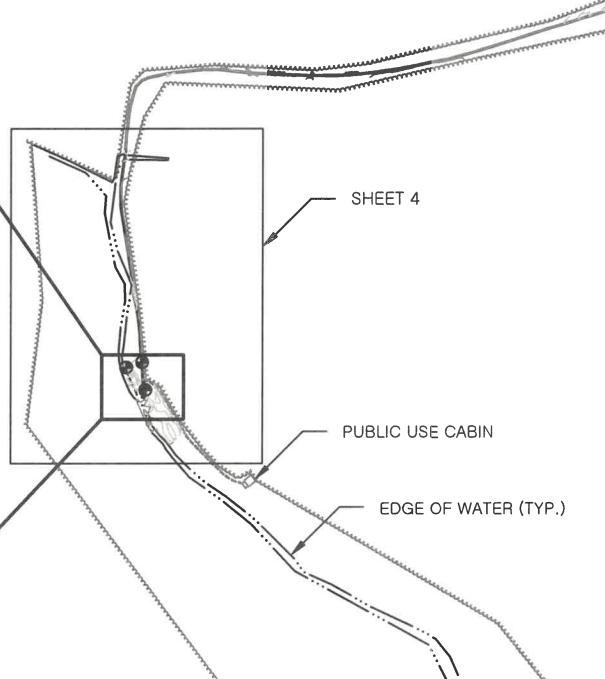
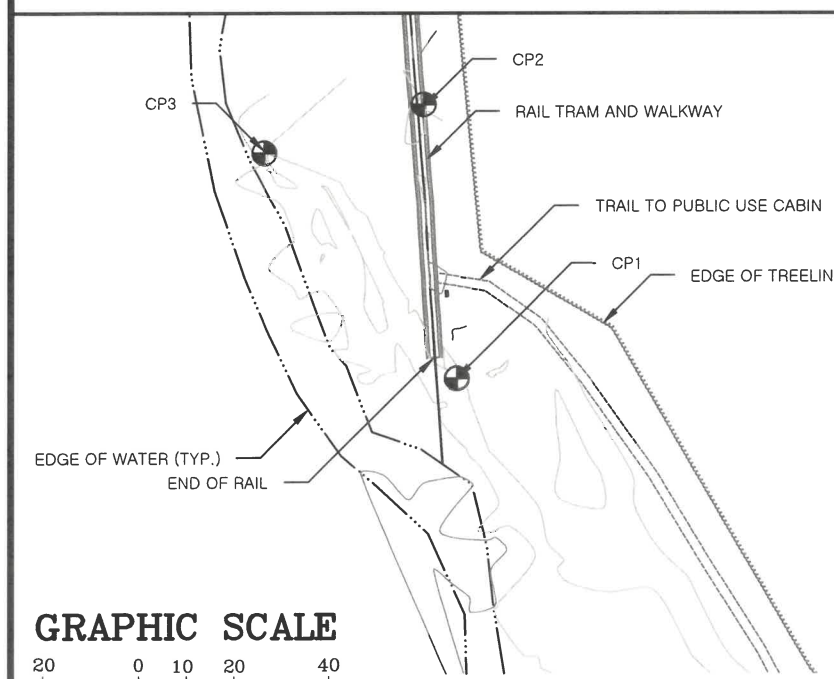

STATE OF ALASKA, DEPARTMENT OF NATURAL RESOURCES
PLANS DEVELOPED BY: DIVISION OF PARKS AND OUTDOOR RECREATION
550 W 7TH AVE. SUITE 1340, ANCHORAGE, AK 99501 - 907.269.8731

OLIVER INLET SMP
TRAM IMPROVEMENTS
PROJECT No. 79199-2

VICINITY MAP AND EXISTING CONDITIONS



PREPARED: CDC
DRAWN: CNS
REVIEWED: RCS
DATE: APRIL 2024

SHEET
3
OF 9 SHEETS

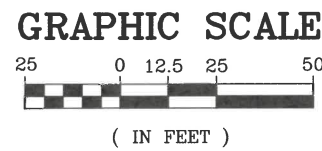
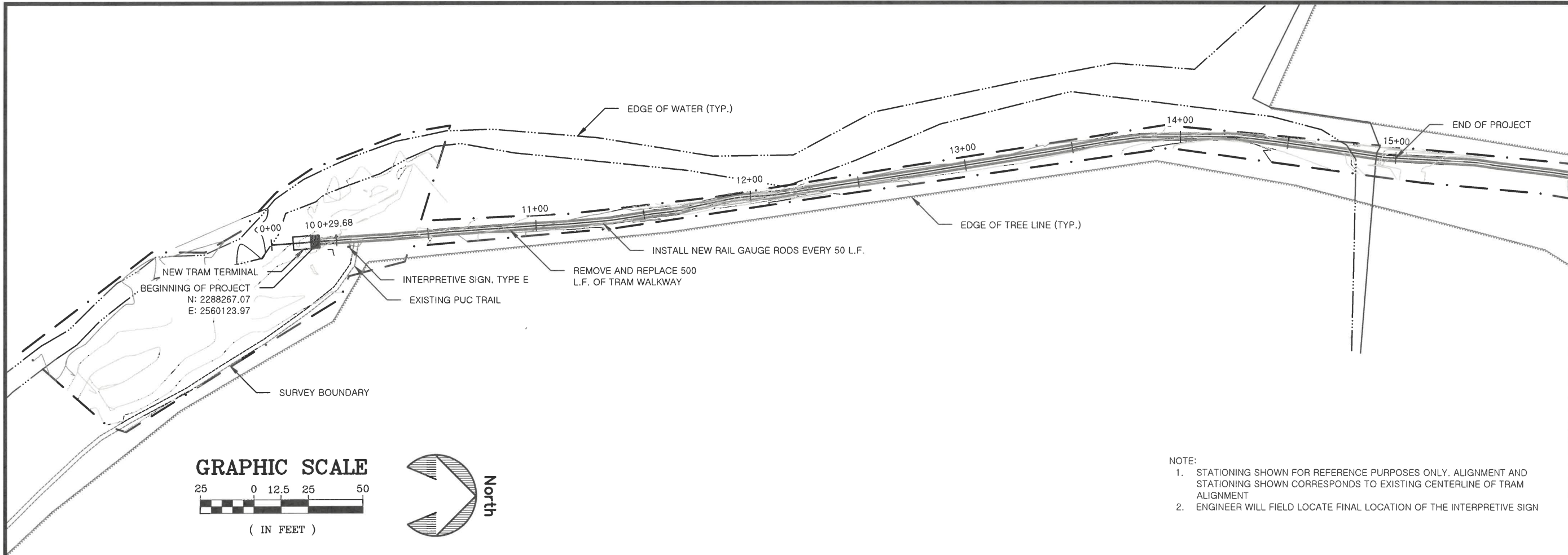

- NOTE:
1. STATIONING SHOWN FOR REFERENCE PURPOSES ONLY. ALIGNMENT AND STATIONING SHOWN CORRESPONDS TO EXISTING CENTERLINE OF TRAM ALIGNMENT
 2. ENGINEER WILL FIELD LOCATE FINAL LOCATION OF THE INTERPRETIVE SIGN

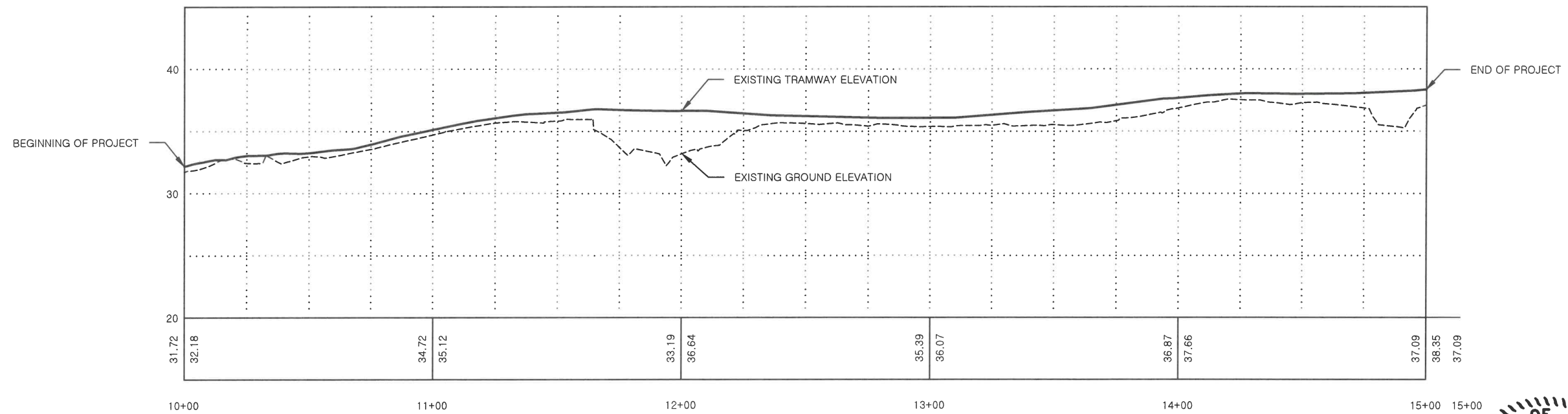

STATE OF ALASKA, DEPARTMENT OF NATURAL RESOURCES
PLANS DEVELOPED BY: DIVISION OF PARKS AND OUTDOOR RECREATION
 550 W 7TH AVE. SUITE 1340, ANCHORAGE, AK 99501 - 907.269.8731

OLIVER INLET SMP
 TRAM IMPROVEMENTS
 PROJECT No. 79199-2

PLAN AND PROFILE



PREPARED: CDC
 DRAWN: CNS
 REVIEWED: RCS
 DATE: APRIL 2024

SHEET

4

OF 9 SHEETS

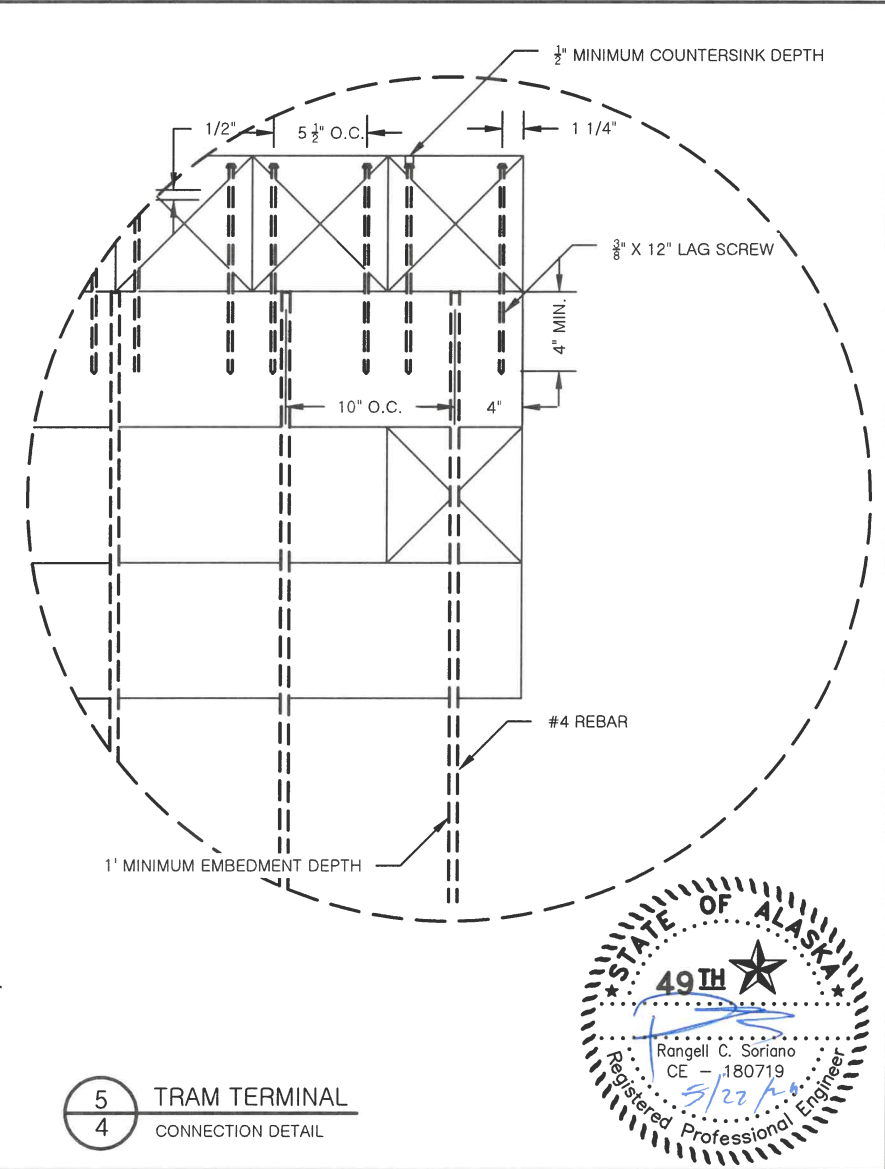
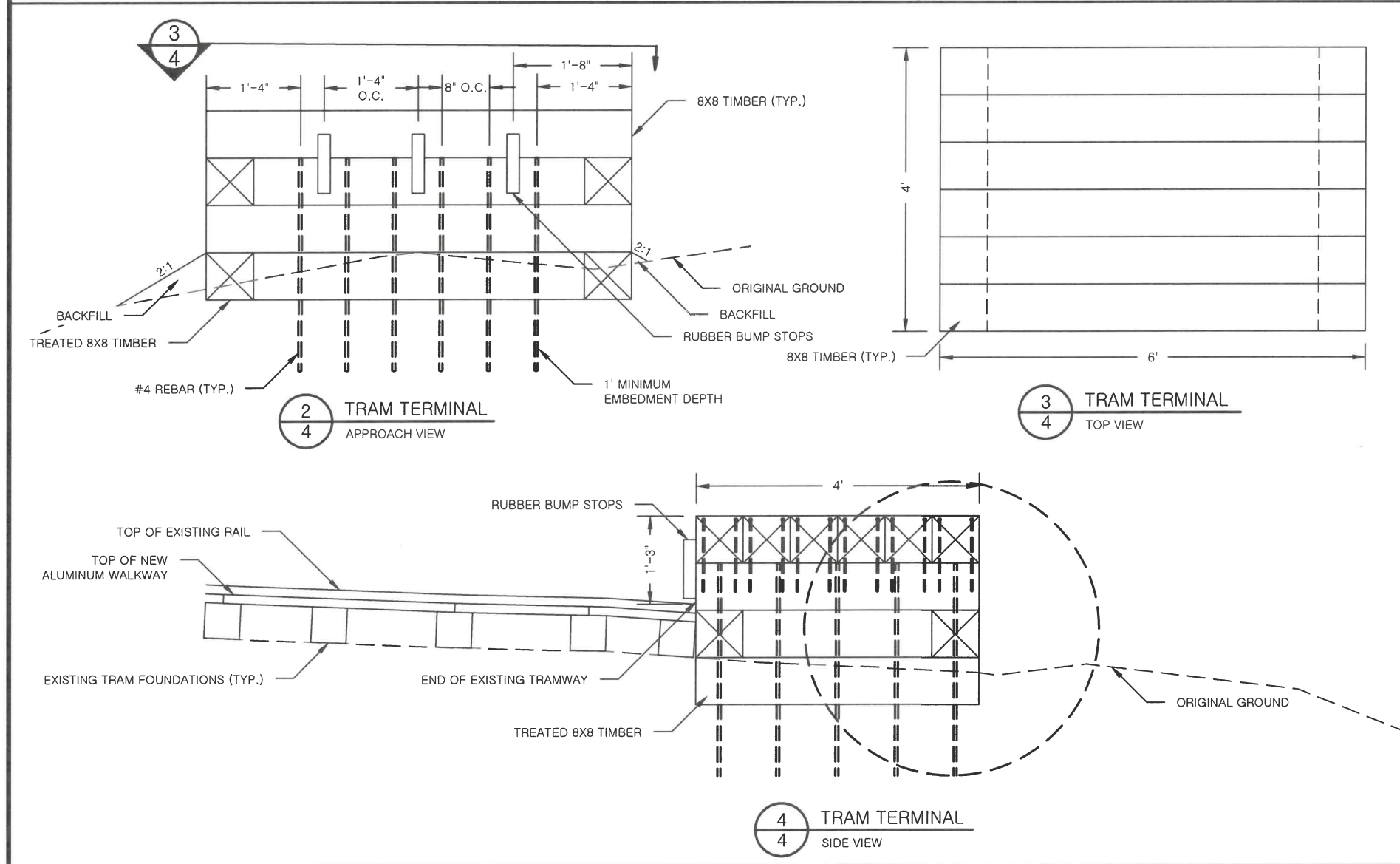
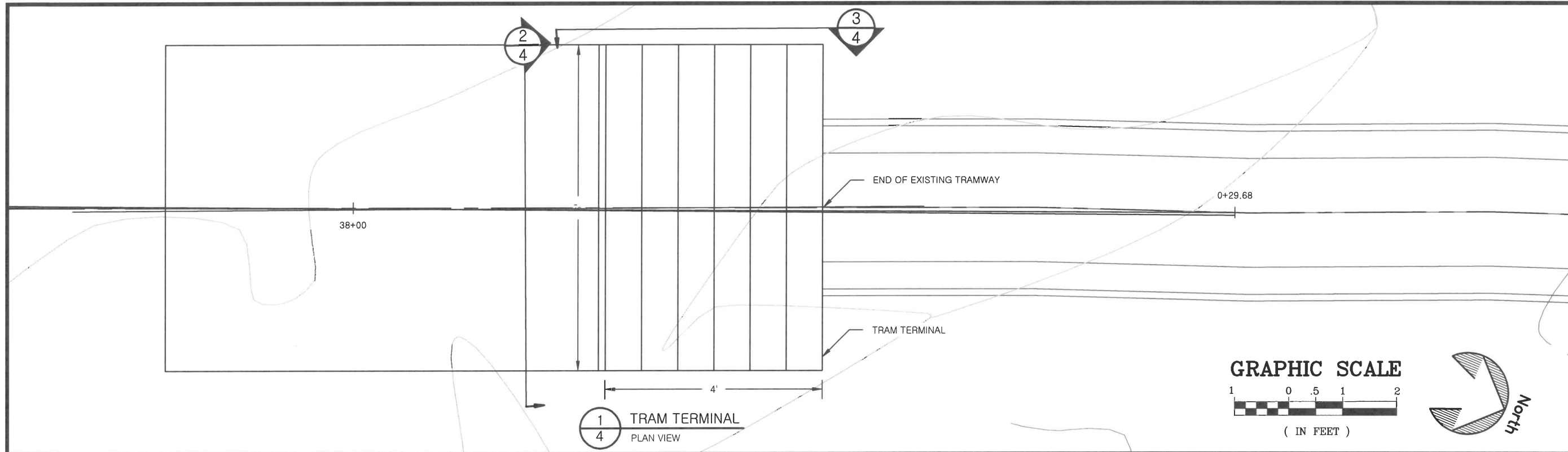

STATE OF ALASKA, DEPARTMENT OF NATURAL RESOURCES
 PLANS DEVELOPED BY: DIVISION OF PARKS AND OUTDOOR RECREATION
 550 W 7TH AVE. SUITE 1340, ANCHORAGE, AK 99501 - 907.269.8731

OLIVER INLET SMP
 TRAM IMPROVEMENTS
 PROJECT No. 79199-2

TRAM TERMINAL DETAILS



PREPARED: CDC
 DRAWN: CNS
 REVIEWED: RCS
 DATE: APRIL 2024

SHEET
 5
 OF 9 SHEETS

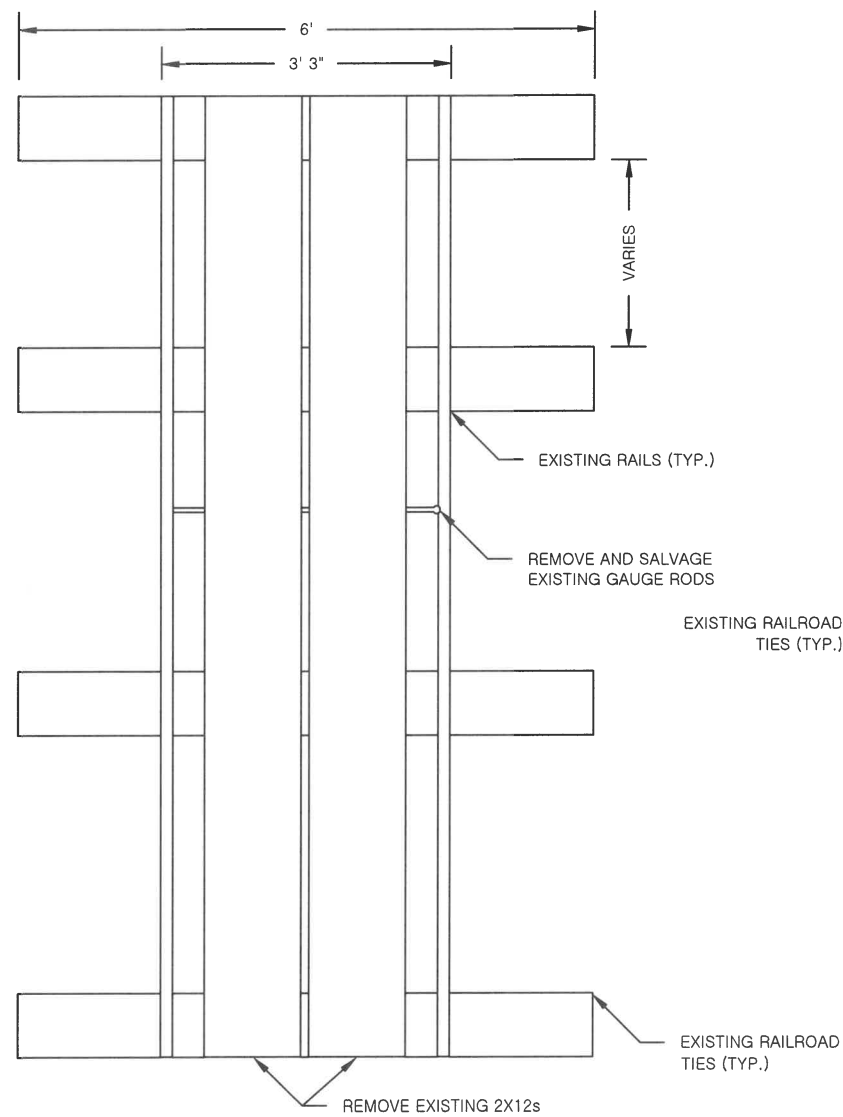

1 TRAM OVERVIEW
6 EXISTING CONDITIONS AND REMOVAL ITEMS

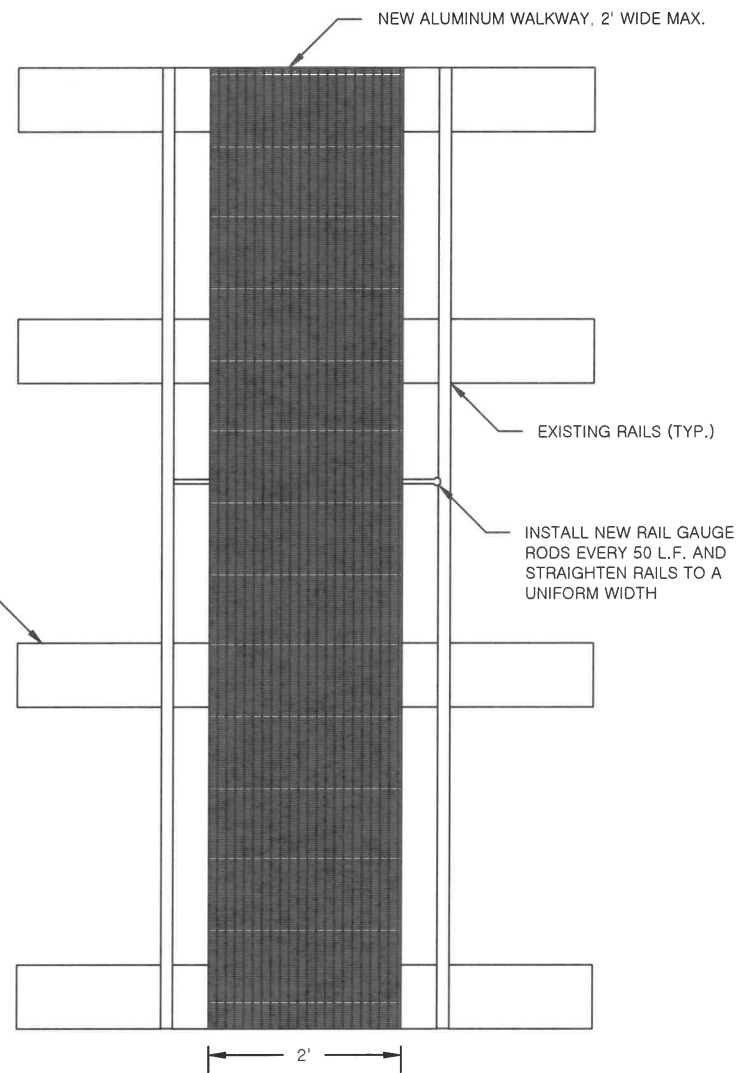

2 TRAM OVERVIEW
6 TRAM MODIFICATIONS

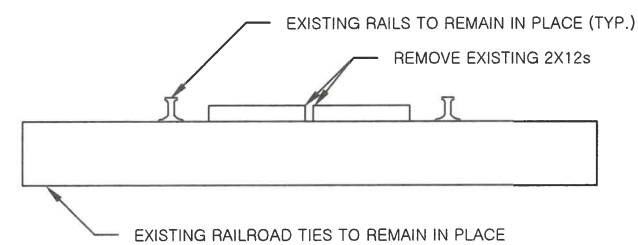

3 TRAM TYPICAL SECTION
6 EXISTING CONDITIONS AND REMOVAL ITEM

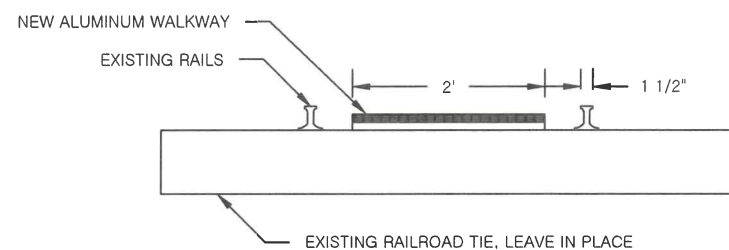

4 TRAM TYPICAL SECTION
6 TRAM MODIFICATIONS

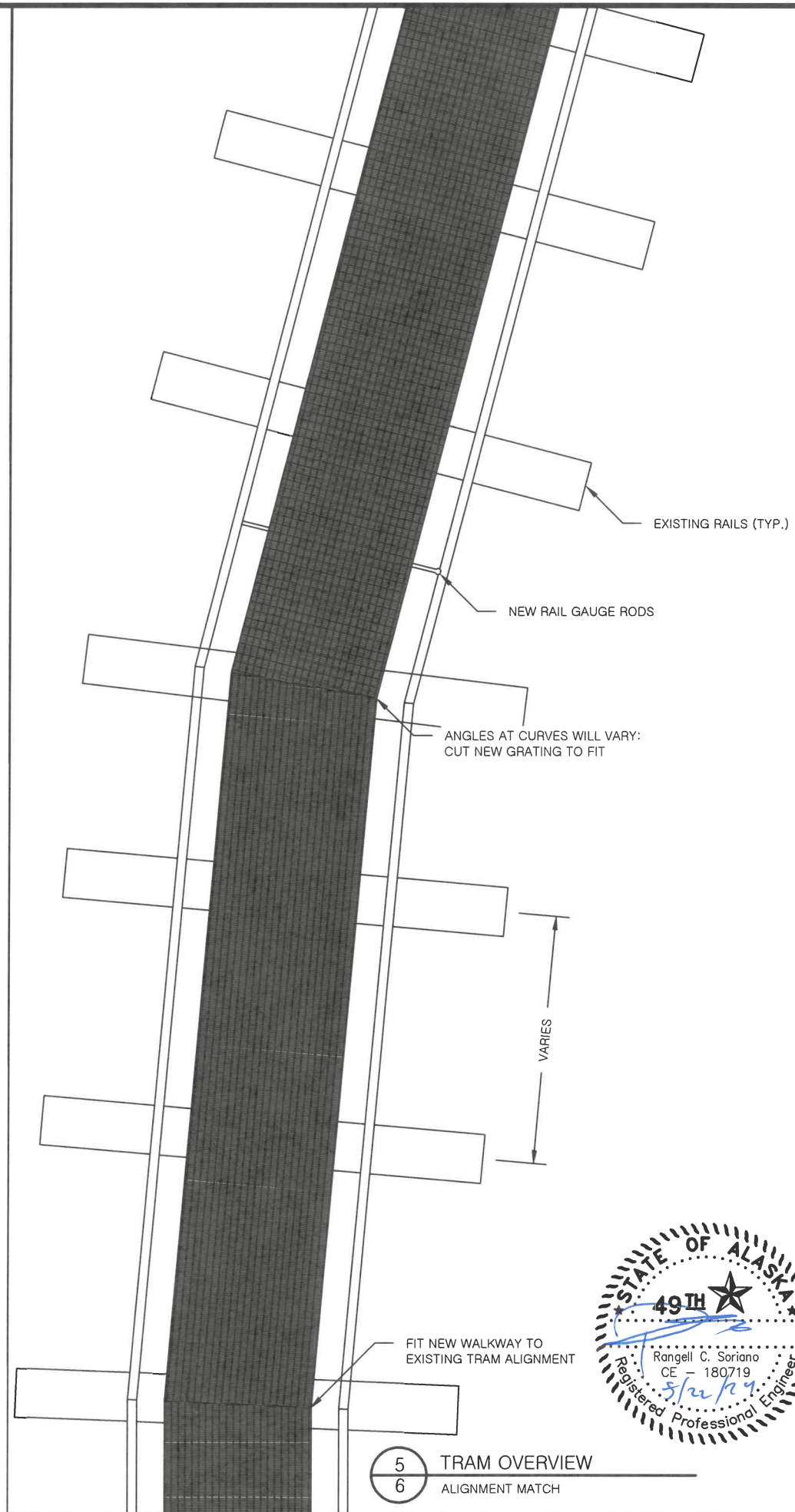

5 TRAM OVERVIEW
6 ALIGNMENT MATCH



STATE OF ALASKA, DEPARTMENT OF NATURAL RESOURCES
PLANS DEVELOPED BY: DIVISION OF PARKS AND OUTDOOR RECREATION
550 W 7TH AVE. SUITE 1340, ANCHORAGE, AK 99501 - 907.269.8731

OLIVER INLET SMP
TRAM IMPROVEMENTS
PROJECT No. 79199-2

TRAM REPAIR PLAN



PREPARED: CDC
DRAWN: CNS
REVIEWED: RCS
DATE: APRIL 2024

SHEET
6
OF 9 SHEETS

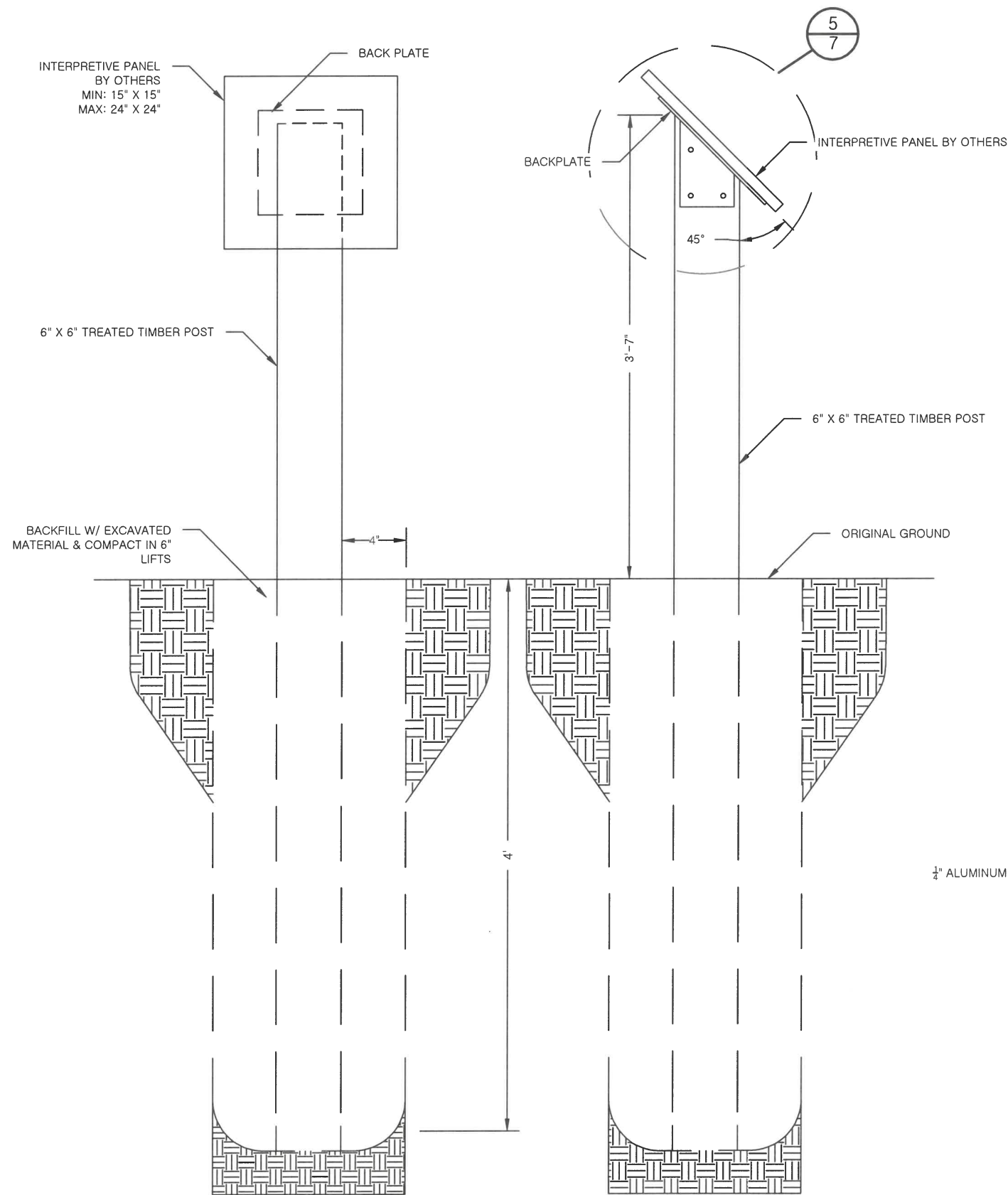

1 INTERPRETIVE SIGN, TYPE E
FRONT VIEW-NTS

2 INTERPRETIVE SIGN, TYPE E
SIDE VIEW-NTS

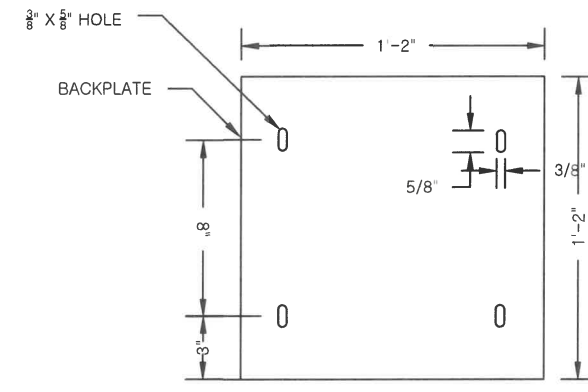

3 INTERPRETIVE SIGN, TYPE E
BACKPLATE FRONT VIEW-NTS

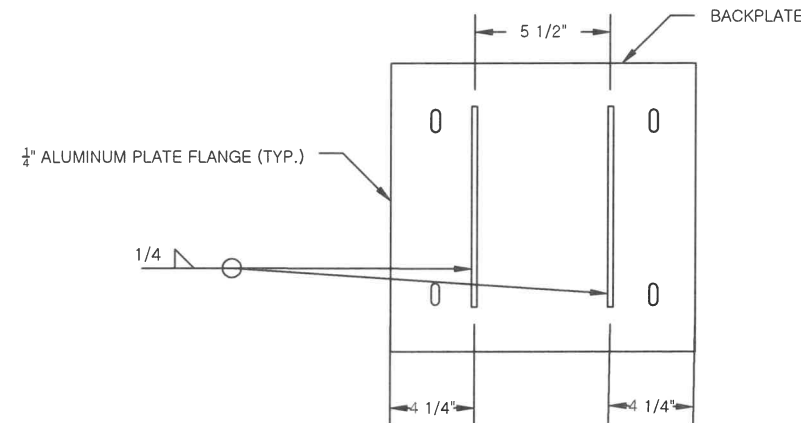

4 INTERPRETIVE SIGN, TYPE E
BACKPLATE BACK VIEW-NTS

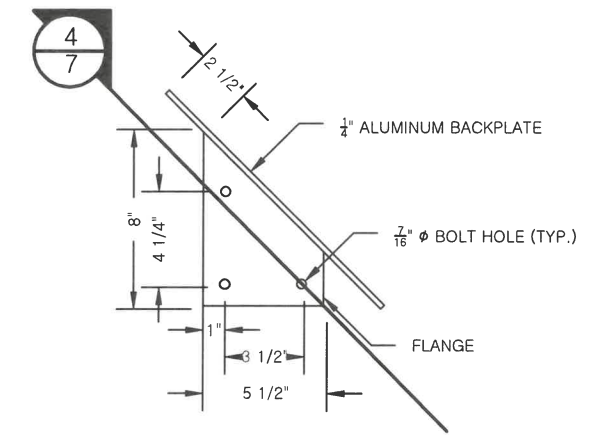

5 INTERPRETIVE SIGN, TYPE E
BACKPLATE DETAIL-NTS



STATE OF ALASKA, DEPARTMENT OF NATURAL RESOURCES
PLANS DEVELOPED BY: DIVISION OF PARKS AND OUTDOOR RECREATION
550 W 7TH AVE. SUITE 1340, ANCHORAGE, AK 99501 - 907.269.8731

OLIVER INLET SMP
TRAM IMPROVEMENTS
PROJECT No. 79199-2

INTERPRETIVE KIOSK, TYPE E DETAILS



PREPARED: CDC
DRAWN: CNS
REVIEWED: RCS
DATE: APRIL 2024

SHEET

7

OF 9 SHEETS

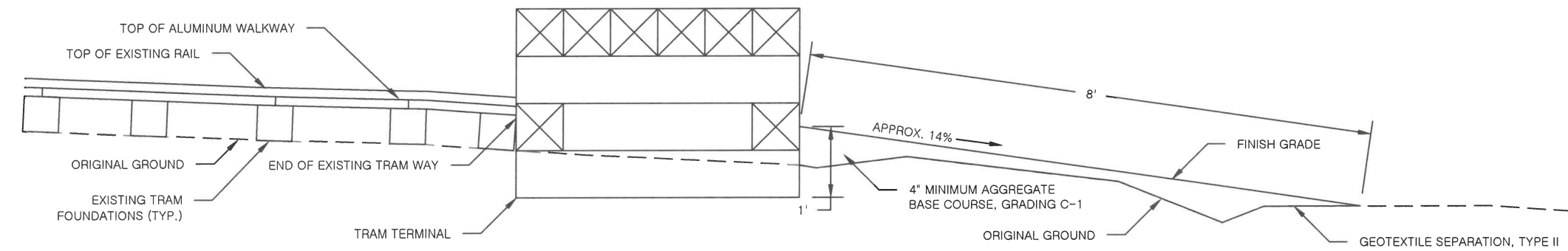
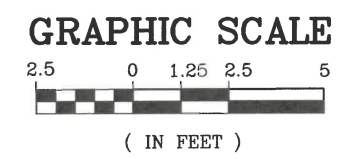
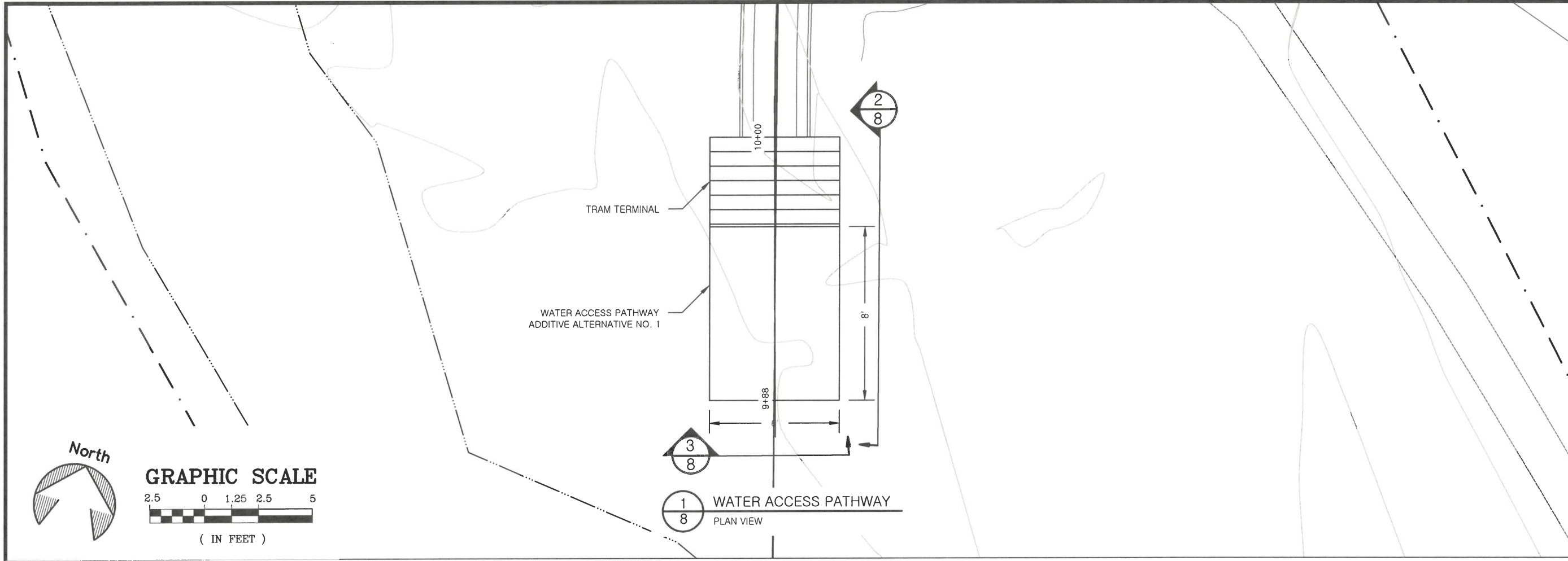

2/8 PROFILE VIEW
WATER ACCESS PATHWAY

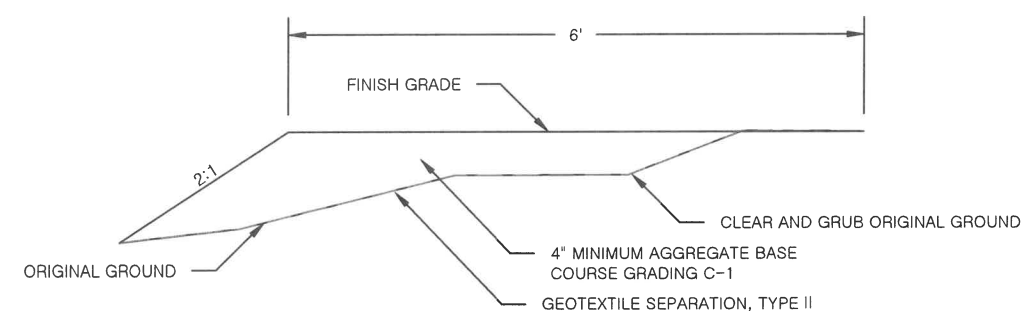

3/8 TYPICAL SECTION
WATER ACCESS PATHWAY



STATE OF ALASKA, DEPARTMENT OF NATURAL RESOURCES
PLANS DEVELOPED BY: DIVISION OF PARKS AND OUTDOOR RECREATION
 550 W 7TH AVE. SUITE 1340, ANCHORAGE, AK 99501 - 907.269.8731

OLIVER INLET SMP
 TRAM IMPROVEMENTS
 PROJECT No. 79199-2

ADDITIVE ALTERNATIVE No. 1
 WATER ACCESS PATHWAY



PREPARED: CNS
 DRAWN: CNS
 REVIEWED: D&C
 DATE: APRIL 2024

SHEET

8

OF 9 SHEETS

NOTE:
 DEBRIS PILE REMOVAL UNDER ADDITIVE ALTERNATIVE NO.2
 IS ONLY PART OF THE CONTRACT IF ADDITIVE ALTERNATIVE
 NO. 2 IS AWARDED

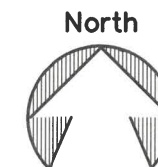
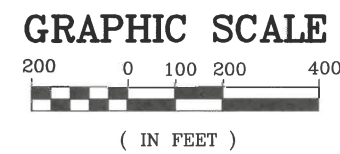
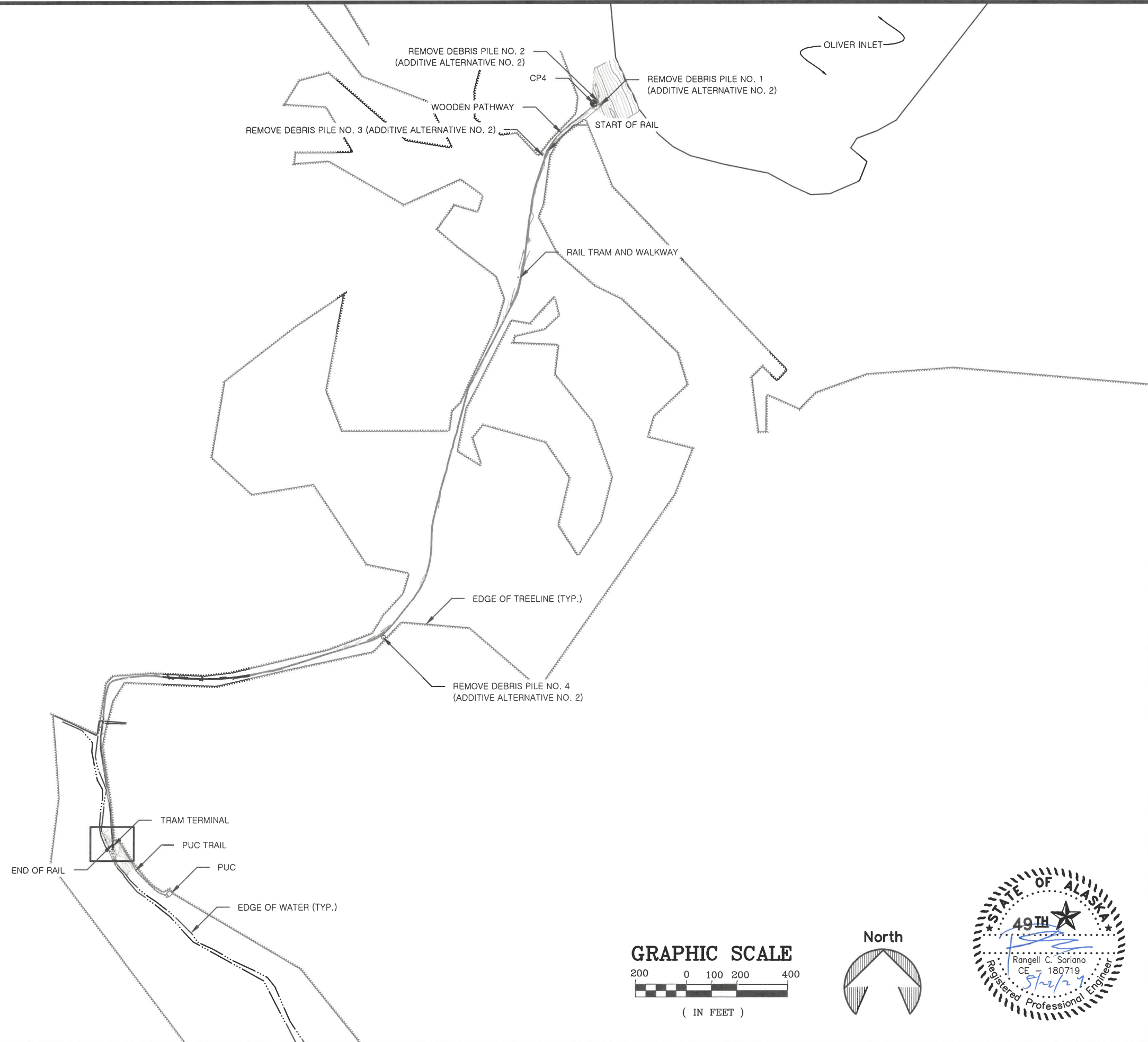

STATE OF ALASKA, DEPARTMENT OF NATURAL RESOURCES
PLANS DEVELOPED BY: DIVISION OF PARKS AND OUTDOOR RECREATION
 550 W 7TH AVE. SUITE 1340, ANCHORAGE, AK 99501 - 907.269.8731

ADDITIVE ALTERNATIVE NO. 2
 REMOVAL OF DEBRIS

OLIVER INLET SMP
 TRAM IMPROVEMENTS
 PROJECT No. 79199-2



PREPARED: CDC
 DRAWN: CNS
 REVIEWED: RCS
 DATE: APRIL 2024

SHEET
9
 OF 9 SHEETS