



Issue Date: November 7, 2023

ATTN: Vendors

RE: **Project Name:** LCCC Generator Replacement
 Project Number: 240002936
 Project Location: Lemon Creek Correctional Center (LCCC), Juneau, Alaska
 New ITB Deadline: **November 17, 2023 @ 2:00 p.m., Local Time**

Addendum # Three (3)

The Department of Corrections is issuing this Addendum to the Invitation to Bid (ITB) for the above project:

The following are questions from interested parties and the department's response:

Q: As much data on the existing generator needing to be remove?

A: *The existing generator is a Kohler, model: 230R084-8317A. See figures 1 and 2 below for reference.*

Q: Is the intent to use the existing ATS in its current location?

A: *Yes, that is correct.*

Q: Where is the remote Annunciator to be located, can this be identified on the site drawing?

A: *Remote Annunciation to be in the in room "GENERATOR" adjacent to the existing ATS. See figure 3 for location.*

Q: Please confirm fuel lines lengths are adequate, most manufacture are concerned with no pump or day tank closer to the unit.

A: *Our fuel piping calc aims to keep the suction in the line less than 10 in. Hg., and with a total distance (assumed 150ft), at 0.27 GPM (per generator manufacturer data), and a ½" pipe, we came to a total pressure loss of 3.41 psi ~ 7.0 in. Hg.*

Q: Please confirm fuel type. Manufactures are requiring ultra low surfer fuel. Not sure what the existing generators and boilers are using.

A: *From as-builts and our site visit, it is our understanding that the existing generators and boilers are utilizing fuel oil, and are served via a 10,000-gallon storage tank, south of the main facility boiler room.*

Q: Please provide design criteria for generator housekeeping pad.

A: *Generator housekeeping pad will need to be designed by a structural engineer. See attached added specification section 26 05 48 – VIBRATION AND SEISMIC CONTROLS FOR ELECTRICAL SYSTEMS. Add the following to section 26 32 00(1.2) "Section 26 05 48 – Vibration and Seismic Controls for Electrical Systems." Add the following the end of section 26 32 00(1.5)(D) "and for generator housekeeping pad." Add the following to the end of section 26 32 00(2.4)(J) "Contractor to provide structural design for housekeeping pad as required to support generator and enclosure in accordance with this Section and Section 26 050 48."*

Q: Please provide elevator weight limits.

A: 2500#, No one item may be more than 500#.

Q: Is a generator mounted E stop acceptable in lieu of a building mounted disconnect as long as it shunts the generator main breaker?

A: Yes, this is acceptable.

Q: The new generator is shown relocated to the exterior. There is no housekeeping pad noted on the drawing. Is there a new Pad intended for the new generator? Please provide details.

A: For contractor convenience we have provided a typical detail. Housekeeping pad and equipment anchoring design shall be provided by the contractor in accordance with specifications 26 05 48. See figure 4.

Q: Assuming there is a new pad, it is assumed there will be Ufer grounds and a grounding detail associated with the generator and pad. Please provide.

A: Provide Ufer in accordance with NEC 250.52(A)(3). Connection to Ufer from grounding bar on generator to #4 AWG Copper.

Q: The discussion on site indicated the existing generator exhaust between the basement and 2nd floor roof is encased in a concrete chase. Would it be acceptable to abandon it in place in lieu of demolishing it and patching wall and floor finishes.

A: Yes. boiler stack at roof to be removed and patched.

Q: What size fuel tank do you want? A fuel tank is mentioned but there isn't any size noted. I can quote a 24-hour tanks with price adders for a 48hr and 72hr, if you 'd like.

A: No fuel tank to be installed. Generator will feed off of existing fuel storage.

This addendum is considered part of the Invitation to Bid (ITB) and is to be acknowledged on your quote form.

Please contact me if you have any questions at michael.lim@alaska.gov or 907-465-6014.

Sincerely,

Michael Lim

Michael Lim
Procurement Specialist V

cc: William Merchant, Facilities Manager I, DOC
Shawn Ratliff, Facilities Manager I, DOC
Clif Reagle, Facilities Manager II, DOC
Jacob Scanlon, LCCC Maintenance Supervisor

End of Addendum

Total number of pages contained within this Addendum: 5



Figure 1: Side view of existing Kohler generator.



Figure 2: Generator control panel and overview.

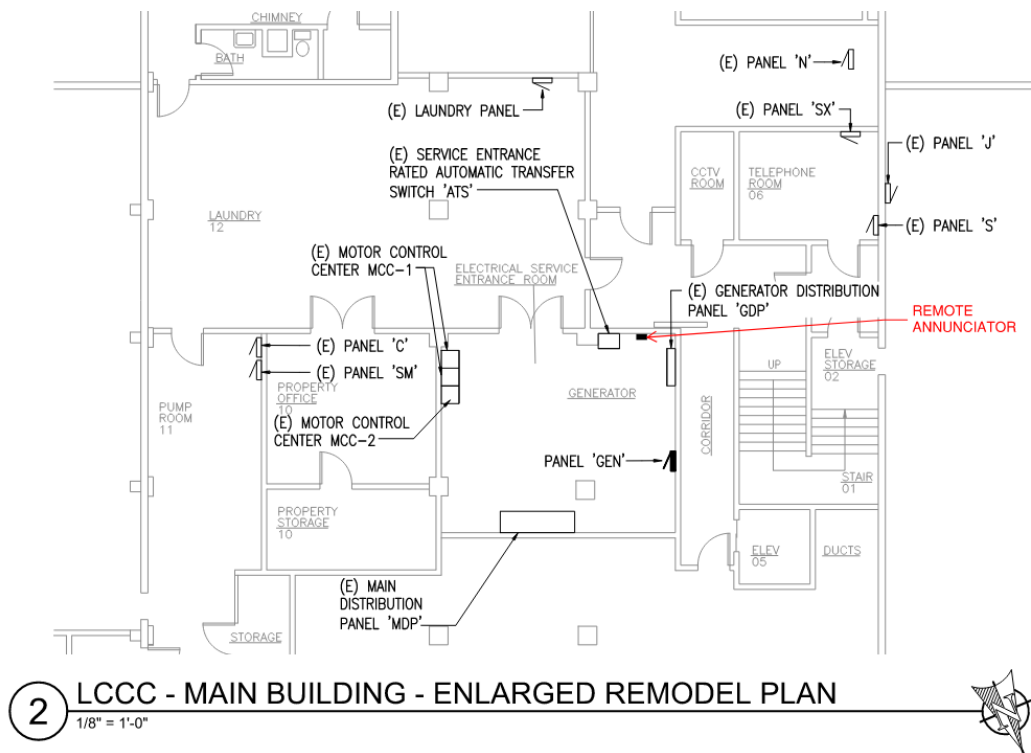

Figure 3: Location of new remote annunciator.

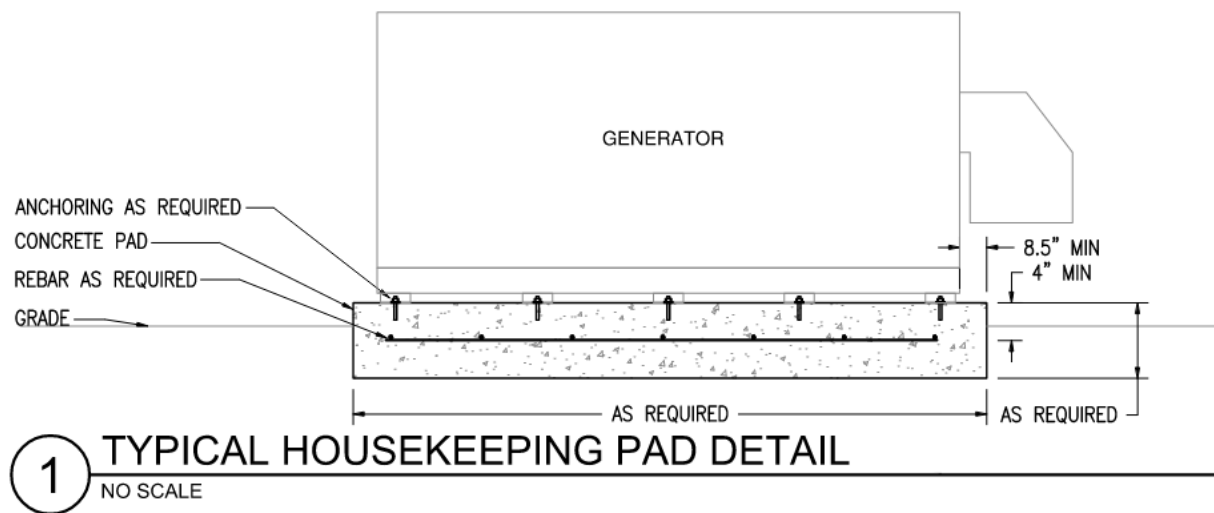

Figure 4: Typical housekeeping pad detail.