



Issue Date: August 17, 2023

ATTN: Vendors

RE:	Project Name:	Alaska Department of Corrections, Juneau Central Office (JCO) Expansion
	Project Number:	230006085
	Project Location:	Juneau, Alaska
	New ITB Deadline:	August 25, 2023 @ 2:00 p.m. Alaska Time

Addendum # Two (2)

The Department of Corrections is issuing this Addendum to the Invitation to Bid (ITB) for the above project.

The following changes are required:

1. Alaska Department of Corrections, Juneau Central Office (JCO) revise drawings (Floor plan, Electrical and Sprinkler) are available upon request. All interested contractors will need to contact Michael Lim at Michael.lim@alaska.gov to request for the drawing.

The following are questions from interested parties and the department's response:

Q: The existing 1x4 light fixtures in the space appear to be almost, if not exactly, identical to those called out in the new lighting schedule. Please confirm the intent is to remove all existing lights shown per electrical demo drawing and replace with new.

DOC Response: Existing lights in this area are to be reused provide all modifications necessary for circuiting, switching and emergency egress are completed by contractor. New fixtures provided shall match color temperature and intensity of existing for overall experiential consistency.

Q: Drawing ED1.3 indicates an existing door at GL Q/10, with a card reader shown to be relocated. This door does not exist on site, nor the card reader. Further, drawing 1.3 appears to show a new door installed into the existing wall at approx. GL Q.5/10, and another at S/10.2. The new door at S/10.2 appears to call for the access controls shown as existing at Q/10, and presumably are to be salvaged and reinstalled. Since there is no door or access control at Q/10, is it correct to assume that new door access control hardware will be required for the new door at S/10.0?

DOC Response: Reference to the revise electrical and floorplan drawings.

Q: Drawings 1.3 and ED1.3 indicate access control as existing on upper stair door 234. This is not existing. However, lower stair door to exterior does have this control.

DOC Response: No access control on upper stair door required.

Q: While on site, it was verbally indicated that a change to design would be forthcoming regarding the door between 241 and 245. As this is not shown in current bid documents, please send along those design changes asap in case there are any downstream effects that require further questions.

DOC Response: Reference to the revise floorplan drawings.

Q: Does DOC want tempered glazing, laminated glazing or tempered and laminated glazing in borrowed lights?

DOC Response: Glazing is detailed in section 088000.

Q: 092216 -Will expansion joints be required at all openings? Or, any other locations?

DOC Response: This is detailed in ASTM C 840, which is reference in the specification 3.3, A, 1. As these walls do not extend to ceiling structure and do not cross building or seismic joints. This typically should not need control joints in condition where the wall is less than 30' long. As this installation is in a heated interior environment, the contractor is allowed to use gypsum board panels to acclimate in the space prior to installation. This will alleviate concerns related to the movement due to moisture and temperature.

Q: 092900 – The specification call out a Level 5 finish. Will the Level 5 finish require special framing and gypsum board hanging techniques to accompany the finish level?

DOC Response: The expectation is that the level of finish match that in the adjacent finished office space in the Douglas Island Building, completed utilizing the same specification language.

Q: Will the General Contractor be provided an exterior staging area?

DOC Response: DOC can reserve up to 3 parking spaces to the awarded contractor.

Q: A2.0; Detail 3: Could criteria for seismic bracing be provided?

DOC Response: Clip wall to the underside structure with cold-formed diagonal strut every 6 feet. Seismic bracing to match existing walls.

Q: A9.0; General Note 2: Could General Contractor participate in furniture move in and set up be further defined.

DOC Response: Not required.

Q: A1.0; Sheet Note C7: Will the owner be providing carpet tiles from inventory on hand?

DOC Response: Contractor will provide matching existing carpet tiles.

Q: A1.0: Existing office 254 does not appear on the demolition plan.

DOC Response: *Remove existing interior walls (approximately 16 lineal feet), door and frame located between grids 9 and 10, V and W, and all associated electrical devices that are not indicated on the demolition plans. Repair ceiling grid and replace partial ceiling tile as required. To complete new work. See sketch below.*

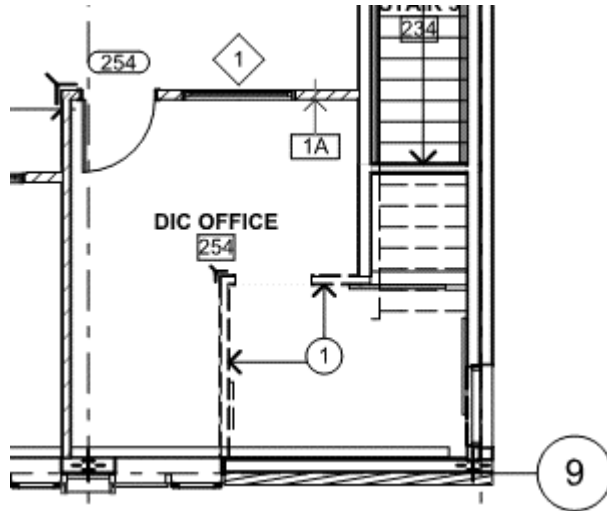

Please contact me if you have any questions at Michael.lim@alaska.gov or 907-465-6014.

Sincerely,

Michael Lim

Michael Lim
Procurement Specialist V

cc: William Merchant, Facilities Manager I, DOC
Clif Reagle, Facilities Manager II, DOC
Erin Messing, Procurement Specialist III

End of Addendum