

CONSTRUCTION PLANS FOR ADAK AIRPORT

FFYXX ADAK AIRPORT RUNWAY, TAXIWAY, AND APRON PAVEMENT REHABILITATION PROJECT No SFAPT00194/ A.I.P. No. X-XX-XXXX-XXX-20XX

Date Plotted: Jun 23, 2020 - 7:41am
 Plot Ratio and Layout: D:\ADK\SFAPT00194\Planes\SFAPT00194_A1_TITL_SHEET.dwg
 File:
 Designed By: TDF
 Checked By: CMT
 Drawn By: TDF

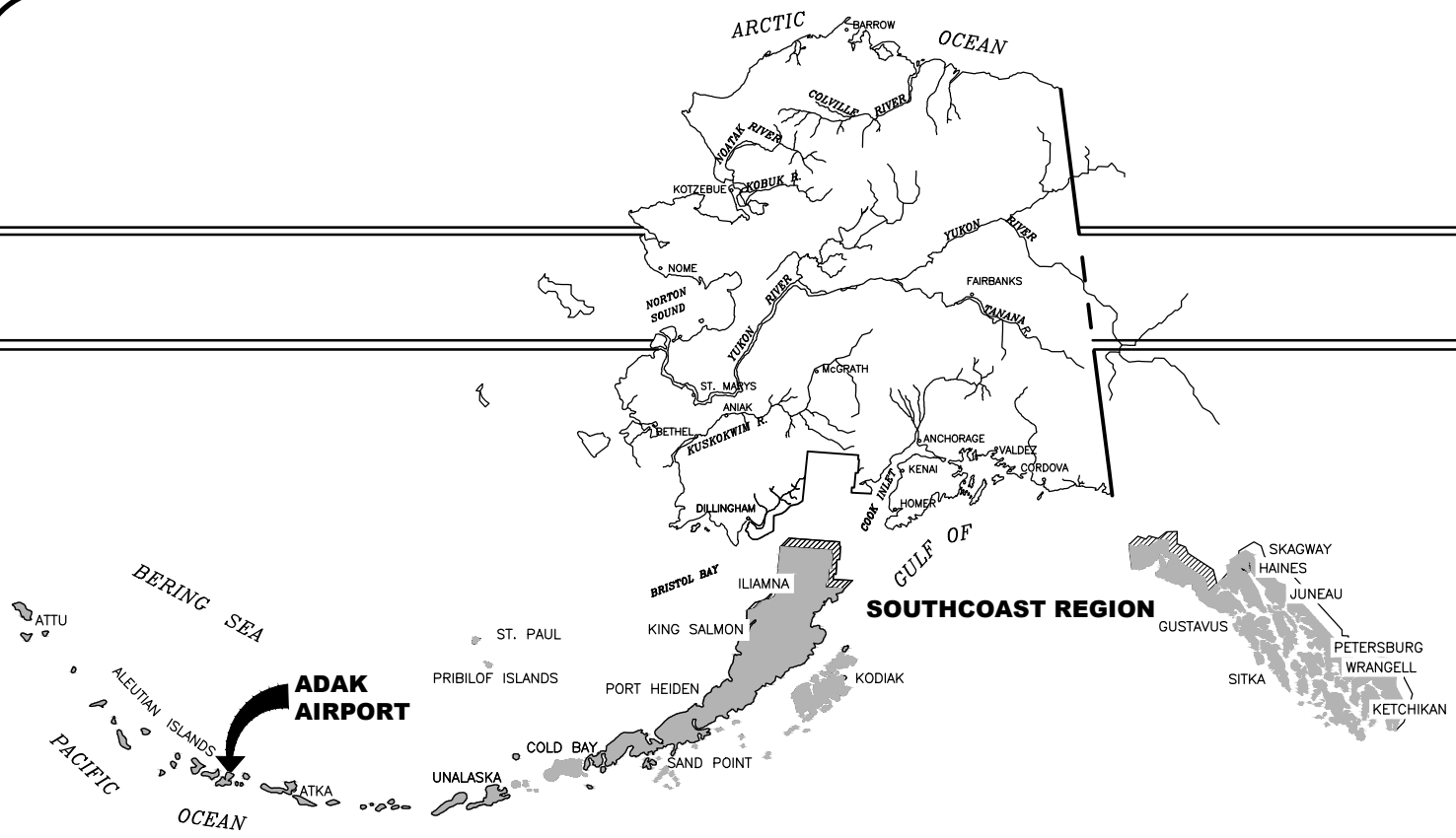

ALASKA SOUTHCOAST REGION LOCATION MAP
NOT TO SCALE

DESIGN DESIGNATIONS	
AIRPORT REFERENCE CODE	C-III (RUNWAY 5/23)
AIRPORT TYPE	OTHER THAN UTILITY
RUNWAY CATEGORY	LOCAL
AIRPORT REFERENCE POINT (ARP Coordinates - NAD '83)	Latitude N 51° 52' 40.89" Longitude W 176° 38' 45.31"
RUNWAY DIMENSION	7790X200 (RUNWAY 5/23)
RUNWAY ELEVATION	19.5/16.9 (NAVD88)
RSA DIMENSION	7790X400 (RUNWAY 5/23)
RUNWAY/TAXIWAY SURFACE	ASPHALT
RUNWAY LIGHTING	HIGH INTENSITY RUNWAY LIGHTING (HIRL)
TAXIWAY LIGHTING	MEDIUM INTENSITY TAXIWAY LIGHTING (MITL)
FAA APPROACH AIDS	REILS, PAPI, SALSF, ILS, NDB/DME
RUNWAY MARKING TYPE	VISUAL/PRECISION

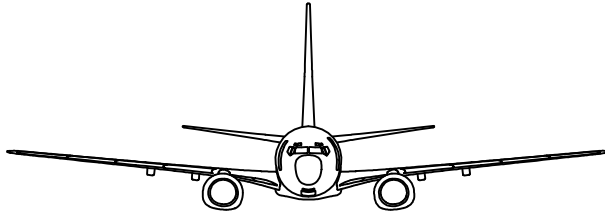
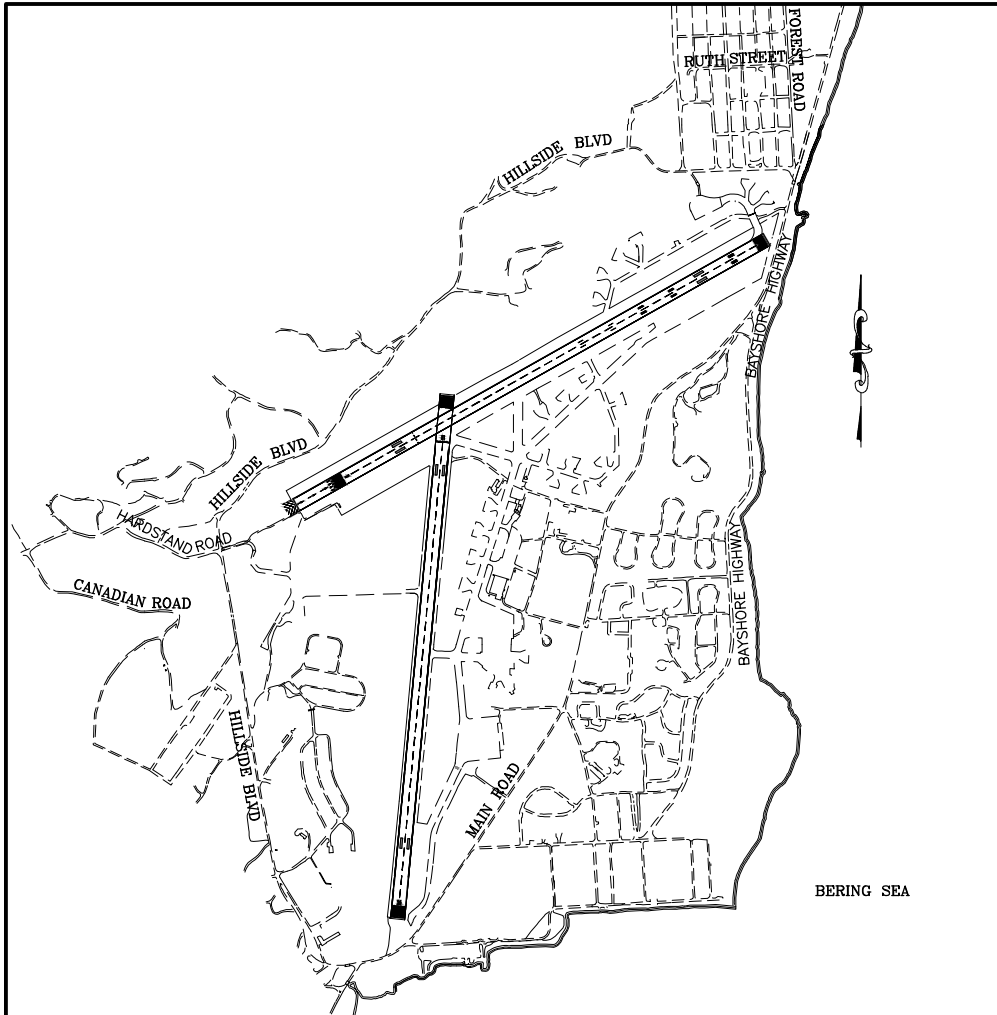

CONCUR _____ **DATE** _____
 D. LANCE MEARIG, P.E. REGIONAL DIRECTOR

APPROVED _____ **DATE** _____
 KIRK D. MILLER, P.E. REGIONAL PRECONSTRUCTION ENGINEER

**SPONSORED BY STATE OF ALASKA DEPARTMENT
OF TRANSPORTATION & PUBLIC FACILITIES
SOUTHCOAST REGION
6860 GLACIER HIGHWAY
JUNEAU, ALASKA 99801
907-465-1763**

800 0 400 800 1600 2000 2400 2800

U.S. SURVEY FEET

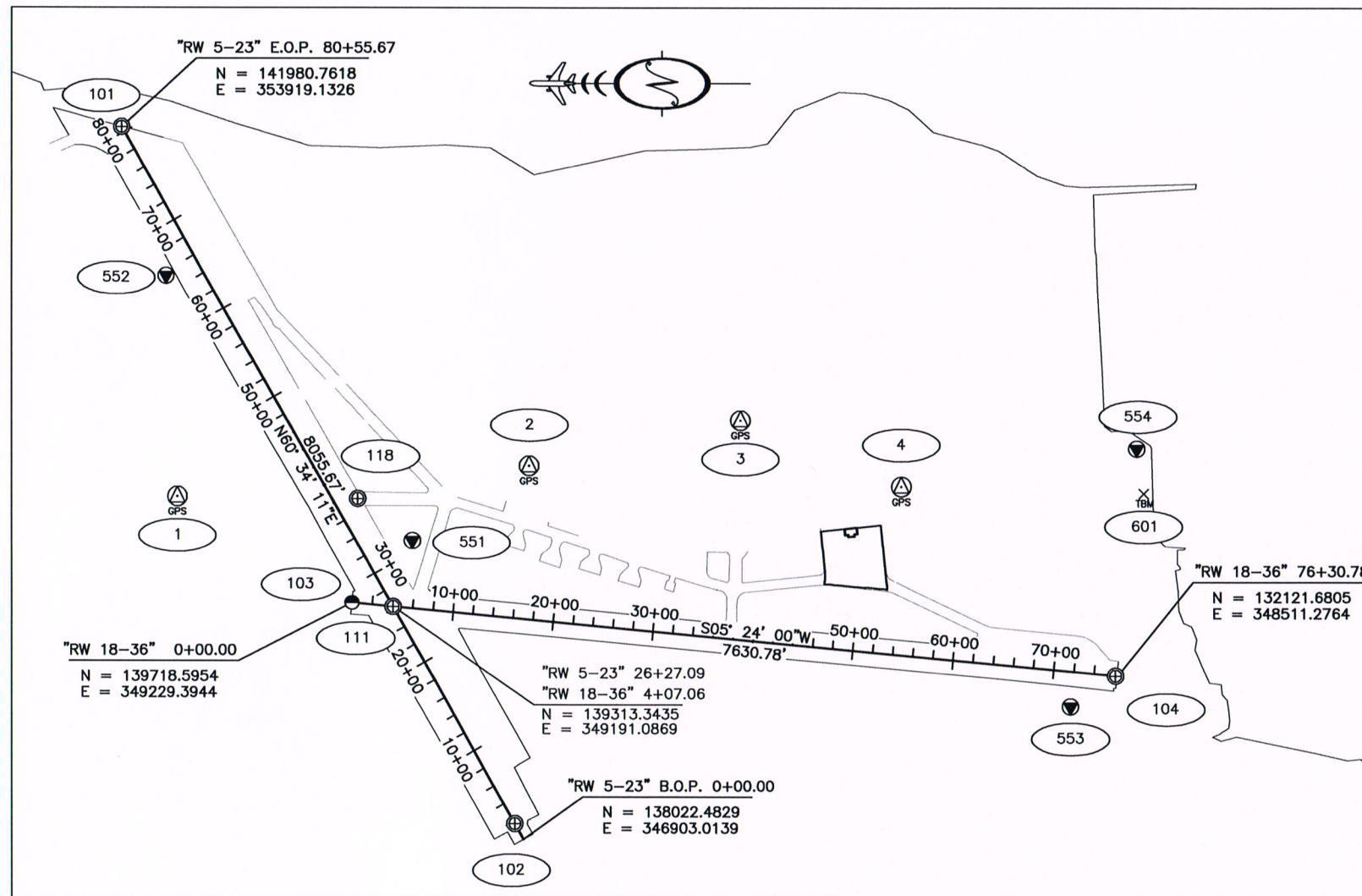

PRIMARY CONTROL POINTS						
Point	Station	Offset	Northing	Easting	Description	Elevation
553	-15+33.76	5377.11 Rt.	132585.6381	348209.3081	Fd BC/ROD[6714-S]: Station ADK C (SACS)	13.78
554	3+53.66	7197.24 Rt.	131927.7950	350747.5116	Fd BC[USCGS]: Station TIDAL BM NO. 18	18.90
551	31+00.57	484.97 Rt.	139123.6130	349841.7638	Fd BC/ROD[6714-S]: Station ADK A (PACS)	11.12
552	65+60.63	338.28 Lt.	141540.7739	352450.7964	Fd BC/ROD[6714-S]: Station ADK B (SACS)	8.86

HORIZONTAL CONTROL						
Point	Station	Offset	Northing	Easting	Description	
4	11+71.84	4989.12 Rt.	134252.9935	350375.1073	Fd BC: Station H.7 1944	
3	25+27.08	3912.16 Rt.	135856.8921	351026.2797	Fd BC: Station H..5 1944	
2	31+72.73	1856.01 Rt.	137964.9565	350578.2949	Fd BC[LS 8297]: Station BEDROCK 1	
1	46+12.01	1307.90 Lt.	141427.7868	350277.2049	Fd BC[9812-S]: Station BUNKER ALPHA	

VERTICAL CONTROL						
Point	Station	Offset	Northing	Easting	Elevation	Description
601	-0+63.32	7039.84 Rt.	131860	350307	16.00	Fd BC[NOS]: Station TIDAL BM 1380F 1983

FOUND MONUMENTATION						
Point	Station	Offset	Northing	Easting	Description	
104	-14+87.48	5913.41 Rt.	132141.2831	348513.1294	Fd BC/Bx: Runway 18/36 South H9 1944	
102	1+76.21	0.00 Rt.	138109.0664	347056.4847	Fd BC/Bx: Runway 5/23 West	
111	26+27.16	0.02 Lt.	139313.3968	349191.1356	Fd BC/Bx: NORTH RUNWAY 5/23-18/36	
103	28+59.58	334.13 Lt.	139718.5954	349229.3944	Fd AC[LS 8297]: Runway 18-36 North RP 1	
118	37+23.54	219.55 Rt.	139660.8798	350253.9244	Fd BC/Bx: Station K9	
101	80+55.67	0.00 Lt.	141980.7619	353919.1326	Fd BC/Bx: Runway 5/23 East	

NOTES

- The field survey was performed by R&M Consultants, Inc. (R&M) between November 19, 2012 and January 26, 2013.
- All dimensions and coordinates shown hereon are in U. S. Survey Feet unless otherwise noted.
- Horizontal control points were established using networked static GPS methods. The network was adjusted and transformed to the Alaska Adak Airport LDP coordinate system using a simultaneous least squares adjustment constrained to the record NGS NAD83 (2011) position for Survey Control Point No. 551, per the NGS Datasheet for PID DN6711.
- Background mapping is shown for orientation purposes only.
- Refer to Record of Survey 2013-4 Aleutian Islands Recording District for additional information.
- Station and offset information is based on the alignment of runway 5/23.

Legend

- GPS Control Point
- Primary CL Monument
- Secondary CL Monument
- Found Control Station
- Temporary Benchmark

HORIZONTAL CONTROL

This project is located entirely within the Alaska Adak Airport Low Distortion Projection (LDP), a local, low distortion grid coordinate system, expressed in U.S. Survey Feet, developed by R&M Consultants, Inc.

Alaska Adak Airport LDP Definition:

Linear Unit: U.S. Survey Foot
 Ellipsoid Datum: NAD83 (2011)
 System: Alaska Adak Airport LDP
 Zone: AK83-Adak
 Projection: Transverse Mercator
 Latitude of Grid Origin: 51°30'00"N.
 Longitude of Central Meridian: 176°38'40"W.
 Northing at Grid Origin: 0.0000 feet
 Easting at Central Meridian: 350,000.0000 feet
 Scale Factor on Central Meridian: 1.000003 (exact)

VERTICAL CONTROL

The Vertical Datum is NAVD88 (GEOID09). The Basis of Vertical Control is NGS Primary Airport Control Station (PACS) "ADK-A", Elevation = 11.12 feet, per the NGS Data Sheet for PID DN6711. NGS PACS "ADK-A" is a 2 1/2" Brass Cap crimped onto a stainless steel rod that projects above the surface of the cap forming a datum point. The stainless steel rod is surrounded by a 3' section of greased slip-sleeve and encased in a sand filled 6" PVC pipe with an aluminum lid marked ADK-A, 2011, 6714-S. Project elevations were determined by differential level loops, performed by R&M Consultants, Inc., using a Leica DNA-10 Digital Level, between NGS PACS "ADK-A" and all project control points.

All reported elevations need to be field verified from vertical benchmarks or temporary benchmarks before they are used.

Whether listed or not, ALL monuments or property markers, corners, or accessories, which will be disturbed or buried, shall be referenced and re-established in their original position (A.S. 19.10.260) and recorded (A.S. 34.65.040).

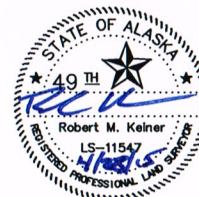

BY	DATE	REVISION

STATE OF ALASKA
DEPARTMENT OF TRANSPORTATION
AND PUBLIC FACILITIES
CENTRAL REGION

ADAK AIRPORT
ADAK, ALASKA
 RUNWAY SAFETY IMPROVEMENTS
 PROJECT NO. 54972
 SURVEY CONTROL SHEET

DATE: 4/21/2015
 SHEET: AB1 of AB2
 AS-BUILT SHEET:

FILE: Q:\ADK\SFAPT00194\Plans\set\SFAPT00194_A4_S\MBOLS.dwg
 DATE: 5/18/2020 14:17 LAYOUT: A4
 DESIGNED: T. FAGNANT
 CHECKED: C. TRIPP
 DRAFTED: T. FAGNANT

NO.	DATE	REVISION	STATE	PROJECT DESIGNATION	YEAR	SHEET NO.	TOTAL SHEETS
			ALASKA	SFAPT00194/	2020	A4	11

	RECOVERED	SET
BLM MONUMENT		
GLO MONUMENT		
USC&GS MONUMENT		
PRIMARY MONUMENT		
CENTERLINE MONUMENT IN CASING		
PRIMARY R.O.W. MONUMENT		
BEARING OBJECT		
MISCELLANEOUS MONUMENT		
LINE OF SIGHT MONUMENT		
CONCRETE R.O.W. MONUMENT		
BENCHMARK		
REBAR AND CAP		
REBAR		
IRON PIPE		
PK NAIL		
SPIKE		
HUB AND TACK		
CONSTRUCTION CENTERLINE		
MICELLANEOUS CENTERLINE		
STATION EQUATION	$\begin{matrix} "L"48+97.23 \text{ POT BK=} \\ "O"48+97.23 \text{ PC AHD} \end{matrix}$	
PROJECT RIGHT-OF-WAY LINE		
EXISTING RIGHT-OF-WAY LINE		
EXISTING PROPERTY LINE		
CONTROLLED ACCESS LINE		
EXISTING EASEMENT LINE		
PROPOSED EASEMENT LINE		
PROPOSED CUT SLOPE LIMIT		
PROPOSED FILL SLOPE LIMIT		
SECTION LINE		
1/4 SECTION LINE		
1/16 SECTION LINE		
TOWNSHIP & RANGE LINE		
MEANDER LINE		

	EXISTING	PROPOSED
SANITARY SEWER (FLOW DIRECTION →)		
FUEL LINE		
GAS LINE		
WATER LINE		
METER, VALVE, FIRE HYDRANT		
EXISTING STORM DRAIN (FLOW DIRECTION →)		
PROPOSED STORM DRAIN		
FIBER OPTIC LINE		
DIRECT BURIAL TELEPHONE CABLE		
DIRECT BURIAL ELECTRIC CABLE		
ELECTRIC LINE (OVERHEAD)		
POWER POLE LINE		
JOINT USE POWER & TELEPHONE		
TELEPHONE POLE LINE		
POLE ANCHOR		
STUB POLE (POWER OR TELEPHONE)		
TELEPHONE DUCT		
TELEPHONE PEDESTAL		
BURIED CABLE MARKER		
PIPELINE MARKER OR VALVE		
CATCH BASIN OR DROP INLET		
MANHOLE		
SANITARY SEWER CLEAN OUT		
PIPE CULVERT		
AIRCRAFT TIE-DOWN		

	EXISTING	PROPOSED
ROADWAY/PAVEMENT EDGE FENCE		
CURB AND GUTTER		
DETECTABLE WARNINGS		
GUARDRAIL		
CULVERT PIPE SIGN		
MAILBOX		
RAILROAD TRACKS		
RAILROAD DEVICES		
TREE LINE		
WATER BOUNDARY		
ORDINARY HIGH WATER LINE		
FLOW CENTERLINE		
FLOW DIRECTION		
WETLANDS		
EXISTING BUILDINGS		
POST OR BOLLARD		
WELL OR MONITORING WELL		
SEPTIC PIPE		
FUEL TANK FILL PIPE/VENT		
SATELLITE DISH		
TEST HOLE		
CONIFER TREE		
DECIDUOUS TREE GRAVE		
THERMOSIPHON		
PARKING METER		
VEHICLE PLUG-IN		
DELINEATOR/GUIDE MARKER		

	EXISTING	PROPOSED
JUNCTION BOX, TYPE IA		
JUNCTION BOX, TYPE II		
JUNCTION BOX, TYPE III		
SIGNAL FACE, VEHICULAR		
SIGNAL FACE, BACKPLATE		
SIGNAL FACE, LEFT TURN, BACKPLATE		
SIGNAL FACE, PEDESTRIAN		
LOOP DETECTOR		
VIDEO DETECTOR		
RADAR DETECTOR		
OPTICOM DETECTOR		
PEDESTRIAN PUSH BUTTON		
SIGNAL POST W/O MAST ARM		
SIGNAL POLE W/MAST ARM		
SIGNAL CONTROLLER		
LOAD CENTER		
LUMINAIRE		
RIGID METAL CONDUIT		

H = HOUSE
 G = GARAGE
 M = MERCHANT/STORE
 B = BARN
 S = SHED
 P = PRIVY
 SS = SERVICE STATION
 W = WAREHOUSE

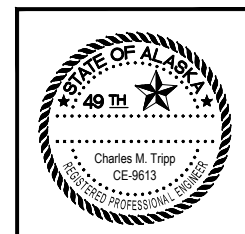

STATE OF ALASKA DEPARTMENT OF
 TRANSPORTATION
 AND PUBLIC FACILITIES
 6860 GLACIER HIGHWAY, JUNEAU, AK 99811
 (907) 465-1763
**GST AIRPORT APRON, RUNWAY,
 AND TAXIWAY PAVEMENT REHAB.**

LEGEND & SYMBOLS

FILE O:\ADK\SFAPT00194\Planset\SFAPT00194_A5_GENERAL_LAYOUT_PLAN.dwg DATE 6/25/2020 17:04 LAYOUT A5 CHECKED C. TRIPP DESIGNED T. FAGNANT DRAFTED T. FAGNANT

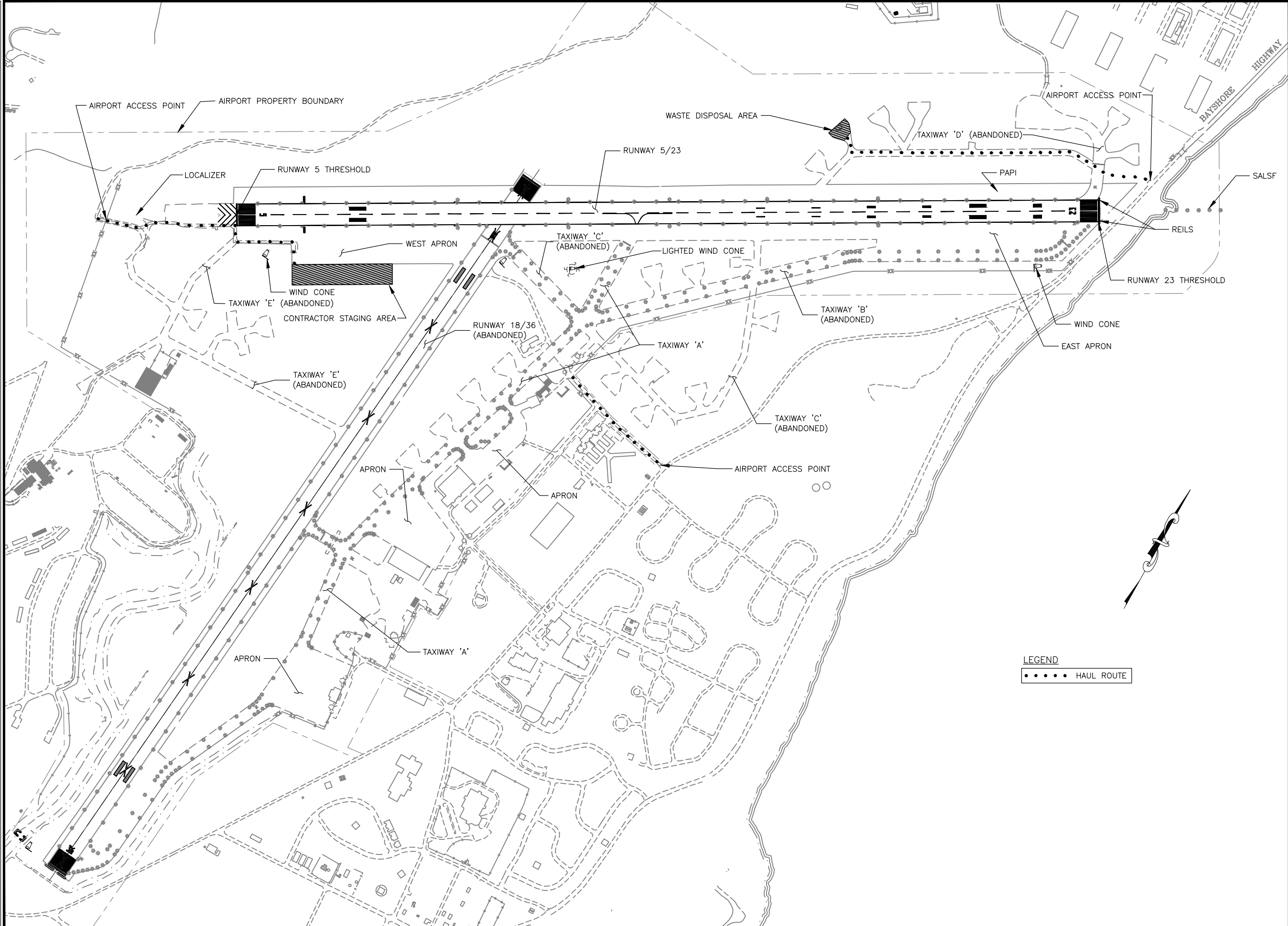

LEGEND
 HAUL ROUTE

SHEET NO.	TOTAL SHEETS
A5	11
STATE	YEAR
ALASKA	20XX
PROJECT DESIGNATION	
SFAPT00194	
X-XXX-XXX-20XX	
REVISION	
DATE	
NO.	



STATE OF ALASKA
 DEPARTMENT OF TRANSPORTATION
 AND PUBLIC FACILITIES
**ADAK AIRPORT RUNWAY,
 TAXIWAY, AND APRON
 PAVEMENT REHABILITATION**
 GENERAL LAYOUT
 PLAN

NO.	DATE	REVISION	STATE	PROJECT DESIGNATION	YEAR	SHEET NO.	TOTAL SHEETS
			ALASKA	SFAPT00194/	2020	A6	11

LEGEND

- RPZ — RUNWAY PROTECTION ZONE
- ROFA — RUNWAY OBJECT FREE AREA
- RSA — RUNWAY SAFETY AREA

FILE G:\ADK\SFAPT00194\Plmset\SFAPT00194_A6_SAFETY SURFACES PLAN.dwg
 DATE 5/20/2020 14:02 LAYOUT A6
 DESIGNED T. FAGNANT
 CHECKED C. TRIPP
 DRAFTED T. FAGNANT

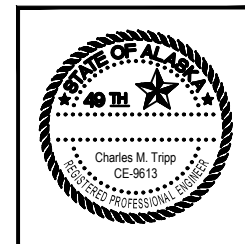
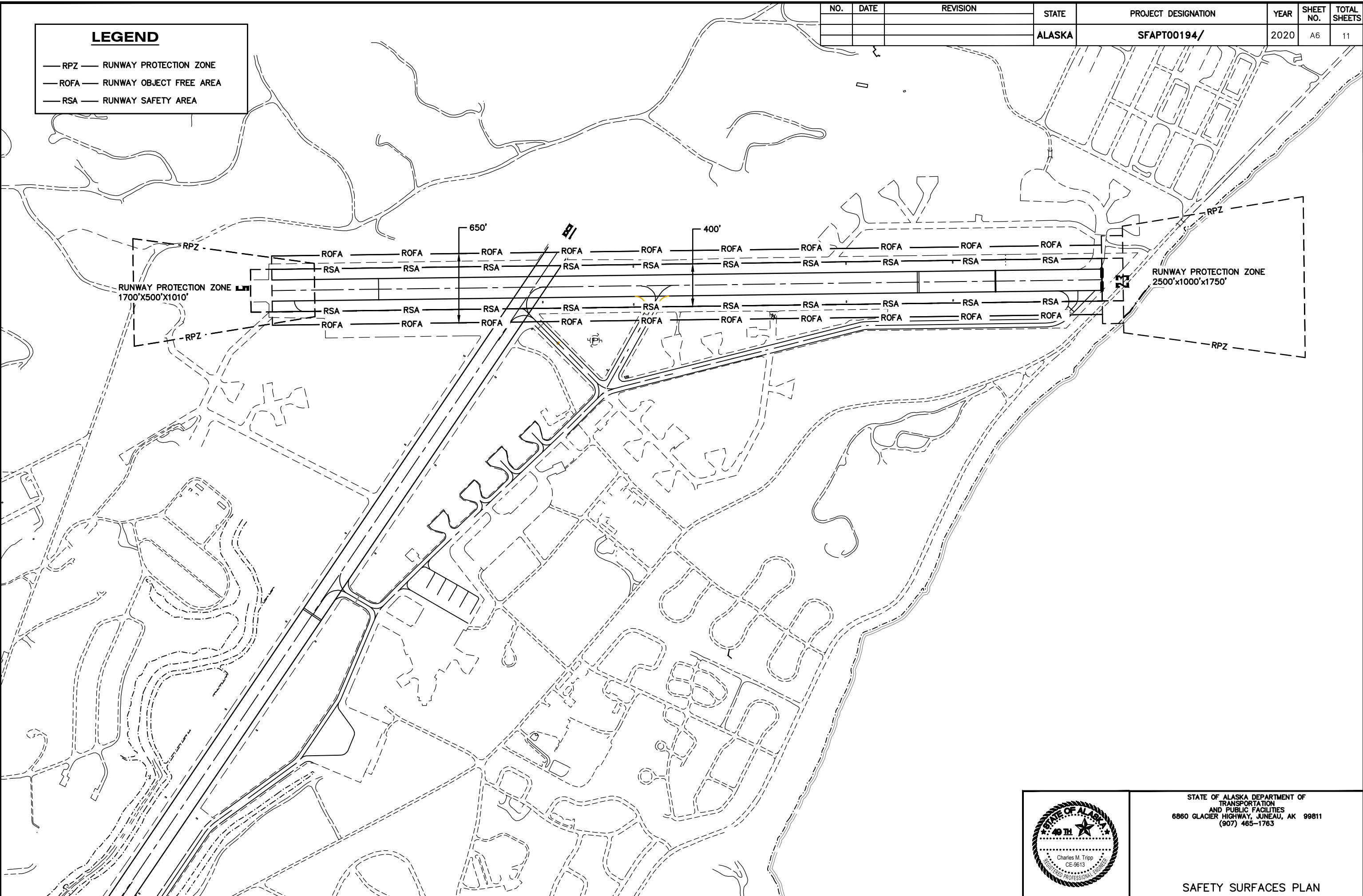

STATE OF ALASKA DEPARTMENT OF
 TRANSPORTATION
 AND PUBLIC FACILITIES
 6860 GLACIER HIGHWAY, JUNEAU, AK 99811
 (907) 465-1763

SAFETY SURFACES PLAN

FILE Q:\ADK\SFAP00194\Plans\SFAP00194_A7-A11_PHASING PLAN.dwg DATE 6/30/2020 16:39 LAYOUT A7 DESIGNED T. FAGNANT CHECKED C. TRIPP DRAFTED T. FAGNANT

SEQUENCING NOTES:

1. THE GENERAL SCOPE OF WORK FOR EACH STAGE IS DESCRIBED BELOW. PARTICULAR RESTRICTIONS ARE NOTED IN THE PLAN VIEW FOR EACH STAGE.
2. SHEETS A8 & A9 SHOW THE CONSTRUCTION SEQUENCE FOR WORK UNDER THIS CONTRACT. THE TASKS SHOWN IN EACH STAGE MAY REQUIRE DIFFERENT SEQUENCING, OR CONCURRENT PROGRESS WITH OTHER TASKS TO ACCOMPLISH THE WORK. THE APPROVED CONSTRUCTION SAFETY AND PHASING PLAN (CSPP) AND SPECIFICATIONS PROVIDE ADDITIONAL GUIDANCE ON OPERATIONAL LIMITATIONS. STAGE CONSTRUCTION TO COMPLY WITH ALL CONDITIONS OF THE CSPP, THE SAFETY COMPLIANCE DOCUMENT (SPCD), SUBSECTION 80-04 LIMITATION OF OPERATIONS, AND PROJECT PERMIT STIPULATIONS.
3. THE RSA OF RUNWAY 5/23 MUST BE CLEAR OF OBJECTS, VEHICLES AND EQUIPMENT WHILE AIRCRAFT ARE TAKING OFF OR LANDING.
4. WORK OUTSIDE THE EXISTING ACTIVE RUNWAY SAFETY AREA MAY BE PERFORMED AT CONTRACTOR'S DISCRETION SUBJECT TO THE LIMITS OF THE CSPP AND THE SPCD.
5. THE RSA OF RUNWAY 5/23 MUST BE CLEAR OF ALL VEHICLES AND OBSTRUCTIONS AND OPEN TO EMERGENCY MEDEVAC FLIGHTS WITHIN 15 MINUTES OF NOTIFICATION. RUNWAY 5/23 MUST BE AVAILABLE FOR MEDEVAC FLIGHTS AT ALL TIMES.
6. USE THESE STAGES AS A BASIS FOR PREPARING STORMWATER POLLUTION PREVENTION PLAN (SWPPP) MEASURES FOR EACH PHASE. THE PROJECT EROSION AND SEDIMENT CONTROL PLAN (ESCP) MEASURES APPLY TO ALL STAGES. PROVIDE SWPPP UPDATES AS EACH STAGE PROGRESSES.
7. ALL FAA FACILITIES SHALL REMAIN IN OPERATION THROUGHOUT THE PROJECT EXCEPT AS SPECIFIED IN THE APPROVED PHASING PLAN. DAMAGE TO FAA FACILITIES INCLUDING POWER DISRUPTION SHALL BE IMMEDIATELY REPAIRED IN A MANNER ACCEPTABLE TO THE FAA AT THE CONTRACTOR'S EXPENSE, AND SHALL BE REPORTED TO THE AIRPORT MANAGER.
8. ENSURE ALL RUNWAY LIGHTS ARE LOCKED OUT WHILE RUNWAY 5/23 IS CLOSED. THE WIND CONE LIGHTS AND ROTATING BEACON SHOULD ALSO BE LOCKED OUT.
9. TAXIWAYS MUST HAVE PROPER LIGHTING IF THEY ARE OPEN DURING THE NIGHT.
10. MAINTAIN A FIRM, UNIFORM, COMPACTED SURFACE ON RUNWAY 5/23 WHILE IT IS ACTIVE.
11. KEEP ALL PEOPLE, EQUIPMENT AND MATERIALS OUTSIDE ACTIVE MOVEMENT AREAS AND THE ACTIVE RUNWAY SAFETY AREA WHEN THE ACTIVE RUNWAY IS OPEN TO AIR OPERATIONS.
12. COVER OR DISABLE THE OPERATION OF RUNWAY EDGE LIGHTS, RUNWAY THRESHOLD LIGHTS, TAXIWAY EDGE LIGHTS, AND VASIs WHICH FUNCTION TO IDENTIFY A CLOSED PORTION OF A RUNWAY.
13. TEMPORARY LIGHTING IS REQUIRED TO MEET AC 150/5340-30, DESIGN AND INSTALLATION DETAILS FOR AIRPORT VISUAL AIDS, AND AC 150/5370-2, OPERATIONS SAFETY ON AIRPORTS DURING CONSTRUCTION.
14. REPAIR OR REPLACE TEMPORARY LIGHTING AND BARRICADES DAMAGE DURING CONSTRUCTION UPON DISCOVERY OR NOTIFICATION.
15. WHEN THE ACTIVE RUNWAY IS REDUCED TO 100' WIDTH, THE RUNWAY SAFETY AREA (RSA) REMAINS 400' WIDE IN THE EXISTING FOOTPRINT, THE CLOSED PORTIONS OF THE RUNWAY BECOME RSA.
16. HAVE AN APPROVED MIX DESIGN PRIOR TO COLD PLANING AND PAVING THE RUNWAY.
17. PROVIDE SUFFICIENT BALLAST OR ANCHORING OF TEMPORARY LIGHTING TO WITHSTAND JET BLAST. SAND BAGS OR OTHER BALLAST MATERIALS MUST BE BLACK AND MUST BE LESS THAN 3" HEIGHT.
18. EDGE LIGHTING SHOWN ON THE ACTIVE PHASE MUST BE IN PLACE PRIOR TO RE-OPENING RUNWAY 5/23 HALF-WIDTH OR FULL WIDTH.
19. FOR SCHEDULED AND UNSCHEDULED FLIGHTS, EVACUATE ALL PERSONNEL AND EQUIPMENT OUTSIDE THE RUNWAY 5/23 RSA 15 MINUTES PRIOR AND 15 MINUTES AFTER ALL ARRIVALS AND DEPARTURES.
20. DETERMINE THE TIMES OF SCHEDULED FLIGHTS INTO ADAK AND ALLOW AIRCRAFT TO USE THE RUNWAY DURING SCHEDULED TIMES. THE CONTRACTOR SHALL MONITOR THE CTAF AND PERFORM VISUAL MONITORING FOR UNSCHEDULED FLIGHTS. THE CONTRACTOR SHALL CLEAR THE RUNWAY ACCORDING TO NOTE 19 FOR ALL ARRIVALS AND DEPARTURES.

SHEET NO.	TOTAL SHEETS
CONSTRUCTION	SAFETY & PHASING
STATE	YEAR
ALASKA	20XX
PROJECT DESIGNATION	
SFAPT00194	
3-02-XXXX-XXX-20XX	
REVISION	
DATE	
NO.	



STATE OF ALASKA
DEPARTMENT OF TRANSPORTATION
AND PUBLIC FACILITIES
ADAK AIRPORT RUNWAY,
TAXIWAY, AND APRON
PAVEMENT REHABILITATION
CONSTRUCTION SAFETY
& PHASING PLAN

FILE G:\ADK\SFAPT00194\Plan\A11_Phasings_Plan.dwg DATE 6/30/2020 16:39 LAYOUT A8 DESIGNED T. FAGNANT CHECKED C. TRIPP DRAFTED T. FAGNANT

SHEET NO.	TOTAL SHEETS
A8	11
STATE	YEAR
ALASKA	20XX
PROJECT DESIGNATION	
SFAPT00194	
3-02-0186-XXX-20XX	

LEGEND
 PHASE 1 WORK AREA: COLD PLANE 2" ASPHALT CONCRETE & PAVE 2" HOT MIX ASPHALT.

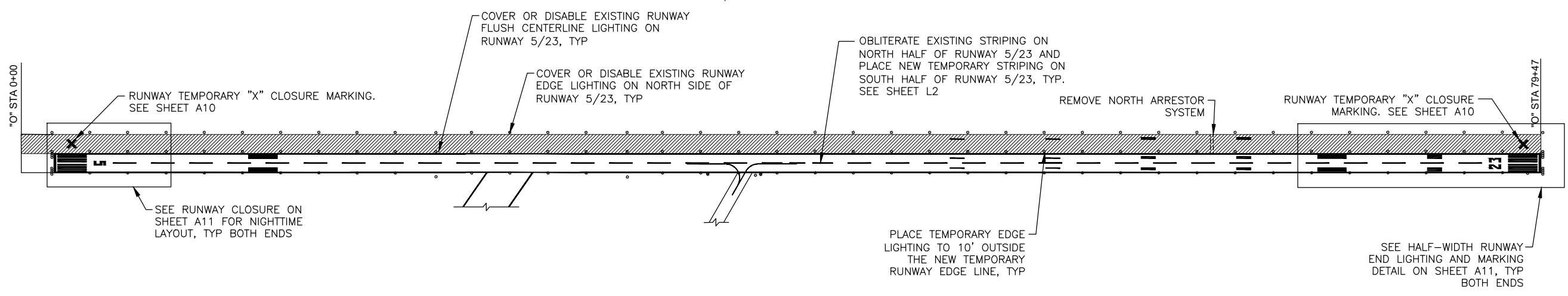

PHASE 1 - RUNWAY 5/23 NORTH HALF CLOSURE

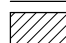
LEGEND
 PHASE 2 WORK AREA: COLD PLANE 2" ASPHALT CONCRETE & PAVE 2" HOT MIX ASPHALT.

- PHASES 1 & 2 NOTES**
1. RUNWAY 5/23 SHALL BE OPEN HALF-WIDTH DURING DAYTIME OPERATIONS, AND CLOSED FULL-WIDTH AT NIGHTTIME.
 2. PLACE TEMPORARY STRIPING, PLACE TEMPORARY EDGE LIGHTING, OBLITERATE PAVEMENT MARKINGS, AND COVER OR DISABLE EXISTING EDGE LIGHTING AS SHOWN IN THESE PHASES, PRIOR TO OPENING RUNWAY 5/23 HALF-WIDTH AND WHEN CHANGING TO A SOUTH HALF CLOSURE.

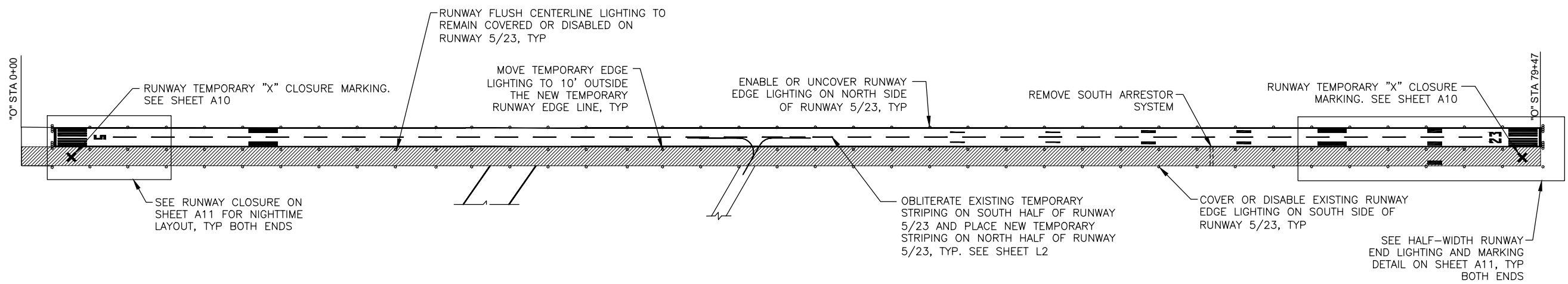



PHASE 2 - RUNWAY 5/23 SOUTH HALF CLOSURE

REVISION									
DATE									
NO.									

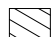

STATE OF ALASKA
 DEPARTMENT OF TRANSPORTATION
 AND PUBLIC FACILITIES
**ADAK AIRPORT RUNWAY,
 TAXIWAY, AND APRON
 PAVEMENT REHABILITATION**
 CONSTRUCTION SAFETY
 & PHASING PLAN

FILE: Q:\ADK\SFAP00194\Plans\A11_Phasings_Plan.dwg DATE: 6/30/2020 16:39 LAYOUT: A9 CHECKED: C. TRIPP DESIGNED: T. FAGNANT DRAFTED: T. FAGNANT



LEGEND
 PHASE 3 WORK AREA: COLD PLANE 3" ASPHALT CONCRETE & PAVE 3" HOT MIX ASPHALT (2" COLD PLANE & 2" PAVE AT TAXIWAY 'A' SHOULDERS)
 PHASE 4 WORK AREA: COLD PLANE 3" ASPHALT CONCRETE, PAVE 3" HOT MIX ASPHALT (2" COLD PLANE & 2" PAVE AT TAXIWAY 'A' SHOULDERS)

PHASES 3, 4, 5, & 6 NOTES:
 1. TAXIWAYS MUST HAVE PROPER LIGHTING IF THEY ARE OPEN DURING THE NIGHT.
 2. AT LEAST ONE OF TAXIWAY 'A' OR ALTERNATE TAXIWAY ACCESS VIA RUNWAY 18/36 SHALL REMAIN OPEN AT ALL TIMES. REMOVE TEMPORARY "X" CLOSURE MARKINGS AND HAZARD MARKER BARRICADES AT TAXIWAY ENTRANCES WHEN TAXIWAYS ARE OPEN.
 3. PLACE TWO TEMPORARY TAXIWAY EDGE MARKINGS SPACED 75' APART, AND PLACE TEMPORARY CONTINUOUS 6" TAXIWAY CENTERLINE MARKING ALONG RUNWAY 18/36 PRIOR TO BEGINNING WORK ON TAXIWAY 'A'. INCLUDE RUNWAY 18/36 TEMPORARY CONNECTIONS TO TAXIWAY 'A' AT "A" STA. 51+05 AND "A" STA. 66+63. SEE SHEET L4 FOR TAXIWAY EDGE MARKING AND TAXIWAY CENTERLINE MARKING DETAILS. REMOVE TEMPORARY TAXIWAY STRIPING ON RUNWAY 18/36 UPON COMPLETION OF PHASE 5.
 4. PHASING IS DESIGNED SO THAT THERE WILL BE ACCESS TO ALL APRONS THAT ARE CURRENTLY USED BY AIRCRAFT AT ADAK AIRPORT ALONG TAXIWAY 'A' DURING ALL CONSTRUCTION PHASES.
 5. REMOVE ALL EQUIPMENT FROM THE ACTIVE PHASE WORK AREA AND COMPLETE EACH PHASE IN ITS ENTIRETY PRIOR TO BEGINNING WORK ON A NEW PHASE DURING PHASES 1-5.
 6. PHASE 6 MAY BE SEQUENCED AT ANY TIME DURING THE PHASING AND MAY BE DONE IN AT THE SAME TIME AS OTHER PHASES.

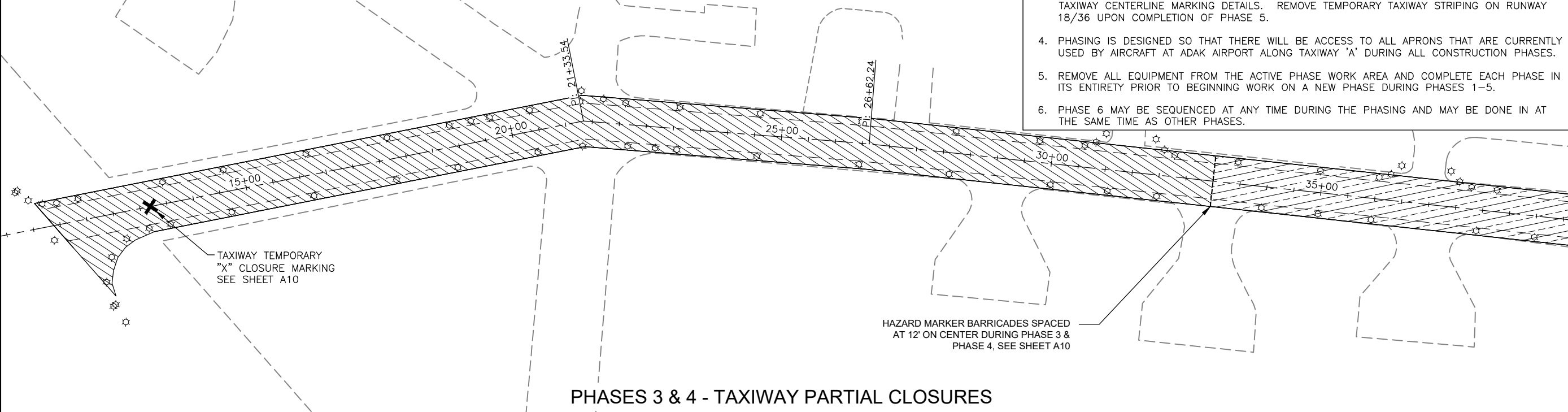
SHEET NO.	TOTAL SHEETS
A9	11
STATE	YEAR
ALASKA	20XX
PROJECT DESIGNATION	
SFAPT00194	
3-02-0186-XXX-20XX	
REVISION	
NO.	DATE

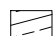

PHASES 3 & 4 - TAXIWAY PARTIAL CLOSURES

LEGEND
 PHASE 4 WORK AREA: COLD PLANE 3" ASPHALT CONCRETE, PAVE 3" HOT MIX ASPHALT (2" COLD PLANE & 2" PAVE AT TAXIWAY 'A' SHOULDERS)
 PHASE 5 WORK AREA: COLD PLANE 3" ASPHALT CONCRETE, PAVE 3" HOT MIX ASPHALT (2" COLD PLANE & 2" PAVE AT TAXIWAY 'A' SHOULDERS)
 PHASE 6 WORK AREA: REPLACE JOINT SEALANT ON APRON

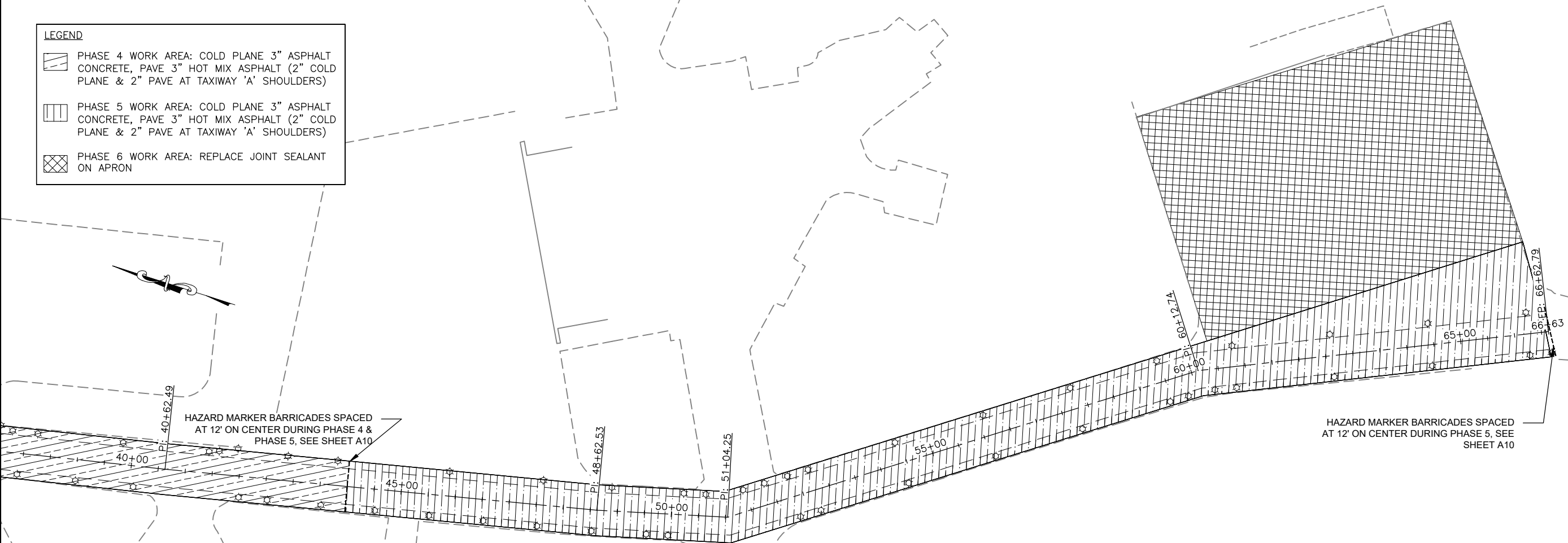

PHASES 4, 5, & 6 - TAXIWAY PARTIAL CLOSURES & APRON WORK



STATE OF ALASKA
 DEPARTMENT OF TRANSPORTATION
 AND PUBLIC FACILITIES
 ADAK AIRPORT RUNWAY,
 TAXIWAY, AND APRON
 PAVEMENT REHABILITATION
 CONSTRUCTION SAFETY
 & PHASING PLAN

FILE Q:\ADK\SFAPT00194\Plans\SFAPT00194_A7-A11_PHASING PLAN.dwg DATE 6/30/2020 16:39 LAYOUT A10 DESIGNED T. FAGNANT CHECKED C. TRIPP DRAFTED T. FAGNANT

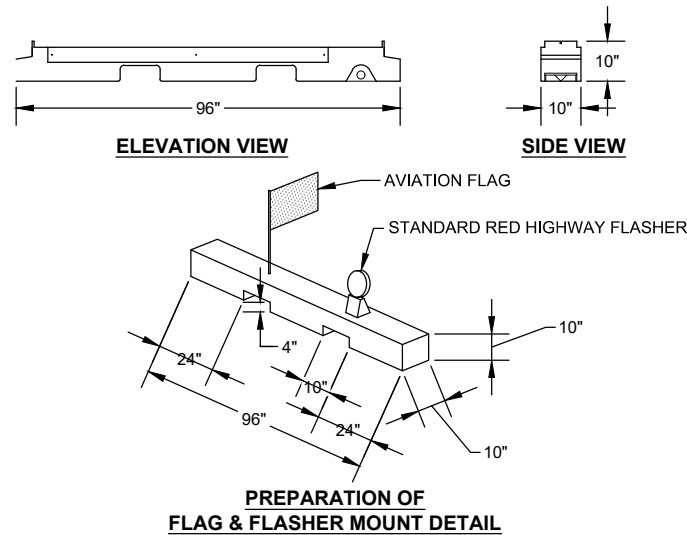

HAZARDOUS AREA BARRIERS

1. PLACE BARRIERS TO LIMIT ACCESS TO THE CLOSED TAXIWAY AND APRON AREAS. USE LOW STYLE BARRIERS (LESS THAN 12 INCHES HIGH) WHEN ADJACENT TO AN ACTIVE MOVEMENT AREA.
2. FLAGS SHALL ALTERNATE COLOR (ORANGE/WHITE) ON EACH BARRIER AS THEY ARE PLACED IN THE AIRPORT OPERATIONS AREA, IN SEQUENCE.

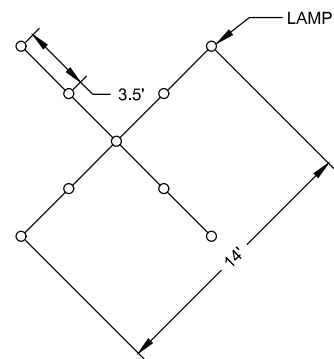

TEMPORARY FULL RUNWAY CLOSURE LIGHTED VISUAL AID

1. REFER TO AC 150/5345-55 FOR DETAILS AND SPECIFICATIONS FOR LIGHTED "X".
2. CROSSES SHALL HAVE A MEANS FOR ADJUSTING AND LEVELING TO ALLOW TILTING TO AN OPTIMUM ANGLE OF 5 DEGREES FROM VERTICAL.
3. PLACE CROSSES AT EACH CLOSED END OF RUNWAYS ON THE RUNWAY CENTERLINE AT THE RUNWAY DESIGNATION NUMBERS.
4. LIGHTED "X" MARKINGS ARE FOR FULL CLOSURES ONLY AND MUST BE COMPLETELY REMOVED FROM THE RUNWAY AND SAFETY AREAS PRIOR TO ANY NIGHTTIME EMERGENCY ARRIVAL OR DEPARTURE.

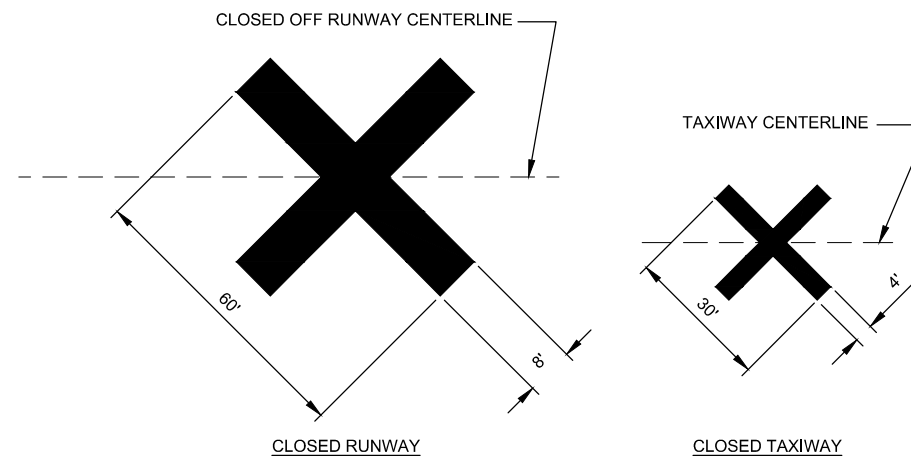

TEMPORARY "X" CLOSURE MARKING

CROSSES SHALL BE YELLOW, CONSTRUCTED OF PLASTIC OR WOOD AND WEIGHTED DOWN AT THE RUNWAY OR TAXIWAY SO AS TO NOT BE MOVED BY WIND, PROP WASH OR JET BLAST. WEIGHTS SHALL BE THE SAME COLOR AS THE MARKING.

SHEET NO.	TOTAL SHEETS
A10	11
STATE	YEAR
ALASKA	20XX
PROJECT DESIGNATION	
SFAPT00194	
3-02-0186-XXX-20XX	
REVISION	
DATE	
NO.	

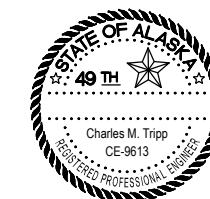

STATE OF ALASKA
DEPARTMENT OF TRANSPORTATION
AND PUBLIC FACILITIES

ADAK AIRPORT RUNWAY,
TAXIWAY, AND APRON
PAVEMENT REHABILITATION

CONSTRUCTION SAFETY &
PHASING PLAN DETAILS

FILE C:\ADK\SFAPT00194\Planset\SFAPT00194_C1_ESTIMATE OF QUANTITIES.dwg DATE 6/29/2020 16:59 LAYOUT C1 DESIGNED T. FAGNANT CHECKED C. TRIPP DRAFTED T. FAGNANT

ESTIMATE OF QUANTITIES

ITEM NUMBER	ITEM DESCRIPTION	PAY UNIT	QUANTITY
G100.010.0000	MOBILIZATION AND DEMOBILIZATION	LUMP SUM	ALL REQ'D
G115.010.0000	WORKER MEALS AND LODGING, OR PER DIEM	LUMP SUM	ALL REQ'D
G130.010.0000	FIELD OFFICE	LUMP SUM	ALL REQ'D
G130.020.0000	FIELD LABORATORY	LUMP SUM	ALL REQ'D
G130.060.0000	NUCLEAR TESTING EQUIPMENT STORAGE SHED	EACH	1
G130.140.0000	RADIOS	EACH	4
G131.010.0000	ENGINEERING TRANSPORTATION (TRUCK)	EACH	4
G135.010.0000	CONSTRUCTION SURVEYING BY THE CONTRACTOR	LUMP SUM	ALL REQ'D
G135.030.0000	MONUMENTS BY THE CONTRACTOR	LUMP SUM	ALL REQ'D
G135.050.0000	CONTRACTOR FURNISHED ENGINEERING TOOLS	CONTINGENT SUM	ALL REQ'D
G200.010.0000	CONTRACTOR QUALITY CONTROL PROGRAM	LUMP SUM	ALL REQ'D
G200.020.0000	QC PROGRAM ADMINISTRATOR	LUMP SUM	ALL REQ'D
G200.030.0000	QC TECHNICIAN	EACH	2
G210.010.0000	CONTRACTOR SAFETY PLAN COMPLIANCE DOCUMENT	LUMP SUM	ALL REQ'D
G300.010.0000	CPM SCHEDULING	LUMP SUM	ALL REQ'D
G310.010.0000	PUBLIC UPDATES	LUMP SUM	ALL REQ'D
G700.010.0000	AIRPORT FLAGGER	CONTINGENT SUM	ALL REQ'D
G700.030.0000	AIRPORT TRAFFIC MAINTENANCE	LUMP SUM	ALL REQ'D
G700.050.0000	MEDEVAC RUNWAY OPENING	LUMP SUM	ALL REQ'D
L125.180.0000	TEMPORARY RUNWAY LIGHTING SYSTEM	LUMP SUM	ALL REQ'D
L125.210.0000	ADJUST RUNWAY AND TAXIWAY LIGHT	EACH	311
P162.010.0000	PAVEMENT COLD PLANING	SQUARE YARD	268,000
P165.010.0000	REMOVAL OF STRUCTURES	LUMP SUM	ALL REQ'D
P209.080.0000	LINEAR GRADING	STATION	264
P401.010.0030	HOT MIX ASPHALT TYPE II, CLASS A	TON	35,970
P401.020.5834	ASPHALT BINDER PG 58-34E	TON	2,158
P401.080.0000	HOT MIX ASPHALT PRICE ADJUSTMENT	CONTINGENT SUM	ALL REQ'D
P401.090.0000	ASPHALT MATERIAL PRICE ADJUSTMENT	CONTINGENT SUM	ALL REQ'D
P401.100.0010	PAVEMENT SMOOTHNESS PRICE ADJUSTMENT, METHOD 1	CONTINGENT SUM	ALL REQ'D
P401.110.0000	LONGITUDINAL JOINT DENSITY PRICE ADJUSTMENT	CONTINGENT SUM	ALL REQ'D
P411.010.0000	INTELLIGENT COMPACTION FOR HOT MIX ASPHALT PAVEMENT	LUMP SUM	ALL REQ'D
P603.010.0010	TACK COAT, STE-1 OR CSS-1	TON	118
P605.010.0000	JOINT SEALING FILLER	LINEAR FOOT	24,000
P620.020.0000	RUNWAY AND TAXIWAY PAINTING	LUMP SUM	ALL REQ'D
P620.060.0000	PAINTED MARKING REMOVAL	LUMP SUM	ALL REQ'D
P620.070.0000	TEMPORARY RUNWAY & TAXIWAY PAINTING	LUMP SUM	ALL REQ'D
P621.020.0000	SAW-CUT GROOVES	LUMP SUM	ALL REQ'D
P641.010.0000	EROSION, SEDIMENT AND POLLUTION CONTROL ADMINISTRATION	LUMP SUM	ALL REQ'D
P641.020.0000	TEMPORARY EROSION, SEDIMENT AND POLLUTION CONTROL	CONTINGENT SUM	ALL REQ'D
P641.050.0000	TEMPORARY EROSION, SEDIMENT AND POLLUTION CONTROL BY DIRECTIVE	CONTINGENT SUM	ALL REQ'D
P641.060.0000	WITHHOLDING	CONTINGENT SUM	ALL REQ'D
P641.070.0000	SWPPP MANAGER	LUMP SUM	ALL REQ'D

BASIS OF ESTIMATE

ITEM NUMBER	PAY ITEM	ESTIMATING FACTOR
G135.030.0000	MONUMENTS BY THE CONTRACTOR	7 EACH
G700.050.0000	MEDEVAC RUNWAY OPENING	APPROX. 28 FLIGHTS/MONTH
P401.010.0030	HOT MIX ASPHALT TYPE II, CLASS A	117 LB./S.Y./IN.
P401.020.5834	ASPHALT CEMENT, PG 58-34E	6% OF ITEM P401.010.0030
P603.010.0010	TACK COAT, STE-1 OR CSS-1	0.1 GAL./S.Y. & 233 GAL./TON
P620.020.0000	RUNWAY AND TAXIWAY PAINTING	136,800 S.F.
P620.060.0000	PAINTED MARKING REMOVAL	122,100 S.F.
P620.070.0000	TEMPORARY RUNWAY & TAXIWAY PAINTING	NEW MARKINGS: 167,800 S.F.
		MARKING REMOVAL: 154,000 S.F.
P621.020.0000	SAW-CUT GROOVES	173,100 S.Y.

SHEET NO.	TOTAL SHEETS
C1	1
STATE	YEAR
ALASKA	20XX
PROJECT DESIGNATION	
SFAPT00194	
X-XX-XXXX-XXX-20XX	
REVISION	
DATE	
NO.	



STATE OF ALASKA
DEPARTMENT OF TRANSPORTATION
AND PUBLIC FACILITIES
**ADAK AIRPORT RUNWAY,
TAXIWAY, AND APRON
PAVEMENT REHABILITATION**
ESTIMATE OF
QUANTITIES

FILE C:\ADK\SFAPT00194\Planset\SFAPT00194_E1_MISC_DETAILS.dwg DATE 2/14/2020 16:26 LAYOUT E1 CHECKED C. TRIPP DRAFTED T. FAGNANT DESIGNED T. FAGNANT



1 **C/L MONUMENT CAP DETAIL**

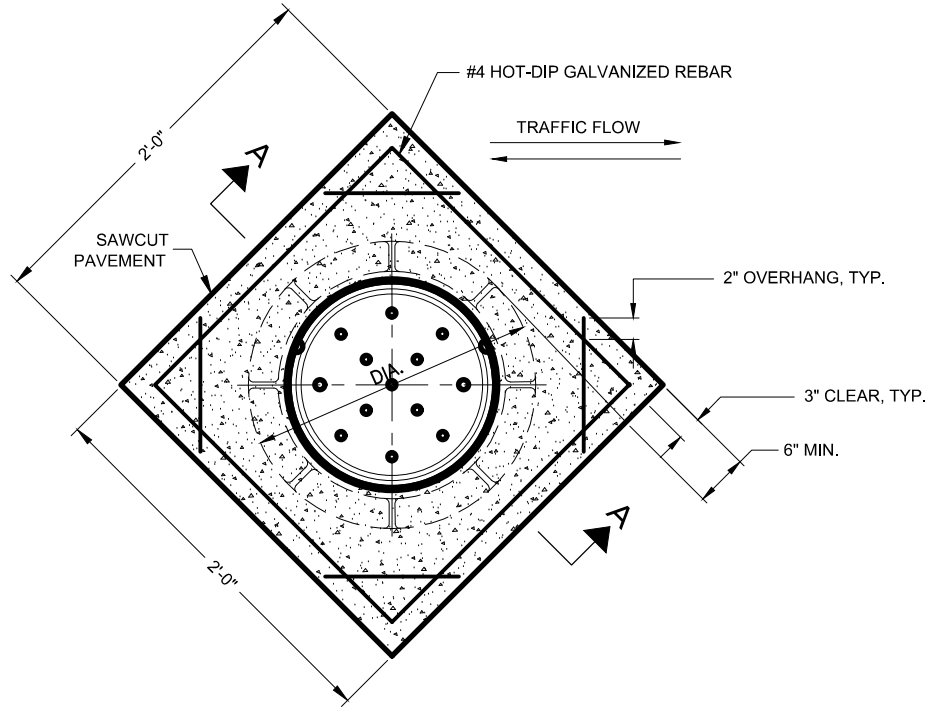

2 **CLASS A CONCRETE COLLAR ENCASEMENT PLAN**

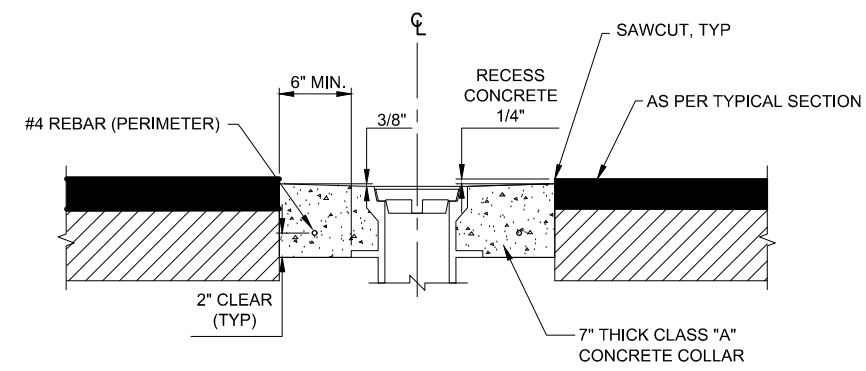

SECTION A-A
3 CLASS A CONCRETE COLLAR ENCASEMENT DETAIL
 REFER TO SHEET A3 FOR LOCATIONS

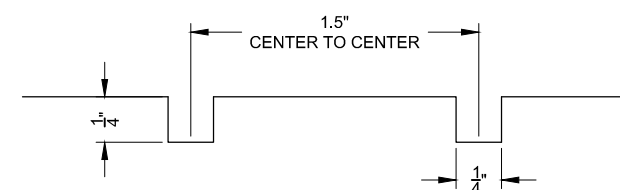

3 **PAVEMENT GROOVE SECTION VIEW**

PAVEMENT GROOVE NOTE:
 SEE SECTION P-630 OF THE SPECIFICATIONS FOR DETAILS OF THE GROOVING OPERATION.

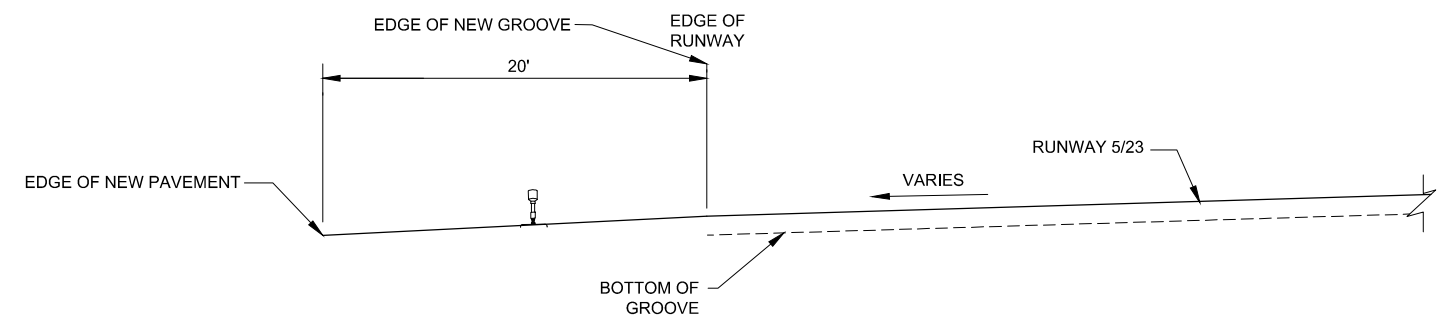

4 **PAVEMENT GROOVE DAYLIGHT DETAIL**
 N.T.S.

SHEET NO.	TOTAL SHEETS
E1	1
STATE	YEAR
ALASKA	20XX
PROJECT DESIGNATION	
SFAPT00194	
X-XXX-XXX-20XX	
REVISION	
DATE	
NO.	

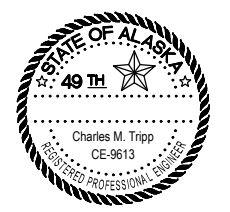

STATE OF ALASKA
 DEPARTMENT OF TRANSPORTATION
 AND PUBLIC FACILITIES
 ADAK AIRPORT RUNWAY,
 TAXIWAY, AND APRON
 PAVEMENT REHABILITATION
 MISCELLANEOUS
 DETAILS

FILE Q:\ADK\SFAP00194\Planset\SFAP00194_F1-F3_PLAN.dwg DATE 7/6/2020 11:28 LAYOUT F1 CHECKED C. TRIPP DESIGNED T. FAGNANT DRAFTED T. FAGNANT

LEGEND

- COLD PLANE 2", PAVE 2" HOT MIX ASPHALT
- COLD PLANE 3", PAVE 3" HOT MIX ASPHALT

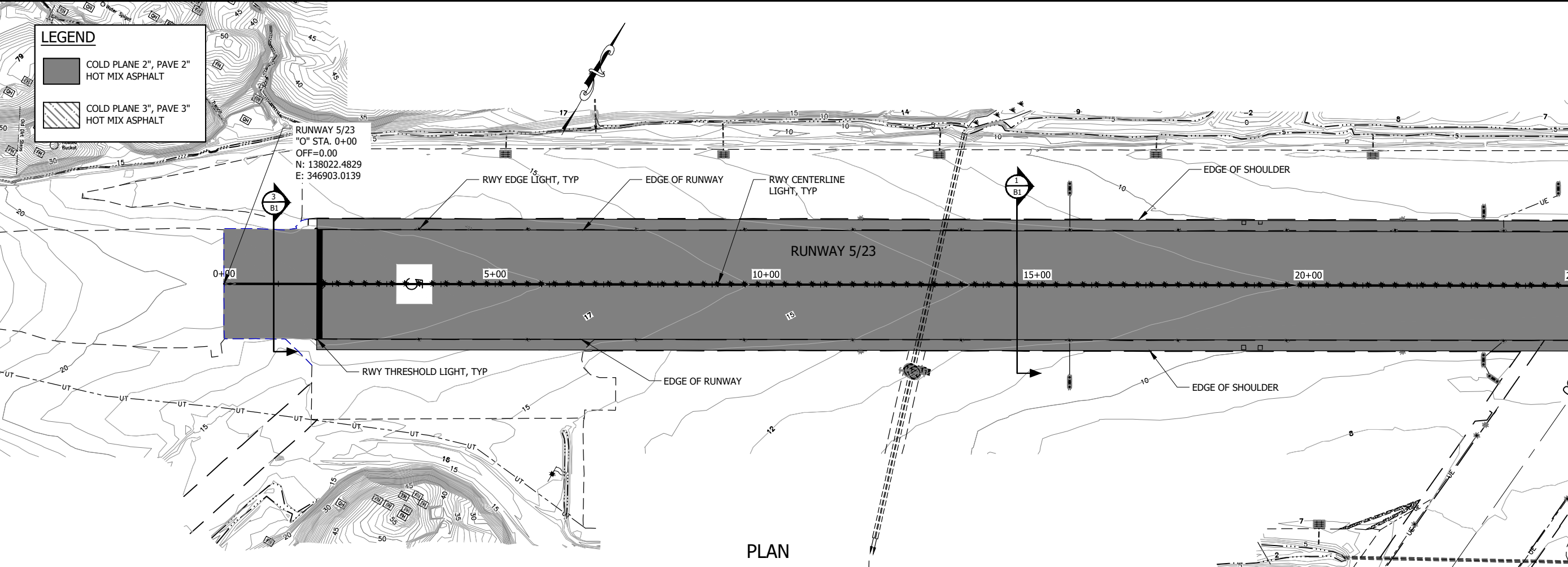

PLAN

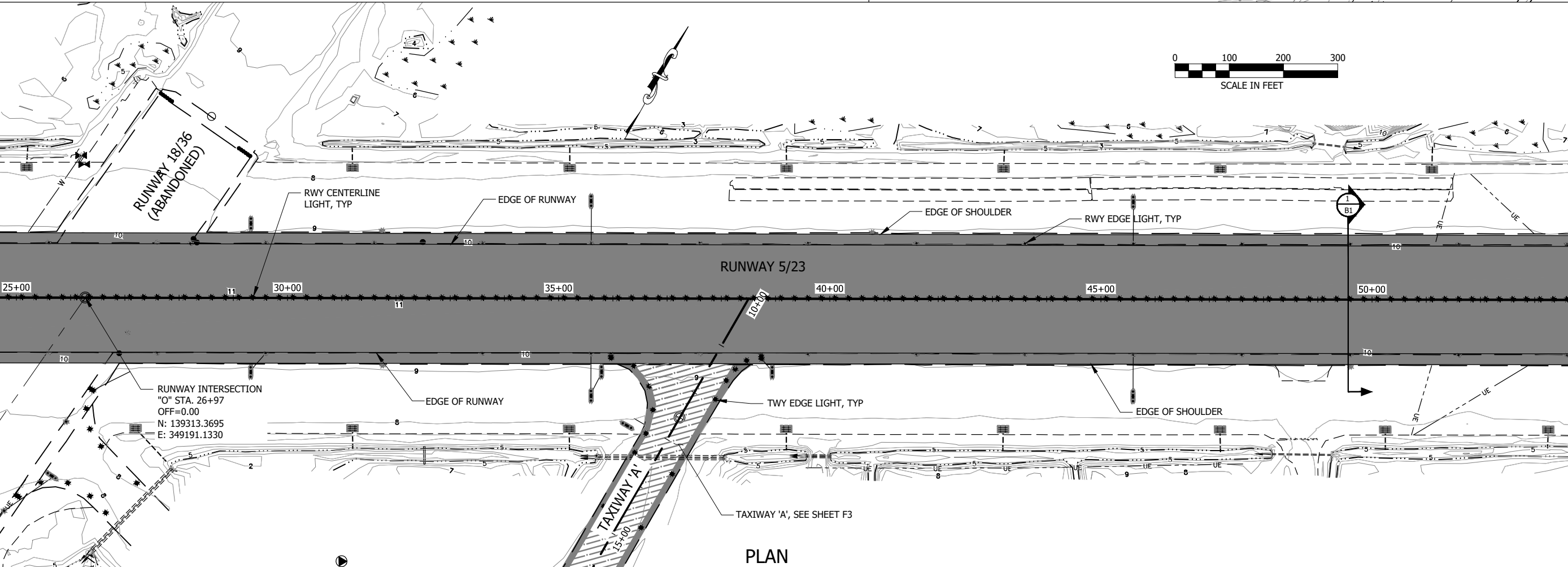

PLAN

SHEET NO.	TOTAL SHEETS
F1	3
STATE	YEAR
ALASKA	20XX

PROJECT DESIGNATION
SFAP00194
X-XXX-XXX-20XX

NO.	DATE	REVISION

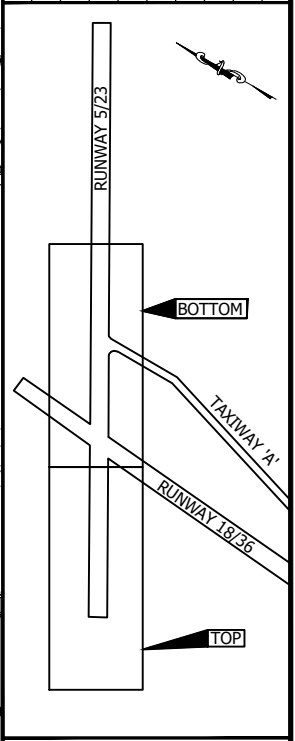

STATE OF ALASKA
DEPARTMENT OF TRANSPORTATION
AND PUBLIC FACILITIES
ADAK AIRPORT RUNWAY,
TAXIWAY, AND APRON
PAVEMENT REHABILITATION

PLAN VIEW

FILE Q:\ADK\SFAP00194\Planset\SFAP00194_F1-F3_PLAN.dwg DATE 7/6/2020 11:28 LAYOUT F2 DESIGNED T. FAGNANT CHECKED C. TRIPP DRAFTED T. FAGNANT

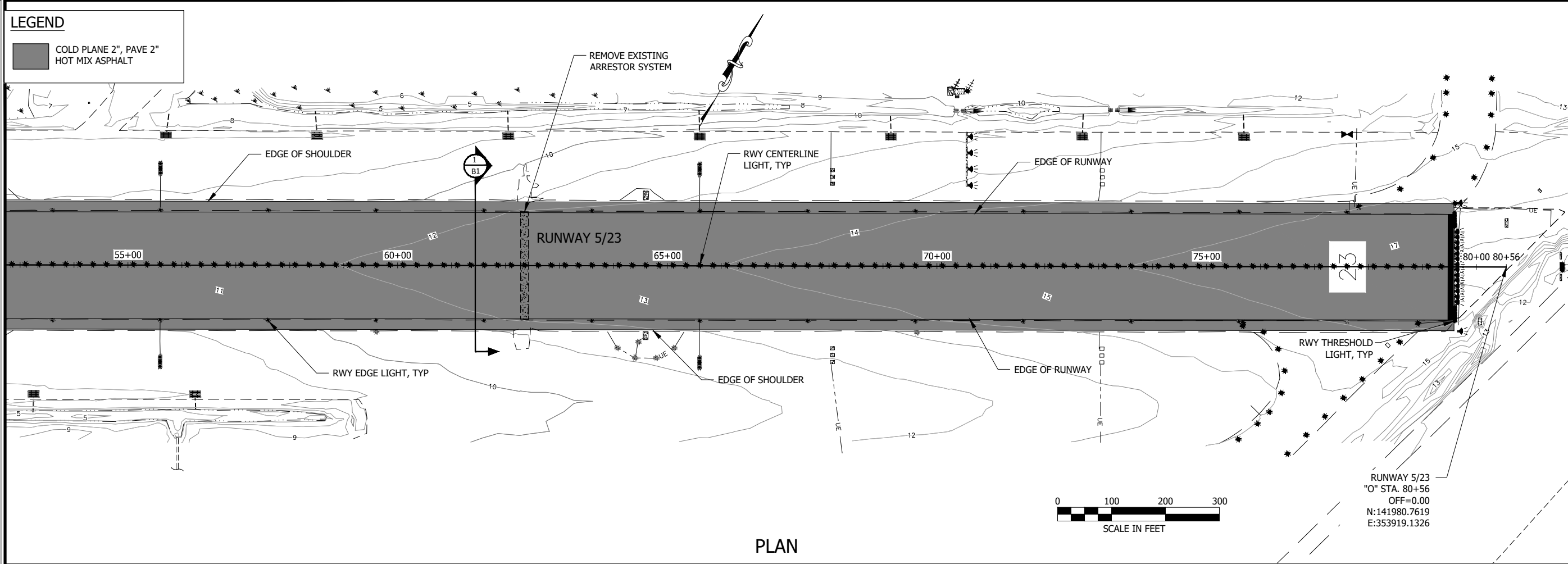

PLAN

SHEET NO.	TOTAL SHEETS
F2	3
STATE	YEAR
ALASKA	20XX

PROJECT DESIGNATION
SFAP00194
X-XXX-XXX-20XX

NO.	DATE	REVISION

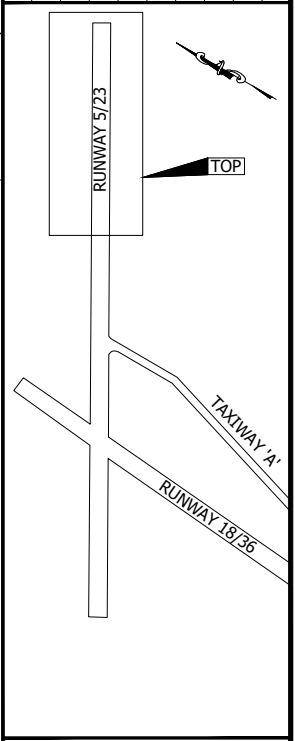

STATE OF ALASKA
DEPARTMENT OF TRANSPORTATION
AND PUBLIC FACILITIES

ADAK AIRPORT RUNWAY,
TAXIWAY, AND APRON
PAVEMENT REHABILITATION

PLAN VIEW

FILE: Q:\ADK\SFAP00194\Planset\SFAP00194_F1-F3_PLAN.dwg DATE: 7/6/2020 11:28 LAYOUT: F3 CHECKED: C. TRIPP DESIGNED: T. FAGNANT DRAFTED: T. FAGNANT

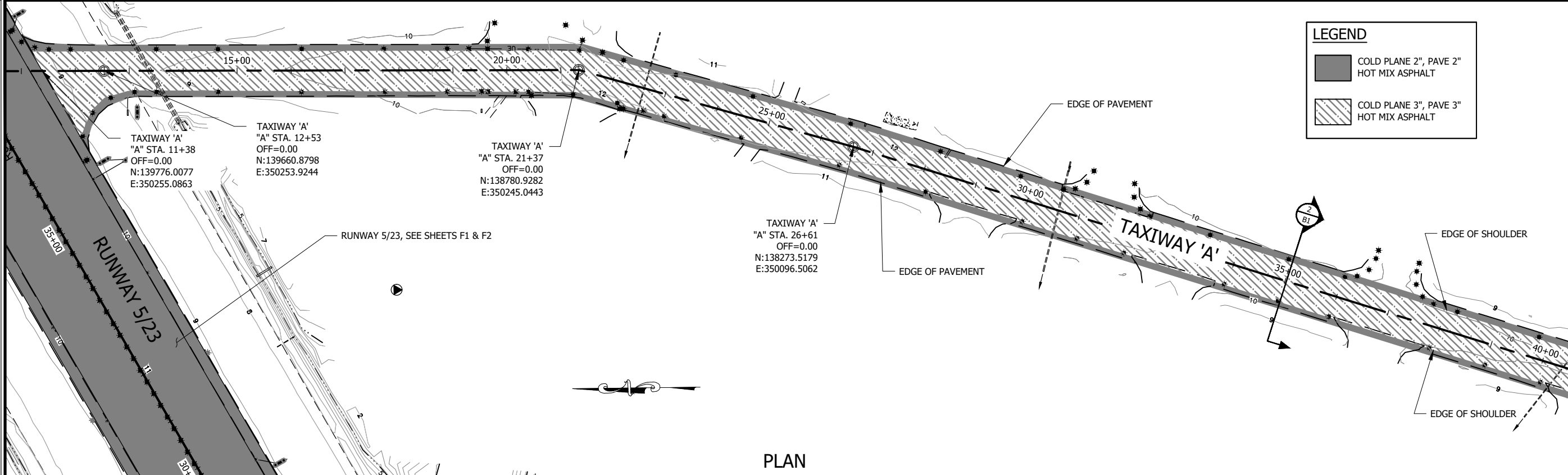

PLAN

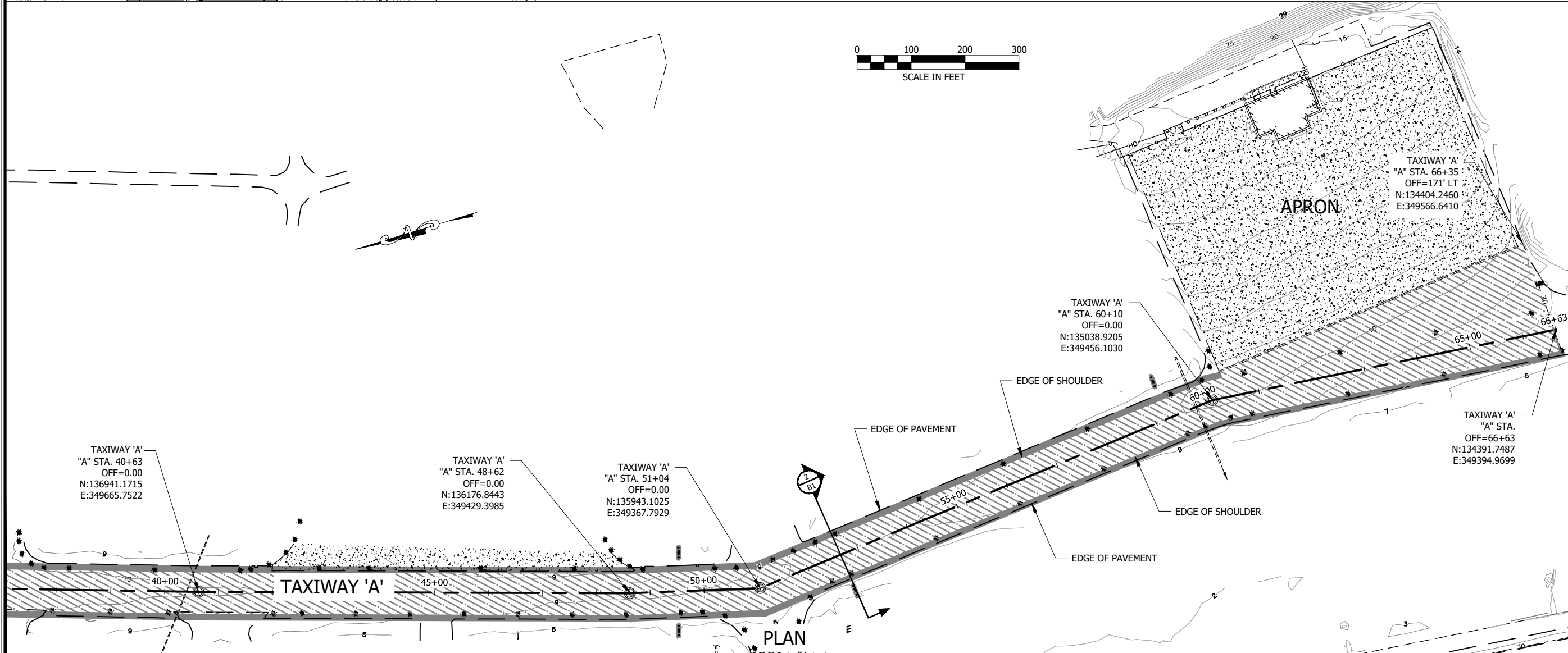

PLAN

SHEET NO.	TOTAL SHEETS
F3	3
STATE	YEAR
ALASKA	20XX
PROJECT DESIGNATION	
SFAP00194	
X-XXX-XXX-20XX	
REVISION	
DATE	
NO.	

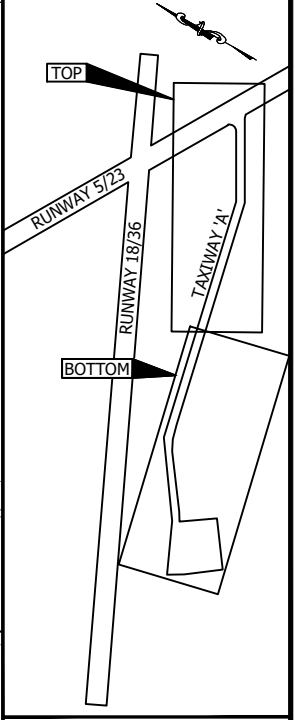

STATE OF ALASKA
DEPARTMENT OF TRANSPORTATION
AND PUBLIC FACILITIES
ADAK AIRPORT RUNWAY,
TAXIWAY, AND APRON
PAVEMENT REHABILITATION
PLAN VIEW

FILE C:\ADK\SFAPT00194\PlanSet\SFAPT00194_L1-L4_MARKINGS.dwg DATE 5/28/2020 16:47 LAYOUT L3 DESIGNED T. FAGNANT CHECKED C. TRIPP DRAFTED T. FAGNANT

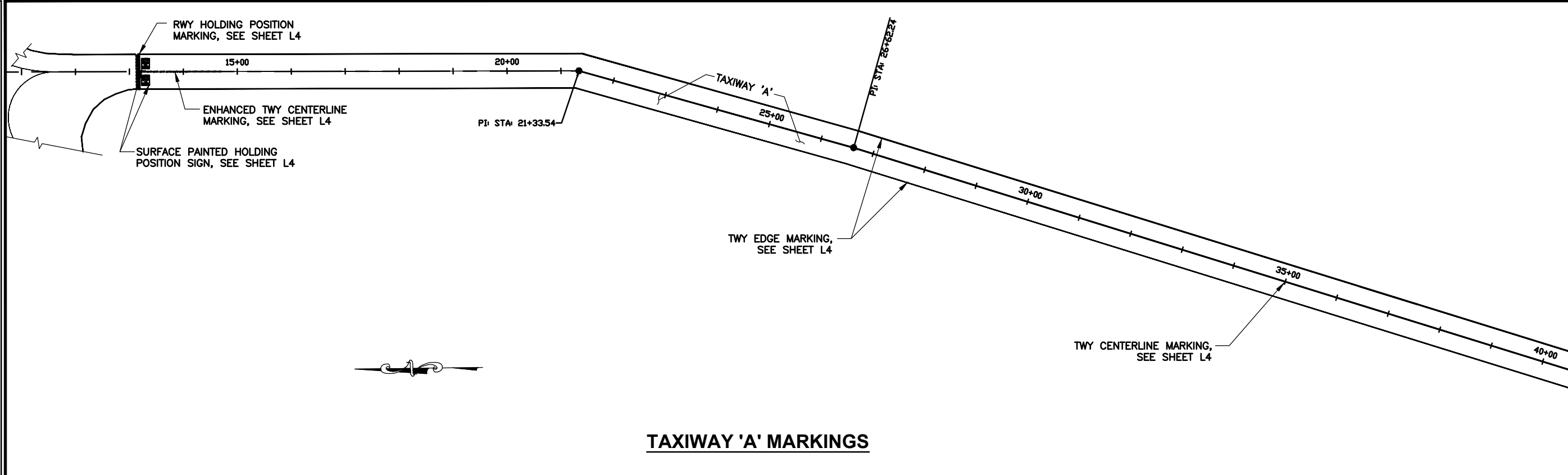

TAXIWAY 'A' MARKINGS

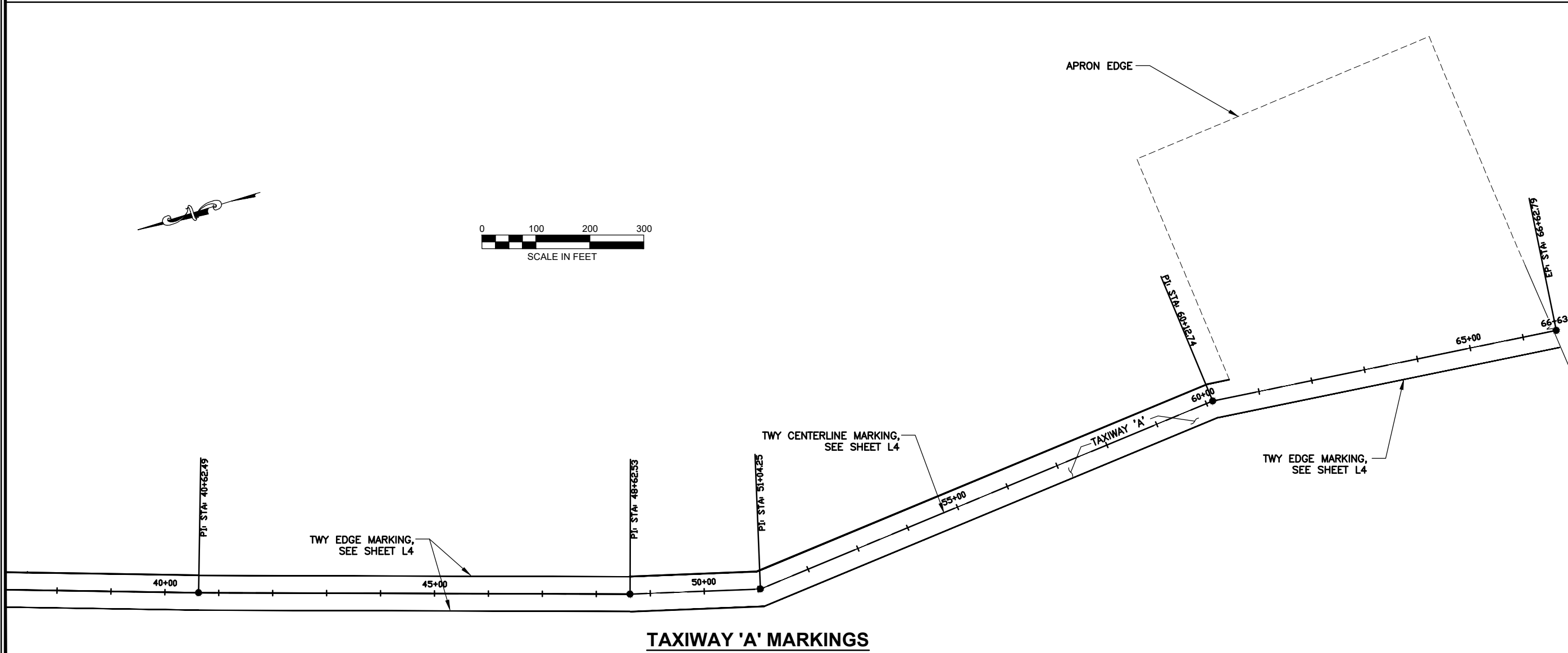

TAXIWAY 'A' MARKINGS

SHEET NO.	TOTAL SHEETS
L3	4
STATE	YEAR
ALASKA	20XX
PROJECT DESIGNATION	
SFAPT00194	
X-XXX-XXX-20XX	
REVISION	
NO.	
DATE	



STATE OF ALASKA
 DEPARTMENT OF TRANSPORTATION
 AND PUBLIC FACILITIES
**ADAK AIRPORT RUNWAY,
 TAXIWAY, AND APRON
 PAVEMENT REHABILITATION**
 MARKINGS

FILE Q:\ADK\SFAP00194\Planset\SFAP00194_01-QX_ESCP.dwg DATE 6/29/2020 16:58 LAYOUT 01 DESIGNED T. FAGNANT CHECKED C. TRIPP DRAFTED T. FAGNANT

LEGEND

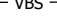
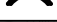
-  DRAINAGE FLOW
-  VEGETATIVE BUFFER STRIP
-  STORM DRAIN INLET PROTECTION

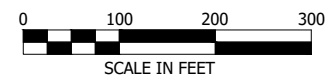
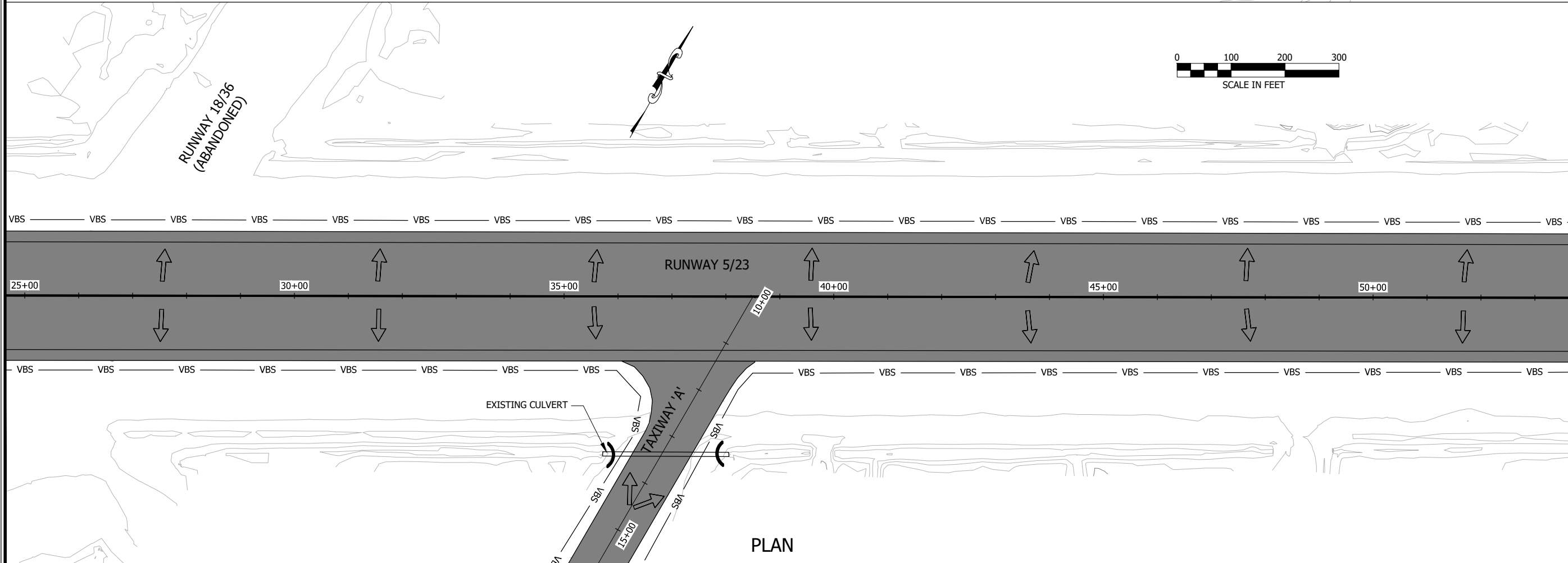
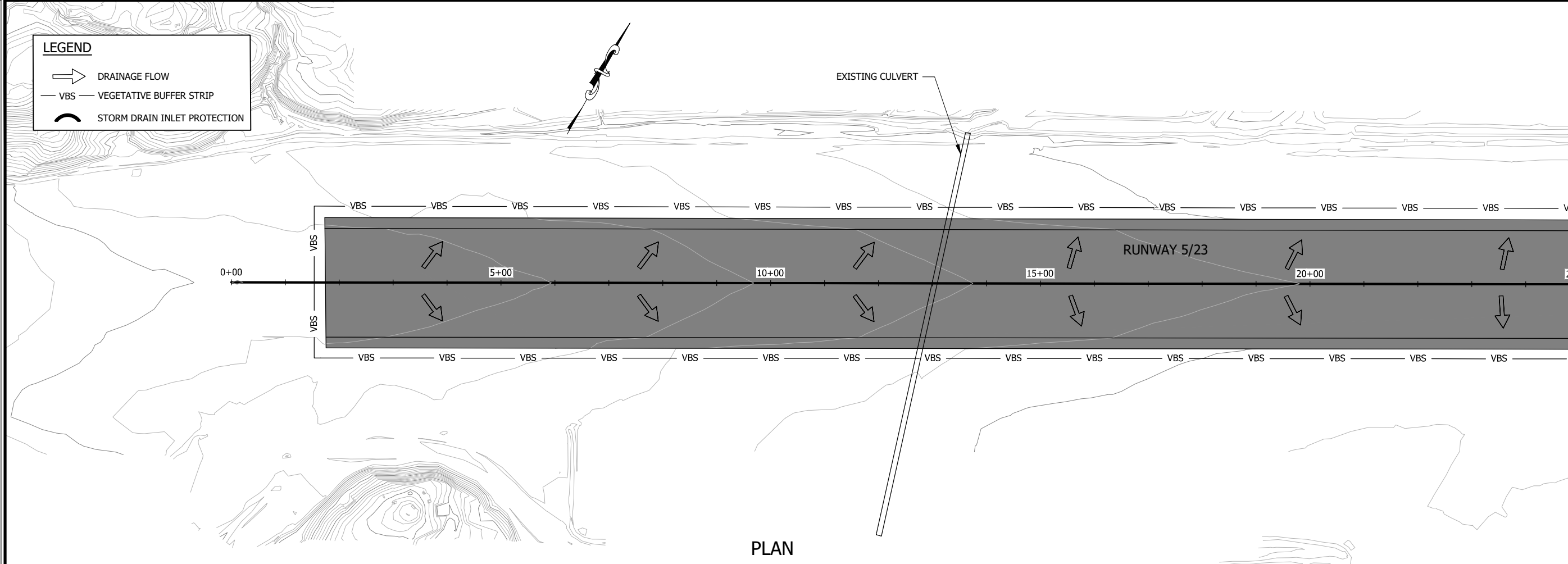

SHEET NO.	TOTAL SHEETS
Q1	3
STATE	YEAR
ALASKA	202X

PROJECT DESIGNATION
SFAP00194
X-XXX-XXX-202X

NO.	DATE	REVISION

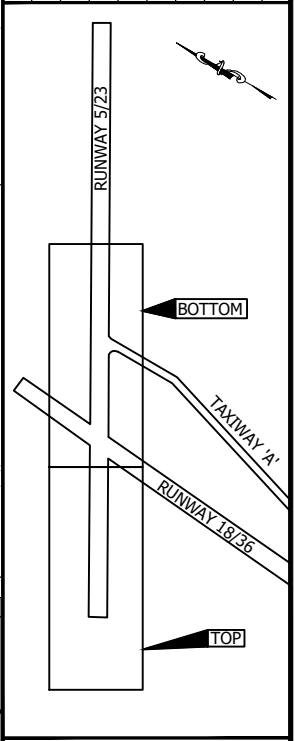

ESCP NOT SEALED IN ACCORDANCE WITH ALASKA HIGHWAY PRECONSTRUCTION MANUAL SECTION 1120.7.3 DATED NOVEMBER 15, 2013

STATE OF ALASKA
DEPARTMENT OF TRANSPORTATION AND PUBLIC FACILITIES
ADAK AIRPORT RUNWAY, TAXIWAY, AND APRON PAVEMENT REHABILITATION
EROSION, SEDIMENT CONTROL PLAN

