

FILE C:\Civil 3D Projects\2014\24\70776-01\Civil\SC14-CT-CV-LD-A-70776.dwg DATE 5/16/2018 10:07 LAYOUT A1 DESIGNED HOBBS CHECKED KILPATRICK DRAFTED WESTPHAL

STATE OF ALASKA

DEPARTMENT OF TRANSPORTATION AND PUBLIC FACILITIES

PROPOSED HIGHWAY PROJECT

MENDENHALL LOOP ROAD CAPACITY IMPROVEMENTS

NANCY STREET TO BACK LOOP ROAD

PROJECT NO. Z676220000

GRADING, DRAINAGE, PAVING, SIGNING, STRIPING,
ILLUMINATION & UTILITIES

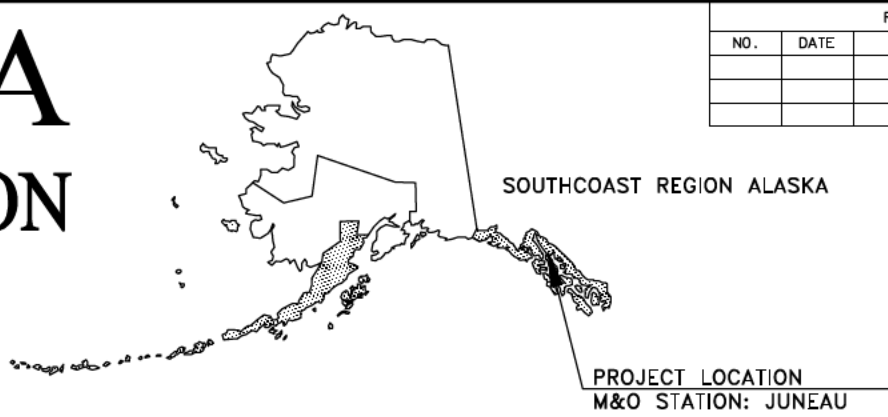

REVISIONS			STATE	PROJECT DESIGNATION	YEAR	SHEET NO.	TOTAL "A" SHEETS
NO.	DATE	DESCRIPTION				A1	A3
			ALASKA	Z676220000	2019	PLAN SET TOTAL	169
			CDS ROUTE: 296400		MILEPOINT: 0.39 TO 2.19		
			LATITUDE: N 58° 23' 14"		LONGITUDE: W 134° 34' 22"		

DESIGN DESIGNATIONS	
FUNCTIONAL CLASS	M NOR ARTERIAL
ADT (2016)	16,230
ADT (2030)	16,800
ADT (2040)	17,230
DHV EXIST NG YEAR	1,970
DHV MID-LIFE YEAR (2030)	2,020
DHV DESIGN YEAR (2040)	2,070
PERCENT TRUCKS (T)	6.35%
DIRECTIONAL SPLIT (D)	55/45
DESIGN SPEED (V)	45 MPH
DESIGN ESAL'S (30 YEARS)	5,450,000

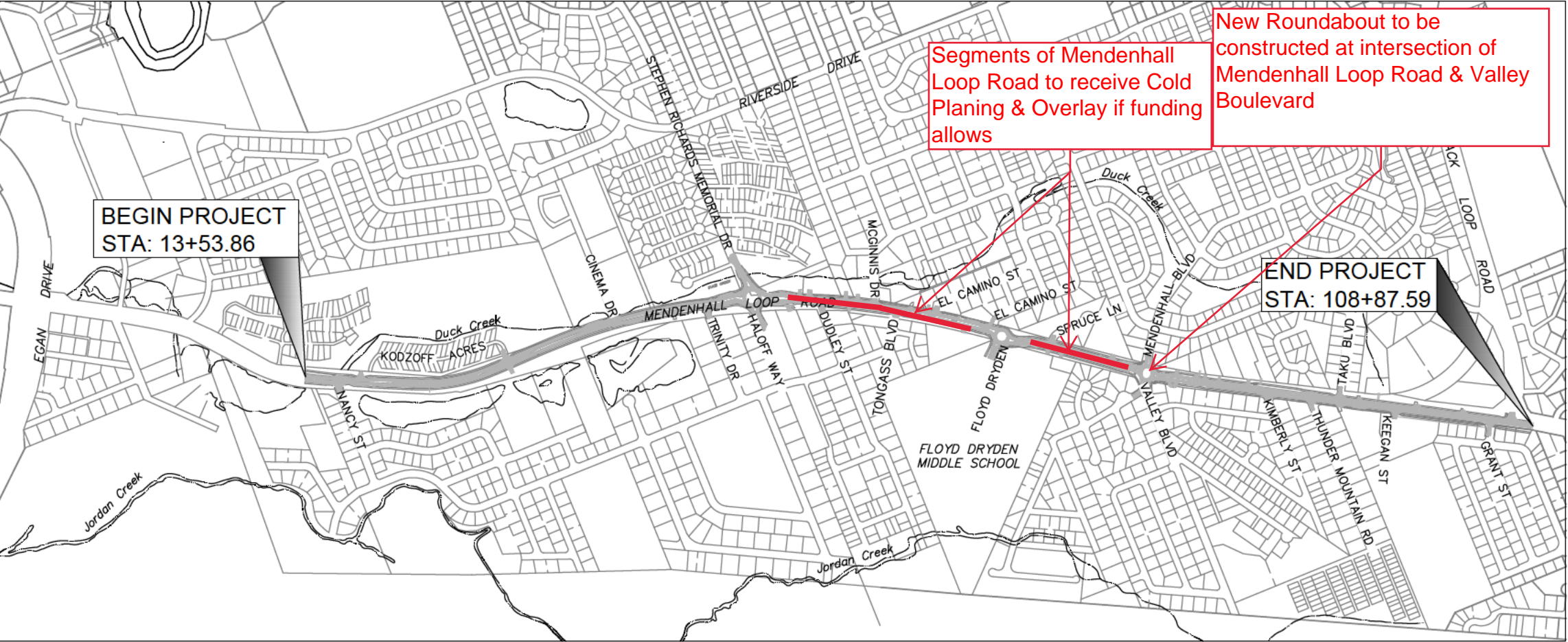

VICINITY MAP

PROJECT SUMMARY	
MENDENHALL LOOP ROAD MP 0.39 TO MP 2.19	
WIDTH OF PAVEMENT	44-58 FEET
LENGTH OF GRAD NG	1.8 MILES
LENGTH OF PAVING	1.8 MILES
LENGTH OF PROJECT	1.8 MILES

USE THESE PLANS IN CONJUNCTION WITH THE STATE OF ALASKA STANDARD SPECIFICATIONS FOR HIGHWAY CONSTRUCTION, 2017 EDITION AND THE PROJECT SPECIAL PROVISIONS.

PLANS DEVELOPED BY: DOWL
5368 COMMERCIAL BLVD. - JUNEAU, AK 99801
907-780-3533 - #AECL848

STATE OF ALASKA
DEPARTMENT OF TRANSPORTATION & PUBLIC FACILITIES



APPROVED:

L. PAT CARROLL, P.E.
REGIONAL PRECONSTRUCTION ENGINEER
CONCUR: DATE

MICHAEL J. COFFEY
DIRECTOR, SOUTHCOAST REGION
DATE

Previous PIH-level roundabout design for the intersection of Mendenhall Loop Road & Valley Boulevard.

Access control islands are not anticipated to be part of the preferred alternative.

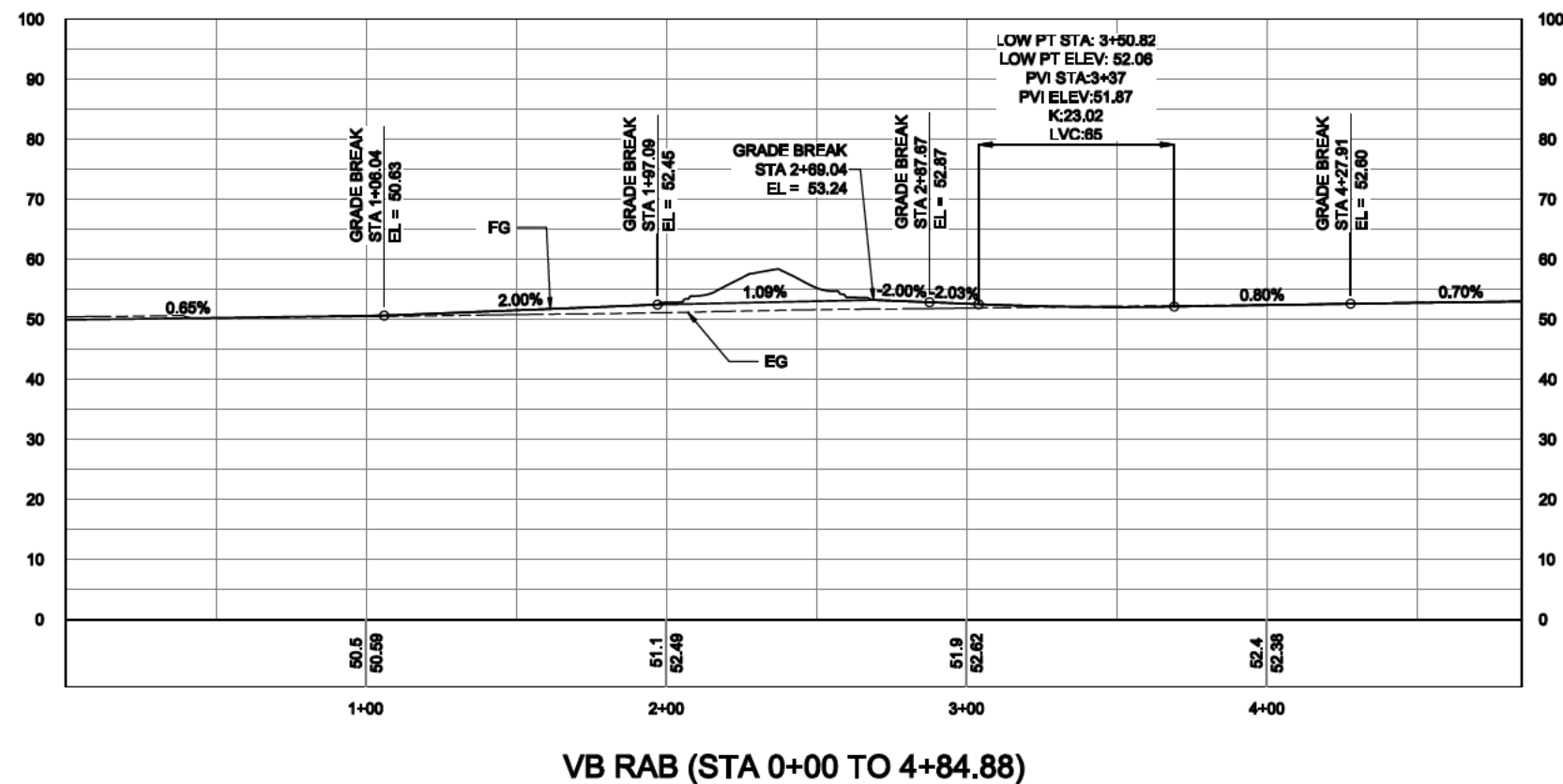
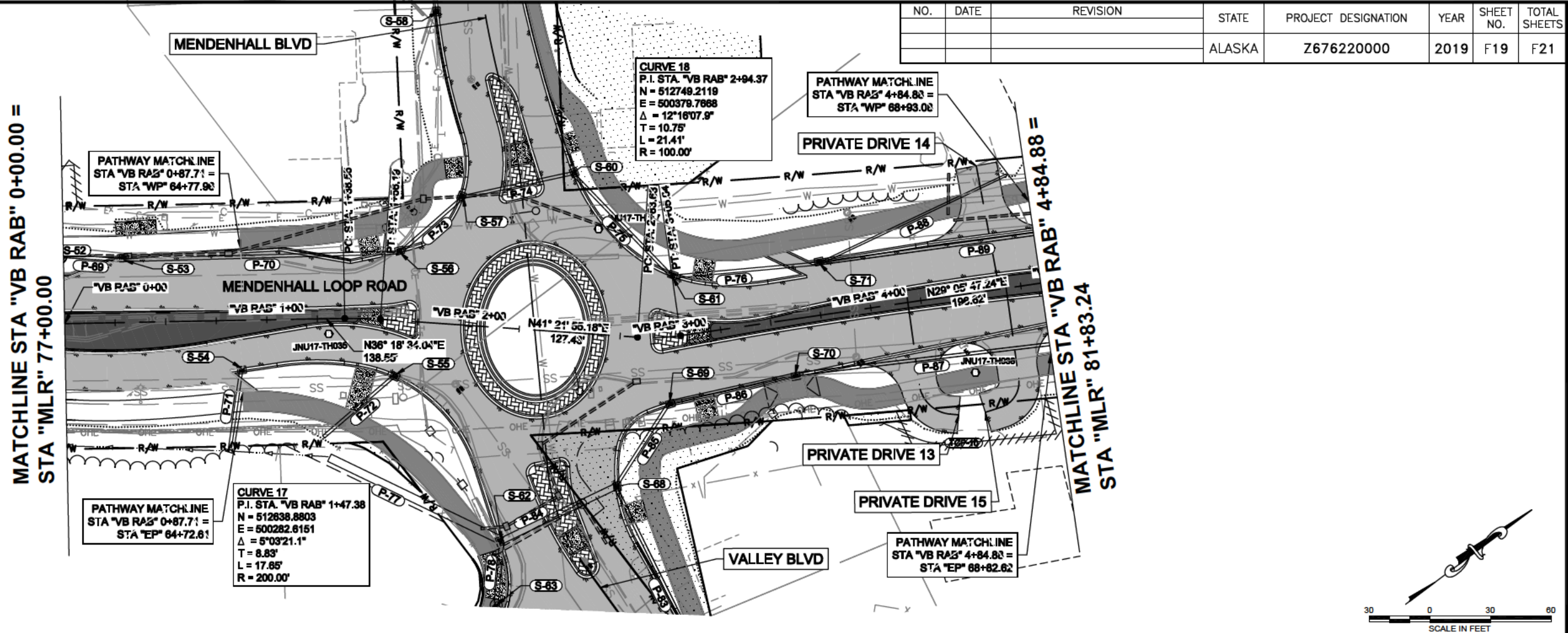

NO.	DATE	REVISION	STATE	PROJECT DESIGNATION	YEAR	SHEET NO.	TOTAL SHEETS
			ALASKA	Z676220000	2019	F21	F21

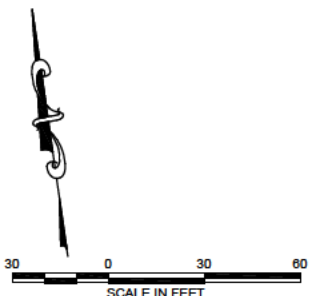
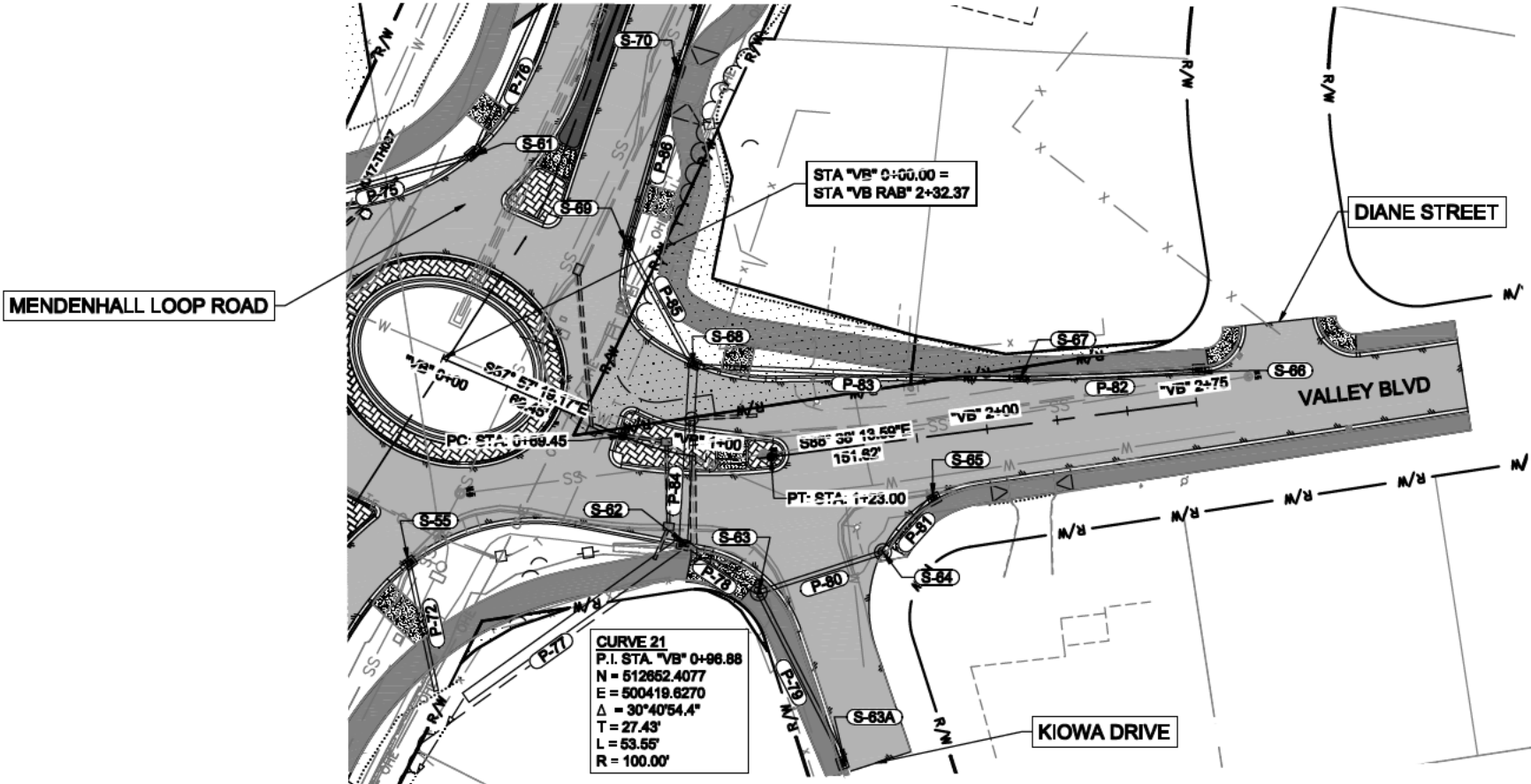

NOTES:
1. IMPROVEMENTS EXTEND BEYOND SURVEY. MORE INFORMATION IS REQUIRED PRIOR TO PHASE 2 DESIGN.

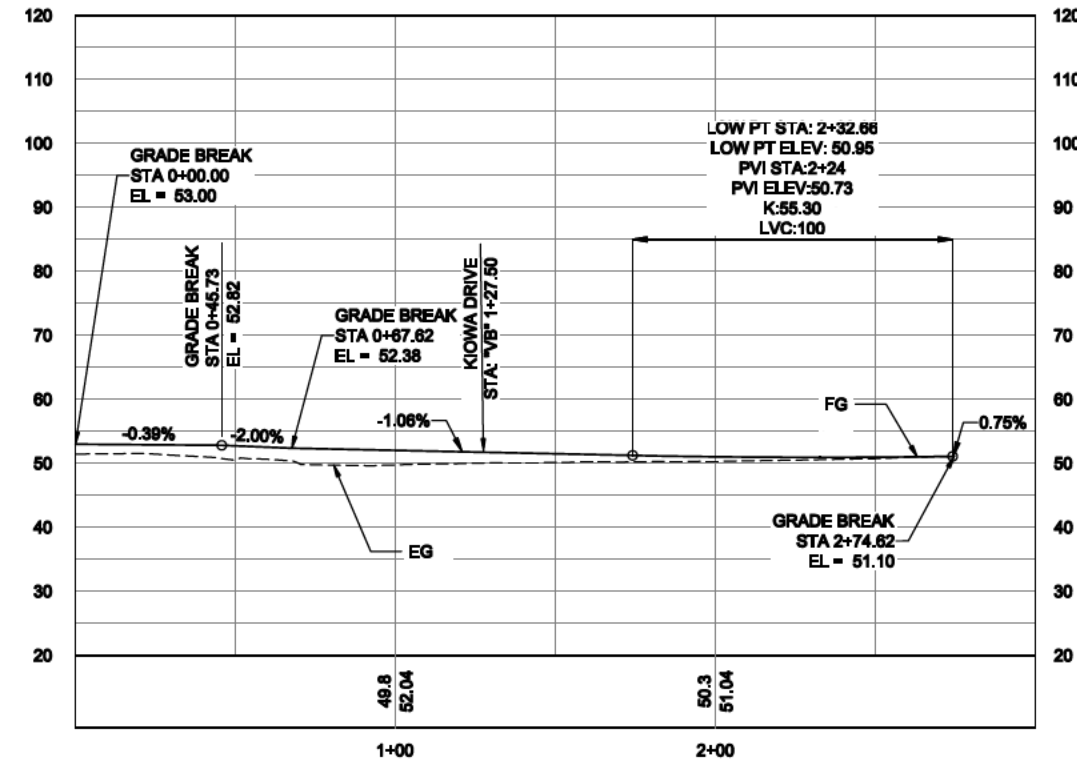

VB (STA 0+00 TO 3+00)

Preliminary Typical Section for repaving
Mendenhall Loop Road

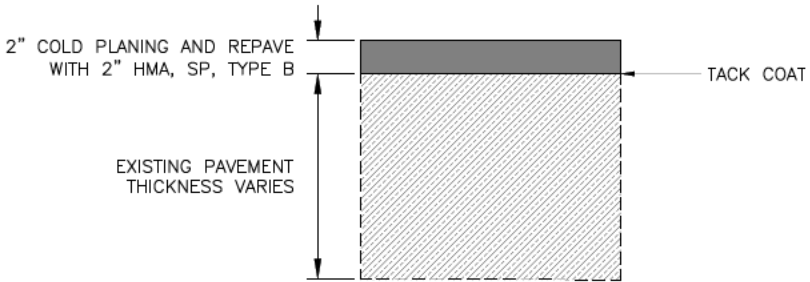

1 PAVEMENT SECTION DETAIL FOR ROAD
B2 NOT TO SCALE

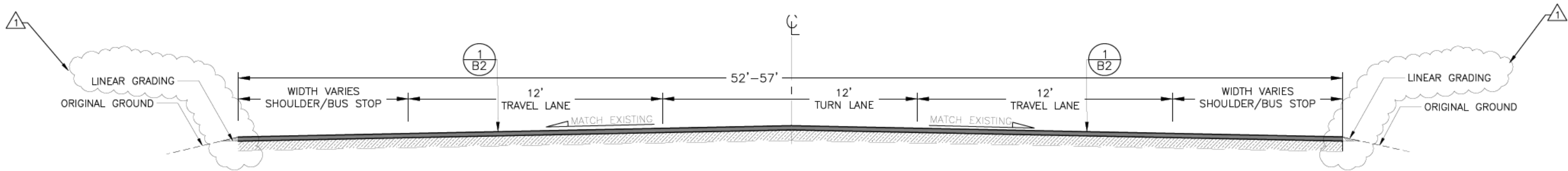

5. TYPICAL SECTION

STA 38+05 - EOP

PATH NOTES

- 1. TOPSOIL AND SEED ALL SLOPES DISTURBED FOR THE INSTALLATION OF P-1 CULVERT PIPE.
- 2. SEE SHEET D1 FOR LOCATION OF GRAVITY BLOCK RETAINING WALL.
- 3. ALL REFERENCES TO "PATH" REFER TO THE MULTI-USE PATH.

SAWCUT NOTES

- 1. SAWCUT AND REMOVE MILLED EDGE AT TRANSVERSE JOINTS, PRIOR TO PAVING.
- 2. DEPTH OF SAWCUT NOT TO EXCEED DEPTH OF COLD PLANING.

STATE OF ALASKA
DEPARTMENT OF TRANSPORTATION
AND PUBLIC FACILITIES
JNU MENDENHALL LOOP RD EGAN TO
STEPHEN RICHARDS RESURFACE