

STATE OF ALASKA  
Application for Permits to Mine in Alaska (APMA)

F2020

Single Year  Multi-year Start: 2022 Finish: 2026 APMA Number (A/F/J, Year, \*\*\*\*) 9157

What type activity are you planning to perform? *REQUIRED (1) <input type="checkbox"/> Exploration/Reclamation <input type="checkbox"/> Mining/Reclamation <input type="checkbox"/> Hardrock Exploration/Reclamat		Surface estate of mineral properties: *REQUIRED (2) <input checked="" type="checkbox"/> State (General) <input type="checkbox"/> Private (Patented) <input type="checkbox"/> Private (Native Corp.)	
<input type="checkbox"/> Access Equipment <input type="checkbox"/> Suction Dredge <input type="checkbox"/> Reclamation		<input type="checkbox"/> State (Mental Health) <input type="checkbox"/> Federal <input type="checkbox"/> City or Borough	
Mineral Property Owners: *REQUIRED (3) Individual Contact Name and Company Name <u>John B. Wentz</u>	Lessee: *if applicable (4) Individual Contact Name and Company Name	Operator: *REQUIRED (5) Individual Contact Name and Company Name <u>Alaska goldmine LLC.</u> <u>Sheldon maier</u>	
Mailing Address for official correspondence: *REQUIRED <u>32107 River View drive</u> <u>Fairbanks AK 99709</u>	Mailing Address for official correspondence:	Mailing Address for official correspondence: *REQUIRED <u>276 Eagle Ridge Rd.</u> <u>Fairbanks AK</u> <u>99712</u>	
Summer phone# (Primary): *REQUIRED <u>(907) 388-7164</u>	Summer phone# (Primary):	Summer phone# (Primary): *REQUIRED <u>(907) 322-6603</u>	
Summer phone# (Secondary):	Summer phone# (Secondary):	Summer phone# (Secondary): <u>(907) 458-9529</u>	
Winter phone# (Primary): *REQUIRED <del><u>(907) 458-9529</u></del>	Winter phone# (Primary):	Winter phone# (Primary): *REQUIRED <u>(907) same 322-6603</u>	
Winter phone# (Secondary):	Winter phone# (Secondary):	Winter phone# (Secondary):	
Cell/Satellite: <u>(907) 388-7164</u>	Cell/Satellite:	Cell/Satellite: <u>(907) 322-6603</u>	
FAX:	FAX:	FAX:	
E-mail:	E-mail:	E-mail:	
Alaska Business/Corporation Entity #:	Alaska Business/Corporation Entity #:	Alaska Business/Corporation Entity #:	
Registered Agent (Corp./LLC/LP):	Registered Agent (Corp./LLC/LP):	Registered Agent (Corp./LLC/LP):	
Project Name If Applicable: (6)	Average Number of Workers: *REQUIRED (7) <u>1</u>	Start-Up/Shut Down: (Month/Day) (8) _____ to _____	
Mining District: *REQUIRED (9) <u>Fairbanks</u>	Applicable USGS Map: *REQUIRED (10) <u>Livengood A-1</u>	On What Stream Is This Activity? (11) <u>Pedro Creek</u>	
Legal Description of mineral properties to be worked (MTRS) *REQUIRED (12) Example: Fairbanks Meridian Township 001N Range 003E Sections 15, 16, and 21 or F 001N 003E Sec. 15, 16, and 21 <u>F2N 1E Section 11</u>			
Internal Use Only: Date Application Received Complete: _____ Adjudicator: _____ LAS Entry: _____ CID(s): _____ CID(s): _____ CID(s): _____			



# APMA 9157 Active Area

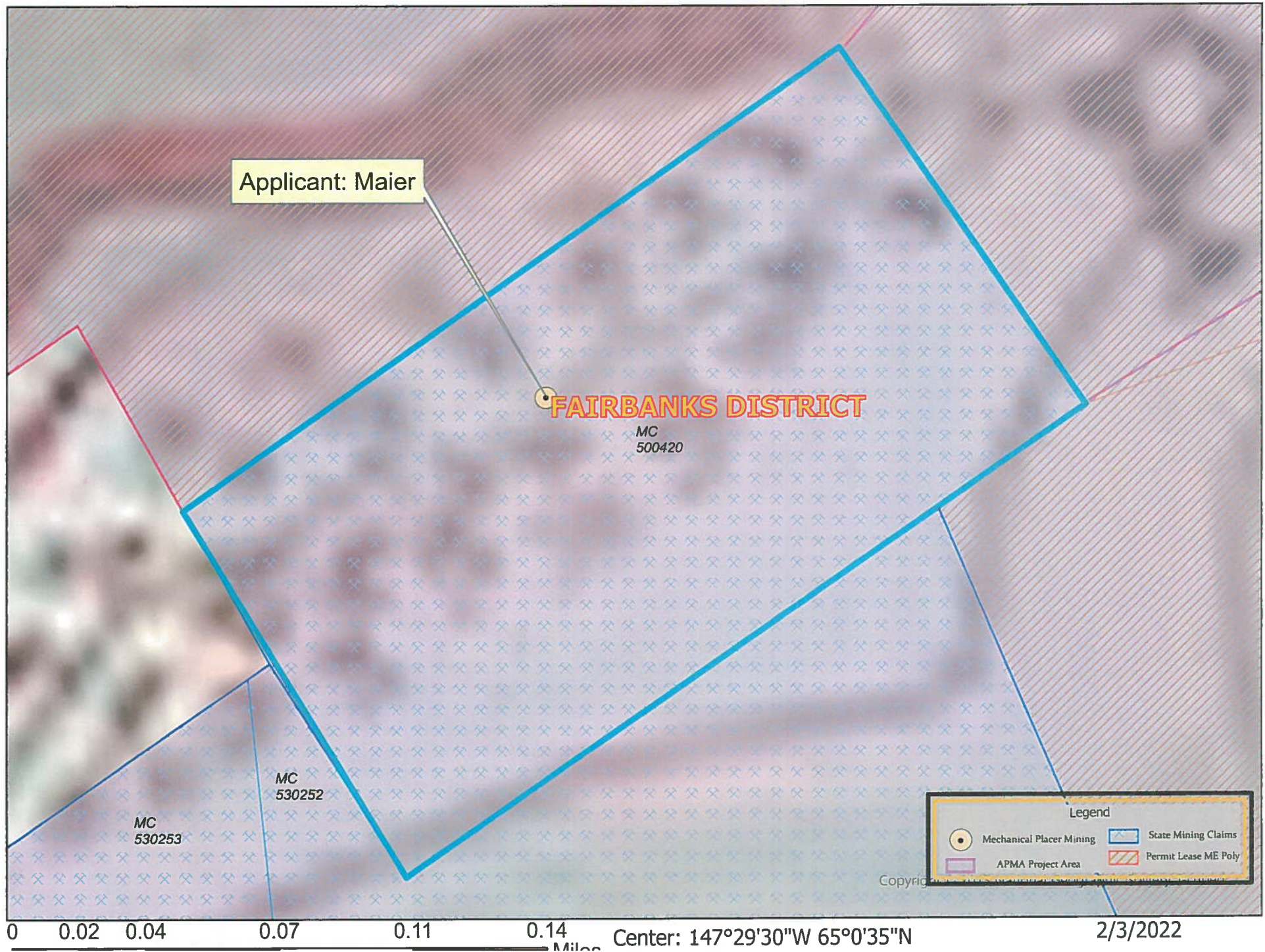

# MV\_ST\_MINING

Source: Alaska Department of Natural Resources, Information Resource Managment

Case ID	Case Status	Case Status Description	Case Type Description	Customer Name	Notepost Date	Total Acres
ADL 500420	35	Active (35)	Mining Claim (713)	Wentz John B	05-APR-84	19

\*\*\*END OF  
REPORT\*\*\*

## Report Information

Source ID	60
Source Name	MV_ST _MINI NG
Source Description	
Run Date and Time	02/03/2 022 02:44:5
Record Count	2 AKST
Count	1

SQL

Statement



**MINERAL PROPERTIES LIST**

(13)

If requesting more than 12 claims, Are additional sheets with ADL/BLM/USMS and Legal Descriptions Attached?  Yes  No  
 Are any of these mineral properties an Upland or Offshore Mining Lease?  Yes  No

	ADL/BLM/USMS #	PROPERTY NAME		ADL/BLM/USMS #	PROPERTY NAME
1.	500420	labore Pedro disc	7.		
2.			8.		
3.			9.		
4.			10.		
5.			11.		
6.			12.		

**INVENTORY OF EQUIPMENT**

(14)

List all mechanized equipment to be used (make, model, type, size, purpose, and number of each, including pumps). Attach additional sheets as necessary. If you are transporting on a trailer to the claim block, include the trailer size.

Check One:

	Make, Model, Type, Size, Purpose of Equipment or Pump	Quantity of this type	Located on the claim block?	Transporting to claim block?
1.	CAT 322 Excavator Digs	1	<input checked="" type="checkbox"/>	
2.	JD 600 Ex Digs	1	<input checked="" type="checkbox"/>	
3.	DAT D-7 Bulldozer Pushes	1	<input checked="" type="checkbox"/>	
4.	Garman Rupp - 6" x 6" pump	1	<input checked="" type="checkbox"/>	
5.	35' Travel trailer 1 Toilet / office / ect.	1	<input checked="" type="checkbox"/>	
6.				
7.				
8.				

**ACCESS OUTSIDE OF CLAIM BLOCK**

(15)

Access across surface estates not owned by the State requires approval of the managing agency. It is the responsibility of the applicant to contact the owners of private property to obtain authorization for access.

All season roads may be an improved dirt road intended to be used during all seasons of the year without causing long term damage to the road. NOTE: It is strongly recommended that you contact the appropriate Regional Land Office as certain roads are subject to Generally Allowed Uses, and authorization (permit or easement) may be required for use of the route with off-road vehicles greater than 1500 lbs curb weight (like mining equipment).

**A completed access map must be submitted with your application.** Copies of USGS topographic maps at a scale of 1"=1 mile must clearly indicate the proposed access route from start to finish and include appropriate legal descriptions (township and range) on each map sheet. The quadrangle map name should also be indicated (Healy A-3, etc.). Paper size should be limited to 8 1/2" x 11". Do not tape maps together.

Is a complete route map attached, including winter cross-country travel if applicable?  Yes  No

Access is:  Existing  To be constructed off claim block  Both, or  Helicopter Supported

Access outside the claim block crosses what type of land(s)?  State (General)  State (Mental Health)  
 City/Borough  Federal  Private  Private (Patented)  Private (Native Corp. Land)

Does the proposed route of travel include use of RS 2477 access?  Yes  No.

If the RS 2477 ROW has a State of Alaska RST number, please list: \_\_\_\_\_

ACCESS OUTSIDE OF CLAIM BLOCK, CONTINUED

Indicate type(s) of existing access:

- All Season Road: \_\_\_\_\_
- Summer Cross Country Travel off of claim block that is not considered Generally Allowed Uses (Complete Box 16)
- Airstrip
- River
- Winter Cross Country Travel that is not generally allowed use (Complete Box 16)

Indicate type(s) of access to be constructed:

- Access Road
- Airstrip

MA

Please describe your construction activities and include mitigation measures to protect water, fish and game resources. (A map outlining the route of construction activities is required). Attach additional pages if necessary:

---



---



---



---



---



---

CROSS COUNTRY TRAVEL

(16)

**Summer Cross Country Travel:** Approvals for summer travel are issued from the DNR/DMLW Land section. Applications for LUPs may require sixty to ninety days to process and applications for easements may require six months to one year to process. A performance guarantee, insurance and fees are required before a permit will be issued and will only be released after travel is completed and no negative trail impacts have occurred.

**Winter Cross Country Travel:** May be approved when ground conditions will support the movement of heavy equipment. Existing roads and trails should be used whenever possible. The winter operation of ground contact vehicles for off-road travel must be limited to areas where ground frost and snow cover are adequate to prevent damage to the vegetation mat and underlying substrate. A completion report is required within 30 days of travel completion. Travel is generally not authorized after April 15<sup>th</sup> of each year (extensions may be granted as conditions allow).

A Cross Country Travel Route Map is required to obtain authorization. Is the map attached?  Yes  No

Name the individual(s) or business(es) who will be conducting the cross country travel:

---

List all equipment and vehicles being transported from box 14, including vehicle weights:

---

State the average total miles traveled in one round trip: \_\_\_\_\_. State the number of trips proposed: \_\_\_\_\_.

State the start and end date(s) or period(s) of proposed cross country travel: \_\_\_\_\_.

Select the following terrain type(s) that best describes your route of travel:  Wetlands  Tundra

Uplands  Rivers or Other Water Bodies  Wooded Areas (6" Trees or larger at breast height)

Will water be needed to construct ramps/ ice bridges?  Yes  No

If Yes, estimated quantity of water will be used \_\_\_\_\_ gallons/day WaterSource: \_\_\_\_\_

**CROSS COUNTRY TRAVEL, CONTINUED**

Are you transporting fuel?  Yes  No

The volume of fuel and hazardous substances to be used is the total volume (in gallons) to be carried on one vehicle and any trailers or sleds that vehicle is towing.

Maximum volume of fuel (in gallons) that is being transported by one vehicle and any trailers or sleds it is towing:

Are you transporting other hazardous substances?  Yes  No If "yes", indicate type and amount (e.g. gallons, lbs, psi):

How are petroleum products contained? (i.e., drums, bladders, steel tanks, etc.) Indicate size of containers:

How are petroleum products being transported? (i.e., skid-mounted tank; trailer; 55 gallon drums on skid; etc.)

Do you have an Oil Discharge Prevention and Contingency Plan approved by the Alaska Department of Environmental Conservation?  Yes  No

Do you have either a trained spill response team or a contract with a spill response company?  Yes  No

Describe any measures you plan to take to minimize drips or spills from leaking equipment or vehicles:

Does your cross country travel include the staging or storage of equipment or structures off the claim block?  Yes  No

If Yes, describe the location and dimensions of the long term or short term parking and/or storage areas.

**PETROLEUM PRODUCTS AT PROJECT SITE**

(17)

Will Petroleum Products Be Stored on the Project Site?

- 0-1,320 gallons of total storage (Secondary Containment recommended, but not required)
- 1,321-10,000 gallons of total storage (count only containers greater than 55 gallon capacity). A self-certified Spill Prevention, Control, and Countermeasure (SPCC) plan is required and applies to all products, such as diesel fuel, gasoline, lube oil, hydraulic oil and waste oil. The self certified SPCC form can be downloaded at: <https://www.sfdph.org/dph/files/EHSdocs/ehsHMUPAdocs/TIERIQFSPPCCPlan.pdf>.  
BLM Operators are required to fill out the BLM-Spill contingency plan that can be downloaded at: <https://www.blm.gov/node/5393>
- 10,000+ gallons of total storage (count only containers with 55 gallons or greater storage capacity). An SPCC certified by a professional engineer is required and applies to all oil products, such as diesel fuel, gasoline, lube oil, hydraulic oil and waste oil.

Indicate Distance Stored From Flowing Waters: water bodies required by DNR is 100 feet). \_\_\_\_\_ Feet. (Minimum distance from naturally occurring

Is waste oil stored on the project site?  Yes  No If yes, describe quantity and storage modality: \_\_\_\_\_

Are fuel containment berms around storage containers?  Yes  No Is berm area lined?  Yes  No

**TEMPORARY STRUCTURES/FACILITIES**

(18)

Is a camp or placement of any temporary structure requested?  Yes  No

If No, Please explain: \_\_\_\_\_

**Describe all temporary improvements (including buildings, tent platforms, out-buildings, etc., including thier quantity, dimensions and building type.**

What type of property is the camp located on?  State  Federal  Private (Patented)  City or Borough  MHTL

If camp is on private land, provide location: \_\_\_\_\_

Proposed Perimeter Dimensions of Camp: 35 length (ft) 8 Width (feet).

Request use of existing facilities, list ADL(s): \_\_\_\_\_

Year-Round  Seasonal, from Approx. \_\_\_\_\_ to \_\_\_\_\_, annually.

Request to place temporary structures, list ADL(s): \_\_\_\_\_

Year-Round  Seasonal, from Approx. \_\_\_\_\_ to \_\_\_\_\_, annually.

	Temporary New Structures Quantity	Existing Structure Quantity	Use (Shop, office, etc.)	Dimensions (ft x ft)	Dimensions (ft x ft)	Dimensions (ft x ft)
Framed						
Tent						
Trailer	<u>1</u>		<u>Office   Toilet   Place to eat.</u>	<u>35</u>	<u>8</u>	
Platforms						
Out-Buildings						
Other:						

\* If Required, list any other structures on a seperate sheet, include dimensions, use and type.

**Grey water and Biological Waste** - Describe storage and proposed method of disposal(e.g.; leach line, septic, holding tank, or pit privy):

leach line for gray water holding tank for black.

**Solid Waste** - Describe the types of waste that will be generated on-site including garbage, scrap metal, industrial; and describe its disposal (e.g.; burn, haul away, buried).

haul away ~~any~~ any garbage

What is the distance grey water, biological, and solid waste will be located from the ordinary high water mark of the nearest freshwater body (lake, stream, river, rivulet, etc.), or the mean high water mark of a saltwater body: 100'

Will there be any use of animals ( horses, dogs, goats/sheep, etc)?  Yes  No

**Dismantle, Removal, and Restoration Plan:** Provide a plan for dismantling and removing temporary structures. Include the method and timeline for restoration of all stucture location areas. **Be sure to include this in your narrative as part of your reclamation, See Section 31.**

**MINING METHOD**

(19)

Mechanical Placer Mining (e.g., terrestrial open-cut operations with dozer or excavator, etc.)

Estimated cubic yards processed annually: 20 to 30,000 yds

Suction dredge       Mechanical dredge (e.g., excavator or clam-shell)

List all suction and mechanical dredges. If information is not applicable, write "N/A." Attach extra sheet if necessary.

	Dredge 1		Dredge 2		Dredge 3	
Vessel ID (Name or Number)	N/A					
Vessel Dimensions	N/A					
Suction Dredge Intake Nozzle Diameter / Pump Size	Inches:	HP:	Inches:	HP:	Inches:	HP:
Mechanical Dredge Bucket Volume	Cubic Yards:		Cubic Yards:		Cubic Yards:	
Processing Rate	Yds. <sup>3</sup> /Hr.:		Yds. <sup>3</sup> /Hr.:		Yds. <sup>3</sup> /Hr.:	
Wastewater Discharge Rate	GPM:		GPM:		GPM:	
Maximum Water Depth	Feet:		Feet:		Feet:	
Average Daily Operating Hours						
Operation on Sea Ice (Yes/No)	Yes <input type="checkbox"/> / No <input type="checkbox"/>		Yes <input type="checkbox"/> / No <input type="checkbox"/>		Yes <input type="checkbox"/> / No <input type="checkbox"/>	
Vessel Registration # / State	#: _____	State: _____	#: _____	State: _____	#: _____	State: _____

Location:     Offshore / Salt Water                       Pond connected to stream  
 Stream                                                               Pond isolated from stream  
 Mine cut isolated from stream

**EXPLORATION TRENCHING and DRILLING**

(20)

(Indicate target and trenching locations on sketch sheet and/or topographic map)

**Trenching:**  Yes  No

Estimated number of trenches to be excavated: \_\_\_\_\_ . How long will trenches be open? \_\_\_\_\_

Average Size: Length: \_\_\_\_\_ Feet Width: \_\_\_\_\_ Feet Depth: \_\_\_\_\_ Feet

**Drilling:**  Yes  No

Total Number of Holes To Be Drilled: \_\_\_\_\_ Type of Drill(s) Used: \_\_\_\_\_

Estimated Maximum Depth: \_\_\_\_\_ Feet Diameter of Drill Rod/Casing Rod \_\_\_\_\_ (NQ/HQ/H, Etc.).

Will water be used?  Yes  No Indicate how many pumps per water source: \_\_\_\_\_

Water source name(s): \_\_\_\_\_

**\*Describe detailed drill plan, closure, plugging methodology, reclamation and abandonment in project narrative.\***

Trench/Drilling Location and Mining Claim Information			
Trench/Drill ID on Map	ADL/BLM/USMS NUMBER	Decimal Degrees, NAD 83 Datum	
		Latitude	Longitude (approximate)

If more than 8 trenches/drill sites, please provide data in tabular format ([http://dnr.alaska.gov/mlw/forms/19apma/AHEA\\_ReclamationSpreadsheet.xls](http://dnr.alaska.gov/mlw/forms/19apma/AHEA_ReclamationSpreadsheet.xls).)



**EXPLOSIVES**

(21)

Will explosives be used?  Yes  No If "Yes", Indicate: Type N Amount: \_\_\_\_\_

Explosive Handler's Certification/ATF Permit Numbers: \_\_\_\_\_

Describe your blast design, blast schedule, and explosives handling plan in the project narrative.

**DAMS**

(22)

No dam required  Existing  To be constructed

Proposed Structure:  Temporary  Permanent

Purpose:  Makeup water pond  Settling/recycle pond  Stream diversion Other: \_\_\_\_\_

Length: \_\_\_\_\_ ft Height: \_\_\_\_\_ ft Width At Crest: \_\_\_\_\_ ft Width At Base: \_\_\_\_\_ ft

Note: Height should be measured from the lowest point at either the upstream or downstream toe of the dam to the crest of the dam.

Water impoundment capacity (if known): \_\_\_\_\_ acre-feet

**IN-STREAM ACTIVITIES and STREAM CROSSINGS**

(23)

List any equipment that will be crossing streams (including low-water crossings along established trails/roads) or used in any natural waterbody (refer to Box 14 if necessary), or used in-stream (refer to Box 14 if necessary):

List all stream crossings, suction dredge or pump locations, including unnamed streams.

	Stream Name/ Water Source	NAD 83 Datum (approximate) Coordinates can be obtained using Alaska Mapper <a href="http://dnr.alaska.gov/mapper/controller">http://dnr.alaska.gov/mapper/controller</a>		MTRSC ¼ ¼ Ex: F001S001N01 SWSW	Check boxes to indicate type(s) of activity		
		Latitude ddd.mmmm	Longitude -ddd.mmmm		Crossing	Dredging	Water Intake
1.	Pedro	05.0097 N	<del>147</del> 147.9915 W	F 2W 1E 511	<input type="checkbox"/>	<input type="checkbox"/>	<input checked="" type="checkbox"/>
2.					<input type="checkbox"/>	<input type="checkbox"/>	<input type="checkbox"/>
3.					<input type="checkbox"/>	<input type="checkbox"/>	<input type="checkbox"/>
4.					<input type="checkbox"/>	<input type="checkbox"/>	<input type="checkbox"/>
5.					<input type="checkbox"/>	<input type="checkbox"/>	<input type="checkbox"/>

If in-stream activities and/or stream crossings are requested at more than 5 locations, please provide tabular data format (DNR template available at <http://dnr.alaska.gov/mlw/forms/?tab=mining>).

**WATER USE AUTHORIZATIONS**

Water usage (including from 100% recycle systems) may require approval by either Temporary Water Use Authorization or a Water Right. Information provided below will be used to determine the quantity of water that you may be authorized to use for your mining operation. When estimating water quantities, please estimate withdrawal amounts typical of a dry summer and provide the maximum quantity that you may withdraw from a particular source (e.g. stream, pond, groundwater, etc.) in a season.

A Temporary Water Use Authorization application may be initiated from this APMA application unless a Water Right is requested. Please contact the ADNR, Water Resources Section at telephone number (907) 451-2790 if interested in a Water Right or for more information.

**A. START-UP WATER AND MAKE-UP WATER:**

Is water withdrawn from any lake, stream, creek, river, etc. (does not include recycling/settling ponds)?  Yes  No

What is the name(s) of the lake, stream, creek, river, etc.? \_\_\_\_\_

What are the months of water use needed (for example May 1<sup>st</sup> through October 31<sup>st</sup>)? \_\_\_\_\_

**Start-up water:** Is water required at the start of the season to fill your recycle/settling pond system?

Yes (if **YES**, complete information below).  No If yes, what is the source name? \_\_\_\_\_

- Source:  Seepage infiltration from groundwater gained from cut and/or stream
- Diversion ditch from stream. Number of days diverting from stream for start-up water: \_\_\_\_\_
- Water intake rate: \_\_\_\_\_ gpm \_\_\_\_\_ hrs/day
- Pump from stream. Number of days pumping from stream for start-up water: \_\_\_\_\_
- Number of water pumps for start-up water: \_\_\_\_\_ Water intake rate (list for each pump): \_\_\_\_\_ gpm  
\_\_\_\_\_ hrs/day

**Make-up water:** Is water required to maintain water level in your recycle/settling pond system?

Yes (if **YES**, complete information below).  No If yes, what is the source name? \_\_\_\_\_

- Source:  Seepage infiltration from groundwater gained from cut and/or stream
- Ditch from stream. Number of days diverting from stream for make-up water: \_\_\_\_\_
- Water intake rate: \_\_\_\_\_ gpm \_\_\_\_\_ hrs/day
- Pump from stream. Number of days pumping from stream for make-up water: \_\_\_\_\_
- Number of water pumps for make-up: \_\_\_\_\_ Water intake rate (list for each pump): \_\_\_\_\_ gpm  
\_\_\_\_\_ hrs/day Pump intake size: \_\_\_\_\_ inches

**B. RECYCLE/SETTLING POND SYSTEM.**

Beaver ponds or other natural water features will not be permitted for use as settling ponds.

Is a pre-settling pond used?:  Yes  No Is recycle used?:  Yes  No

How many ponds are used in the recycle system? 2

Recycle pond is pond #: 2 Settling pond is pond #: 1

**C. RECYCLE/SETTLING POND SYSTEM (continued).**

Indicate Length (L), Width (W), and Depth (D) of each pond:

Pond # 1: L: 100 ft W: 40 ft D: 6' to 10' ft Pond # 2: L: 30 ft W: 15 ft D: 3' to 4' ft  
 Pond # 3: L: \_\_\_\_\_ ft W: \_\_\_\_\_ ft D: \_\_\_\_\_ ft Pond # 4: L: \_\_\_\_\_ ft W: \_\_\_\_\_ ft D: \_\_\_\_\_ ft  
 Pond # 5: L: \_\_\_\_\_ ft W: \_\_\_\_\_ ft D: \_\_\_\_\_ ft Pond # 6: L: \_\_\_\_\_ ft W: \_\_\_\_\_ ft D: \_\_\_\_\_ ft

Estimated hours per day that pump(s) will be used, return line size (in inches), operating pump rate (in gallons per minute), and water usage days per month:

Pump #1: \_\_\_\_\_ hrs/day \_\_\_\_\_ inches \_\_\_\_\_ gpm \_\_\_\_\_ days/month  
Pump #2: \_\_\_\_\_ hrs/day \_\_\_\_\_ inches \_\_\_\_\_ gpm \_\_\_\_\_ days/month  
Pump #3: \_\_\_\_\_ hrs/day \_\_\_\_\_ inches \_\_\_\_\_ gpm \_\_\_\_\_ days/month

**D. CAMP WATER USE.**

Is camp water used?  Yes  No

Maximum number of persons present in camp at a time \_\_\_\_\_

Camp water source:  Well  Haul  Stream  Spring  Lake

Name of water source (if any): \_\_\_\_\_

Camp pump intake diameter: \_\_\_\_\_ Camp pump rate: \_\_\_\_\_ gpm \_\_\_\_\_ hrs/day

**E. EXPLORATION ACTIVITIES.**

Is water required for exploration activities?  Yes  No

If **YES**, What types of exploration activities are being performed?  Trenching  Drilling

If **YES**, How many total pumps are used in the exploration activities? \_\_\_\_\_ (Max pumps per source).

Estimated hours per day that pump(s) will be used, return line size (in inches), operating pump rate (in gallons per minute), and water usage days per month: Pump #1: \_\_\_\_\_ hrs/day \_\_\_\_\_ inches \_\_\_\_\_ gpm \_\_\_\_\_ days/month

**A map of your requested drilling water sources is required with the following information:**

- MTRS sections,
- stream reaches or other water sources (please label, including take points if known)
- and drill hole locations

**F. SUCTION DREDGING.**

If suction dredging activity is occurring please ensure that you have completed the dredge table in Section (19) **MINING METHOD.**

**TIMBER CLEARING AND USE**  
**(Operations on State Lands Only)**

(25)

Pursuant to AS 38.05.255, timber from land open to *mining without lease*, except "timberland", may be used by a mining claimant or prospecting site locator for the mining or development of the location or adjacent claims under common ownership. Timber not used for the mining or development of the location or adjacent locations, that is removed from the operation must be acquired via timber sale or written letter of non-objection from the Alaska Division of Forestry.

On other lands ("timberlands" and in areas that are closed to mining without lease), timber cleared, used and/or removed must be acquired via a timber sale or a written letter of non-objection from the Alaska Division of Forestry.

Will timber be used for the mining or development of the location or lease?  Yes  No If yes, continue:

Describe the timbered area or areas to be cleared; include a map or drawing of the areas of timber to be cleared.

---

Describe the amount of timber to be used for the mining or development of the location or lease and the clearing methods you will use.

---

Are more than 40 acres of timbered area(s) to be cleared?  Yes  No

11 AAC 86.145. "A classification or designation indicating that timber and other forest products of significant value are included within a mining property is prima facie evidence that the land on which the property is located is considered to be "timberlands" for purposes of AS 38.05.255"

**WASTEWATER DISCHARGE PERMIT APPLICATION**

(26)

All mechanical placer mine, suction dredge, and mechanical dredge operations that discharge to a water of the U.S. require an Alaska Pollutant Discharge Elimination System (APDES) permit from DEC. See Cover Pages for a list of APDES permit fees.

Operations wishing to discharge under the APDES Small Suction Dredge General Permit (dredges with intake diameters of 6" or less, or highbankers) may skip this section but must complete annual online registrations, including \$25 fee payments, at <http://alaska.gov/go/2MPF>.

Previously issued DEC-APDES Wastewater discharge permit #: \_\_\_\_\_

Do you want this APMA to act as an application or renewal for any of the following APDES general permits (GPs)\*:

- Mechanical Placer Miners GP (open-cut terrestrial operations):  Yes  No
- Medium-Size Suction Dredge GP (nozzle diameter greater than 6" to 10"):  Yes  No
- Norton Sound Large Dredge GP (nozzle diameter greater than 10" or mechanical dredge):  Yes  No

Waterbody the discharge flows directly into, or would potentially flow: \_\_\_\_\_

Approximate coordinates of mine site:

Latitude: \_\_\_\_\_ Longitude: \_\_\_\_\_

Source (e.g., DNR - Alaska Mapper): \_\_\_\_\_

\*Mechanical placer operations that do not elect coverage under the Mechanical Placer Miners GP may be required to obtain coverage under the Multi-Sector General Permit for Storm Water. Contact DEC to terminate a permit.

**Optional\* - Mixing Zone Request or Termination for Mechanical Placer Mine Operations**

Do you wish to apply for a mixing zone and modified turbidity limit from DEC?  Yes  No

If a mixing zone is requested, provide the following

Coordinates of discharge location: Latitude: \_\_\_\_\_ Longitude: \_\_\_\_\_

Maximum Effluent Flow anticipated from your operation \_\_\_\_\_ (GPM) [must be greater than zero (0)].

Distance to nearest downstream drinking water source \_\_\_\_\_ and downstream placer mine \_\_\_\_\_

Do you wish to terminate an active authorized mixing zone?  Yes (APDES# \_\_\_\_\_)  No

\*A mixing zone authorizes an increase in the permit's turbidity limit based on available dilution from the surface water. Permittees without mixing zones must meet the water quality standard for turbidity at the point of discharge into the surface water.

**Certification Statement – applicable only to information required for DEC authorizations (required for all DEC permit or mixing zone applicants)**

I certify under penalty of law that this document and all attachments were prepared under my direction or supervision in accordance with a system designed to assure that qualified personnel properly gather and evaluate the information submitted. Based on my inquiry of the person or persons who manage the system, or those persons directly responsible for gathering the information, the information submitted is, to the best of my knowledge and belief, true, accurate, and complete. I am aware that there are significant penalties for submitting false information, including the possibility of fine and imprisonment for knowing violations.

Signature of Responsible Party: \_\_\_\_\_

Responsible Party Name (First Last, Position) - Printed: \_\_\_\_\_

Business Name (if applicable) - Printed: \_\_\_\_\_



SECTION 404 WETLANDS PERMIT

JURISDICTIONAL DETERMINATION (CORPS JD) and MITIGATION STATEMENT

All Placer Mining applicants are required to contact the Corps of Engineers for submittal requirements.

A complete application for a Department of the Army (DA), U.S. Army Corps of Engineers (Corps) Section 404 permit includes a description of project impacts (contained in the APMA), a Jurisdictional Determination (JD) and a Mitigation Statement. The applications for the JD and the Mitigation Statement are contained in two Corps Supplements, which may be attached to this APMA. The Supplements may be downloaded from the Corps and DNR websites, or obtained directly from a Corps office in paper copy, by email, or mail. Please contact the Corps to determine what supplements are required.

**Corps Supplement, Attachment 1, Jurisdictional Determination:** Attachment 1 must be filled in and submitted to the Corps for **all new placer applications (New and Existing Operations)**. Photos of your mine site are required. Your JD will be valid for five years. Your photos will be used only for the purpose of conducting an offsite JD.

**Corps Supplement, Attachment 2, Mitigation Statement:** Alaska District regional mitigation policy for placer mining operations under this General Permit (GP) emphasizes avoidance and minimization of impacts; **compensatory mitigation is not required**. However, by regulation, a Mitigation Statement covering measures for avoidance, minimization, and compensatory mitigation, or, a reason why compensatory mitigation is not proposed, must be submitted to the Corps with each new APMA for projects that impact waters of the U.S.

**Note:**

- If your APMA requires, but does not include a JD or Mitigation Statement, your application will be considered incomplete. The Corps may also contact you for additional information. Please ensure your contact information on the front page is current.
- For BLM Operators: A complete 404 Wetland Permit Package with additional photos of the upland areas to be mined will be sufficient to meet the requirement for the uplands reclamation baseline data and riparian mitigation measures as required by § 43 CFR 3809.

**Provide the Latitude and Longitude of the operation location (DD, NAD83):**

Latitude: \_\_\_\_\_ Longitude: - \_\_\_\_\_

Source (e.g., DNR - Alaska Mapper): \_\_\_\_\_

**Please list Corps permits previously issued for this site: POA- \_\_\_\_\_ - \_\_\_\_\_, POA- \_\_\_\_\_ - \_\_\_\_\_**

**Certification Statement**

The Alaska District will accept the APMA as a pre-construction notification, pursuant to 33 CFR 320.1 (c). Application is hereby made for a permit to authorize the work described in this APMA. I certify the information in the APMA, and any required Supplements, is complete and accurate. I future certify that I possess the authority to undertake the work described herein or am acting as the duly authorized agent of the operator/ applicant.

Operator or Agent:

Print Name

Signature

Date

STREAM DIVERSION

(28)

**A MAP OF COMPLETE STREAM DIVERSION IS REQUIRED:** Plan Map of Operation included in the APMA should show the entire length of the diversion (i.e. where the water is diverted from the natural stream channel to where it returns to the natural stream channel) with start and end locations clearly marked.

**Please note:** If you have a stream diversion structure; this structure may also qualify as a dam and be subject to the Alaska Department of Natural Resources Dam Safety Program per definitions provided in AS 46.17.900(3), Complete Section 22 (regarding a Dam) of this APMA. If you require further regulatory guidance regarding dams, please contact our Dam Safety and Construction Unit, Dam Safety Engineer at telephone number 907-269-8636 or for more information go to the Alaska Dam Safety Program website at: <http://dnr.alaska.gov/mlw/water/dams/>

**Is stream diversion required?**  Yes (if **YES**, complete information below).  No

Stream Name: \_\_\_\_\_

Existing (Date Constructed \_\_\_\_\_)  To Be Constructed (Date \_\_\_\_\_)

**If a diversion is required or pre-existing, please contact your local ADF&G, Habitat Section for Fish Habitat Permitting information. To facilitate permit issuance, please provide the following information:**

Is Stream Diversion?  Permanent  Temporary \_\_\_\_\_ year(s) \_\_\_\_\_ months

Will diversion be reclaimed annually prior to freeze-up or be retained throughout the mine life?

Annually reclaimed/returned to natural stream  Maintained throughout mine life

Dimensions of existing stream in diversion area:

Length \_\_\_\_\_(ft) Top Width\_\_\_\_(ft) Bottom Width\_\_\_\_(ft) Depth\_\_\_\_(ft) Floodplain Width\_\_\_\_(ft)

Dimensions of proposed diversion:

Length \_\_\_\_\_(ft) Top Width\_\_\_\_(ft) Bottom Width\_\_\_\_(ft) Depth\_\_\_\_(ft) Floodplain Width\_\_\_\_(ft)

Dominant substrate type (Choose Two): Bedrock Boulder Cobble Gravel Sand Silt/Clay

Note: Diversion should approximate the existing stream in terms of meander bends, length, depth, stream width, and floodplain width.

**(Please provide plan and profile diagrams of diversion in Section 29, PLAN MAP OF OPERATION) or attach additional sheets as necessary**



# APMA 9157 Claim Status Map

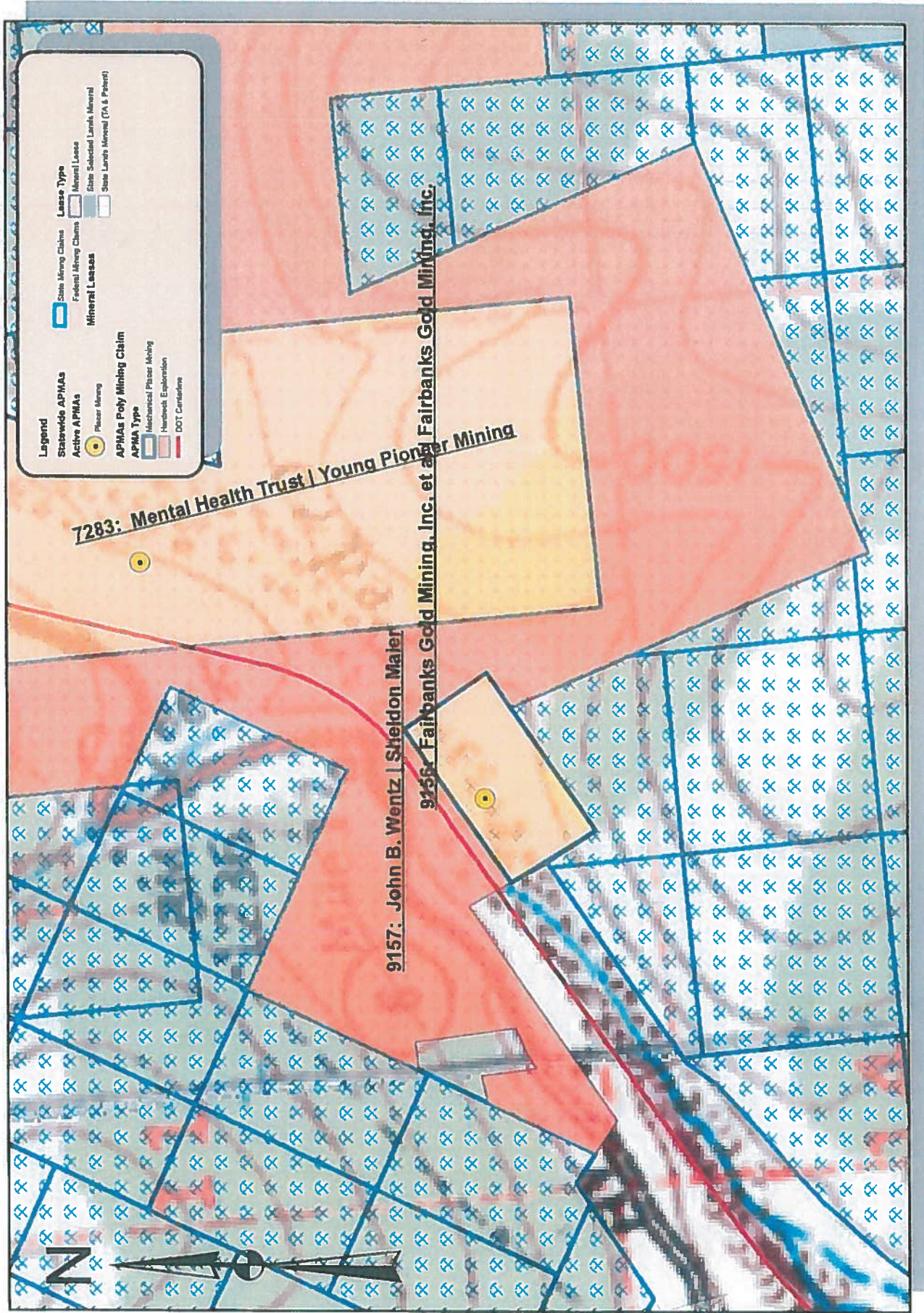

PLAN MAP OF OPERATION \*REQUIRED

(29)

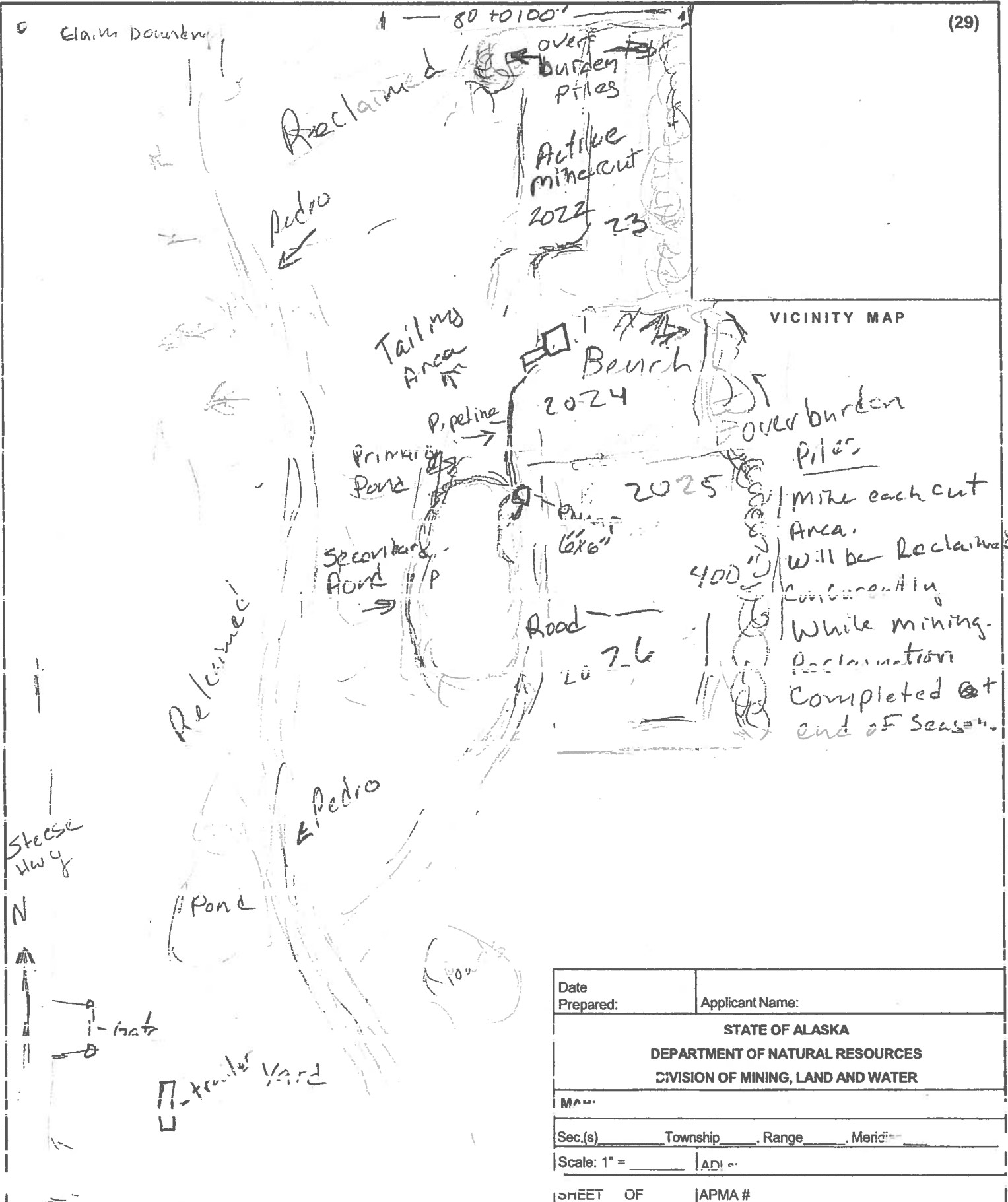

VICINITY MAP

Date Prepared:	Applicant Name:
STATE OF ALASKA DEPARTMENT OF NATURAL RESOURCES DIVISION OF MINING, LAND AND WATER	
Map:	
Sec(s)	Township
Range	Merid:
Scale: 1" =	ADP:
SHEET OF	APMA #

(Attach additional sheets, along with detailed explanations as necessary)



CROSS SECTION SKETCH \*REQUIRED

BEFORE ACTIVITY

(30)

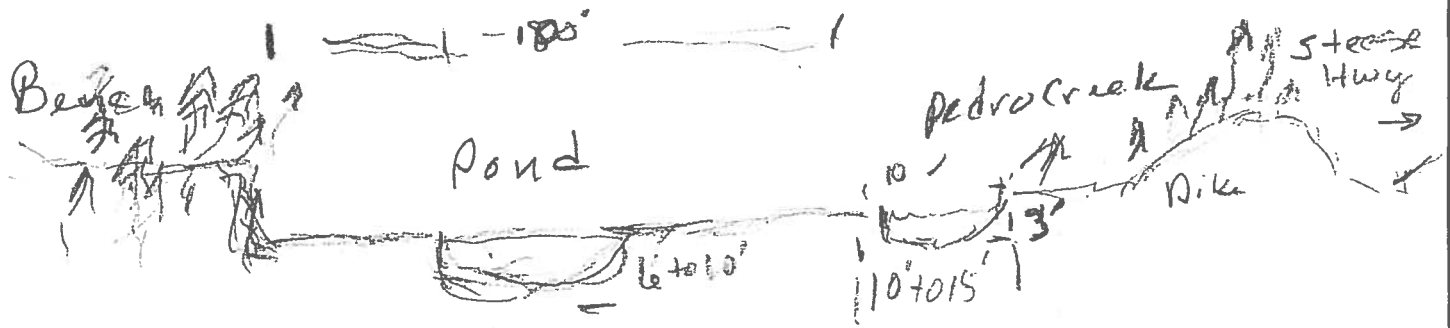

DURING ACTIVITY

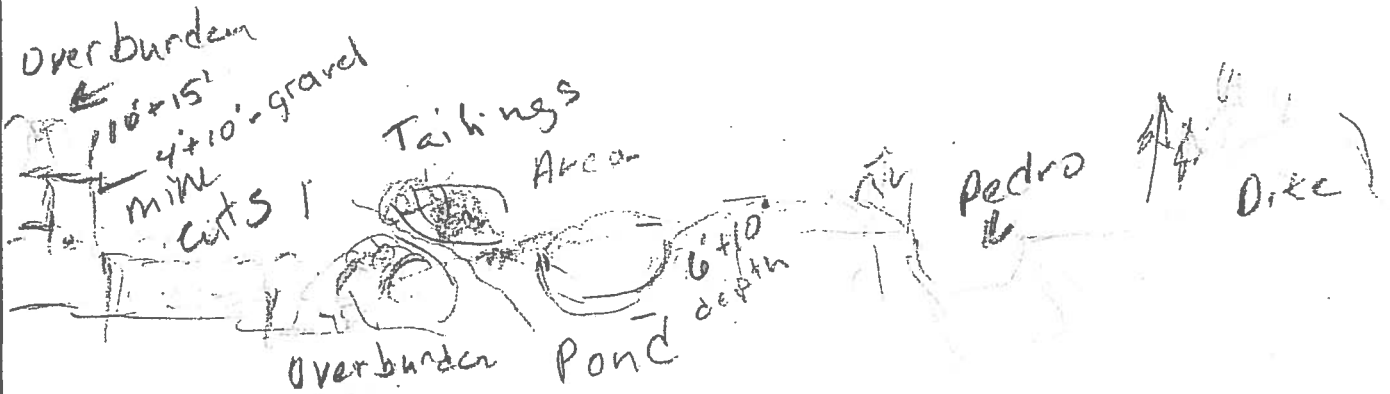

AFTER ACTIVITY

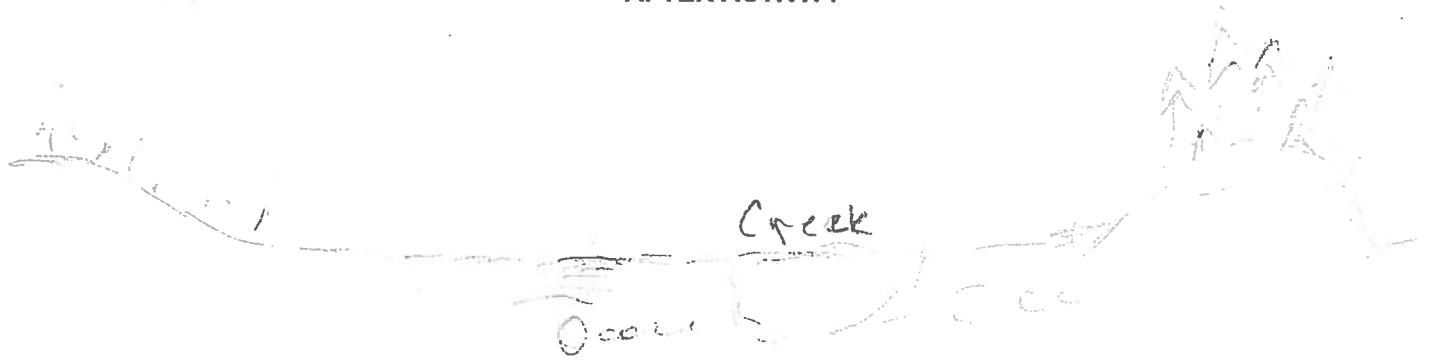

Date Prepared:	Applicant Name:
STATE OF ALASKA DEPARTMENT OF NATURAL RESOURCES DIVISION OF MINING, LAND AND WATER	
MAP:	
Sec.(s) _____ Township _____, Range _____, Meridian _____	
Scale: 1" = _____	ADLs:
SHEET OF _____	APMA # _____

PLACER/SUCTION DREDGE NARRATIVE \*REQUIRED

(31)

A narrative of the operation is required. Please use this space to describe the access, mining process, environmental protection measures and reclamation measures to be used for the duration of this permit. Use multiple sheets if necessary.

**DESCRIBE ACCESS, PERSONNEL HOUSING AND CAMP LAYOUT:**

Access is directly off Steese Hwy. No employees or extra personnel. Self contained travel trailer for office & toilet.

**DESCRIBE PROGRESSIVE STEPS OF MINING METHOD:**

Remove previously disturbed overburden / uncover gravel. remove top gravel sluice / Finish sluice Reclaim during season as I move along stripped area. ~~Reclamation completed at end of season~~

**DESCRIBE PLANNED RECLAMATION MEASURES INCLUDING TIMELINE FOR RECLAMATION TO TAKE PLACE:**

Reclamation will be both concurrent than finished at the end of season. Transplant trees and after contouring and spreading top soil and moss, Tundra ect.

**DISCUSS WATER MANAGEMENT PLANS, INCLUDING USE, SOURCE, QUANTITY AND SURFACE WATER/ EROSION MANAGMENT PLAN:**

Everything runs into the ponds.

**DISCUSS FUEL STORAGE, HANDLING, AND SPILL PREVENTION AND RESPONSE PLANS:**

No onsite storage of fuel.

**DISCUSS HOW THE OPERATION WILL AVOID/MITIGATE POTENTIAL IMPACTS TO FISH, WILDLIFE AND CULTURAL RESOURCES:**

There are no fish in upper Pedro

2020 ANNUAL RECLAMATION STATEMENT

(32)

- Placer Mining
- Suction Dredging
- Hardrock Exploration

APMA # 9157

Complete and return this statement by December 31, 2020. If you did not operate, fill in your name, check bottom box, sign, and return form.

In accordance with AS 27.19 (Reclamation Act):

I, Sheldon Mager hereby file an annual reclamation statement for the 2020 mining operation described in subject Application for Permits to Mine in Alaska. (Submission of this statement does not constitute reclamation approval.)

Volume of material disturbed in 2020: 20-30K cubic yards (Includes strippings and processed material.)

Sluice days last season: ~~30~~<sup>45</sup> Cubic yards of material processed daily: \_\_\_\_\_ Annually: 5300

Total acreage disturbed in 2020: State X, Federal \_\_\_\_\_, Private \_\_\_\_\_. (Includes stripped areas, mining cuts, overburden and tailing stockpiles and disposal areas, temporary stream diversions, stream bypasses, and settling ponds.) Federal operators should include area of camp and access roads.

Length \_\_\_\_\_ feet and Width \_\_\_\_\_ feet of stream diversion.

Stream diversion:  Temporary  Permanent  No Diversion (check one).

Total Area reclaimed in 2020: 2<sup>+2.5</sup> acres.

Total un-reclaimed acres: 2 (This should match "total acreage currently disturbed" on the 2021 Reclamation Plan Form.)

For areas reclaimed, the following reclamation measures were used (check only measures that were used).

**You must include photographs or videotapes of the completed reclamation work:**

- Spread and contoured tailings
- Spread topsoil, vegetation, overburden muck or fines on the surface of contoured tailings
- Reestablished flood plain with stream channel in stable position
- Ponds are reclaimed
- Backfilled and reclaimed temporary stream diversions
- Camp removed, cleaned up and left free of debris
- Hardrock Exploration: Complete and submit an electronic Annual Reclamation Report

Other Reclamation Measures Taken:

Empty rectangular box for other reclamation measures.

Did not operate in 2020 and therefore did not conduct reclamation.

Relationship to Claim(s)

Owner  Lessee  Operator

Agent For: \_\_\_\_\_

Signed [Signature] Date 11/30/21

**2021 RECLAMATION PLAN FORM (PLACER EXPLORATION OR MINING)**

<input type="checkbox"/> <b>A. RECLAMATION PLAN</b> (REQUIRED if the operation will disturb five or more acres this year, OR 50,000 cubic yards, OR if the operation has a cumulative disturbed area of five or more acres).	<input type="checkbox"/> <b>B. RECLAMATION PLAN VOLUNTARY</b> (for an operation below limits shown in Box A but wanting to qualify for the statewide bonding pool. (Operations on BLM Lands and others not filing Letter of Intent).	<input checked="" type="checkbox"/> <b>C. LETTER OF INTENT</b> <span style="float: right;">(33)</span> (less than five acres to be disturbed AND less than 50,000 cubic yards AND less than five acres unreclaimed area).
---------------------------------------------------------------------------------------------------------------------------------------------------------------------------------------------------------------------------------	-----------------------------------------------------------------------------------------------------------------------------------------------------------------------------------------------------------------------------------------	------------------------------------------------------------------------------------------------------------------------------------------------------------------------------------------------------------------------------

In accordance with Alaska Statute 27.19, reclamation is required of all mining operations. Reclamation bonding is required of operations with disturbance of 5 acres or greater. Completion of this application will meet the requirements for a "Reclamation Plan" for operations 5 acres and larger in size and for a "Letter of Intent To Do Reclamation" for operations under 5 acres. If you do not intend to use the reclamation methods presented below, you must provide additional information concerning your plans for reclamation under separate attachments.

Total acreage currently disturbed: 2 acres. This should match: "Total Unreclaimed Acres" on your 2020 Annual Reclamation Statement for Small Mines, or line #7 on your 2021 Bond Pool Renewal Form. Disturbed ground includes all unreclaimed mining and exploration activity (excluding camps and roads) since October 1991. Federal operators must include areas of camps and roads.

New acres to be disturbed in 2021 2 acres. Total acreage (currently disturbed plus new acres): 4 acres.

Acreage disturbed by land status: 4 State (general) \_\_\_\_\_ State (Mental Health) \_\_\_\_\_ Private \_\_\_\_\_ Federal \_\_\_\_\_

Total acreage to be reclaimed in 2021: 2 acres; Total volume of material to be disturbed in 2021: 30K cubic yards.

Include strippings and overburden to be removed. Cubic yards = Length (yards) x Width (yards) x Depth (yards).

Reclamation will be conducted concurrently with activity.  Reclamation will be conducted at the end of the season.

**THE FOLLOWING RECLAMATION MEASURES SHALL BE USED:**

(These measures are required by law. Those that do not apply may be crossed out; but, an explanation must be given as to why these measures are not necessary at your site.)

- Topsoil, vegetation, and overburden muck, not promptly redistributed to an area being reclaimed, will be individually separated and stockpiled for future use. This material will be protected from erosion and from contamination by acidic or toxic materials and will not be buried by tailings.
- The area reclaimed will be reshaped to blend with the surrounding area using tailings, strippings, and overburden and be stabilized.
- Stockpiled topsoil, overburden muck, will be spread over the contoured exploration sites to promote natural plant growth such that the area can reasonably be expected to revegetate within five years. Stockpiled vegetation will be spread over topsoils.
- Settling ponds located within the active flood plain and necessary for continued use during the next mining season will be protected from erosion or the fines removed.
- If the mining operation diverts a stream channel or modifies a flood plain to the extent that the stream channel is no longer stable, the stream channel will be reestablished in a stable location in the valley flood plain.
- The flood plain will be established as appropriate to accommodate seasonal high-water flood events and prevent undue erosional degradation.
- Exploration trenches will be backfilled. Brush piles, stumps, topsoil, and other organics will be spread on the backfilled surface to inhibit erosion and promote natural revegetation.
- Shallow auger holes (limited to depth of overburden) will be backfilled with drill cuttings or other locally available material in such a manner that closes the hole to minimize the risk to humans, livestock and wildlife.
- At placer drift mine closure, all mine shafts, adits, tunnels, and air vents to underground workings will be stabilized and properly sealed to ensure protection of the public, wildlife, and the environment.
- On state lands; all buildings and structures constructed, used or improved will be removed, dismantled, or otherwise properly disposed of unless the surface owner or manager authorizes that the buildings and structures may stay.
- On state lands; all scrap iron, equipment, tools, piping, hardware, chemicals, fuels, waste, and general construction debris will be removed or properly disposed of.
- Reclamation measures taken will be consistent with any alternate post mining land use approved by the Commissioner, subject to the provisions of 11 AAC 97.300(h) and the conditions (if any) of an approved reclamation plan.

**IMPORTANT:** 1. Alternative reclamation measures may be approved if the reclamation measures presented above are not applicable to your site. Please explain in separate correspondence. Submit a sketch and describe additional reclamation measures you propose to conduct at your operation. Reclamation measures must comply with AS 27.19.

**BONDING:** In accordance with AS 27.19, bonding is required for all operations having a mined area of greater than or equal to five acres on State Land. This area must be bonded for \$750.00 per acre, unless the miner can demonstrate that a third party contractor can do the needed reclamation for less. The Statewide Bonding Pool may be joined by completing a bond pool application form and meeting certain requirements. No reclamation plan approval goes into effect until the bonding pool deposit and annual nonrefundable fees are paid. Use bond form to calculate area of disturbance for bonding.

BLM requires that a reclamation plan be consistent with §43 CFR 3809.420, Performance Standards for the Surface Management regulations for Federal Operations. Refer to 43 CFR 3809 or the BLM minerals website available at <https://www.blm.gov/programs/energy-and-minerals/mining-and-minerals> for more information on what is needed for a reclamation plan on Federal lands, as they may be different than those identified above.

<p><u>Sheldon Maier</u> Printed name (Applicant)</p> <p><u>[Signature]</u> Signature (Applicant)</p>	Relationship to Mineral Property: <input type="checkbox"/> Owner <input type="checkbox"/> Lessee <input checked="" type="checkbox"/> Operator <input type="checkbox"/> Agent For: _____	Date: <u>11/30/21</u> APMA #: <u>9157</u>
--------------------------------------------------------------------------------------------------------------	-----------------------------------------------------------------------------------------------------------------------------------------------------------------------------------------------	----------------------------------------------



**NOTICE OF OPERATOR AUTHORIZATION -- MINERAL LOCATIONS**

All operators or lease holders submitting APMAs for operations on mineral locations must submit a "Notice of Authorization" from the owner of record. This notice of authorization must name the operator and leaseholder (if different), the mineral properties by their designation (e.g.; ADL, AKFF, USMS, MTRS) and the time frame (beginning and ending dates) for which the authorization remains in effect. The Division of Mining, Land & Water will only issue a mining authorization for private land, per 11 AAC 97.310.(7), after notarized receipt of this Notice. **Please include it with your APMA.**

**OPERATOR AUTHORIZATION**

APMA# \_\_\_\_\_

I, <u>John Wentz</u> , OWNER of mineral property(s): List all mineral properties by their casefile number (ADL/AKFF/USMS) or legal description (MTRS). <u>ADL 500420</u> _____ _____ (Attach additional sheet if necessary) Have authorized <u>ALASKA GOLDMINE LLC (Sheldon Mairer)</u> Address of Operator _____ to operate on these claims from <u>12 / 10 / 2021</u> to <u>12 / 31 / 2026</u> Owner's Signature _____ Date <u>12/10/2021</u>	Check Type of Mineral Property(s) <input checked="" type="checkbox"/> State ADL <input type="checkbox"/> Federal AKFF/AKAA <input type="checkbox"/> USMS <input type="checkbox"/> MTRS (Native Lands)
----------------------------------------------------------------------------------------------------------------------------------------------------------------------------------------------------------------------------------------------------------------------------------------------------------------------------------------------------------------------------------------------------------------------------------------------------------------------------	-------------------------------------------------------------------------------------------------------------------------------------------------------------------------------------------------------------------

**NOTARY**  
 Subscribed and sworn to before me this 10<sup>th</sup> day of Dec, 2021.  
 For (owner)  
 (Signature of Notary) David L. Charron  
 My commission expires: with office



**OR** (If the LESSEE and OPERATOR are not the same, both sections must be completed)

I, _____, LESSEE of mineral property(s): List all mineral properties by their casefile number (ADL/AKFF/USMS) or legal description (MTRS). _____ _____ (Attach additional sheet if necessary) have authorized _____ to operate on these claims from ____ / ____ / ____ to ____ / ____ / ____. Lessee's Signature _____ Date _____ Lessee's Address _____	Check Type of Mineral Property(s) <input type="checkbox"/> State ADL <input type="checkbox"/> Federal AKFF/AKAA <input type="checkbox"/> USMS <input type="checkbox"/> MTRS (Native Lands)
-------------------------------------------------------------------------------------------------------------------------------------------------------------------------------------------------------------------------------------------------------------------------------------------------------------------------------------------------------------------------------	--------------------------------------------------------------------------------------------------------------------------------------------------------------------------------------------------------

**NOTARY:**  
 Subscribed and sworn to before me this \_\_\_\_ day of \_\_\_\_\_, 20 \_\_\_\_.  
 For (Lessee)  
 (Signature of Notary) \_\_\_\_\_  
 My commission expires: