

SHEET INDEX

Sheet 2	Portion Tracts D, F
Sheet 3	Portion Tracts D, F and Tracts A, B, C & E
Sheet 4	Portion Snowfence Easement and History of Surveys
Sheet 5	Portion Tracts D, F, G and History of Surveys
Sheet 6	Portion Tracts F, G, J and Tracts I, H, K, Public Access Easement
Sheet 7	Portion Tracts F, J, N and Tracts L, M, Lots 3D-1, 3D-2, 4A-1, 4A-2, 4A-3, 5A and 5B, Public Utility Easement
Sheet 8	Portion Tracts F, N and History of Surveys
Sheet 9	Portion Tracts F, N and History of Surveys
Sheet 10	Portion Tracts F, Q, R and Tracts O, P
Sheet 11	Portion Tracts Q, R, T, U and Tract S
Sheet 12	Portion Tracts T, U, Waterline Easement
Sheet 13	Portion Tracts T, U, Waterline Easement
Sheet 14	Portion Tracts T, U, Waterline Easement
Sheet 15	Portion Tracts T, U, Waterline Easement
Sheet 16	Portion Snowfence Easement
Sheet 17	Tract V
Sheet 18-23	Recovered Monuments

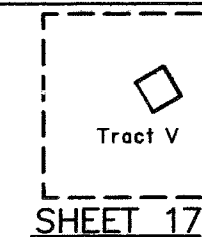

ALASKA NATIVE CLAIMS SETTLEMENT ACT
(ANCSA) SECTION 14(c), TRACTS A THROUGH U,
LOTS 3D-1, 3D-2, 4A-1, 4A-2 4A-3, 5A, 5B,
P.L. 92-203 (85 STAT. 688, 702, 703)
SHAKTOOLIK NATIVE CORPORATION
AT
SHAKTOOLIK, ALASKA

This plat, in 23 sheets, contains the entire survey record.

The history of surveys is listed on sheets 4, 5, 8 and 9.

This survey was executed by Douglas F. Popham, Registered Alaska Land Surveyor No. 10161, and Certified Federal Surveyor No. 1245, for Shaktoolik Native Corporation, June 5, 2010 through June 17, 2010, in accordance with the specifications set forth in the Manual of Instructions for the Survey of the Public Lands of the United States, 2009, Special Instructions dated April 27, 2009, approved May 22, 2009, amended May 14, 2010, approved May 19, 2010 under Contract LIOAV20000, awarded June 3, 2010, Assignment Instructions dated June 3, 2010, and Notice to Proceed dated June 3, 2010.

Field Assistants were:

Michael P. Frame, Land Surveyor
Thomas L. Willefs, Party Chief
William A. McClintock, Party Chief
Eric M. Katchatag, Survey Technician
Myron P. Savetilik, Survey Technician

Area Surveyed: 159.67 Acres

The azimuth was established using Global Satellite Positioning Systems (GPS/Glonass) and refers to the true meridian.

The geographic position of the Southerly corner of Lot 4A-1, centrally located within this survey, and within Section 23, Township 13 South, Range 13 West, Kateel River Meridian, Alaska, in NAD83 (CORS96), epoch 2003.00, as determined by GPS observation utilizing the National Geodetic Survey Online Positioning User Service (OPUS), to a Network Accuracy with a maximum peak-to-peak separation for each component of the computed position, of less than 0.05 meter, as defined in the Bureau of Land Management's Standards for the Positional Accuracy of Cadastral Surveys When Using Global Navigational Satellite Systems (GNSS), dated February 23, 2009, is:

Latitude: 64° 21' 13.041" North (NAD 83)
Longitude: 161° 11' 34.538" West

The corner positions for this survey were determined using Static Relative Positioning techniques.

The mean magnetic declination was computed using the U.S. Geological Survey Geomagix software program and database file, igrfl.co

This survey is located in and around the village of Shaktoolik, Alaska within protracted Sections 14, 15, 23-26, Township 13 South, Range 13 West, and Section 7, Township 13 South, Range 12 West, Kateel River Meridian, Alaska.

The land is a predominantly level sand and gravel spit along the shore of Norton Sound with little vegetation other than beach grass and scattered willow.

The soil is sandy gravel with a few areas of silty sand and peat.

UNITED STATES DEPARTMENT OF THE INTERIOR
BUREAU OF LAND MANAGEMENT
Anchorage, Alaska

The survey represented by this plat, sheets 1 through 23, having been properly executed and examined, is hereby accepted for having fulfilled the requirements of Section 14(c) of the Alaska Native Claims Settlement Act.

For the Director

JUNE 21, 2012
Date

Chief Cadastral Surveyor for Alaska

Sec. 10

Sec. 11

Sec. 14

Sec. 15

SHEET 2

SHEET 4

SHEET 3

SHEET 16

SHEET 5

SHEET 6

SHEET 7

SHEET 8

SHEET 9

SHEET 10

SHEET 11

SHEET 12

SHEET 13

SHEET 14

SHEET 15

NORTON SOUND

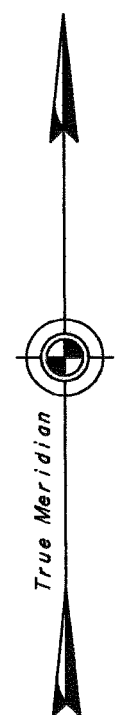

Mean
Magnetic
Declination
14 1/2° E.

EV-3-325 LEGEND

Portion Of Record Boundary Line
To Be Eliminated

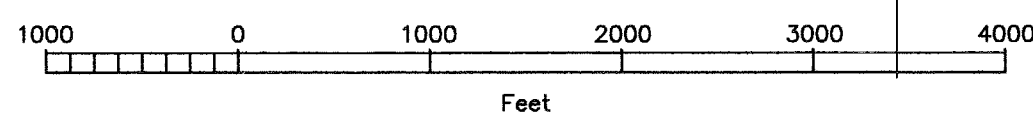

I hereby certify, upon honor, that the parcels created by this plat of survey, sheets 1-23, are on lands interim conveyed to Shaktoolik Native Corporation by Interim Conveyance No. 719, dated September 26, 1983, issued by the United States of America; said tracts also fulfill all entitlements under the provisions of ANCSA 14(c) as requested by Shaktoolik Native Corporation Resolution No. 05-01 and Shaktoolik Native Corporation ANCSA 14(c) Map of Boundaries accepted May 25, 2006.

6-13-12
Date

Eugene Prichard
President
Shaktoolik Native Corporation

NOME 2012-5

Sec. 25

SHAKTOOLIK, ALASKA

REFERENCE SHOULD BE MADE
TO
SHEET I
FOR SURVEY INFORMATION

- ☒ ANCSA Primary Monument Set This Survey
- ☐ Secondary Monument Set This Survey
- ☐ Monument Recovered This Survey
- ☒ Set Monument Designator

☐ Recovered Monument Designator
See Sheet 23 for descriptions

Refer to Sheet 2

**Portion Of Record Boundary Line
To Be Eliminated**

Primary: Set a stainless steel post, 28 ins. long, 2 1/2 ins. diameter, 25 to 28 ins. in the ground, with a magnet in a white plastic case at its base, and a brass cap marked as shown.

Secondary: Set 2 ins. aluminum cap on a 5/8 in. x 30 ins. pointed rebar, 28 ins. in the ground.

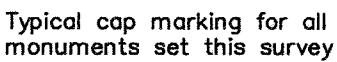

Cap	Marking	Accessory	Bears	Dist.(ft.)
S53	TR O TR Q	NONE		
S54	TR O TR Q	NONE		
S55	TR Q TR P	NONE		
S56	TR P TR Q TR F	NONE		
S57	TR P TR F	NONE		
S58	TR F TR Q	NONE		
S59	TR F TR Q	NONE		
S60	TR F TR Q TR R	NONE		
S61	WC TR F MC TR R	NONE		