

SECTION 23
T. 13 S., R. 13 W.
KATEEL RIVER MERIDIAN ALASKA
INTERIM CONVEYANCE NO. 719
SHAKTOOLIK NATIVE CORPORATION

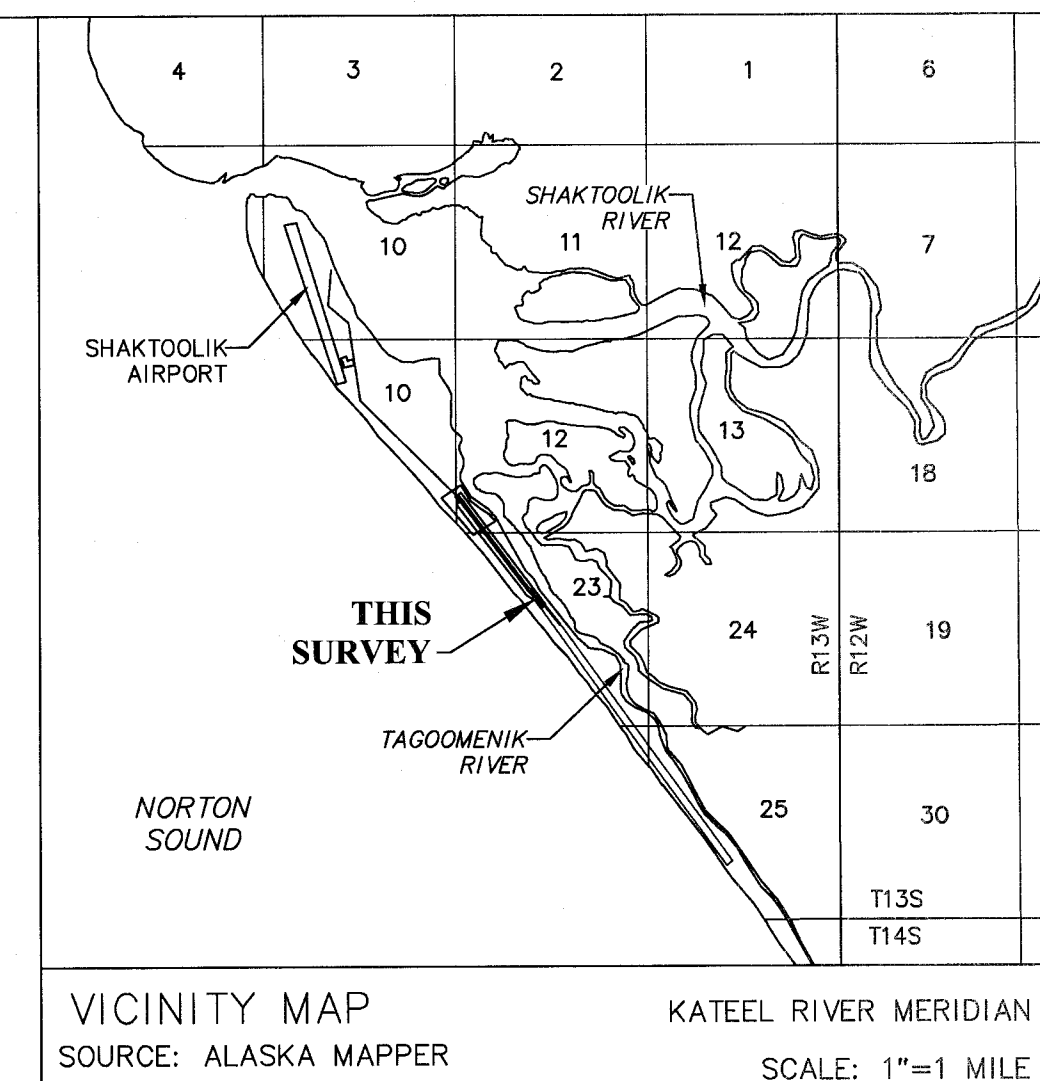

Portion Of Record Boundary Line To Be Eliminated

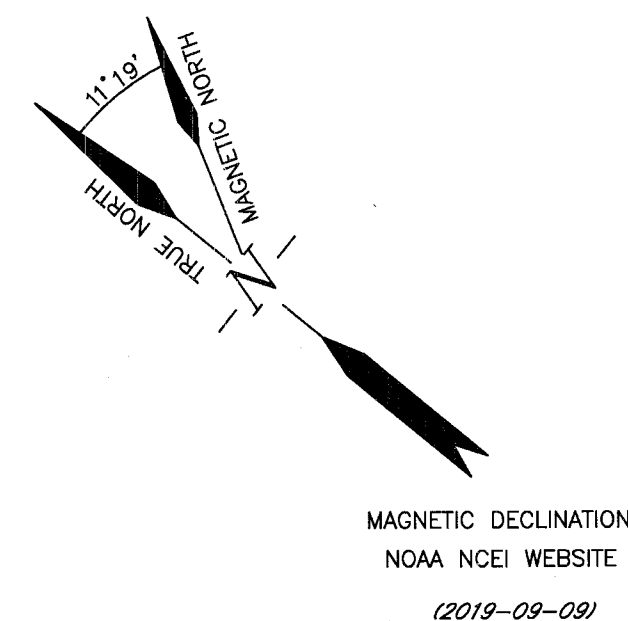
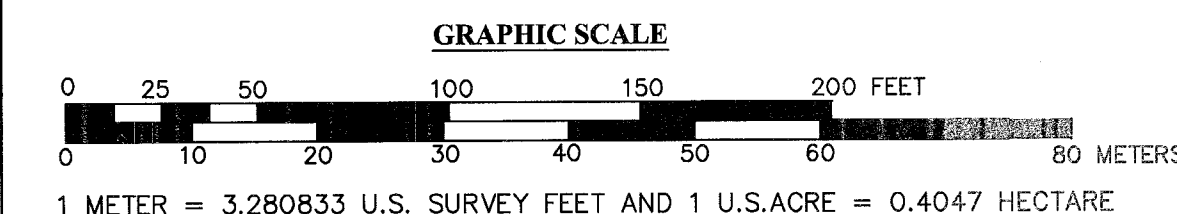
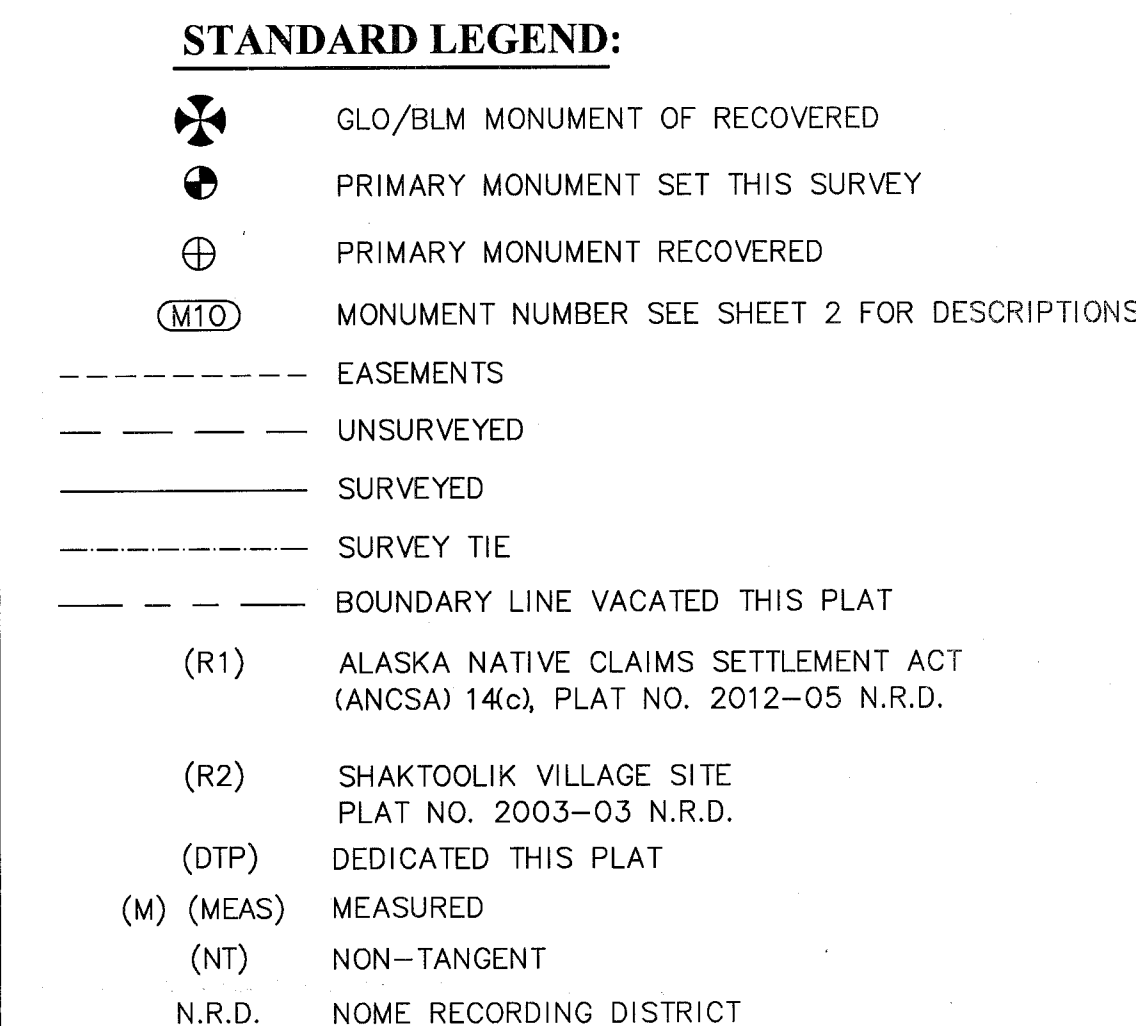

DETAIL A SCALE 1" = 20'

CURVE TABLE					
CURVE NO.	LENGTH	RADIUS	DELTA	CHORD BEARING	DISTANCE
C1	179.52	675.00	15° 14' 17"	N47° 11' 09"W	178.99
C2	113.50	775.00	8° 23' 26"	N50° 36' 34"W	113.39
C3 (M)	99.88	725.00	7° 53' 36"	N50° 51' 30"W	99.80
C3 (R1)	99.83	725.00	7° 53' 23"	N50° 49' 42"W	99.76
C4 (M) (NT)	144.73	725.00	11° 26' 16"	N49° 02' 17"W	144.49
C4 (R1)	144.65	725.00	11° 25' 55"	N49° 03' 26"W	144.41
C5 (M) (NT)	47.79	725.00	3° 46' 37"	N41° 25' 51"W	47.78
C5 (R1)	47.87	725.00	3° 46' 59"	N41° 26' 59"W	47.86

I HEREBY CERTIFY THAT I AM PROPERLY REGISTERED AND LICENSED TO PRACTICE LAND SURVEYING IN THE STATE OF ALASKA, THAT THIS PLAT REPRESENTS A SURVEY MADE BY ME OR UNDER MY DIRECT SUPERVISION, THAT THE MONUMENTS SHOWN HEREON ACTUALLY EXIST AS DESCRIBED, AND THAT ALL DIMENSIONS AND OTHER DETAILS ARE CORRECT.

DATE _____

BRADFORD W. WATTS, LS-12319
PROFESSIONAL LAND SURVEYOR



PRELIMINARY

DRAWN BY: <u>BWW</u>		DATE OF SURVEY: BEGINNING: <u>9/11/2019</u>	
DATE: <u>11/05/2019</u>		ENDING: <u>9/12/2019</u>	
SHEET: <u>1 OF 2</u>	SCALE: <u>1"=100'</u>	CHECKED: <u>AJR</u>	DNR FILE NO.

RECEIVED
NOV - 7 2019
By

CERTIFICATE OF OWNERSHIP AND DEDICATION

I, THE UNDERSIGNED, CERTIFY THAT SHAKTOOLIK NATIVE CORPORATION IS THE OWNER OF TRACT F AND TRACT Q, A.N.C.S.A 14(C), PLAT 2012-05, AS SHOWN ON THIS PLAT. ON BEHALF OF SHAKTOOLIK NATIVE CORPORATION, I APPROVE THIS SURVEY AND PLAT AND DEDICATE OR RESERVE FOR PUBLIC OR PRIVATE USE, AS NOTED, ALL EASEMENTS, PUBLIC UTILITY AREAS, AND RIGHTS-OF-WAY AS SHOWN AND DESCRIBED HEREON AND ACCEPT.

I ALSO CERTIFY THAT THE LAND DEDICATED FOR PUBLIC USE DOES NOT CONTAIN CLAIMS UNDER SECTION 14(C)(1) & (2) OF THE ALASKA NATIVE CLAIMS SETTLEMENT ACT.

TONIA SAGOONICK, GENERAL MANAGER
SHAKTOOLIK NATIVE CORPORATION
PO BOX 46
SHAKTOOLIK, AK 99771

NOTARY'S ACKNOWLEDGEMENT

SUBSCRIBED AND SWORN TO BEFORE ME THIS DAY OF 20

BY

NOTARY PUBLIC FOR ALASKA
MY COMMISSION EXPIRES

ACCEPTANCE OF DEDICATION

THE MAYOR HEREBY ACCEPTS FOR PUBLIC USES AND FOR PUBLIC PURPOSES THE REAL PROPERTY DEDICATED TO THE PUBLIC BY THIS PLAT INCLUDING EASEMENTS, RIGHTS-OF-WAY, ALLEYS, AND ROADWAYS SHOWN ON THIS PLAT. THE ACCEPTANCE OF LANDS FOR PUBLIC USE OR PUBLIC PURPOSE DOES NOT OBLIGATE THE PUBLIC OR ANY GOVERNING BODY TO CONSTRUCT, OPERATE OR MAINTAIN IMPROVEMENTS.

MAYOR
CITY OF SHAKTOOLIK
PO BOX 10
SHAKTOOLIK, AK 99771

NOTARY'S ACKNOWLEDGEMENT

SUBSCRIBED AND SWORN TO BEFORE ME THIS DAY OF 20

BY

NOTARY PUBLIC FOR ALASKA
MY COMMISSION EXPIRES

PLAT APPROVAL

THIS PLAT IS APPROVED BY THE COMMISSIONER OF THE DEPARTMENT OF NATURAL RESOURCES, OR THE COMMISSIONER'S DESIGNEE, IN ACCORDANCE WITH AS 40.15.

COMMISSIONER DATE

TAX CERTIFICATE

THIS SUBDIVISION LIES OUTSIDE OF ANY TAXING AUTHORITY, AT THE TIME OF FILING.

RECOVERED MONUMENTS:

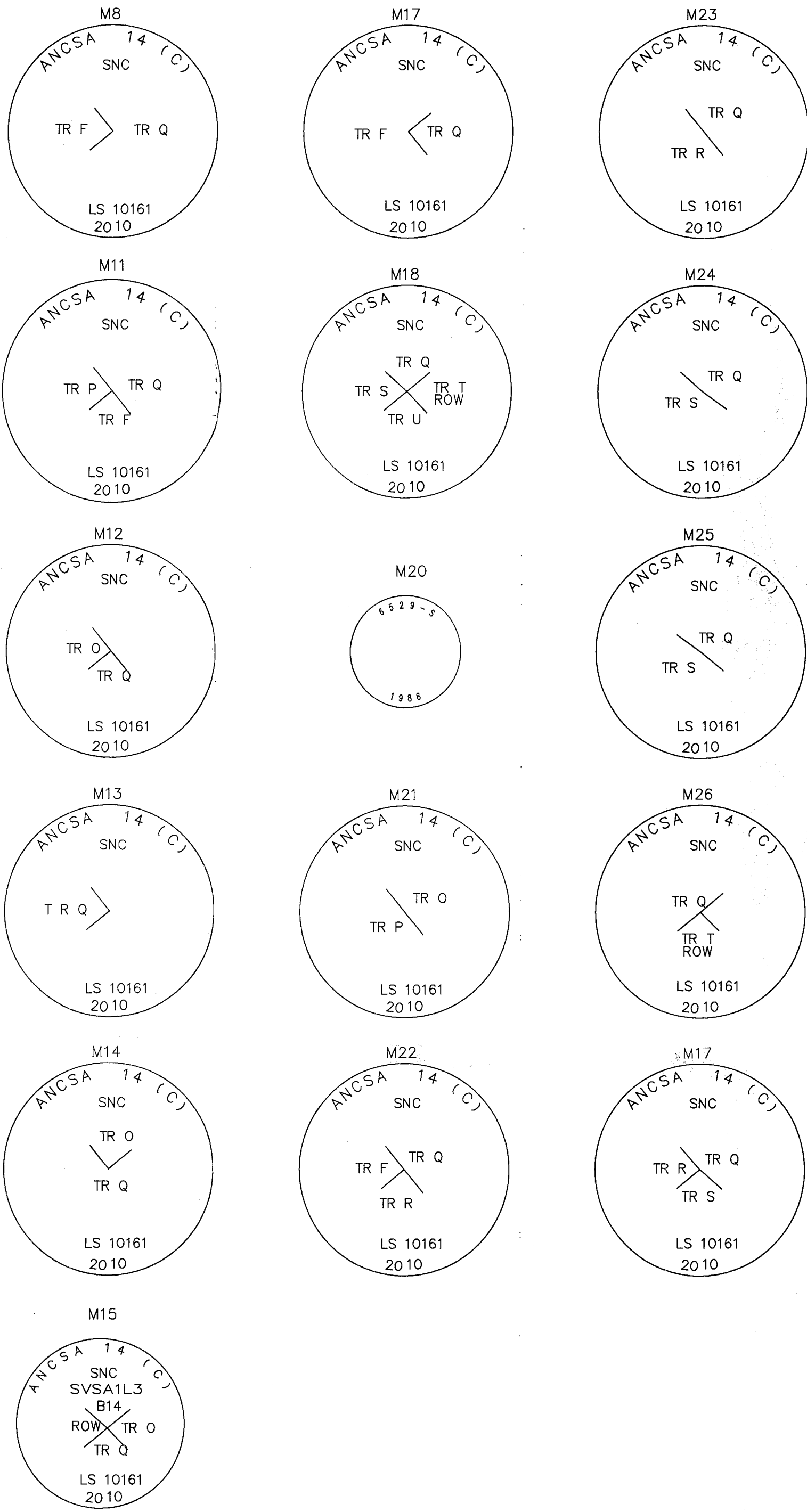

SET MONUMENT DATA	
MONUMENT	DESCRIPTION
M101	SET A 5/8" X 24" REBAR WITH 2" ALUMINUM CAP, FLUSH WITH SURFACE.
M102	SET A 5/8" X 24" REBAR WITH 2" ALUMINUM CAP, FLUSH WITH SURFACE.
M103	SET A 5/8" X 24" REBAR WITH 2" ALUMINUM CAP, 0.2' BELOW SURFACE.
M104	SET A 5/8" X 24" REBAR WITH 2" ALUMINUM CAP, 0.2' BELOW SURFACE.
M105	SET A 5/8" X 24" REBAR WITH 2" ALUMINUM CAP, 0.1' BELOW SURFACE.
M106	SET A 5/8" X 24" REBAR WITH 2" ALUMINUM CAP, FLUSH WITH SURFACE.
M107	SET A 5/8" X 24" REBAR WITH 2" ALUMINUM CAP, FLUSH WITH SURFACE.
M108	SET A 5/8" X 24" REBAR WITH 2" ALUMINUM CAP, FLUSH WITH SURFACE.
M109	SET A 5/8" X 24" REBAR WITH 2" ALUMINUM CAP, FLUSH WITH SURFACE.
M110	SET A 5/8" X 24" REBAR WITH 2" ALUMINUM CAP, FLUSH WITH SURFACE.
M111	SET A 5/8" X 24" REBAR WITH 2" ALUMINUM CAP, FLUSH WITH SURFACE.
M112	SET A 5/8" X 24" REBAR WITH 2" ALUMINUM CAP, 0.2' BELOW SURFACE.
M113	SET A 5/8" X 24" REBAR WITH 2" ALUMINUM CAP, FLUSH WITH SURFACE.
M114	SET A 5/8" X 24" REBAR WITH 2" ALUMINUM CAP, 0.5' BELOW SURFACE.

SET MONUMENTS:

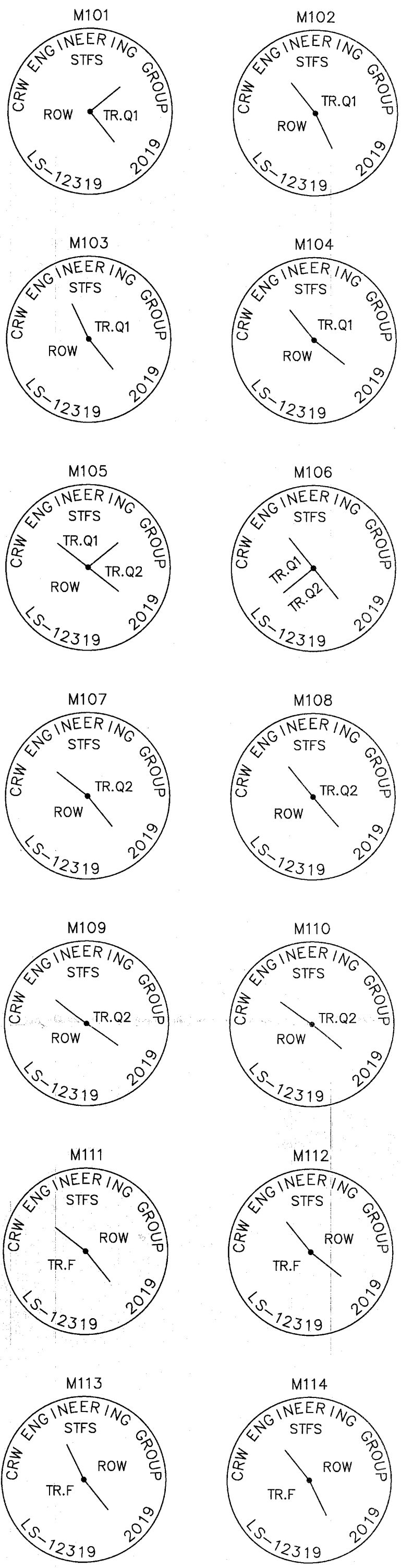

A PLAT OF
SHAKTOOLIK TANK FARM SUBDIVISION
CREATING TRACTS Q1 & Q2

A SUBDIVISION OF
ALASKA NATIVE CLAIMS SETTLEMENT ACT (ANCSA)
SECTION 14(c), TRACTS Q & F, PLAT 2012-05
WITH DEDICATION

LOCATED WITHIN
PROTRACTED SECTION 23
TOWNSHIP 13 SOUTH, RANGE 13 WEST
KATEEL RIVER MERIDIAN, ALASKA

CONTAINING 4.591 ACRES

NOME RECORDING DISTRICT

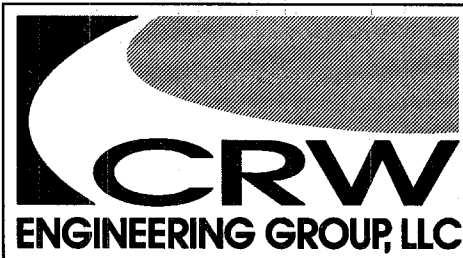

CRW Engineering Group, LLC
3940 Arctic Blvd., Suite 300
Anchorage, Alaska, 99503
#AECL882-AK

SURVEYOR: BRADFORD W. WATTS

DRAWN BY: BWW DATE OF SURVEY: BEGINNING: 9/11/2019
DATE: 11/05/2019 ENDING: 9/12/2019
SHEET: 2 OF 2 SCALE: 1"=100' CHECKED: AJR DNR FILE NO.

SURVEYOR'S CERTIFICATE

I HEREBY CERTIFY THAT I AM PROPERLY REGISTERED AND LICENSED TO PRACTICE LAND SURVEYING IN THE STATE OF ALASKA, THAT THIS PLAT REPRESENTS A SURVEY MADE BY ME OR UNDER MY DIRECT SUPERVISION, THAT THE MONUMENTS SHOWN HEREON ACTUALLY EXIST AS DESCRIBED, AND THAT ALL DIMENSIONS AND OTHER DETAILS ARE CORRECT.

DATE BRADFORD W. WATTS, LS-12319
PROFESSIONAL LAND SURVEYOR



PRELIMINARY