

# SHEET INDEX

SHEET	DESCRIPTION
1	COVER, VICINITY MAP AND SHEET INDEX
2	SITE LOCATION MAP
3	SYMBOLS, QUANTITIES AND ABBREVIATIONS
4	EXISTING SITE CONDITIONS
5	SITE PLAN
6	SLOPE PROTECTION/RESTORATION DETAIL

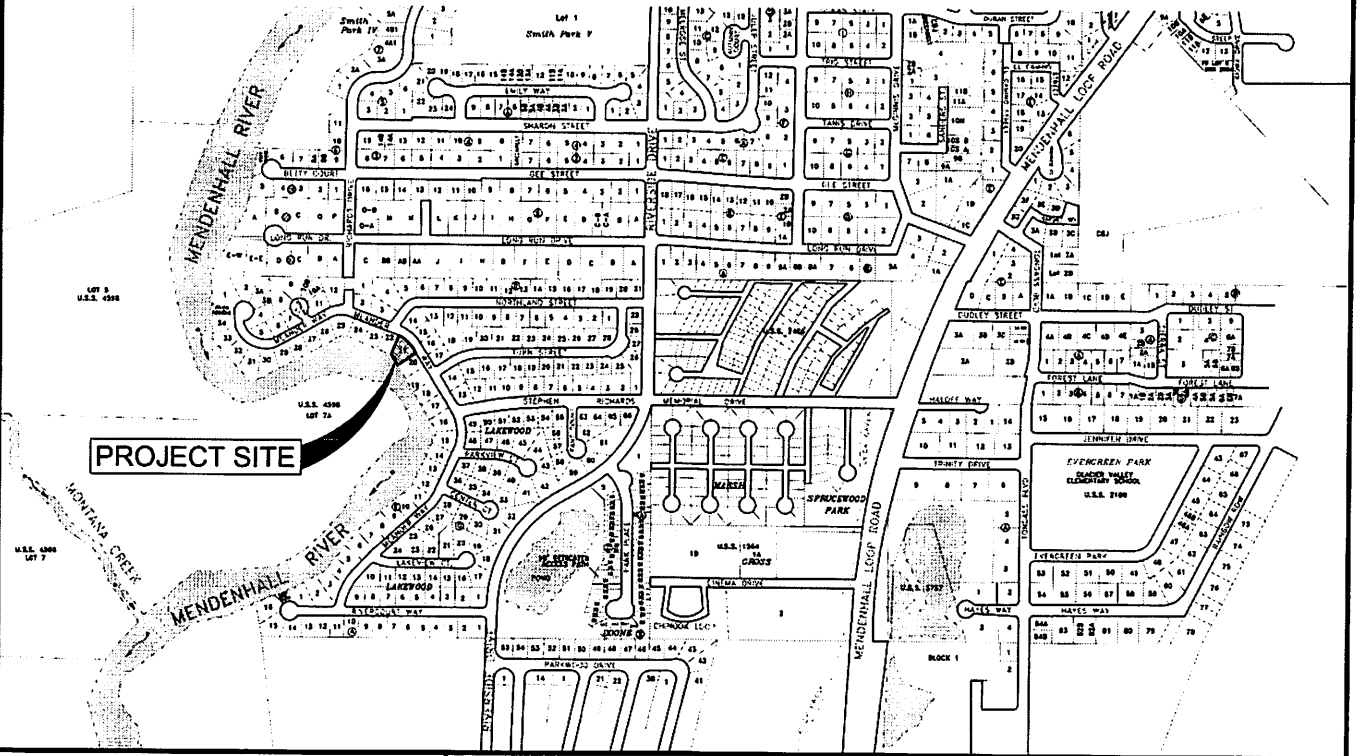

**JUNEAU, GASTINEAU CHANNEL,  
STEPHENS PASS, ALASKA**  
(PUBLICATION DATED 8/26/2018)  
**TIDAL DATUM**  
H.T.L. . . . . . 20.6'  
M.H.W. . . . . . 15.34'  
M.L.L.W. . . . . . 0.00'

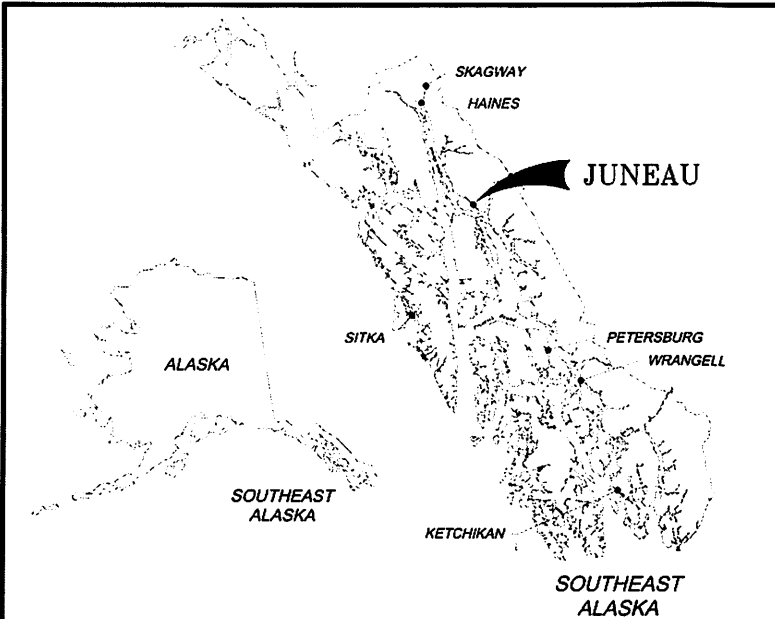
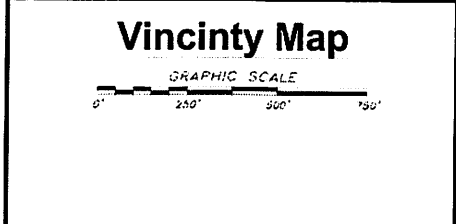

**PROPOSED  
BANK STABILIZATION  
FOR 3445 MEANDER WAY**

IN: MENDENHALL RIVER  
AT: JUNEAU, ALASKA  
APPLICANT: NORMAN STATION  
3445 MEANDER WAY  
JUNEAU, ALASKA 99801

DATE: OCT 12, 2018 SHEET 1 OF 6  
PDC PROJ.: 18270JN

**PROJECT PURPOSE:** THE PURPOSE OF PROJECT IS TO RESTORE FAILING BANK ON THE MENDENHALL RIVER IN JUNEAU, ALASKA WITH BIOENGINEERED BANK RESTORATION METHODS.

P:\2018\18270JN-Station\_1445.mxd\SitePlan\16270JN\_wk.dwg P: 01: October 11, 2018 at: 4:26pm rfbgorenme@alaska.gov

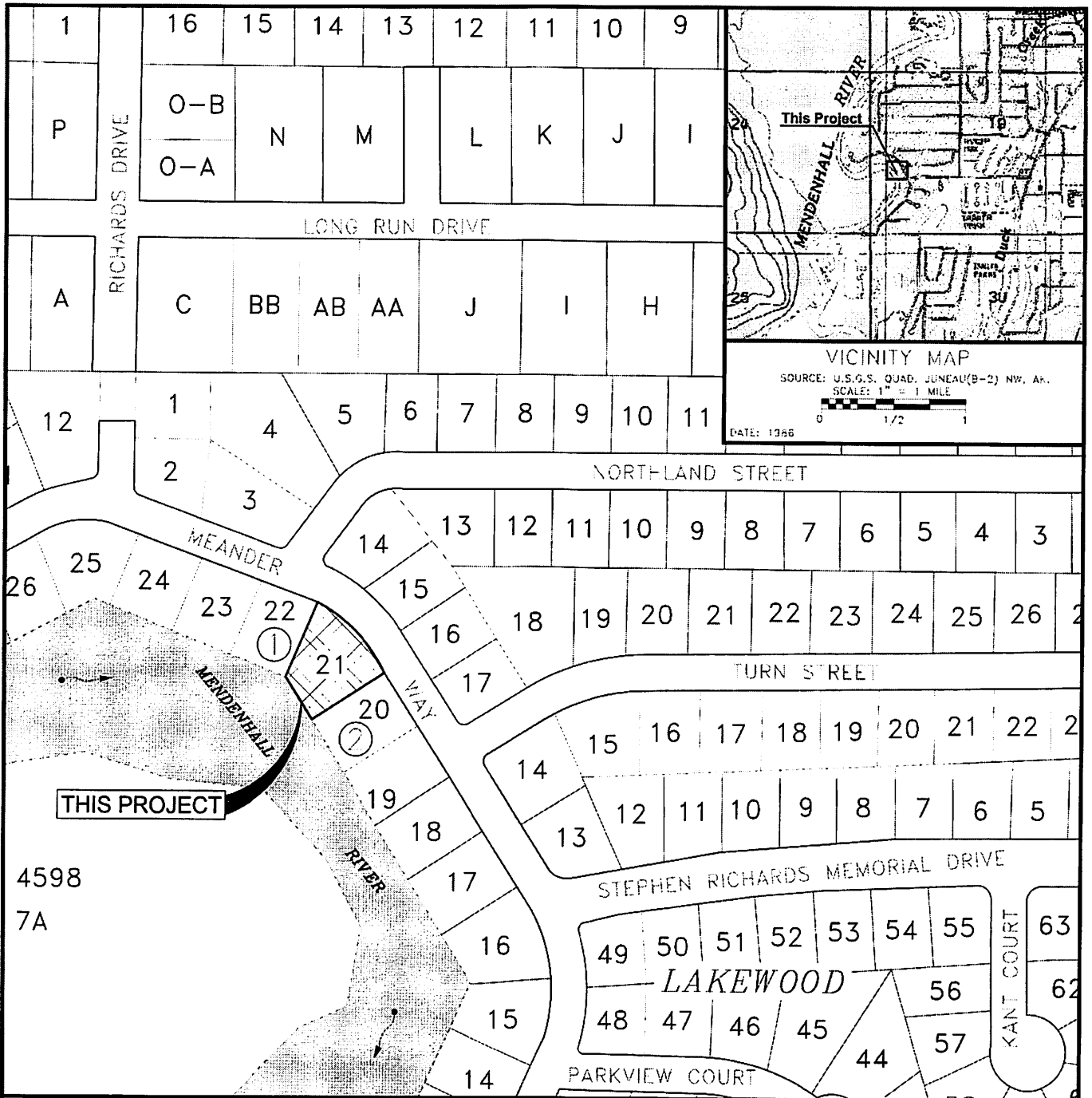

**SITE LOCATION MAP**

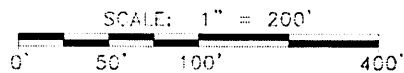

**ADJACENT PROPERTY OWNERS**

- ① JAGER & ROBERTA HOWARD – 3451 MEANDER WAY JUNEAU, AK.
- ② GREG WAGNER – 3441 MEANDER WAY JUNEAU, AK.

**PROPOSED BANK STABILIZATION FOR 3445 MEANDER WAY**

IN: MENDENHALL RIVER  
 AT: JUNEAU, ALASKA  
 APPLICANT: NORMAN STATION  
 3445 MEANDER WAY  
 JUNEAU, ALASKA 99801









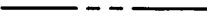

DATE: OCT 12, 2018 SHEET 2 OF 6

PDC PROJ.: 18270JN



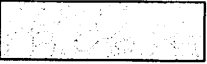

P:\2018\18270JN-Station\_1445\_mdr\Site\Site\16270JN\_4.dwg PLOT: October 11, 2018 at: 4:30pm etjgann@emg.com

# SYMBOLS

## EXISTING

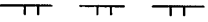
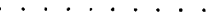
	G.L.O. MONUMENT
	PROPERTY CORNER
	PROPERTY LINE
	EDGE OF PAVEMENT
	CHAIN LINK FENCE
	MAJOR CONTOUR INTERVAL
	SPRUCE TREE
	COTTONWOOD TREE
	RIPRAP
	21.1 EXISTING SPOT ELEVATION

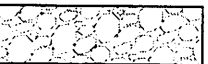
## NEW

	TOP OF RIPRAP SLOPE PROTECTION
	TOE OF RIPRAP SLOPE PROTECTION
	DRAINAGE FLOW INDICATOR
	RIPRAP SLOPE/ BIOENGINEERED SLOPE
	EXCAVATED STONE BANK TOE
	SITE CROSS SECTION

## QUANTITIES

EXCAVATION BELOW O.H.W.	= 50 C.Y.
RIPRAP BELOW O.H.W.	= 220 C.Y.

## ABBREVIATIONS

CMP	CORRUGATED METAL PIPE	I.E.	INVERT ELEVATION
CPP	CORRUGATED POLYETHYLENE PIPE	LI	LIMITS OF IMPACT TO WATERS OF THE U.S.
COMM	COMMUNICATION	MIN.	MINIMUM
DI	DUCTILE IRON	O.H.W.	ORDINARY HIGH WATER
EXIST.	EXISTING	TYP.	TYPICAL

### PROPOSED BANK STABILIZATION FOR 3445 MEANDER WAY

IN: MENDENHALL RIVER  
 AT: JUNEAU, ALASKA  
 APPLICANT: NORMAN STATON  
 3445 MEANDER WAY  
 JUNEAU, ALASKA 99801

DATE: OCT 12, 2018 SHEET 3 OF 6

PDC PROJ.: 18270JN

P:\2018\18270JN-Station\_3445\_Mdr\Sheet\5A\18270JN\_ws.dwg PLOT: October 11, 2018 at: 4:29pm ethanocemilling

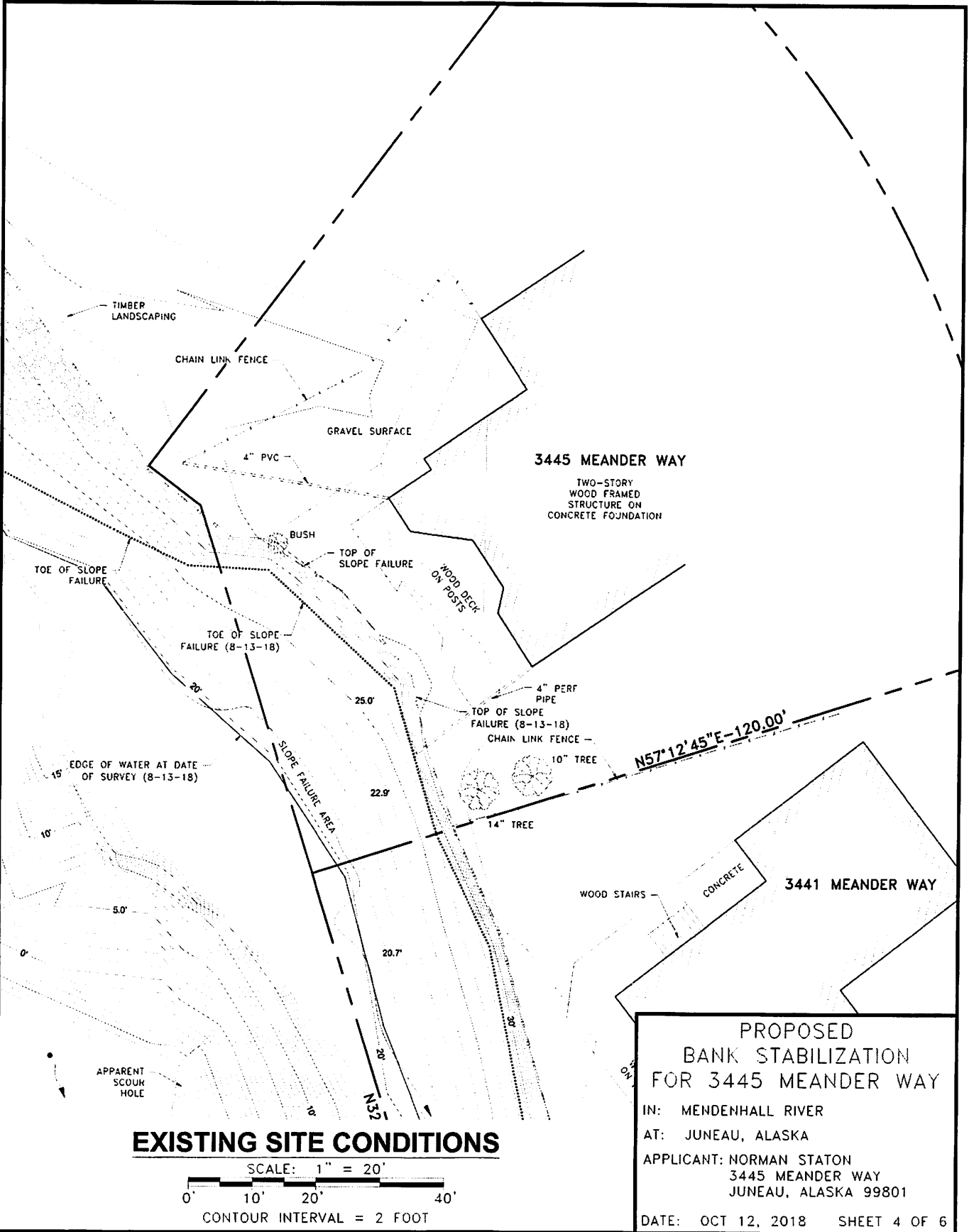

### EXISTING SITE CONDITIONS

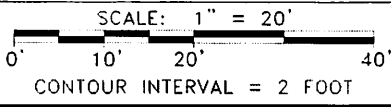

PROPOSED  
 BANK STABILIZATION  
 FOR 3445 MEANDER WAY

IN: MENDENHALL RIVER  
 AT: JUNEAU, ALASKA  
 APPLICANT: NORMAN STATON  
 3445 MEANDER WAY  
 JUNEAU, ALASKA 99801

DATE: OCT 12, 2018 SHEET 4 OF 6  
 PDC PROJ.: 18270JN

P:\2018\18270JN-Station\_3445\_Mdr\Sheets\18270JN-w.dwg PLOT: October 12, 2018 at: 10:22am ehanonrmling

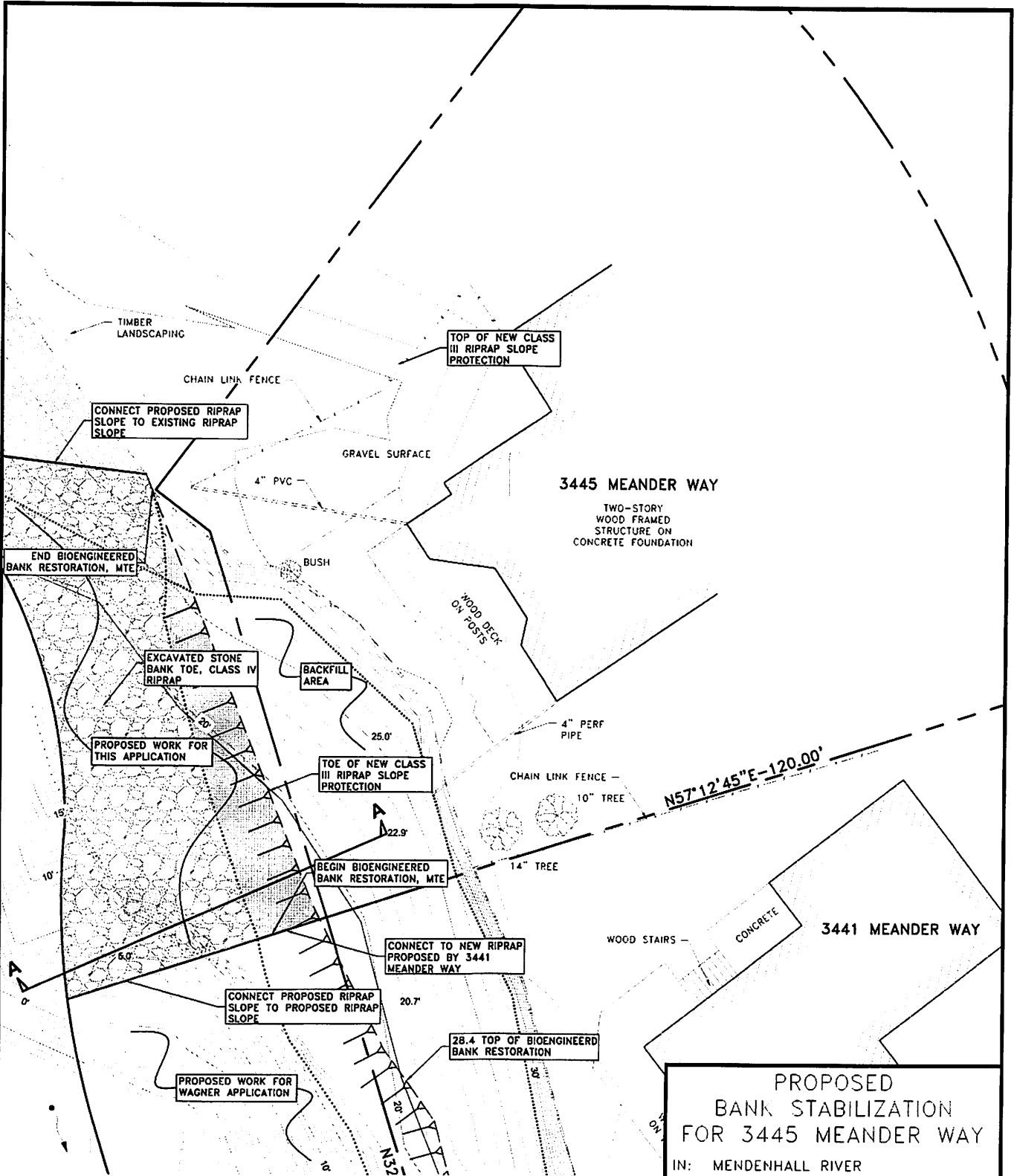

### SITE PLAN

SCALE: 1" = 20'

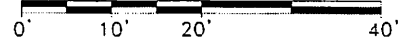

CONTOUR INTERVAL = 1 FOOT

**PROPOSED BANK STABILIZATION FOR 3445 MEANDER WAY**

IN: MENDENHALL RIVER  
 AT: JUNEAU, ALASKA  
 APPLICANT: NORMAN STATON  
 3445 MEANDER WAY  
 JUNEAU, ALASKA 99801

DATE: OCT 12, 2018 SHEET 5 OF 6

FLOOD ELEVATION TABLE	
Q100 EL.	= 28.4'
Q50 EL.	= 27.8'
Q25 EL.	= 27.2'
Q10 EL.	= 26.3'
Q2 EL.	= 24.3'

ELEVATIONS BASED ON USGS HYDROLOGY, GEOMORPHOLOGY AND FLOOD PROFILES OF THE MENDENHALL RIVER, JUNEAU, ALASKA. WATER RESOURCES INVESTIGATION REPORT 99-4150

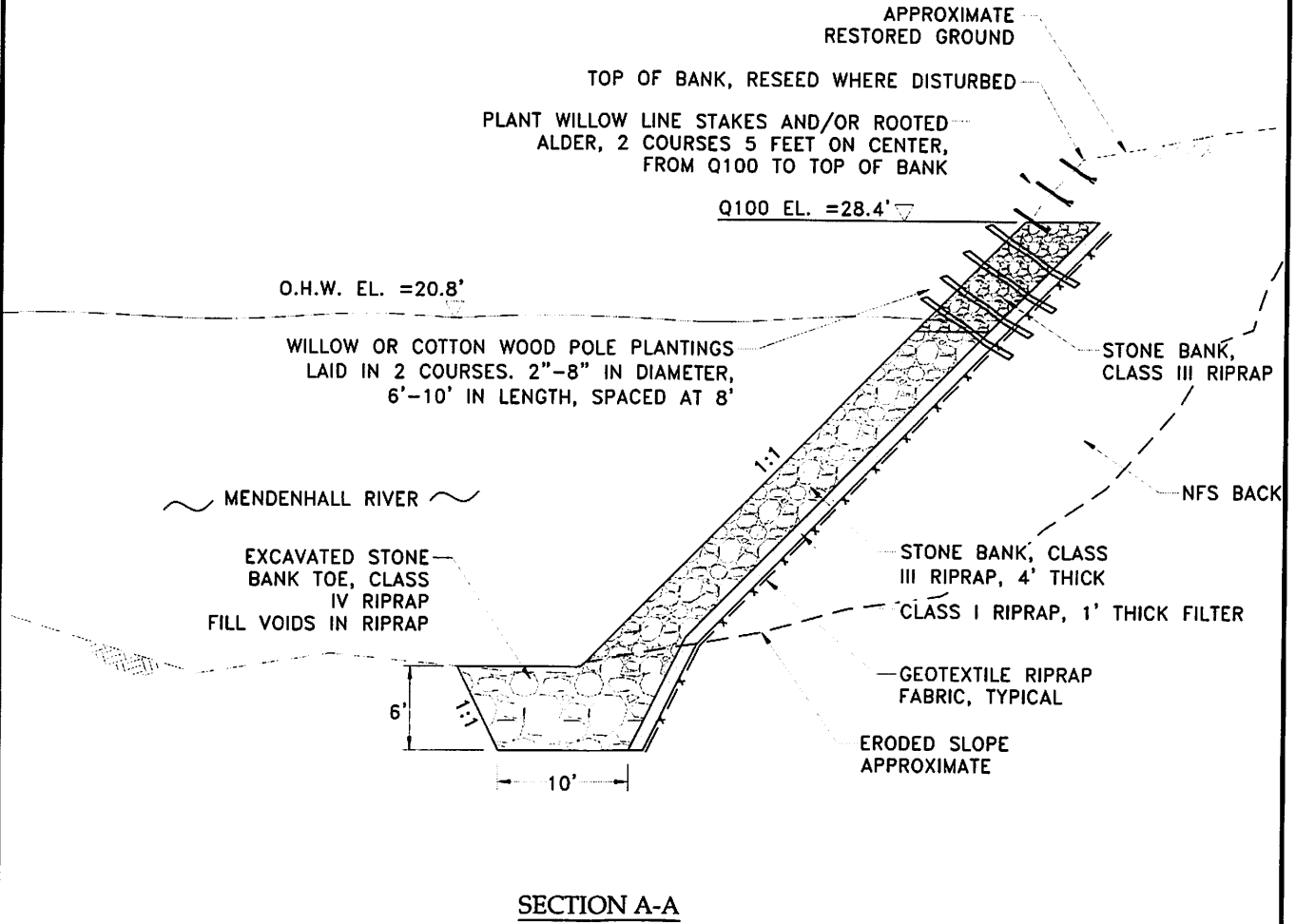

**SECTION A-A**

**BIOENGINEERED BANK RESORATION DETAIL**

N.T.S.

**NOTES:**

- 1) ALL RIPRAP MATERIALS TO BE CLEAN AND OBTAINED FROM AN UPLAND QUARRY SITE.
- 2) ALL EXCAVATED MATERIALS WILL BE DISPOSED OF AT AN UPLAND DISPOSAL SITE APPROVED BY THE ENGINEER OR UTILIZED AS UPLAND FILL ABOVE OHW BEHIND RIPRAP.

PROPOSED  
BANK STABILIZATION  
FOR 3445 MEANDER WAY

IN: MENDENHALL RIVER

AT: JUNEAU, ALASKA

APPLICANT: NORMAN STATON  
3445 MEANDER WAY  
JUNEAU, ALASKA 99801

DATE: OCT 12, 2018 SHEET 6 OF 6

PDC PROJ.: 18270JN

P:\2018\18270JN-Station\_3445\_Meander\Sheet5.dwg 18270JN - v1.dwg PLOT: October 12, 2018 at 10:24am #hanraemaling