

FINISH SCHEDULE

FLOORING:	CARPET TILE: MFR: INTERFACE COLLECTION: SILVER LININGS SL930 COLOR: CHARCOAL FADE 104524 INSTALL: ASHLAR (NORTH SOUTH DIRECTION) LOCATIONS: TYPICAL ALL AREAS EXCEPT LAB UNO BASE: JOHNSONITE RUBBER BASE, CHARCOAL	GLASS FILM	MFR: GILA (www.gilafilms.com) COLLECTION: ADHESIVE WINDOW FILM COLOR: TRANSLUCENT LOCATIONS: TYPICAL ALL GLAZED DOORS UNO	COUNTERTOPS:	EXPOXY RESIN BLACK TOPS LOCATION: LAB (COUNTER AND TABLES)  LAMINATE COUNTERTOPS: COLOR: FORMICA: 949 WHITE EDGES: DOELKEN 3MM EDGEBANDING MATCHING PATTERN AND COLOR LOCATION: AV ROOM COUNTERS
FLOORING:	RESILIENT FLOORING: MFR: NORA COLLECTION: ENVIRONCARE COLOR: #2932 NIGELLA AND #2955 LEMON GRASS INSTALL: WELDED SEAM, COVE BASE LOCATIONS: LAB/CASE 101 BASE: INTEGRAL COVE	WINDOW TREATMENT:	MFR: MECHOSHADE COLLECTION: URBAN SHADE BLACKOUT SHADE COLOR: MIDNIGHT BLACKOUT 0200 SERIES- SILVER.  LIGHT DIFFUSING SHADE COLOR: ECOVEIL 0950 1% OPEN SILVER BIRCH  LOCATIONS: TYPICAL ALL GLAZED EXTERIOR AND INTERIOR WINDOWS SEE DRAWINGS FOR BLACKOUT OR DIFFUSING SHADE	P-LAM 1:	MFR: FORMICA COLOR: WHITE ASH 8841-58 LOCATIONS: BASE DRAWER/CABINET FACE LAMINATE IN LAB, TALL CABINETS IN LAB, CASEWORK IN OFFICES AND ANY OTHER CASEWORK U.N.O.
BACKSPLASH :	WALL PANEL: MFR: CROSSVILLE PRODUCT: LAMINAM COLLECTION: FILO 3+ COLOR: ARGENTO LOCATION: BETWEEN COUNTER AND UPPER CASWORK/SHELVING IN LAB			P-LAM 2:	MFR: WILSONART COLOR:ASIAN NIGHT 7949K-18 LOCATIONS: UPPER OPEN CASEWORK IN LAB INCLUDING ALL EXPOSED FACES U.N.O.
				PAINT 1:	GENERAL WALL PAINT: MFR: SHERWIN WILLIAMS COLOR: SW7008 ALABASTER CCE: oz        32 64 128 B1= Black       -   1   - Y3+ Deep Gold   2   1   - FINISH: EGGSHELL LOCATIONS: TYPICAL U.N.O.
				PAINT 2:	ACCENT WALL PAINT: MFR: BENJAMIN MOORE COLOR: LIGHT OF THE MOON #365 CCE Y3        0 x 7 Y2        0 x 11 S2        0 x .5 FINISH: EGGSHELL LOCATIONS: AS INDICATED
				PAINT 3:	ACCENT WALL PAINT: MFR: BENJAMIN MOORE COLOR: OPAL ESSENCE #680 CCE Y3        0 x 2.5 S1        0 x 2 G1        0 x 4 FINISH: EGGSHELL LOCATION: AS INDICATED
				PAINT 4:	DOOR FRAMES PAINT: MFR: SCUFFMASTER COLOR: SOLID METAL SM807 FINISH: SATIN LOCATION: DOORFRAMES, TYPICAL
				CEILING:	ACT ARMSTRONG ULTIMA HIGH NRC 24X48 SECOND LOOK WITH PRELUDE SUSPENSION SYSTEM
				FABRIC WRAPPED WALL PANELS:	MFR: CARNEGIE, XOREL COLOR: FLASHBACK 6615-WD50 LOCATIONS: CLASSROOM AND OTHER FABRIC WRAPPED TACKABLE BOARDS AS INDICATED

DOORS AND HARDWARE

Door Schedule Phase II								
Mark	Height	Width	Full Relite	Hardware Group	Access Controls	Frame Material	Comments	Smoke Sealed
101	7' - 0"	3' - 0"	YES	CLASSROOM SECURITY	YES	MTL		YES
103	7' - 0"	3' - 0"	YES	CLASSROOM SECURITY	YES	MTL		YES
105	7' - 0"	3' - 0"	NO	CLASSROOM SECURITY	YES	MTL		YES
107	7' - 0"	3' - 0"	YES	CLASSROOM SECURITY	YES	MTL		YES
113	7' - 0"	3' - 0"	YES	CLASSROOM SECURITY	YES	MTL		YES
113A	7' - 0"	3' - 0"	YES	OFFICE	NO	MTL	NO CLOSER	NO
113B	7' - 0"	3' - 0"	NO	OFFICE	NO	MTL	NO CLOSER	NO
113C	7' - 0"	3' - 0"	YES	OFFICE	NO	MTL	NO CLOSER	YES
113D	7' - 0"	3' - 0"	YES	OFFICE	NO	MTL	NO CLOSER	YES

EXISTING SALVAGED LOCKSETS MAY BE REUSED FOR INTERIOR OFFICES . SUBJECT TO OWNER APPROVAL

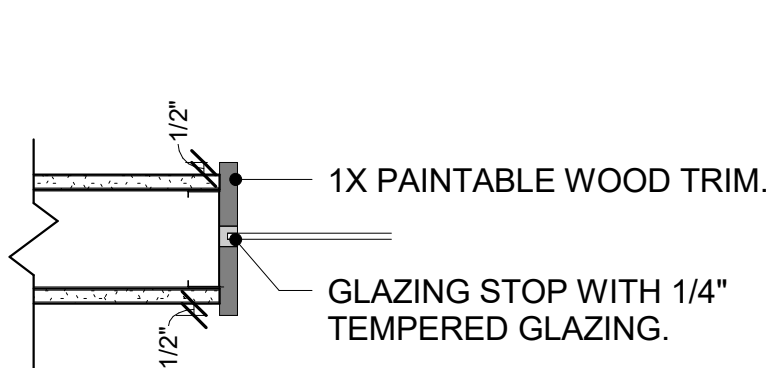
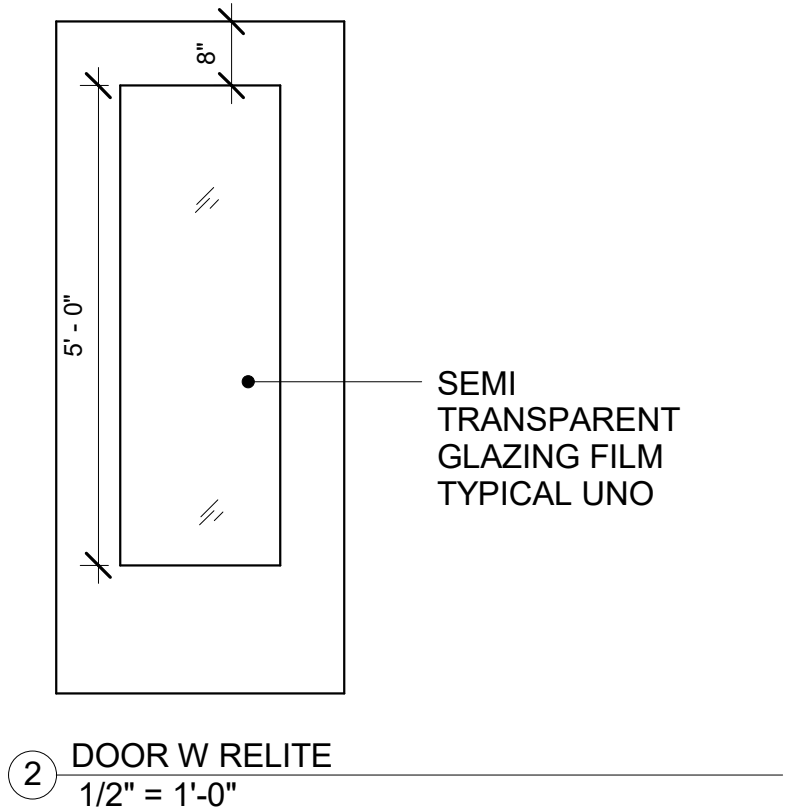

③ OPENINGS  
1 1/2" = 1'-0"

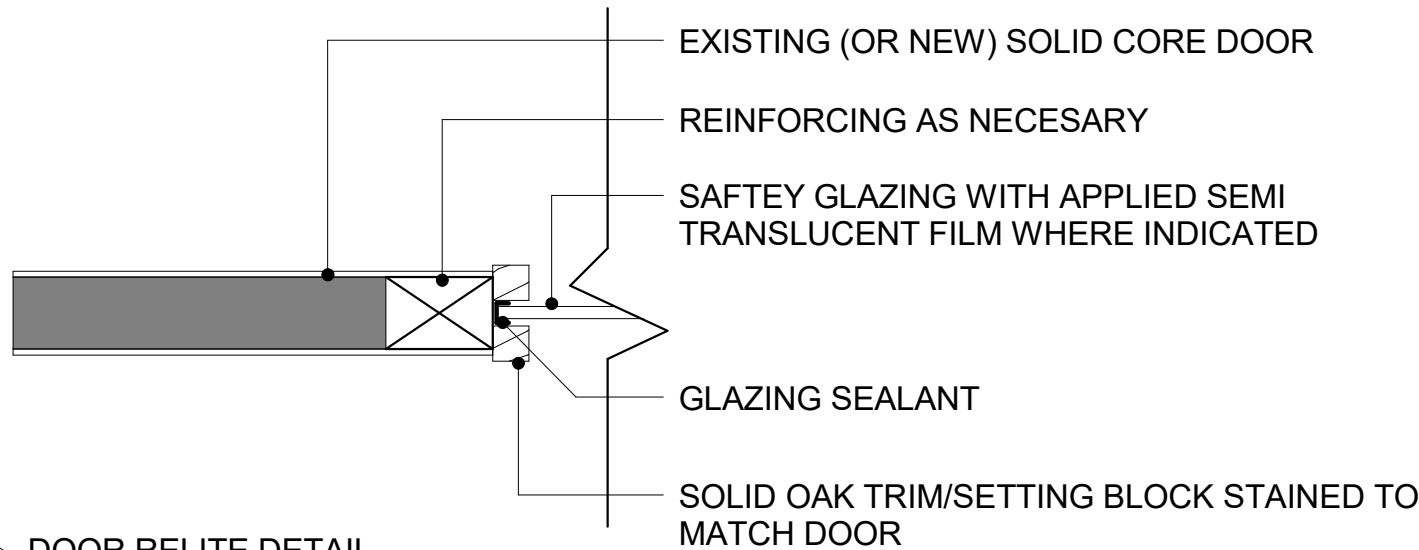

① DOOR RELITE DETAIL  
3" = 1'-0"