

FILE NAME: X:\16601 NSB001\Draws\Edw\Sheet Files\16601 - E1.0.dwg
PLOTED: MPL 03/08/2017 11:02:16 AM

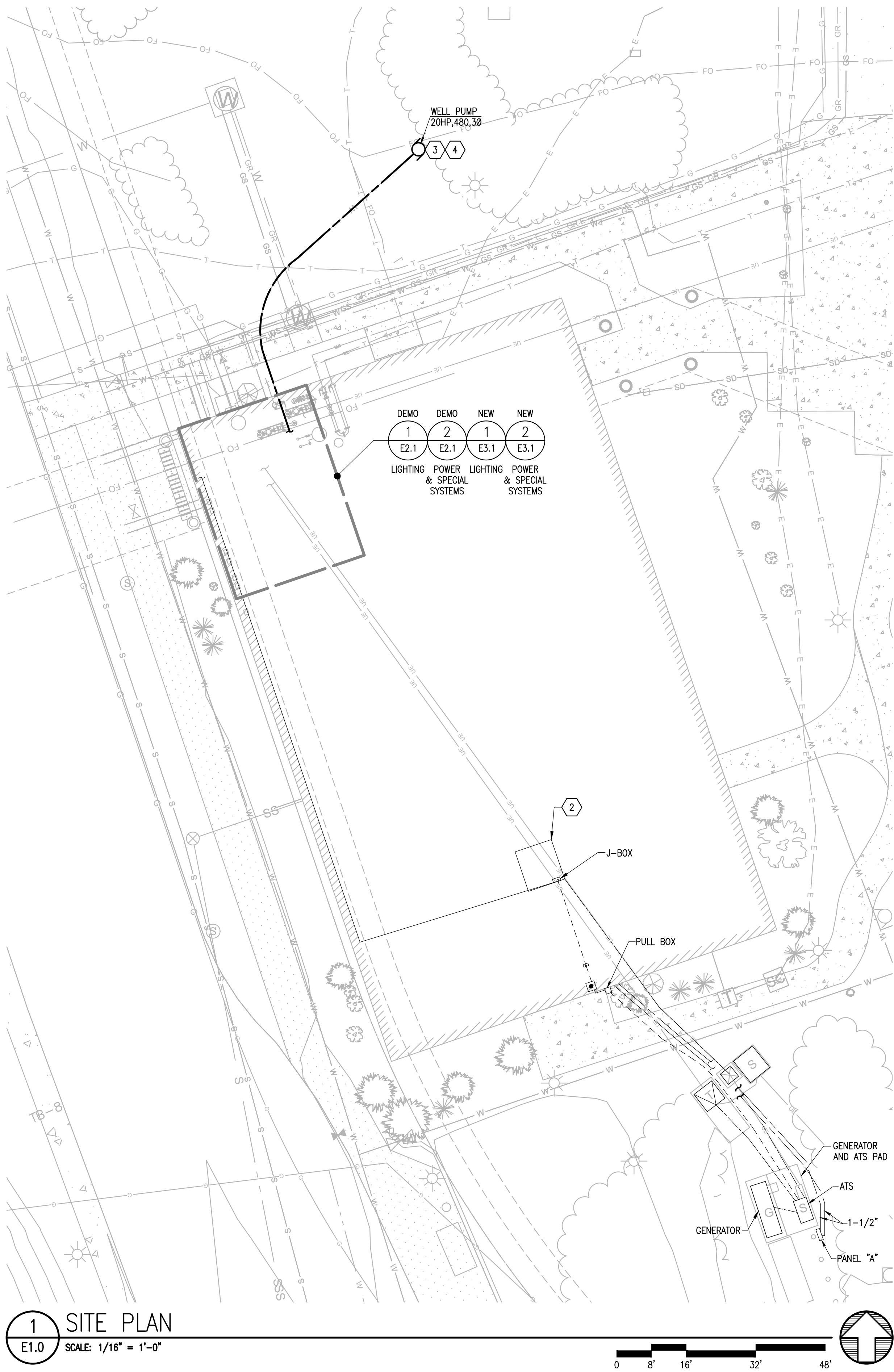

NOTIFICATION OF POTENTIAL HAZARD

ASBESTOS CONTAINING MATERIAL (ACM) IS PRESENT IN THE BUILDING THAT MAY IMPACT THE WORK OF ALL TRADES. THE CONTRACTOR SHALL REQUIRE THEIR PERSONNEL AND ALL SUBCONTRACTOR PERSONNEL TO COORDINATE WITH OTHER TRADES AND CONDUCT THEIR WORK TO PREVENT WORKER EXPOSURE OR SITE CONTAMINATION. REFER TO DIVISION 01 AND 02 SPECIFICATIONS FOR SPECIFIC INFORMATION CONCERNING REMOVING AND DISPOSING OF THESE MATERIALS AND THE INSTALLATION OF NEW MATERIALS AND COMPONENTS. THIS NOTIFICATION IS PROVIDED IN ACCORDANCE WITH EPA AND OSHA REQUIREMENTS.

SHEET NOTES

1. SITE INFORMATION INCLUDING EQUIPMENT LOCATIONS, CONDUIT, FEEDER LOCATIONS, AND ROUTING BASED UPON AS-BUILT DOCUMENTATION. FIELD VERIFY ALL. COORDINATE WITH UAA TO PERFORM LOCATES.
2. APPROXIMATE LOCATION OF EXISTING ELECTRICAL ROOM ON THE LOWER LEVEL. UPPER LEVEL ELECTRICAL ROOM IS DIRECTLY ABOVE LOWER ELECTRICAL ROOM.
3. LOCATION OF EXTERIOR WELL PUMP. REFER TO SHEET E3.1 FOR LOCATION OF VSD. PROVIDE OUTPUT FILTER/REACTOR FOR VSD BASED ON DISTANCE TO WELL PUMP.
4. REFER TO DETAIL 2/E1.0 AND CIVIL DRAWINGS FOR TRENCH DETAIL AT WELL PUMP.

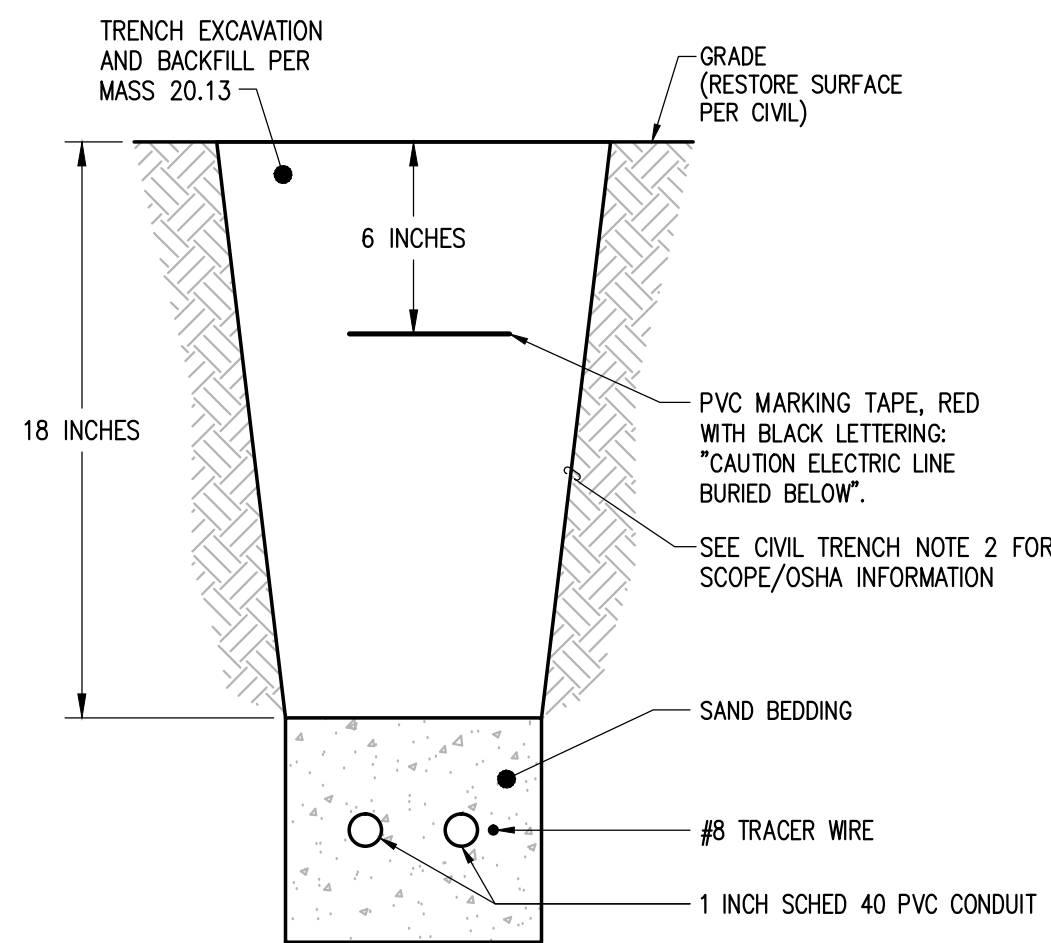

2
E1.0
DETAIL - WELL PUMP TRENCH - 2@ 1 INCH DUCT
SCALE: NONE

NSB EM-2 MECHANICAL SYSTEMS CONVERSION/UPGRADE

Revisions

No.	Date	Description

Design: JEH

Drawn: MPL

UAA Project No.: 16-0103

Date: 02/17/2017

Sheet Title

SITE PLAN

Sheet Number

E1.0