

UAA KPC BROCKEL BUILDING REROOF

University of Alaska

Project No: 16-0111

Soldotna, Alaska

ABBREVIATIONS

ACM	ASBESTOS CONTAINING MATERIALS APPROXIMATELY
BLDG	BUILDING
BUR	BUILT UP ROOFING
CMU	CONCRETE MASONRY UNIT
CONC	CONCRETE
CONT	CONTINUOUS
DIA	DIAMETER
DWG	DRAWING
EIFS	EXTERIOR INSULATION AND FINISH SYSTEM
EJ	EXPANSION JOINT
EL	ELEVATION
ELEC	ELECTRIC, ELECTRICAL
ELEV	ELEVATION
EPDM	ETHYLENE PROPYLENE DIENE MONOMER
EPS	EXPANDED POLYSTYRENE INSULATION
EQ	EQUAL
ETR	ELECTRICAL THROUGH ROOF
(E), EXIST	EXISTING
FIB BD	FIBER BOARD
GA	GAUGE
GALV	GALVANIZED
GLB	GLUE LAMINATED BEAM
GWB	GYPSUM WALL BOARD
INFO	INFORMATION
INSUL	INSULATION
J-BOX	JUNCTION BOX
KPC	KENAI PENINSULA COLLEGE
LF	LINEAL FEET
LG	LIGHT GUARD
MAX	MAXIMUM
MCBUR	MINERAL CAP BUILT UP ROOF
MECH	MECHANICAL
MFR	MANUFACTURER
MISC	MISCELLANEOUS
MIN	MINIMUM
NA	NOT APPLICABLE
NIC	NOT IN CONTRACT
NRCA	NATIONAL ROOFING CONTRACTORS ASSOCIATION
NTS	NOT TO SCALE
OC	ON CENTERS
OD	OUTSIDE DIAMETER
OFS	OVERFLOW SCUPPER
ORD	OVERFLOW ROOF DRAIN
POLY	POLYETHYLENE
POLYISO	POLYISOCYANURATE INSULATION
PREFAB	PREFABRICATE
PSF	POUNDS PER SQUARE FOOT
PSI	POUNDS PER SQUARE INCH
PT	PRESSURE PRESERVATIVE TREATED
PTR	PIPE THROUGH ROOF
RD	ROOF DRAIN
RL	RAIN LEADER
RM	ROOM
SAM	SELF ADHERING MEMBRANE
SBS	STYRENE-BUTADIENE-STYRENE
SD	STORM DRAIN
SF	SQUARE FOOT, SQUARE FEET
SIM	SIMILAR
SM	SHEET METAL
SPF	SPRAYED POLYURETHANE FOAM
SS	STAINLESS STEEL
STRUC	STRUCTURAL
TO	TOP OF
TYP	TYPICAL
UON	UNLESS OTHERWISE NOTED
VIF	VERIFY IN FIELD
VR	VAPOR RETARDER
VTR	VENT THROUGH ROOF
W	WIDE
W/	WITH
XPS	EXTRUDED POLYSTYRENE BOARD

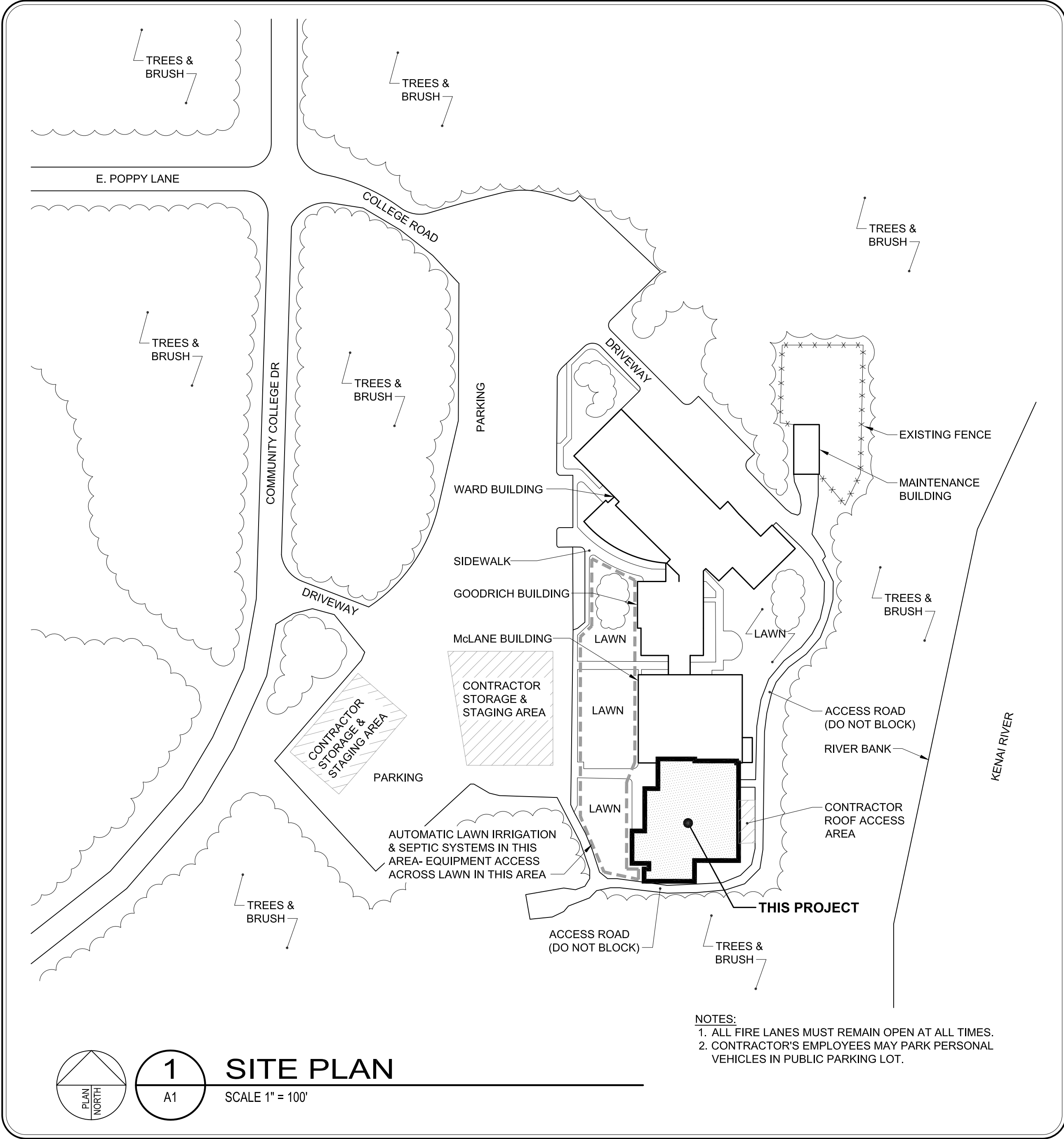

- NOTES:
1. ALL FIRE LANES MUST REMAIN OPEN AT ALL TIMES.
 2. CONTRACTOR'S EMPLOYEES MAY PARK PERSONAL VEHICLES IN PUBLIC PARKING LOT.

ENVIRONMENTAL

1. ROOF MEMBRANE SAMPLES WERE ANALYZED FOR ASBESTOS. NO ASBESTOS DETECTED. SEE EXISTING ROOF PLAN FOR LOCATIONS OF ROOF CUTS.

PROJECT SUMMARY

1. REROOF: MCBUR, INSULATION.
2. NEW ROOF DRAINS.
3. MECHANICAL ROOM AIR MODIFICATIONS.
4. METAL SIDING & TRIM.
5. WINDOW REPLACEMENT, MINOR INTERIOR FINISHES.
6. MISCELLANEOUS.

GENERAL NOTES

1. THE "NATIONAL ROOFING CONTRACTOR'S ASSOCIATION (NRCA) ROOFING MANUAL: MEMBRANE ROOF SYSTEMS" IS USED AS THE BASIS FOR THIS DESIGN AND IS TO BE USED BY THE CONTRACTOR AS A BASIS FOR CONSTRUCTION, UNLESS OTHERWISE NOTED.
2. ROOF INVESTIGATIVE INFORMATION IS SHOWN ON EXISTING DETAILS.
3. EXISTING CONDITIONS ARE SHOWN AS ACCURATELY AS POSSIBLE. SITE VERIFY ALL INFORMATION NOTED IN THESE CONTRACT DOCUMENTS.
4. ALL DETAILS ARE TO BE CONSIDERED TYPICAL. SIMILAR DETAILS OCCUR AT SIMILAR LOCATIONS.
5. IF DECAYED WOOD OR STEEL IS FOUND, INFORM THE OWNER'S REPRESENTATIVE.
6. NO SILICONE SEALANT IS TO BE USED. USE APPROVED POLYURETHANE SEALANT.
7. CONTRACTOR SHALL VERIFY LOCATION OF ALL UTILITIES, ELECTRICAL EQUIPMENT AND WIRING BEFORE PROCEEDING WITH ANY WORK.
8. ALL ROOFING AND BUILDING MATERIALS ARE TO BE KEPT DRY.
9. CONTRACTOR TO WORK ON ONLY THE PORTION OF THE ROOFING THAT CAN BE WATERPROOFED THAT DAY.
10. CLEANING DURING CONSTRUCTION: CONTROL ACCUMULATION OF WASTE MATERIALS AND RUBBISH. DISPOSE OF WASTE IMMEDIATELY. KEEP AREAS FREE OF HAZARDS AND RUBBISH.
11. BUILDINGS ARE TO BE OCCUPIED DURING REROOF WORK. COORDINATE ALL WORK SO AS TO NOT INTERRUPT OCCUPANCY REQUIREMENTS.
12. CONTRACTOR TO COORDINATE WITH THE OWNER'S REPRESENTATIVE AS TO LOCATION OF ASPHALT KETTLES TO MINIMIZE FUMES ON BUILDING OCCUPANTS.
13. CONTRACTOR IS RESPONSIBLE FOR PROTECTING THE SITE AND BUILDING FROM PROJECT RELATED DAMAGE.
14. PROTECT EXISTING BUILDING WALLS FROM ACCIDENTAL DISCHARGE OR LEAKING FROM HOT ASPHALT DELIVERY PIPING SYSTEM.
15. TAKE SPECIAL CARE TO SECURE ALL CONSTRUCTION AND DEMOLITION MATERIALS FROM WIND DISPLACEMENT.
16. COORDINATE WITH OWNER'S REPRESENTATIVE TO ACCOMMODATE ANY SPECIAL REASONABLE NEEDS.
17. NO NOISE PRODUCING WORK BEFORE 7 AM OR AFTER 10 PM.

ACCESS & STAGING NOTES

1. MAINTAIN ALL SITE ACCESS AND BUILDING OCCUPANT AND VEHICLE ENTRIES FREE FROM OBSTRUCTIONS AT ALL TIMES.
2. STAGING AREAS, BUILDING ACCESS AND CONSTRUCTION ACTIVITIES TO BE COORDINATED WITH OWNER'S REPRESENTATIVE.
3. CONTRACTOR TO BE RESPONSIBLE FOR TEMPORARY FENCING AND MATERIAL STORED ON SITE.

DEAD LOAD ANALYSIS

REMOVED FROM ROOF

2 3/8" LG BOARD	4.5 PSF
3" XPS INSULATION	0.5 PSF
BUR MEMBRANE	2.5 PSF
1/2" WOOD FIB BD	0.5 PSF
5 1/2" EPS INSUL	0.6 PSF
1-PLY BUR VR	1.0 PSF
1/2" GWB	2.2 PSF
	11.8 PSF

ADDED TO ROOF

MINERAL CAP BUR	2.5 PSF
1/2" WOOD FIBER BOARD	0.5 PSF
7" AVERAGE POLYISO	1.4 PSF
BUR VAPOR RETARDER	1.5 PSF
1/2" GWB	2.2 PSF
	8.1 PSF

DESIGN/CODE DATA

- THIS DESIGN/CODE DATA REFERS TO ROOFING WORK ONLY
- 2009 INTERNATIONAL BUILDING CODE (IBC)
- 2009 INTERNATIONAL MECHANICAL CODE (IMC)
- 2011 NATIONAL ELECTRICAL CODE (NEC)
- 2009 UNIFORM PLUMBING CODE (UPC)
- WIND DESIGN SPEED = 110 MPH PER 2009 IBC (EXPOSURE B)
- CLASS "A" ROOF COVERINGS
- MINIMUM AVERAGE ROOF INSULATION = R40 (ESTABLISHED PER DETAILS)

SYMBOLS

	DETAIL NUMBER
	SHEET NUMBER WHERE DETAIL IS LOCATED
	CONTINUOUS LUMBER
	DISCONTINUOUS LUMBER
	RIGID INSULATION
	BATT INSULATION
	PLYWOOD
	GYPSUM WALL BOARD
	WOOD FIBERBOARD
	EXISTING ROOF DRAIN
	NEW ROOF DRAIN
	EXISTING SCUPPER
	NEW SCUPPER
	HOT STACK
	HOT STACK W/ CURB
	ROUND SHEET METAL VENT STACK
	MECHANICAL VENT ON CURB
	PLUMBING VENT THROUGH ROOF
	PIPE THROUGH ROOF
	ROOF SLOPE DIRECTION
	ROOF CUT / CORE SAMPLE LOCATION
	TAPERED EPS DRAINAGE CRICKET
	ROOF HATCH
	ROOF ACCESS LADDER
	INDICATES ROOF AREA NUMBER
	APPROXIMATE ROOF ELEVATION
	APPROXIMATE ELEVATION AT THIS LOCATION
	ROOF DECK HEIGHT CHANGE DUE TO SLOPE

SPECIAL CONDITIONS

1. CONTRACTOR MAY UTILIZE POWER AND WATER AT THE SITE AT NO COST.
2. CONTRACTOR TO PROVIDE PORTABLE TOILETS.
3. COORDINATE ANY BUILDING EQUIPMENT SHUTDOWNS WITH THE OWNER'S REPRESENTATIVE.

COLOR SCHEDULE

1. MC BUR: WHITE
2. PREFINISHED SHEET METAL: MEDIUM BRONZE
3. PREFINISHED METAL SIDING: MEDIUM BRONZE
4. METAL LOUVERS: TO MATCH NEW SIDING
5. PAINT: TO MATCH ADJACENT (COLORS VARY)
6. ALL TO BE APPROVED VIA SUBMITTAL PROCESS

SHEET INDEX

A1	TITLE AND INFORMATION SHEET
A2	EXISTING ROOF PLAN
A3	NEW ROOF PLAN
A4	EXTERIOR ELEVATIONS
A5	EXTERIOR ELEVATIONS
A6	REFERENCE FLOOR PLAN
A7	ROOF DETAILS
A8	ROOF DETAILS
A9	ROOF DETAILS
A10	DETAILS

M1	LEGEND, ABBREVIATIONS & SCHEDULES
M2	ENLARGED PENTHOUSE DEMOLITION PLAN
M3	ENLARGED PENTHOUSE REMODEL PLAN



BDS INC. ENTITY# 25796D



3330 C St, Suite 200
Anchorage, AK 99503
T: 907.562.6076 | F: 907.562.6635
W: www.bdsak.com

SOLDOTNA, ALASKA

UAA KPC
BROCKEL BLDG
REROOF

UAA PROJECT NO.: 16-0111
BDS PROJECT NO.: 616004.002

PHASE
BID DOCUMENTS
DATE
FEBRUARY 28, 2017
DRAWING TITLE
TITLE AND
INFORMATION
SHEET

A1