

**STATE OF ALASKA ITB NUMBER 2515N021F
AMENDMENT NUMBER 7**

RETURN THIS AMENDMENT TO THE ISSUING OFFICE AT:



Department of Transportation &
Public Facilities
Northern Region Procurement
2301 Peger Road
Fairbanks, AK 99709

THIS IS NOT AN ORDER

DATE AMENDMENT ISSUED: January 5, 2015

ITB TITLE: Aggregate, Stockpiled, Multiple Grades, Multiple Locations, Denali Highway, AK, Federally Funded

ITB OPENING DATE AND TIME: January 8, 2015. 10:00 a.m.

The following changes/additions are required:

1. Change the Bid Opening Date from "January 8, 2014. 10:00 a.m." to "January 15, 2015, 10:00 a.m.".
2. Please see the attached for Survey Guidelines for MP 55 of the Denali Highway.

This amendment must be signed and returned for your bid to be considered responsive.

Jean M. Caskey

Jeannie Caskey
Northern Region Procurement Officer
PHONE: (907) 451-5236
TDD: (907) 451-2363
FAX: (907) 451-5270

NAME OF COMPANY

SIGNATURE

DATE



SURVEY GUIDANCE

MS 52-1-034-5

MP 56 Denali Highway

Within Unsurveyed Township 22 South, Range 5 East, F.M.

Rectangular and aliquot part lines

This Material Site is partially described by aliquot part, but is in an Unsurveyed Township. Refer to **11 AAC 53.150 Supplemental cadastral rectangular surveys** for guidance in performing the survey. Note, however, that the intent of this survey is not to perform a rectangular survey of the section, but only to survey and monument the boundary of the Material Site.

For computing the section corner positions for this township, Category I applies (11 AAC 53.150(a)(1)).

"(1) Category I applies if no rectangular cadastral survey corners have been set to define the rectangular survey township perimeter. The township is, therefore, legally described only be reference to the official protraction diagrams. The section corner positions along the perimeter and within the interior of the township must be established at the official protracted geodetic positions as shown on the official protraction diagram."

To subdivide the section, refer to the guidance in 11 AAC 53.150(b).

Since this is not an official cadastral survey, and the section will remain Unsurveyed, Material Site corner designations should be numbered C1, C2, C3, etc. (numerically), and not be designated as aliquot part corners.

In short, all necessary rectangular corner positions will be computed based on the official protraction diagram, but only the corners of the Material Site will be monumented.

To obtain a NAD27 basis of coordinates, use OPUS to obtain NAD83 coordinates and then convert to NAD27 using NADCON. (While it is usually preferable to recover NGS monuments with published superseded NAD27 coordinates, we find that to be impractical for this survey.)

Right of Way line

A right of way map for this portion of the Denali Highway does not exist. The width of this portion of the Denali Highway is based on a Public Land Order and following Secretarial Order. The physical centerline of the highway was surveyed and fixed by plat "Control Drawing of Denali Highway Milepost 42-80," 2004-2 Talkeetna Recording District. To establish the north boundary of this site as coincident with the right of way line, locate the right of way centerline based on Plat 2004-2 and then offset the appropriate width (150').

Location Description clarification

In the case of this material site, the NW1/4 should be understood to be the portion of Section 6 that is west of the protracted N-S centerline and north of the protracted E-W centerline, with the centerlines defined in accordance with 11 AAC 53.150(b) as referenced above. The N1/2 of the NW1/4 should be understood to be that portion of the NW1/4 that is north of the protracted E-W sixteenth line of the NW1/4 in accordance with 11 AAC 53.150(b).

SURVEY PROPOSAL

Meander Corners

The ordinary high water mark of Oscar Creek forms a portion of the southerly boundary of this Material Site. Use customary survey procedures in setting Witness Corners to the Meander Corners, and reporting the meanders of Oscar Creek.

General scope

Monument the Material Site corners with a 2 ½" post, 30" long, with a 3 ¼" cap, to be provided by the Department. Intermediate monuments shall be set on lines longer than 1320' so that there is no distance greater than 1320' between monuments. Intermediate monuments shall also be set at any angle points or PCs/PTs on the Right of Way. Intermediate monuments shall be 5/8" steel rebar, 36" long, with a 2" aluminum cap, to be supplied by the contractor. Brush property lines (excluding ROW line and meander line) 2' wide and install Carsonite markers 150' on center along the property line. Survey and brush clearing will be approved by the Department before the commencement of stockpile work. Supply the Department with a recorded plat at the end of the project, which must be approved before final payment will occur.

Limits of Disturbance

If the surveyor observes that any ground disturbance or material extraction has taken place outside the limits of the described parcel, immediately report the findings to the Department for further guidance.

LOCATION MAP

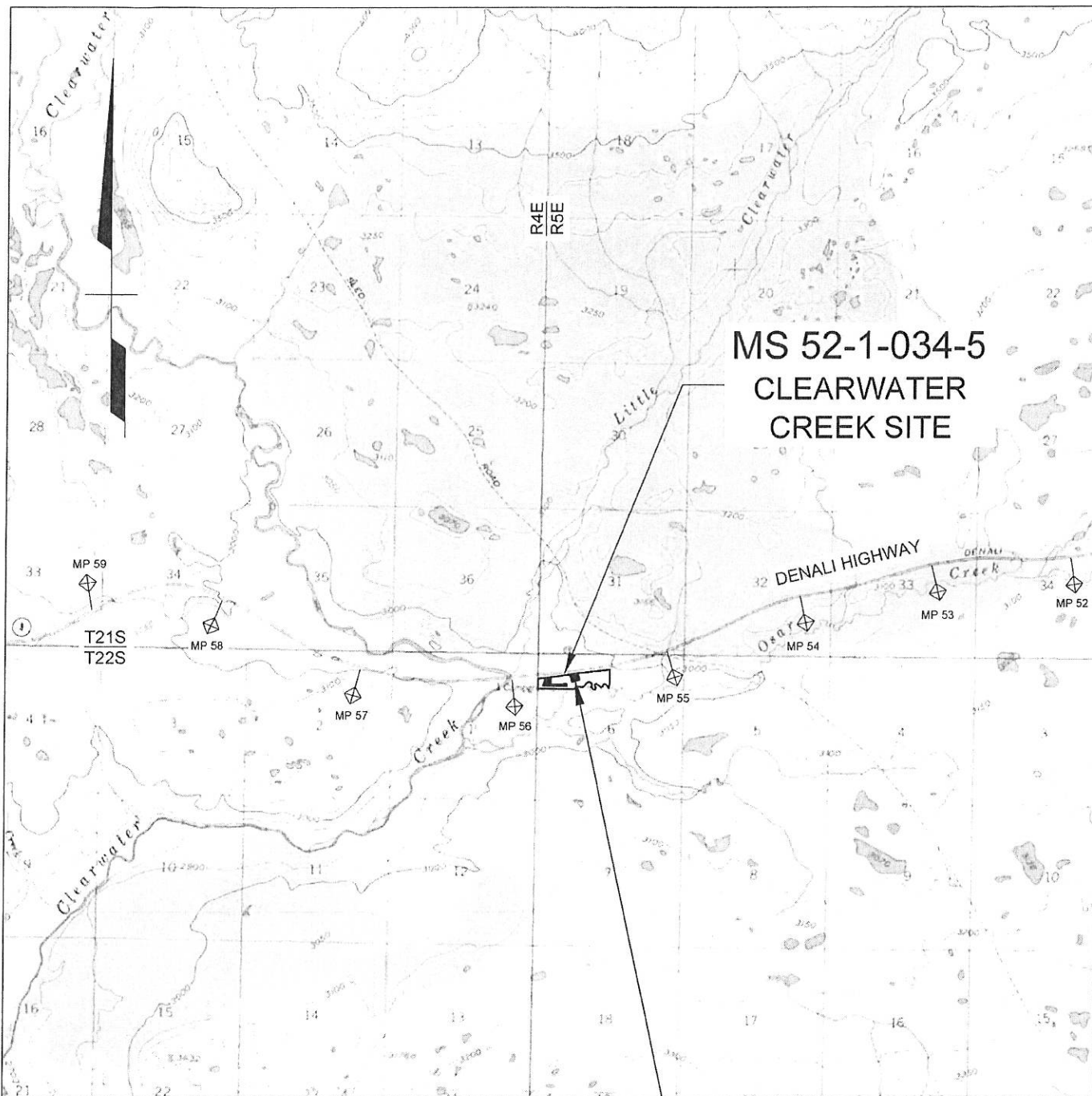

**MS 52-1-034-5
CLEARWATER
CREEK SITE**

32 DENALI HIGHWAY

U.S.G.S. QUADRANGLE: MT HAYES (A-6)

GPS COORDINATES FROM GOOGLE EARTH

UTM (WGS84-METERS)
ZONE 6: N6,990,330 E506,351
AK STATE PLANE (NAD83-US SURVEY FT)
ZONE 3: N3,305,017 E1,495,254

ACTIVE - OPEN



GRAPHIC SCALE IN MILES

BASE MAP CREATED WITH TERRAIN NAVIGATOR PRO

Prepared By:
R&M CONSULTANTS, INC.

STATE OF ALASKA DEPARTMENT OF TRANSPORTATION AND PUBLIC FACILITIES			
STATEWIDE MATERIAL SITE INVENTORY			
MS 52-1-034-5			
SCALE AS SHOWN	DESIGNED P.K.H. CHECKED C.H.R.	DRAWN P.K.H. DATE SEPT 2012	PAGE 2

Z:\project\1443.03\52_Denali_Highway\MS 52-1-034-5-A - Copy\acad\MS_Topo_Map_52-1-034-5.dwg

Plotted 7/29/2014 2:33 PM by Pete Hordcastle

STATE OF ALASKA
DEPARTMENT OF NATURAL RESOURCES
DIVISION OF MINING, LAND & WATER
Southcentral Region
550 W. 7th, Suite 900C
Anchorage, Alaska 99501-3577

NEGOTIATED MATERIAL SALE CONTRACT

ADOT Material Sale ADL 231676

MS 521-034-5

MP 56 Denali Highway

Expires May 31, 2024

Under AS 38.05.550-38.05.565 (Disposal of Materials) AS 38.05.125 and AS 38.05.810(a) and the regulations implementing these statutes, the State of Alaska, Department of Natural Resources, the seller, whose address is 550 W. 7th Avenue, Suite 900C, Anchorage, AK 99501-3577, agrees to sell, and the State of Alaska, Department of Transportation and Public Facilities (DOT&PF), the buyer, whose address is 2301 Peger Road Fairbanks Alaska 99709, agrees to buy, the material designated in this contract, subject to the provisions which follow:

1. Description: Location, Material, Quantity, and Price.

(a) The material sale area covered by this contract contains approximately 34 acres within Township 22 South Range 5 East Section 6: that portion of the N1/2NW1/4 lying south of the Denali Highway and north of Oscar Creek, Fairbanks Meridian. (**ADNR MATERIAL SITE ADL 231680**) for the removal of materials. The area is further designated by the boundaries shown on the attached sale area map, which is made part of this contract, or as designated on the ground by the seller.

(b) The material to be removed and the price are:

Kind of Material	No. Of Units	Unit Price	Total Price
Gravel	up to 500,000 cy	\$.50/cubic yard	See 2(a) below

2. Payments and Deposits. No part of the materials sold under this contract may be extracted from the sale area by the buyer except in accordance with the following terms:

(a) In accordance with Director's Policy File 93-06, Fee Schedule Section (17), Material Sales for Public Projects, Sale of materials to be used in constructing, reconstructing or maintaining a public project:

(1) for the first 5,000 cubic yards of material to be removed there will be no charge; for maintenance on an ongoing basis, a project is considered to last one year.

(2) for each cubic yard of material beyond 5,000 cubic yards, the base fee listed in the annual base price schedule under 11 AAC 71.090 will be charged. For the fiscal years 2014, the base price has been set at \$0.50 per cubic yard.